

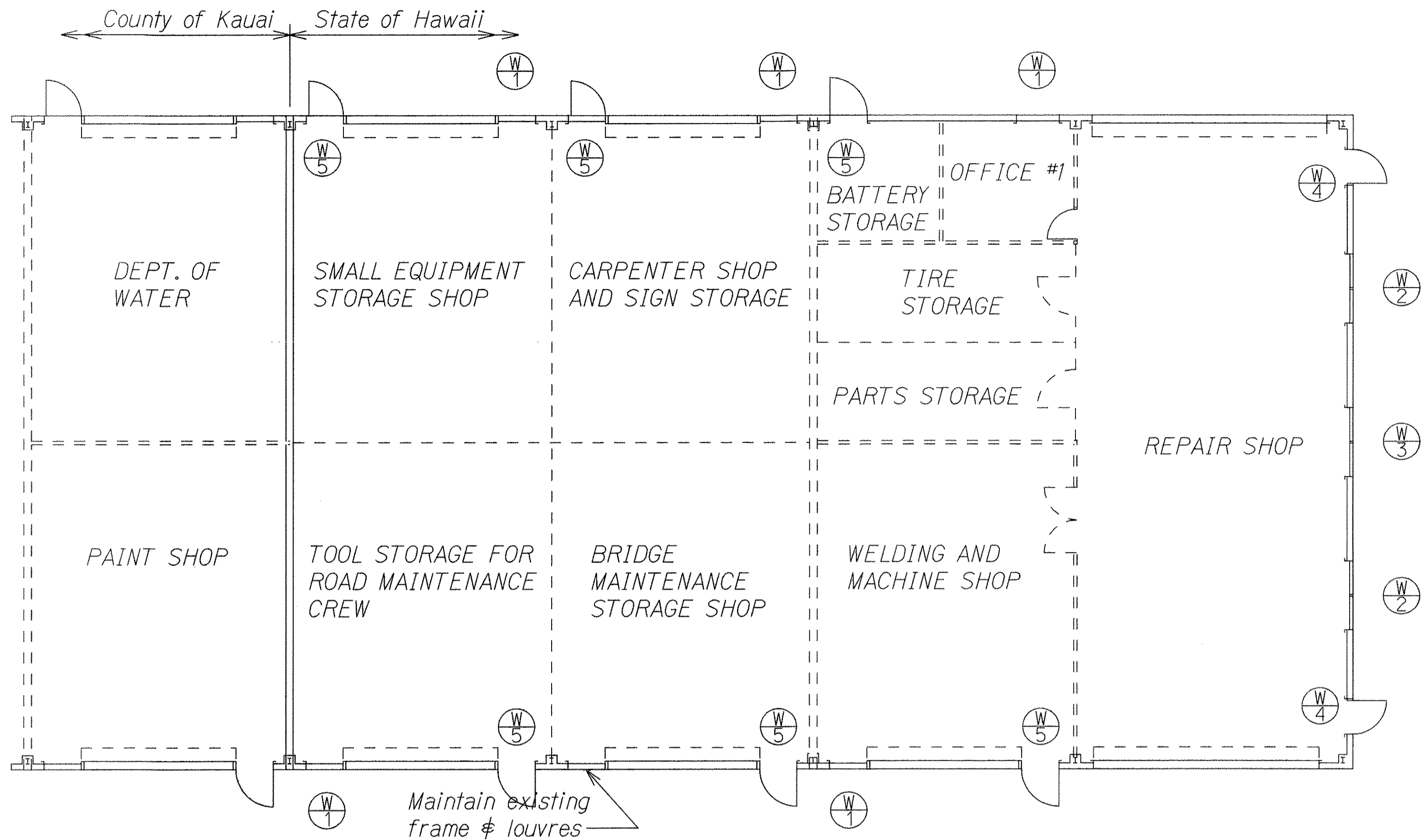

FED. ROAD DIST. NO.	STATE	PROJ. NO.	FISCAL YEAR	SHEET NO.	TOTAL SHEETS
HAWAII	HAW.	HWY-K-01-94M	1994	3R	10



LOUVRE REPLACEMENT PLAN
BUILDING A
 Scale: $\frac{3}{8}"=1'$

 - Denotes louvre frame & window replacement locations

Notes: (Typical for all louvre replacement plans)

1. Sash dimensions shown in the plans are approximate only. Prior to fabrication of aluminum frames for louvre windows, Contractor shall field measure and verify all window dimensions.
2. For operator type, see Special Provisions.
3. At locations where louvres meet glass headers, secure fixed glass header to louvre frame with aluminum channels screwed to frame. Caulk space between glass and channels.

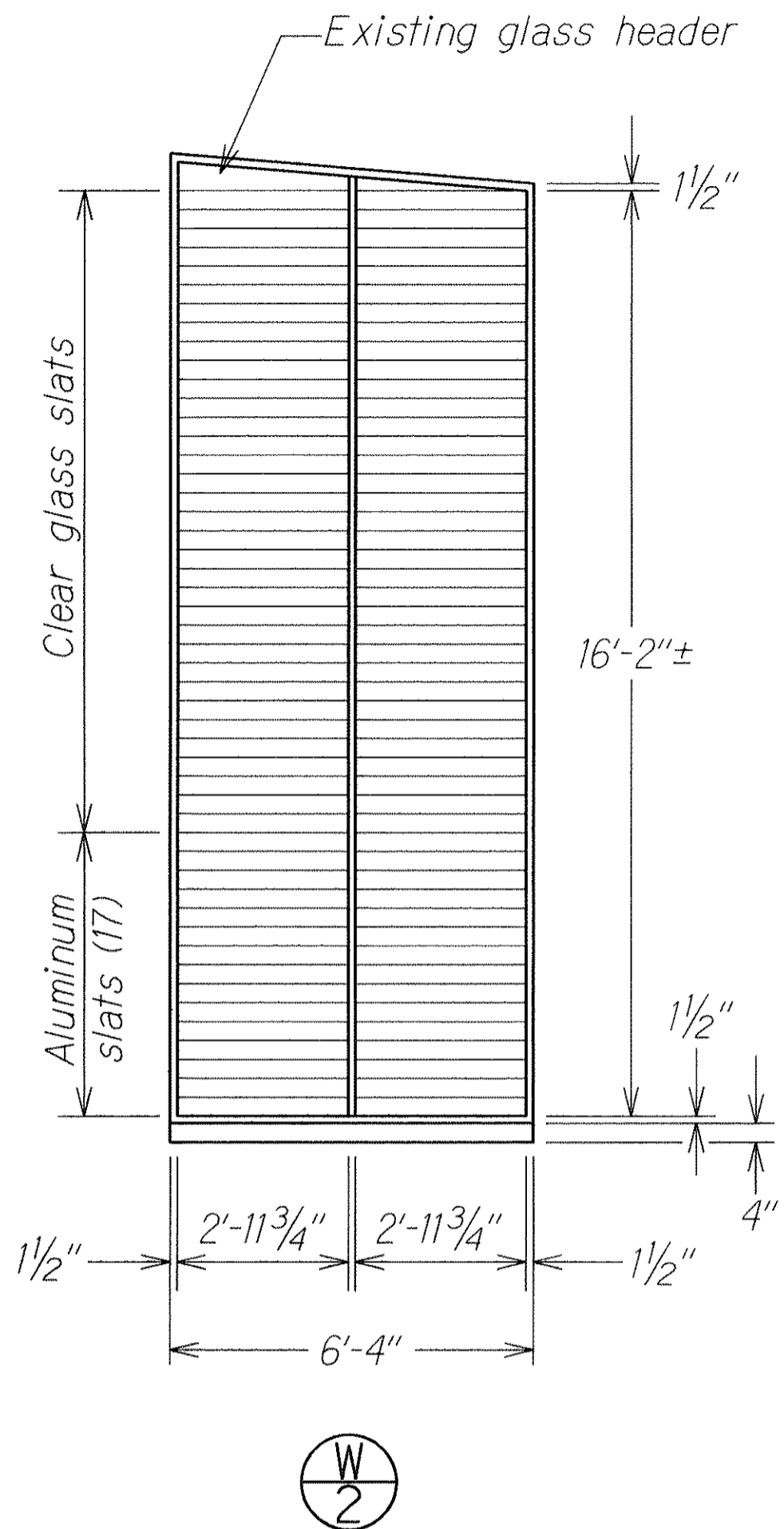
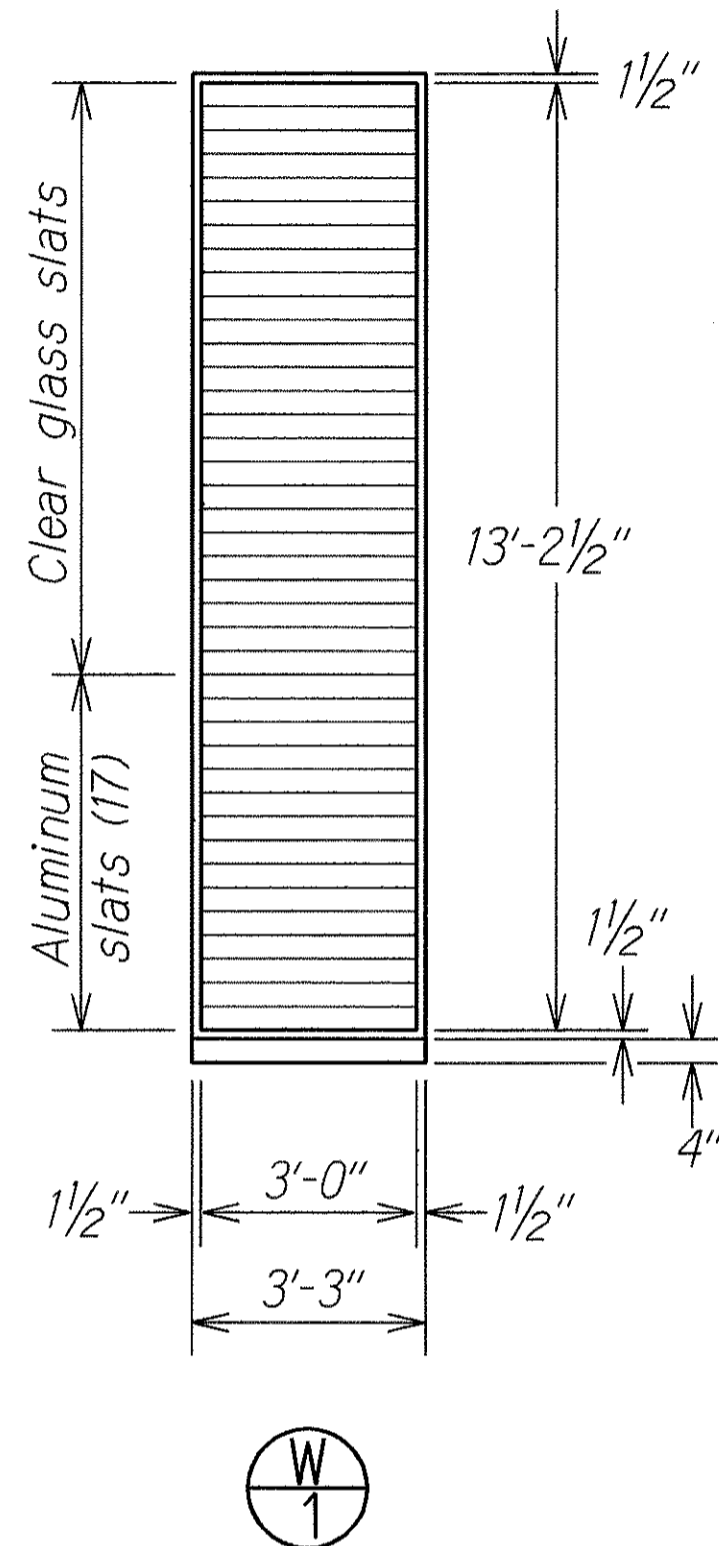
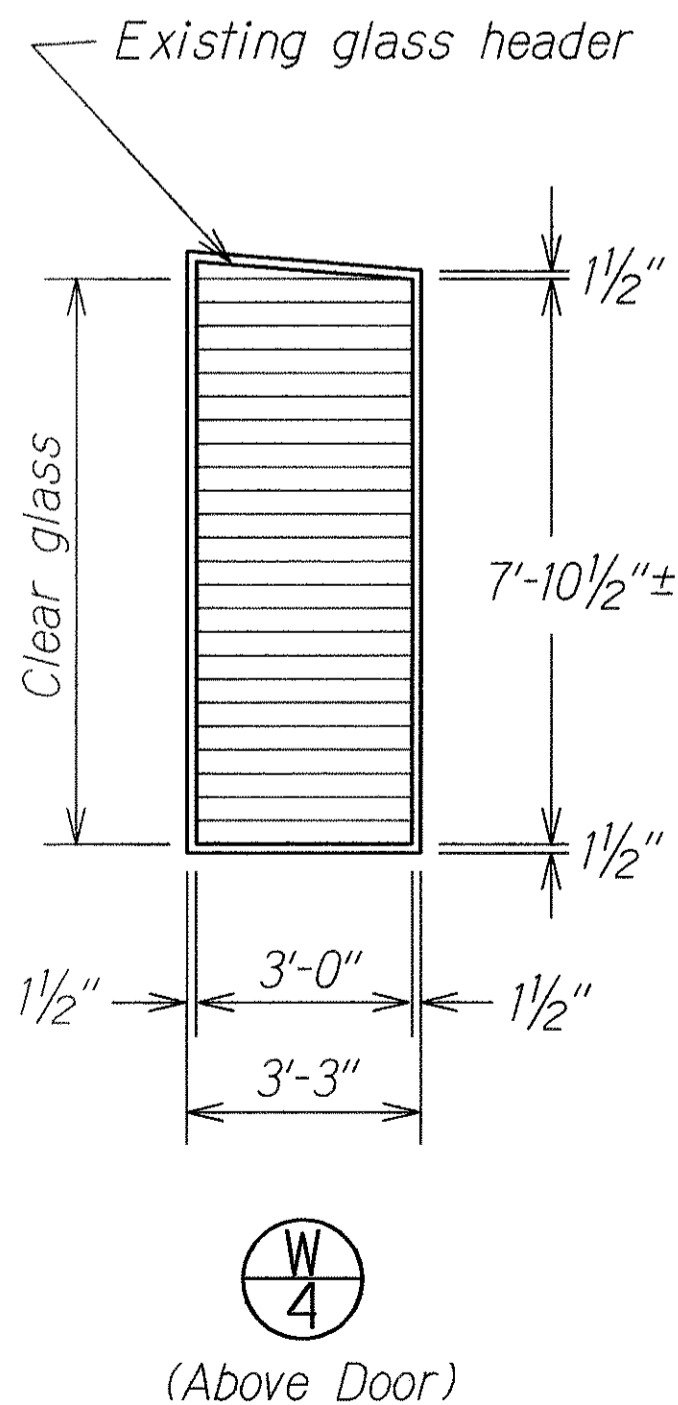
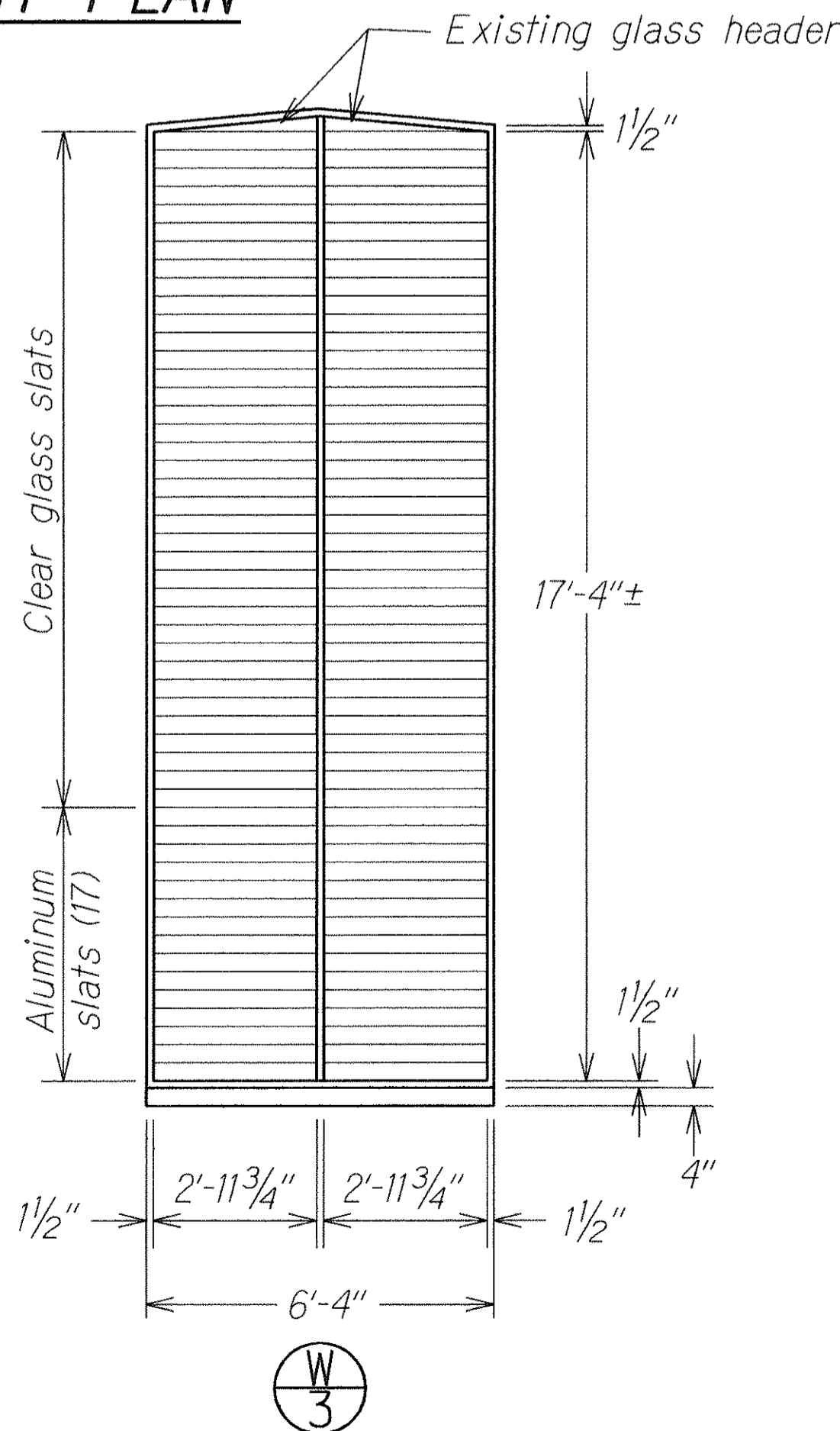

SASH TYPES (TYPICAL)
 Scale: $\frac{3}{8}"=1'$

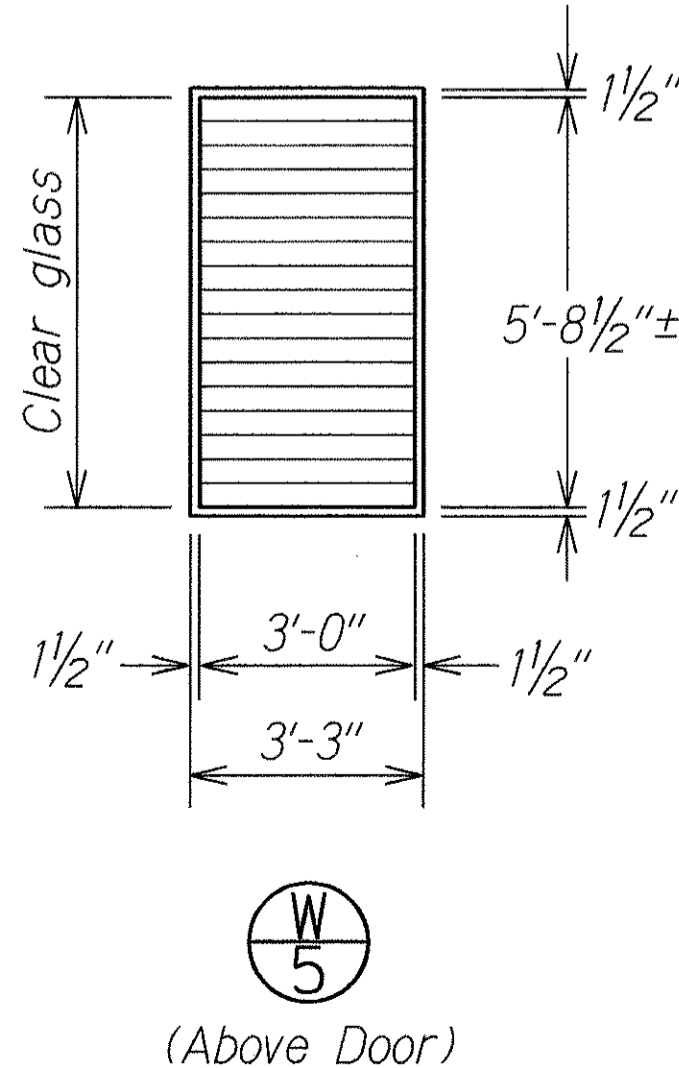
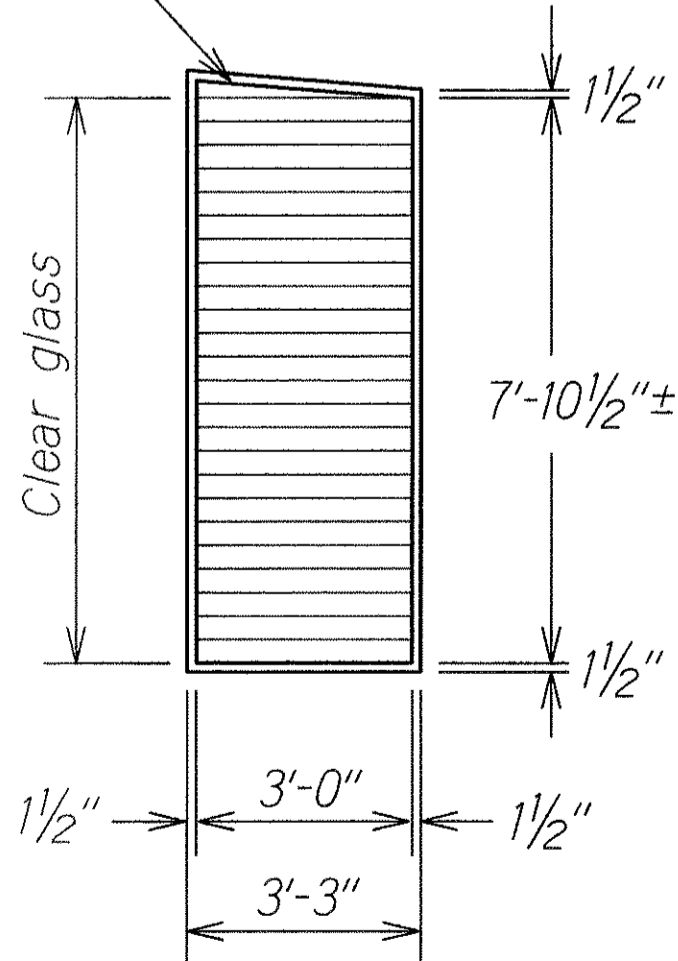

5-25-94	This Sheet Supersedes Plan Sheet No. 3
DATE	REVISION
STATE OF HAWAII DEPARTMENT OF TRANSPORTATION HIGHWAYS DIVISION LOUVRE REPLACEMENT PLAN BUILDING A KAPAA BASEYARD RENOVATIONS Project No. HWY-K-01-94M	
Scale: As Shown	Date: Sept., 1993
SHEET No. 1 OF 2 SHEETS	

DESIGNED BY	DATE
DRAWN BY	
CHECKED BY	
NOTED BY	
ORIGINAL PLAN	

FED. ROAD DIST. NO.	STATE	PROJ. NO.	FISCAL YEAR	SHEET NO.	TOTAL SHEETS
HAWAII	HAW.	HWY-K-01-94M	1994	4	10

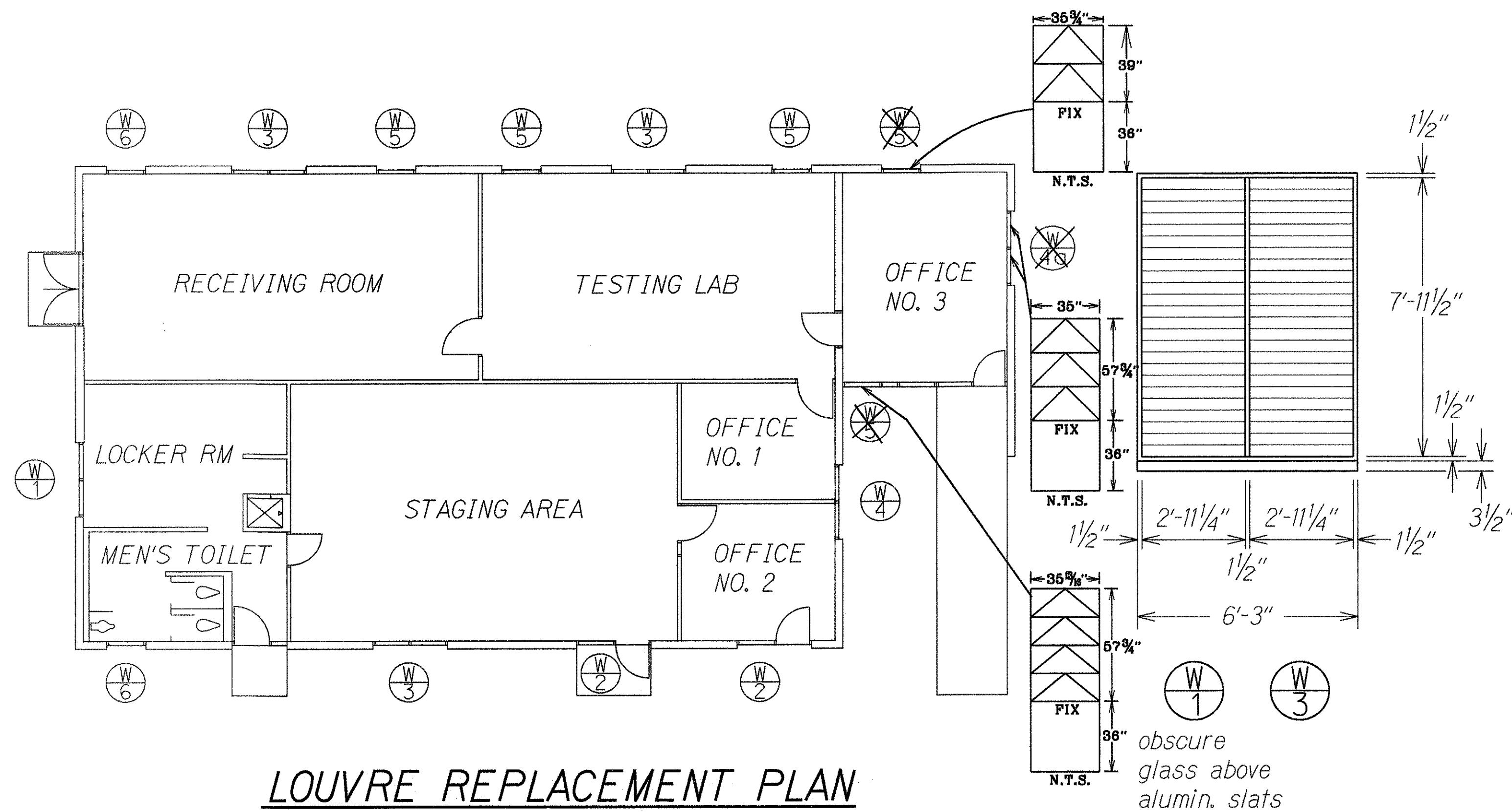

LOUVRE REPLACEMENT PLAN
BUILDING C
 Scale: 3/8"=1'

Note: For operator type, see Spec. Provisions
 (All louvres in Office No. 3 shall be equipped with Roto-type operator).

SASH TYPES (TYPICAL)
 Scale: 3/8"=1'

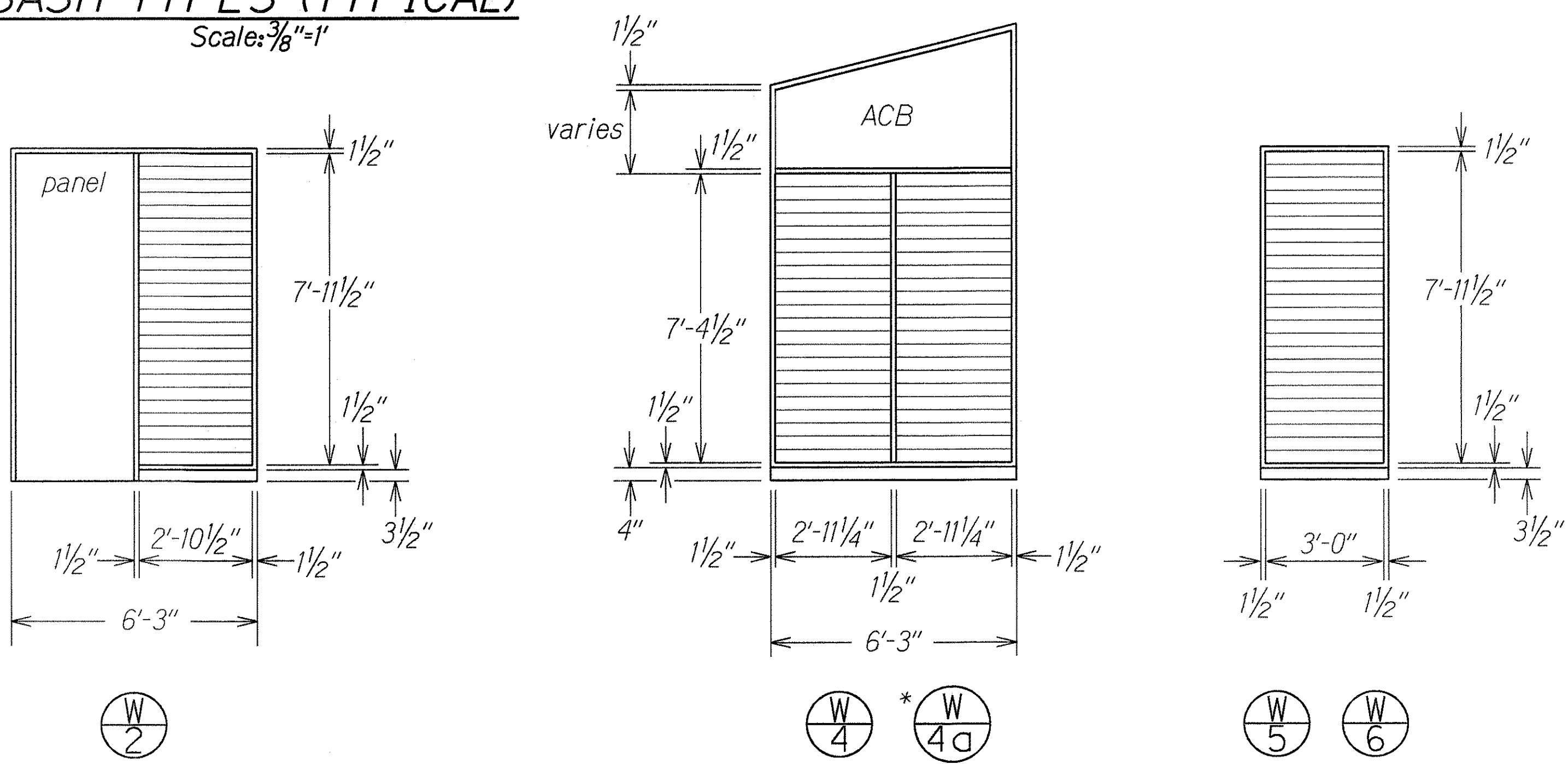

Note: For all sash types, Bldg."c", bottom 17 slats aluminum, clear glass above unless otherwise noted

* W4a is mirror image of W4

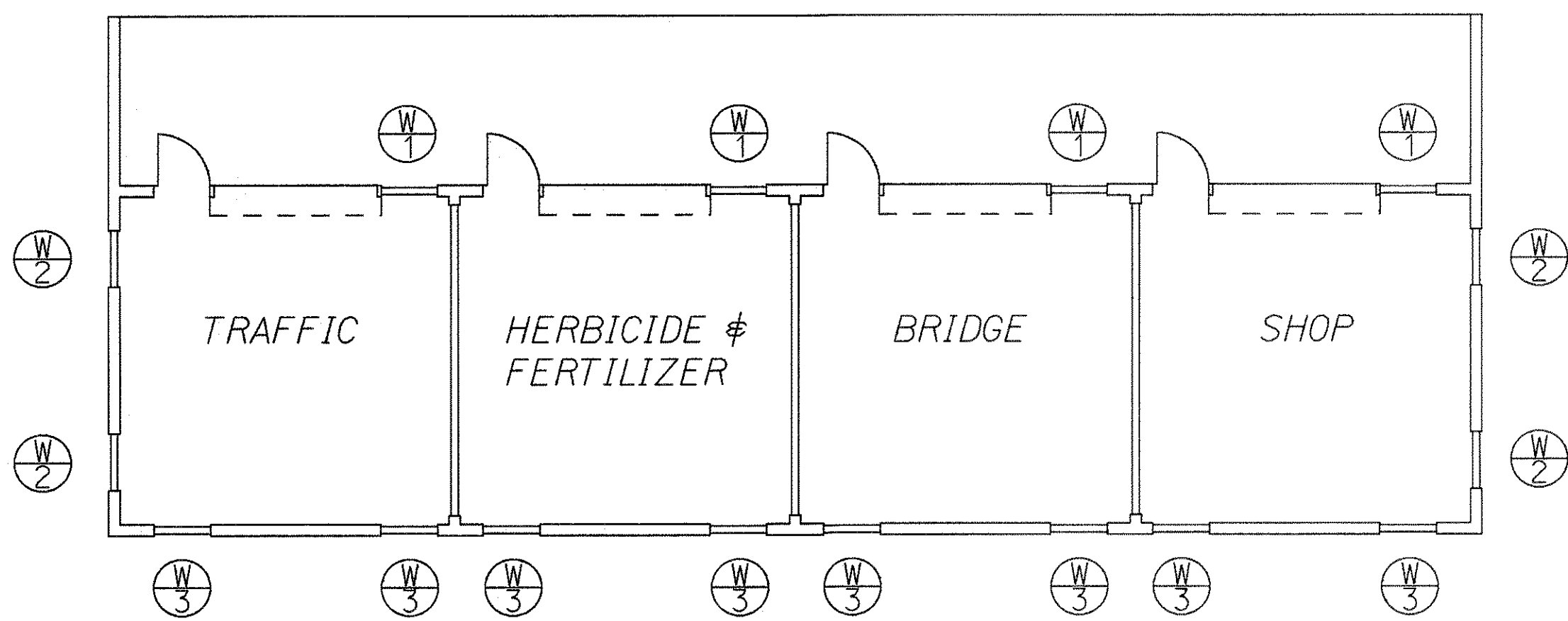

LOUVRE REPLACEMENT PLAN
BUILDING E
 Scale: 3/8"=1'

Note: For operator type, see Spec. Provisions

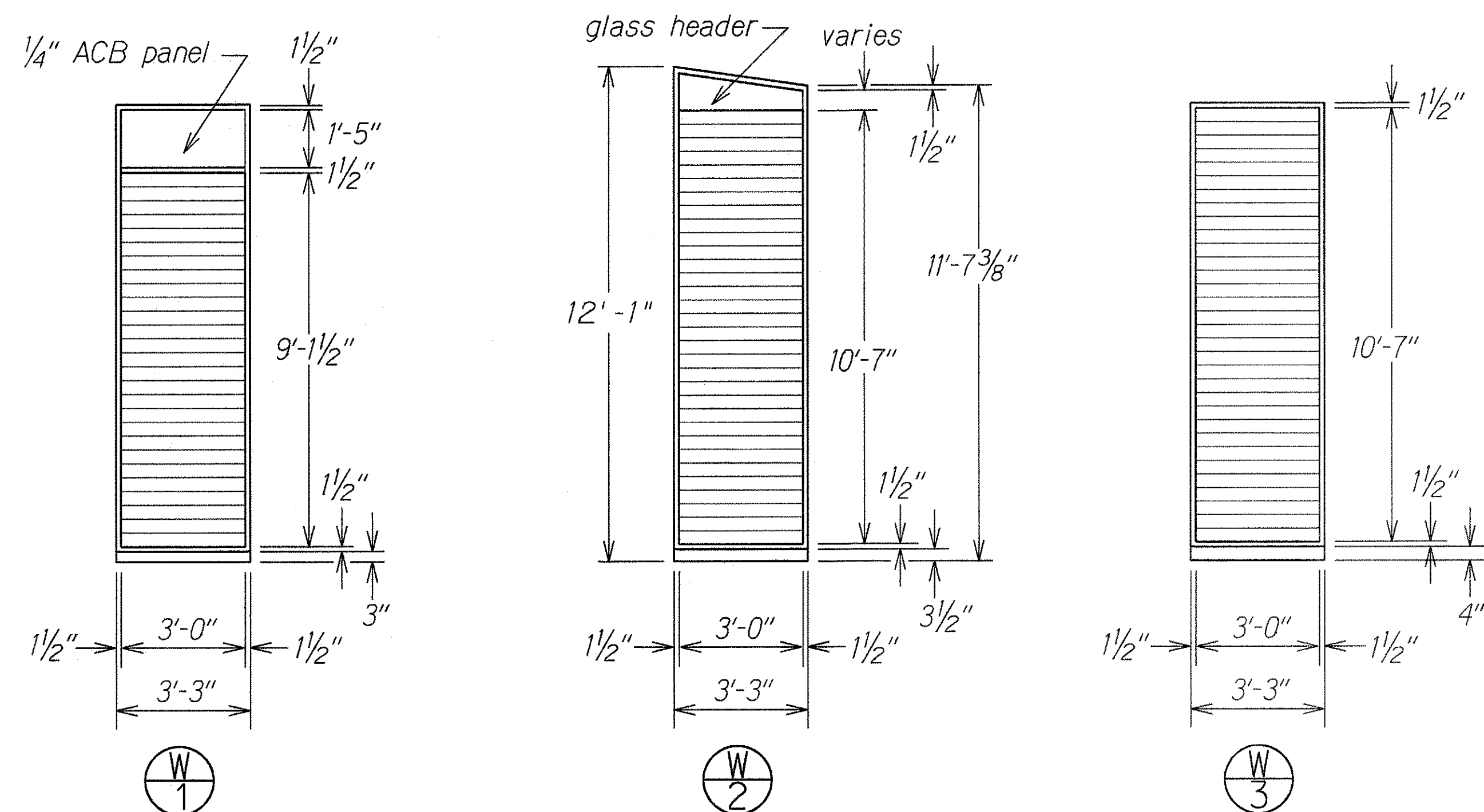

SASH TYPES (TYPICAL)
 Scale: 3/8"=1'

LEGEND FOR AS-BUILT POSTINGS	
	Squiggly line for as-built deletion
	Double line for as-built deletion
Roadway	Text for as-built posting

Note: All slats shall be clear glass

STATE OF HAWAII
DEPARTMENT OF TRANSPORTATION
HIGHWAYS DIVISION

LOUVRE REPLACEMENT PLAN
BUILDING C & E
KAPAA BASEYARD RENOVATIONS
Project No. HWY-K-01-94M
Scale: As Shown Date: Sept., 1993
SHEET No. 2 OF 2 SHEETS

ORIGINAL PLAN	SURVEY PLOTTED BY	DATE
NOTE BOOK	DRAWN BY	
	DESIGNED BY	
	CHECKED BY	