

SIGN NOTES

1. Letter Size:
- a. When letters are all uppercase, use series "E"
 - b. When Initial uppercase letter is used in conjunction with lowercase letters, use series "E" (M) for uppercase letter.
2. All signs shall conform to Section 621 of the Special Provisions and the latest editions and amendments of the following FHWA publications:
- a. "Manual on Uniform Traffic Control Devices for Streets and Highways" (MUTCD)
 - b. "Standard Highway Signs"
 - c. "Standard Alphabets for Highway Signs"
3. Borders, messages, arrows, symbols and shield shall conform to details as shown on the plans and as specified in the MUTCD.
4. Sign messages shall be as indicated on the plan.
5. All panels shall be reflectorized in accordance with Section 712.20 of the Standard Specifications. Minimum width of panels shall be 2 ft. Abutting edges of panels shall be in only one direction if vertical abutting edges are used. No horizontal abutting edges shall be allowed and vice versa.
6. Contractor shall submit all sign splicing details to the Engineer for approval. All backing for signs 4 feet by 6 feet or less shall be of one sheet.
7. Backing for all new Regulatory and Warning Signs shall not be spliced.
8. Final locations of all signs shall be approved by the Engineer prior to any installation work.
9. Existing signs that are to be replaced, shall not be removed until new signs are installed as replacements, or the messages are no longer necessary.
10. Existing signs not shown on these plans shall remain as posted unless otherwise directed by the Engineer. Removal and disposal of existing signs and/or posts as designated on these plans shall be incidental to the various signing items.
11. Removal of Existing Delineators and Posts shall be considered incidental to the various signing items.
12. Removing and reinstalling existing Street Name Signs on Regulatory and Warning Sign Post shall not be paid for separately but shall be considered incidental to the various signing items.
13. All Destination, Street Name, and Non-Standard Signs, that are to be Removed and Installed at the same or new location, shall be identical to the existing sign in size and text. The Contractor shall submit Shop Drawings to the Engineer for approval prior to fabricating the sign.
14. All signs shall be installed on square tubing posts, unless otherwise noted.
15. Mount Sign Posts with RM-3 reflector markers as directed in the field by the Engineer.
16. Sign posts shall be painted with yellow reflective paint, except where located behind guardrails. Such paint work shall be considered incidental to sign items.
17. The Contractor shall erect at the beginning of the project and at the end of the project advance construction warning signs as indicated on the plans or as directed by the Engineer for the duration of the highway project and shall be maintained by the Contractor. These signs shall be placed in addition to the required traffic control signs called for in Section 645-Traffic Control. The advance construction warning signs shall be new and become the property of the State. The Contractor shall remove, clean, and deliver the signs and posts to the Hilo District Baseyard or as directed by the Engineer at the end of the project.

REGULATORY AND WARNING SIGN SUMMARY

SIGN NO.	MESSAGE	QUANTITY			
		(10 SQ. FT. OR LESS)		(MORE THAN 10 SQ. FT.)	
		W/POST	W/O POST	W/POST	W/O POST
D11-1 / M4-12	BIKE ROUTE / END	1			
R1-2	YIELD	3			
R3-50	ONLY ↑ ↘ ONLY	1			
R3-51	ONLY ↑ ↗	2			
R3-52	ONLY ↑ ↑ ↗			3	
R3-53	ONLY ↑ ↑ ↗			2	
R3-54	↑ ↑ ONLY	2			
R8-3a	ANYTIME ↔	1			
R10-12	LEFT TURN YIELD ON GREEN ●		2		
R10-5-A	ON LEFT ARROW ONLY		2		
R15-1	UNLAWFUL TO LITTER \$500 FINE	1			
W11-1	BICYCLE / SHARE THE ROAD	1			
TOTAL		12	4	5	0

STREET NAME SIGN SUMMARY

SIGN NO.	MESSAGE	QUANTITY
D3-1	Kanoelehua Ave.	2
D3-2	Pualako St.	2
TOTAL		4

PAVEMENT MARKING SUMMARY

DESCRIPTION	QUANTITY
PAVEMENT MARKERS	
TYPE A	368 EA.
TYPE C	341 EA.
TYPE D	20 EA.
TYPE H	85 EA.
THERMOPLASTIC EXTRUSION	
4-Inch Pavement Striping	9,686 L.F.
8-Inch Pavement Striping	3,206 L.F.
12-Inch Wide Stop Bars	778 L.F.
Crosswalk Marking	19 LANES
Pavement Arrow	45 EA.
Pavement Word	21 EA.
Pavement Symbol	6 EA.

STATE ROUTE MARKER SUMMARY

SIGN NO.	MESSAGE	LOCATION	ASSEMBLY	
			TYPE A	TYPE B
M1-6(11), M6-3 / M1-6(2000), M6-4	11 2000	I.B.L. Sta. 1351+15± Rt.		1
M1-6(11), M6-4	11	Pualako St. Sta. 12+00± Lt.	1	
M1-6(2000), M2-1	2000 JCT	I.B.L. Sta. 1345+15± Rt.	1	
TOTAL			2	1

MILE POST MARKER SUMMARY

SIGN NO.	MESSAGE	LOCATION	QUANTITY
D10-1, D10-7	MILE "0" HWY 2000	Pualako St. Sta. 8+30± Lt.	1
TOTAL			1



THIS WORK WAS PREPARED BY ME OR UNDER MY SUPERVISION AND CONSTRUCTION OF THIS PROJECT WILL BE UNDER MY OBSERVATION.

DATE: *[Signature]*

STATE OF HAWAII
DEPARTMENT OF TRANSPORTATION
HIGHWAYS DIVISION

SIGN DETAILS & NOTES

PUAINAKO STREET IMPROVEMENTS, PHASE 1
Kilauea Ave. to Kanoelehua Ave.

Project No. 2000E-01-00

Scale: N/A

Date: May, 2000

SHEET No. 1 OF 2 SHEETS

FED. ROAD DIST. NO.	STATE	PROJ. NO.	FISCAL YEAR	SHEET NO.	TOTAL SHEETS
HAWAII	HAW.	2000E-01-00	2000	30	60

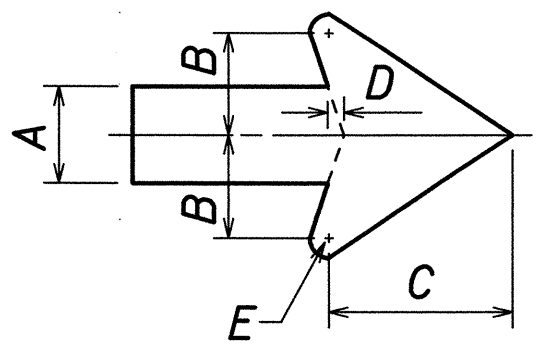

ARROW DIMENSIONS (Inches)				
A	B	C	D	E
2 1/2"	2 7/8"	5 1/16"	3/8"	1/2"

NOTE:
1. All Signs on this Sheet shall have a Black Non-ReflectORIZED Legend and Border on a White ReflectORIZED Background.

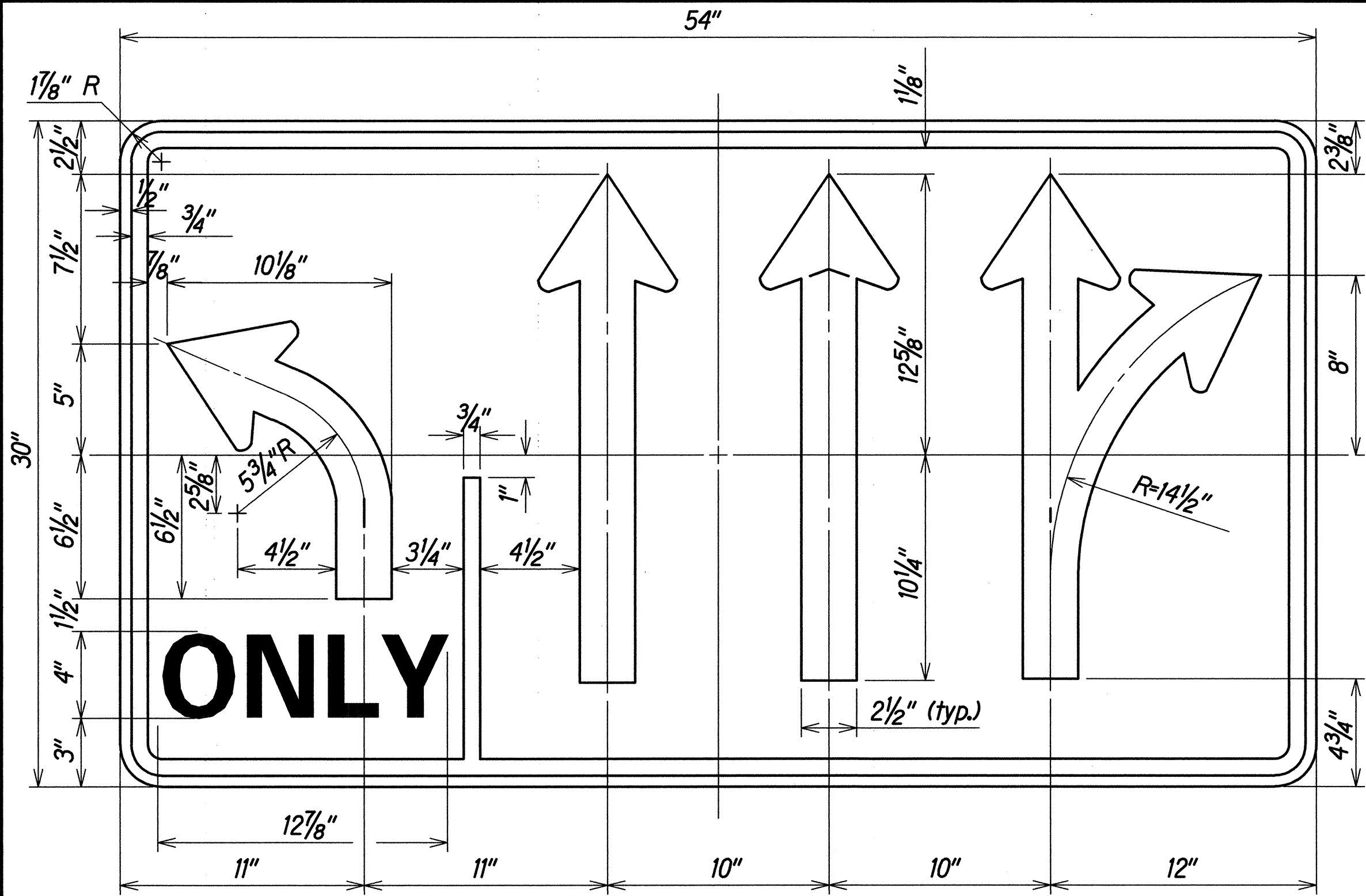

R3-52

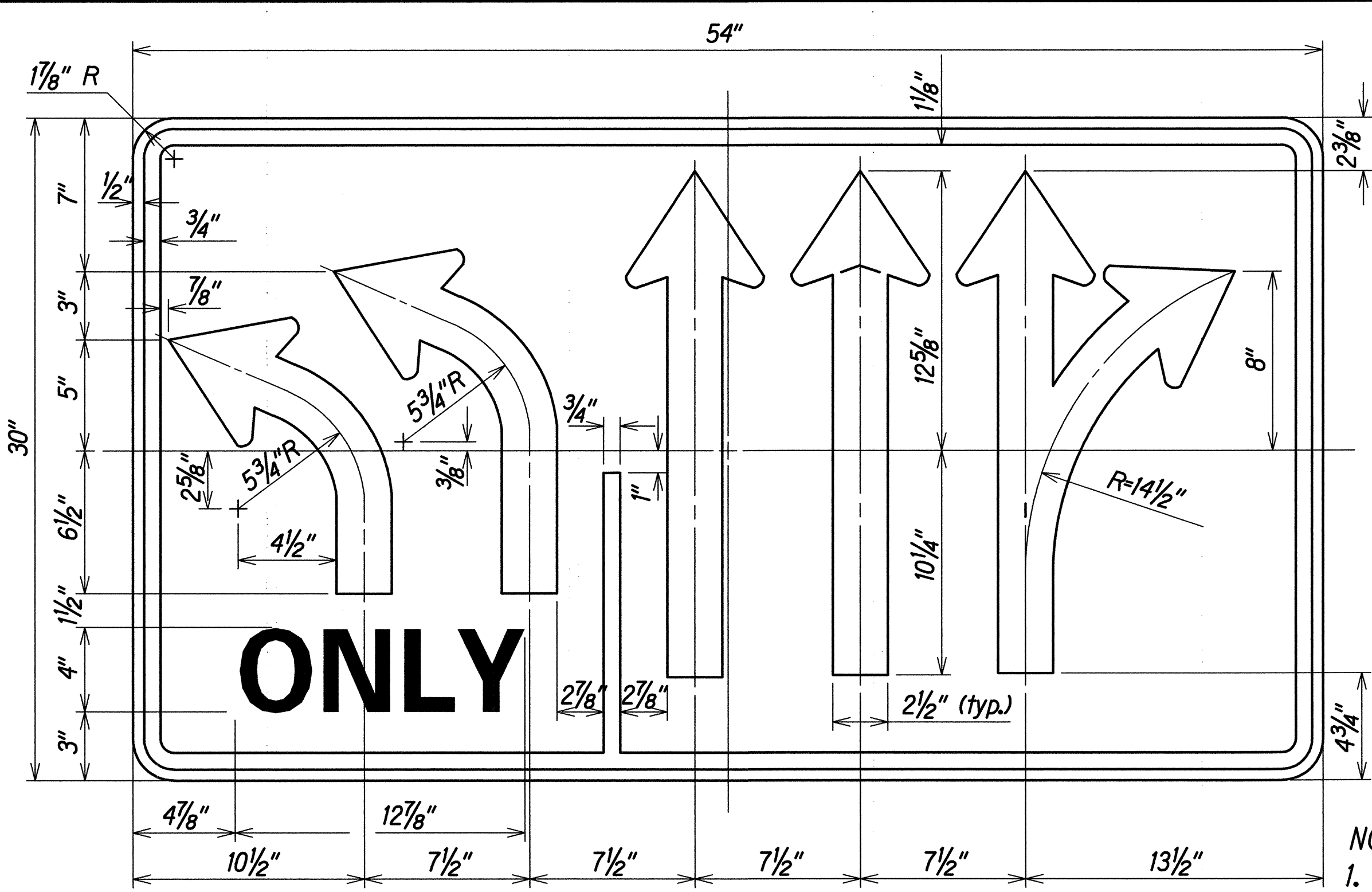

R3-53

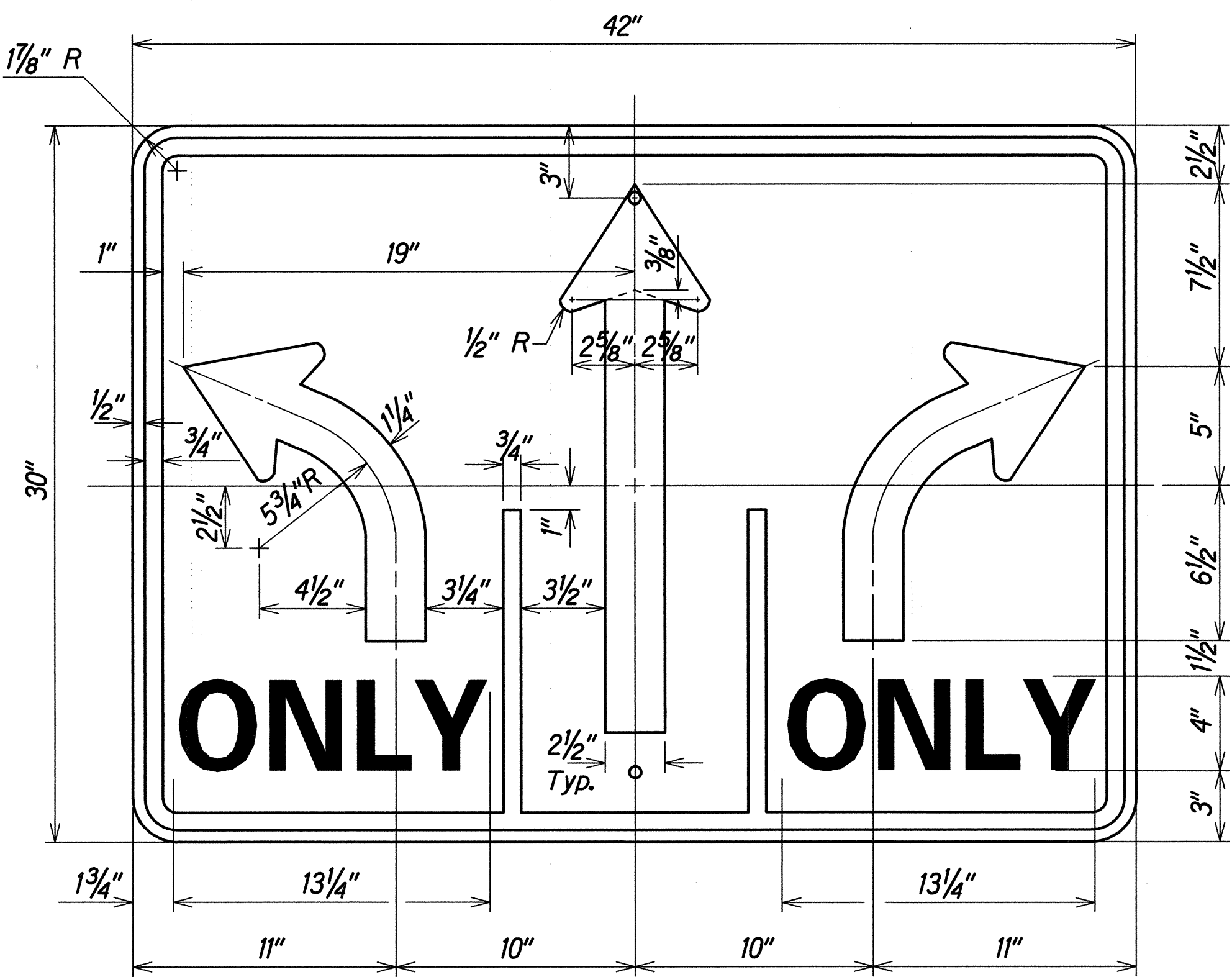

R3-50

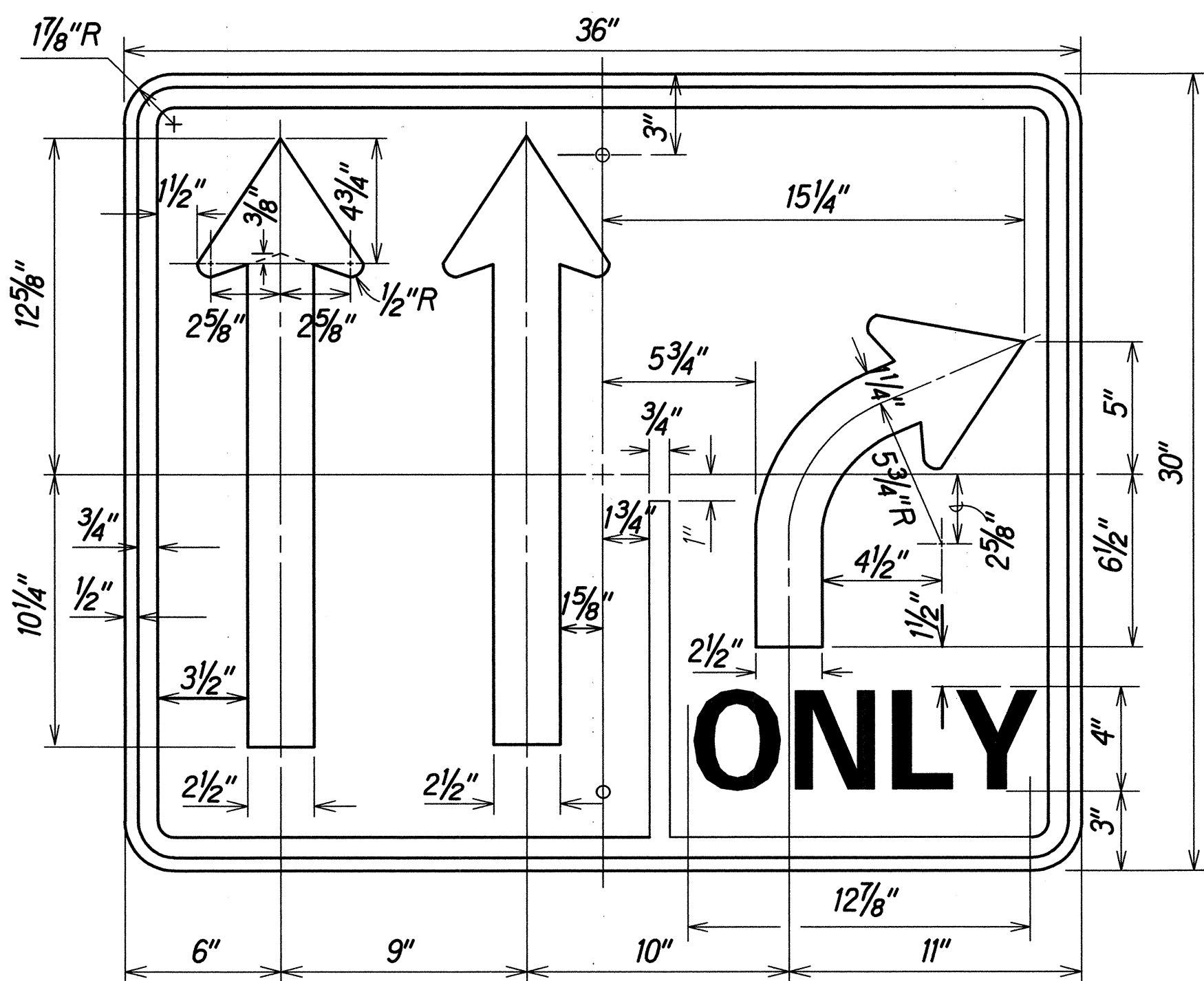

R3-54

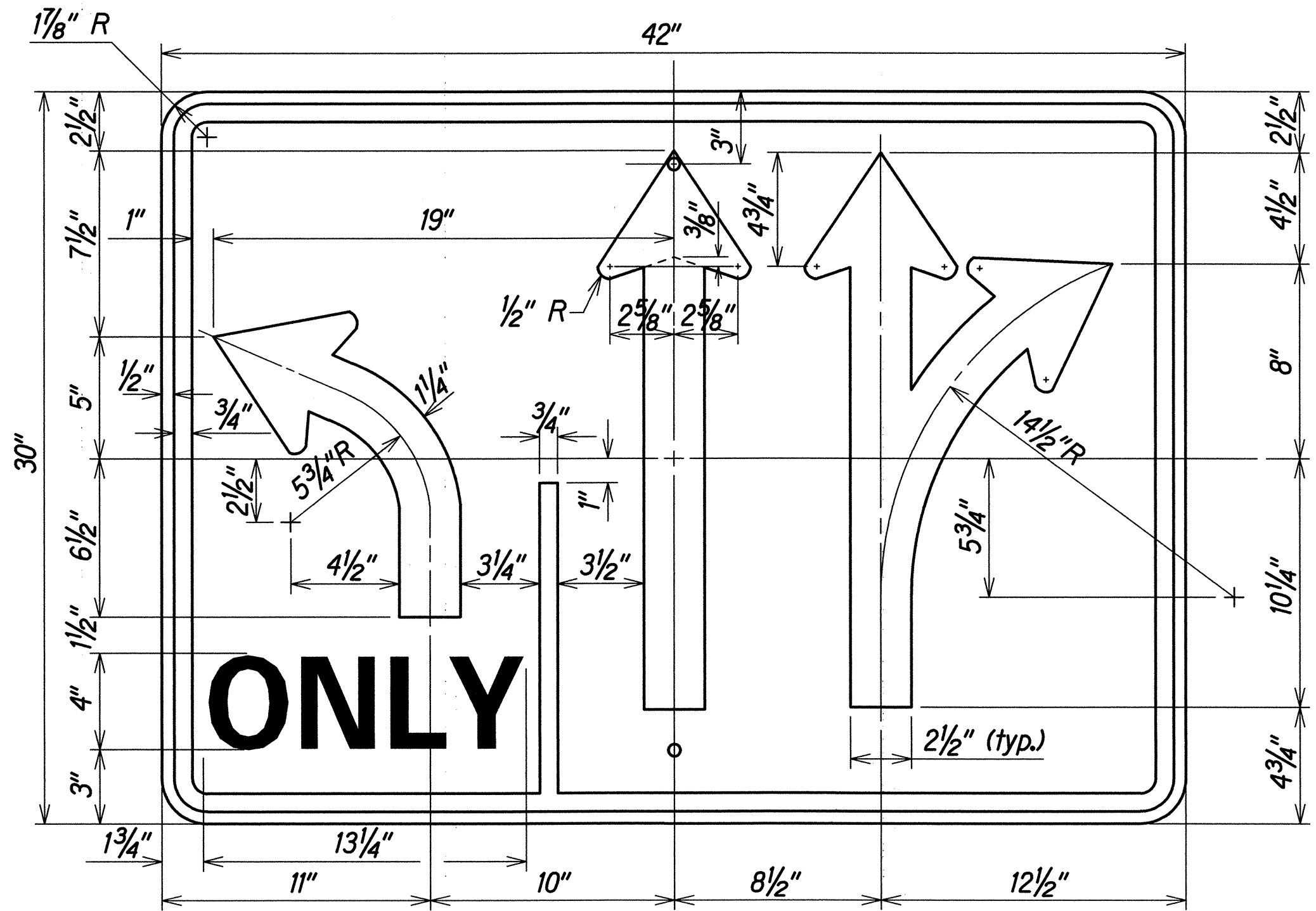

R3-51

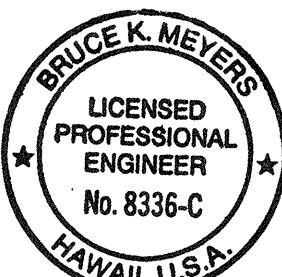

THIS WORK WAS PREPARED BY ME OR UNDER MY SUPERVISION AND CONSTRUCTION OF THIS PROJECT WILL BE UNDER MY OBSERVATION.
DATE: *[Signature]*

SIGN DETAILS & NOTES	
STATE OF HAWAII DEPARTMENT OF TRANSPORTATION HIGHWAYS DIVISION	
PUAINAKO STREET IMPROVEMENTS, PHASE 1 Kilauea Ave. to Kanoelehua Ave.	
Project No. 2000E-01-00	
Scale: N.T.S.	Date: May, 2000
SHEET No. 2 OF 2 SHEETS	

DESIGNED BY	DATE
DRAWN BY	
CHECKED BY	
NOTED BY	
APPROVED BY	

9905014pasc02.dgn

FED. ROAD DIST. NO.	STATE	PROJ. NO.	FISCAL YEAR	SHEET NO.	TOTAL SHEETS
HAWAII	HAW.	2000E-01-00	2000	ADD.30S-1	60

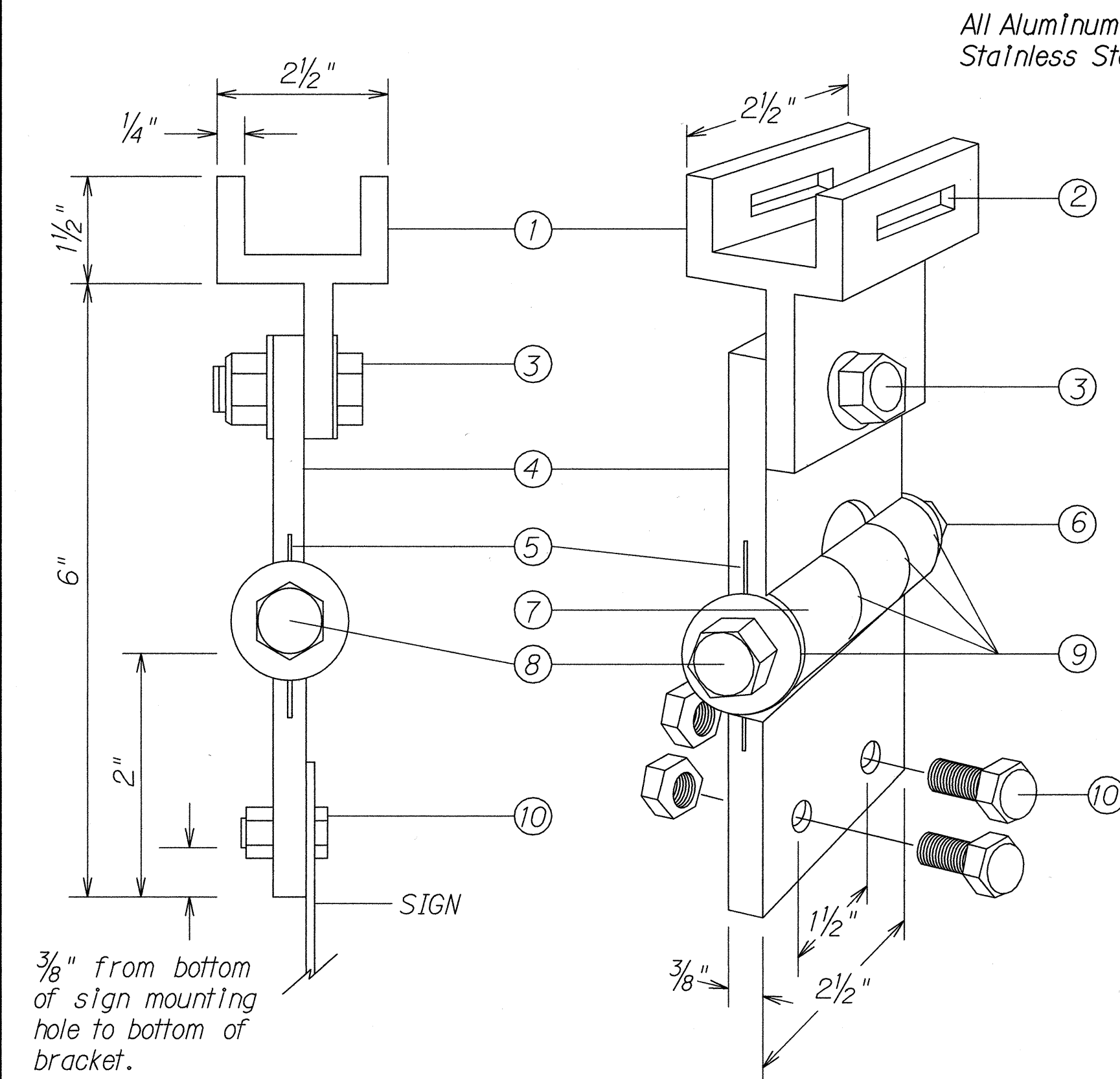

**FIXED LENGTH NON-ADJUSTABLE
SWING SIGN BRACKET**

- ① Pivotal Upper Bracket
- ② 1 5/8" x 1/4" Slot for double strapping to electrolier mast arm. (M2G-34S(HD) .030" x 3/4" Heavy Duty Stainless Steel Strap with M2G-34B(HD) Buckle recommended.)
- ③ 1/2" - 13 x 1 1/2" Stainless Steel Hex Head Bolt with Stainless Steel Hex Lock Nut and 1/16" Stainless Steel Washer (both sides). Allows upper bracket to pivot and align with electrolier mast arm.
- ④ 6" Overall drop with Fixed Length Sign Bracket
- ⑤ Stainless Steel Dampener Spring (Removable)
- ⑥ Stainless Steel Hex Lock Nut with 1/16" Stainless Steel Washer
- ⑦ 1" O.D. Axle Housing
- ⑧ 1/2" - 13 x 4" Stainless Steel Hex Head Bolt with 1/16" Stainless Steel Washer
- ⑨ Ollite Bushing
- ⑩ Sign Mounting Sets, consisting of two each 5/16" - 18 x 1" Stainless Steel Hex Head Bolt with Stainless Steel Hex Lock Nut. Two holes on 1/2" centers provide positive lock sign mounting to bracket.

All Aluminum 6061T6 Alloy and
Stainless Steel Components.

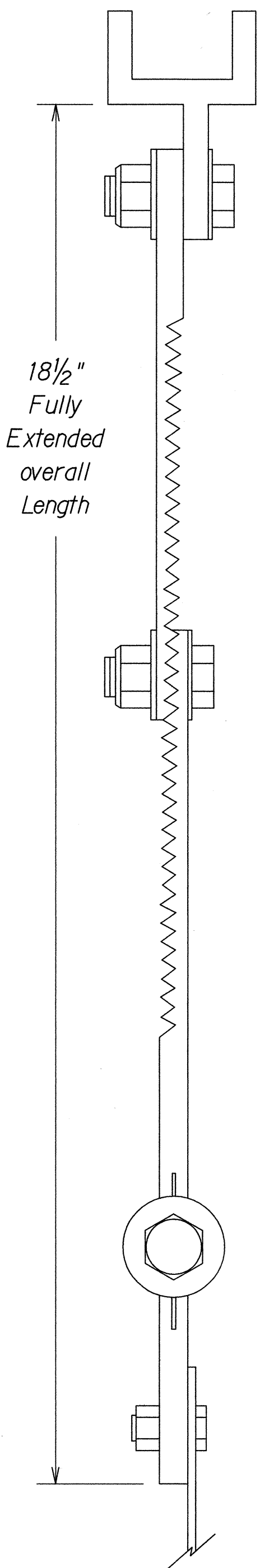

Allows
Length
Adjustment
of 4 1/2"

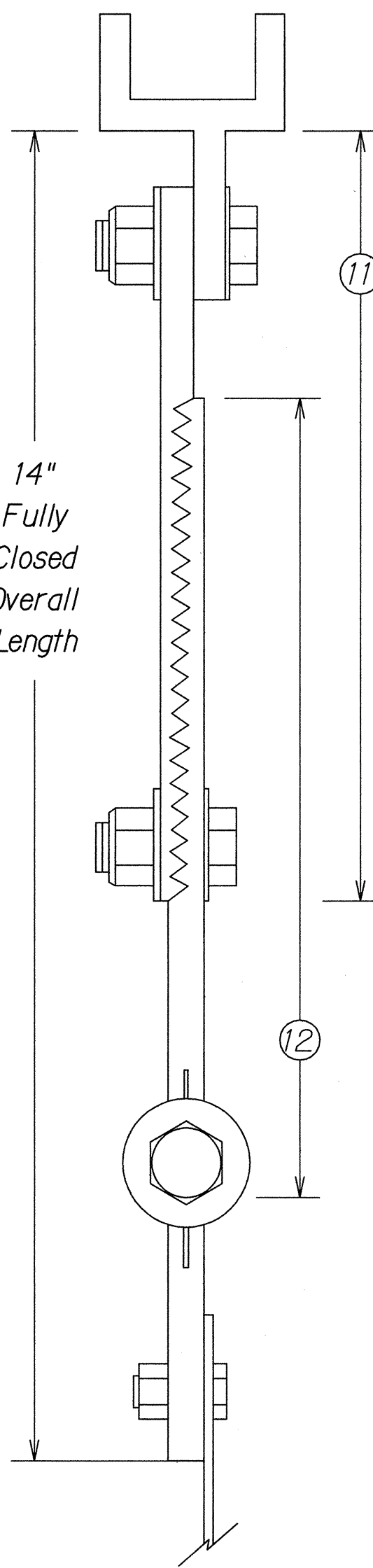

**ADJUSTABLE LENGTH
SWING SIGN BRACKET**

- ⑪ 8 1/4" overall length Upper Adjustable Sign Bracket section
- ⑫ 9" overall length Lower Adjustable Sign Bracket section, including Axle Housing (8" overall length to top of Axle Housing)
- ⑬ 1/2" - 13 x 1 1/2" Stainless Steel Hex Bolt with Stainless Steel Hex Lock Nut and 1/16" Stainless Steel Washers (both sides). Loosen lock nut, adjust bracket teeth to level sign.

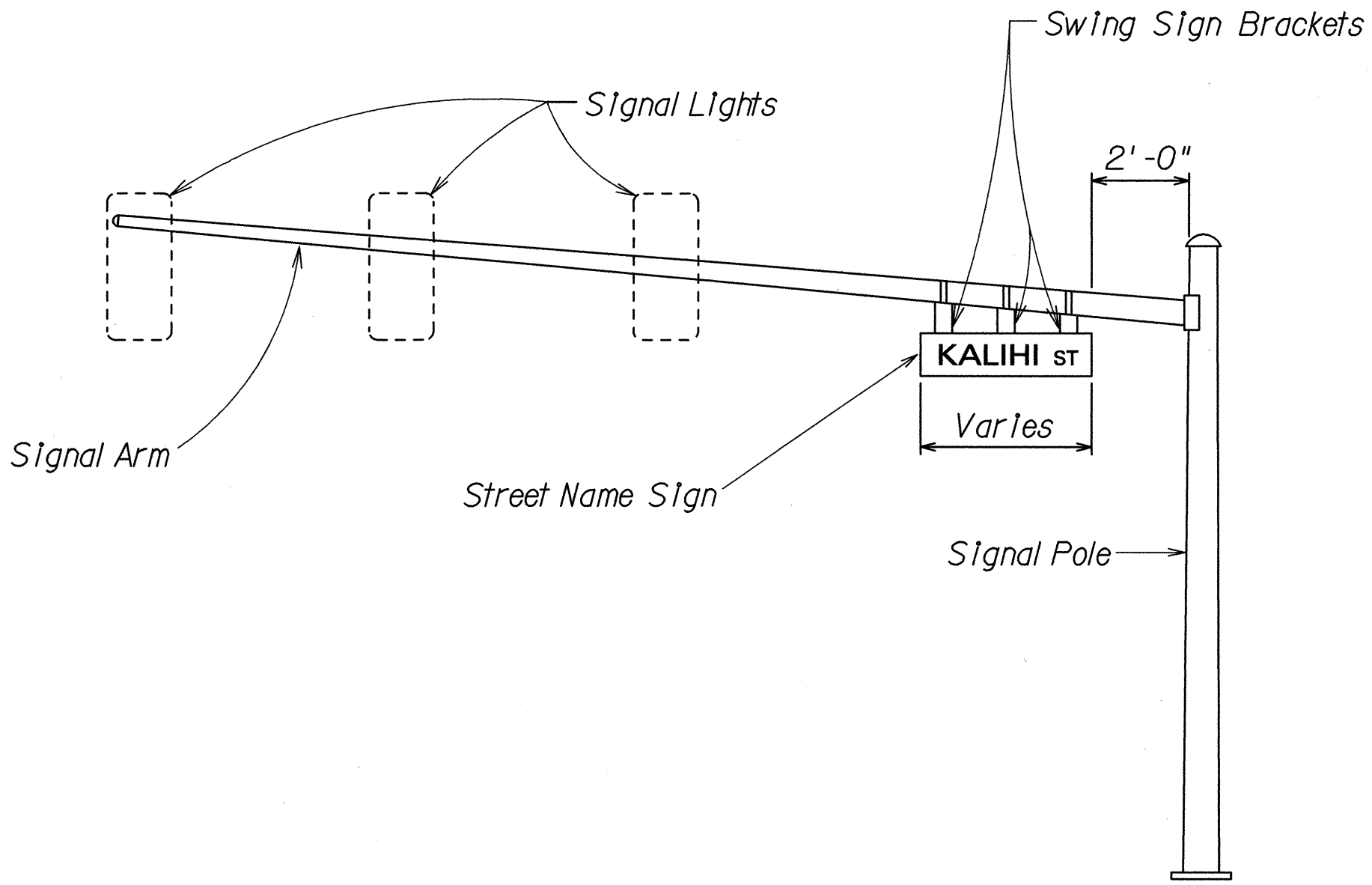

**STREET NAME SIGN MOUNTING
ON MAST ARM**

SURVEY PLOTTED BY	DATE
DRAWN BY	
DESIGNED BY	
QUANTITIES BY	
CHECKED BY	
ORIGINAL PLAN	
NOTE BOOK	
NO.	

99050/4/00assmldgn

Note: Dimensions may vary slightly.

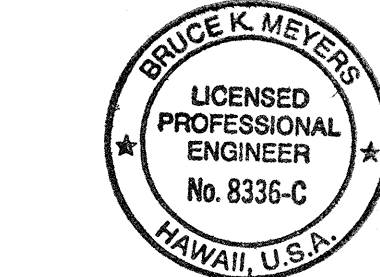

THIS WORK WAS PREPARED BY ME OR UNDER MY SUPERVISION AND CONSTRUCTION OF THIS PROJECT WILL BE UNDER MY OBSERVATION.
Bruce K. Meyers
DATE: _____

6/16/00	Added Entire Sheet.
Date	Revision

STATE OF HAWAII
DEPARTMENT OF TRANSPORTATION
HIGHWAYS DIVISION
SIGN MOUNTING DETAIL
PUAINAKO STREET IMPROVEMENTS, PHASE 1
Kilauea Ave. to Kanoolehewa Ave.
Project No. 2000E-01-00
Scale: N.T.S. Date: June, 2000
SHEET No. 1 OF 1 SHEETS