

**STATE OF HAWAII
DEPARTMENT OF TRANSPORTATION
HIGHWAYS DIVISION**

**ADDENDUM NO. 1
for
AKONI PULE HIGHWAY PAVEMENT PREVENTIVE MAINTENANCE
VICINITY OF MAHUKONA TO KOHALA RANCH
FEDERAL-AID PROJECT NO. STP-0270(019)**

The following amendments shall be made to the Bid Documents:

A. SPECIFICATIONS

1. Amend section 645 – Traffic Control by adding “Rough Road / Uneven Lanes, Figure 8 – Traffic Control Plan”, sheet 645-1a dated 6/15/11.

B. PROPOSAL

1. Replace sheet P-1 with revised sheet P-1 dated 6-15-11
2. Replace sheet P-8 to P-10 with revised sheet P-8 to P-10 dated 6-15-11.

C. PLANS

1. Plan Sheet 3, General Notes – Delete general note no. 11 and general note no. 12.
2. Plan Sheet 3, General Notes – Add the following note to the General Notes:

“19. The Contractor's attention is called to page 645-1a of the Special Provisions. The Contractor is required to install applicable signs as part of the Work Zone Traffic Control, whenever he creates a condition of rough roads (e.g., exposed cold-planed surface) or uneven lanes (e.g., failure to block pave or to block cold-plane the roadway). Installation of these signs shall be considered as included under the Lump Sum payment for Item No. 645.0100, Traffic Control.”
3. Plan Sheet 6, Typical Section and Details – Add the following note to the Typical Pavement Edge Detail: “The safety edge is not required

behind guardrails."

4. Plan Sheet 6, Typical Section and Details – Revise the label shown on the Typical Section, "Cold plane $\frac{3}{4}$ " in the travelway and shoulders and seal cracks", by deleting the words "and seal cracks".

D. PRE-BID MEETING MINUTES

1. Attached are the June 9, 2011 Pre-Bid Meeting Minutes and attendance sheet for your information.

Please acknowledge receipt of this Addendum No. 1 by recording the date of its receipt in the space provided on page P-4 of the Proposal.

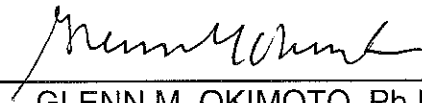

GLENN M. OKIMOTO, Ph.D.
Director of Transportation

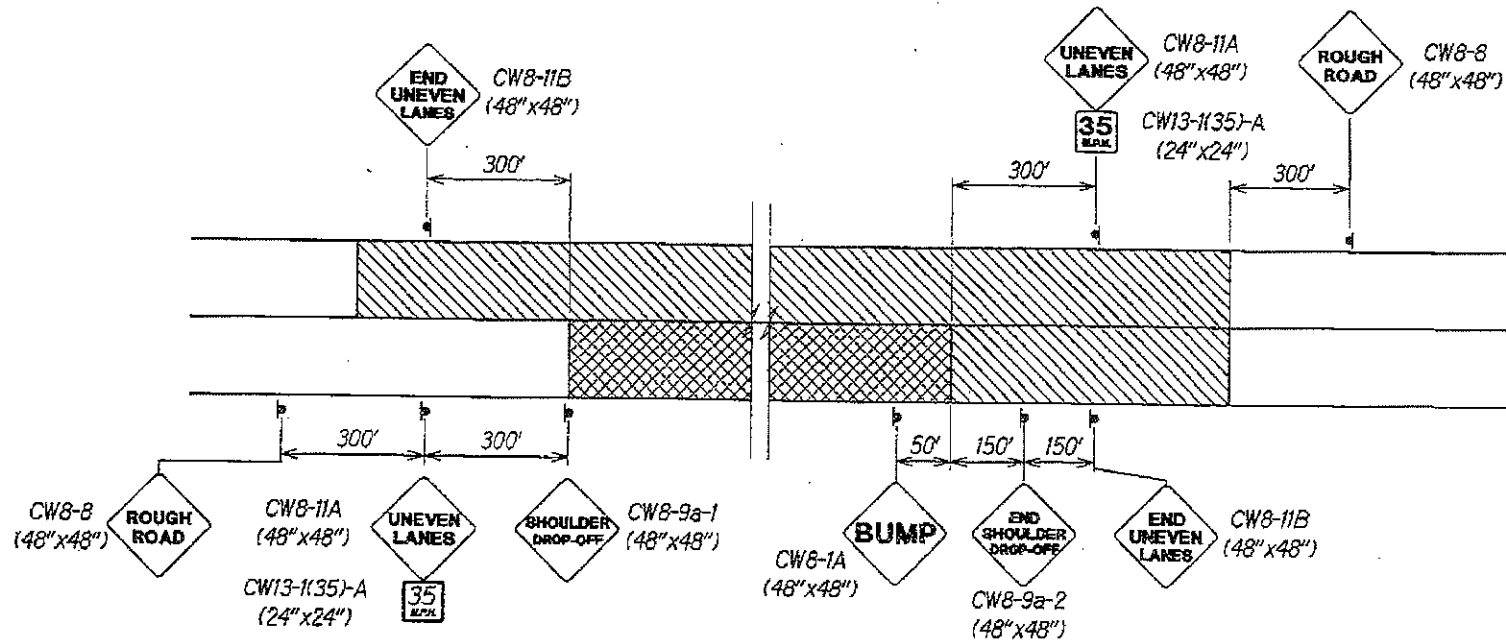

ROUGH ROAD/UNEVEN LANES
FIGURE 8 - TRAFFIC CONTROL PLAN

LEGEND:

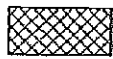

Paved Areas

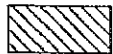

Cold Plane Areas

NOTES

1. Non-applicable signs shall be omitted where conditions do not apply.
2. Signs shall conform to Section 750 and be installed on portable "Windmaster" stands. Stands shall be securely anchored to prevent tipping by high winds.
3. The installation, maintenance and removal of portable construction signs shall be considered incidental to Item No. 645 0100 - Traffic Control.
4. Signs and portable stands shall be new and become the property of the Contractor upon completion of the project.

**PROPOSAL TO THE
STATE OF HAWAII
DEPARTMENT OF TRANSPORTATION**

PROJECT: Akoni Pule Highway
Pavement Preventive Maintenance
Vicinity of Mahukona to Kohala Ranch
District of North Kohala
Island of Hawaii

PROJECT NO.: STP-0270(019)

COMPLETION TIME: 205 Working days from the date indicated in the
Notice to Proceed from the Department.

DBE PROJECT GOAL: None Specified

DESIGN PROJECT MANAGER:

NAME: Robert Taira
ADDRESS: 50 Makaala Street
Hilo, HI 96720
PHONE NO.: (808) 933-8866
EMAIL: Robert.taira@hawaii.gov
FAX NO.: (808) 933-0444

PROPOSAL SCHEDULE

ITEM NO.	ITEM	APPROX. QUANTITY	UNIT	UNIT PRICE	AMOUNT
209.0100	Installation, Maintenance, Monitoring, and Removal of BMP	L.S.	L.S.	L.S.	\$ _____
209.0200	Additional Water Pollution, Dust, and Erosion Control	F.A.	F.A.	F.A.	\$ <u>50,000.00</u>
401.0400	HMA Pavement Mix No. IV	17,700	Ton	\$ _____	\$ _____
401.0600	HMA Pavement Mix No. V (paving under guardrails)	300	Ton	\$ _____	\$ _____
401.0600	Shoulder Milled Rumble Strip	84,000	L.F.	\$ _____	\$ _____
415.1000	Cold Planing (Existing Travelway and Shoulder)	L.S.	L.S.	L.S.	\$ _____
613.0300	Adjusting Centerline and Reference Survey Monuments	40	EA.	\$ _____	\$ _____
629.1011	Single Yellow 4-Inch Pavement Striping (Thermoplastic Extrusion)	L.S.	L.S.	L.S.	\$ _____
629.1012	Single White 4-Inch Pavement Striping (Thermoplastic Extrusion)	L.S.	L.S.	L.S.	\$ _____
629.1013	Double Yellow 4-Inch Pavement Striping (Thermoplastic Extrusion)	L.S.	L.S.	L.S.	\$ _____
629.1018	Single White 12-Inch Pavement Striping (Thermoplastic Extrusion)	L.S.	L.S.	L.S.	\$ _____
629.2030	Type C Pavement Markers	L.S.	L.S.	L.S.	\$ _____

PROPOSAL SCHEDULE

ITEM NO.	ITEM	APPROX. QUANTITY	UNIT	UNIT PRICE	AMOUNT
629.2040	Type D Pavement Markers	L.S.	L.S.	L.S.	\$ _____
629.2070	Type H Pavement Markers	L.S.	L.S.	L.S.	\$ _____
629.2080	Type J Pavement Markers	L.S.	L.S.	L.S.	\$ _____
631.1000	Construction Sign with Post	L.S.	L.S.	L.S.	\$ _____
645.1000	Traffic Control	L.S.	L.S.	L.S.	\$ _____
645.2000	Additional Police Officers And/or Additional Traffic Control Devices and Advertisement	F.A.	F.A.	F.A.	\$ <u>150,000.00</u>
648.1000	Field Posted Drawings	L.S.	L.S.	L.S.	\$ _____
696.2000	Maintenance of Trailers	F.A.	F.A.	F.A.	\$ <u>20,000.00</u>
699.1000	Mobilization (Not to Exceed 10 Percent of the Sum of All Items Excluding the Bid Price of this Item and Force Account Items)	L.S.	L.S.	L.S.	\$ _____

PROPOSAL SCHEDULE

ITEM NO.	ITEM	APPROX. QUANTITY	UNIT	UNIT PRICE	AMOUNT
a.	Sum of All Items				\$ _____
b.	Either Furnish Foreign Steel Not to Exceed Minimal Amount (Fill in '0') or Furnish Foreign Steel in Excess of Minimal Amount (Fill in 25% x a)				\$ _____
c.	Amount for Comparison of Bids (a + b)				\$ _____
All bidders must fill in b and complete c					
NOTE: Bidders must complete all unit prices and amounts. Failure to do so may be grounds for rejection of bid.					

**DEPARTMENT OF TRANSPORTATION
MEMORANDUM FOR RECORD**

DATE: June 9, 2011

HIGHWAYS
DIVISION
HAWAII DISTRICT
BRANCH OR SECTION

NON-MANDATORY PRE-BID CONFERENCE FOR:

AKONI PULE HIGHWAY PAVEMENT PREVENTIVE MAINTENANCE,
VICINITY OF MAHUKONA TO KOHALA RANCH, FEDERAL AID PROJECT NO.
STP-270(019), DISTRICT OF NORTH KOHALA, ISLAND OF HAWAII

DATE, TIME & PLACE:

June 9, 2011, 8:00 A.M., Hawaii District Office (50 Makaala St., Hilo, HI, 96720)

PARTICIPANTS:

See attached Sign-In Sheet.

BRIEF SUMMARY OF MEETING:

1. Opening remarks and introductions of people attending the meeting.
2. A brief overview of the project was presented.
3. The following announcements were made:
 - a. DBE goals were inadvertently omitted from the Special Provisions. This error shall be corrected by Addendum No. 1.
 - b. Paving under guardrails will be paid for separately under Hot Mix Asphalt Pavement Mix No. V. by Addendum No. 1.
4. Question: Plans are missing reconstruction areas?
Response: Reconstruction of weakened pavement areas will be deleted from the project.
Post Response: Item No. 312.0200, Hot Mix Glassphalt Base Course, and Item No. 414.0100, Excavation of Weakened Pavement Areas, have been deleted from the Proposal Schedule. See Addendum No. 1.

5. Question: Is it the intention of the project to install rumble strips per the typical section or to use the more recent tapered design?
Response: The more recent tapered design will be used. The revised typical section will be issued in Addendum No. 1.
Post Response: The State has reconsidered its response and decided not to change the design. The rumble strips shall be installed per the rumble strip details shown on the plans.
6. Question: General Note No. 12 requires earth swales to be graded to drain, but the plans do not show any earth swales. What are the limits of this work?
Response: The State will either delineate the areas affected or delete this note in Addendum No. 1.
Post Response: General Note No. 12 has been deleted from the plans, see Addendum No. 1.
7. Question: Where are stock piles of materials used for dressing of shoulders?
Response: As noted in the plans, there is a stock pile located at the 7 Mile Post marker on Route 250. The State will check for any other stock piles in the area.
Post Response: There are no other stock piles in the immediate vicinity of the project.
8. Question: The typical section shows a detail requiring the sealing of cracks exposed after cold planing. What material should be used for the crack sealing? How is payment to be made for the sealing work?
Response: The material and method of payment shall be specified or the crack sealing work shall be deleted in Addendum No. 1.
Post Response: The crack sealing work has been deleted from the plans, see Addendum No. 1.
9. Question: Is it the intention of the project for the Contractor to maintain every culvert shown per General Note No. 11 (incidental work)?
Response: The State will consider the question and respond in Addendum No. 1.
Post Response: General Note No. 11 has been deleted from the plans, see Addendum No. 1.
10. Question: If the Contractor chooses not to block pave, does the Contractor need to put a taper along the 1-1/2" pavement dropoff created by each day's paving?
Response: The State will consider the question and respond in Addendum No. 1.
Post Response: Yes. The Contractor is referred to the Standard Specifications for Road and Bridge Construction, Section 401.03, page 401-12.
11. Question: After cold-planing, how long a period of time may the rough surface be left open to traffic before being overlaid?
Response: The State will consider the question and respond in Addendum No. 1.
Post Response: Three calendar days. The Contractor is referred to the Standard Specifications for Road and Bridge Construction, Section 415.03, page 415-2.

12. Question: General Note No. 7 specifies working hours from 8:30am to 3:30pm. Can the hours be extended due to the rural nature of the roadway (lower volumes of traffic)?

Response: Contractors are directed to bid based on the bid documents.

Post Response: There was a conflict between General Note No. 7 (8:30am to 3:30pm) and Section 645 of the Standard Specifications for Road and Bridge Construction (8:30am to 3:00pm). It is the intention of this project to abide by the stricter hours.

13. Question: Is overtime work excluded from this project?

Response: Overtime for State project personnel is limited to 10 hours per month.

Anything more must be justified for approval by the Director, Department of Transportation (requires long lead time for approval). The Contractor must work with the State's inspection personnel to stay within the authorized limits.

14. Question: Page 401-2a of the Special Provisions specifies that the asphalt content be increased by 0.5% for HMA pavements for areas that are "not part of roadway and other areas not subjected to vehicular traffic." Does this provision apply to shoulder areas?

Response: The State will consider the question and respond in Addendum No. 1.

Post Response: Shoulder areas are subject to vehicular traffic, except for areas behind guardrails. Therefore, this provision applies to paved shoulder areas under guardrails.

PRE-BID CONFERENCE (NON-MANDATORY)

Project: Akoni Pule Highway PPM

Vicinity of Mahukona to Kohala Ranch

Project No.: STP-0270(019)

Date, Time, Location: June 9, 2011; 8:00 A.M.; Hawaii District Office

[illegible]