

FED. ROAD DIST. NO.	STATE	PROJ. NO.	FISCAL YEAR	SHEET NO.	TOTAL SHEETS
HAWAII	HAW.	270A-01-96M	1996	5	28

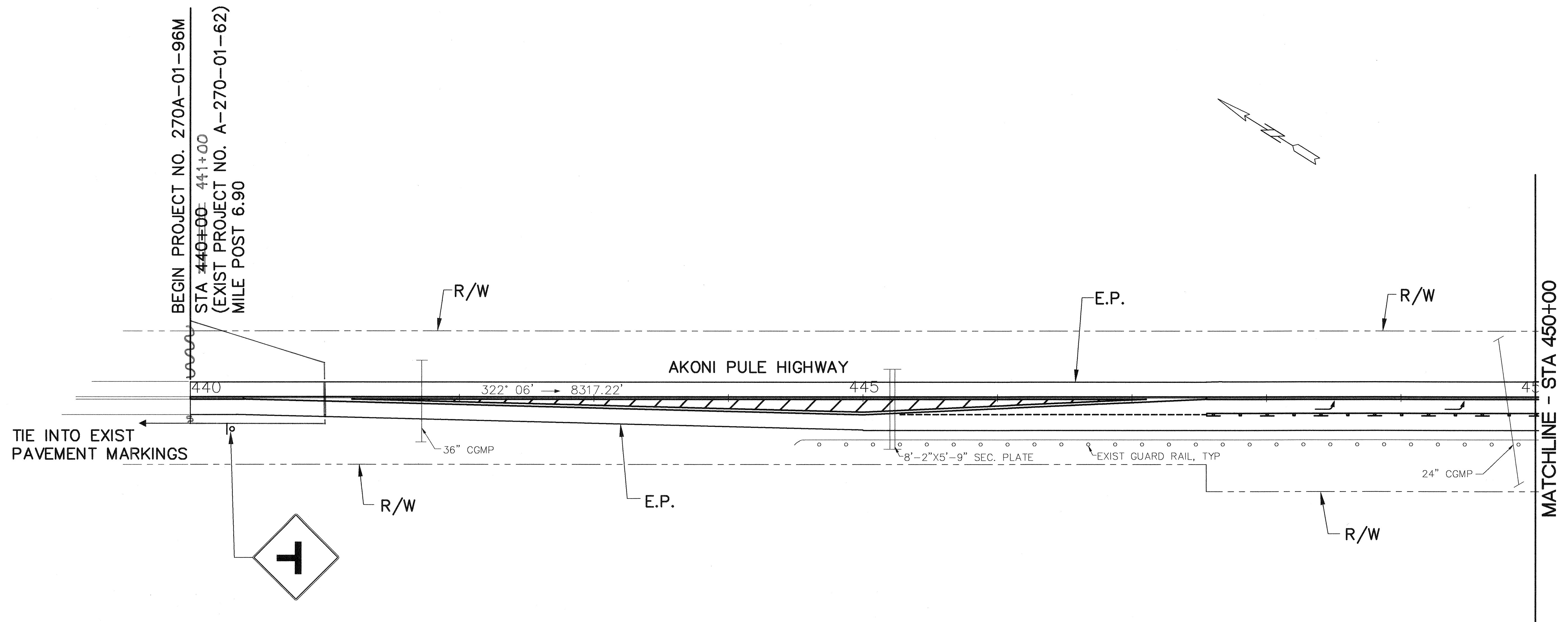

SURVEY PLOTTED BY	DATE
DRAWN BY	
TRACED BY	
DESIGNED BY	
NOTE BOOK	
QUANTITIES BY	
CHECKED BY	
ORIGINAL PLAN	
No.	

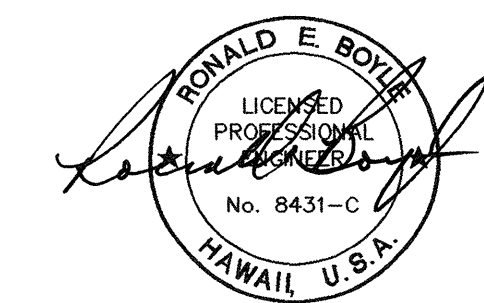

STATE OF HAWAII  
 DEPARTMENT OF TRANSPORTATION  
 HIGHWAYS DIVISION

**ROADWAY, STRIPING AND  
 SIGN PLANS**

**AKONI PULE HIGHWAY RESURFACING**  
 Mile Post 6.90 to 3.43  
 Project No. 270A-01-96M  
 Scale: 1"=40' Date: May 1996

SHEET No. 1 OF 16 SHEETS

"AS-BUILT"

FED. ROAD DIST. NO.	STATE	PROJ. NO.	FISCAL YEAR	SHEET NO.	TOTAL SHEETS
HAWAII	HAW.	270A-01-96M	1996	6	28

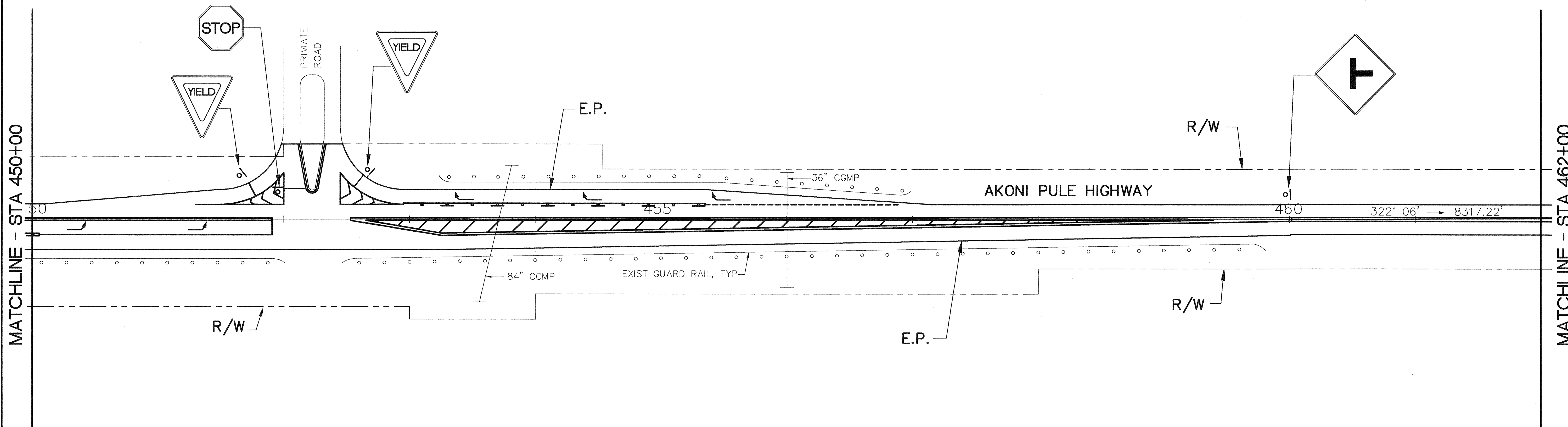

ORIGINAL PLAN	DATE
SURVEY PLOTTED BY	
DRAWN BY	
DESIGNED BY	
QUANTITIES BY	
CHECKED BY	
No.	

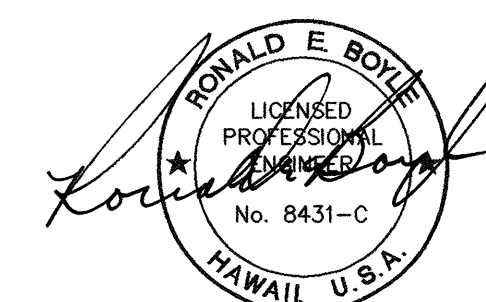

STATE OF HAWAII  
DEPARTMENT OF TRANSPORTATION  
HIGHWAYS DIVISION

**ROADWAY, STRIPING AND  
SIGN PLANS**

**AKONI PULE HIGHWAY RESURFACING**  
Mile Post 6.90 to 3.43  
Project No. 270A-01-96M

Scale: 1"=40'      Date: May 1996

SHEET No. 2 OF 16 SHEETS

FED. ROAD DIST. NO.	STATE	PROJ. NO.	FISCAL YEAR	SHEET NO.	TOTAL SHEETS
HAWAII	HAW.	270A-01-96M	1996	7	28

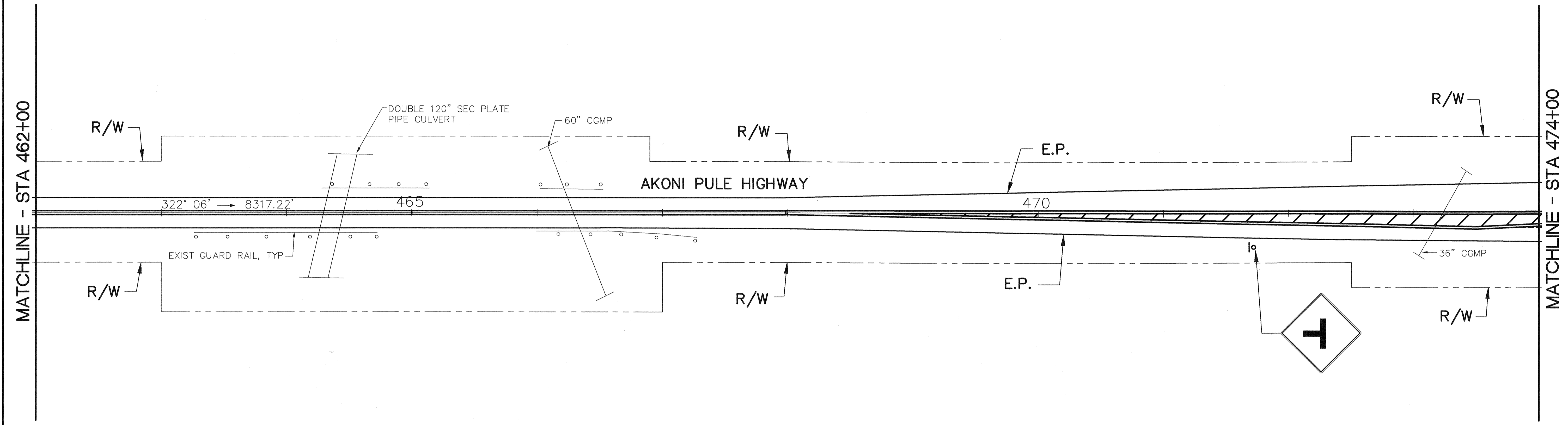
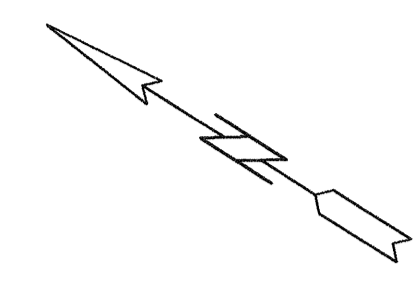

SURVEY PLOTTED BY	DATE
DRAWN BY	
TRACED BY	
QUANTITIES BY	
CHECKED BY	
ORIGINAL PLAN No.	

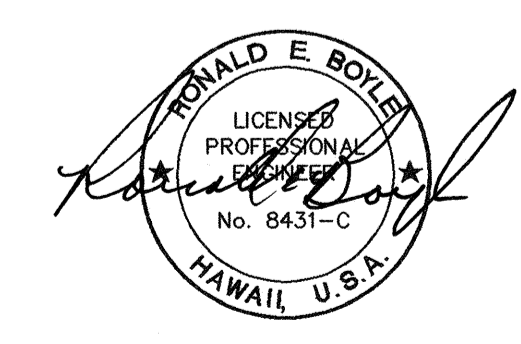

STATE OF HAWAII  
DEPARTMENT OF TRANSPORTATION  
HIGHWAYS DIVISION

**ROADWAY, STRIPING AND  
SIGN PLANS**

**AKONI PULE HIGHWAY RESURFACING**  
Mile Post 6.90 to 3.43  
Project No. 270A-01-96M

Scale: 1"=40'      Date: May 1996

SHEET No. 3 OF 16 SHEETS

FED. ROAD DIST. NO.	STATE	PROJ. NO.	FISCAL YEAR	SHEET NO.	TOTAL SHEETS
HAWAII	HAW.	270A-01-96M	1996	8	28

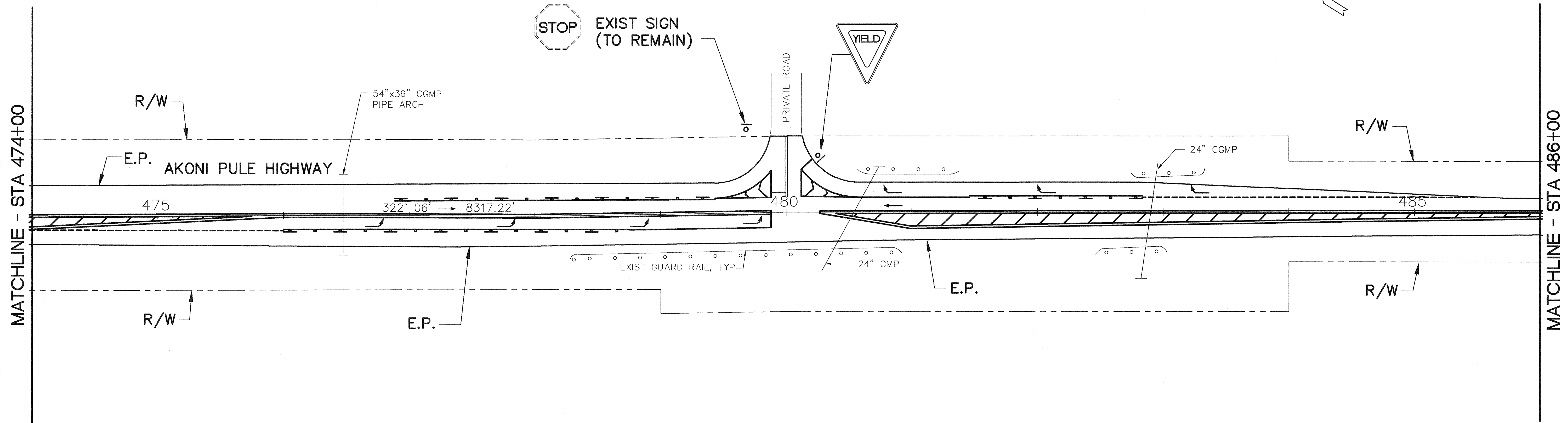

SURVEY PLOTTED BY	DATE
DRAWN BY	
DESIGNED BY	
CHECKED BY	
NOTE BOOK No.	

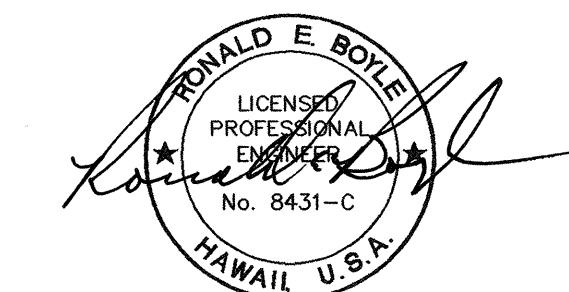

STATE OF HAWAII  
DEPARTMENT OF TRANSPORTATION  
HIGHWAYS DIVISION

**ROADWAY, STRIPING AND  
SIGN PLANS**

**AKONI PULE HIGHWAY RESURFACING**  
Mile Post 6.90 to 3.43  
Project No. 270A-01-96M

Scale: 1"=40'      Date: May 1996

SHEET No. 4 OF 16 SHEETS

FED. ROAD DIST. NO.	STATE	PROJ. NO.	FISCAL YEAR	SHEET NO.	TOTAL SHEETS
HAWAII	HAW.	270A-01-96M	1996	9	28

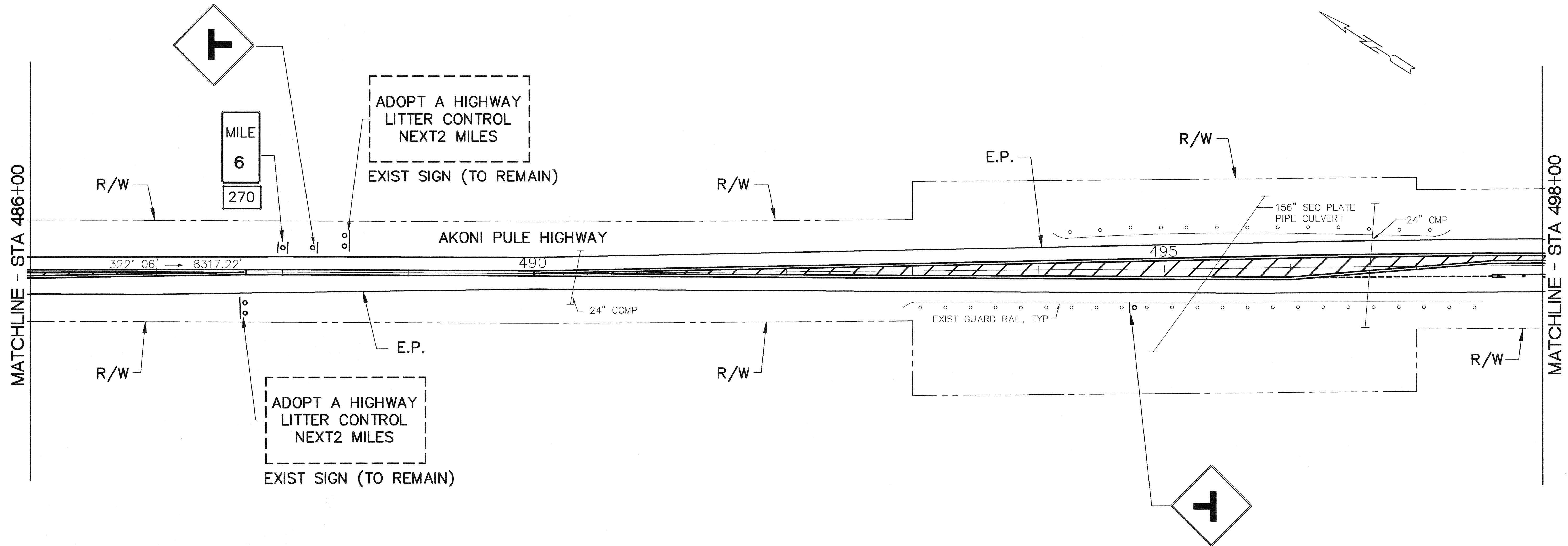

SURVEY PLOTTED BY	DATE
DESIGNED BY	
TRACED BY	
DESIGNED BY	
QUANTITIES BY	
CHECKED BY	
ORIGINAL PLAN No.	
NOTE BOOK No.	

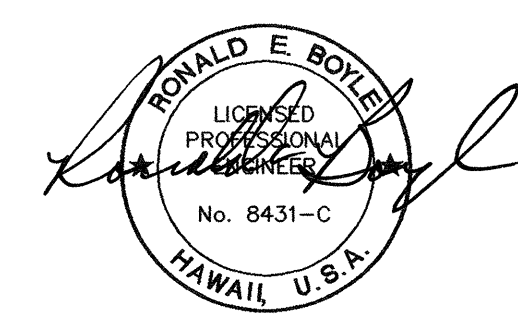

STATE OF HAWAII  
DEPARTMENT OF TRANSPORTATION  
HIGHWAYS DIVISION

**ROADWAY, STRIPING AND  
SIGN PLANS**

**AKONI PULE HIGHWAY RESURFACING**  
Mile Post 6.90 to 3.43  
Project No. 270A-01-96M

Scale: 1"=40'      Date: May 1996

SHEET No. 5 OF 16 SHEETS

FED. ROAD DIST. NO.	STATE	PROJ. NO.	FISCAL YEAR	SHEET NO.	TOTAL SHEETS
HAWAII	HAW.	270A-01-96M	1996	10	28

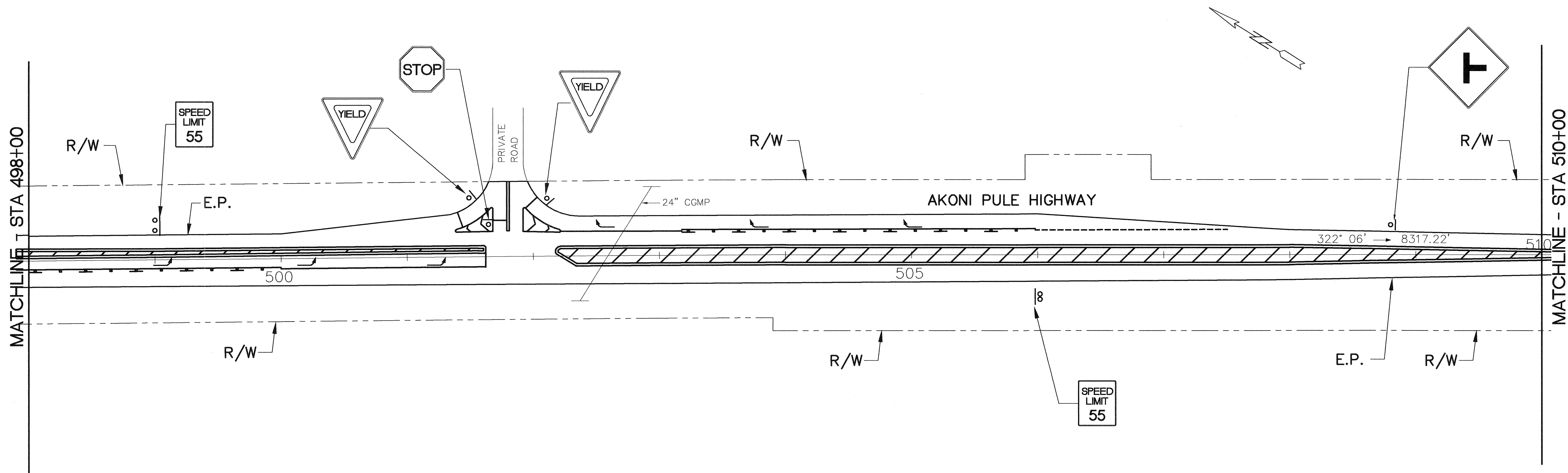

SURVEY PLOTTED BY	DATE
DRAWN BY	
TRACED BY	
DESIGNED BY	
CHECKED BY	
ORIGINAL PLAN No.	
NOTE BOOK No.	

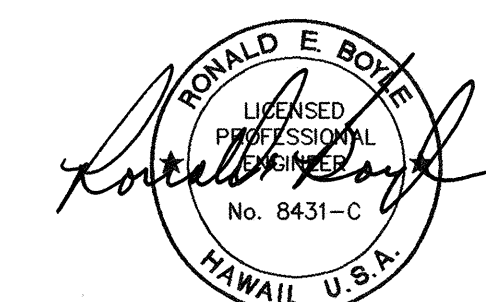

STATE OF HAWAII  
DEPARTMENT OF TRANSPORTATION  
HIGHWAYS DIVISION

**ROADWAY, STRIPING AND  
SIGN PLANS**

**AKONI PULE HIGHWAY RESURFACING**  
Mile Post 6.90 to 3.43  
Project No. 270A-01-96M  
Scale: 1"=40' Date: May 1996  
SHEET No. 6 OF 16 SHEETS

FED. ROAD DIST. NO.	STATE	PROJ. NO.	FISCAL YEAR	SHEET NO.	TOTAL SHEETS
HAWAII	HAW.	270A-01-96M	1996	11	28

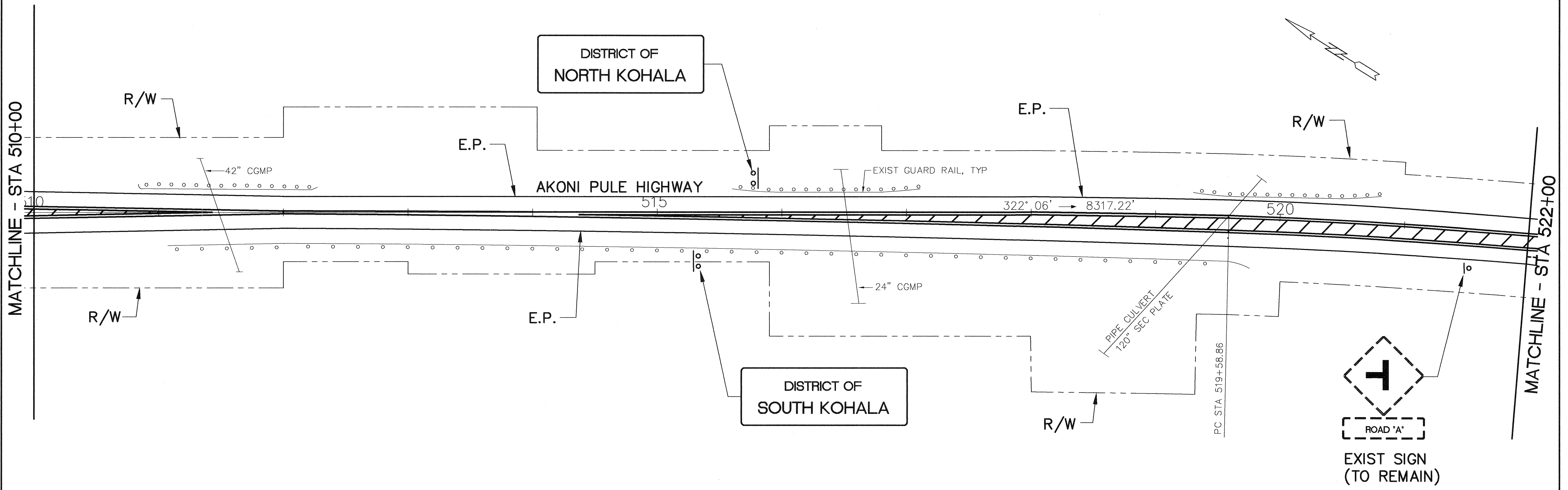

$\Delta = 7^\circ 30'$   
 $R = 4583.66'$   
 $T = 300.43'$   
 $L = 600'$

SURVEY PLOTTED BY	DATE
DRAWN BY	
DESIGNED BY	
QUANTITIES BY	
CHECKED BY	
ORIGINAL PLAN No.	

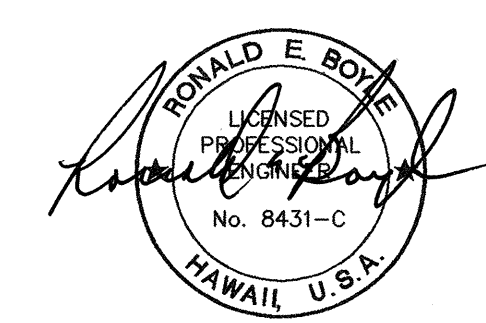

STATE OF HAWAII  
 DEPARTMENT OF TRANSPORTATION  
 HIGHWAYS DIVISION  
**ROADWAY, STRIPING AND SIGN PLANS**  
**AKONI PULE HIGHWAY RESURFACING**  
 Mile Post 6.90 to 3.43  
 Project No. 270A-01-96M  
 Scale: 1"=40'      Date: May 1996  
 SHEET No. 7 OF 16 SHEETS

FED. ROAD DIST. NO.	STATE	PROJ. NO.	FISCAL YEAR	SHEET NO.	TOTAL SHEETS
HAWAII	HAW.	270A-01-96M	1996	12	28

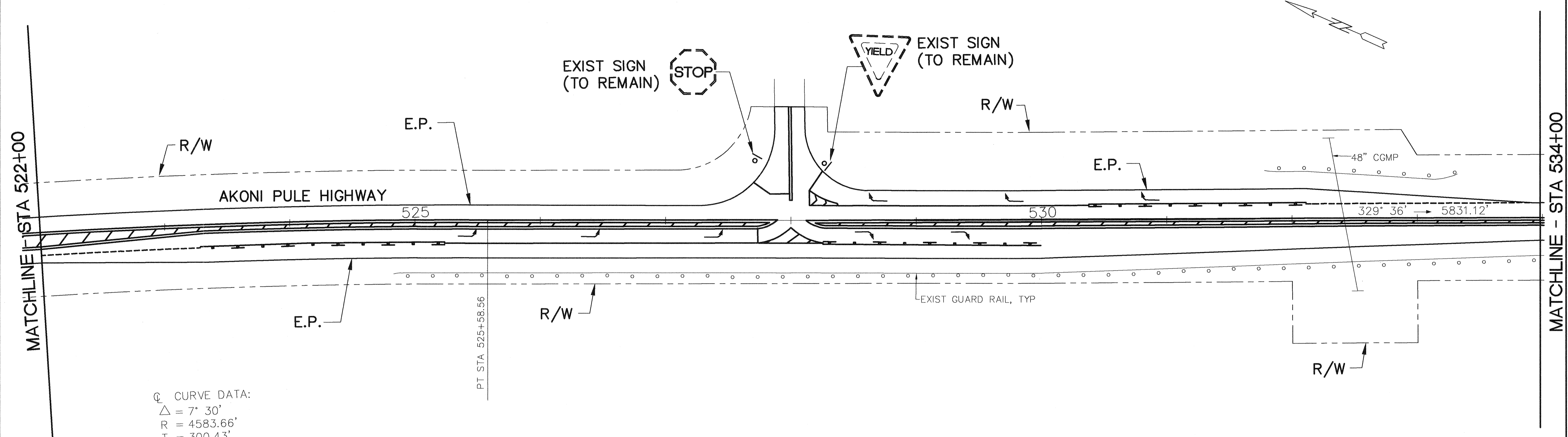

Q CURVE DATA:  
 $\Delta = 7^\circ 30'$   
 $R = 4583.66'$   
 $T = 300.43'$   
 $L = 600'$

PT STA 525+58.56

SURVEY PLOTTED BY	DATE
DESIGNED BY	
QUANTITIES BY	
CHECKED BY	
ORIGINAL PLAN No.	
NOTE BOOK No.	

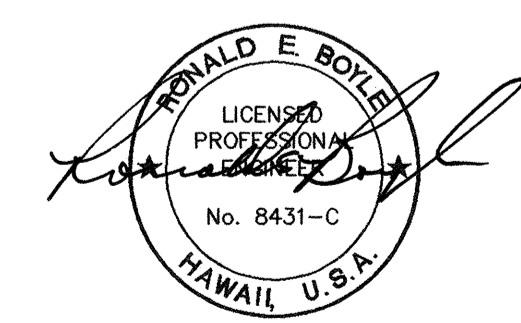

STATE OF HAWAII  
 DEPARTMENT OF TRANSPORTATION  
 HIGHWAYS DIVISION  
**ROADWAY, STRIPING AND SIGN PLANS**  
**AKONI PULE HIGHWAY RESURFACING**  
**Mile Post 6.90 to 3.43**  
**Project No. 270A-01-96M**  
 Scale: 1"=40' Date: May 1996  
 SHEET No. 8 OF 16 SHEETS

FED. ROAD DIST. NO.	STATE	PROJ. NO.	FISCAL YEAR	SHEET NO.	TOTAL SHEETS
HAWAII	HAW.	270A-01-96M	1996	13	28

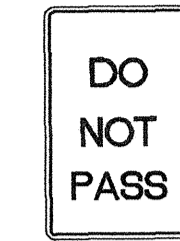
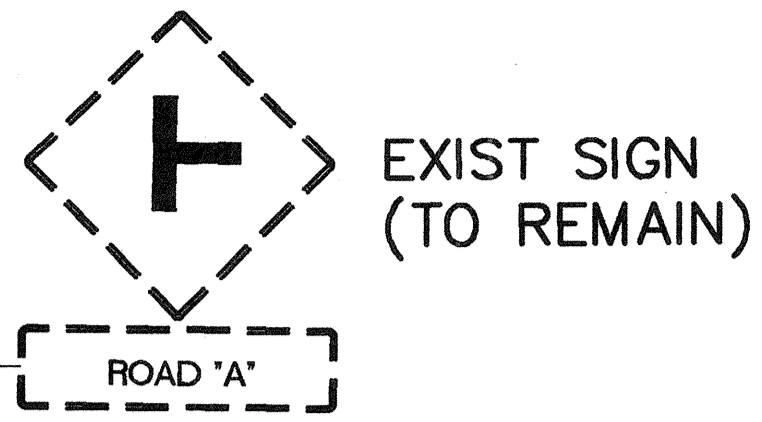

MATCHLINE - STA 534+00

MATCHLINE - STA 546+00

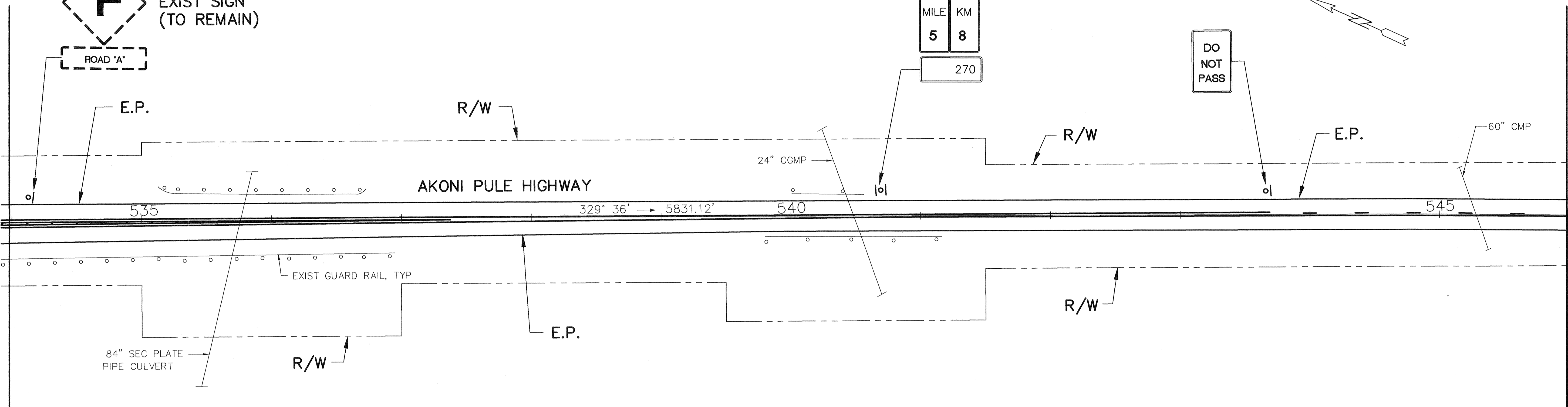

SURVEY PLOTTED BY	DATE
DESIGNED BY	
QUANTITIES BY	
CHECKED BY	
ORIGINAL PLAN No.	

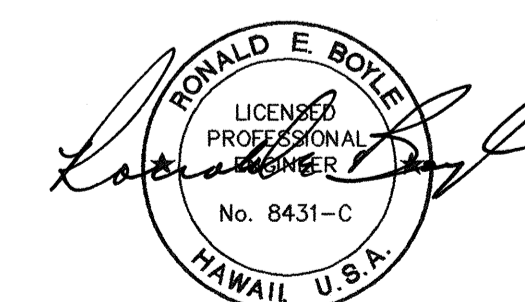

STATE OF HAWAII  
DEPARTMENT OF TRANSPORTATION  
HIGHWAYS DIVISION

**ROADWAY, STRIPING AND  
SIGN PLANS**

**AKONI PULE HIGHWAY RESURFACING**  
Mile Post 6.90 to 3.43  
Project No. 270A-01-96M

Scale: 1"=40' Date: May 1996

SHEET No. 9 OF 16 SHEETS

FED. ROAD DIST. NO.	STATE	PROJ. NO.	FISCAL YEAR	SHEET NO.	TOTAL SHEETS
HAWAII	HAW.	270A-01-96M	1996	14	28

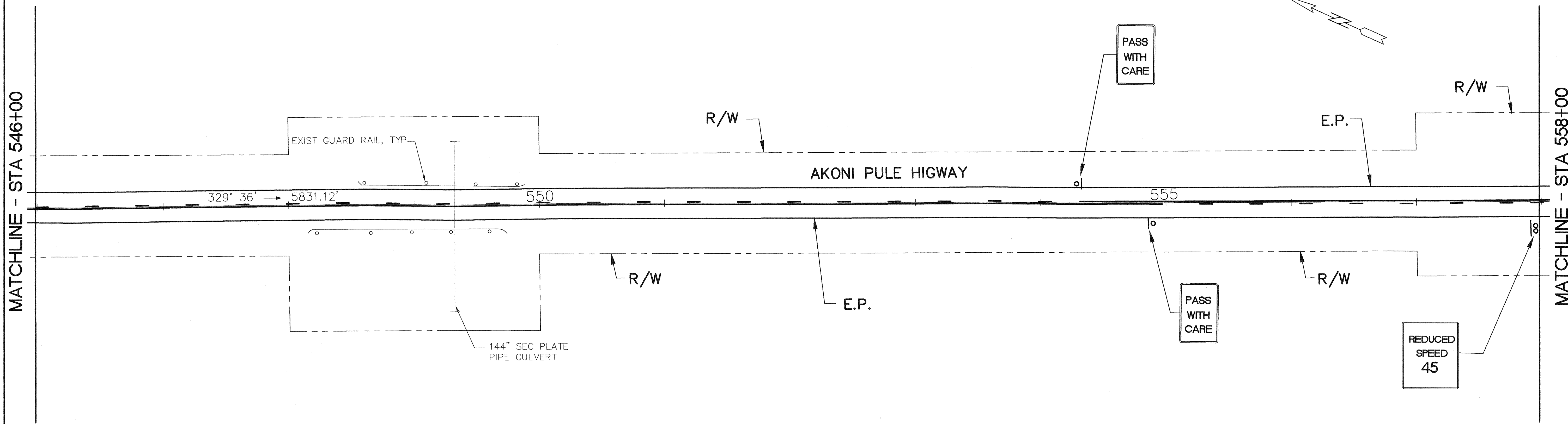

ORIGINAL PLAN No.	SURVEY PLOTTED BY	DATE
	DRAWN BY	
	DESIGNED BY	
	QUANTITIES BY	
	CHECKED BY	

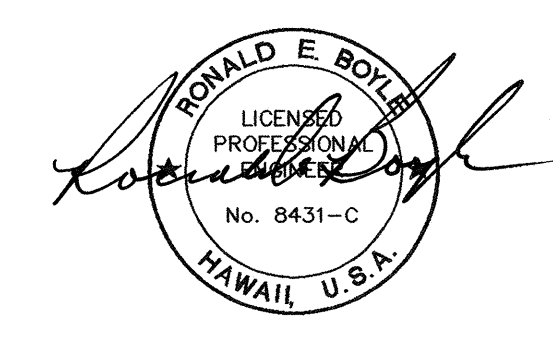

STATE OF HAWAII  
DEPARTMENT OF TRANSPORTATION  
HIGHWAYS DIVISION

**ROADWAY, STRIPING AND  
SIGN PLANS**

**AKONI PULE HIGHWAY RESURFACING**  
Mile Post 6.90 to 3.43  
Project No. 270A-01-96M  
Scale: 1"=40' Date: May 1996

SHEET No. 10 OF 16 SHEETS

FED. ROAD DIST. NO.	STATE	PROJ. NO.	FISCAL YEAR	SHEET NO.	TOTAL SHEETS
HAWAII	HAW.	270A-01-96M	1996	15	28

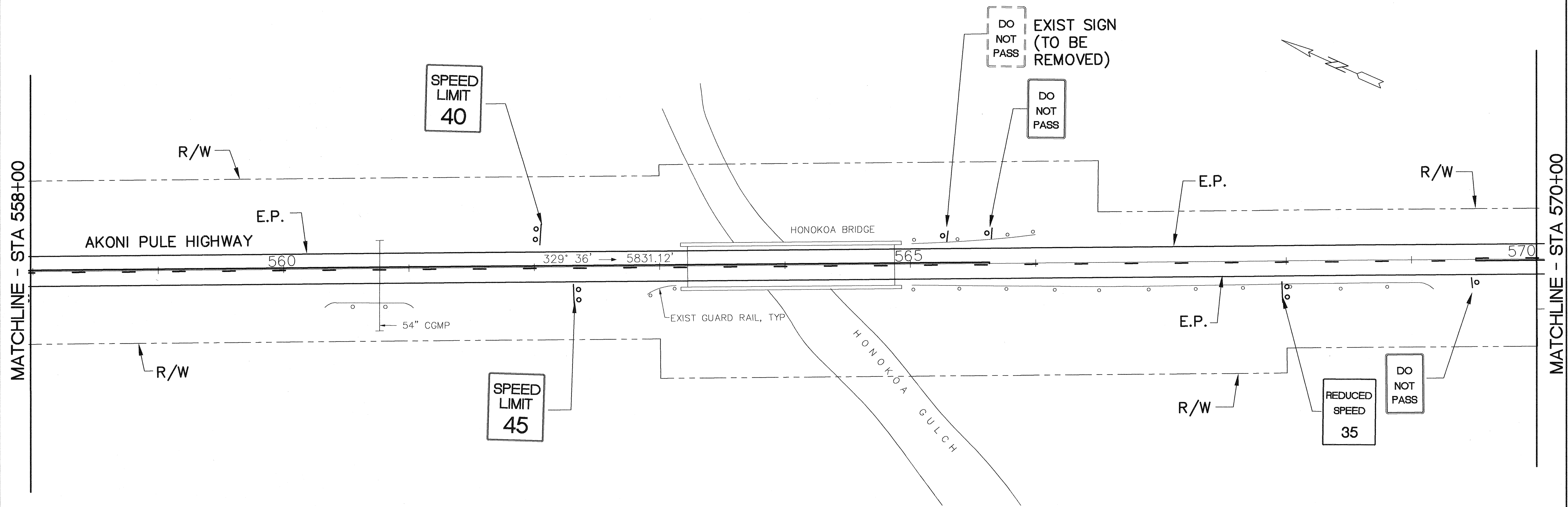

SURVEY PLOTTED BY	DATE
DESIGNED BY	
QUANTITIES BY	
CHECKED BY	
ORIGINAL PLAN No.	
NOTE BOOK No.	

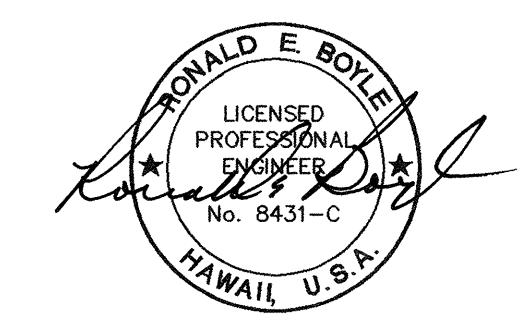

STATE OF HAWAII  
DEPARTMENT OF TRANSPORTATION  
HIGHWAYS DIVISION

**ROADWAY, STRIPING AND  
SIGN PLANS**

**AKONI PULE HIGHWAY RESURFACING**  
Mile Post 6.90 to 3.43  
Project No. 270A-01-96M

Scale: 1"=40'      Date: May 1996

SHEET No. 11 OF 16 SHEETS

FED. ROAD DIST. NO.	STATE	PROJ. NO.	FISCAL YEAR	SHEET NO.	TOTAL SHEETS
HAWAII	HAW.	270A-01-96M	1996	16	28

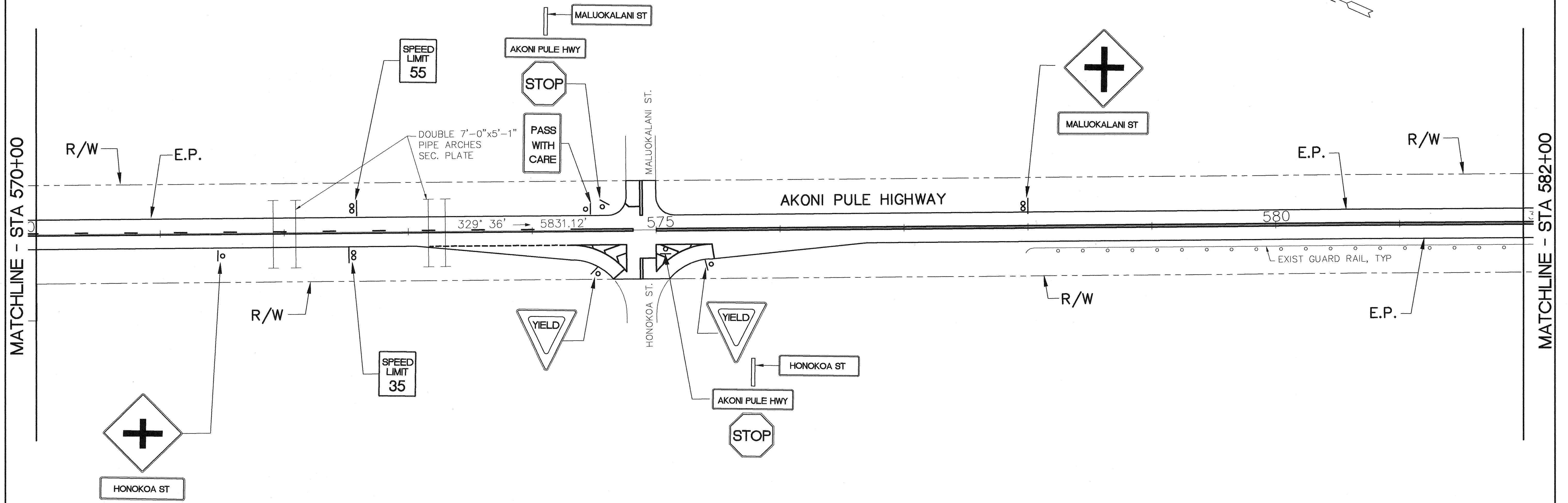

ORIGINAL PLAN	SURVEY PLOTTED BY	DATE
NOTE BOOK	DRAWN BY	
NO.	TRACED BY	
	DESIGNED BY	
	QUANTITIES BY	
	CHECKED BY	

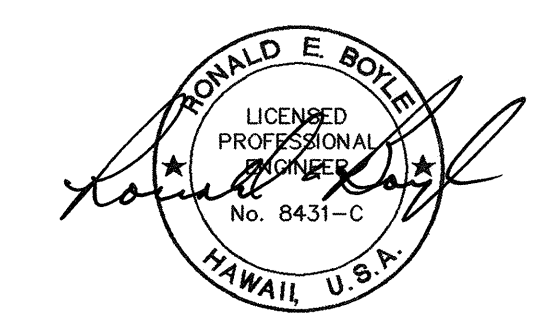

STATE OF HAWAII  
DEPARTMENT OF TRANSPORTATION  
HIGHWAYS DIVISION

**ROADWAY, STRIPING AND  
SIGN PLANS**

**AKONI PULE HIGHWAY RESURFACING**  
Mile Post 6.90 to 3.43  
Project No. 270A-01-96M  
Scale: 1"=40'      Date: May 1996

SHEET No. 12 OF 16 SHEETS

FED. ROAD DIST. NO.	STATE	PROJ. NO.	FISCAL YEAR	SHEET NO.	TOTAL SHEETS
HAWAII	HAW.	270A-01-96M	1996	17	28

MILE  
4  
270

Q CURVE DATA:  
 $\Delta = 7^{\circ} 17' 20''$   
 $R = 4583.66'$   
 $T = 291.95'$   
 $L = 583.11'$

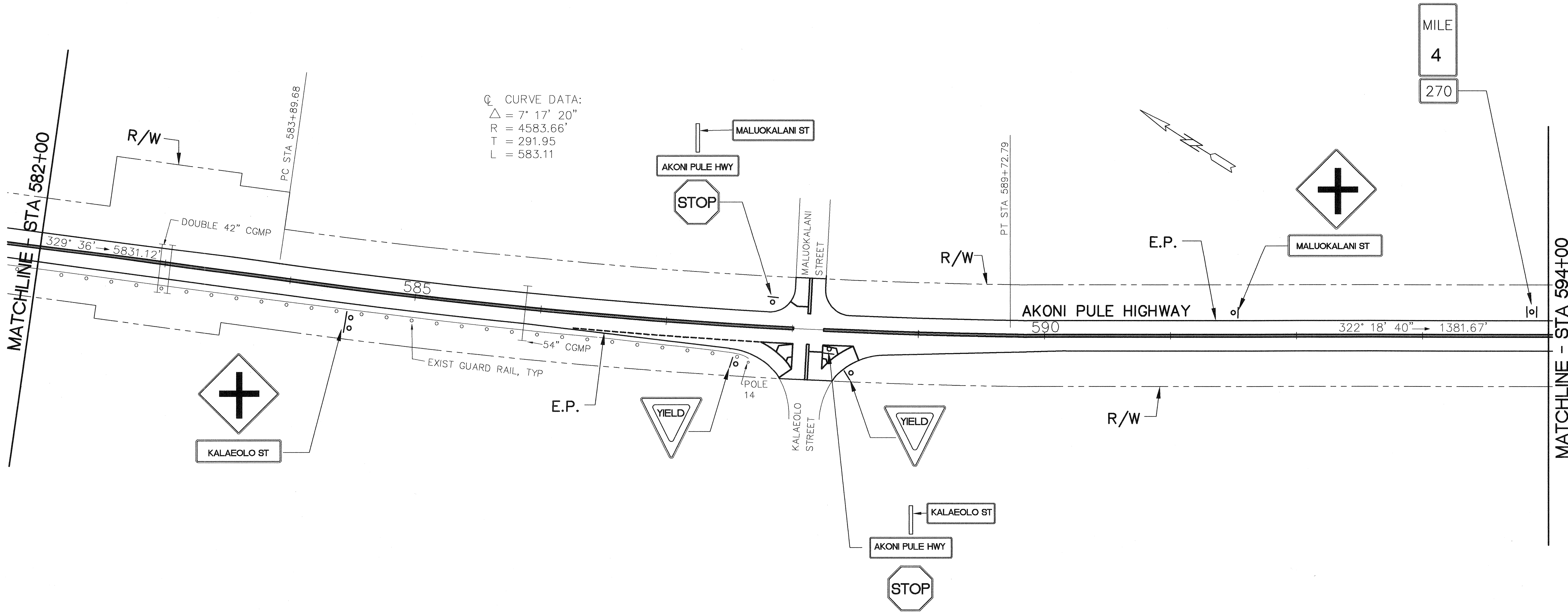

SURVEY PLOTTED BY	DATE
DRAWN BY	
DESIGNED BY	
QUANTITIES BY	
CHECKED BY	
ORIGINAL PLAN No.	

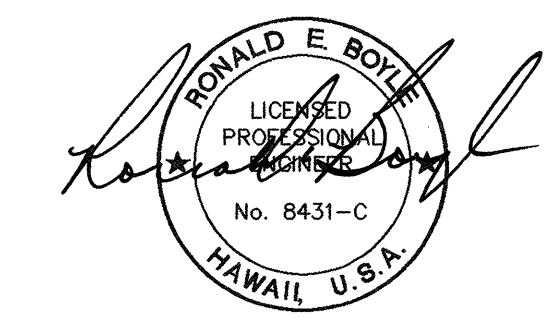

STATE OF HAWAII  
 DEPARTMENT OF TRANSPORTATION  
 HIGHWAYS DIVISION

**ROADWAY, STRIPING AND SIGN PLANS**

**AKONI PULE HIGHWAY RESURFACING**  
 Mile Post 6.90 to 3.43  
 Project No. 270A-01-96M

Scale: 1"=40'      Date: May 1996

SHEET No. 13 OF 16 SHEETS

FED. ROAD DIST. NO.	STATE	PROJ. NO.	FISCAL YEAR	SHEET NO.	TOTAL SHEETS
HAWAII	HAW.	270A-01-96M	1996	18	28

MATCHLINE - STA 594+00

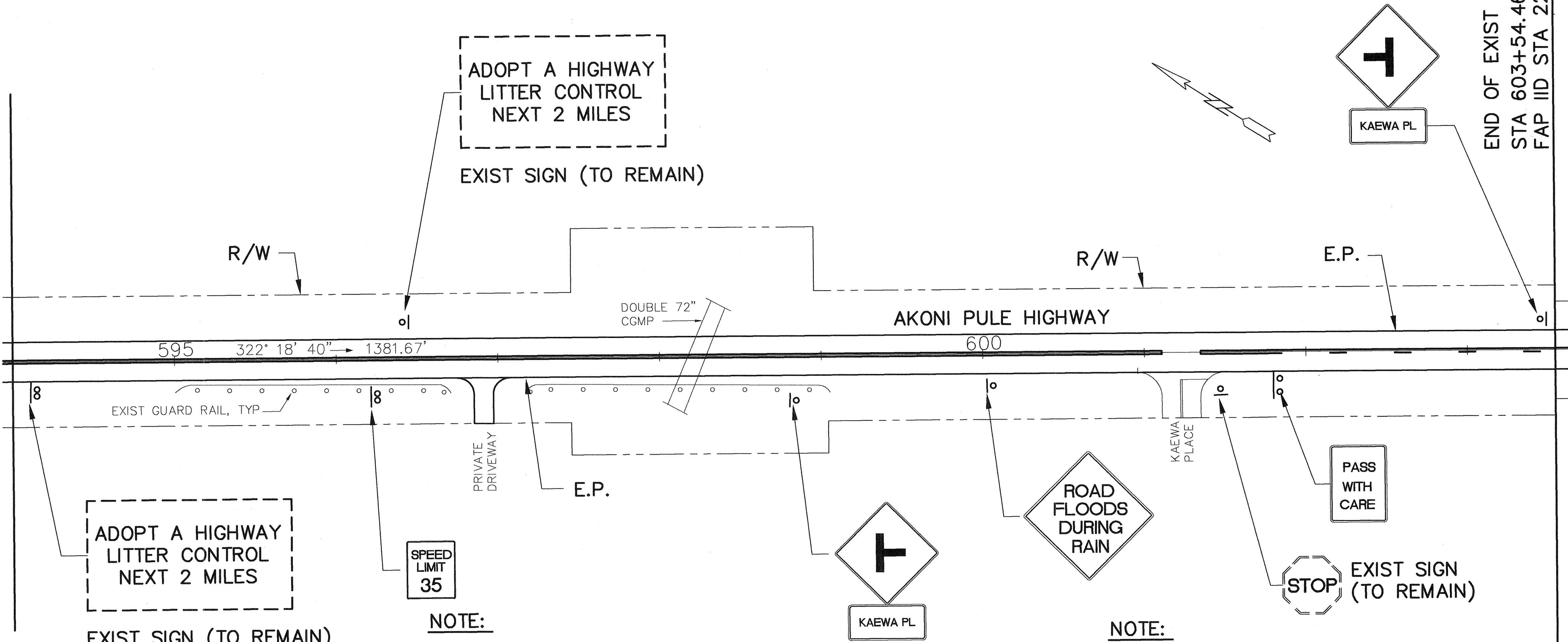

END OF EXIST PROJECT NO. A-270-01-62  
STA 603+54.46=  
FAP IID STA 22+00

MATCHLINE - STA 603+54.46

ADOPT A HIGHWAY LITTER CONTROL NEXT 2 MILES  
EXIST SIGN (TO REMAIN)

SPEED LIMIT 35

**NOTE:**  
PROVIDE A.C. OVERLAY OF PRIVATE DRIVEWAY STA 596+90 UP TO R/W; E.O.P STRIPING TO EXTEND ACROSS DRIVEWAY ENTRANCE.

KAWEA PL

**NOTE:**  
NO A.C. OVERLAY FOR KAWEA PLACE; PROVIDE 4' TAPER; TIE INTO EXIST PAVEMENT MARKINGS.

STOP EXIST SIGN (TO REMAIN)

SURVEY PLOTTED BY	DATE
DRAWN BY	
DESIGNED BY	
QUANTITIES BY	
CHECKED BY	
ORIGINAL PLAN	
NOTE BOOK	
No.	

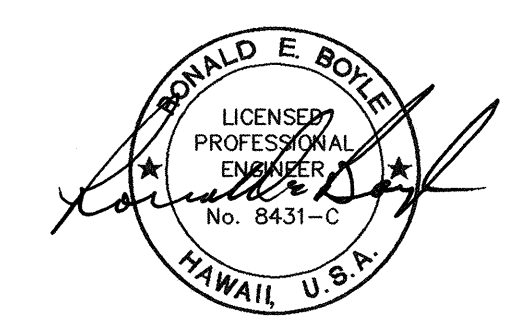

STATE OF HAWAII  
DEPARTMENT OF TRANSPORTATION  
HIGHWAYS DIVISION

**ROADWAY, STRIPING AND  
SIGN PLANS**

**AKONI PULE HIGHWAY RESURFACING**  
Mile Post 6.90 to 3.43  
Project No. 270A-01-96M  
Scale: 1"=40' Date: May 1996

SHEET No. 14 OF 16 SHEETS

FED. ROAD DIST. NO.	STATE	PROJ. NO.	FISCAL YEAR	SHEET NO.	TOTAL SHEETS
HAWAII	HAW.	270A-01-96M	1996	19	28

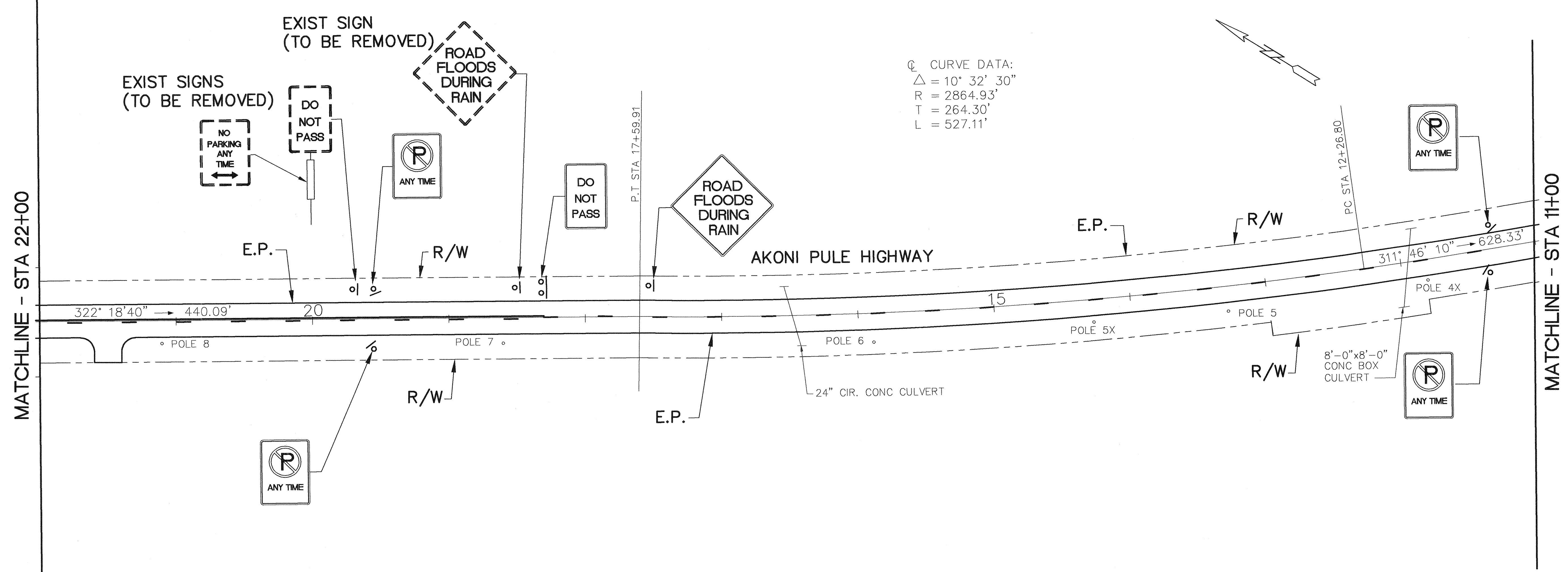

Q CURVE DATA:  
 $\Delta = 10^\circ 32' 30''$   
 $R = 2864.93'$   
 $T = 264.30'$   
 $L = 527.11'$

ORIGINAL PLAN	SURVEY PLOTTED BY	DATE
NOTE BOOK	DRAWN BY	
NO.	DESIGNED BY	
	QUANTITIES BY	
	CHECKED BY	

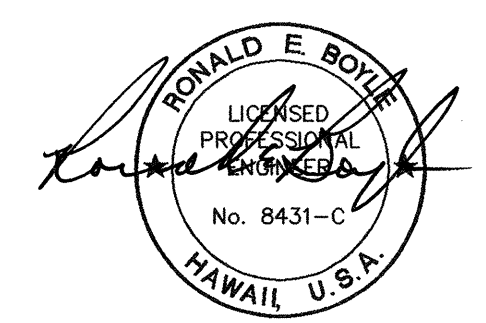

STATE OF HAWAII  
 DEPARTMENT OF TRANSPORTATION  
 HIGHWAYS DIVISION  
**ROADWAY, STRIPING AND  
 SIGN PLANS**  
**AKONI PULE HIGHWAY RESURFACING**  
**Mile Post 6.90 to 3.43**  
**Project No. 270A-01-96M**  
 Scale: 1"=40'      Date: May 1996  
 SHEET No. 15 OF 16 SHEETS

FED. ROAD DIST. NO.	STATE	PROJ. NO.	FISCAL YEAR	SHEET NO.	TOTAL SHEETS
HAWAII	HAW.	270A-01-96M	1996	20	28

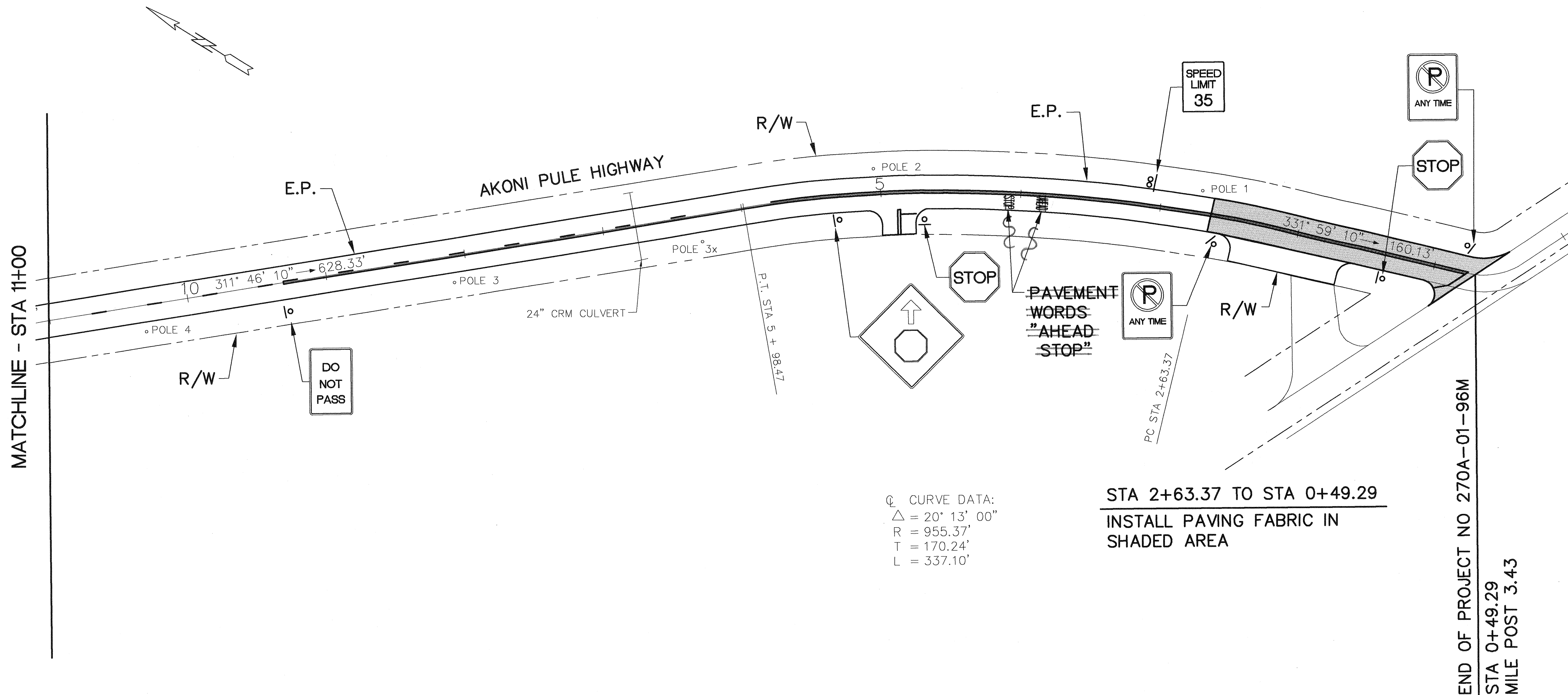

Q CURVE DATA:  
 $\Delta = 20^\circ 13' 00''$   
 $R = 955.37'$   
 $T = 170.24'$   
 $L = 337.10'$

STA 2+63.37 TO STA 0+49.29  
 INSTALL PAVING FABRIC IN  
 SHADED AREA

END OF PROJECT NO 270A-01-96M  
 STA 0+49.29  
 MILE POST 3.43

SURVEY PLOTTED BY	DATE
DRAWN BY	
TRACED BY	
DESIGNED BY	
QUANTITIES BY	
CHECKED BY	
ORIGINAL PLAN No.	



STATE OF HAWAII  
 DEPARTMENT OF TRANSPORTATION  
 HIGHWAYS DIVISION  
**ROADWAY, STRIPING AND  
 SIGN PLANS**  
 AKONI PULE HIGHWAY RESURFACING  
 Mile Post 6.90 to 3.43  
 Project No. 270A-01-96M  
 Scale: 1"=40' Date: May 1996  
 SHEET No. 16 OF 16 SHEETS

"AS-BUILT"