

FED. ROAD DIST. No.	STATE	PROJ. No.	PRICAL YEAR	SHEET No.	TOTAL SHEETS
	HAWAII	5-0260(1)	1959	7	38

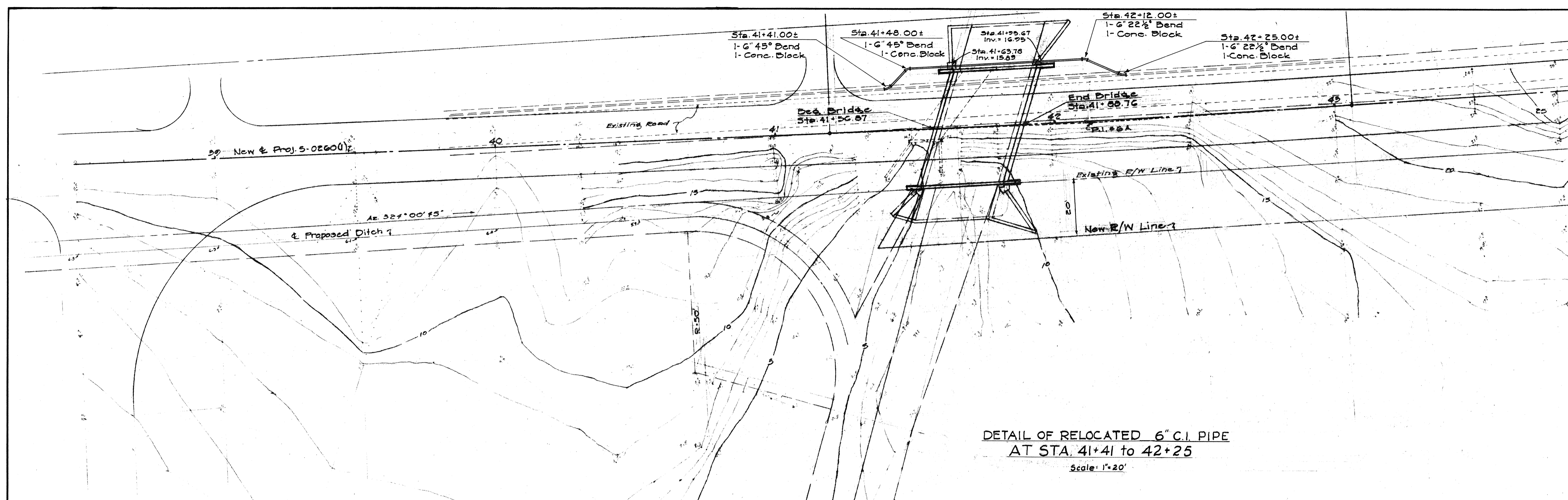

DETAIL OF RELOCATED 6" C.I. PIPE
AT STA. 41+41 TO 42+25
Scale: 1"=20'

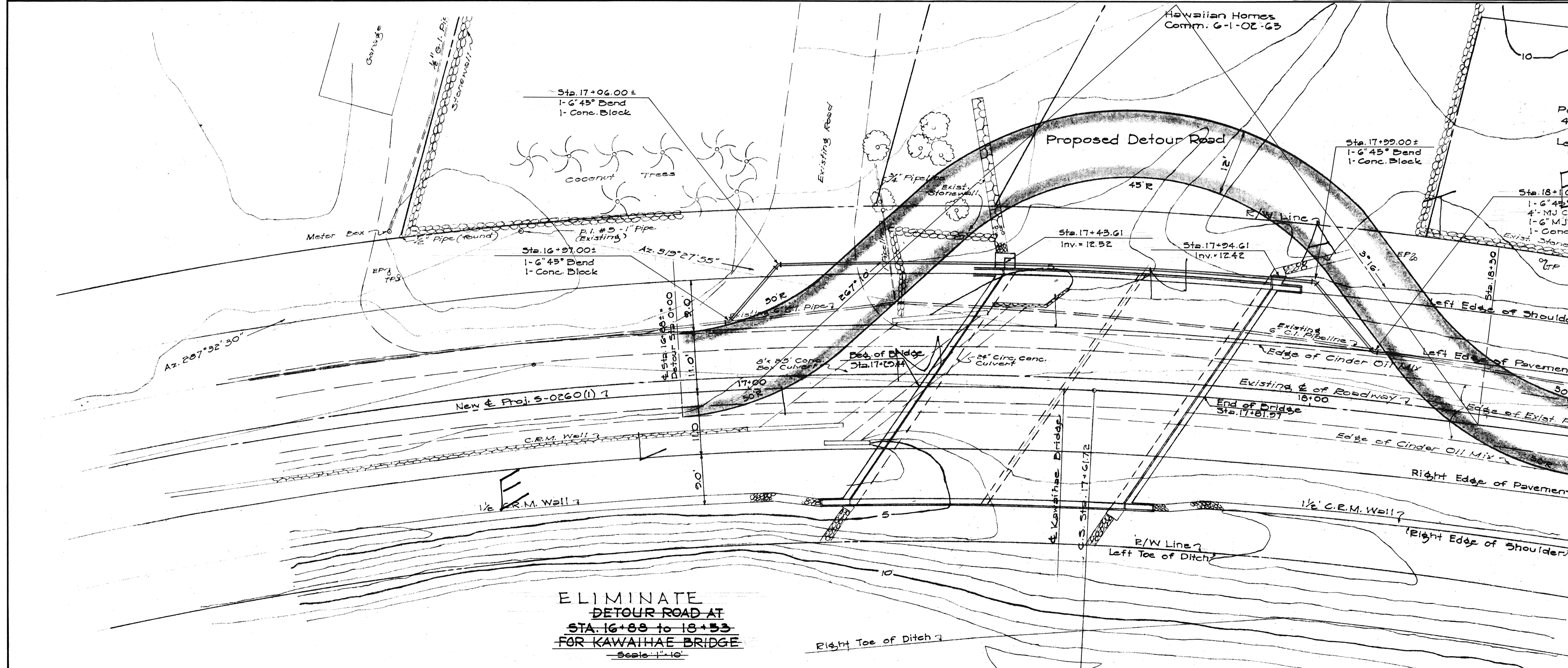
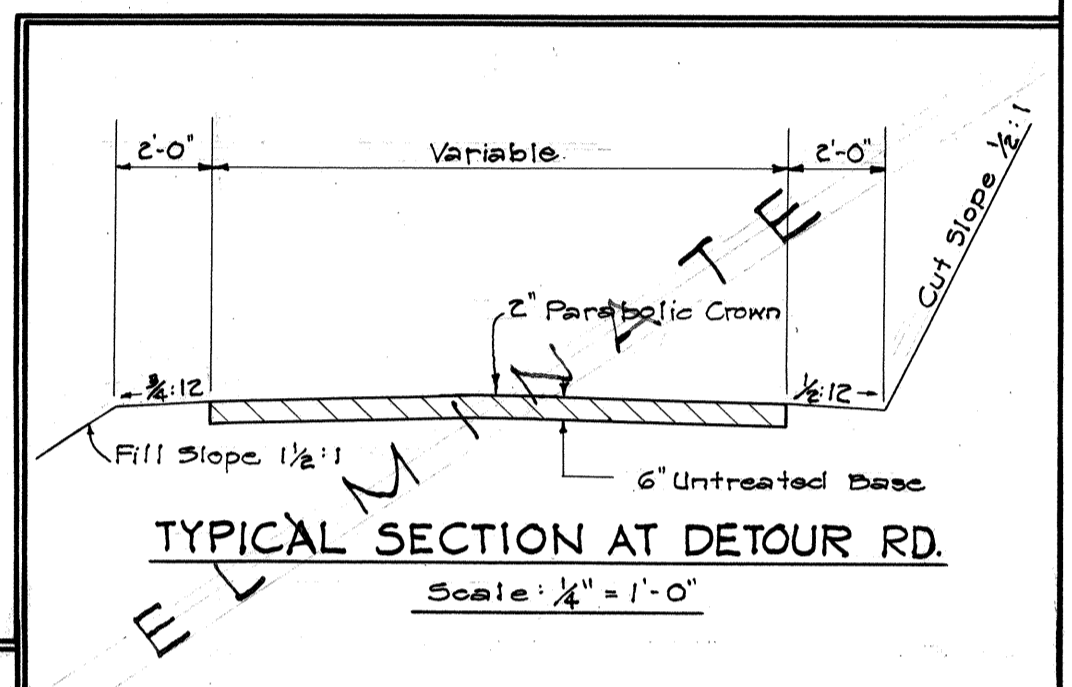

ELIMINATE
DETOUR ROAD AT
STA. 16+88 TO 18+53
FOR KAWAIHAE BRIDGE
Scale: 1"=10'

TERRITORIAL HIGHWAY DEPARTMENT
TERRITORY OF HAWAII
DETAILS OF DETOUR ROAD
& RELOCATED 6" C.I. PIPE
KAWAIHAE ROAD PROJ. 5-0260(1)
Scale as Noted