

FED. ROAD DIST. NO.	STATE	FED. AID PROJ. NO.	FISCAL YEAR	SHEET NO.	TOTAL SHEETS
HAWAII	HAW.	HSIP-0250(007)	2017	25	35

**LEGEND**

- 4 each Type A Raised Pavement Markers
- Type C Raised Pavement Markers @ 40'-0" o.c.
- 4 each Type J Raised Pavement Markers
- Type D Raised Pavement Markers @ 40'-0" o.c.
- 8" White Stripe with Type C Raised Pavement Markers @ 20'-0" o.c. (Tape, Type I or Thermoplastic Extrusion)
- 4" Double Solid Yellow with Type D Raised Pavement Markers @ 20'-0" o.c. (Tape, Type I or Thermoplastic Extrusion)
- 4" Double Solid Yellow Stripes with Type H Raised Pavement Markers @ 20'-0" o.c. (Tape, Type II or Thermoplastic Extrusion)
- 4" Yellow Edge Stripe with Type H Raised Pavement Markers @ 40'-0" o.c. (Tape, Type II or Thermoplastic Extrusion)
- 4" Double Solid White Stripes with Type C Raised Pavement Markers @ 20'-0" o.c. (Tape, Type I or Thermoplastic Extrusion)
- Lane Change Restriction Marking
- 4 each Type A Raised Pavement Markers  
Type C Raised Pavement Markers @ 20'-0" o.c.  
4" White Stripe (Tape, Type I or Thermoplastic Extrusion)
- 4" or 8" White Edge Stripe with Type C Raised Pavement Markers @ 40'-0" o.c. (Tape, Type II or Thermoplastic Extrusion)
- 4" White Guide Lines (Tape, Type III or Thermoplastic Extrusion except for bus bays)
- Transverse Median Marking (Tape, Type II or Thermoplastic Extrusion)
- Transverse Shoulder Marking (Tape, Type II or Thermoplastic Extrusion)
- Channelizing Island or Deceleration Lane Gore (Tape, Type II or Thermoplastic Extrusion)
- Crosswalk and Stop Line. All Stop Lines shall be 10'-0" from Crosswalk unless otherwise noted. The circled number indicates the number of lanes for payment (Tape, Type III or Thermoplastic Extrusion)
- Pavement Arrow (Tape, Type III or Thermoplastic Extrusion)
- STOP Pavement Word (Tape, Type III or Thermoplastic Extrusion)
- 4" Wide x 10'-0" Long Yellow Stripe @ 40'-0" o.c.
- 4 Each Type J Raised Pavement Markers
- Type D Raised Pavement Markers @ 40'-0" o.c.
- Type H Raised Pavement Markers (Reflective Surface facing no-passing direction)
- 4" Single Solid Yellow Stripe (Tape, Type I or Thermoplastic Extrusion)
- Extension of Edge Line, 4" Wide x 2'-0" Long White Stripe @ 10'-0" o.c. w/Type C Markers @ 40'-0" o.c. (Tape, Type III or Thermoplastic Extrusion)
- Reflector Marker (RM-5) Mounted on New and Existing Metal Guardrail

**NOTES**

1. Layout of pavement markings and striping shall be done by the Contractor and approved by the Engineer prior to any installation work.
2. Existing pavement markings not incorporated in the final traffic pattern shall be removed as directed by the Engineer. Costs shall be incidental to the various pavement marking items.
3. Raised pavement markers shall not be installed within crosswalks.
4. Final locations of all signs shall be approved by the Engineer prior to any installation work.
5. Existing signs not shown on these plans shall remain as posted unless otherwise directed by the Engineer. Removal and disposal of existing signs and/or posts as designated on these plans shall be incidental to the various signing items.
6. Final locations of all Stop Lines shall be approved by the Engineer prior to installation.
7. All pavement striping shall be as noted on the legend or plans.
8. All preformed pavement marking tapes over existing pavement shall be applied with an approved primer as recommended by the tape manufacturer and as approved by the Engineer. The primer shall be allowed to dry to the tacky stage prior to tape application.
9. All Pedestrian warning signs with supplemental sign shall be on a fluorescent yellow-green retroreflective background with a legend and border.
10. All new sign posts shall be painted safety yellow as directed by the Engineer. Costs shall be incidental to the various signing items.

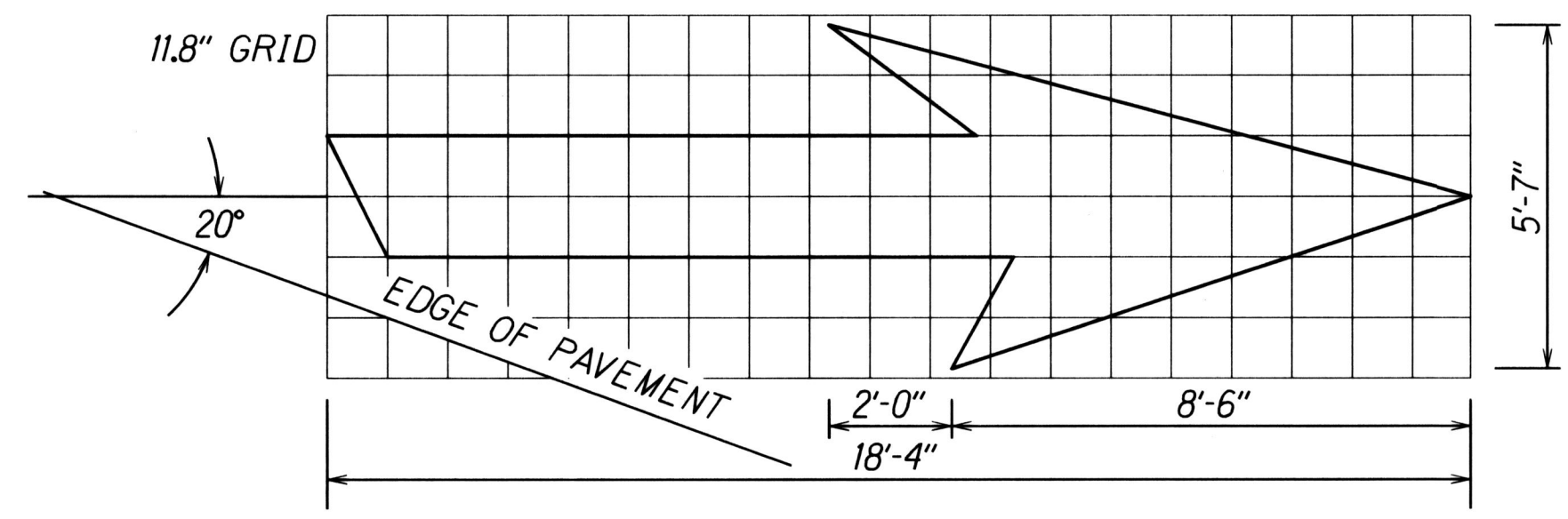

**TYPE VI ARROW**  
RIGHT LANE DROP ARROW  
(FOR LEFT LANE, USE MIRROR IMAGE)

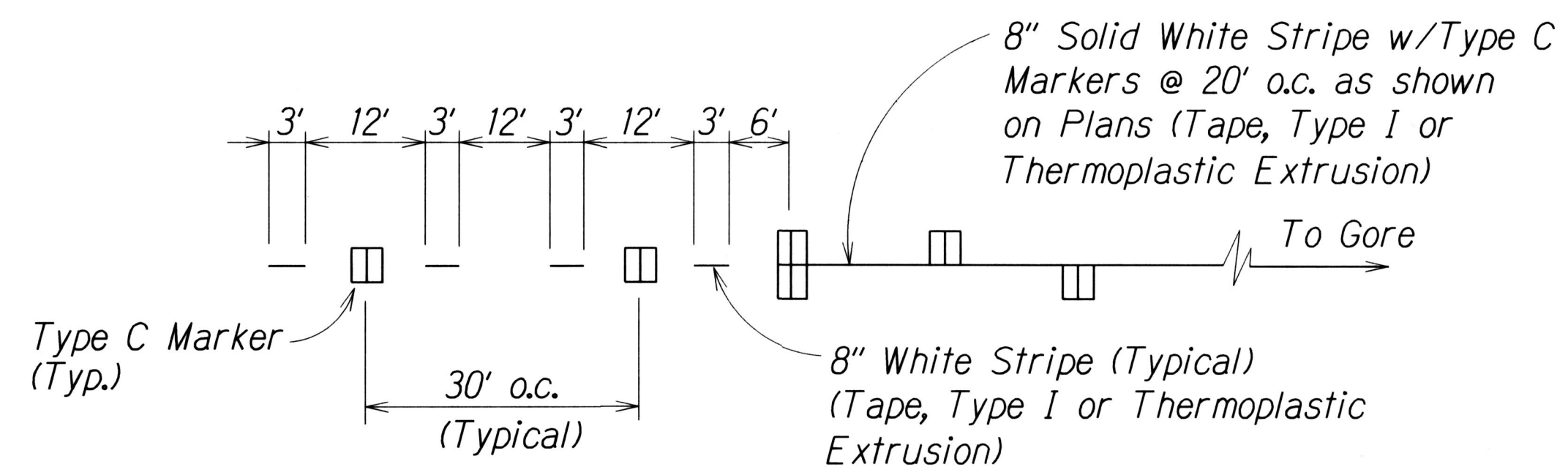

**LANE DROP MARKING**  
Not to Scale

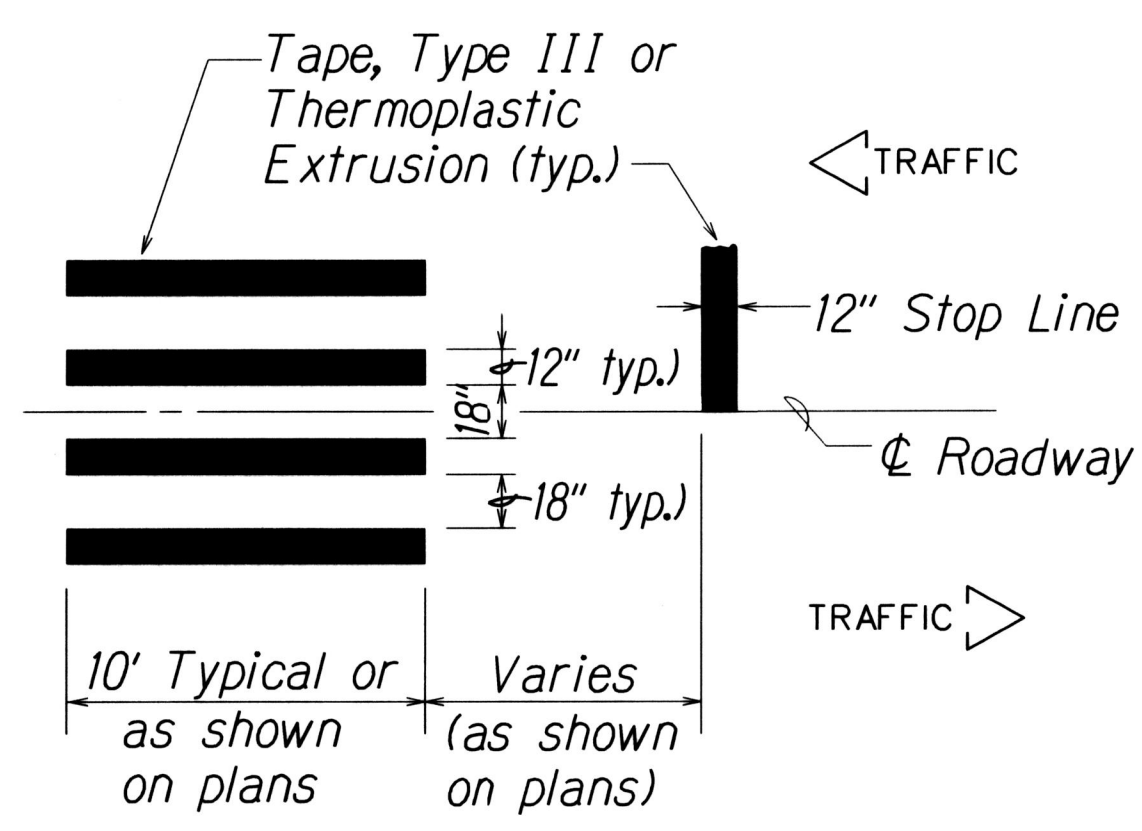

**CROSSWALK STRIPING DETAIL**  
Not to Scale

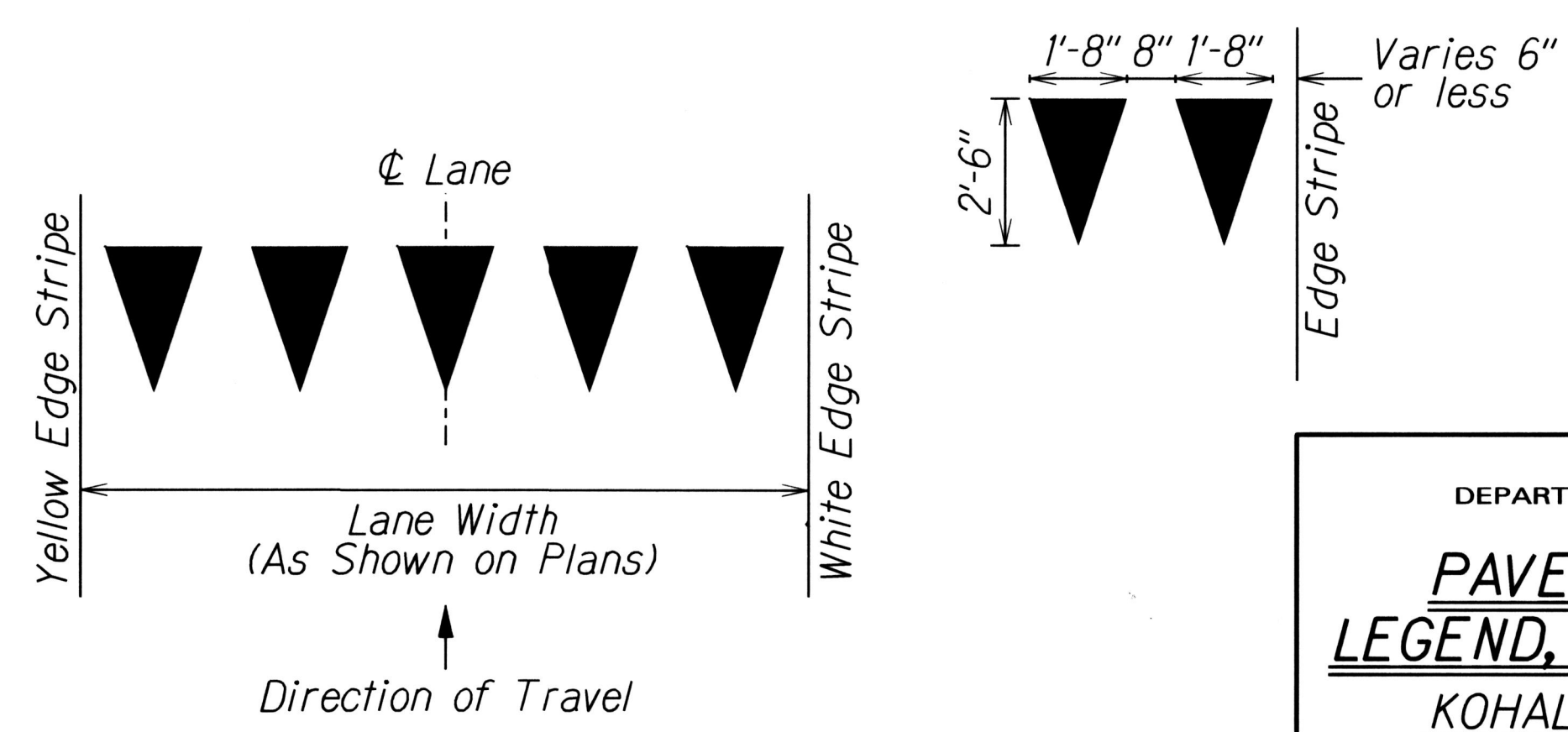

**YIELD LINE**  
Not to Scale

DESIGNED BY	DATE
DRAWN BY	
CHECKED BY	
QUANTITIES BY	
NOTED BY	
ORIGINAL PLAN	

STATE OF HAWAII  
DEPARTMENT OF TRANSPORTATION  
HIGHWAYS DIVISION

**PAVEMENT MARKING  
LEGEND, DETAILS & NOTES**

KOHALA MOUNTAIN ROAD  
Safety Improvements

Federal Aid Project No. HSIP-0250(007)

Scale: As Shown      Date: March 2017

SHEET No. 11 OF 11 SHEETS

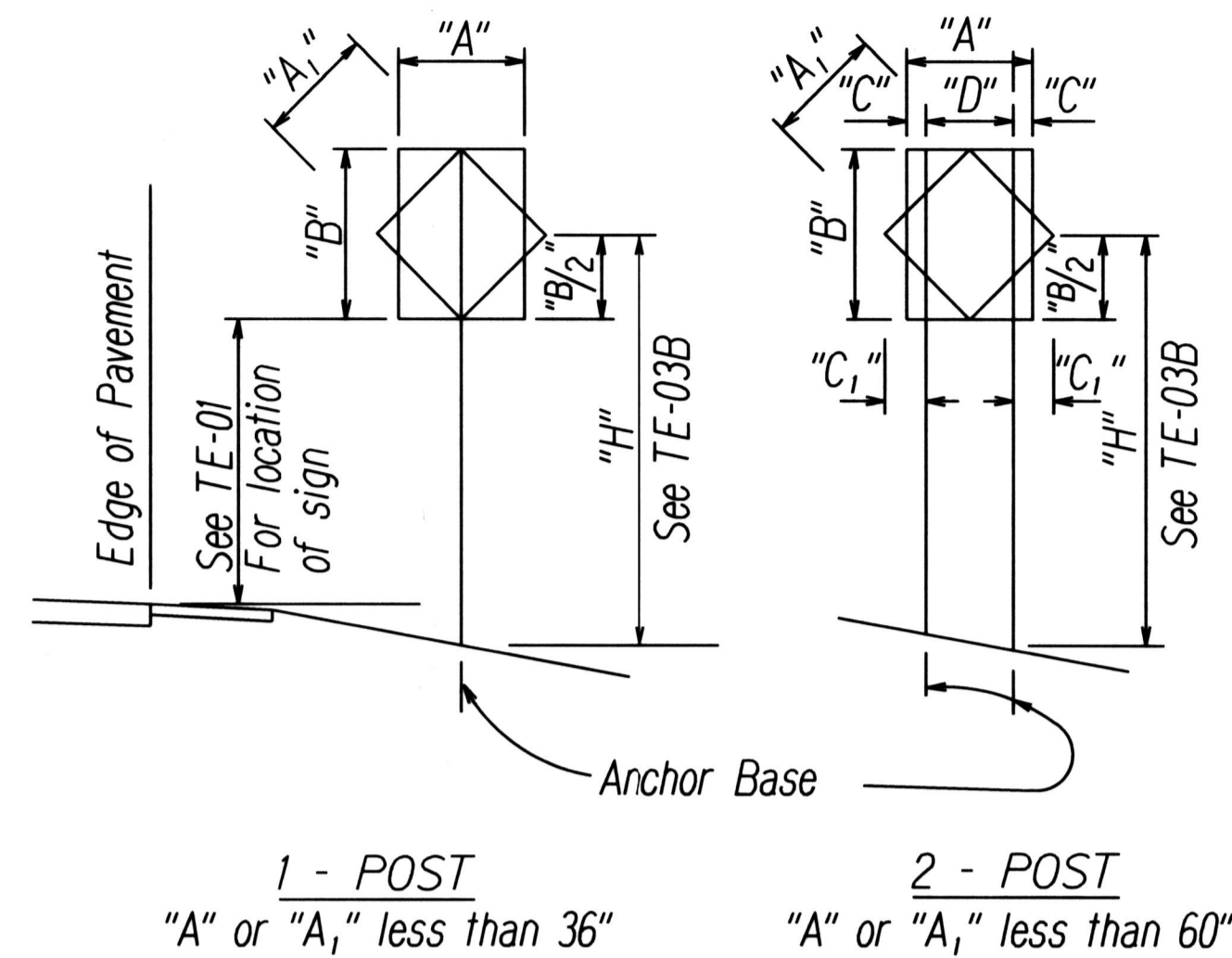

"A" or "A <sub>1</sub> "	"C"	"C <sub>1</sub> "
Less than 36"	6"	-
Greater than 36" and less than 48"	9"	19"
Greater than 48"	12"	24"

NOTE: Frame stiffeners are required when D is greater than 24"  
See General Notes.

### TYPICAL INSTALLATION

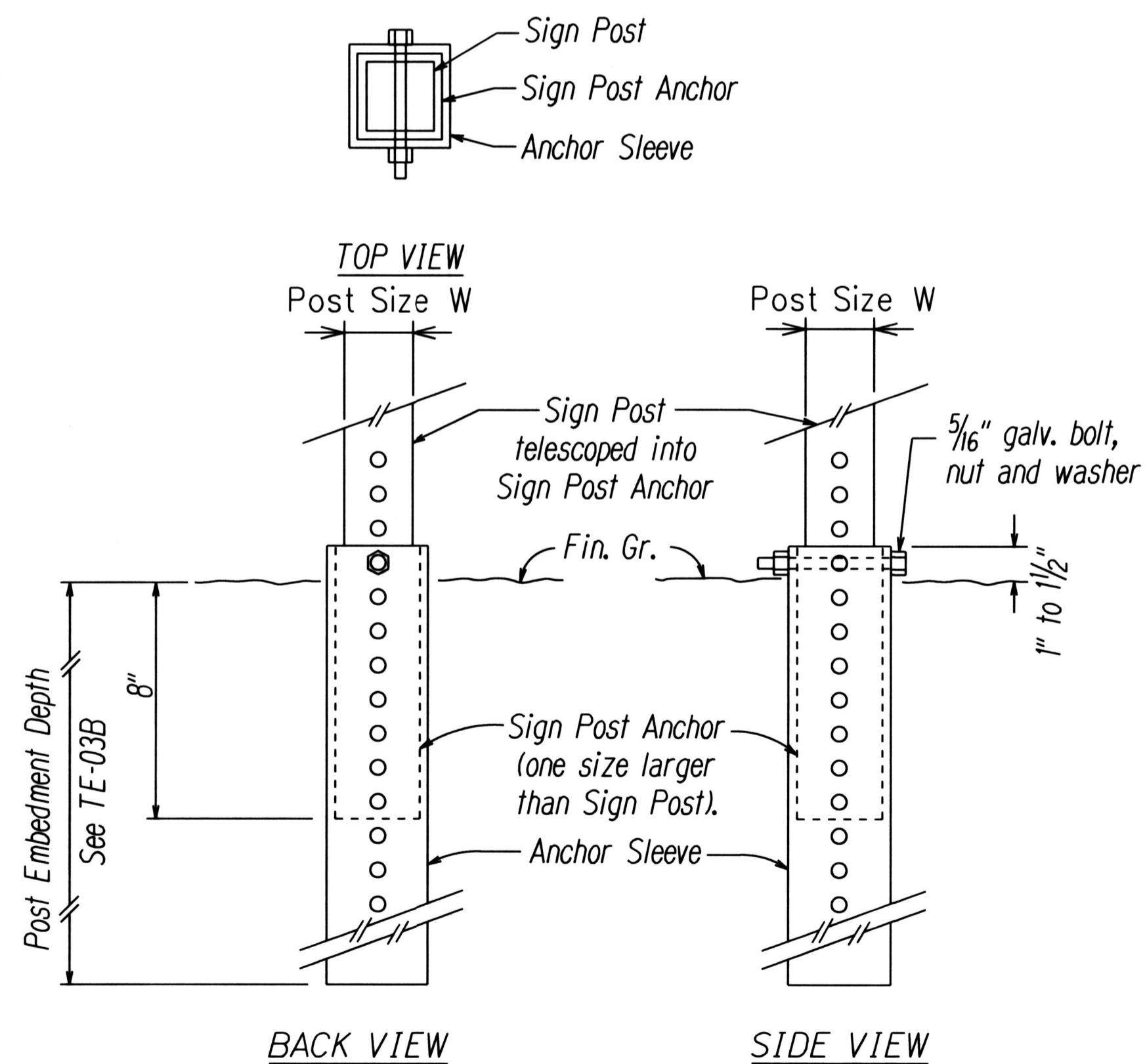

SIGN POST INSTALLATION  
ANCHOR BASE DETAIL

### GENERAL NOTES

- Design Specifications:**
  - Design shall conform w/ the latest AASHTO Standard Specifications for the Structural Supports for Highway Signs, Luminaires & Traffic Signals and its interim supplements and modifications by the Highways Division, Department of Transportation State of Hawaii.
  - Latest HDOT Memorandum with subject title "Design Criteria for Bridges and Structures."
- Loads:**
  - Basic Wind Speed: 105 mph.
  - Recurrence Interval of 10 years.
- Materials:**
  - Post shall conform to the Standard Specifications.
  - All connection bolts shall be AASHTO M164 bolts and anchor bolts shall be AASHTO M314-105 bolt.
  - Lap splice nuts and bolts shall be M180, with an ultimate tensile strength of 180 ksi, min.
  - Aluminum members and surfaces in contact with structural steel shall be isolated with neoprene material as approved by the Engineer.
- General:**
  - See General Notes on B-01, TE-01, and TE-03B for additional information.
  - All square tube posts shall be 12 gauge unless otherwise specified or shown on the plans.
  - Square tube posts shall be perforated with  $\frac{7}{16}$ "  $\phi$  holes, 1" o.c., 4 sides, along entire length of post.
  - All accessories, fittings and stiffener details (as required) shall be submitted to the Engineer for approval 20 days prior to installation.
  - Alternate designs in accordance with the plans and specifications shall use the Service Load Design Method and shall be stamped by a registered structural engineer of the State of Hawaii and submitted to the Engineer for approval.
  - All sign support posts without break away anchor base shall be outside of the clear zone or shielded by an appropriate traffic barrier system. The traffic barrier system shall be submitted to the Engineer for his approval.
  - The Contractor shall use templates while installing the anchor bolts. Anchor bolts shall be vertical.
  - Excavation and backfill shall be considered incidental to the cost of the sign foundation.

ORIGINAL PLAN	DATE
DESIGNED BY	
TRACED BY	
NOTED BY	
QUANTITIES BY	
CHECKED BY	

STATE OF HAWAII  
DEPARTMENT OF TRANSPORTATION  
HIGHWAYS DIVISION

**GALVANIZED SQUARE TUBE  
SIGN POST MOUNTING**

KOHALA MOUNTAIN ROAD  
Safety Improvements

Federal Aid Project No. HSIP-0250(007)

Scale: As Shown Date: March 2017

SHEET No. T2 OF 11 SHEETS

FED. ROAD DIST. NO.	STATE	FED. AID PROJ. NO.	FISCAL YEAR	SHEET NO.	TOTAL SHEETS
HAWAII	HAW.	HSIP-0250(007)	2017	27	35

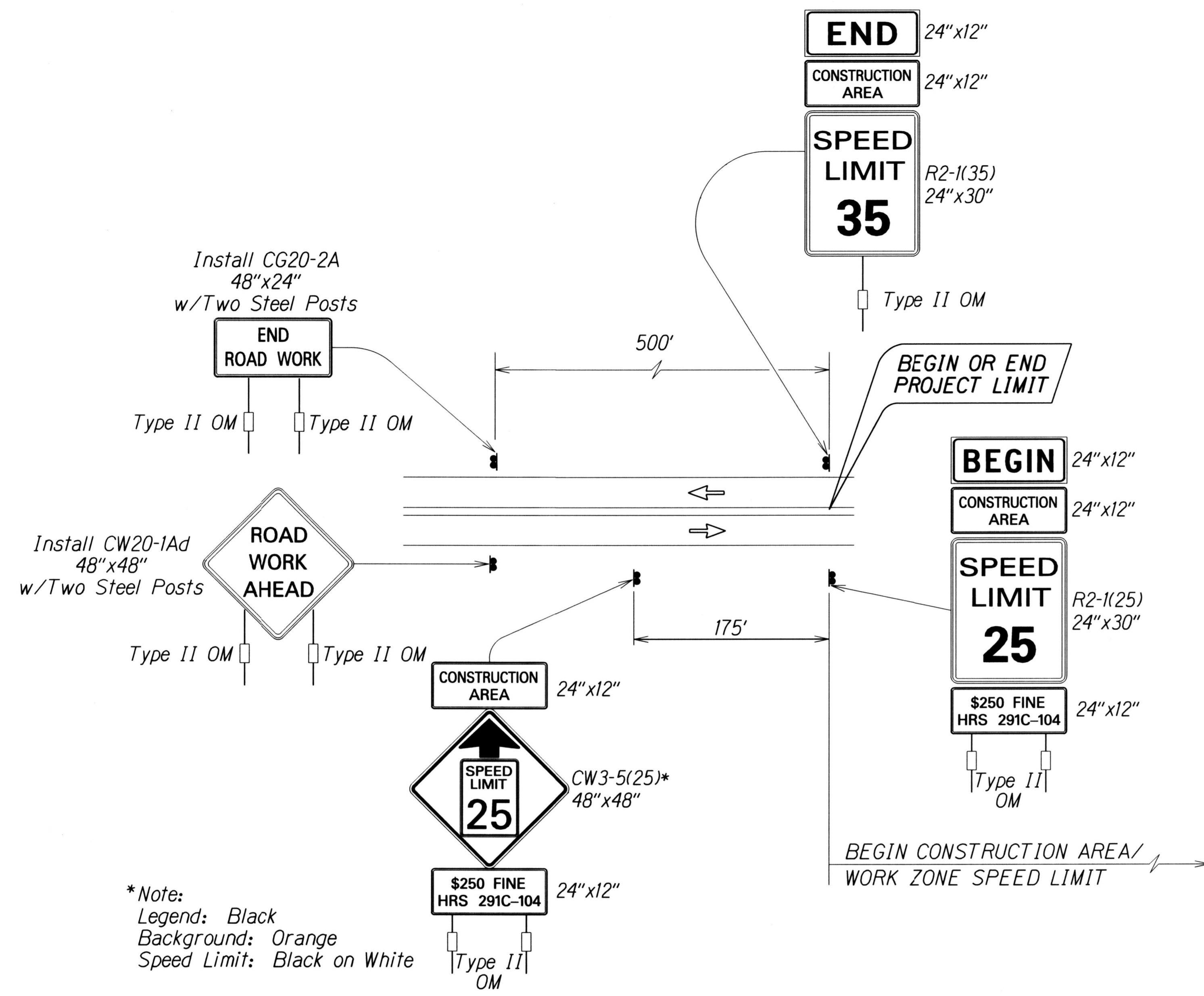

**TYPICAL DETAIL FOR CONSTRUCTION SIGNS  
 ON TWO LANE OR MULTILANE UNDIVIDED LOW SPEED HIGHWAY**

**Work Zone Note:**

1. This Work Zone Sign Plan is intended for use on long-term stationary work zones/construction phases (3 days or more). All work zones or construction phases less than 3 days duration will use Traffic Control Plans shown in Section 645 of the Special Provisions.
2. All existing regulatory speed limit signs with posts within the work zone/project limits shall be removed and replaced with work zone speed limit sign assemblies (R2-1(25) and CW3-5(25) with "CONSTRUCTION AREA" and "\$250 FINE HRS 291C-104" Supplemental Signs).
3. Construction sign assemblies shall be installed on both the approaching and trailing ends of each work zone as shown on this plan.
4. Each construction warning sign shall have a minimum of two (2) Type II OM. Each work zone speed limit assembly shall have a minimum of one (1) Type II OM. Installation of each Type II OM shall be considered incidental to Item No. 645.0100 - Traffic Control.
5. Upon the completion of all physical work or as directed by the Engineer, all construction signs and work zone speed limit assemblies shall be removed. All speed limit signs and posts that were existing at the start of the project within the work zone/project limits shall be restored back to their original locations and configurations.
6. Placement of construction signs shall not obstruct the path of pedestrians and bicyclists.
7. The removal and restoration of existing regulatory speed limit signs with new posts along with the installation, maintenance and removal of work zone speed limit sign assemblies shall be considered incidental to Item No. 645.0100 - Traffic Control.

SURVEY PLOTTED BY	DATE
DESIGNED BY	
TRACED BY	
DESIGNED BY	
QUANTITIES BY	
CHECKED BY	

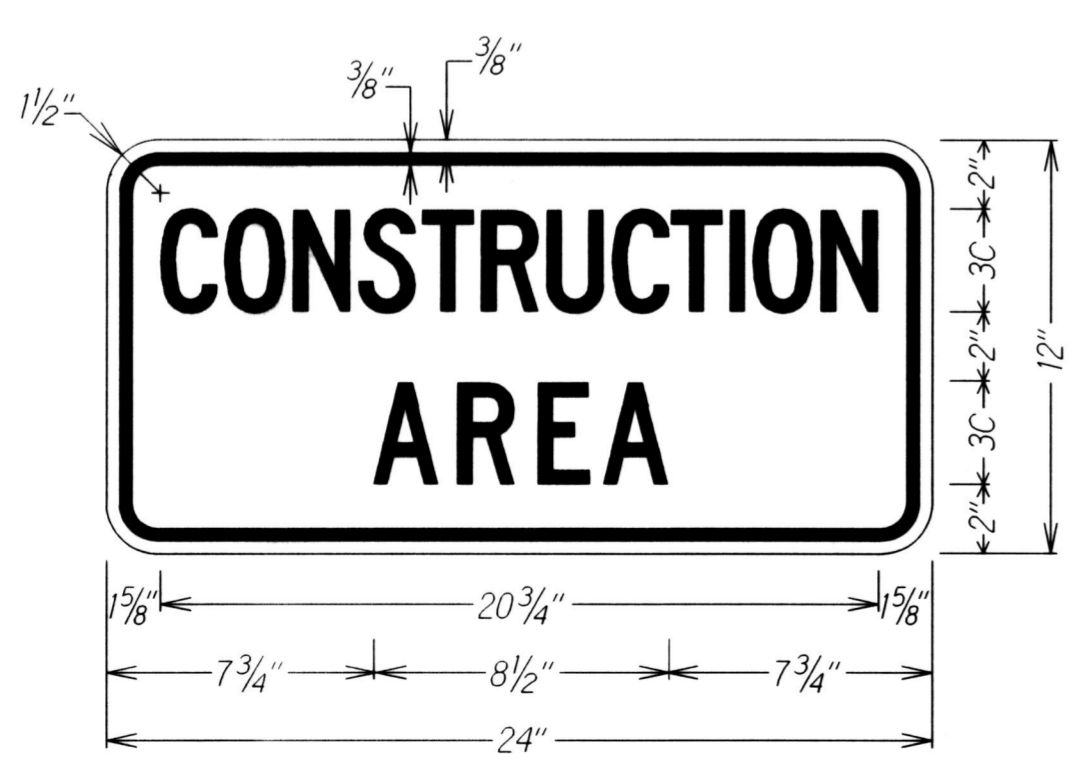

LEGEND: BLACK  
BACKGROUND: ORANGE

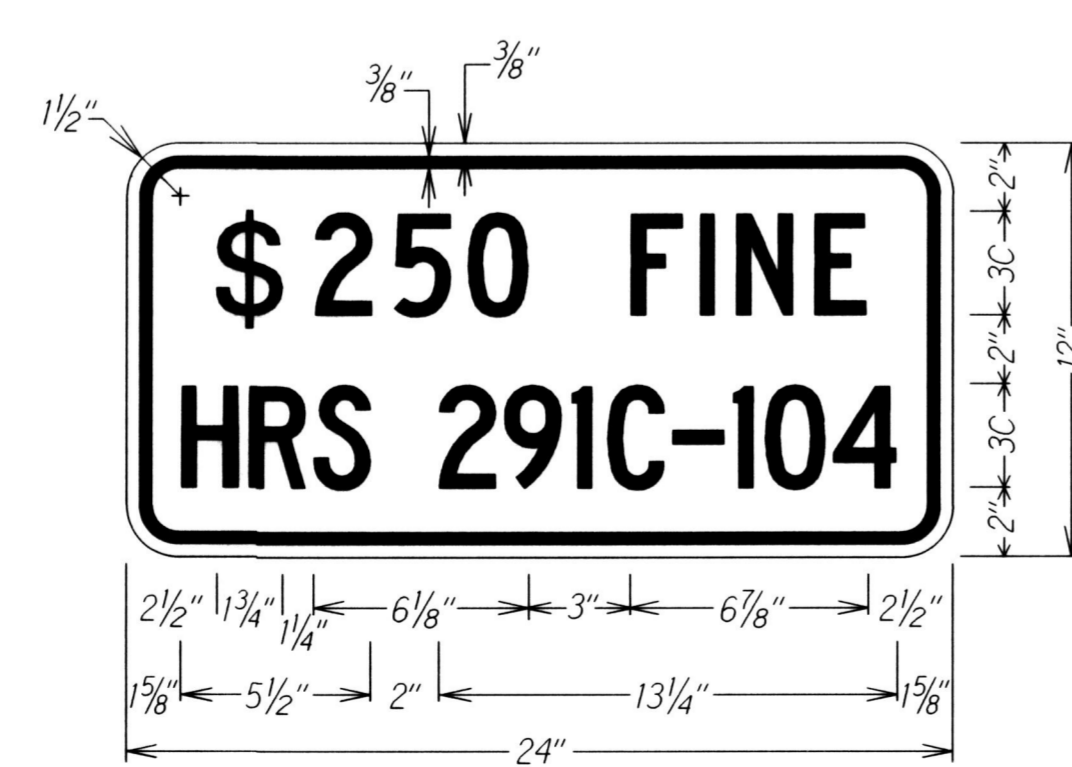

LEGEND: BLACK  
BACKGROUND: WHITE

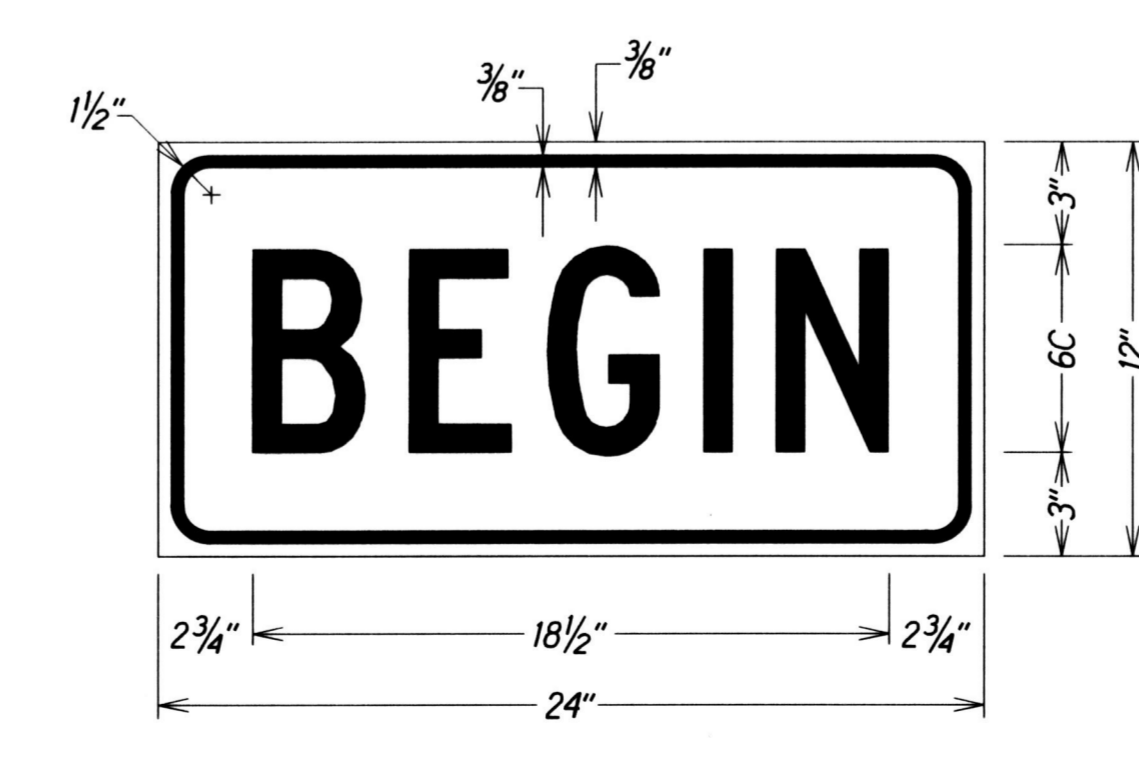

LEGEND: BLACK  
BACKGROUND: ORANGE

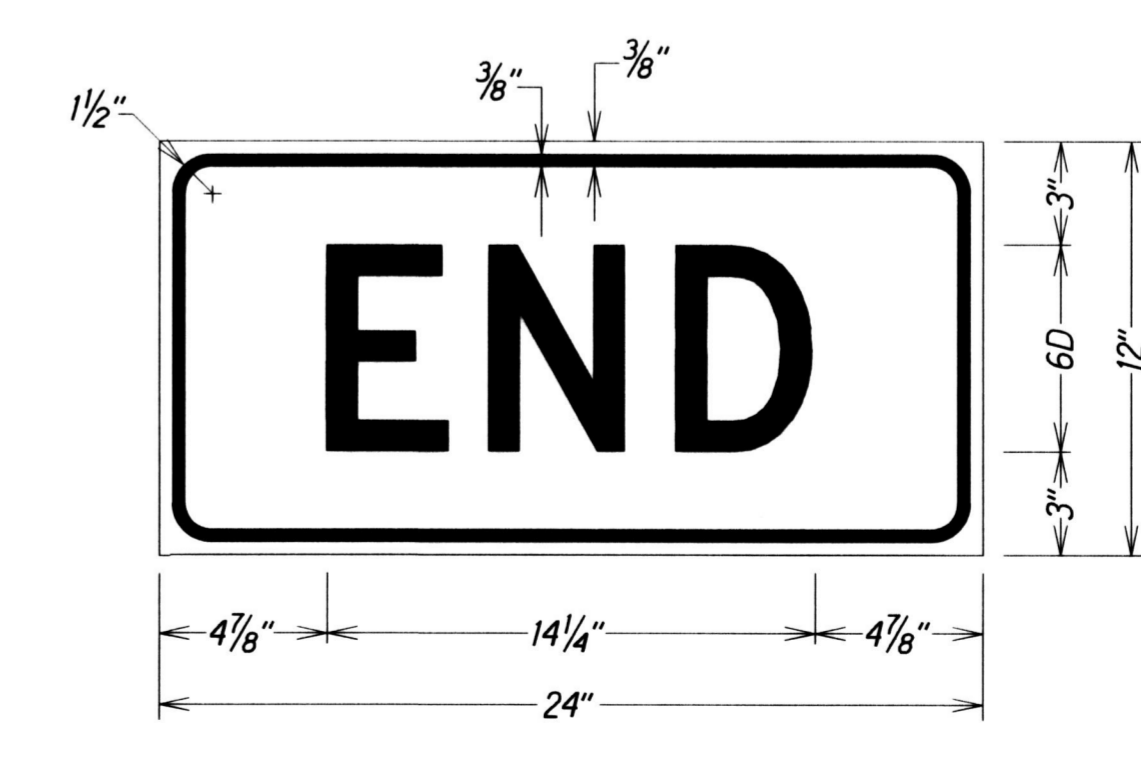

LEGEND: BLACK  
BACKGROUND: ORANGE

STATE OF HAWAII  
 DEPARTMENT OF TRANSPORTATION  
 HIGHWAYS DIVISION  
**LOW SPEED UNDIVIDED HIGHWAY**  
**WORK ZONE SIGNING PLAN, NOTES&DETAILS**  
 KOHALA MOUNTAIN ROAD  
 Safety Improvements  
 Federal Aid Project No. HSIP-0250(007)  
 Scale: As Shown Date: March 2017  
 SHEET No. T3 OF 11 SHEETS



FED. ROAD DIST. NO.	STATE	FED. AID PROJ. NO.	FISCAL YEAR	SHEET NO.	TOTAL SHEETS
HAWAII	HAW.	HSIP-0250(007)	2017	29	35

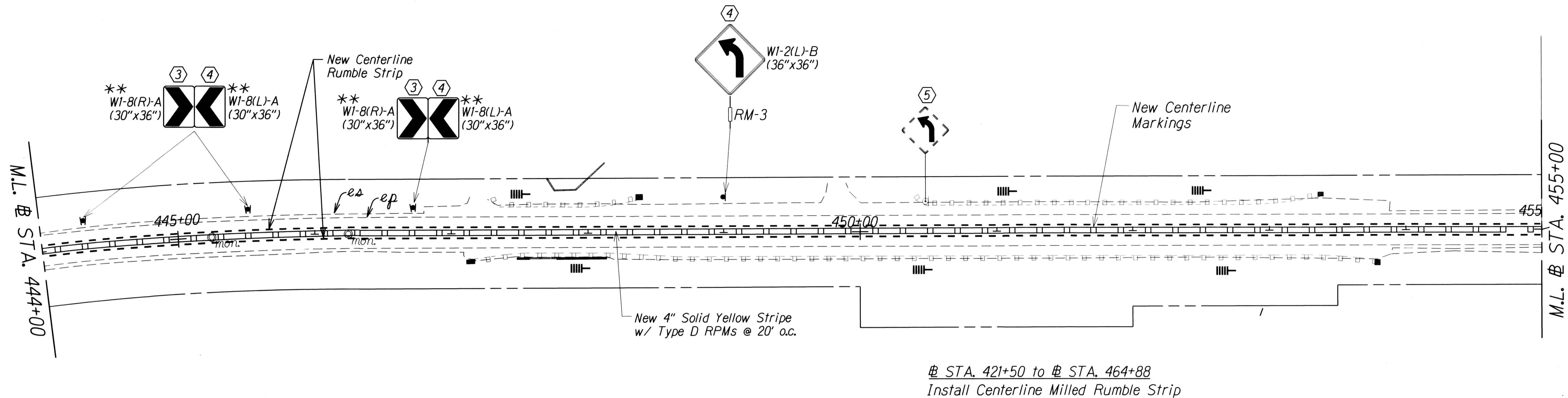

Ⓜ STA. 421+50 to Ⓜ STA. 464+88  
Install Centerline Milled Rumble Strip

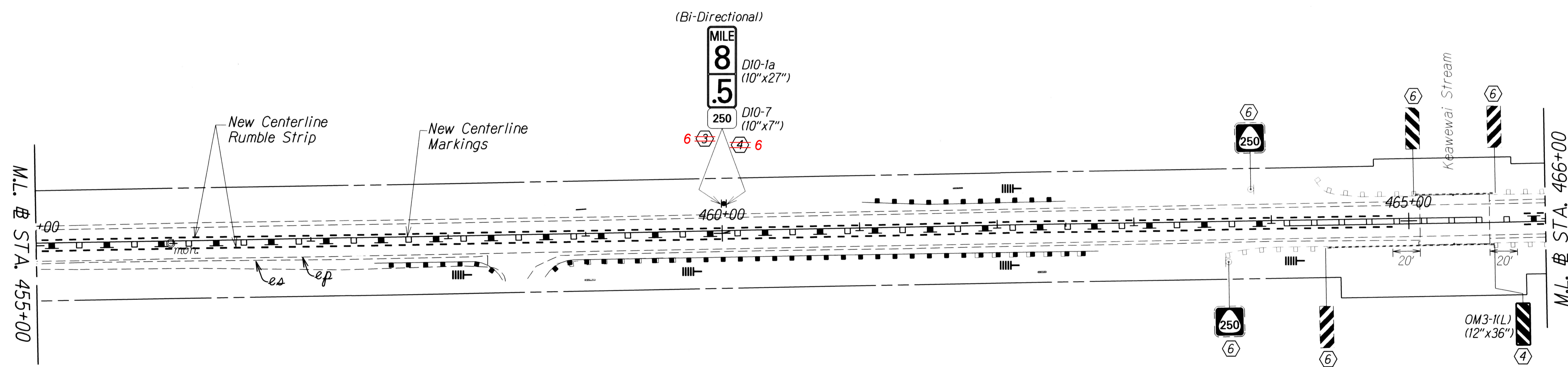

Ⓜ STA. 465+79 to Ⓜ STA. 535+00  
Install Centerline Milled Rumble Strip

- KEY:**
- ① Remove Exist. Sign(s) & Post(s) & Install New Sign(s) & Posts(s)
  - ② Remove Exist. Sign(s) & Install New Sign(s)
  - ③ Install New Sign(s)
  - ④ Install New Sign(s) & Post(s)
  - ⑤ Remove Existing Sign(s) and Post(s)
  - ⑥ Existing Sign(s) and Post(s) to Remain

\*\* Fluorescent Yellow Sign Sheeting

|||— Reflector Markers (RM-5) shall be mounted every 25 feet on all new and existing metal guardrails except on Terminal Sections. For new guardrail installation, furnishing and installing of each RM-5 shall be considered incidental to the adjacent guardrail system. Unless otherwise noted, the Contractor shall be responsible for mounting RM-5s on all existing metal guardrails even when not shown on plans. For existing guardrails, furnishing and installing of each RM-5 shall be considered incidental to Item No. 632.0200-Reflector Marker (RM-5, White) Mounted on Existing Guardrail.

**NOTE:**  
All existing edgeline pavement marking & striping shall remain & are for reference only.

SURVEY PLOTTED BY	DATE
DESIGNED BY	
TRACED BY	
NOTE BOOK	
QUANTITIES BY	
CHECKED BY	

STATE OF HAWAII  
DEPARTMENT OF TRANSPORTATION  
HIGHWAYS DIVISION

**PAVEMENT MARKING &  
SIGNING PLANS**

KOHALA MOUNTAIN ROAD  
Safety Improvements

Federal Aid Project No. HSIP-0250(007)  
Scale: 1" = 40' Date: March, 2017

FED. ROAD DIST. NO.	STATE	FED. AID PROJ. NO.	FISCAL YEAR	SHEET NO.	TOTAL SHEETS
HAWAII	HAW.	HSIP-0250(007)	2017	30	35

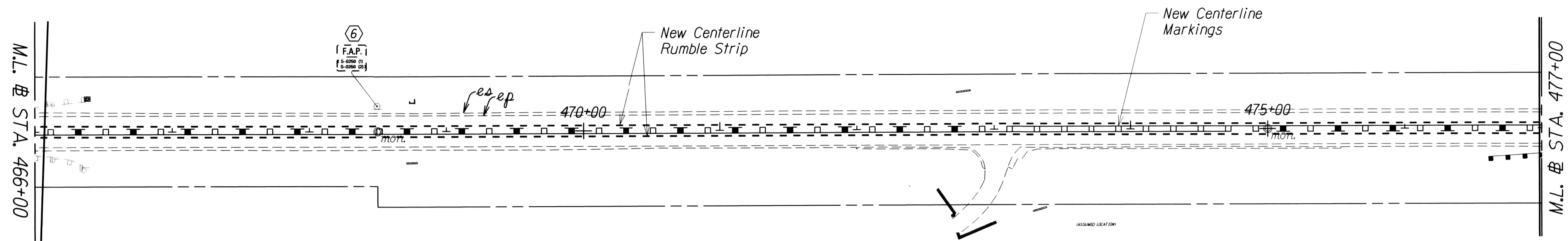

# STA. 465+79 to # STA. 535+00  
Install Centerline Milled Rumble Strip

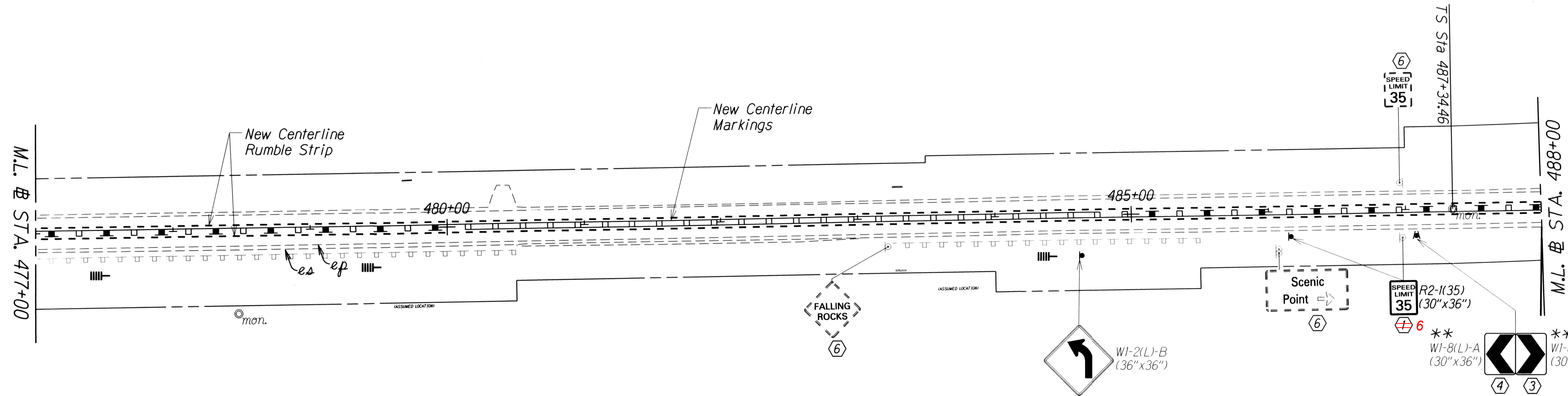

- KEY:**
- ① Remove Exist. Sign(s) & Post(s) & Install New Sign(s) & Posts(s)
  - ② Remove Exist. Sign(s) & Install New Sign(s)
  - ③ Install New Sign(s)
  - ④ Install New Sign(s) & Post(s)
  - ⑤ Remove Existing Sign(s) and Post(s)
  - ⑥ Existing Sign(s) and Post(s) to Remain

**NOTE:**  
All existing edgeline pavement marking & striping shall remain & are for reference only.

\*\* Fluorescent Yellow Sign Sheeting

|||— Reflector Markers (RM-5) shall be mounted every 25 feet on all new and existing metal guardrails except on Terminal Sections. For new guardrail installation, furnishing and installing of each RM-5 shall be considered incidental to the adjacent guardrail system. Unless otherwise noted, the Contractor shall be responsible for mounting RM-5s on all existing metal guardrails even when not shown on plans. For existing guardrails, furnishing and installing of each RM-5 shall be considered incidental to Item No. 632.0200-Reflector Marker (RM-5, White) Mounted on Existing Guardrail.

ORIGINAL PLAN	DATE
DESIGNED BY	
TRACED BY	
QUANTITIES BY	
CHECKED BY	

STATE OF HAWAII  
DEPARTMENT OF TRANSPORTATION  
HIGHWAYS DIVISION

**PAVEMENT MARKING &  
SIGNING PLANS**

KOHALA MOUNTAIN ROAD  
Safety Improvements

Federal Aid Project No. HSIP-0250(007)  
Scale: 1" = 40' Date: March, 2017

SHEET No. T6 OF 11 SHEETS

"AS-BUILT"

FED. ROAD DIST. NO.	STATE	FED. AID PROJ. NO.	FISCAL YEAR	SHEET NO.	TOTAL SHEETS
HAWAII	HAW.	HS1P-0250(007)	2017	31	35

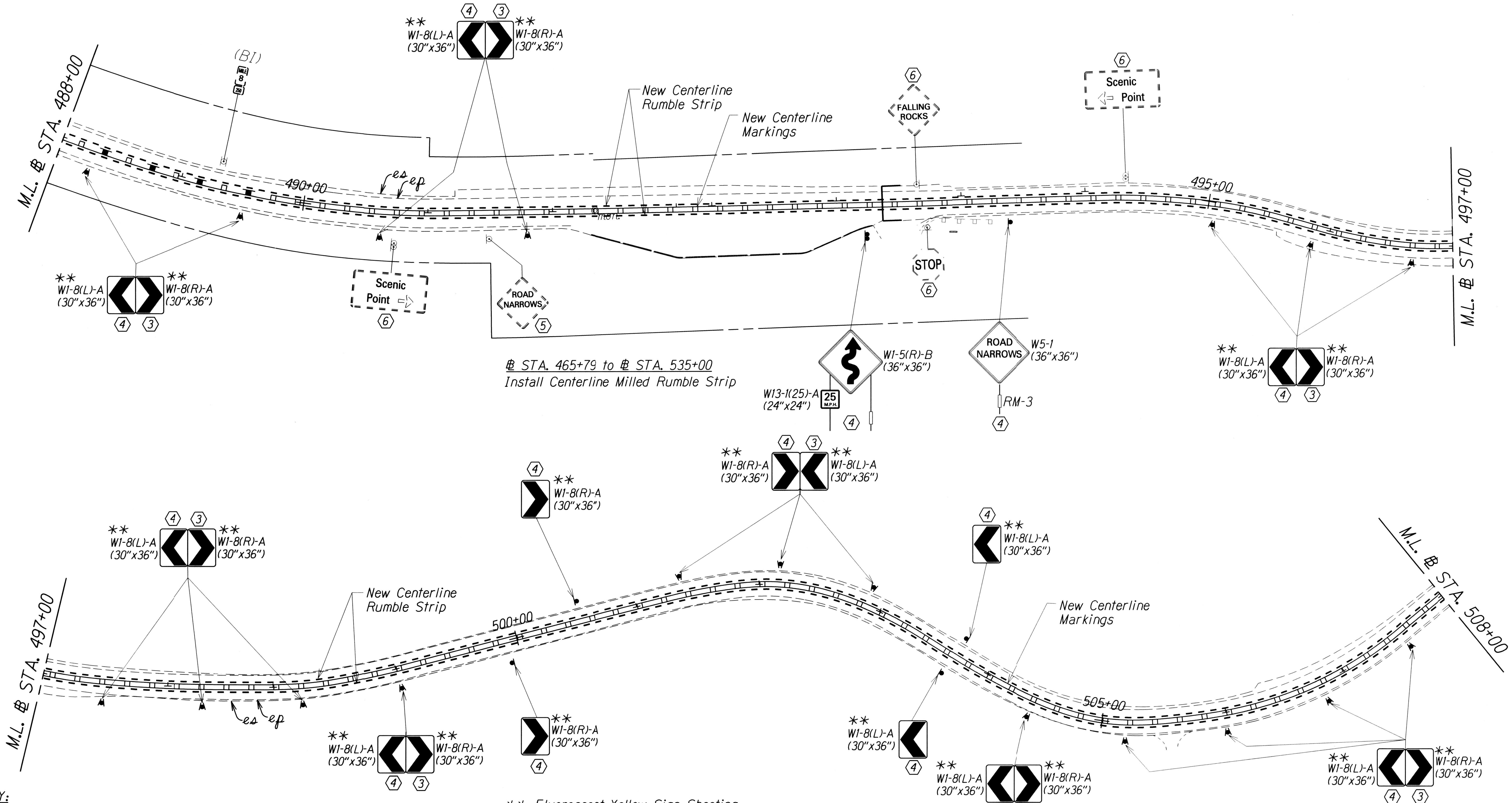

- KEY:**
- ① Remove Exist. Sign(s) & Post(s) & Install New Sign(s) & Posts(s)
  - ② Remove Exist. Sign(s) & Install New Sign(s)
  - ③ Install New Sign(s)
  - ④ Install New Sign(s) & Post(s)
  - ⑤ Remove Existing Sign(s) and Post(s)
  - ⑥ Existing Sign(s) and Post(s) to Remain

\*\* Fluorescent Yellow Sign Sheeting

|||— Reflector Markers (RM-5) shall be mounted every 25 feet on all new and existing metal guardrails except on Terminal Sections. For new guardrail installation, furnishing and installing of each RM-5 shall be considered incidental to the adjacent guardrail system. Unless otherwise noted, the Contractor shall be responsible for mounting RM-5s on all existing metal guardrails even when not shown on plans. For existing guardrails, furnishing and installing of each RM-5 shall be considered incidental to Item No. 632.0200-Reflector Marker (RM-5, White) Mounted on Existing Guardrail.

**NOTE:**  
All existing edgeline pavement marking & striping shall remain & are for reference only.

ORIGINAL PLAN	DATE
DESIGNED BY	
TRACED BY	
QUANTITIES BY	
CHECKED BY	

STATE OF HAWAII  
DEPARTMENT OF TRANSPORTATION  
HIGHWAYS DIVISION

**PAVEMENT MARKING & SIGNING PLANS**

KOHALA MOUNTAIN ROAD  
Safety Improvements

Federal Aid Project No. HS1P-0250(007)  
Scale: 1" = 40' Date: March, 2017

SHEET No. T7 OF 11 SHEETS

FED. ROAD DIST. NO.	STATE	FED. AID PROJ. NO.	FISCAL YEAR	SHEET NO.	TOTAL SHEETS
HAWAII	HAW.	HSIP-0250(007)	2017	32	35

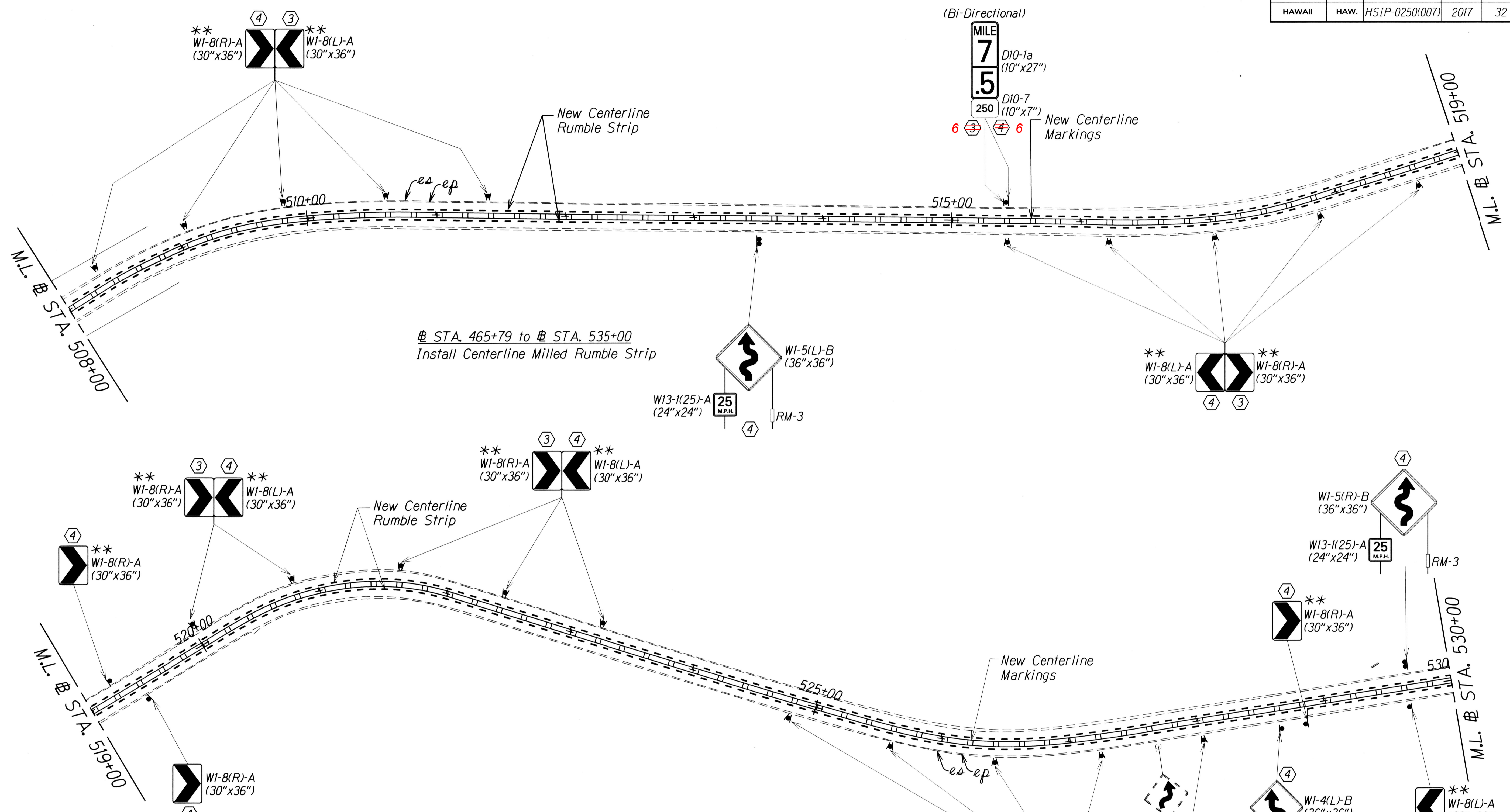

- KEY:**
- ① Remove Exist. Sign(s) & Post(s) & Install New Sign(s) & Posts(s)
  - ② Remove Exist. Sign(s) & Install New Sign(s)
  - ③ Install New Sign(s)
  - ④ Install New Sign(s) & Post(s)
  - ⑤ Remove Existing Sign(s) and Post(s)
  - ⑥ Existing Sign(s) and Post(s) to Remain

\*\* Fluorescent Yellow Sign Sheeting

|||— Reflector Markers (RM-5) shall be mounted every 25 feet on all new and existing metal guardrails except on Terminal Sections. For new guardrail installation, furnishing and installing of each RM-5 shall be considered incidental to the adjacent guardrail system. Unless otherwise noted, the Contractor shall be responsible for mounting RM-5s on all existing metal guardrails even when not shown on plans. For existing guardrails, furnishing and installing of each RM-5 shall be considered incidental to Item No. 632.0200-Reflector Marker (RM-5, White) Mounted on Existing Guardrail.

**NOTE:**  
All existing edgeline pavement marking & striping shall remain & are for reference only.

SURVEY PLOTTED BY	DATE
DESIGNED BY	
QUANTITIES BY	
CHECKED BY	
ORIGINAL PLAN	
NOTE BOOK	

STATE OF HAWAII  
DEPARTMENT OF TRANSPORTATION  
HIGHWAYS DIVISION

**PAVEMENT MARKING & SIGNING PLANS**

KOHALA MOUNTAIN ROAD  
Safety Improvements

Federal Aid Project No. HSIP-0250(007)  
Scale: 1" = 40' Date: March, 2017

FED. ROAD DIST. NO.	STATE	FED. AID PROJ. NO.	FISCAL YEAR	SHEET NO.	TOTAL SHEETS
HAWAII	HAW.	HSIP-0250(007)	2017	33	35

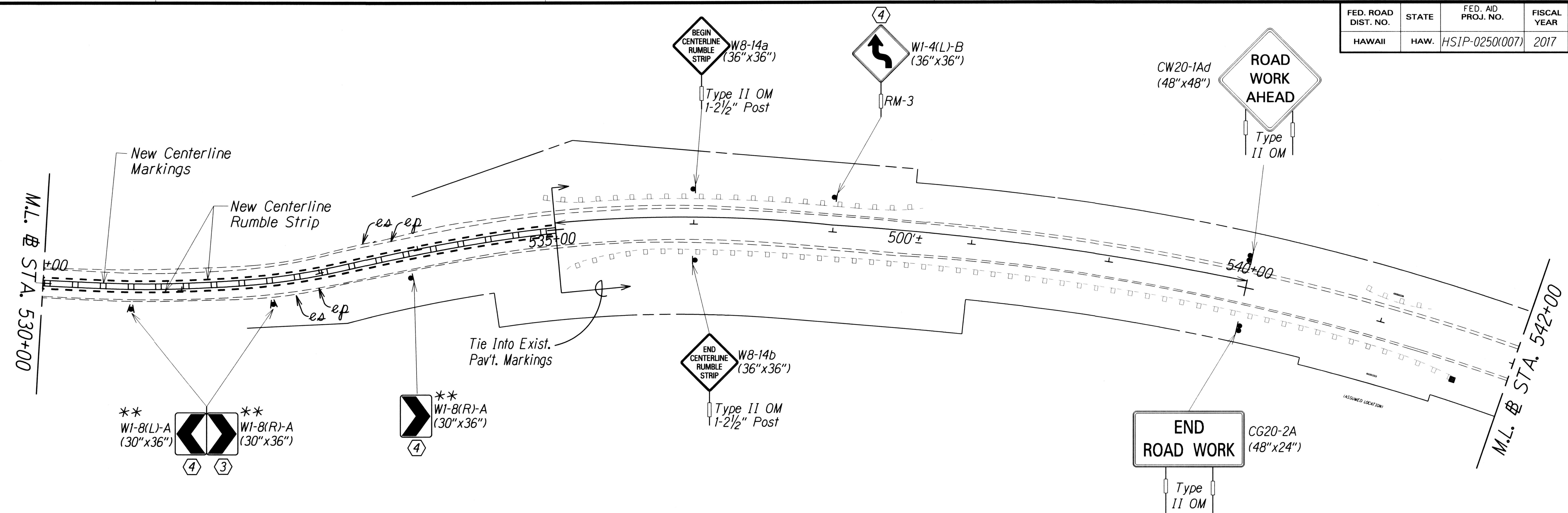

⊕ STA. 465+79 to ⊕ STA. 535+00  
Install Centerline Milled Rumble Strip

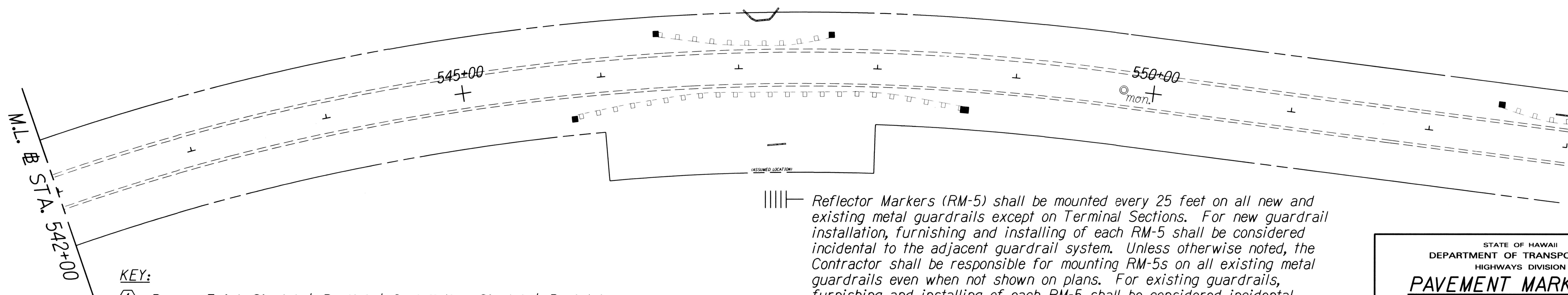

**KEY:**

- ① Remove Exist. Sign(s) & Post(s) & Install New Sign(s) & Posts(s)
- ② Remove Exist. Sign(s) & Install New Sign(s)
- ③ Install New Sign(s)
- ④ Install New Sign(s) & Post(s)
- ⑤ Remove Existing Sign(s) and Post(s)
- ⑥ Existing Sign(s) and Post(s) to Remain

\*\* Fluorescent Yellow Sign Sheeting

||| Reflecter Markers (RM-5) shall be mounted every 25 feet on all new and existing metal guardrails except on Terminal Sections. For new guardrail installation, furnishing and installing of each RM-5 shall be considered incidental to the adjacent guardrail system. Unless otherwise noted, the Contractor shall be responsible for mounting RM-5s on all existing metal guardrails even when not shown on plans. For existing guardrails, furnishing and installing of each RM-5 shall be considered incidental to Item No. 632.0200-Reflector Marker (RM-5, White) Mounted on Existing Guardrail.

**NOTE:**

All existing edgeline pavement marking & striping shall remain & are for reference only.

SURVEY PLOTTED BY	DATE
DESIGNED BY	
TRACED BY	
NOTE BOOK	
DESIGNED BY	
QUANTITIES BY	
CHECKED BY	

STATE OF HAWAII  
DEPARTMENT OF TRANSPORTATION  
HIGHWAYS DIVISION

**PAVEMENT MARKING &  
SIGNING PLANS**

KOHALA MOUNTAIN ROAD  
Safety Improvements

Federal Aid Project No. HSIP-0250(007)  
Scale: 1" = 40' Date: March, 2017

SHEET No. T9 OF 11 SHEETS

FED. ROAD DIST. NO.	STATE	FED. AID PROJ. NO.	FISCAL YEAR	SHEET NO.	TOTAL SHEETS
HAWAII	HAW.	HSIP-0250(007)	2017	34	35

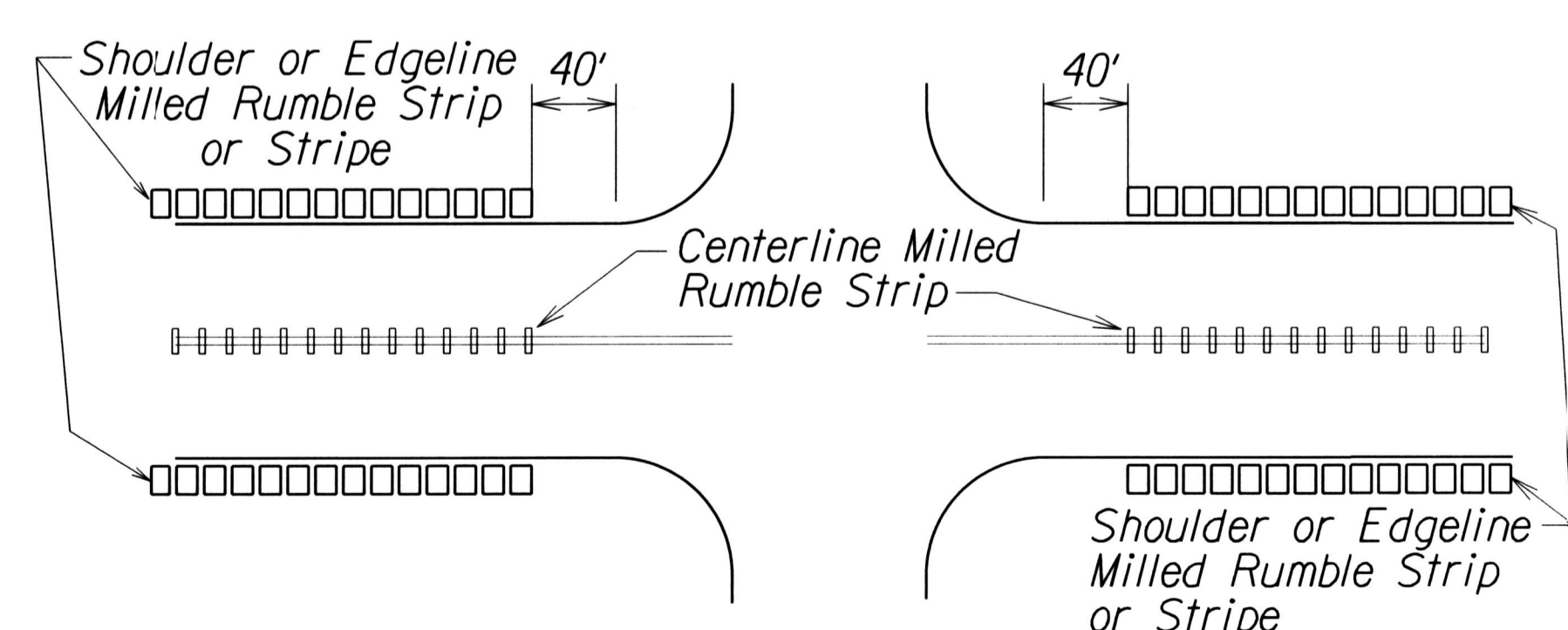
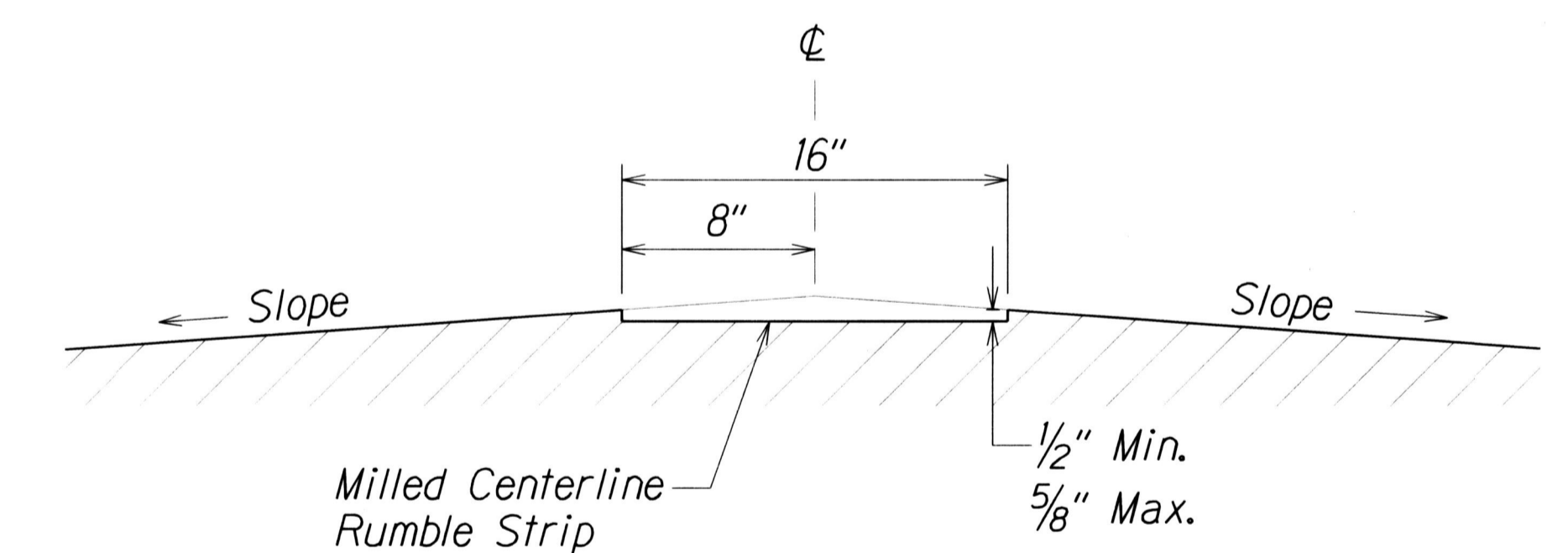
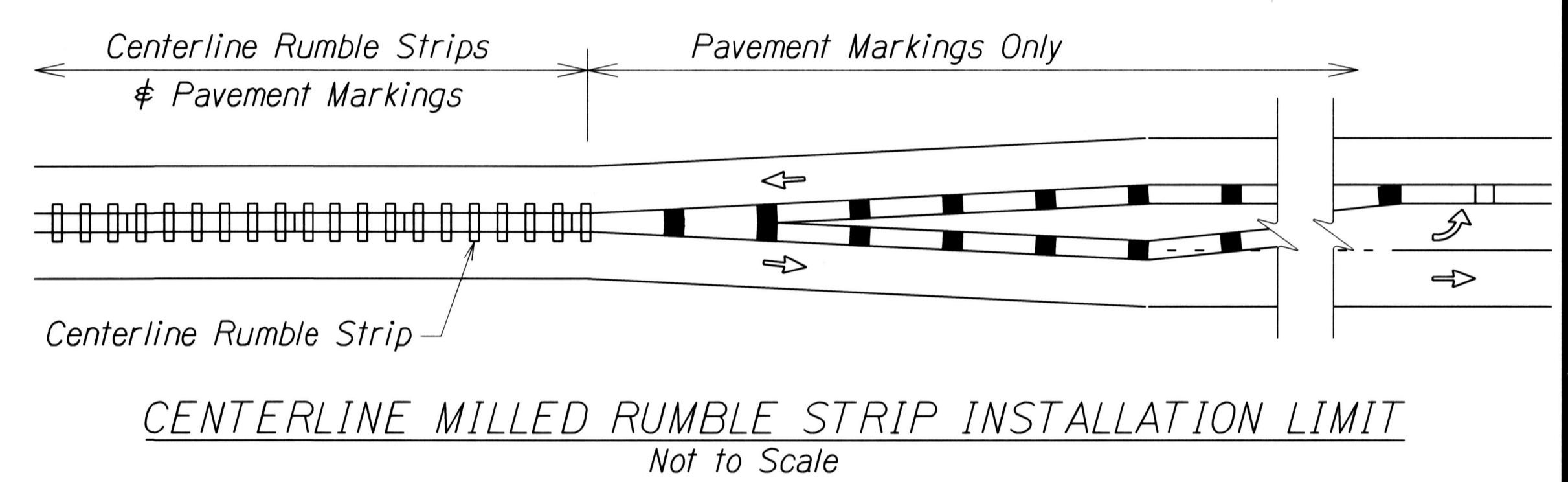
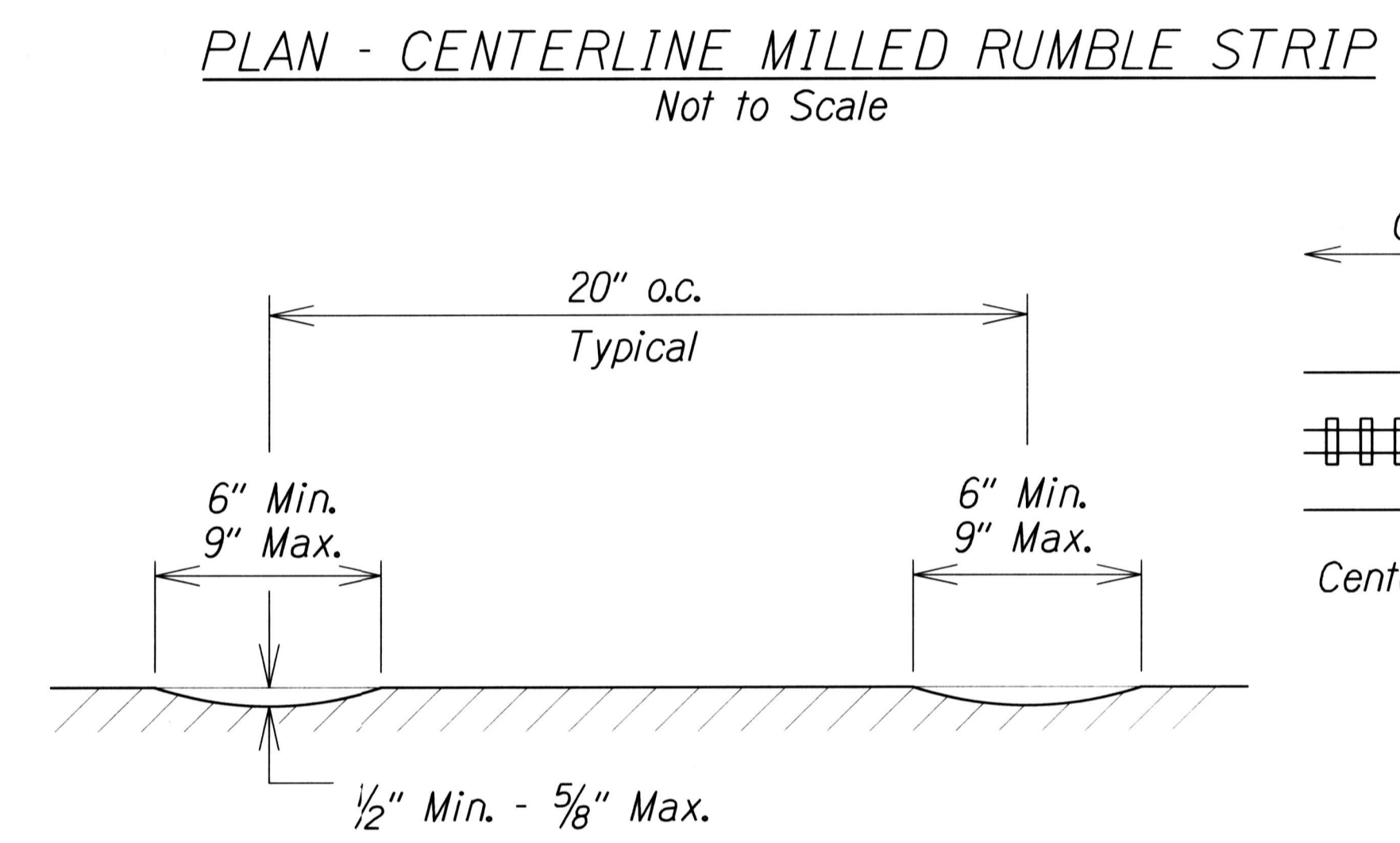
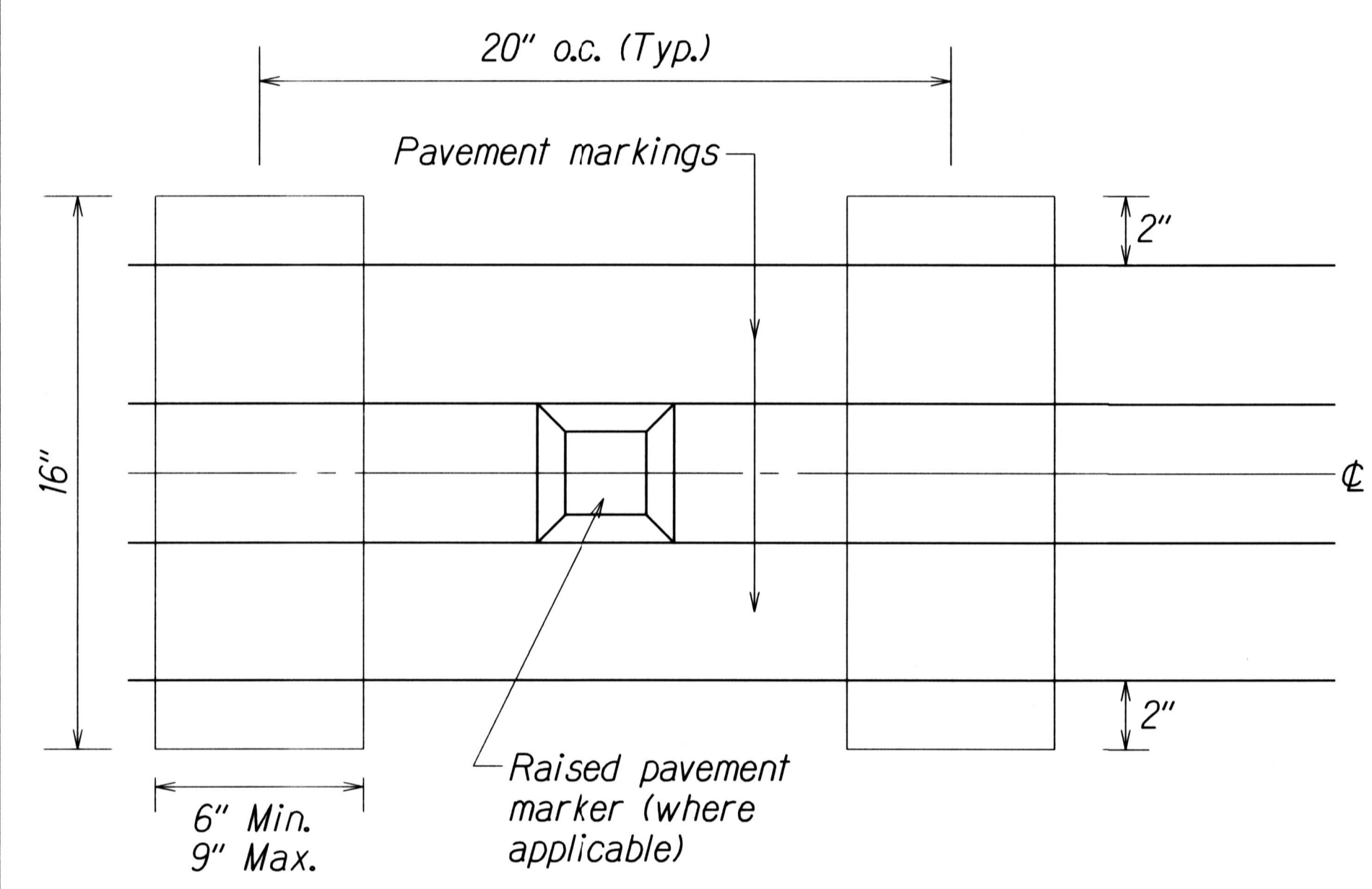
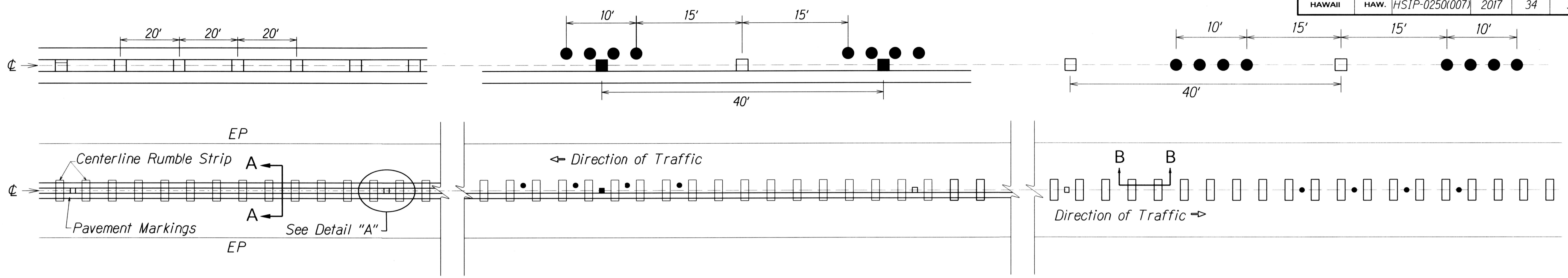

**NOTES:**

1. The method of constructing the centerline milled rumble strip shall be submitted to the Engineer for acceptance prior to the actual work.
2. Dimensions shown are approximate. Adjust rumble strip spacing to coordinate with pavement markings prior to installation.
3. Raised pavement markers shall be installed on level surface between the rumble strips. Do not install raised pavement markers inside the milled area.
4. The construction of the centerline milled rumble strip shall be paid for under Item No. 615.0100 - 16-inch Milled Rumble Strip, Centerline.
5. The milling apparatus and removal of existing pavement markings will not be paid for separately and shall be considered incidental to Item 615.0100 - 16-Inch Milled Rumble Strip, Centerline.
6. Do not install centerline rumble strips on bridge decks.
7. Where at-grade bridges are present, rumble strips shall end/begin 20 L.F. beyond the existing bridge deck joints/concrete approach slab.
8. Hot spray thermoplastic shall be used for solid line markings within the milled centerline rumble strip area.

ORIGINAL PLAN	SURVEY PLOTTED BY	DATE
NOTE BOOK	DESIGNED BY	
	QUANTITIES BY	
	CHECKED BY	

STATE OF HAWAII  
DEPARTMENT OF TRANSPORTATION  
HIGHWAYS DIVISION  
**CENTERLINE MILLED RUMBLE STRIP DETAIL**  
KOHALA MOUNTAIN ROAD  
Safety Improvements  
Federal Aid Project No. HSIP-0250(007)  
Scale: As Shown Date: March 2017  
SHEET No. T10 OF 11 SHEETS

FED. ROAD DIST. NO.	STATE	FED. AID PROJ. NO.	FISCAL YEAR	SHEET NO.	TOTAL SHEETS
HAWAII	HAW.	HSIP-0250(007)	2017	35	35

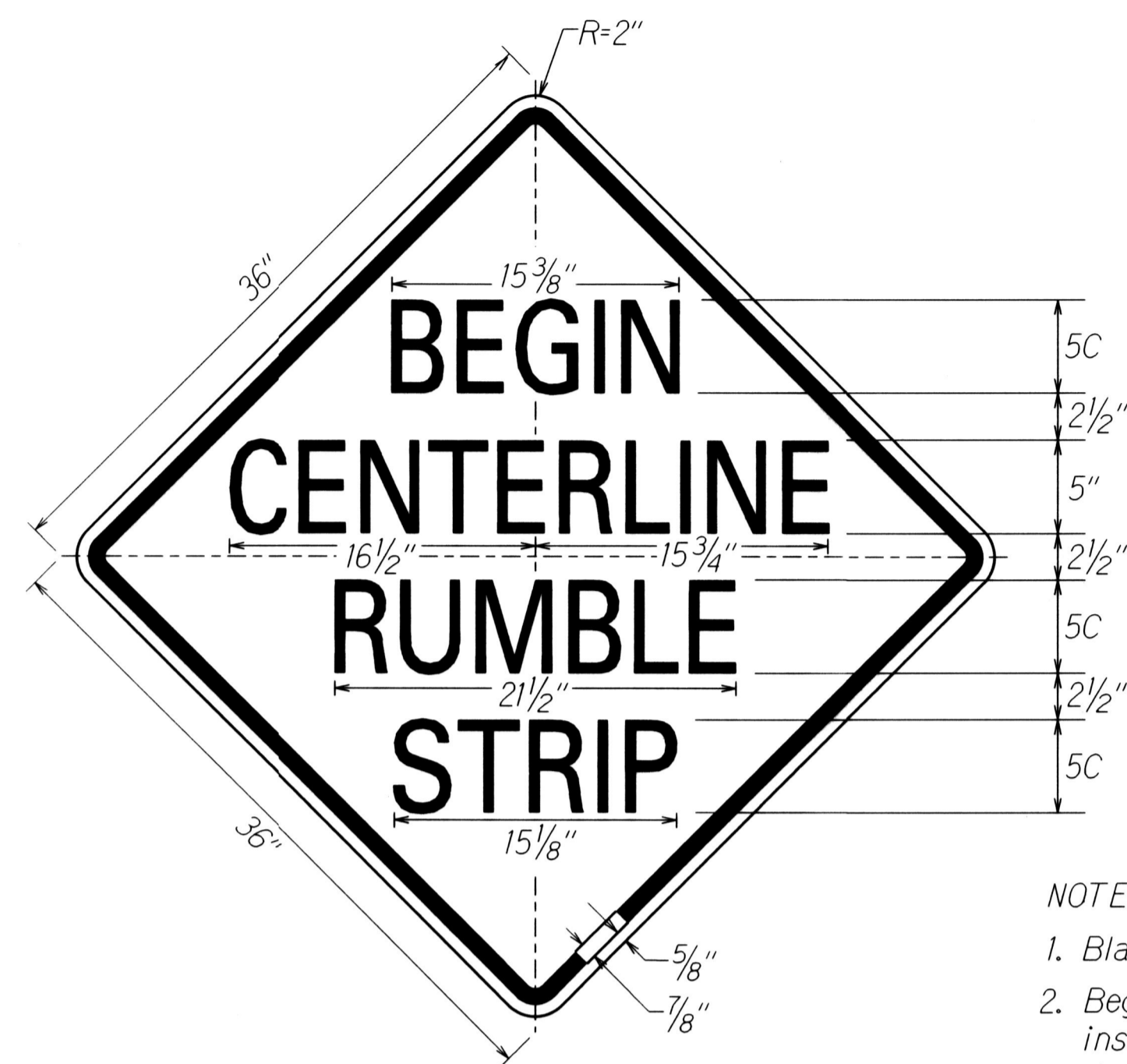

W8-14a

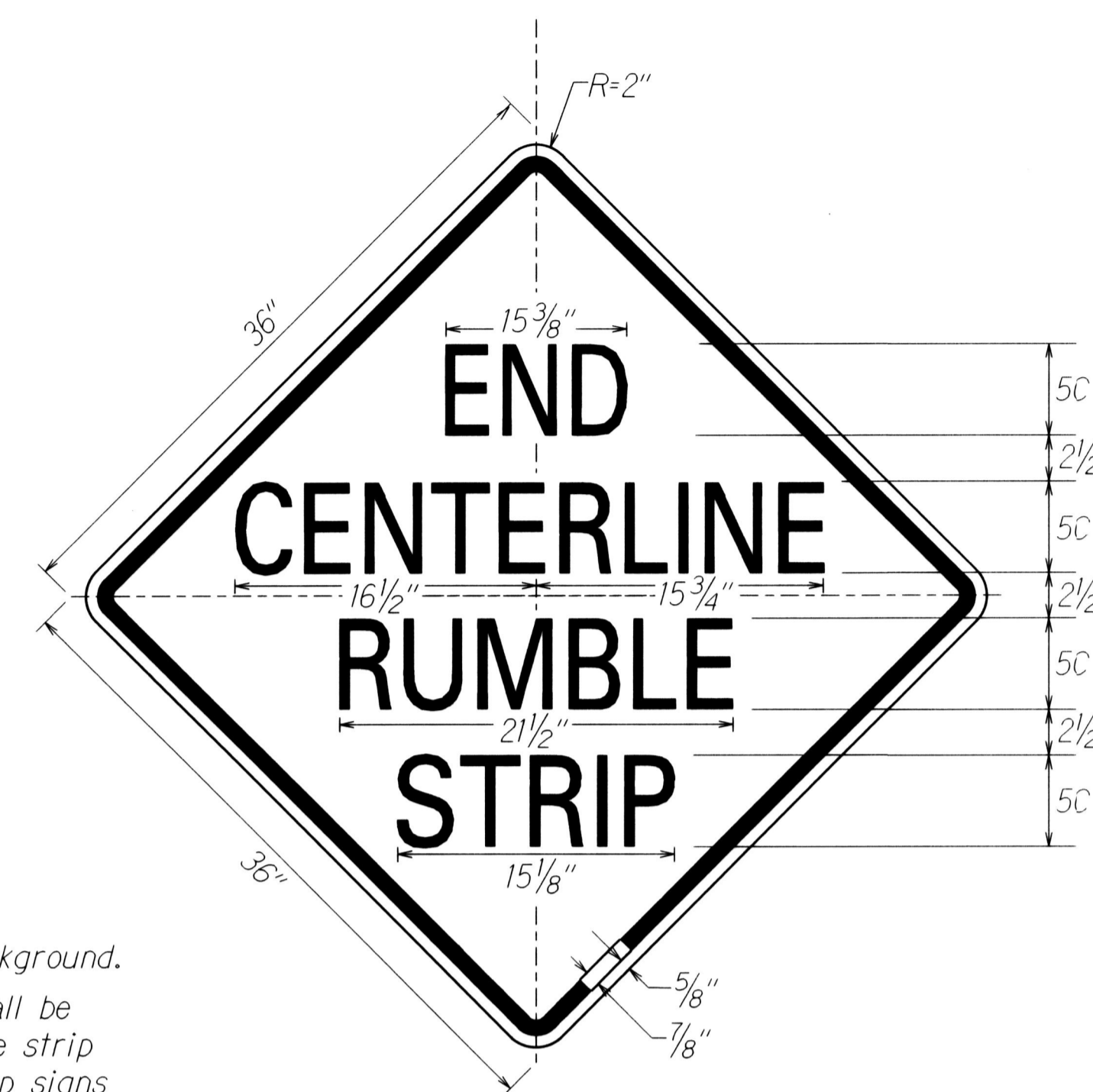

W8-14b

NOTE:

1. Black legend on reflectorized yellow background.
2. Begin Centerline Rumble Strip signs shall be installed 50 feet before the first rumble strip depression. End Centerline Rumble Strip signs shall be installed 50 feet beyond the last rumble strip depression.

SIGN NOTES

1. All signs shall conform to Section 621 of the Special Provisions and the latest editions and amendments of the following FHWA publications:
  - a. "Manual on Uniform Traffic Control Devices for Streets and Highways" (MUTCD)
  - b. "Standard Highway Signs"
  - c. "Standard Alphabets for Highway Signs"
2. Borders, messages, arrows, symbols and shield shall conform to details as shown on the plans and as specified in the MUTCD.
3. Sign messages shall be as indicated on the plan, or as directed by the Engineer.
4. Backing for all new Regulatory and Warning Signs shall not be spliced.
5. Final locations of all signs shall be accepted by the Engineer prior to any installation work.
6. Existing signs that are to be replaced, shall not be removed until new signs are installed as replacements, or the messages are no longer necessary.
7. Existing signs not shown on these plans shall remain as posted unless otherwise directed by the Engineer. Removal and disposal of existing signs and/or posts as designated on these plans shall be incidental to the various signing items.
8. All signs shall be installed on square tube posts, unless otherwise noted.
9. For centerline rumble strip sign (Shown on this sheet) each sign post shall have a Type II OM. Installation of Type II OM shall be considered incidental to sign items.
10. For all other new sign installations with post(s), each sign post shall have an RM-3 reflector marker. Installation of RM-3 shall be considered incidental to Sign Items.
11. Contractor shall mark the back of all signs using labels. Payment to be incidental to various contract items.

ORIGINAL PLAN	DATE
SURVEY PLOTTED BY	
DESIGNED BY	
QUANTITIES BY	
CHECKED BY	

STATE OF HAWAII  
DEPARTMENT OF TRANSPORTATION  
HIGHWAYS DIVISION

**CENTERLINE RUMBLE STRIP**  
**SIGN DETAILS AND NOTES**

KOHALA MOUNTAIN ROAD  
Safety Improvements  
Federal Aid Project No. HSIP-0250(007)

Scale: As Shown      Date: March 2017

SHEET No. 11 OF 11 SHEETS