

FED. ROAD DIST. NO.	STATE	FED. AID PROJ. NO.	FISCAL YEAR	SHEET NO.	TOTAL SHEETS
HAWAII	HAW.	STP-250(006)	2011	20	20

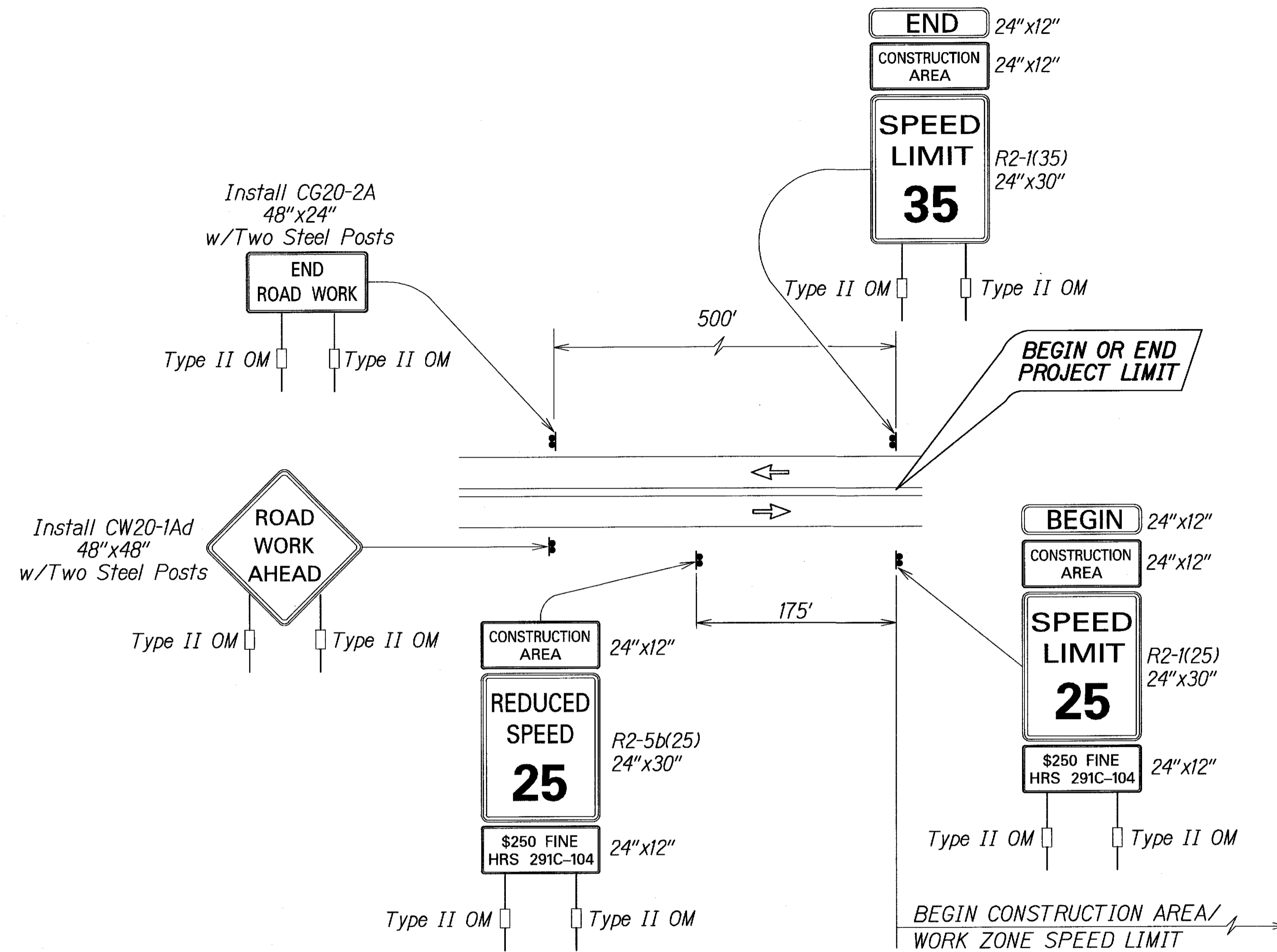

TYPICAL DETAIL FOR CONSTRUCTION SIGNS ON TWO LANE LOW SPEED HIGHWAY

Work Zone Note:

1. This Work Zone Sign Plan is intended for use on long-term stationary work zones/construction phases (3 days or more). All work zones or construction phases less than 3 days duration will use Traffic Control Plans shown in Section 645.
2. All existing regulatory speed limit signs with posts within the work zone/project limits shall be covered. Work zone speed limit sign assemblies (R2-1(25) and R2-5b(25) with "CONSTRUCTION AREA" and "\$250 FINE HRS 291C-104" Supplemental Signs) shall be Temporarily installed within work zone/project limits.
3. Construction sign assemblies shall be installed on both the approaching and trailing ends of each work zone as shown on this plan.
4. Each construction warning sign shall have a minimum of two (2) Type II OM. Each work zone speed limit assembly shall have a minimum of one (1) Type II OM. Installation of each Type II OM shall be considered incidental to Item No. 621.7100, Construction Sign with Posts.
5. Upon the completion of all physical work or as directed by the Engineer, all construction signs and work zone speed limit assemblies shall be removed. All speed limit signs and posts that were existing at the start of the project within the work zone/project limits shall be uncovered back to their original configurations.
6. Placement of construction signs shall not obstruct the path of pedestrians and bicyclists.
7. The installation, maintenance and removal of work zone speed limit sign assemblies shall be considered incidental to Item No. 621.7100, Construction Sign with Posts.

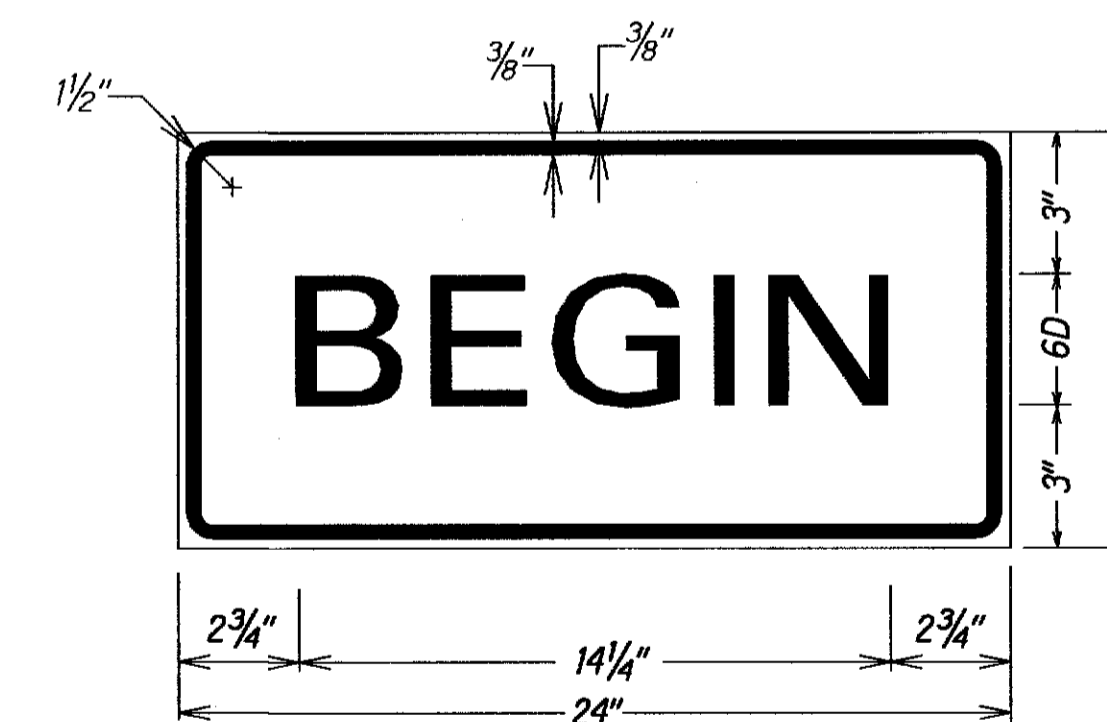

LEGEND: BLACK  
BACKGROUND: ORANGE

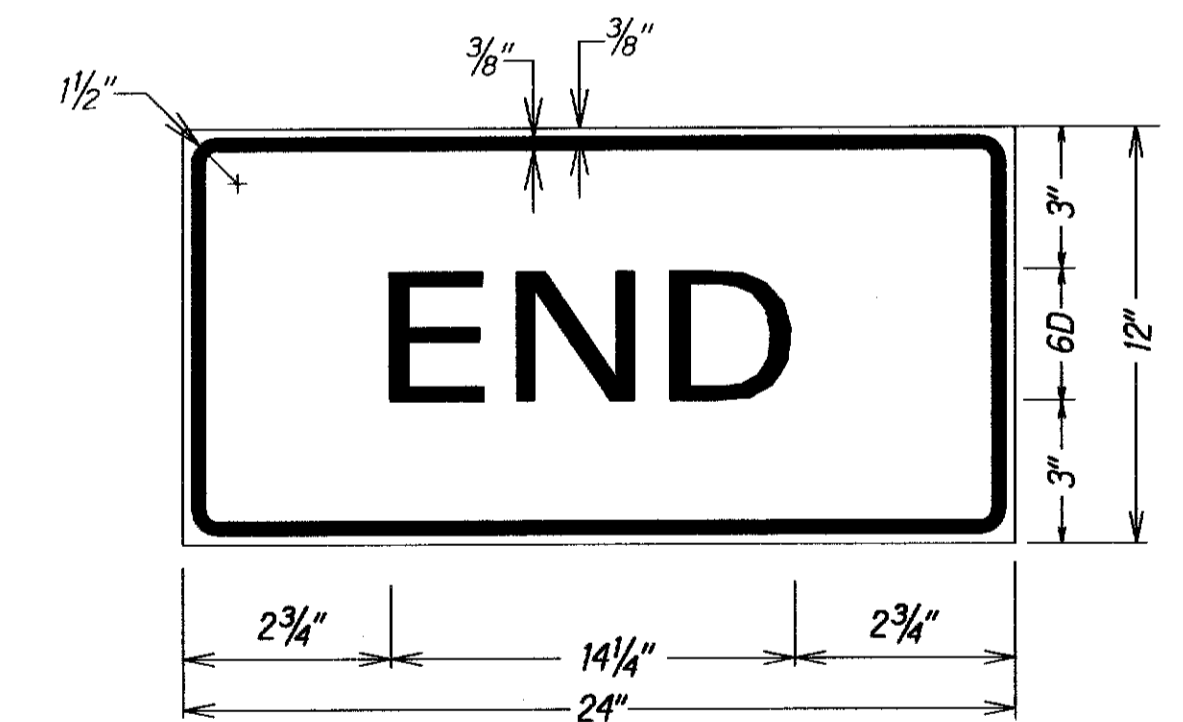

LEGEND: BLACK  
BACKGROUND: ORANGE

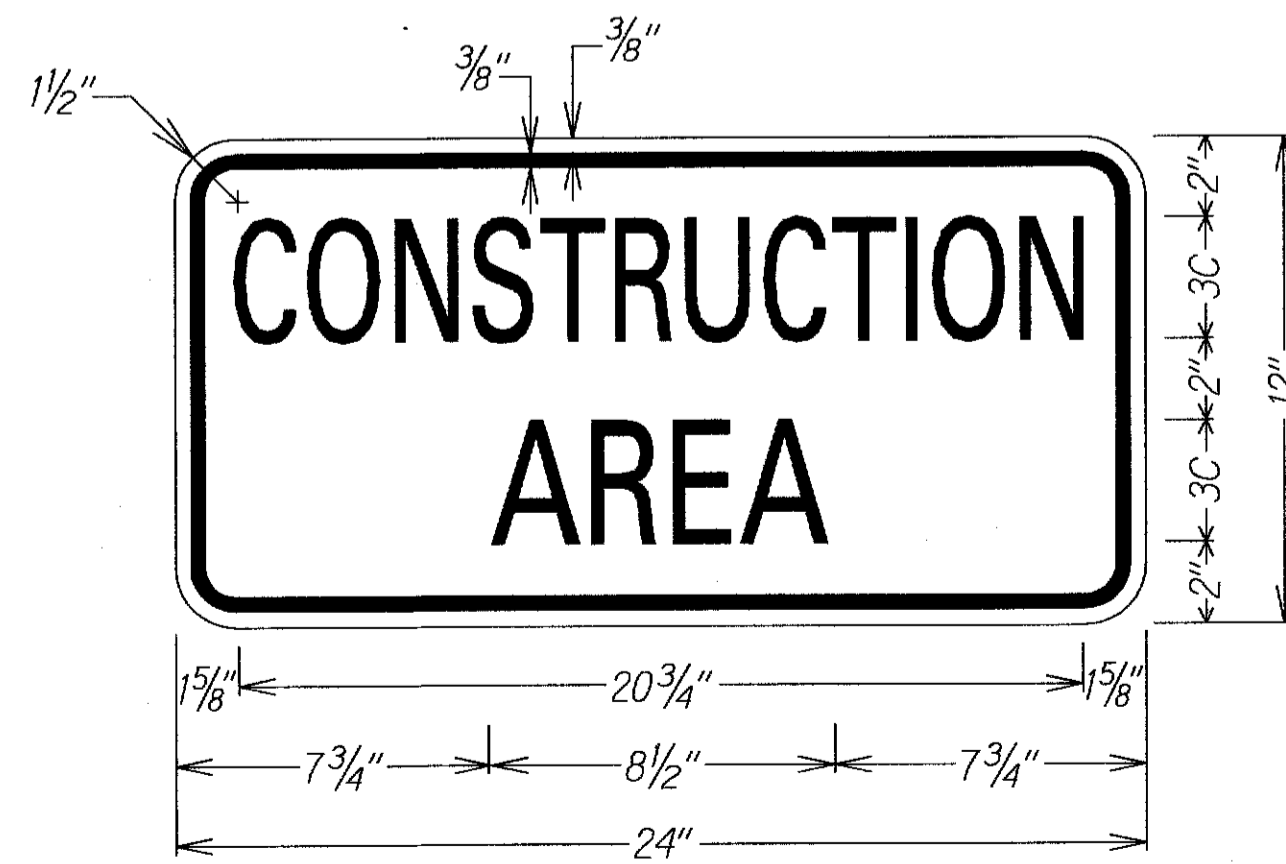

LEGEND: BLACK  
BACKGROUND: ORANGE

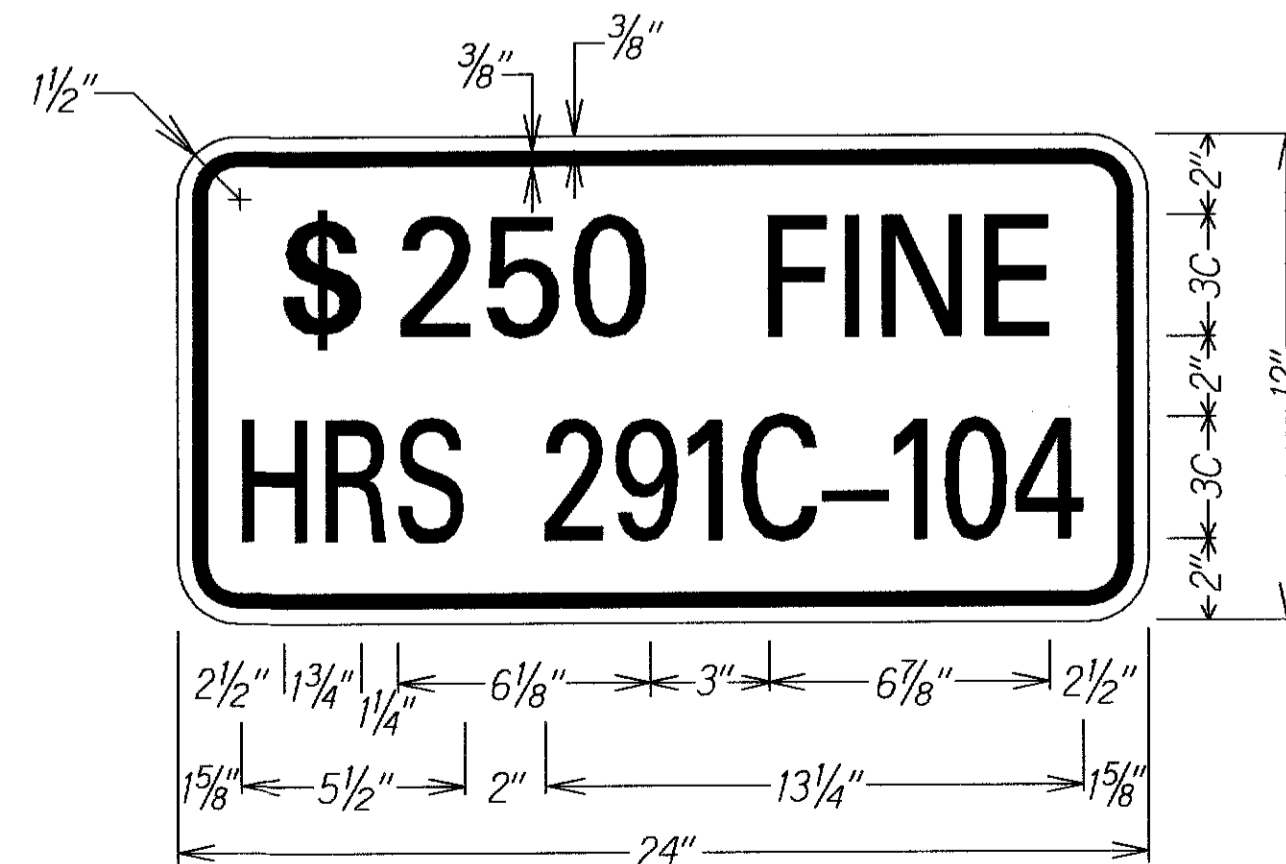

LEGEND: BLACK  
BACKGROUND: WHITE

LEGEND FOR AS-BUILT POSTINGS	
	Squiggly line for as-built deletion
	Double line for as-built deletion
	Text for as-built posting

DATE	_____
SURVEY PLOTTED BY	_____
DRAWN BY	_____
DESIGNED BY	_____
QUANTITIES BY	_____
CHECKED BY	_____
ORIGINAL PLAN	_____
NOTE BOOK	_____
FILE NO.	_____
DATE	_____

STATE OF HAWAII  
DEPARTMENT OF TRANSPORTATION  
HIGHWAYS DIVISION

**LOW SPEED UNDIVIDED HIGHWAY  
WORK ZONE SIGNING PLAN, NOTES & DETAILS**

KOHALA MOUNTAIN ROAD  
PAVEMENT PREVENTIVE MAINTANANCE  
WAIAKA JUNCTION TOWARD HAWI  
Federal Aid Project No. STP-250(006)

Date: April, 2011