

12/15/2014 4:15:57 PM W:_Civil\3D Projects\2014_027.001 ATKINS Saddle Road West Side Truck Escape Ramps\Roadway\Sheets\W-635\HI SR 20000_ TTC plan-03.dgn

DESCRIPTION OF WORK:

- Install street lighting, signing and rumble strips at the intersection of Mamalahoa Hwy and Daniel K. Inouye Hwy.
- For shoulder work, apply Temporary Traffic Control Standard 635-10 (Shoulder Closure).
- For rumble strip work, apply MUTCD Temporary Traffic Control Plan TA-32 for short term situations (See Special 635-B).
- Apply advanced signing per Standard 635-1.



STATE	PROJECT	SHEET NO.	TOTAL SHEETS
HI	HI A-AD 6(8)	W3	W8

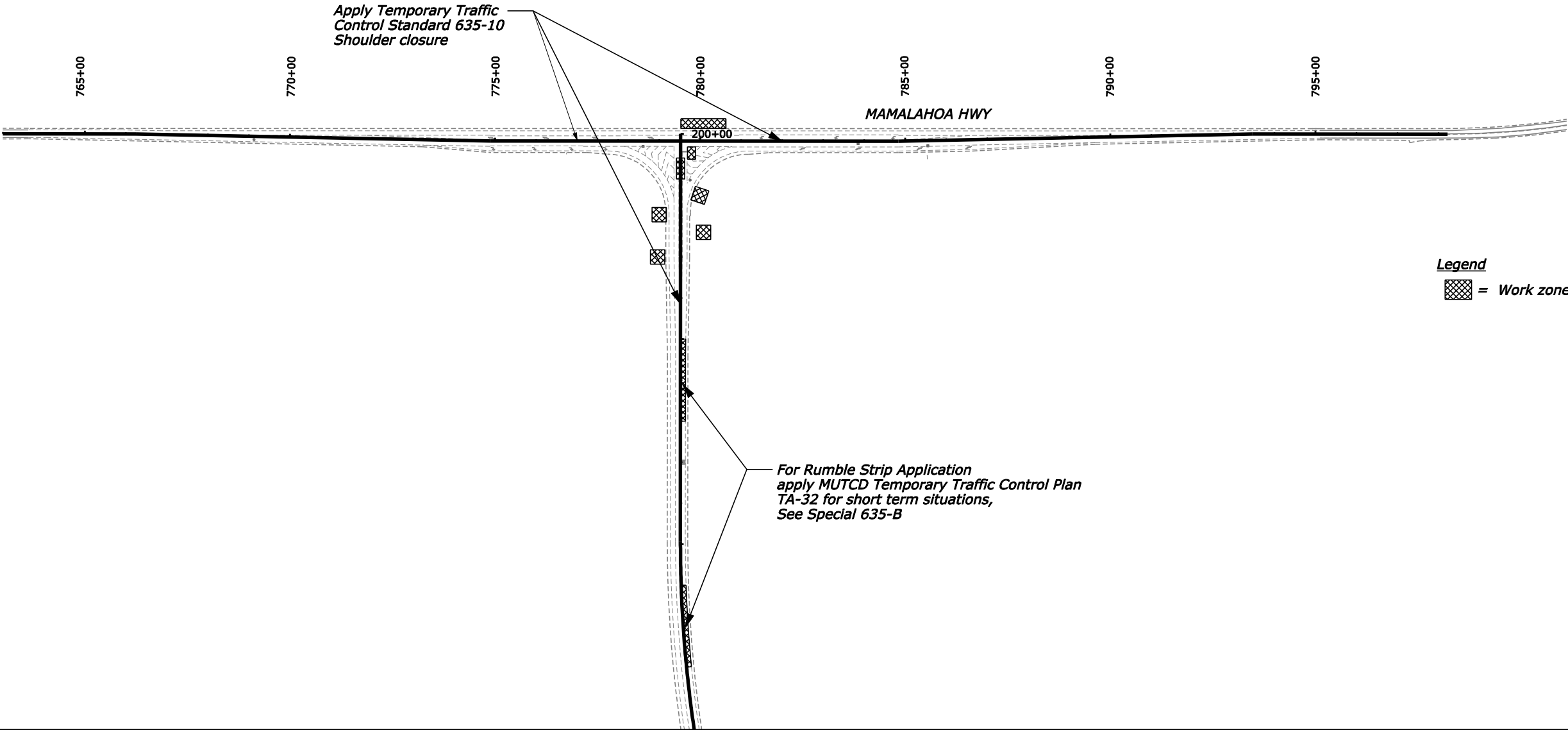

Legend

 = Work zone

NOTES:

1. During construction, access shall be maintained at all times to areas of Daniel K. Inouye Hwy that serve recreational areas, including hunting units.
2. Construction vehicles shall be provided access to pass through construction zones without delays and unimpeded access to roadside facilities at all times.
3. Project construction shall include provisions for pedestrian and bicycle crossings of Saddle Road during construction periods.
4. See section 156 - Public Traffic for information on maintaining roadways.

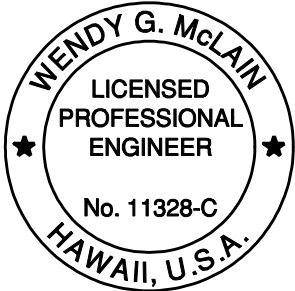

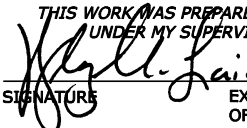
THIS WORK WAS PREPARED BY ME OR UNDER MY SUPERVISION.

SIGNATURE 4/30/2016
EXPIRATION DATE OF THE LICENSE

U.S. DEPARTMENT OF TRANSPORTATION
FEDERAL HIGHWAY ADMINISTRATION
CENTRAL FEDERAL LANDS HIGHWAY DIVISION

HWY 190 (MAMALAHOA HWY)
TEMPORARY
TRAFFIC CONTROL PLAN