

STATE	PROJECT	SHEET NO.	TOTAL SHEETS
HI	HI A-AD 6(5)	A5	A16

Notes:

- Construction access roads are located near proposed milepost 38.5 (Ahi Road Access), proposed milepost 37 (Makai Road Access) and proposed milepost 34 (State Park Access).
- Finished subgrade from Sta. 17+00 to 353+00 for this project was completed under projects HI A-AD 6(1), 6(2), 6(3), & 6(4).

TRUE NORTH
SCALE: 1" = 2500'

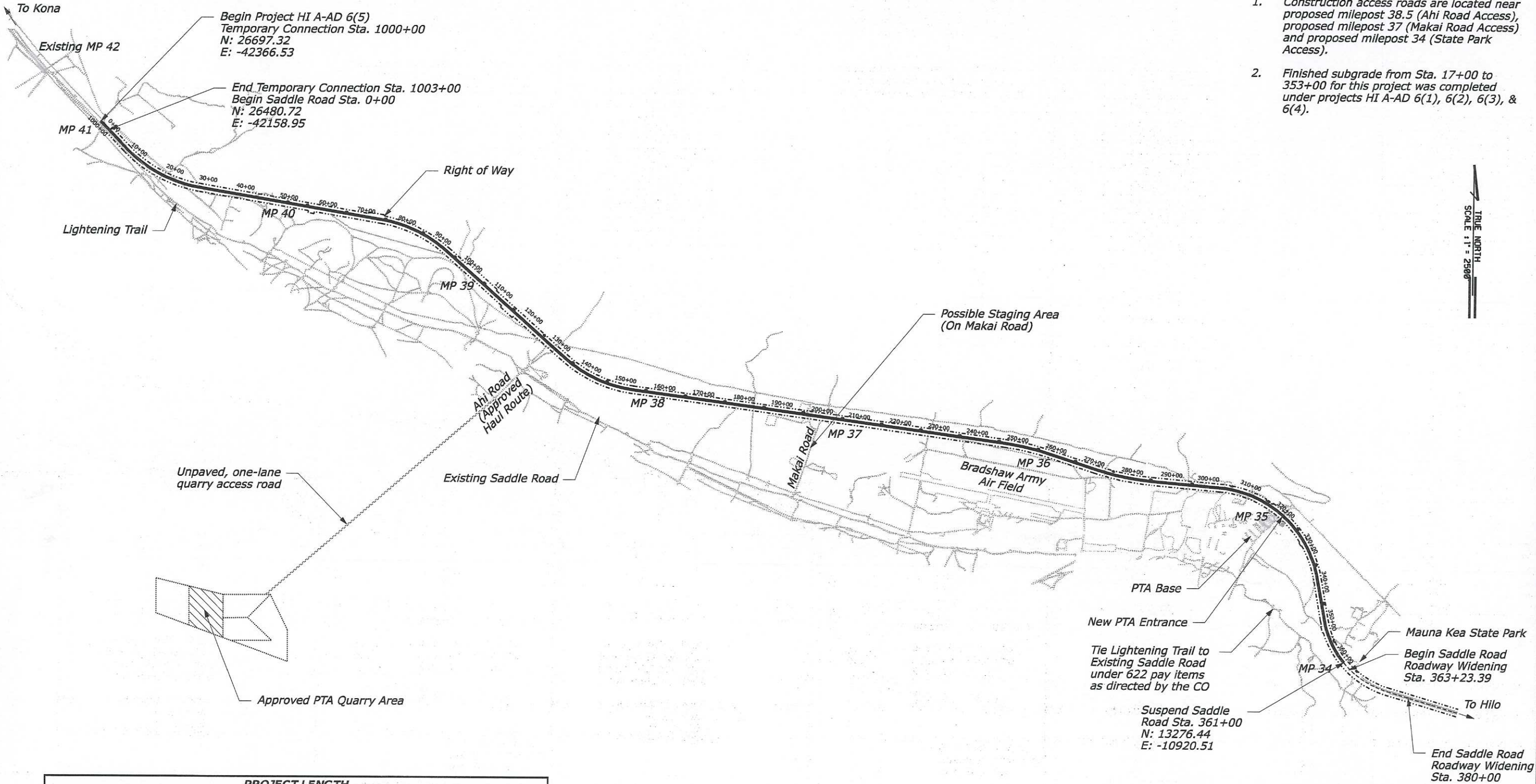

PROJECT LENGTH				
Begin Station	End Station	Length Feet	Length Miles	Type of Construction
1000+00	1003+00	300	0.06	Grading & Temporary Pavement
00+00	17+00	1700	0.32	Grading & Pavement
17+00	353+00	33600	6.36	Road Reconditioning & Pavement
353+00	361+00	800	0.15	Grading & Pavement
363+23.39	380+00	1676.61	0.32	Roadway Widening & Pavement

U.S. DEPARTMENT OF TRANSPORTATION
FEDERAL HIGHWAY ADMINISTRATION
CENTRAL FEDERAL LANDS HIGHWAY DIVISION

OVERALL SITE PLAN

Scale: 1"=2500' Date: July 21, 2008