

STATE	PROJECT	SHEET NO.	TOTAL SHEETS
HI	HI A-AD 6(7)	E17	E17

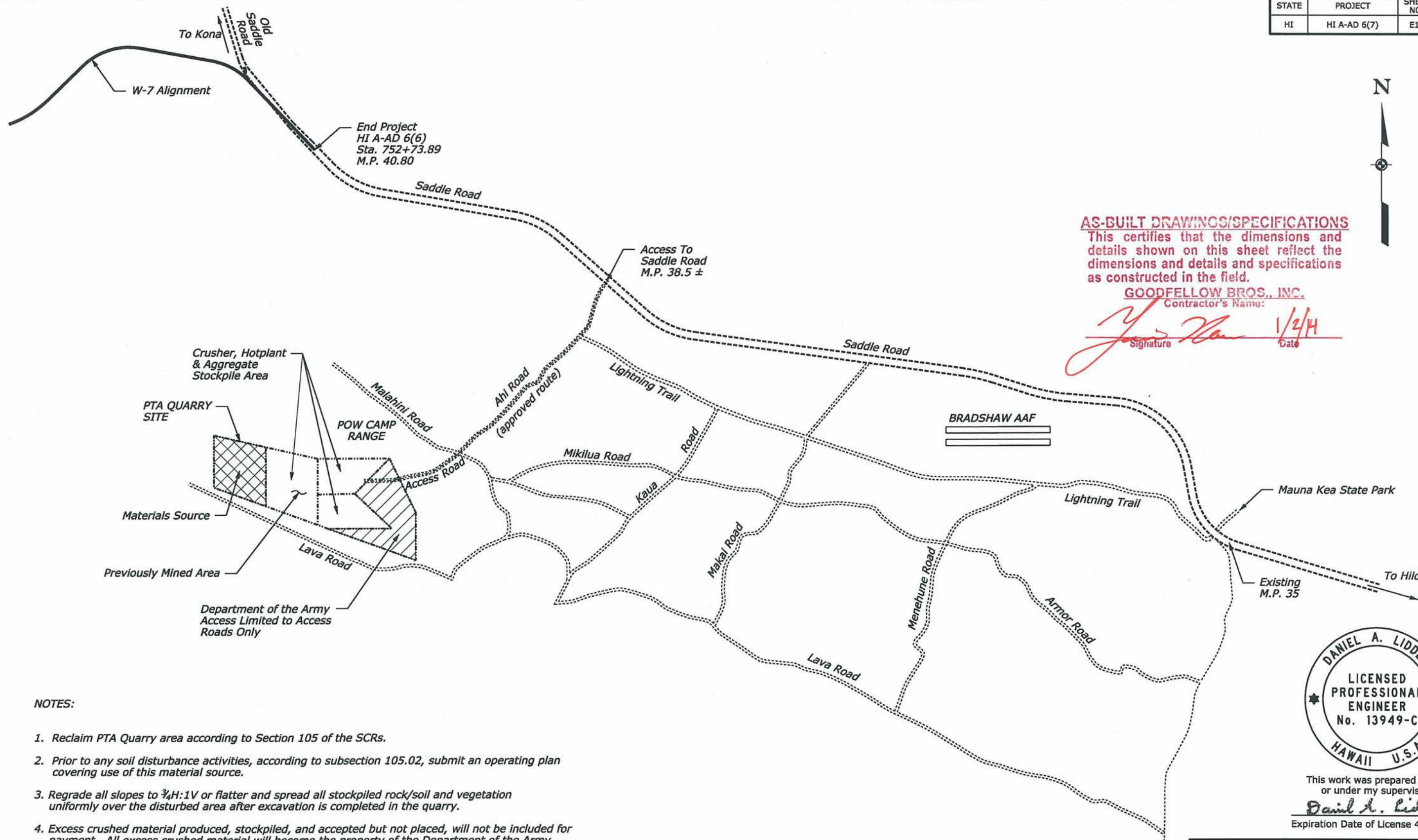

**AS-BUILT DRAWINGS/SPECIFICATIONS**  
This certifies that the dimensions and details shown on this sheet reflect the dimensions and details and specifications as constructed in the field.

**GOODFELLOW BROS., INC.**  
Contractor's Name:

*[Signature]* *1/2/14*  
Signature Date

# NOTES:

1. Reclaim PTA Quarry area according to Section 105 of the SCRs.
2. Prior to any soil disturbance activities, according to subsection 105.02, submit an operating plan covering use of this material source.
3. Regrade all slopes to 3/4H:1V or flatter and spread all stockpiled rock/soil and vegetation uniformly over the disturbed area after excavation is completed in the quarry.
4. Excess crushed material produced, stockpiled, and accepted but not placed, will not be included for payment. All excess crushed material will become the property of the Department of the Army.
5. No payment will be made for any work required for the use and reclamation of this material source it will be considered subsidiary to pay items for material produced from this source.
6. Access roads for hauling is limited to Ahi Road only.
7. See "Materials Source Report" HI-A-AD 6(5) for quarry investigation data and material quality in quarry.

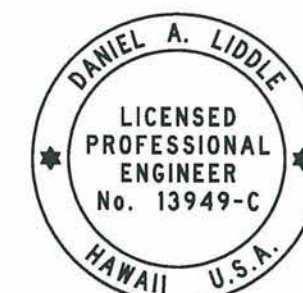

This work was prepared by me or under my supervision  
*Daniel A. Liddle*  
Expiration Date of License 4/30/2014

U.S. DEPARTMENT OF TRANSPORTATION  
FEDERAL HIGHWAY ADMINISTRATION  
CENTRAL FEDERAL LANDS HIGHWAY DIVISION

U.S. CUSTOMARY SPECIAL

## **PTA QUARRY SITE MAP & HAUL ROADS**

SPECIAL  
157-D

NO SCALE

S:\Tranpro\100013746-SR\HwyDes\Roadway\Sheets\_Bld\_Package\_21E-150\HI SR 200(00)\_sp157-D.dgn 11:05:01 AM 3/21/2012