

STATE	PROJECT	SHEET NO.	TOTAL SHEETS
HI	HI A-AD 6(6)	T1	T17

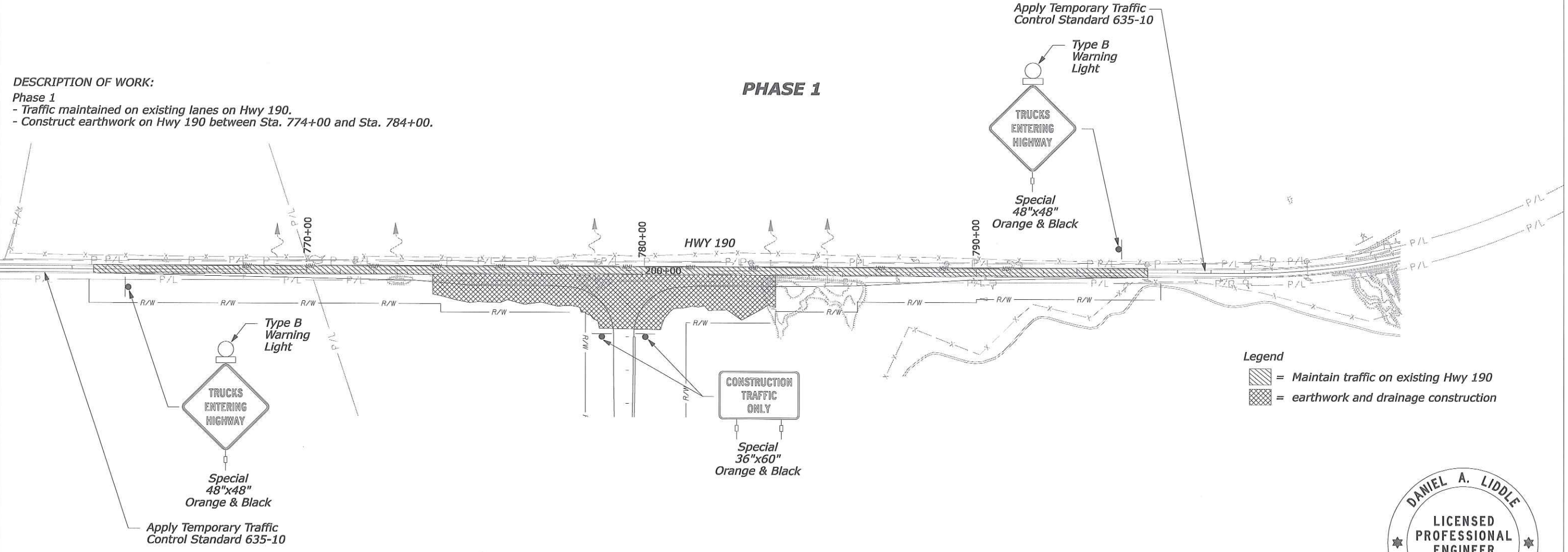

DESCRIPTION OF WORK:
Phase 1
- Traffic maintained on existing lanes on Hwy 190.
- Construct earthwork on Hwy 190 between Sta. 774+00 and Sta. 784+00.

PHASE 1



Legend
[Hatched Box] = Maintain traffic on existing Hwy 190
[Cross-hatched Box] = earthwork and drainage construction

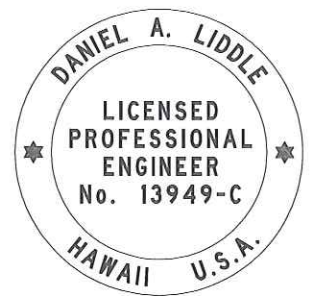

This work was prepared by me or under my supervision
Daniel A. Liddle
Expiration Date of License 4/30/2012

- NOTES:**
1. [Redacted]
 2. During construction, access [Redacted] maintained at all times to areas of Saddle Road that serve recreational areas, including hunting units.
 3. Construction vehicles [Redacted] provided access to pass through construction zones without delays and unimpeded access to roadside facilities at all times.
 4. Project construction [Redacted] include provisions for pedestrian and bicycle crossings of Saddle Road during construction periods.
 5. See section 156 - Public Traffic for information on maintaining roadways.

U.S. DEPARTMENT OF TRANSPORTATION
FEDERAL HIGHWAY ADMINISTRATION
CENTRAL FEDERAL LANDS HIGHWAY DIVISION

**HWY 190 (MAMALAHOA HWY)
TEMPORARY
TRAFFIC CONTROL PLAN**
SHEET 1 of 2

S:\Tranproj\100013746-SR\HwyDes\Roadwy\Sheets_Bld_Package_1\T-600\HI SR 200(00)_TTC plan-01.dgn
1:22:41 PM
5/12/2011

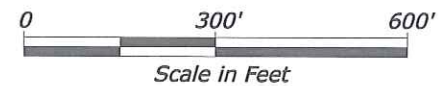

STATE	PROJECT	SHEET NO.	TOTAL SHEETS
HI	HI A-AD 6(6)	T2	T17

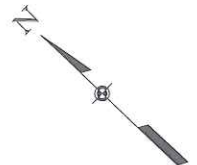

DESCRIPTION OF WORK:

Phase 1 was

- Traffic will be maintained on existing Saddle Road.
- Construct new alignment at full width to Sta. 707+00.
- Lightning Trail - No Work Beyond Sta. 707+00.

Maintain and Keep Open for Military.
Coordinate Temporary Closure During Construction With the Military.
Construct Construction Access to the Project From Old Saddle Road at Approx. Sta. 710+00. ~~was provided~~ a Traffic Control Plan and Schedule ~~was~~ was provided for Approval by the Contracting Officer a Minimum of 14 Days Prior to the Start of Any Work or Construction Traffic Affecting Lightning Trail.

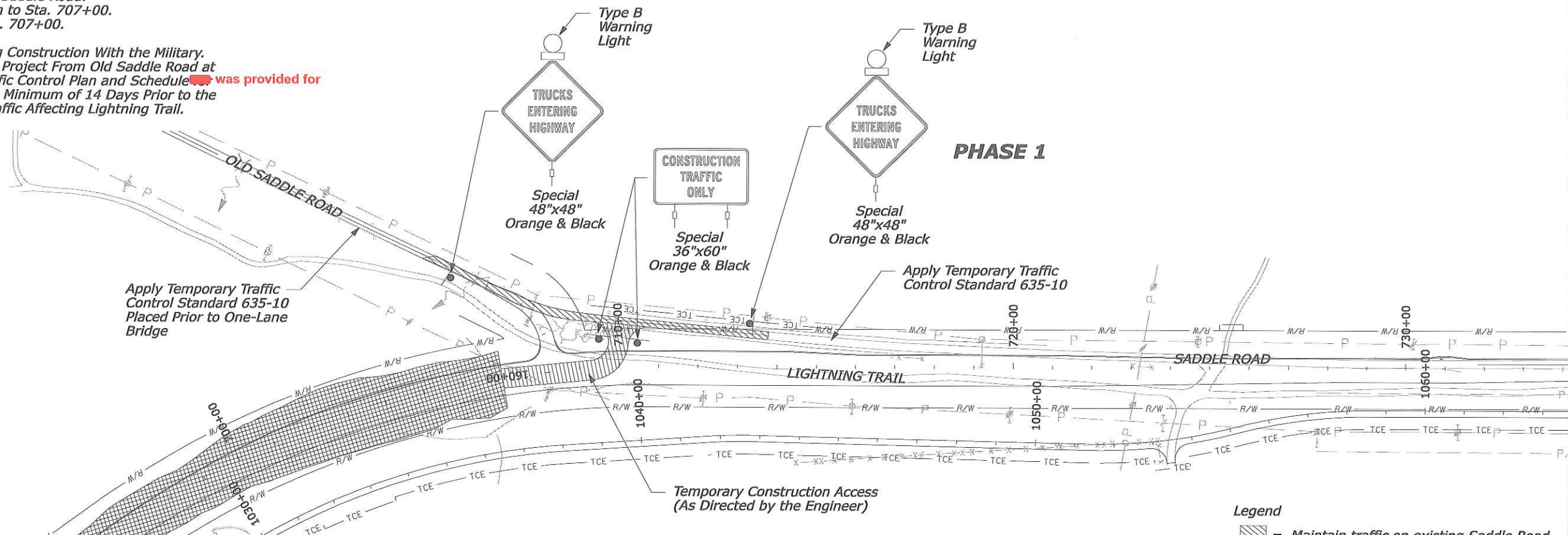

- Legend
- [Hatched Box] = Maintain traffic on existing Saddle Road
 - [Cross-hatched Box] = New roadway construction
 - [Diagonal-hatched Box] = Temporary Construction Access

- NOTES:
1. During construction, access ~~was~~ maintained at all times to areas of Saddle Road that serve recreational areas, including hunting units.
 2. Construction vehicles ~~provided~~ provided access to pass through construction zones without delays and unimpeded access to roadside facilities at all times.
 3. Project construction ~~include~~ include provisions for pedestrian and bicycle crossings of Saddle Road during construction periods.
 4. See section 156 - Public Traffic for information on maintaining roadways.
 5. Maintain traffic on existing Saddle Road through the entire construction.
 6. Construct temporary construction access and gate at approximately Sta 710+00.
 7. Place construction fence between existing Saddle Road and construction areas.
 8. Coordinate utility relocations through the construction access located East of station 707+00.

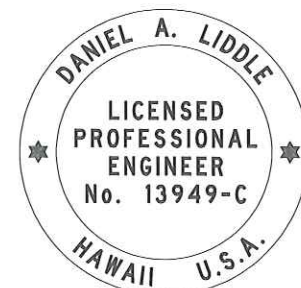

This work was prepared by me or under my supervision
Daniel A. Liddle
Expiration Date of License 4/30/2012

U.S. DEPARTMENT OF TRANSPORTATION
FEDERAL HIGHWAY ADMINISTRATION
CENTRAL FEDERAL LANDS HIGHWAY DIVISION

OLD SADDLE ROAD
TEMPORARY
TRAFFIC CONTROL PLAN
SHEET 2 of 2