



CW20-1Ad
48"x48"



CW20-1
(1 MILE)
48"x48"



CW20-1a
48"x48"



CW20-2d
48"x48"



CW20-3b
48"x48"



CW20-4d
48"x48"



CW20-5d(L)
48"x48"



500 FEET
CW20-7a
36"x36"
24"x18"
CW20-7a-A
48"x48"
24"x18"



CW21-1
36"x36"
CW21-1-A
48"x48"



CW21-2
30"x30"



CW21-3
36"x36"



CW21-5
30"x30"
CW21-5-A
48"x48"



CW21-6
30"x30"



CW22-1b
48"x48"



CW22-2
48"x36"



CW22-3
42"x36"



CW8-8
36"x36"



CW23-2b
48"x48"



CW23-3(R)
48"x48"

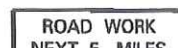

CG20-1A(5)
60"x24"

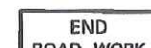

CG20-2A
48"x24"

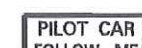

CG20-4
36"x18"



CM4-9(R)
30"x24"



CM4-10(R)
48"x18"



R9-8
36"x18"

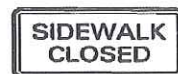

R9-9
24"x12"

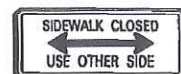

R9-10
24"x12"



R9-11
24"x12"



R9-11a
24"x12"

GENERAL NOTES *conformed*

1. Sign details *conformed* to the latest editions of FHWA publications "Manual on Uniform Traffic Control Devices for Streets and Highways", "Standard Alphabets for Highway Signs" and "Standard Highway Signs", and as amended.
2. All construction signs *are* reflectorized.
3. All construction signs *are* have 3/8" bolt holes drilled at appropriate locations.
4. Numerals in () indicate numerals to be inserted for sign message. (R) or (L) indicates right or left.
5. For "CW" series signs, suffixes a,b,c and d are as follows:
a-1500 Ft., b-1000 Ft., c-500 Ft. and d-AHEAD.

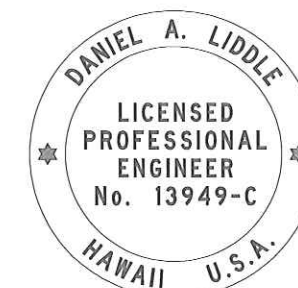

This work was prepared by me or under my supervision
Daniel A. Liddle
Expiration Date of License 4/30/2012



00/00/00	X	
DATE	REVISION	APP'D.

STANDARD PLAN TE-07 07/11/08

U.S. DEPARTMENT OF TRANSPORTATION
FEDERAL HIGHWAY ADMINISTRATION
CENTRAL FEDERAL LANDS HIGHWAY DIVISION

U.S. CUSTOMARY SPECIAL

**(HDOT STD TE-07)
CONSTRUCTION SIGNS**

SPECIAL
635-A

STATE	PROJECT	SHEET NO.	TOTAL SHEETS
HI	HI A-AD 6(6)	T16	T17

SADDLE ROAD REALIGNMENT PROJECT

MP 41 TO 42 ANTICIPATE DELAYS

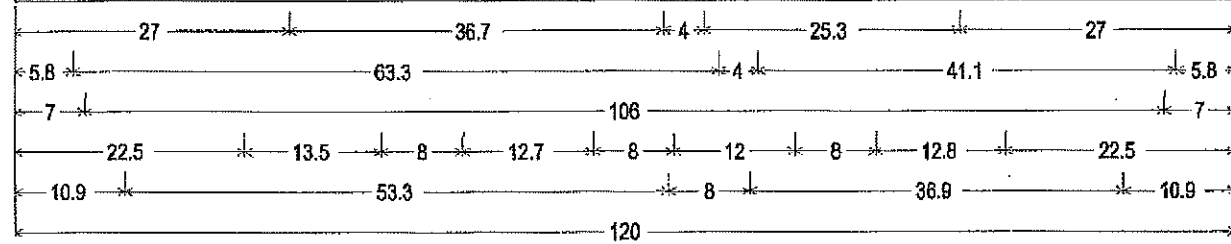

3.0' Radius, 1.3" Border, 0.8" Indent, Black on Orange;
 [SADDLE ROAD] D 50) spacing; [REALIGNMENT PROJECT] D 50) spacing; [MP 11 TO 19] D;
 [ANTICIPATE DELAYS] D 50) spacing;

MAMALAHOA HIGHWAY WIDENING PROJECT

MP 13 TO 15 ANTICIPATE DELAYS

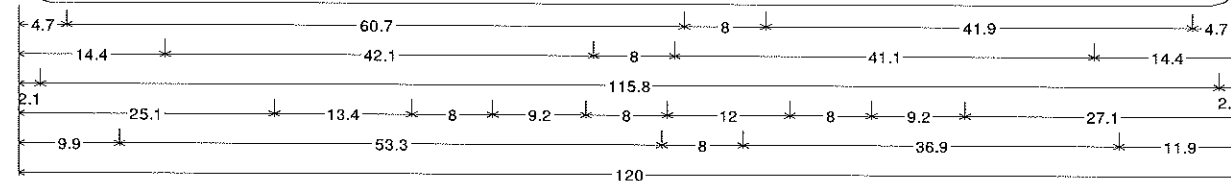

3.0' Radius, 1.3" Border, 0.8" Indent, Black on Orange;
 [MAMALAHOA HIGHWAY] D 50) spacing; [WIDENING PROJECT] D 50) spacing; [MP 13 TO 15] D; [ANTICIPATE DELAYS] D 50) spacing;

SADDLE ROAD REALIGNMENT PROJECT CONSTRUCTION SIGN

Note:
Confirm with CO before sign fabrication.

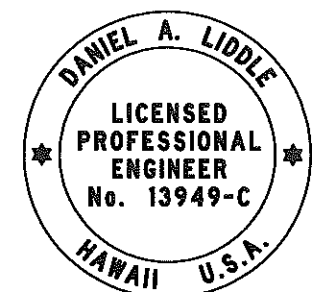

This work was prepared by me
or under my supervision
Daniel A. Liddle
Expiration Date of License 4/30/2012

U.S. DEPARTMENT OF TRANSPORTATION FEDERAL HIGHWAY ADMINISTRATION CENTRAL FEDERAL LANDS HIGHWAY DIVISION	
U.S. CUSTOMARY SPECIAL	
SADDLE ROAD CONSTRUCTION SIGN	
	SPECIAL 635-B

S:\Thompson\100013746-SR\HwyDes\Draw\Sheets_Bld_Package_11T-600\HI SR 200(00)_esp635-B.dgn 9:21:23 AM 5/7/2011

STATE	PROJECT	SHEET NO.	TOTAL SHEETS
HI	HI A-AD 6(6)	T17	T17

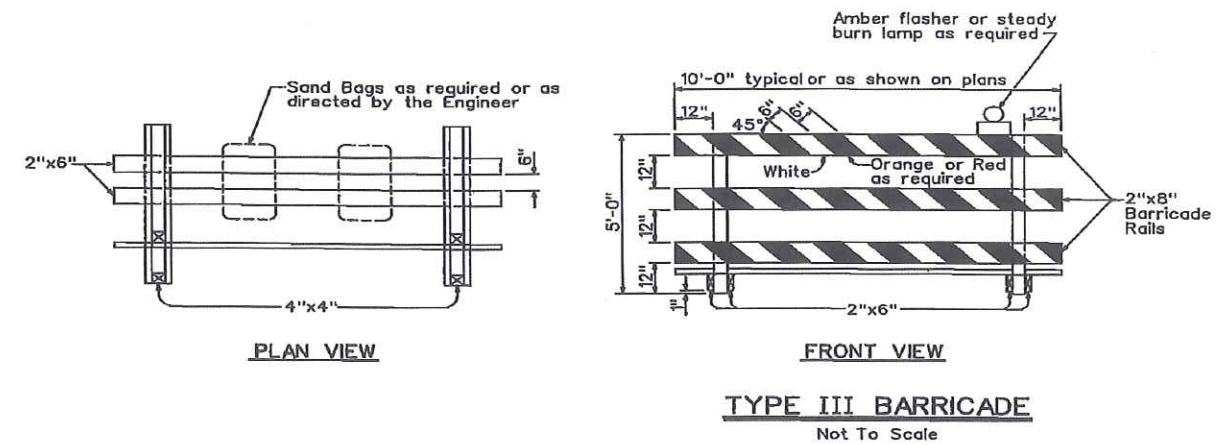
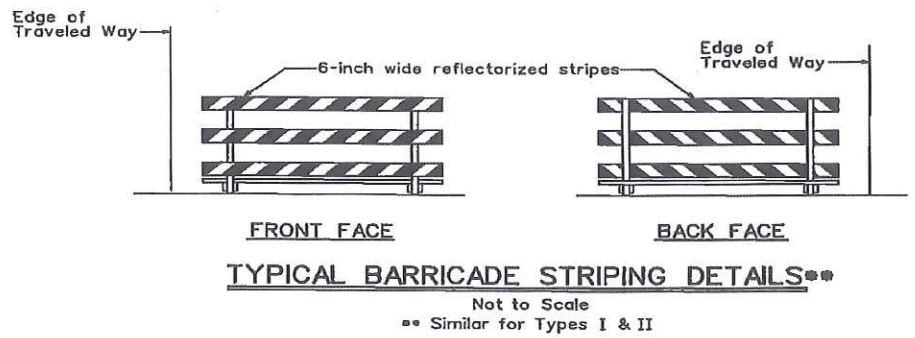
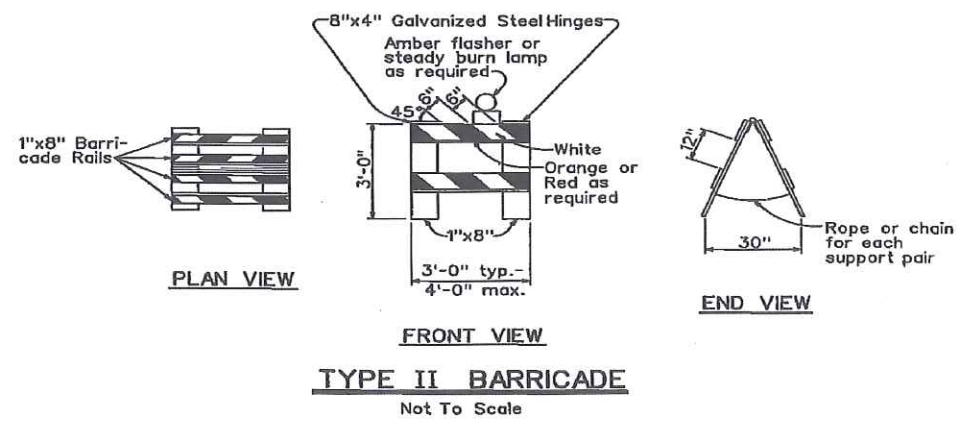
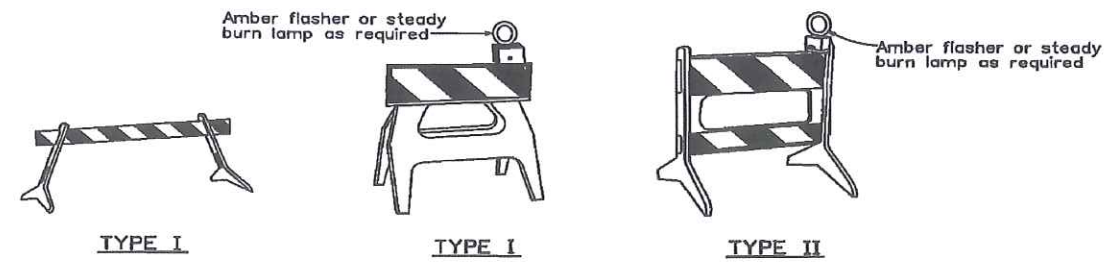
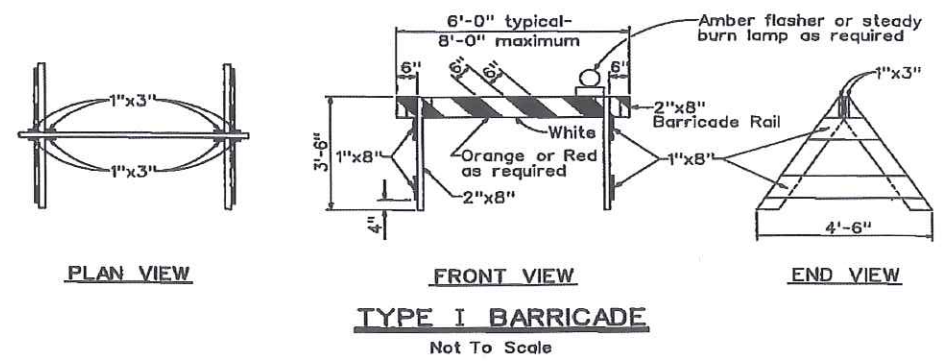

GENERAL NOTES

1. The front and back faces of each barricade rail ~~are~~ reflectorized with stripes sloping downward toward the same side (traveled way) of each barricade.
2. Contractor may submit alternate barricade designs for approval.
3. Sandbags or other approved weights ~~were not~~ placed on top of any striped rail.
4. The Contractor is directed to Section 645 - Work Zone Traffic Control.

DATE	REVISION	APP'D.
00/00/00	X	

STATE OF HAWAII
DEPARTMENT OF TRANSPORTATION
HIGHWAYS DIVISION
STANDARD PLAN TE-45
BARRICADES

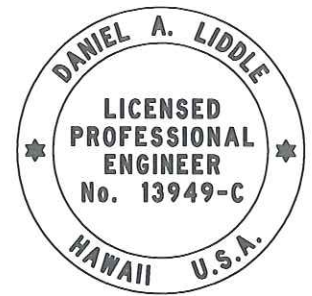

This work was prepared by me or under my supervision
Daniel A. Liddle
Expiration Date of License 4/30/2012

STANDARD PLAN TE-45 07/11/08

U.S. DEPARTMENT OF TRANSPORTATION
FEDERAL HIGHWAY ADMINISTRATION
CENTRAL FEDERAL LANDS HIGHWAY DIVISION
U.S. CUSTOMARY SPECIAL
(HDOT STD TE-45)
BARRICADES
SPECIAL
635-C

5/1/2011 11:44:32 AM S:\Transport\100013746-SR\HwyDes\Drawings\Sheets_Bld_Package_1\17-600\HI SR 200(00)_esp635-C.dgn