

STATE	SADDLE ROAD PROJECT	SHEET NO.	TOTAL SHEETS
HI	HI A-AD 6(4)	Q4	Q5



R4-1
24"x30"
R4-1-A
48"x60"



R4-2
24"x30"
R4-2-A
48"x60"



R11-2
48"x30"

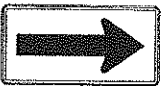

W1-6
48"x24"



W3-4
48"x48"



W5-1
36"x36"
W5-1-A
48"x48"



W8-12
48"x48"



W13-1(25)
18"x18"
W13-1(25)-A
24"x24"

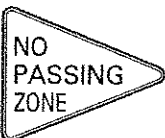

W14-3
36"x48"x48"
W14-3-A
48"x64"x64"



W20-1
48"x48"



W20-2
36"x36"



W20-3
36"x36"



W20-4
36"x36"



W20-5(L)
36"x36"



W20-7a
36"x36"
W16-2
24"x18"



W21-1
36"x36"



W21-1a
36"x36"



W21-2
30"x30"



W21-3
36"x36"



W21-5
30"x30"



W21-6
30"x30"



W22-1
48"x48"



W22-2
42"x36"



W22-3
42"x36"



W8-6
30"x30"

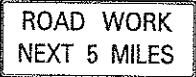

G20-1(5)
36"x18"

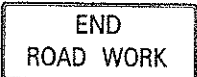

G20-2
36"x18"



G20-4
36"x18"



M4-9(R)
30"x24"



M4-10(R)
48"x18"

GENERAL NOTES

1. Sign details shall conform to the latest editions of FHWA publications "Manual on Uniform Traffic Control Devices for Streets and Highways," "Standard Alphabets for Highway Signs," and "Standard Highway Signs," and as amended.
2. All construction signs shall be reflectorized.
3. All construction signs shall have 3/8" bolt holes drilled at appropriate loactions.
4. Numerals in () indicate numerals to be inserted for sign message. (R) or (L) indicates right or left.
5. At the beginning of the project and at the end of the project, the Contractor erects advance construction warning signs as indicated on the plans or as directed by the Contracting Officer for the duration of the highway project and is maintained by the Contractor. These signs are placed in addition to the required traffic control signs called for in Section 635-Traffic Control. The advance construction warning signs are new and become the property of the State. The Contractor removes, cleans, and delivers the signs and posts to the Hilo District Baseyard or as directed by the Contracting Officer at the end of the project.

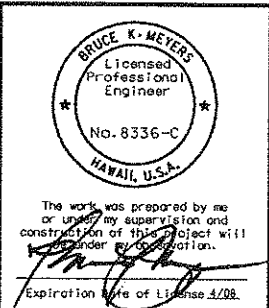

U.S. DEPARTMENT OF TRANSPORTATION FEDERAL HIGHWAY ADMINISTRATION CENTRAL FEDERAL LANDS HIGHWAY DIVISION	
SPECIAL 635 (HDOT STD TE-08)	
CONSTRUCTION SIGNS	
Scale: N.T.S.	Date: June 29, 2007
SHEET No. 1 OF 1	

STATE	SADDLE ROAD PROJECT	SHEET NO.	TOTAL SHEETS
HI	HI A-AD 6(4)	Q5	Q5

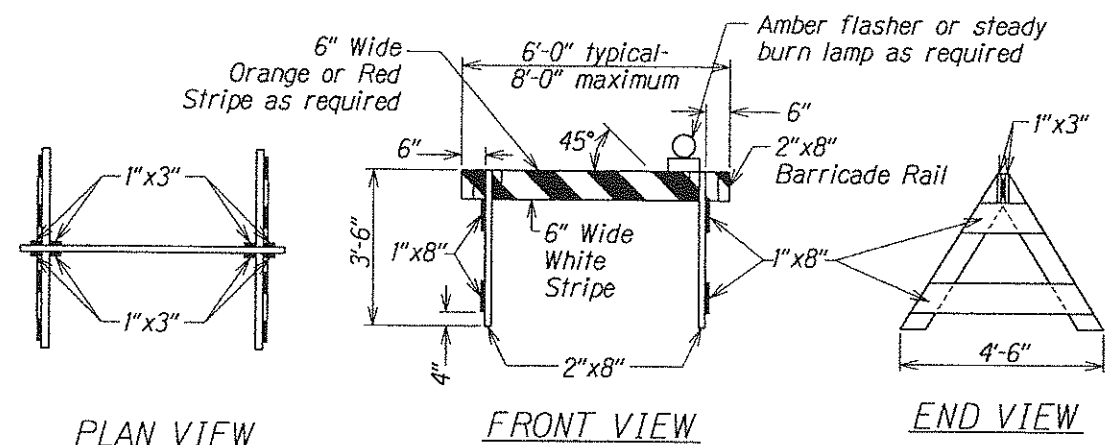

TYPE I BARRICADE
Not to Scale

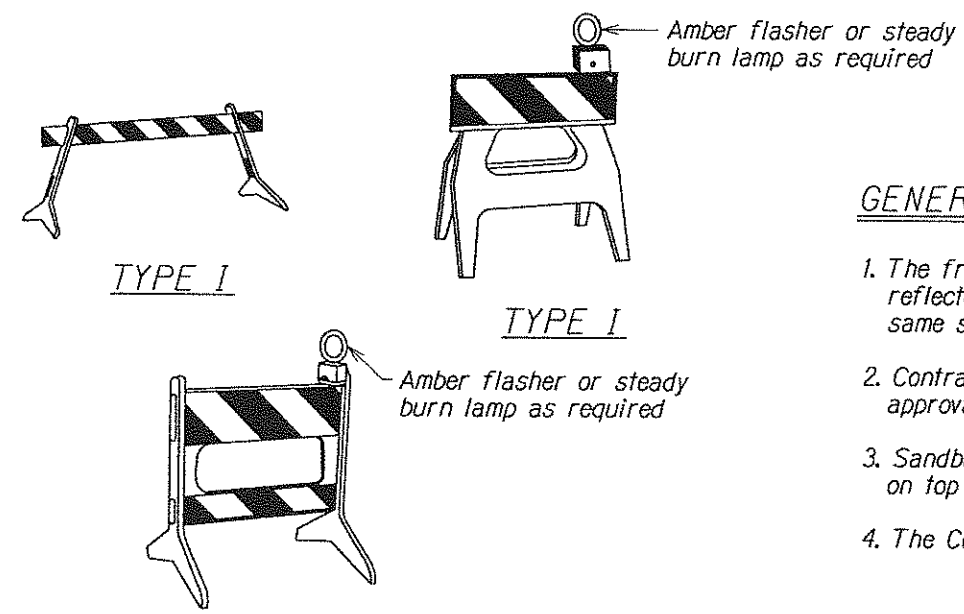

TYPE II
PLASTIC MOLDED BARRICADE OPTIONS*
Not to Scale
* Shop Drawings must be submitted for approval.

GENERAL NOTES

1. The front and back faces of each barricade rail shall be reflectorized with stripes sloping downward toward the same side (traveled way) of each barricade.
2. Contractor may submit alternate barricade designs for approval.
3. Sandbags or other approved weights shall not be placed on top of any striped rail.
4. The Contractor is directed to Section 635.

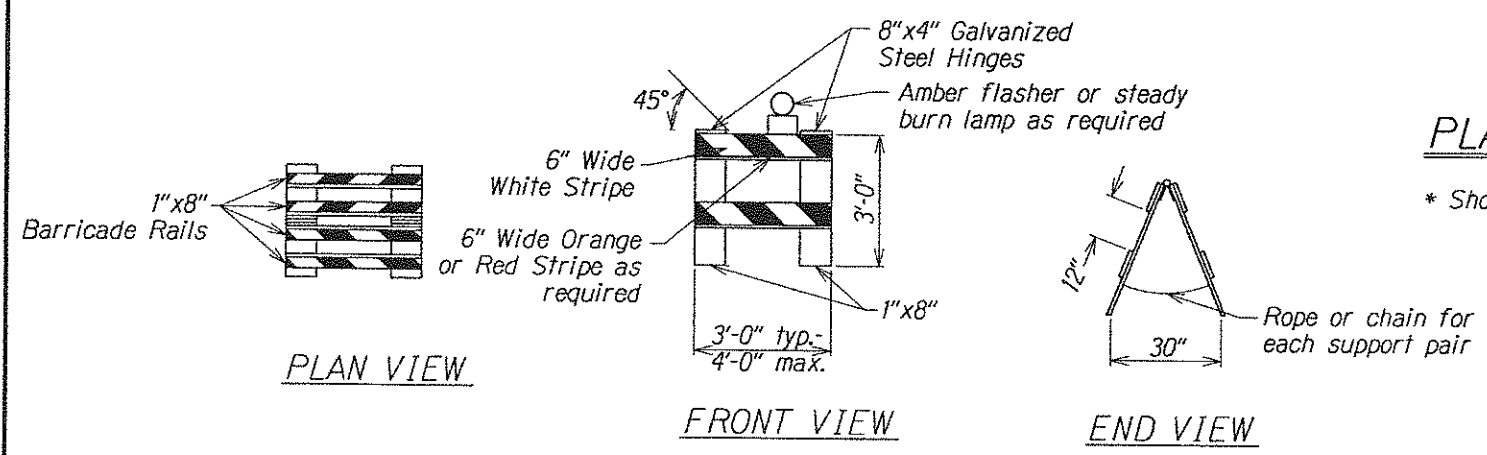

TYPE II BARRICADE
Not to Scale

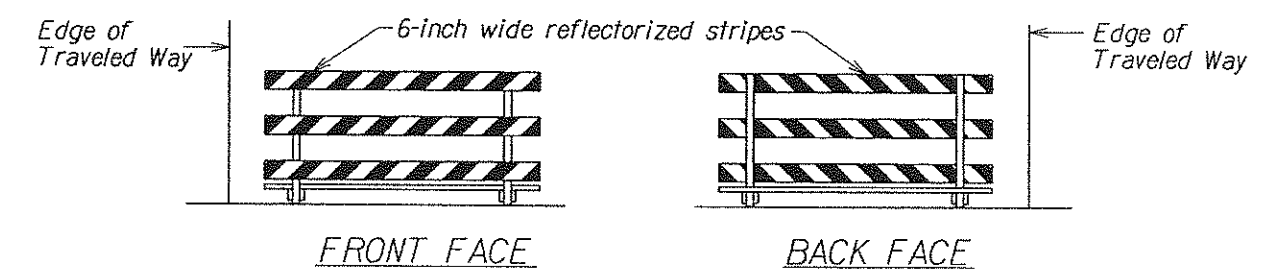

TYPICAL BARRICADE STRIPING DETAILS**
Not to Scale
** Similar for Types I & II

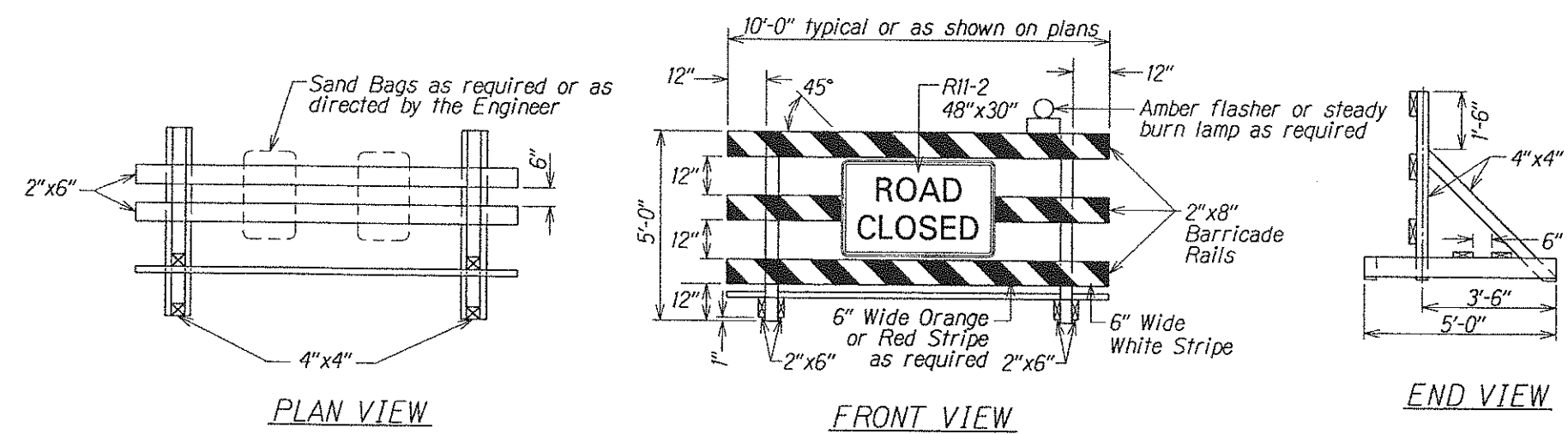

TYPE III BARRICADE
Not to Scale

BRUCE K. MEYERS
Licensed Professional Engineer
No. 8336-C
HAWAII, U.S.A.

The work was prepared by me or under my supervision and construction of this project will be under my observation.
Expiration Date of License 3/28

U.S. DEPARTMENT OF TRANSPORTATION
FEDERAL HIGHWAY ADMINISTRATION
CENTRAL FEDERAL LANDS HIGHWAY DIVISION

SPECIAL 635 (HDOT STD TE-66)

BARRICADES

Scale: N.T.S. Date: June 29, 2007

SHEET No. 1 OF 1

M:\Mproj\Lenntle\204028\100% sheets\shiq005.dgn