

FED. ROAD DIST. NO.	STATE	FED. AID PROJ. NO.	FISCAL YEAR	SHEET NO.	TOTAL SHEETS
HAWAII	HAW.	BR-0190(13)	1999	53	75

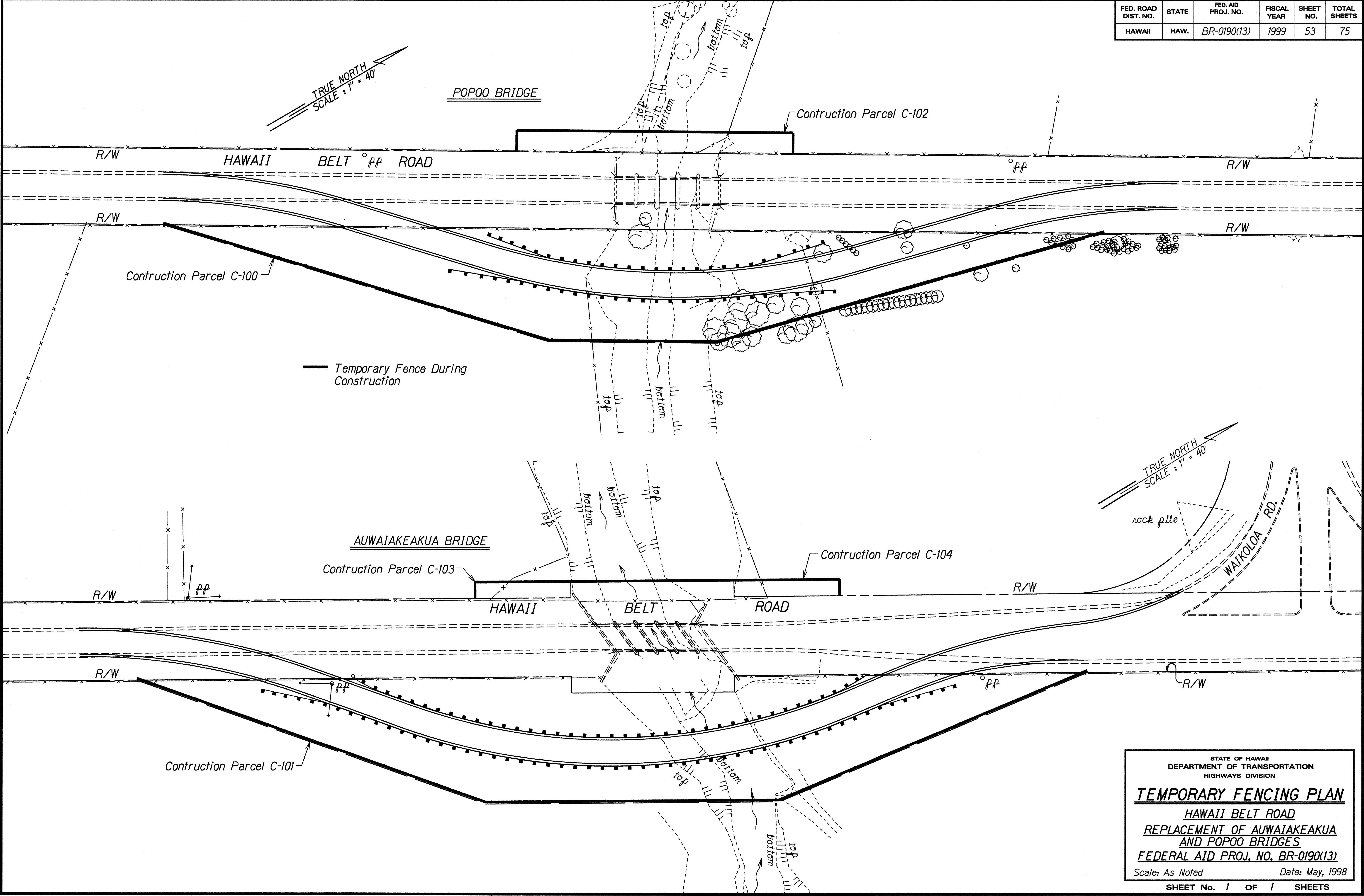

DATE	3-22-99
SURVEY PLOTTED BY	P. Wang
DRAWN BY	P. Wang
DESIGNED BY	J. W. W. W. W.
CHECKED BY	J. W. W. W.

STATE OF HAWAII  
DEPARTMENT OF TRANSPORTATION  
HIGHWAYS DIVISION

**TEMPORARY FENCING PLAN**  
HAWAII BELT ROAD  
REPLACEMENT OF AUWAIAKEAKUA  
AND POPOO BRIDGES  
FEDERAL AID PROJ. NO. BR-0190(13)  
Scale: As Noted      Date: May, 1998  
SHEET No. 1 OF 1 SHEETS

FED. ROAD DIST. NO.	STATE	FED. AID PROJ. NO.	FISCAL YEAR	SHEET NO.	TOTAL SHEETS
HAWAII	HAW.	BR-0190(13)	1999	54	75

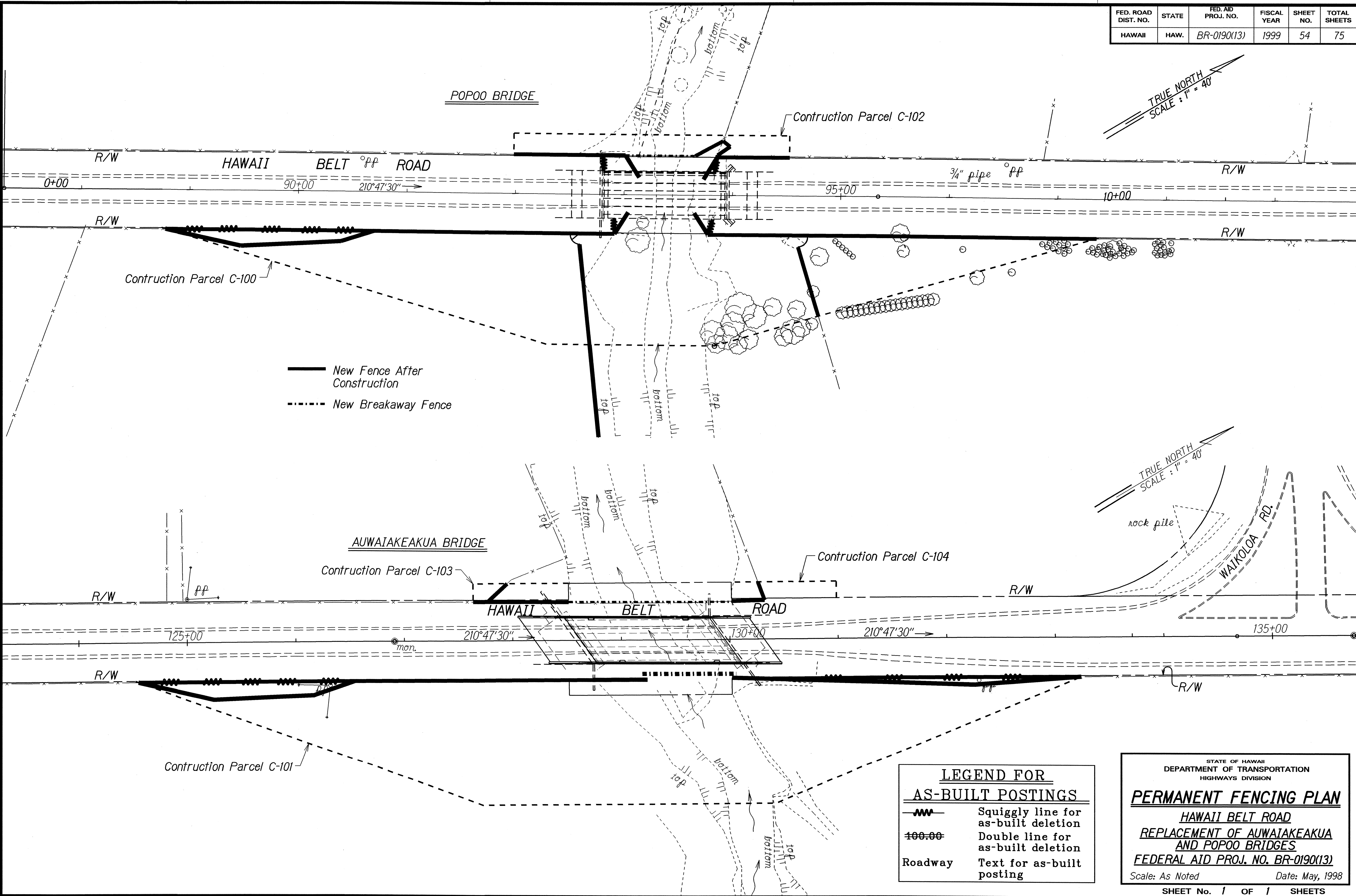

SURVEY PLOTTED BY	DATE
DRAWN BY	3-25-99
TRACED BY	
CHECKED BY	
NOTE BOOK	
QUANTITIES BY	
CHECKED BY	

LEGEND FOR AS-BUILT POSTINGS	
	Squiggly line for as-built deletion
	Double line for as-built deletion
Roadway	Text for as-built posting

STATE OF HAWAII  
DEPARTMENT OF TRANSPORTATION  
HIGHWAYS DIVISION

**PERMANENT FENCING PLAN**

**HAWAII BELT ROAD**  
**REPLACEMENT OF AUWAIKEAKUA AND POPOO BRIDGES**  
**FEDERAL AID PROJ. NO. BR-0190(13)**

Scale: As Noted Date: May, 1998

SHEET No. 1 OF 1 SHEETS