

FED. ROAD DIST. NO.	STATE	FED. AID PROJ. NO.	FISCAL YEAR	SHEET NO.	TOTAL SHEETS
HAWAII	HAW.	HSIP-0130(031)	2014	21	108

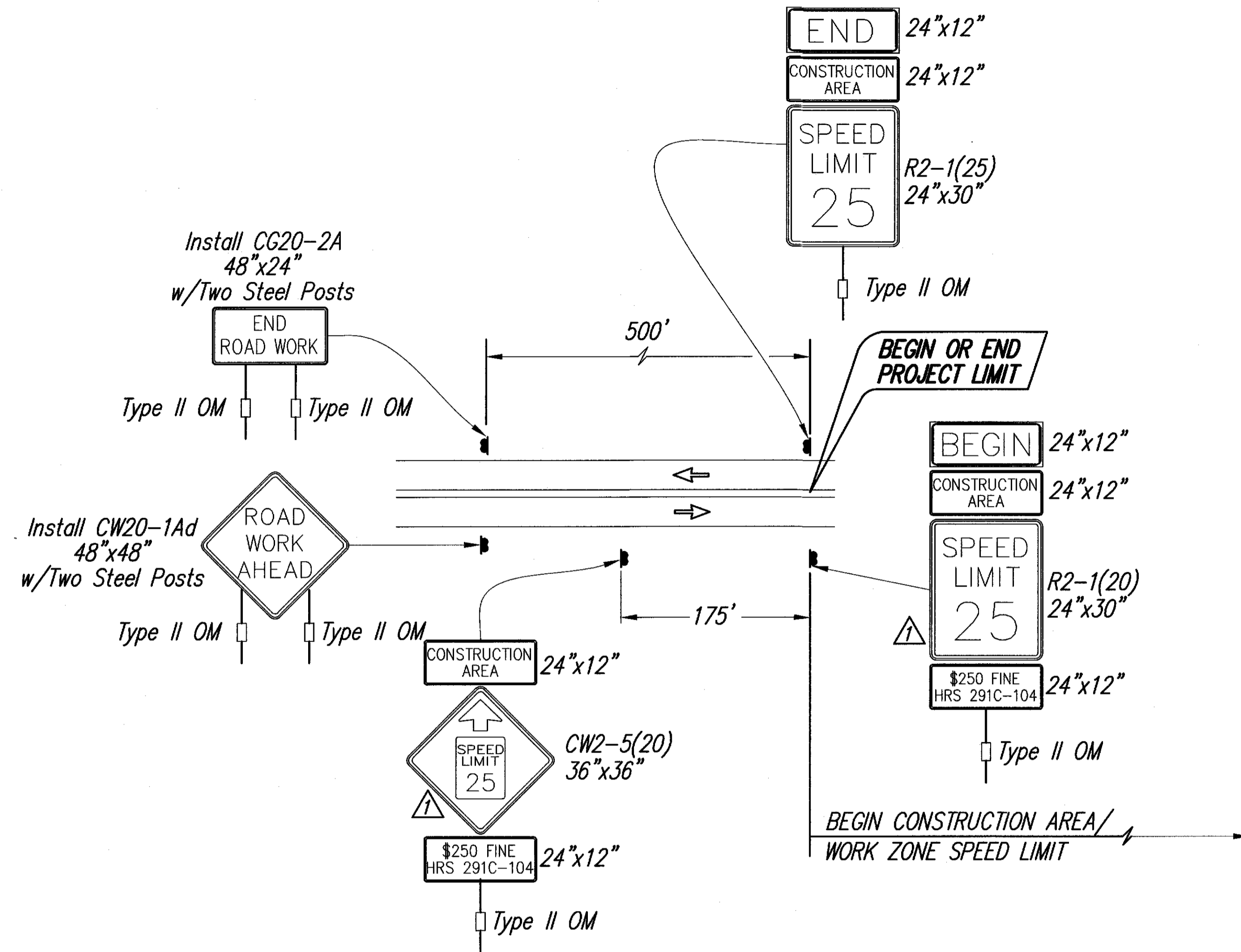

TYPICAL DETAIL FOR CONSTRUCTION SIGNS
ON TWO LANE OR MULTILANE UNDIVIDED LOW SPEED HIGHWAY

Work Zone Notes:

1. This Work Zone Sign Plan is intended for use on long-term stationary work zones/construction phases (3 days or more). All work zones or construction phases less than 3 days duration will use Traffic Control Plans shown in Section 645 of the Special Provisions.
2. All Existing Regulatory speed limit signs with posts within the work zone/project limit shall be removed and replaced with work zone speed limit sign assemblies (R2-1(20) and CW2-5(20) with "CONSTRUCTION AREA" and "\$250 FINE HRS 291C-104" Supplemental Signs).
3. Construction sign assemblies shall be installed on both the approaching and trailing ends of each work zone as shown on this plan.
4. Each construction warning sign shall have a minimum of two (2) Type II OM. Each work zone speed limit assembly shall have a minimum of one (1) Type II OM. Installation of each Type II OM shall be considered incidental to Item No. 645.1000, Traffic Control.
5. Upon the completion of all physical work or as directed by the Engineer, all construction signs and work zone speed limit assemblies shall be removed. All speed limit signs and posts that were existing at the start of the project within the work zone/project limits shall be restored back to their original locations and configurations.
6. Placement of construction signs shall not obstruct the path of pedestrians and bicyclists.
7. The removal and restoration of existing regulatory speed limit signs with new posts along with the installation, maintenance and removal of work zone speed limit sign assemblies shall be considered incidental to Item No. 645.1000 - Traffic Control.
8. The installation, maintenance and removal of work zone speed limit sign assemblies shall be paid for under item No. 645.1000 - Traffic Control.
9. The work zone speed limit signs shall be new and become the property of the State and shall be delivered at a location designated by the Engineer.

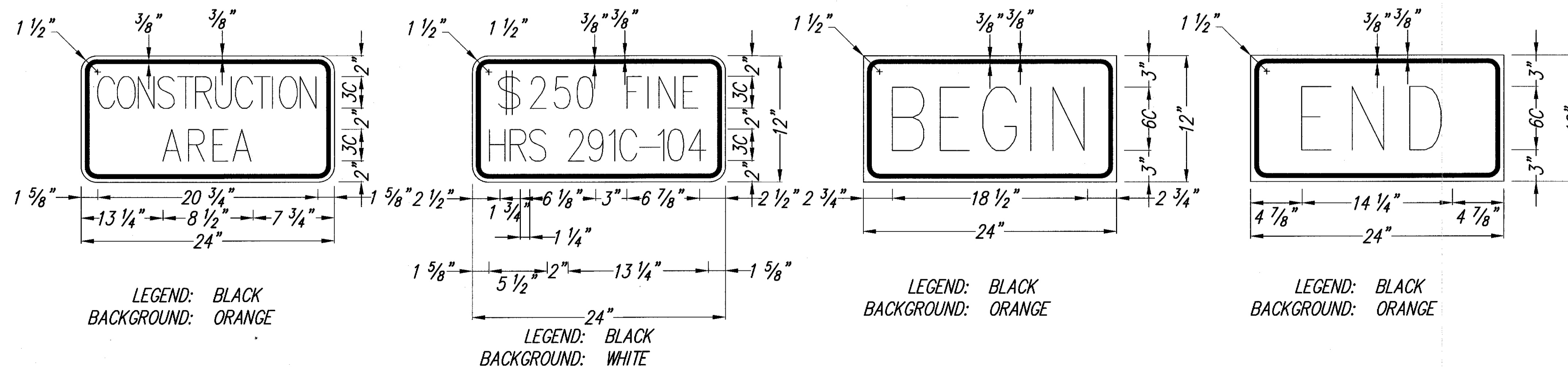

LEGEND: BLACK BACKGROUND: ORANGE

LEGEND: BLACK BACKGROUND: WHITE

LEGEND: BLACK BACKGROUND: ORANGE

LEGEND: BLACK BACKGROUND: ORANGE

DATE	_____
SURVEY PLOTTED BY	_____
DRAWN BY	_____
TRACED BY	_____
CHECKED BY	_____
QUANTITIES BY	_____
NO.	_____

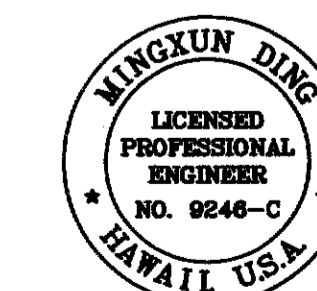

LICENSE EXPIRES 4/30/14
THIS WORK WAS PREPARED BY ME OR UNDER MY SUPERVISION

02/07/14 Revised Speed Limit to 25mph

STATE OF HAWAII
DEPARTMENT OF TRANSPORTATION
HIGHWAYS DIVISION

LOW SPEED UNDIVIDED HIGHWAY WORK ZONE SIGNING PLAN AND DETAILS

Keaau-Paho Road Intersection
Improvements at Old Government Road
Federal-Aid Project No. HSIP-0130(031)

Scale: None Date: August 2013

SHEET No. 1 OF 1 SHEETS