

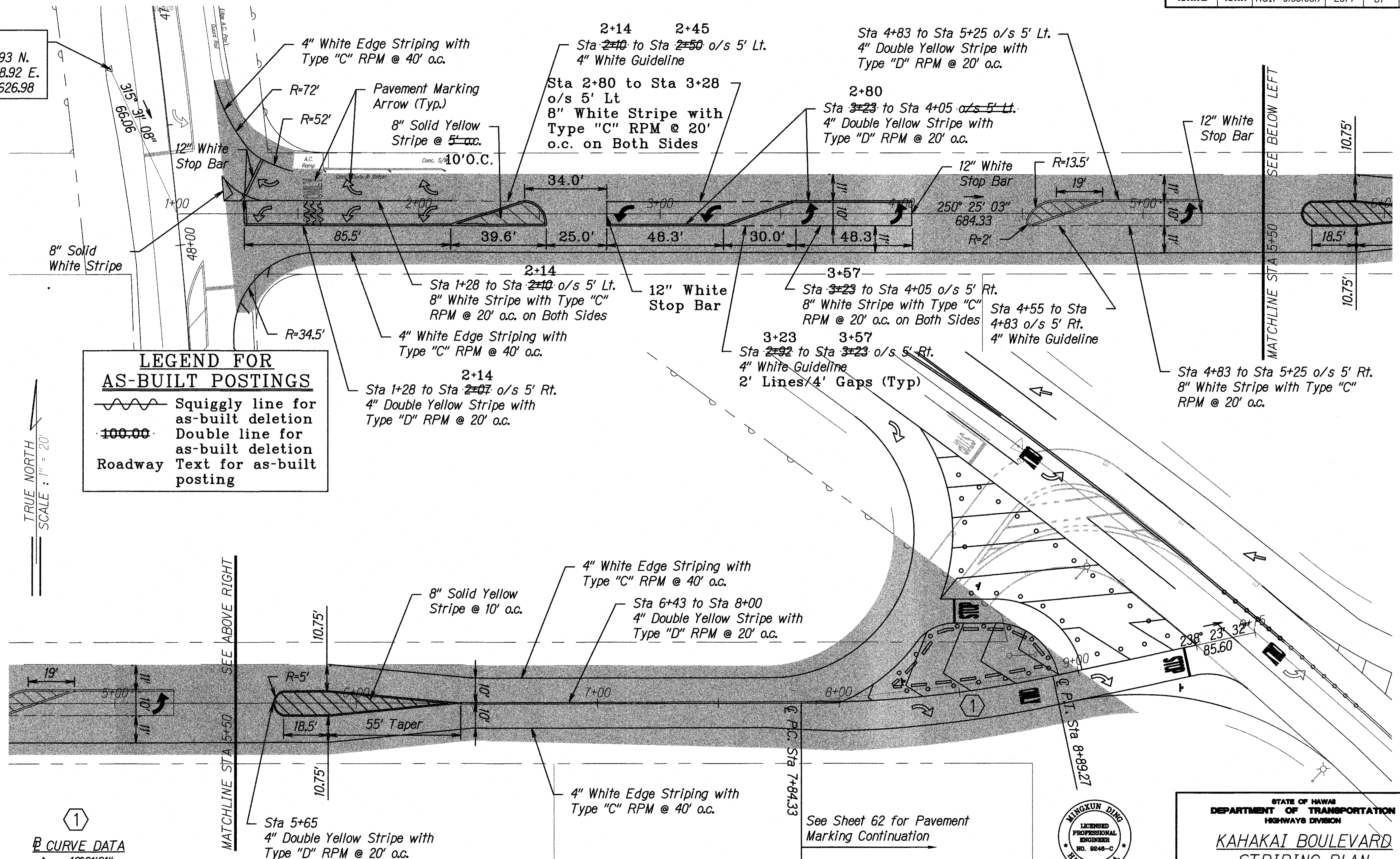

FED. ROAD DIST. NO.	STATE	FED. AID PROJ. NO.	FISCAL YEAR	SHEET NO.	TOTAL SHEETS
HAWAII	HAW.	HSIP-0130(031)	2014	67	108

T-2  
242,781.93 N.  
1,827,858.92 E.  
Elev = 626.98



**LEGEND FOR AS-BUILT POSTINGS**

~~~~~ Squiggly line for as-built deletion

==== Double line for as-built deletion

Roadway Text for as-built posting

TRUE NORTH  
SCALE: 1" = 20'

**1**  
**B CURVE DATA**  
Δ = 12°01'31"  
R = 500.00'  
T = 52.66'  
L = 104.75'  
Lc = 104.94'

# **KAHAKAI BOULEVARD STRIPING PLAN**

Scale: 1" = 20'

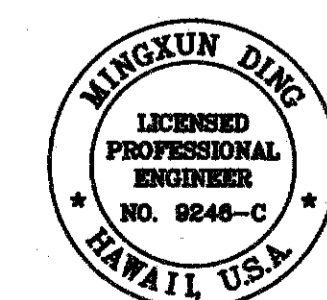
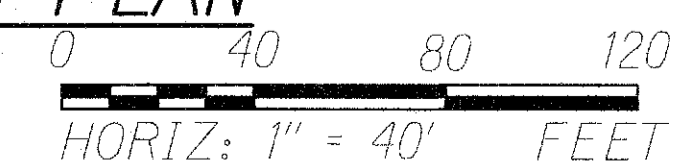

STATE OF HAWAII  
DEPARTMENT OF TRANSPORTATION  
HIGHWAYS DIVISION

**KAHAKAI BOULEVARD  
STRIPING PLAN**

**Keaau-Pahoa Road Intersection  
Improvements at Old Government Road  
Federal-Aid Project No. HSIP-0130(031)**

Scale: 1" = 20' Date: August 2013

SHEET No. 1 OF 1 SHEETS

"AS-BUILT"