

FED. ROAD DIST. NO.	STATE	PROJ. NO.	FISCAL YEAR	SHEET NO.	TOTAL SHEETS
HAWAII	HAW.	130B-01-07	2007	19	29

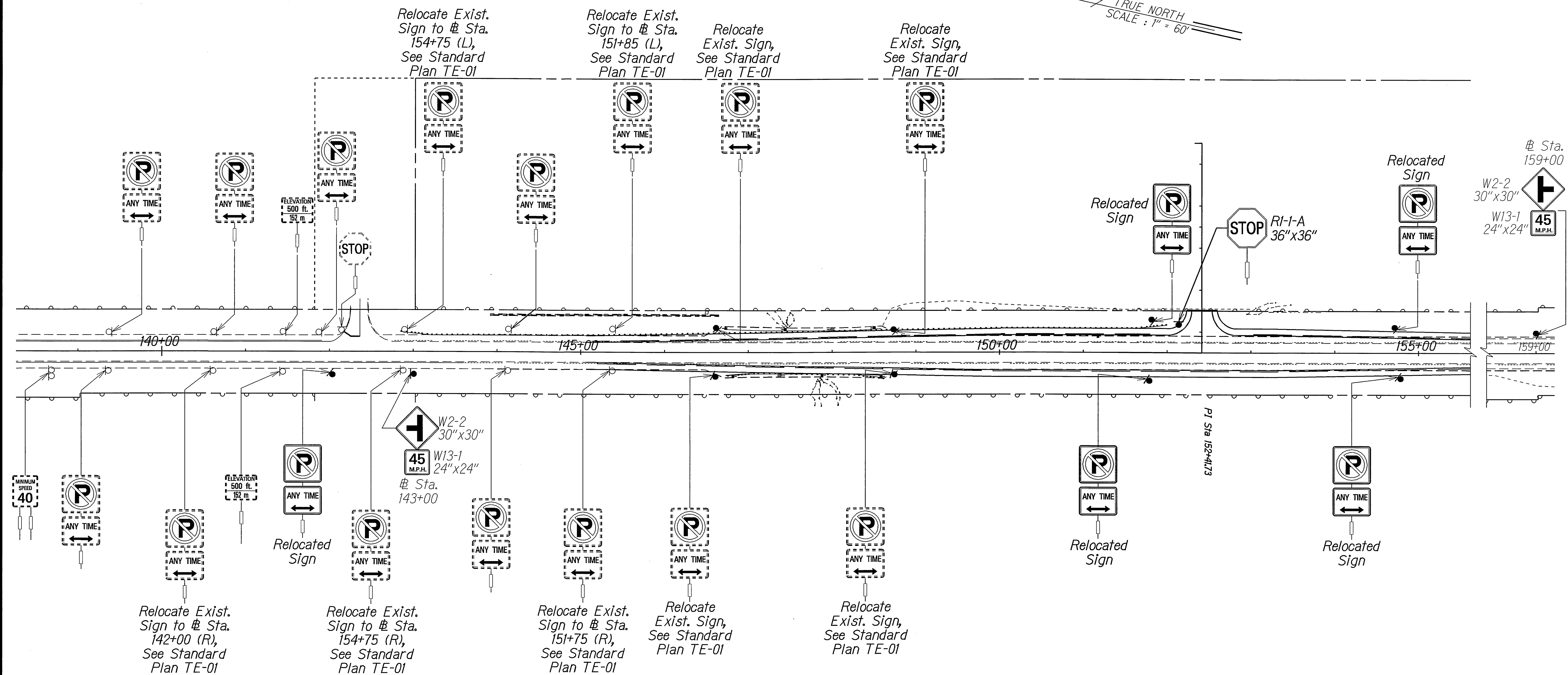

SIGN NOTES:

- Letter size:
 - when letters are all uppercase, use series "E"
 - when initial upper case letter is used in conjunction with lowercase letters, use series "E" (M) for uppercase letter.
- All signs shall conform to Section 631 of Standard Specification and the latest editions and amendments of the following FHWA publications:
 - "Manual on Uniform Traffic Control Devices for Streets and Highways" (MUTCD)
 - "Standard Highway Signs"
 - "Standard Alphabets for Highway Signs"
- All panels shall be reflectorized in accordance with Section 750 of the Standard Specifications.
- Contractor shall submit all sign splicing details to the Engineer for approval. All backing for signs 4 feet by 6 feet shall be of one sheet.
- Paint all sign posts with yellow reflective paint. This work is considered as incidental to sign items.
- Existing signs not shown on these plans or listed in the Sign Schedule shall remain as posted unless otherwise directed by the Engineer. Removal and disposal of existing signs and/or posts as designated on these plans shall be incidental to the various signing items.
- Final locations of all signs shall be approved by the Engineer prior to any installation work.
- Removal of existing delineators and posts shall be considered incidental to various signing items.
- All signs shall be installed with square tube posts, unless otherwise noted.
- "No Parking" signs shall be placed at a 45 degree angle to approaching traffic.

STATE OF HAWAII
DEPARTMENT OF TRANSPORTATION
HIGHWAYS DIVISION

SIGN RELOCATION PLAN & NOTES

KEA'AU-PĀHOA ROAD
HIGHWAY ACCESS IMPROVEMENTS
Vicinity of Ka Ohūwalu Street
Project No. 130B-01-07

Scale: 1"=60' Date: Jan. 2007

SHEET No. 1 OF 1 SHEETS