

FED. ROAD DIST. NO.	STATE	FED-AID PROJ. NO.	FISCAL YEAR	SHEET NO.	TOTAL SHEETS
HAWAII	HAW.	STP-0130(27)	2020	36	50

C:\CIVIL\_3D\_PROJECTS\2012\_153.000\_KEAAU-PAHOA\_RD\_IMPR\_RTE130\ROUNDABOUT DESIGN\ASBUILT DRAWINGS\01 ANALOHA 36-37 PAVT MARK AND SIGN PLANS.DWG 2/26/2021 5:28 PM KSAW

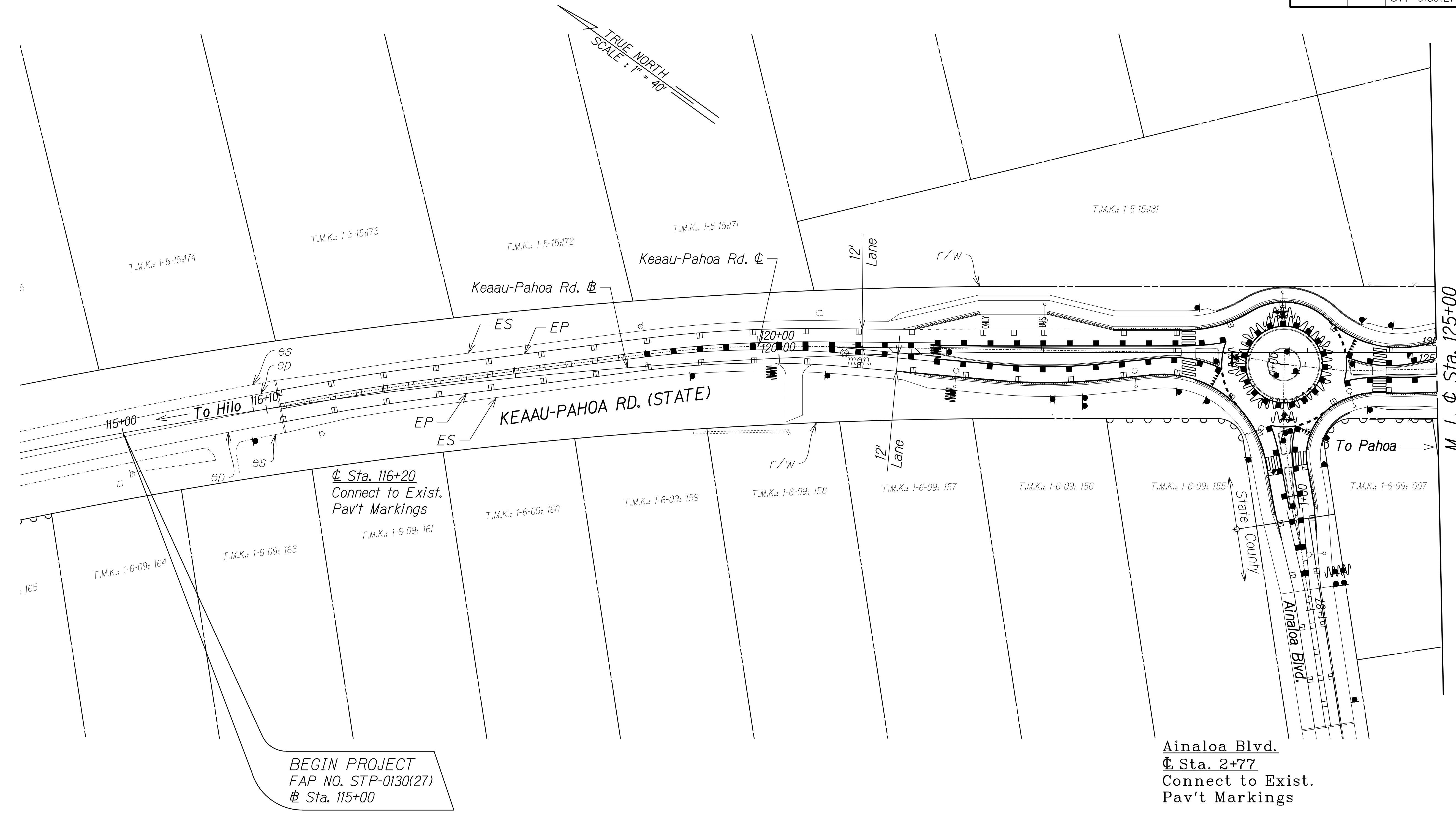

BEGIN PROJECT  
FAP NO. STP-0130(27)  
Sta. 115+00

Ainaloa Blvd.  
Sta. 2+77  
Connect to Exist.  
Pav't Markings

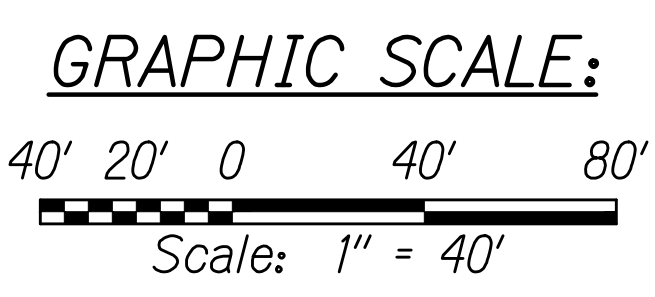

**LEGEND FOR AS-BUILT POSTINGS**

	Squiggly line for as-built deletion
	Double line for as-built deletion
Roadway	Text for as-built posting

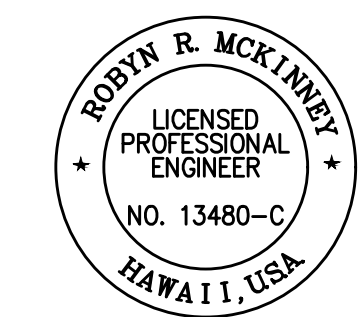

THIS WORK WAS PREPARED BY ME OR UNDER MY SUPERVISION AND CONSTRUCTION OF THIS PROJECT WILL BE UNDER MY OBSERVATION.

*Robyn McKinney* 04/30/20  
SIGNATURE EXPIRATION DATE OF THE LICENSE

STATE OF HAWAII  
DEPARTMENT OF TRANSPORTATION  
HIGHWAYS DIVISION

**OVERALL PAVEMENT MARKING AND SIGNING PLAN**

**KEAAU-PAHOA ROAD INTERSECTION IMPROVEMENTS at Ainaloa Boulevard**  
Federal-Aid Project No. STP-0130(27)

Scale: 1" = 40' Date: July, 2019

SHEET No. 2 OF 7 SHEETS

FED. ROAD DIST. NO.	STATE	FED-AID PROJ. NO.	FISCAL YEAR	SHEET NO.	TOTAL SHEETS
HAWAII	HAW.	STP-0130(27)	2020	37	50

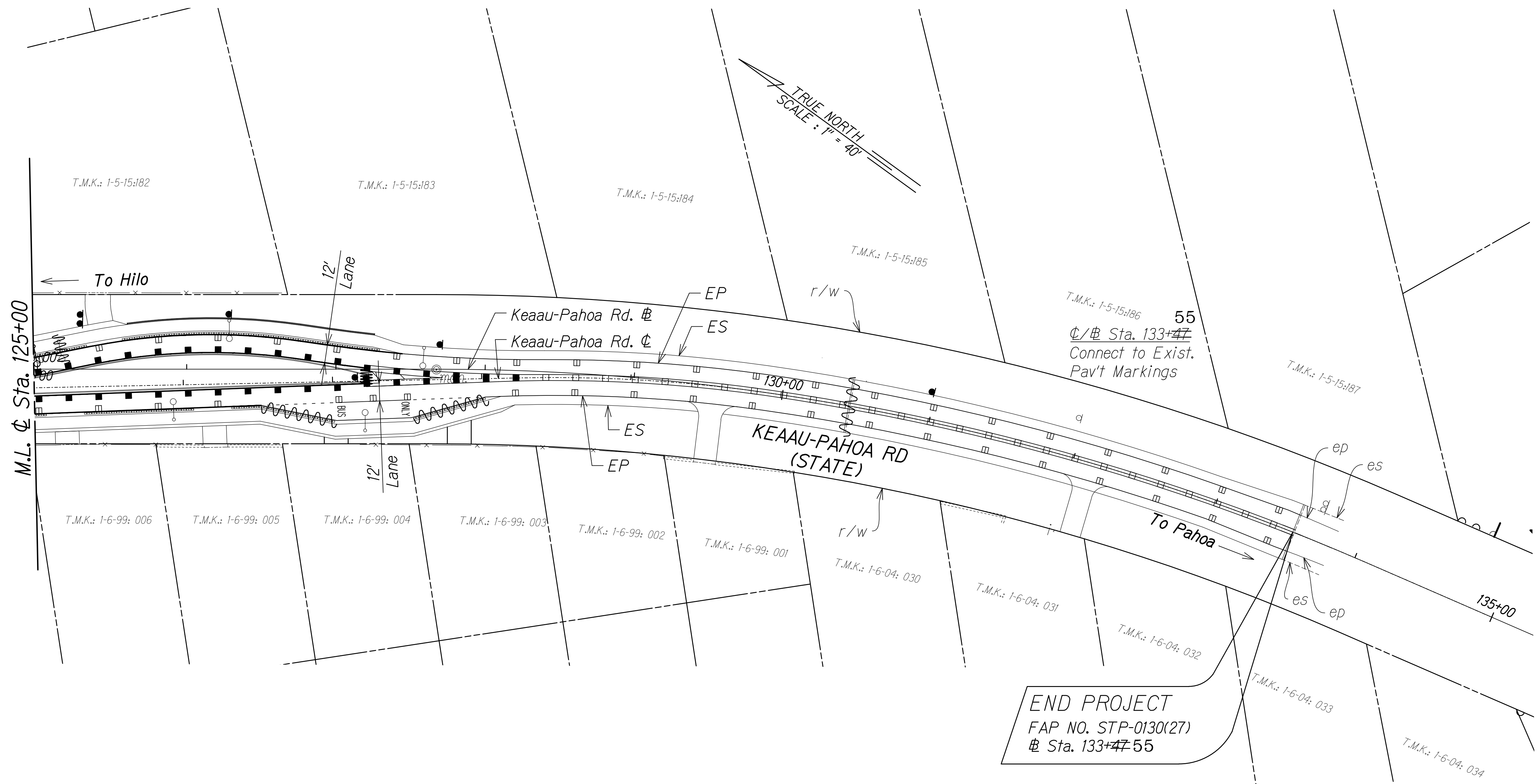

C:\CIVIL\_3D\_PROJECTS\2012\_153.000\_KEAAU-PAHOA\_RD\_IMPR\_RTE130\ROUNDABOUT DESIGN\ASBUILT DRAWINGS\01\_AINALOA\36-37\_PAVT MARK AND SIGN PLANS.DWG 2/26/2021 5:34 PM KSAW

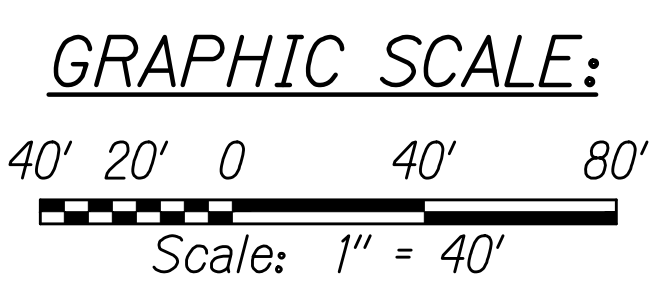

LEGEND FOR AS-BUILT POSTINGS	
	Squiggly line for as-built deletion
	Double line for as-built deletion
Roadway	Text for as-built posting

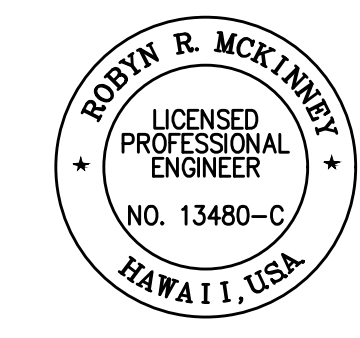

THIS WORK WAS PREPARED BY ME OR UNDER MY SUPERVISION AND CONSTRUCTION OF THIS PROJECT WILL BE UNDER MY OBSERVATION.

*Rodyn McKinney* 04/30/20  
SIGNATURE EXPIRATION DATE OF THE LICENSE

STATE OF HAWAII  
DEPARTMENT OF TRANSPORTATION  
HIGHWAYS DIVISION

**OVERALL PAVEMENT MARKING AND SIGNING PLAN**

**KEAAU-PAHOA ROAD INTERSECTION IMPROVEMENTS at Ainaloa Boulevard**  
Federal-Aid Project No. STP-0130(27)

Scale: 1" = 40' Date: July, 2019

SHEET No. 3 OF 7 SHEETS

"AS-BUILT"

FED. ROAD DIST. NO.	STATE	FED-AID PROJ. NO.	FISCAL YEAR	SHEET NO.	TOTAL SHEETS
HAWAII	HAW.	STP-0130(27)	2020	38	50

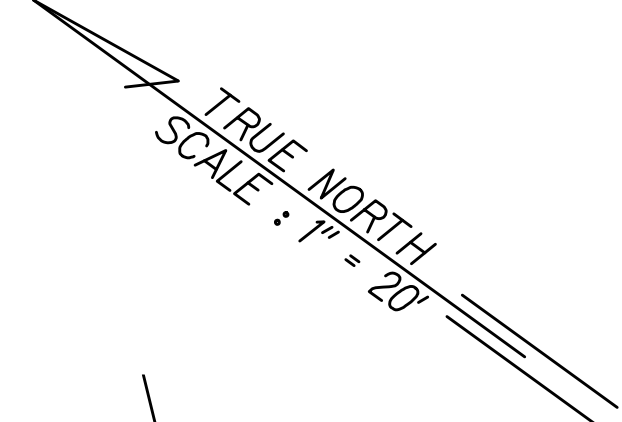

C:\\_CIVIL\_3D\_PROJECTS\2012\_153,000\_KEAAU-PAHOA\_RD\_IMPR\_RTE130\ROUNDABOUT\_DESIGN\AS-BUILT\_DRAWINGS\01\_ANALOA\38-41\_PAVT\_MARK\_SIGN\_PLANS\_20\_ANALOA.DWG 2/24/2021 4:49 PM SRODELAS

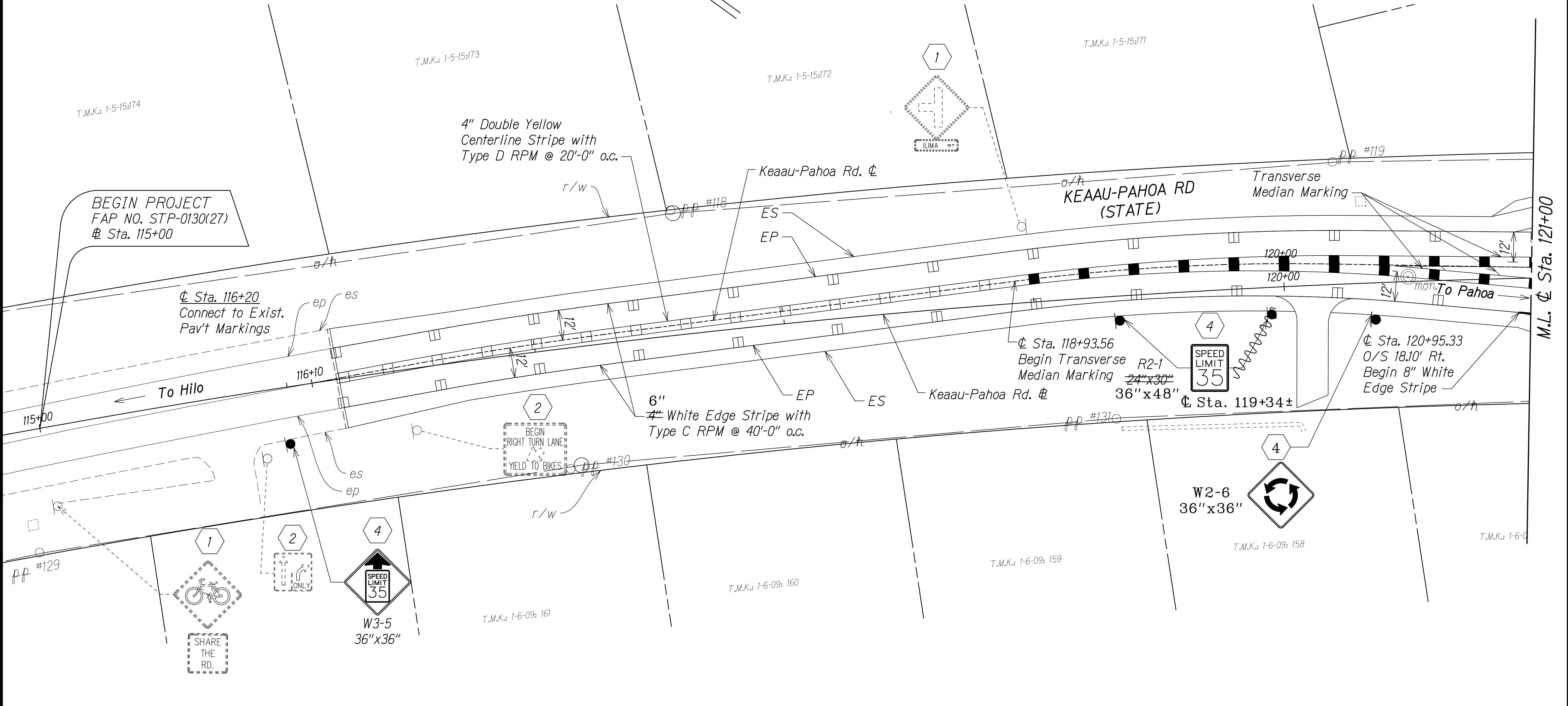

**BEGIN PROJECT**  
FAP NO. STP-0130(27)  
# Sta. 115+00

☉ Sta. 116+20  
Connect to Exist.  
Pav't Markings

6" ~~4"~~ White Edge Stripe with  
Type C RPM @ 40'-0" o.c.

☉ Sta. 118+93.56  
Begin Transverse R2-1  
Median Marking 24"x30"  
36"x48"

☉ Sta. 120+95.33  
O/S 18.10' Rt.  
Begin 8" White  
Edge Stripe

	Squiggly line for as-built deletion
	Double line for as-built deletion
Roadway	Text for as-built posting

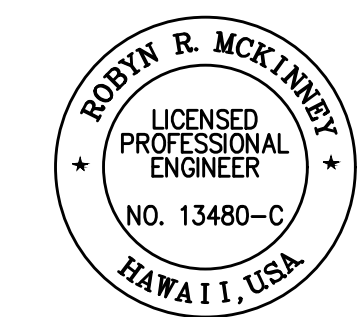
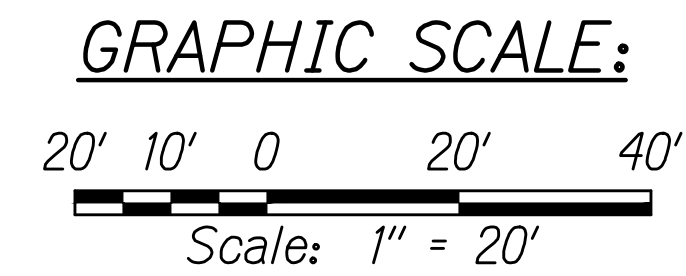

THIS WORK WAS PREPARED BY ME OR UNDER MY SUPERVISION AND CONSTRUCTION OF THIS PROJECT WILL BE UNDER MY OBSERVATION.  
*Robyn McKinney* 04/30/20  
SIGNATURE EXPIRATION DATE OF THE LICENSE

STATE OF HAWAII  
DEPARTMENT OF TRANSPORTATION  
HIGHWAYS DIVISION

**PAVEMENT MARKING AND SIGNING PLAN**  
**KEAAU-PAHOA ROAD INTERSECTION IMPROVEMENTS at Ainaloa Boulevard**  
Federal-Aid Project No. STP-0130(27)  
Scale: 1" = 20' Date: July, 2019

SHEET No. 4 OF 7 SHEETS

"AS-BUILT"

FED. ROAD DIST. NO.	STATE	FED-AID PROJ. NO.	FISCAL YEAR	SHEET NO.	TOTAL SHEETS
HAWAII	HAW.	STP-0130(27)	2020	ADD.39	50

**NOTES:**

1. For Typical Bus Pullout Bay Pavement Markings, See Sht. ADD.35.
2. For Crosswalk Marking dimension, See Sht. ADD.35.
3. For Curve and Point Data, See Sht. ADD.40.
4. For fire hydrant marker location, see DWS Det. FH13 but shall be outside crosswalk markings.

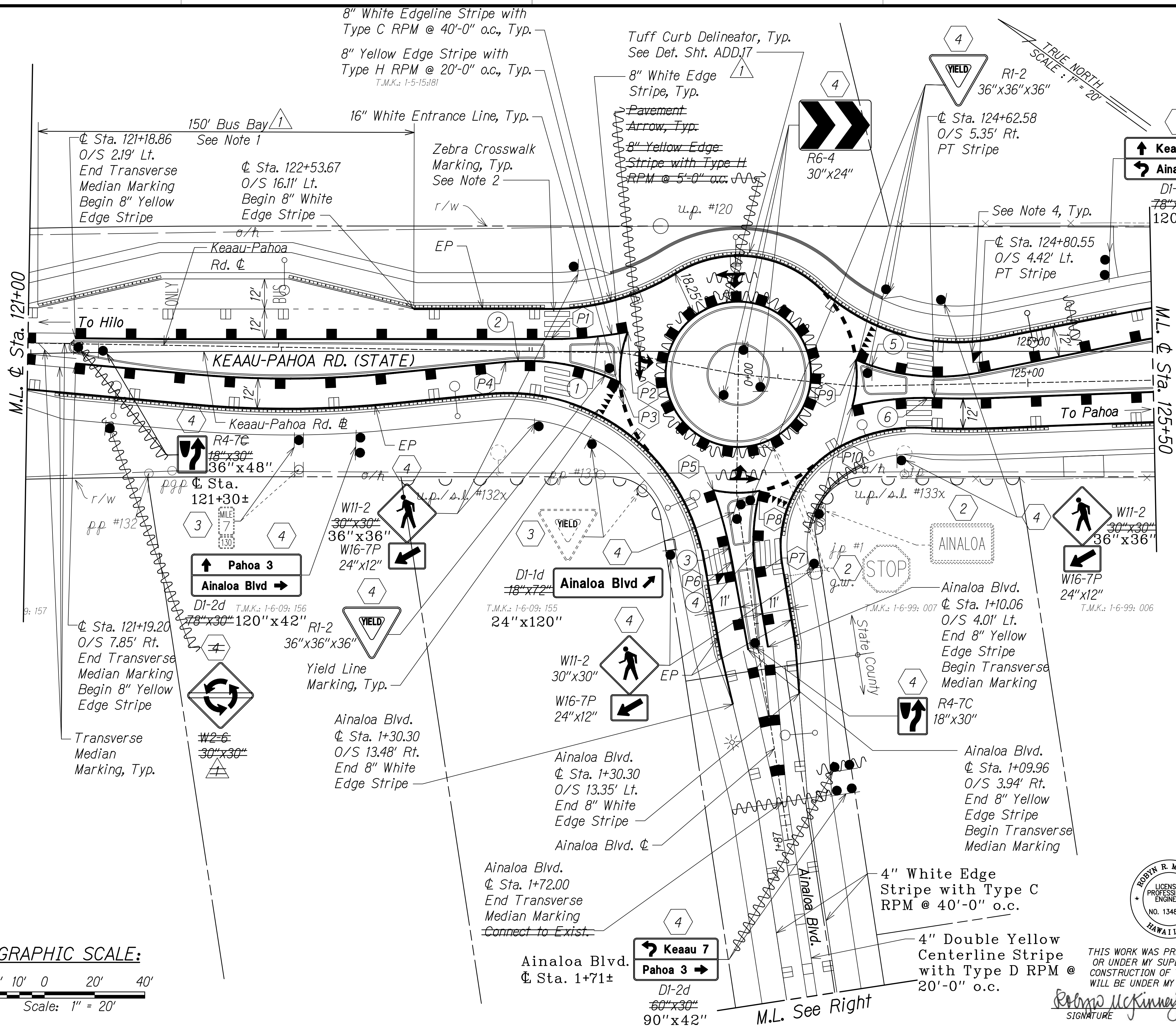

**LEGEND FOR AS-BUILT POSTINGS**

	Squiggly line for as-built deletion
	Double line for as-built deletion
	Roadway Text for as-built posting

12/16/19	Removed W13-1P; Revised Bus Pad Labels & Sheet References
DATE	REVISION

STATE OF HAWAII  
DEPARTMENT OF TRANSPORTATION  
HIGHWAYS DIVISION

**PAVEMENT MARKING AND SIGNING PLAN**  
**KEAAU-PAHOA ROAD INTERSECTION IMPROVEMENTS at Ainaloa Boulevard**  
Federal-Aid Project No. STP-0130(27)

Scale: 1" = 20' Date: July, 2019

SHEET No. 5 OF 7 SHEETS

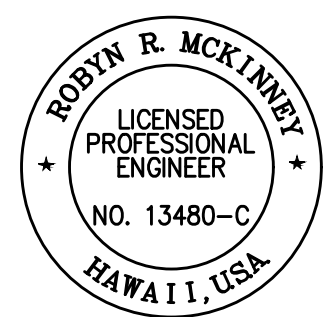

THIS WORK WAS PREPARED BY ME OR UNDER MY SUPERVISION AND CONSTRUCTION OF THIS PROJECT WILL BE UNDER MY OBSERVATION.

*Robyn McKinney* 04/30/20  
SIGNATURE EXPIRATION DATE OF THE LICENSE

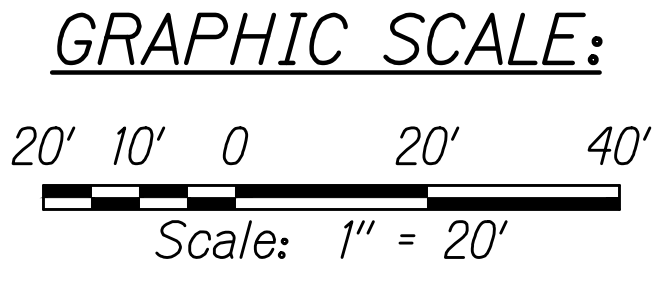

C:\\_CIVIL\_3D\_PROJECTS\2012\_153,000\_KEAAU-PAHOA\_RD\_IMPR\_RTE130\ROUNDABOUT DESIGN\ASBUILT DRAWINGS\01\_AINALOA\38-41\_PAVT MARK SIGN PLANS\_20\_AINALOA.DWG 2/24/2021 7:57 PM SRODELAS

TRUE NORTH  
SCALE: 1" = 20'

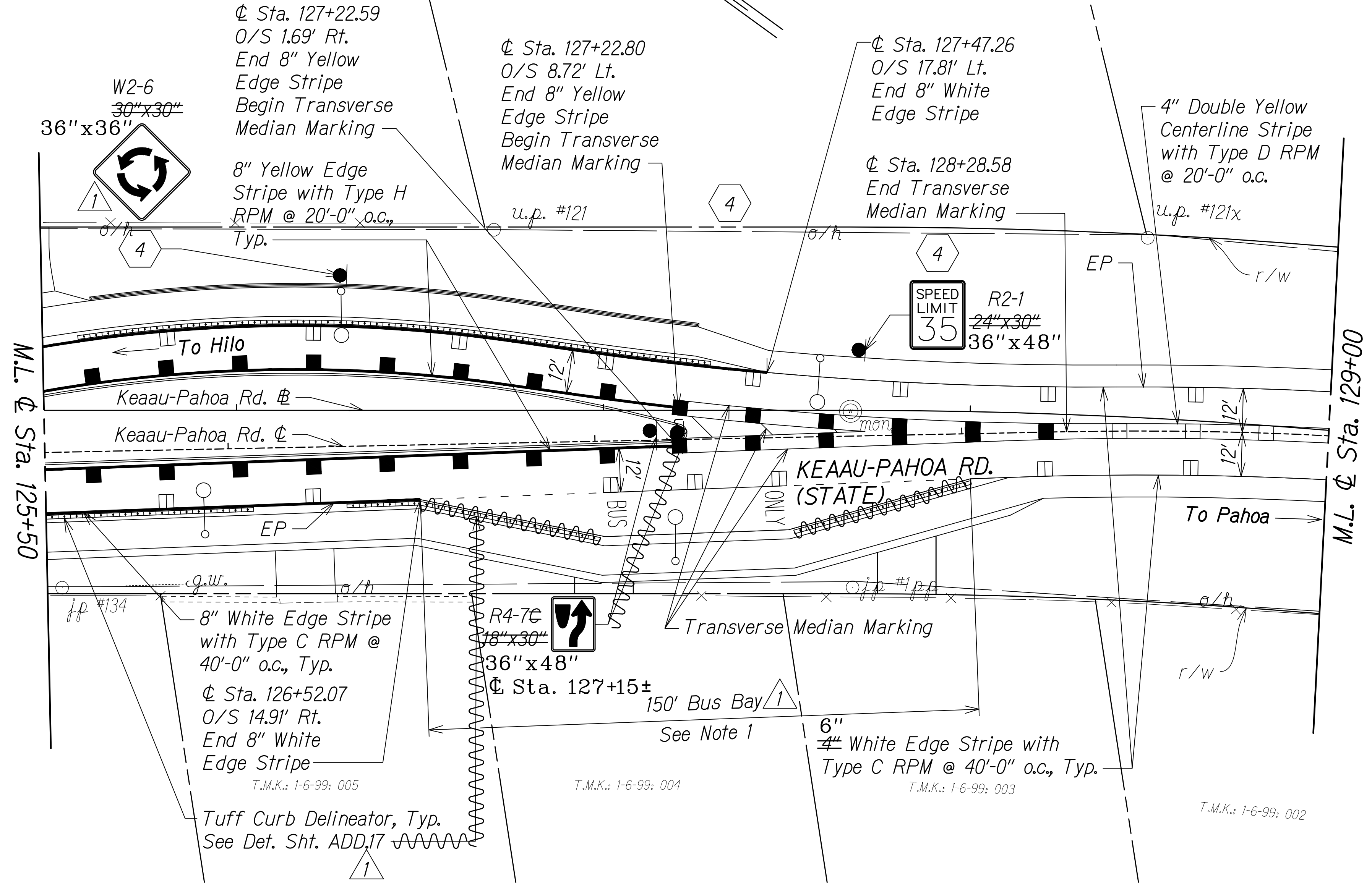

**POINT DATA:**

- |     |   |    |   |    |   |
|-----|---|----|---|----|---|
| P1  | ☉ Sta. 123+08.72<br>O/S 5.02' Lt.<br>PC Stripe                | P2 | ☉ Sta. 123+37.76<br>O/S 8.62' Lt.<br>PT Stripe                | P3 | ☉ Sta. 123+38.45<br>O/S 11.74' Rt.<br>PT Stripe               |
| P4  | ☉ Sta. 122+90.73<br>O/S 4.38' Rt.<br>PC Stripe                | P5 | Ainaloa Blvd.<br>☉ Sta. 0+46.32<br>O/S 9.34' Rt.<br>PC Stripe | P6 | Ainaloa Blvd.<br>☉ Sta. 0+74.12<br>O/S 5.52' Rt.<br>PT Stripe |
| P7  | Ainaloa Blvd.<br>☉ Sta. 0+80.84<br>O/S 3.20' Lt.<br>PT Stripe | P8 | Ainaloa Blvd.<br>☉ Sta. 0+46.32<br>O/S 9.34' Lt.<br>PC Stripe | P9 | ☉ Sta. 124+30.27<br>O/S 10.51' Lt.<br>PC Stripe               |
| P10 | ☉ Sta. 124+30.76<br>O/S 8.15' Rt.<br>PC Stripe                |    |   |    |   |

**CURVE DATA:**

CURVE	①	②	③	④	⑤	⑥
Δ	10°39'16.29"	31°39'17.00"	8°52'45.99"	24°17'48.97"	34°36'15.01"	15°45'51.56"
Δ/2	5°19'38.15"	15°49'38.50"	4°26'22.99"	12°08'54.48"	17°18'07.51"	7°52'55.78"
R	165.00'	85.00'	190.00'	80.00'	83.00'	120.00'
Tan.	15.39'	24.10'	14.75'	17.22'	25.85'	16.61'
C	30.64'	46.37'	29.42'	33.67'	49.37'	32.91'
Lc	30.68'	46.96'	29.45'	33.92'	50.13'	33.02'

**NOTE:**

1. For Typical Bus Bay Pavement Markings, See Sht. ADD.35.

**LEGEND FOR AS-BUILT POSTINGS**

~~~~~ Squiggly line for as-built deletion

~~100.00~~ Double line for as-built deletion

Roadway Text for as-built posting

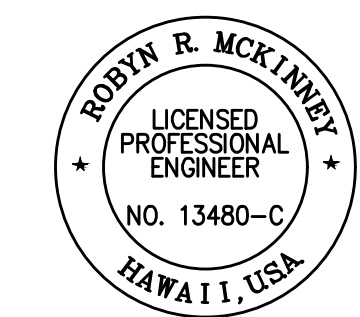
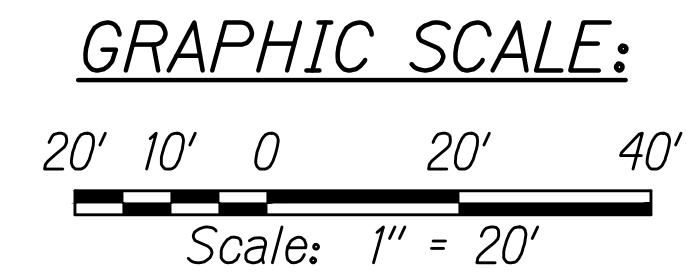

THIS WORK WAS PREPARED BY ME OR UNDER MY SUPERVISION AND CONSTRUCTION OF THIS PROJECT WILL BE UNDER MY OBSERVATION.

*Robyn McKinney* 04/30/20  
SIGNATURE EXPIRATION DATE OF THE LICENSE

12/16/19 Removed W13-1P; Revised Bus Pad Labels & Note #1

DATE REVISION

STATE OF HAWAII  
DEPARTMENT OF TRANSPORTATION  
HIGHWAYS DIVISION

**PAVEMENT MARKING AND SIGNING PLAN**

**KEAAU-PAHOA ROAD INTERSECTION IMPROVEMENTS at Ainaloa Boulevard**

Federal-Aid Project No. STP-0130(27)

Scale: 1" = 20' Date: July, 2019

SHEET No. 6 OF 7 SHEETS

C:\CIVIL\_3D\_PROJECTS\2012\_153.000\_KEAAU-PAHOA\_RD\_IMPR\_RTE130\ROUNDABOUT\_DESIGN\ASBUILT\_DRAWINGS\01\_AINALOA\38-41\_PAVT\_MARK\_SIGN\_PLANS\_20\_AINALOA.DWG 2/24/2021 7:57 PM KSAW

| FED. ROAD DIST. NO. | STATE | FED. AID PROJ. NO. | FISCAL YEAR | SHEET NO. | TOTAL SHEETS |
|---------------------|-------|--------------------|-------------|-----------|--------------|
| HAWAII              | HAW.  | STP-0130(27)       | 2020        | 41        | 50           |

C:\CIVIL 3D PROJECTS\2012\_153.000\_KEAAU-PAHOA\_RD\_IMPR\_RTE130\ROUNDABOUT DESIGN\ASBUILT DRAWINGS\01\_AINALOA\38-41\_PAVT MARK SIGN PLANS\_20\_AINALOA.DWG 2/24/2021 6:13 PM SRODELAS

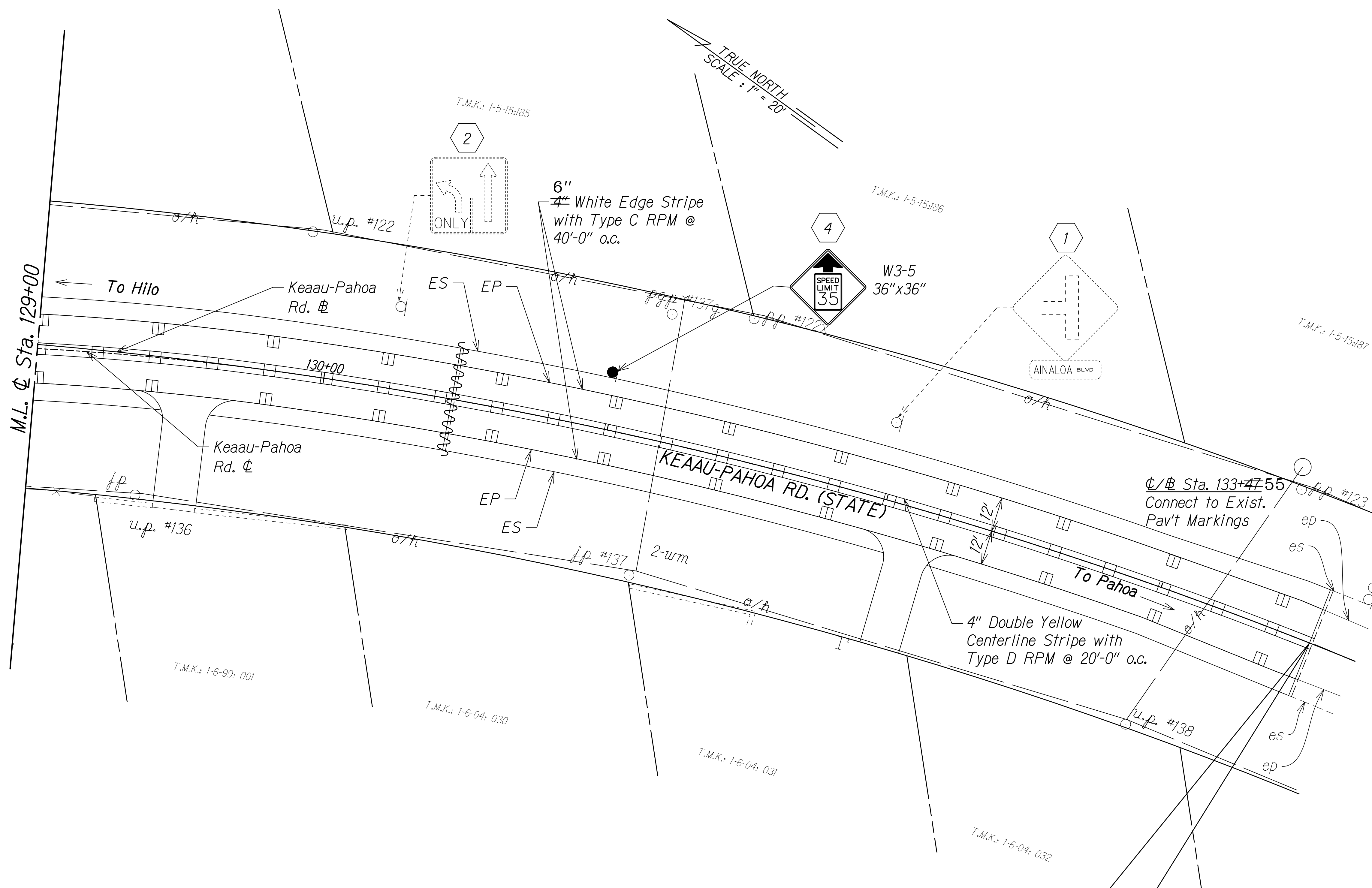

|         |                                     |
|---------|-------------------------------------|
|         | Squiggly line for as-built deletion |
|         | Double line for as-built deletion   |
| Roadway | Text for as-built posting           |

END PROJECT  
FAP NO. STP-0130(27)  
Sta. 133+47.55

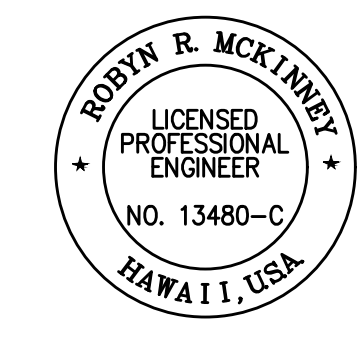
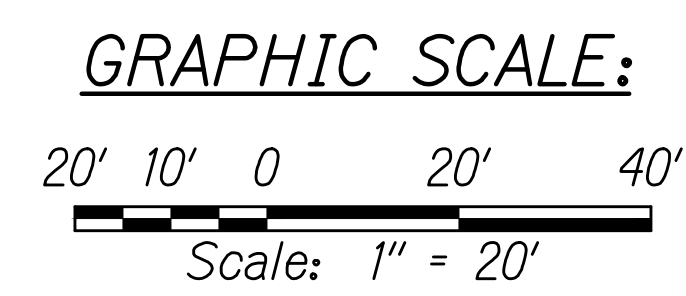

THIS WORK WAS PREPARED BY ME OR UNDER MY SUPERVISION AND CONSTRUCTION OF THIS PROJECT WILL BE UNDER MY OBSERVATION.

*Robyn McKinney* 04/30/20  
SIGNATURE EXPIRATION DATE OF THE LICENSE

STATE OF HAWAII  
DEPARTMENT OF TRANSPORTATION  
HIGHWAYS DIVISION

**PAVEMENT MARKING AND SIGNING PLAN**

KEAAU-PAHOA ROAD  
INTERSECTION IMPROVEMENTS  
at Ainaloa Boulevard  
Federal-Aid Project No. STP-0130(27)

Scale: 1" = 20' Date: July, 2019

SHEET No. 7 OF 7 SHEETS

"AS-BUILT"