

FED. ROAD DIST. NO.	STATE	FED-AID PROJ. NO.	FISCAL YEAR	SHEET NO.	TOTAL SHEETS
HAWAII	HAW.	STP-0130(27)	2020	ADD.33	50

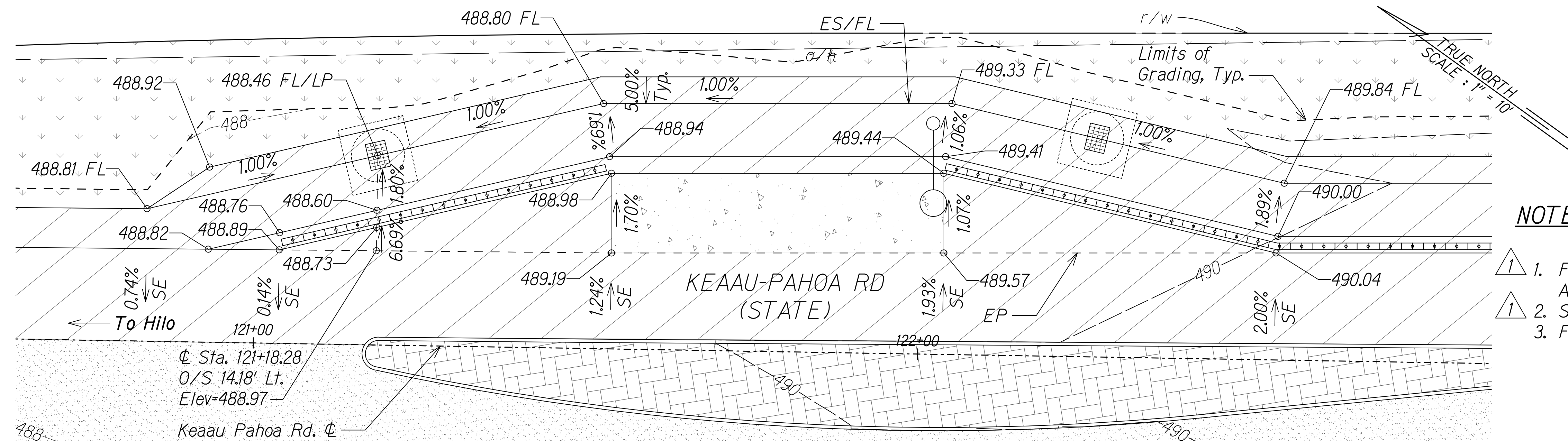

NOTES:

1. For Roadway Layout, See Roadway Plans, Shts. ADD.25 to ADD.32.
2. See Cross Sections Shts. ADD.45 to ADD.50.
3. For Superelevation Diagram, See Sht. 21.

LT. BUS BAY 

Scale: 1"=10'

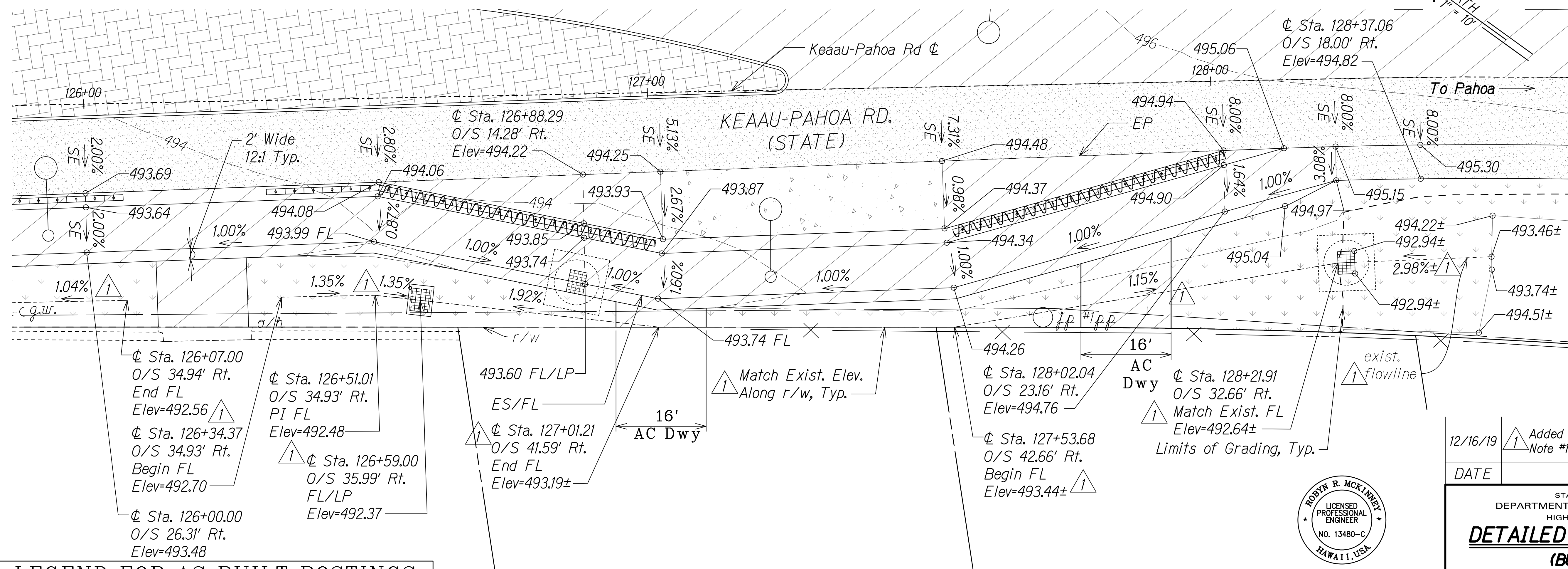

LEGEND FOR AS-BUILT POSTINGS

	Squiggly line for as-built deletion
100.00	Double line for as-built deletion
Roadway	Text for as-built posting

RT. BUS BAY 

Scale: 1"=10'

GRAPHIC SCALE:

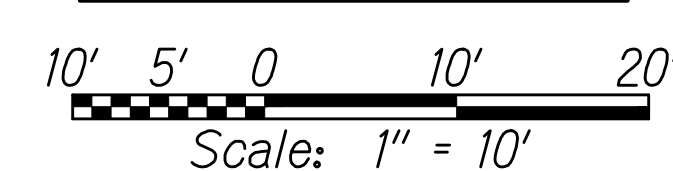

THIS WORK WAS PREPARED BY ME
OR UNDER MY SUPERVISION AND
CONSTRUCTION OF THIS PROJECT
WILL BE UNDER MY OBSERVATION.

Robert McKinney 04/30/20
SIGNATURE EXPIRATION DATE
OF THE LICENSE

12/16/19	1	Added Flowline; Revised Labels & Note #1 and #2
----------	---	---

<i>DATE</i>	<i>REVISION</i>
-------------	-----------------

STATE OF HAWAII
DEPARTMENT OF TRANSPORTATION
HIGHWAYS DIVISION

(BUS BAYS)

KEAAU-PAHOA ROAD
INTERSECTION IMPROVEMENTS
at Ainaloa Boulevard

Federal-Aid Project No. STP-0130(27)
Scale: 1"=10' Date: July, 2019

SHEET No. 1 OF 2 SHEETS

"AS-BUILT"

ADD.33

C:\CIVIL 3D PROJECTS\2012_153.000 KEAAU-PAHOA RD IMPR RTE130\ROUNDABOUT DESIGN\ASBUILT DRAWINGS\01 AINALOA\33-34 GRAD PLANS.DWG 3/3/2021 11:04 AM KSAW

FED. ROAD DIST. NO.	STATE	FED-AID PROJ. NO.	FISCAL YEAR	SHEET NO.	TOTAL SHEETS
HAWAII	HAW.	STP-0130(27)	2020	ADD.34	50

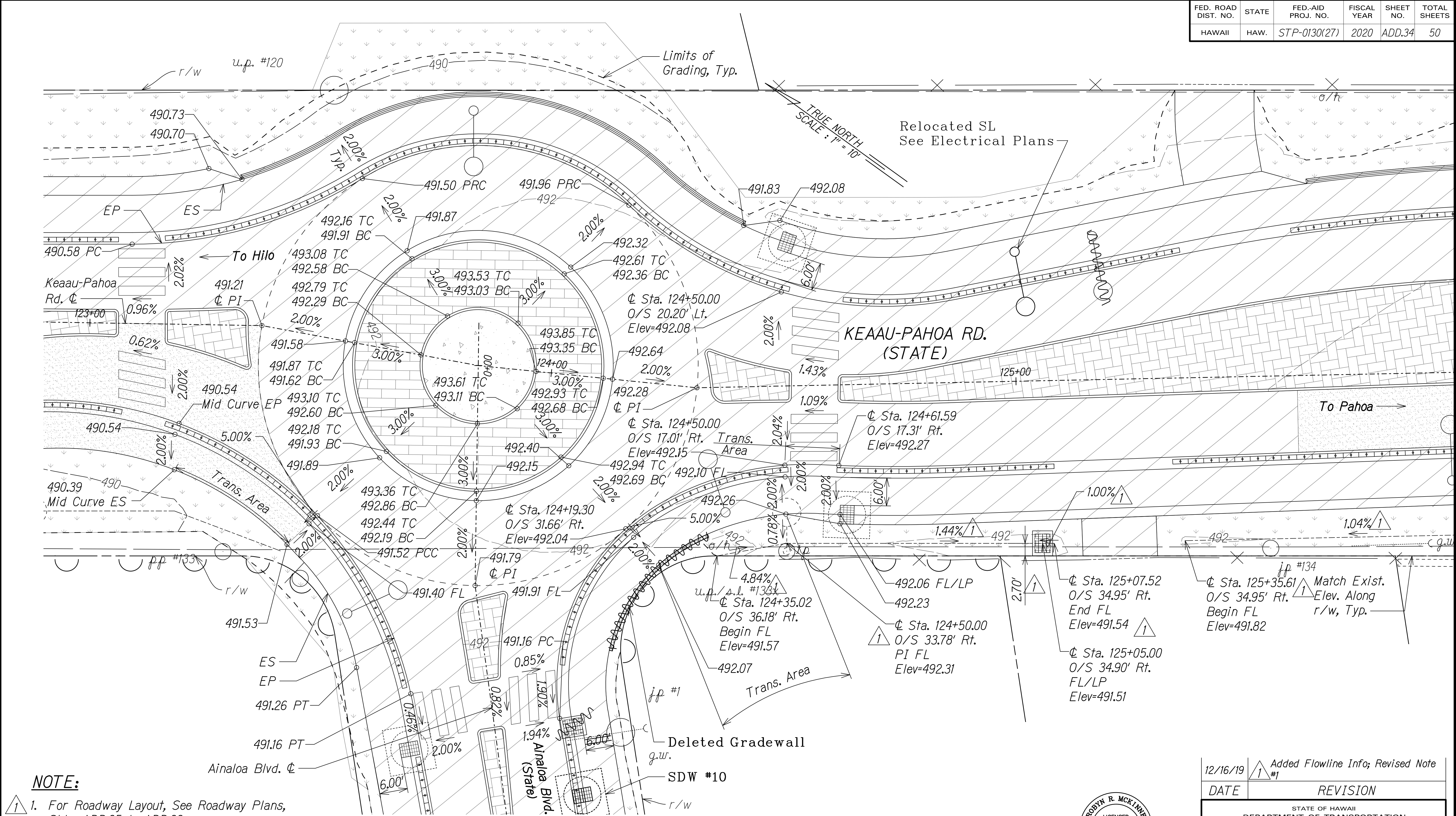

NOTE:

1. For Roadway Layout, See Roadway Plans, Shts. ADD.25 to ADD.32.

LEGEND FOR AS-BUILT POSTINGS	
	Squiggly line for as-built deletion
	Double line for as-built deletion
Roadway	Text for as-built posting

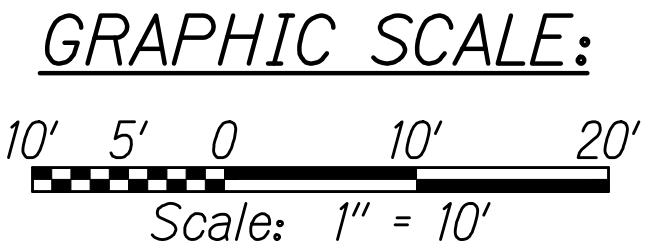

RODIN R. MCKINNEY
LICENSED PROFESSIONAL ENGINEER
NO. 13480-C
HAWAII, USA

THIS WORK WAS PREPARED BY ME OR UNDER MY SUPERVISION AND CONSTRUCTION OF THIS PROJECT WILL BE UNDER MY OBSERVATION.

Rodney McKinney 04/30/20
SIGNATURE EXPIRATION DATE OF THE LICENSE

12/16/19	Added Flowline Info; Revised Note
DATE	REVISION

STATE OF HAWAII
DEPARTMENT OF TRANSPORTATION
HIGHWAYS DIVISION

DETAILED GRADING PLAN
(ROUNDBOUT)
KEAAU-PAHOA ROAD
INTERSECTION IMPROVEMENTS
at Ainaloa Boulevard
Federal-Aid Project No. STP-0130(27)

Scale: 1"=10' Date: July, 2019

SHEET No. 2 OF 2 SHEETS

"AS-BUILT"

ADD.34

FED. ROAD DIST. NO.	STATE	FED-AID PROJ. NO.	FISCAL YEAR	SHEET NO.	TOTAL SHEETS
HAWAII	HAW.	STP-0130(27)	2020	ADD. 34S-1	50

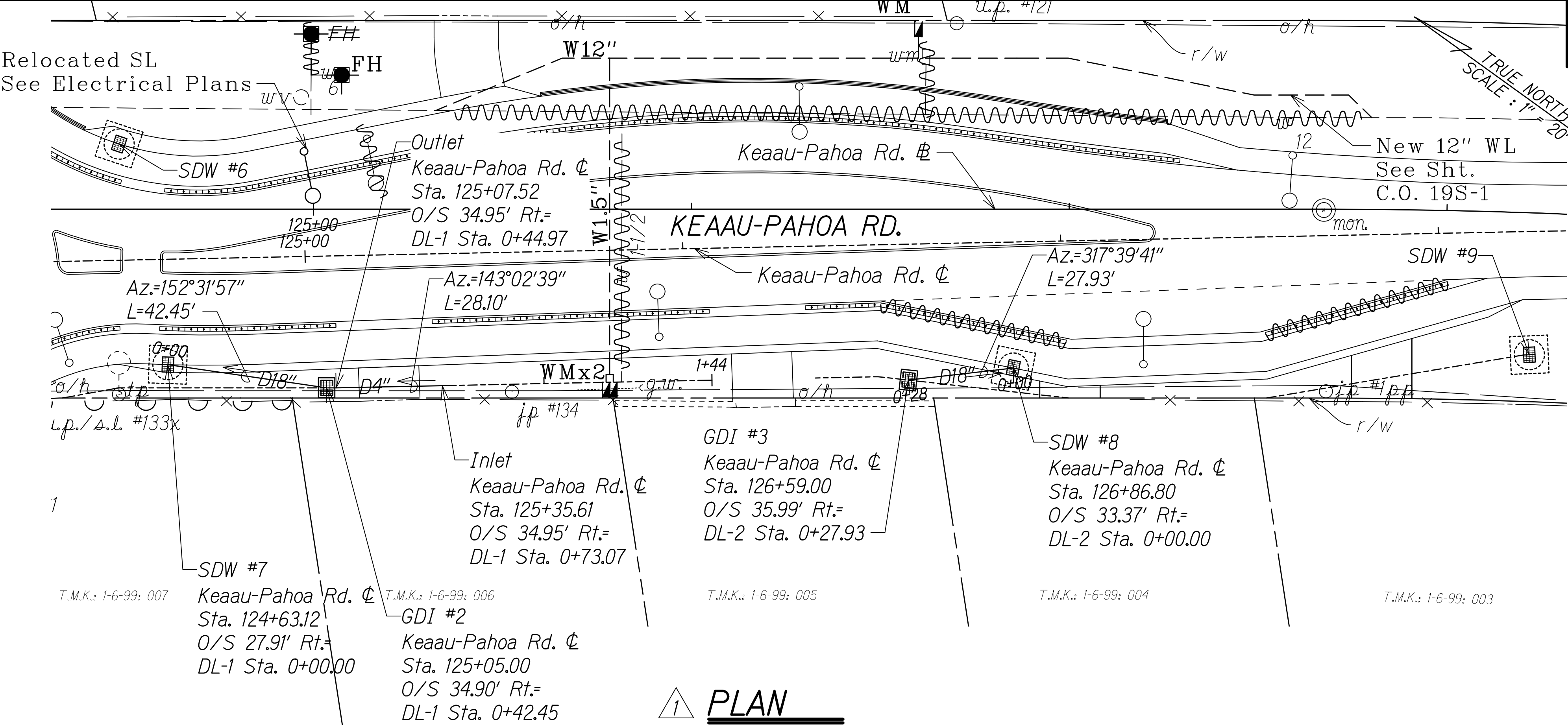

- NOTES:**
- For Shallow Drywell Details, See Sht. ADD.18.
 - GDI #2 & #3 grate shall be a modified 1211214P. See Det. Sht. ADD.18 and HDOT Std. Plans H-12 and H-15.
 - For Drainline Trench Restoration Detail, See Sht. ADD.17.

LEGEND FOR AS-BUILT POSTINGS	
	Squiggly line for as-built deletion
	Double line for as-built deletion
Roadway	Text for as-built posting

PLAN
Scale: 1" = 20'

GRAPHIC SCALES:

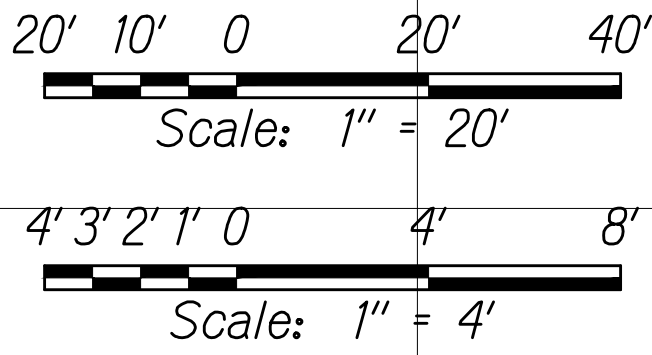

PROFILE - DRAINLINE 1

Scale: Horiz. 1" = 20'
Vert. 1" = 4'

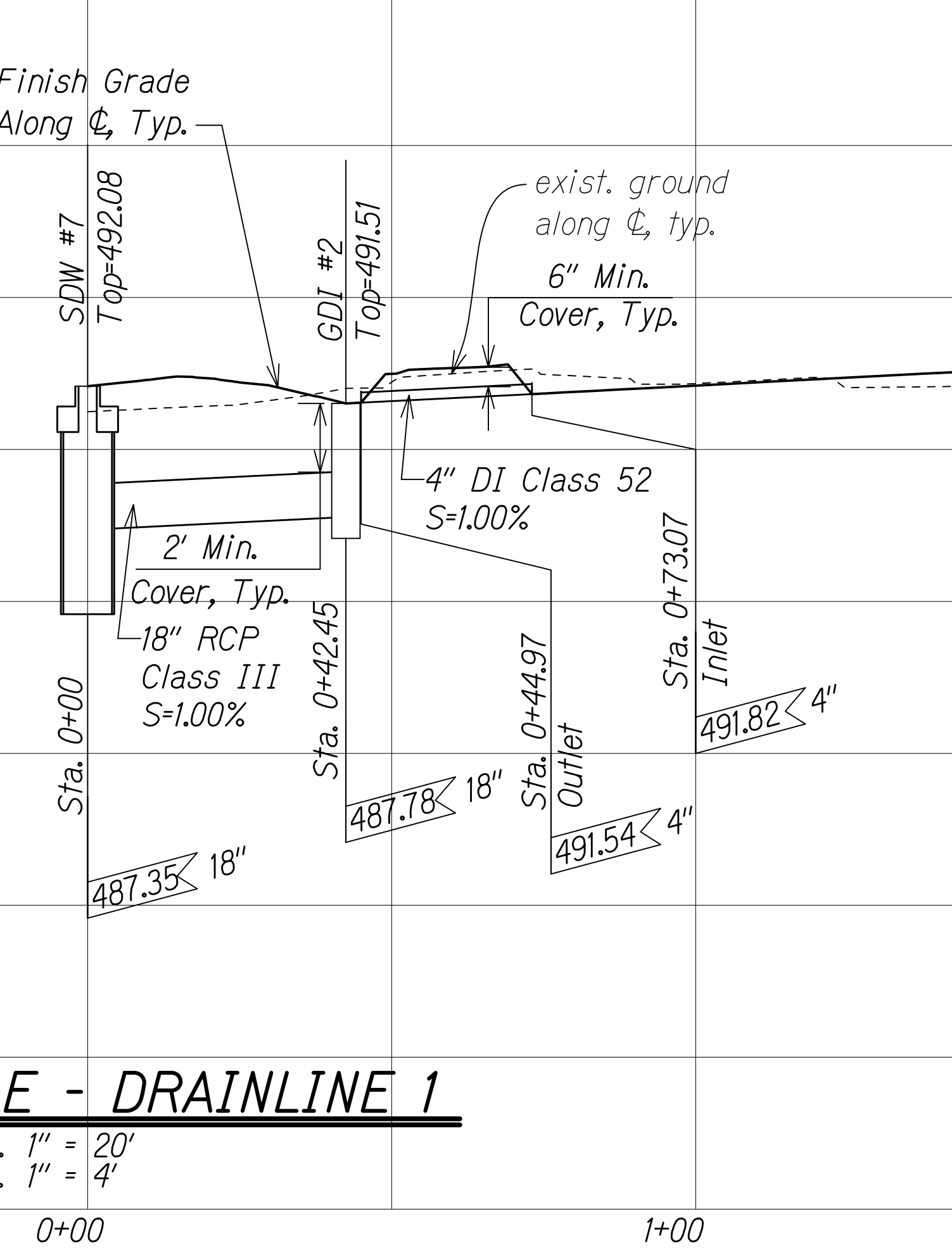

PROFILE - DRAINLINE 2

Scale: Horiz. 1" = 20'
Vert. 1" = 4'

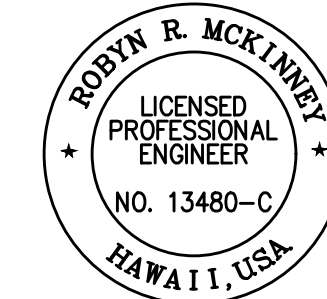
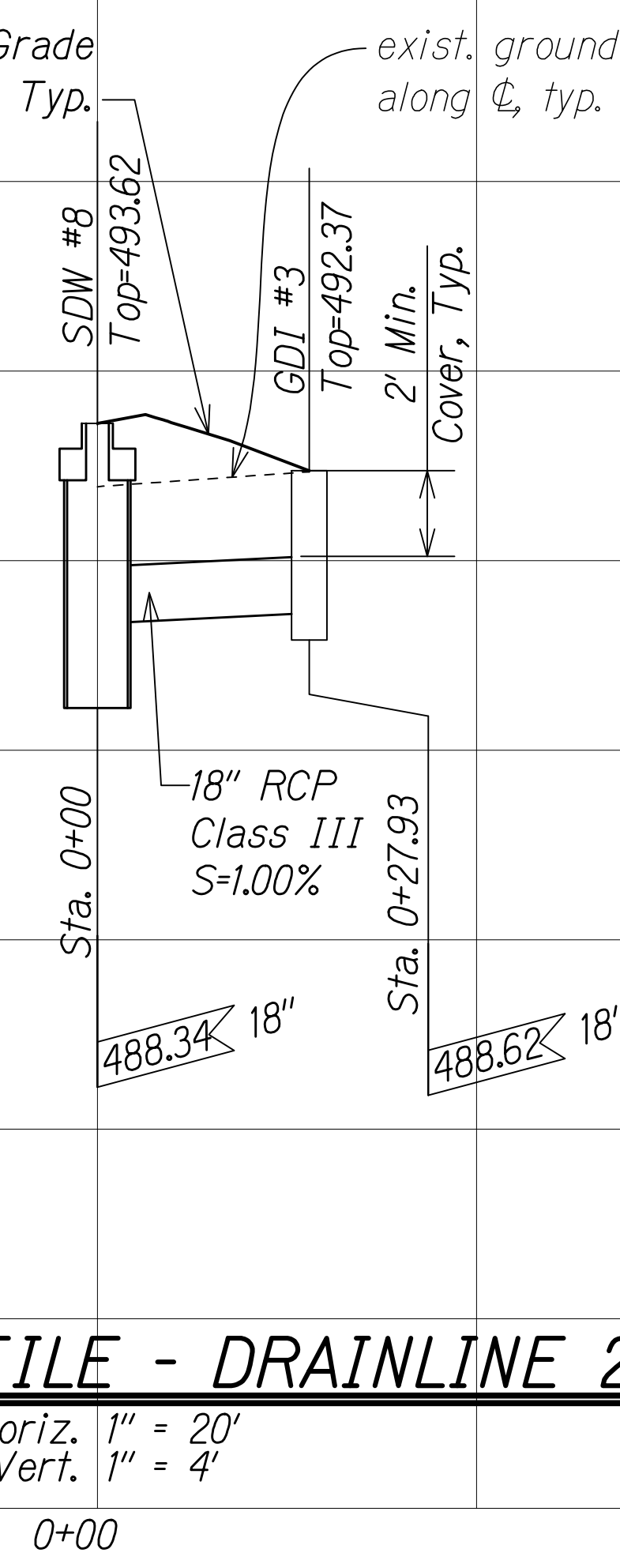

THIS WORK WAS PREPARED BY ME OR UNDER MY SUPERVISION AND CONSTRUCTION OF THIS PROJECT WILL BE UNDER MY OBSERVATION.

Robin R. McKinney
SIGNATURE

04/30/20
EXPIRATION DATE OF THE LICENSE

12/16/19 **1** Added Sheet

DATE REVISION

C:\CIVIL 3D PROJECTS\2012_153.000_KEAAU-PAHOA RD IMPR RTE130\ROUNDABOUT DESIGN\ASBUILT DRAWINGS\01_AINALOA 34S1 DRAINLINE ENP.DWG 3/3/2021 11:09 AM KSAW