

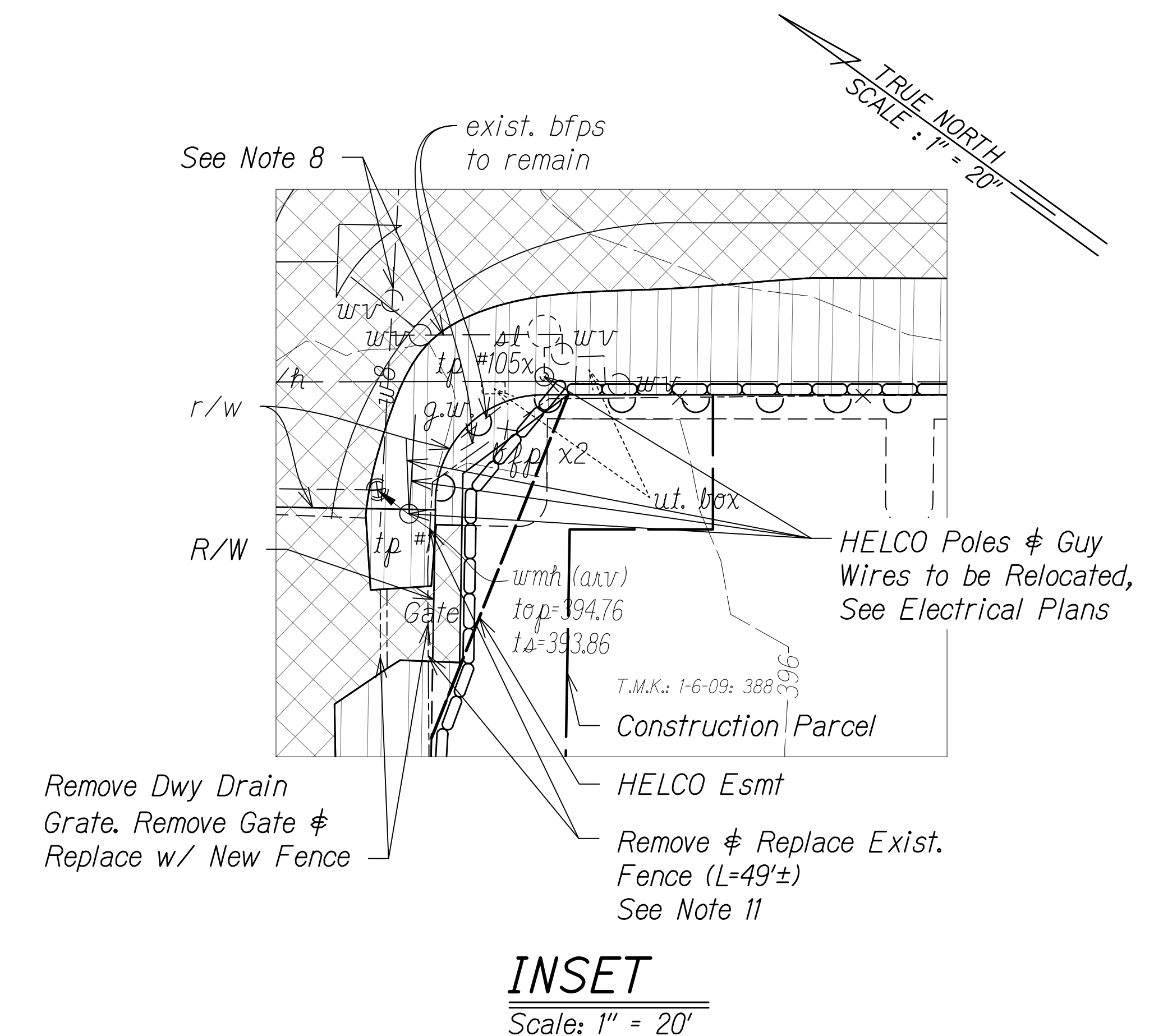

FED. ROAD DIST. NO.	STATE	FED-AID PROJ. NO.	FISCAL YEAR	SHEET NO.	TOTAL SHEETS
HAWAII	HAW.	STP-0130(27)	2021	26	116

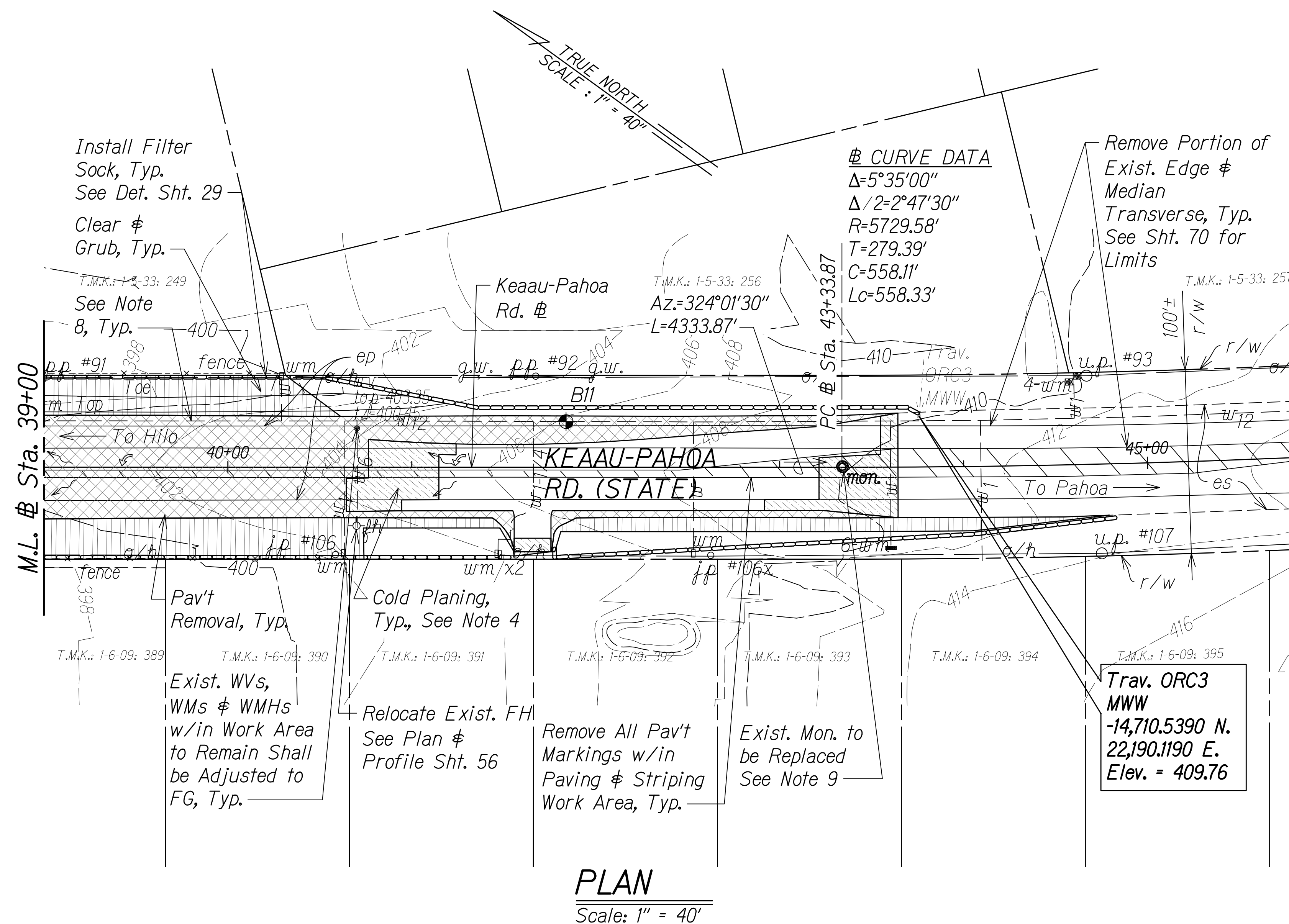

NOTES:

1. *Sediment and Erosion Control BMP measures shown in the Contract Documents are minimum BMPs requirements and do not constitute an acceptable and/or complete Sediment and Erosion Control Plan. The Contractor shall incorporate additional BMPs based upon their means and methods considering site conditions and construction sequence in accordance with the Contract Documents including applicable permit document requirements. Cost shall be included in Pay Item 209.0100, Installation, Maintenance, Monitoring, and Removal of BMP.*
2. *The Contractor shall take proper precautions and make necessary measures to ensure compliance to all applicable but not limited to Federal, State, and HDOT guidelines.*
3. *Limits of resurfacing and pavement reconstruction are shown in Roadway Plans Shts. 37 to 40.*
4. *Limits of cold planing shown are approximate only. Contractor to verify limits in field.*
5. *Removal/relocation and any other sign-related works resulting from the proposed improvements are shown in the Pavement Marking and Signing Plans Shts. 63 to 74.*
6. *Provide inlet protection around proposed inlets once in place. See location in Roadway Plans.*
7. *For utility pole removal or relocation, see Electrical Plans.*
8. *For waterline relocation, see Waterline Plan and Profile Shts. 58 to 60.*
9. *All existing monuments to be replaced shall be flushed to Finish Grade. See Roadway Plan and Profile Shts. 31 to 32.*
10. *All existing fences, gates, and other safety devices such as guardrails and signs shall remain in place and remain effective for as long as possible before removal becomes necessary.*
11. *Provide temporary fencing until permanent fence is installed.*

GRAPHIC SCALES:

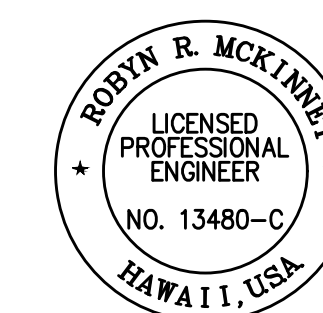
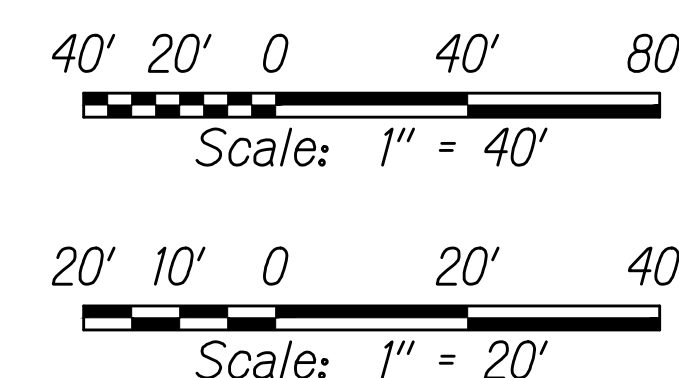

THIS WORK WAS PREPARED BY ME  
OR UNDER MY SUPERVISION AND  
CONSTRUCTION OF THIS PROJECT  
WILL BE UNDER MY OBSERVATION.

Robert McKinney 04/30/22  
SIGNATURE EXPIRATION DATE  
OF THE LICENSE

STATE OF HAWAII  
DEPARTMENT OF TRANSPORTATION  
HIGHWAYS DIVISION

**DEMOLITION AND EROSION**  
**CONTROL PLAN**  
**KEAAU-PAHOA ROAD**  
**INTERSECTION IMPROVEMENTS**  
**at Orchidland Drive & Makuu Drive**  
**Federal-Aid Project No. STP-0130(27)**

Scale: As Noted      Date: Sept, 2020

SHEET No. 2 OF 5 SHEETS



FED. ROAD DIST. NO.	STATE	FED-AID PROJ. NO.	FISCAL YEAR	SHEET NO.	TOTAL SHEETS
HAWAII	HAW.	STP-0130(27)	2021	27	116

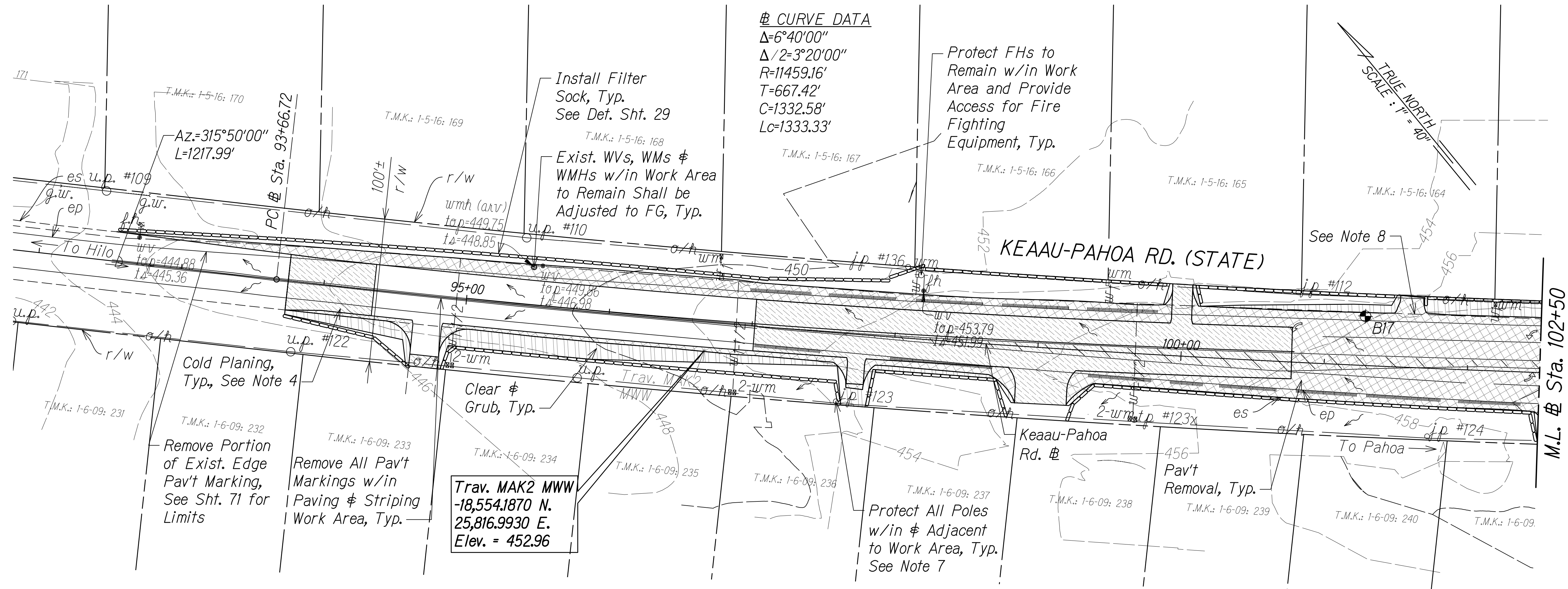

**NOTES:**

1. Sediment and Erosion Control BMP measures shown in the Contract Documents are minimum BMPs requirements and do not constitute an acceptable and/or complete Sediment and Erosion Control Plan. The Contractor shall incorporate additional BMPs based upon their means and methods considering site conditions and construction sequence in accordance with the Contract Documents including applicable permit document requirements. Cost shall be included in Pay Item 209.0100, Installation, Maintenance, Monitoring, and Removal of BMP.
2. The Contractor shall take proper precautions and make necessary measures to ensure compliance to all applicable but not limited to Federal, State, and HDOT guidelines.
3. Limits of resurfacing and pavement reconstruction are shown in Roadway Plans Shts. 41 to 45.
4. Limits of cold planing shown are approximate only. Contractor to verify limits in field.
5. Removal/relocation and any other sign-related works resulting from the proposed improvements are shown in the Pavement Marking and Signing Plans Shts. 63 to 74.
6. Provide inlet protection around proposed inlets once in place. See location in Roadway Plans.
7. For utility pole removal or relocation, see Electrical Plans.
8. For waterline relocation, see Waterline Plan and Profile Shts. 61 to 62.
9. All existing fences, gates, and other safety devices such as guardrails and signs shall remain in place and remain effective for as long as possible before removal becomes necessary.

**GRAPHIC SCALE:**

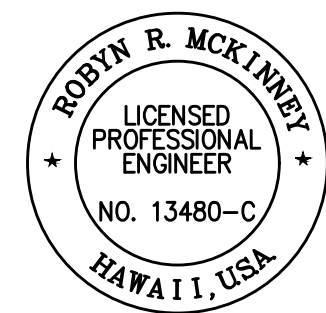
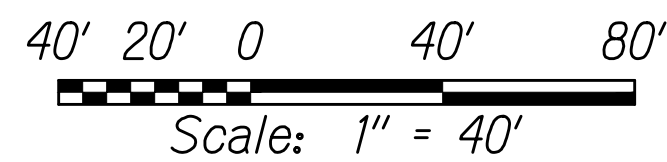

THIS WORK WAS PREPARED BY ME OR UNDER MY SUPERVISION AND CONSTRUCTION OF THIS PROJECT WILL BE UNDER MY OBSERVATION.

SIGNATURE: *Rodney R. McKinney* 04/30/22  
EXPIRATION DATE OF THE LICENSE

STATE OF HAWAII  
DEPARTMENT OF TRANSPORTATION  
HIGHWAYS DIVISION

**DEMOLITION AND EROSION  
CONTROL PLAN**  
KEAAU-PAHOA ROAD  
INTERSECTION IMPROVEMENTS  
at Orchidland Drive & Makuu Drive  
Federal-Aid Project No. STP-0130(27)

Scale: 1" = 40'      Date: Sept, 2020

SHEET No. 3 OF 5 SHEETS

FED. ROAD DIST. NO.	STATE	FED-AID PROJ. NO.	FISCAL YEAR	SHEET NO.	TOTAL SHEETS
HAWAII	HAW.	STP-0130(27)	2021	28	116

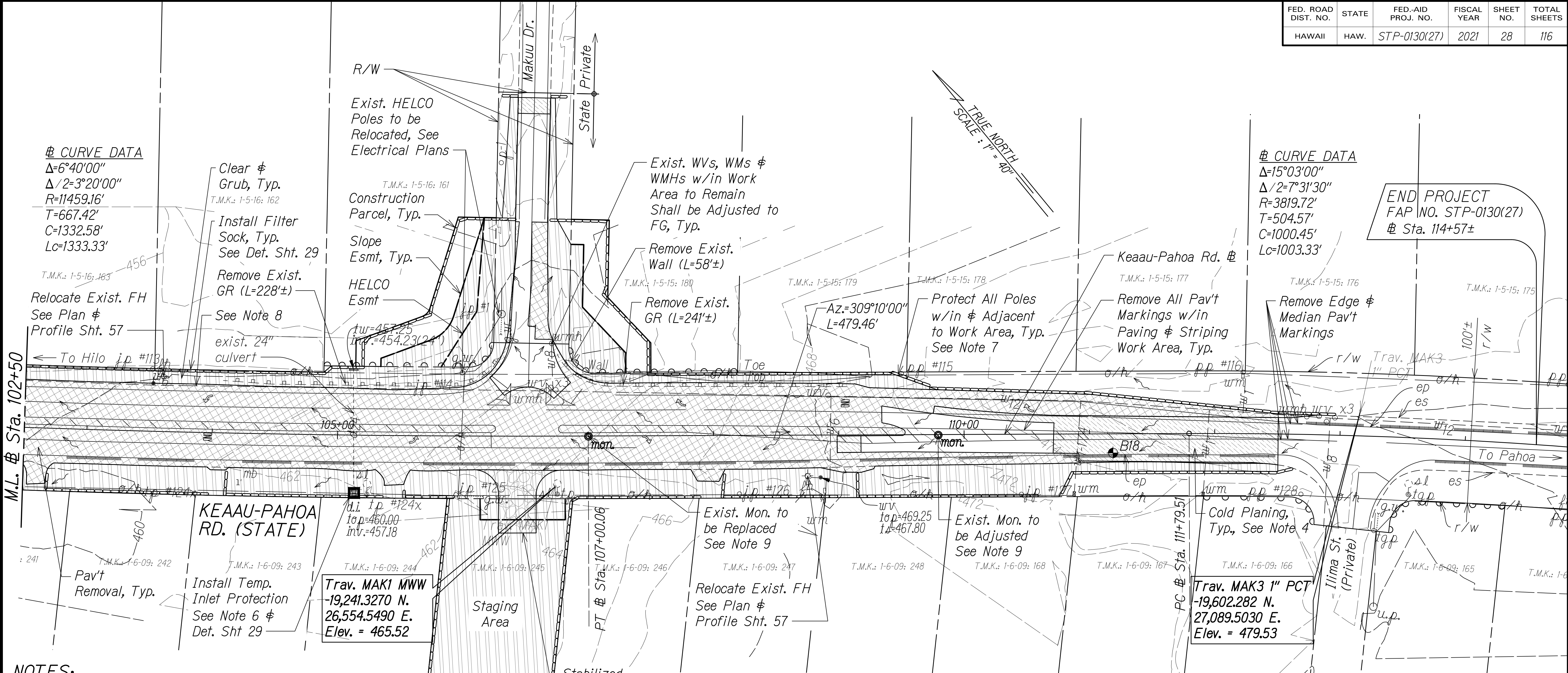

**NOTES:**

- Sediment and Erosion Control BMP measures shown in the Contract Documents are minimum BMPs requirements and do not constitute an acceptable and/or complete Sediment and Erosion Control Plan. The Contractor shall incorporate additional BMPs based upon their means and methods considering site conditions and construction sequence in accordance with the Contract Documents including applicable permit document requirements. Cost shall be included in Pay Item 209.0100, Installation, Maintenance, Monitoring, and Removal of BMP.
- The Contractor shall take proper precautions and make necessary measures to ensure compliance to all applicable but not limited to Federal, State, and HDOT guidelines.
- Limits of resurfacing and pavement reconstruction are shown in Roadway Plans Shts. 41 to 45.
- Limits of cold planing shown are approximate only. Contractor to verify limits in field.
- Removal/relocation and any other sign-related works resulting from the proposed improvements are shown in the Pavement Marking and Signing Plans Shts. 63 to 74.
- Provide inlet protection around proposed inlets once in place. See location in Roadway Plans.
- For utility pole removal or relocation, see Electrical Plans.
- For waterline relocation, see Waterline Plan and Profile Shts. 61 to 62.
- All existing monuments that are either to be replaced by new or adjusted shall be flushed to Finish Grade. See Roadway Plan and Profile, Shts. 33 to 34.
- All existing fences, gates, and other safety devices such as guardrails and signs shall remain in place and remain effective for as long as possible before removal becomes necessary.
- The Contractor shall inspect and clean all drain culverts within the project limits as directed by the Engineer and shall be paid under Item No. 603.0100 Clean Existing Culverts.

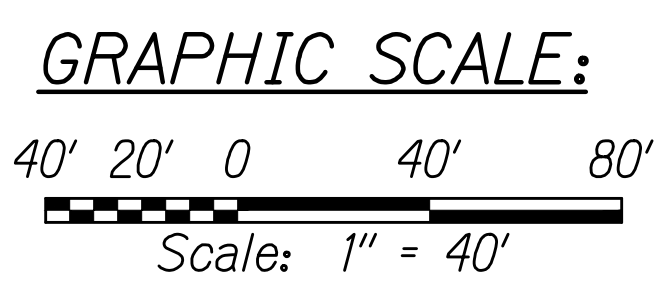

THIS WORK WAS PREPARED BY ME OR UNDER MY SUPERVISION AND CONSTRUCTION OF THIS PROJECT WILL BE UNDER MY OBSERVATION.

*Robyn R. McKinney* 04/30/22  
SIGNATURE EXPIRATION DATE OF THE LICENSE

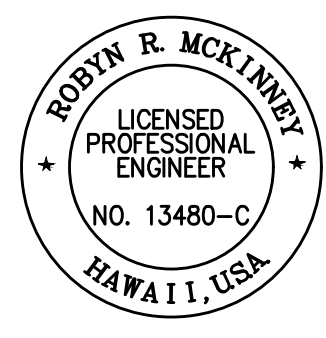

STATE OF HAWAII  
DEPARTMENT OF TRANSPORTATION  
HIGHWAYS DIVISION

**DEMOLITION AND EROSION CONTROL PLAN**

KEAAU-PAHOA ROAD  
INTERSECTION IMPROVEMENTS  
at Orchidland Drive & Makuu Drive  
Federal-Aid Project No. STP-0130(27)

Scale: 1" = 40' Date: Sept, 2020

SHEET No. 4 OF 5 SHEETS



FED. ROAD DIST. NO.	STATE	FED-AID PROJ. NO.	FISCAL YEAR	SHEET NO.	TOTAL SHEETS
HAWAII	HAW.	STP-0130(27)	2021	29	116

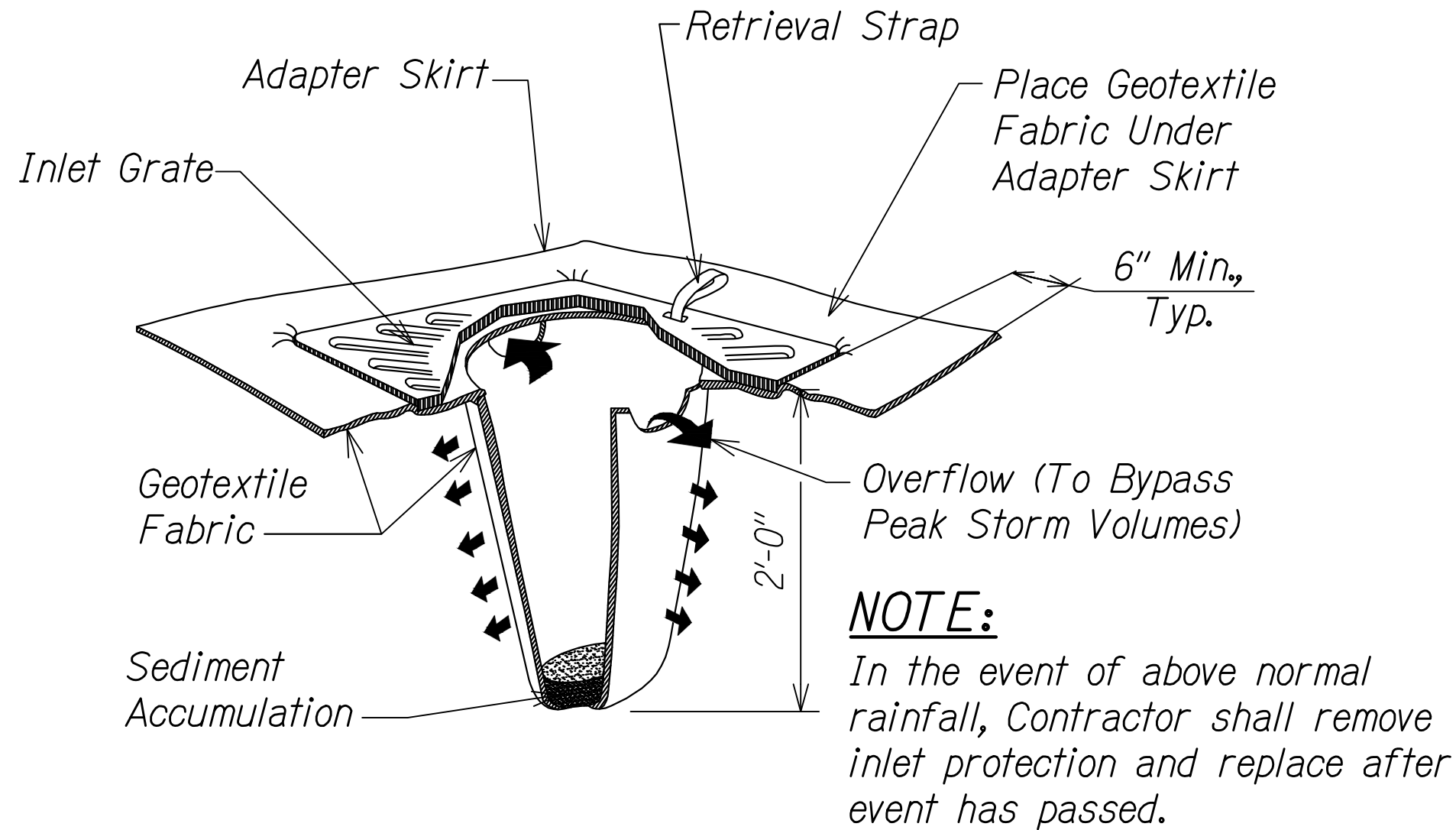

### TEMPORARY INLET PROTECTION

Not to Scale

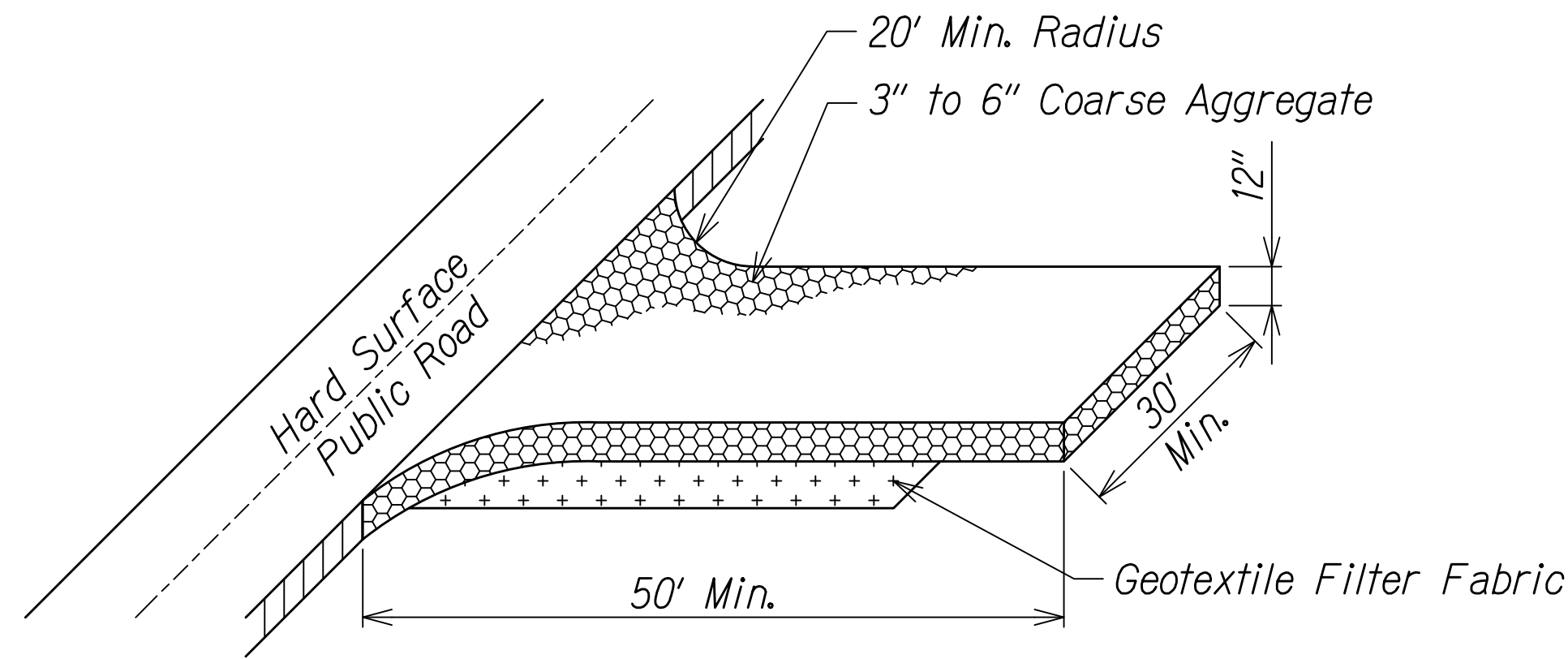

#### NOTES:

- All points of egress and ingress to the site shall be protected with a stabilized construction entrance.
- A manufactured rumble strip covering the full width of the construction entrance may be used in place of coarse aggregate. A manufactured rumble strip shall be built on a stable base over geotextile fabric and will be of adequate length to encompass one full tire rotation of all vehicles entering and exiting the site. Rumble strips shall be maintained on at least a weekly basis and remain free of compacted rock.

### STABILIZED CONSTRUCTION ENTRANCE

Not to Scale

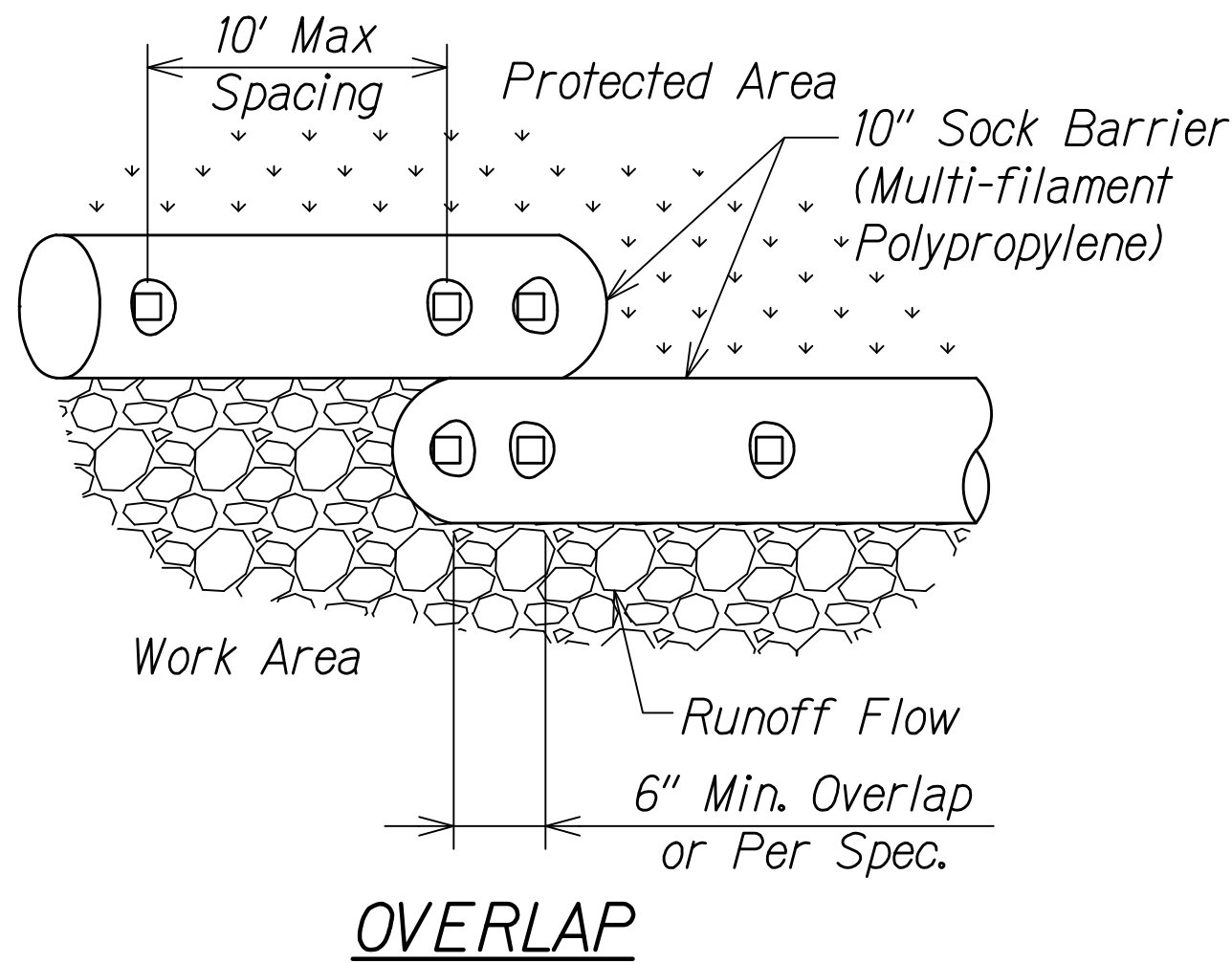
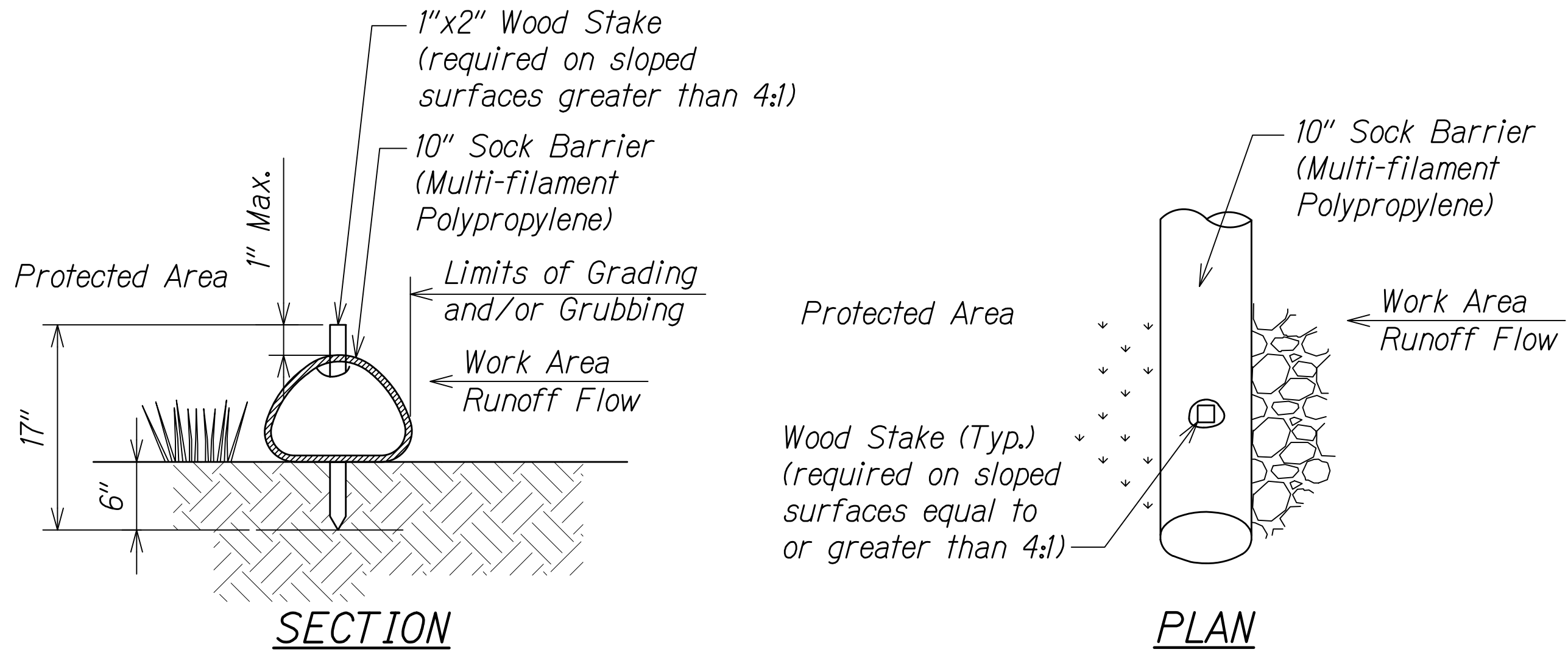

SLOPE GRADIENT	ANCHOR SPACING
<4:1	Not Required
4:1 to 3:1	10'
>3:1 to 2:1	5' to 10'
>2:1	5'

#### NOTES:

- Fill composition is wood mulch.
- Fill shall not contain biosolids and should be consistent with EPA Guidelines.

### FILTER SOCK BARRIER

Not to Scale

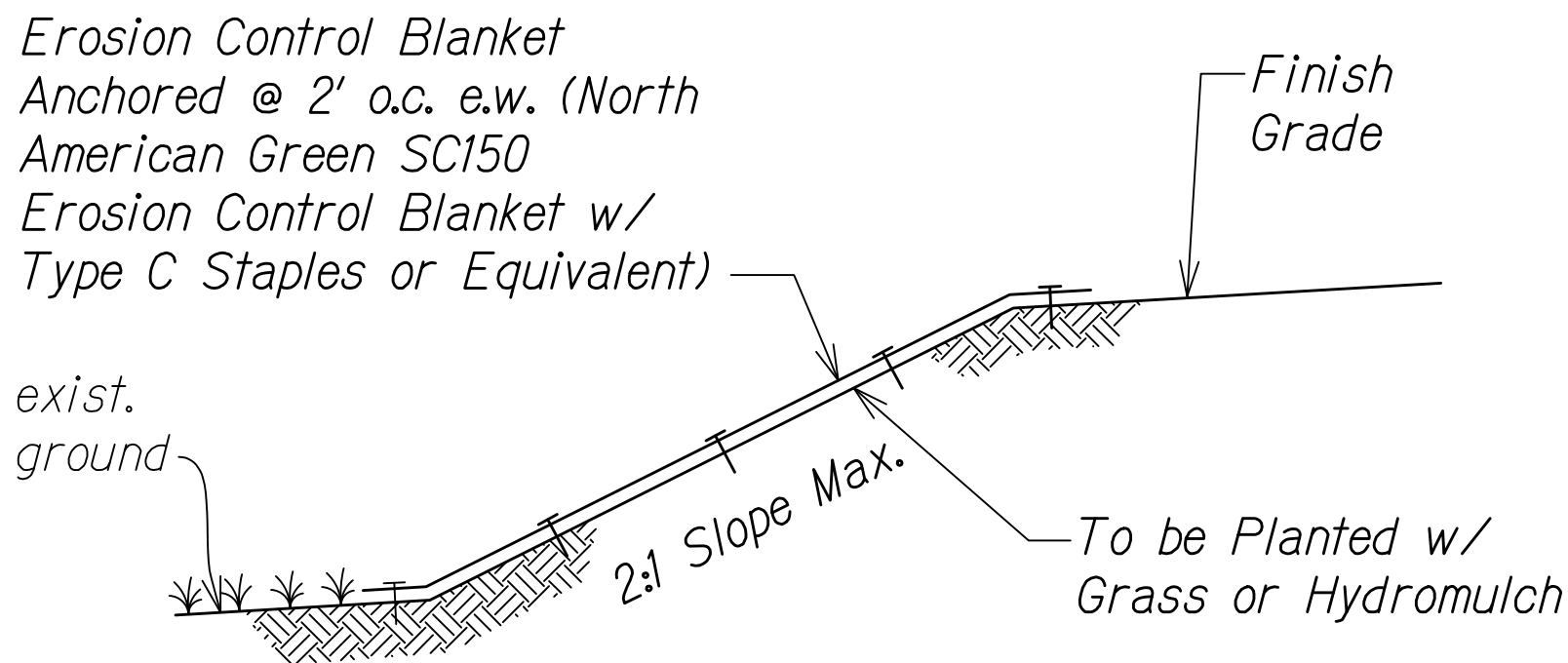

### PERMANENT SLOPE PROTECTION

Not to Scale

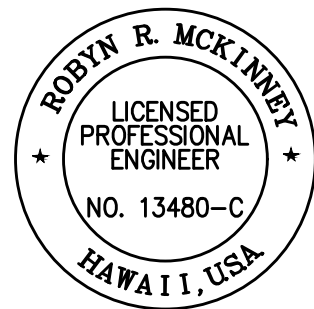

THIS WORK WAS PREPARED BY ME OR UNDER MY SUPERVISION AND CONSTRUCTION OF THIS PROJECT WILL BE UNDER MY OBSERVATION.

SIGNATURE: *Rodyn McKinney* 04/30/22  
EXPIRATION DATE OF THE LICENSE

STATE OF HAWAII  
DEPARTMENT OF TRANSPORTATION  
HIGHWAYS DIVISION

**EROSION CONTROL DETAILS**

KEAAU-PAHOA ROAD  
INTERSECTION IMPROVEMENTS  
at Orchidland Drive & Makuu Drive  
Federal-Aid Project No. STP-0130(27)

Scale: Not to Scale      Date: Sept, 2020

SHEET No. 5 OF 5 SHEETS