

LEGEND FOR AS-BUILT POSTINGS

~~~~~ Squiggly line for as-built deletion

±±±±± Double line for as-built deletion

Roadway Text for as-built posting

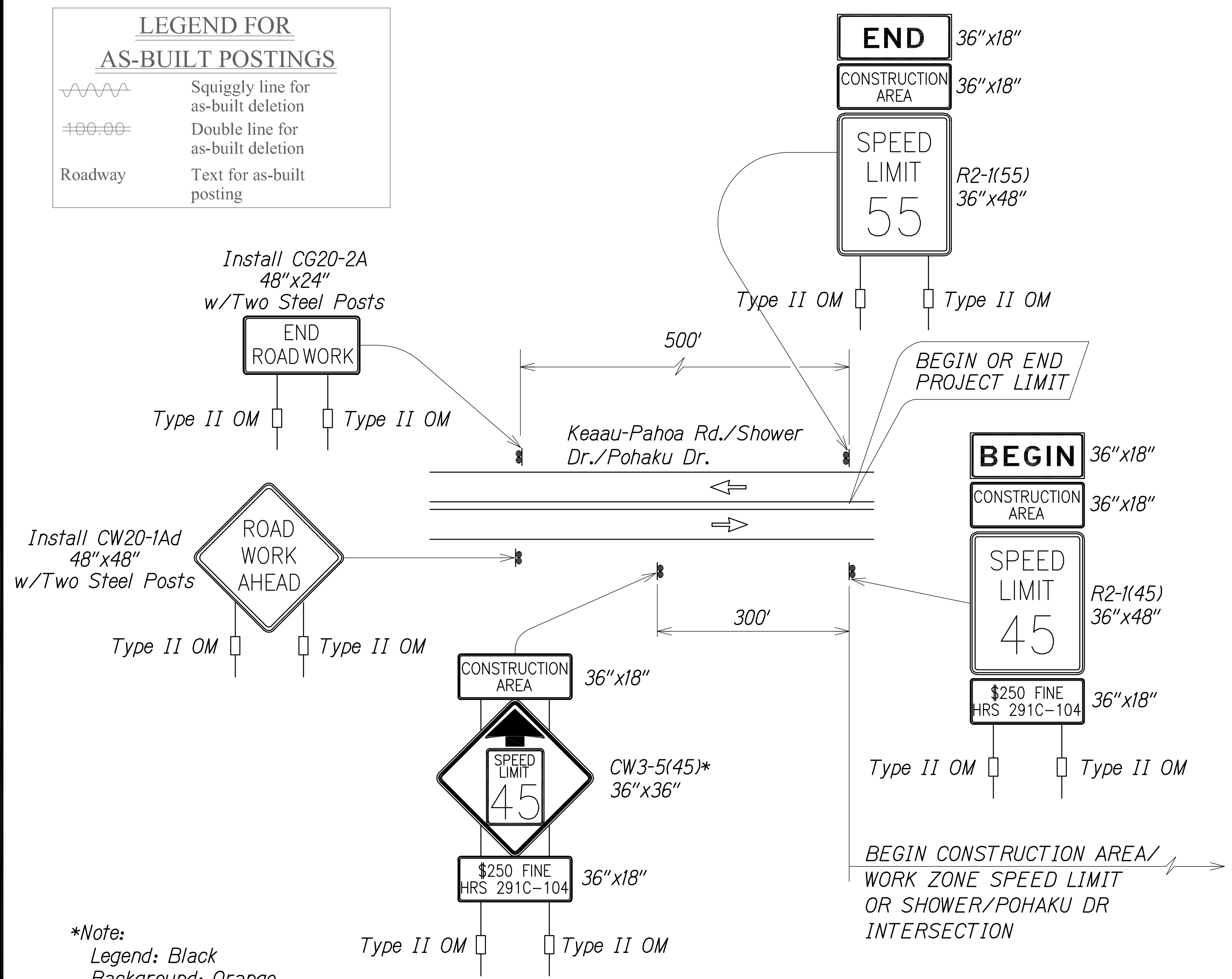

\*Note:  
 Legend: Black  
 Background: Orange  
 Speed Limit: Black on White

**TYPICAL DETAIL FOR CONSTRUCTION SIGNS ON TWO LANE OR MULTILANE UNDIVIDED HIGH SPEED HIGHWAY**

**Work Zone Notes:**

1. This Work Zone Sign Plan is intended for use on long-term stationary work zones/construction phases (3 days or more). All work zones or construction phases less than 3 days duration will use Traffic Control Plans shown in Section 645 of the Special Provisions.
2. All existing regulatory speed limit signs with posts within the work zone/project limits shall be removed and replaced with work zone speed limit sign assemblies (R2-1(XX) and CW3-5(XX) with "CONSTRUCTION AREA" and "\$250 FINE HRS 291C-104" Supplemental Signs).
3. Construction sign assemblies shall be installed on both the approaching and trailing ends of each work zone as shown on this plan.
4. Each construction warning sign and work zone speed limit assembly shall have a minimum of two (2) Type II OM. Installation of each Type II OM shall be considered incidental to Item No. 621.7100, Construction Sign with Posts.
5. Upon the completion of all physical work or as directed by the Engineer, all construction signs and work zone speed limit assemblies shall be removed. All speed limit signs and posts that were existing at the start of the project within the work zone/project limits shall be restored back to their original locations and configurations.
6. Placement of construction signs shall not obstruct the path of pedestrians and bicyclists.
7. The removal and restoration of existing regulatory speed limit signs with new posts along with the installation, maintenance and removal of work zone speed limit sign assemblies shall be considered incidental to Item No. 621.7100, Construction Sign with Posts.

**TABLE I**  
 GUIDELINE FOR ADVANCE PLACEMENT OF SPEED REDUCTION SIGN CW3-5(XX), CONSTRUCTION AREA SPEED LIMIT

| EXISTING POSTED SPEED LIMIT (MPH) | XX-NEW CONSTRUCTION AREA SPEED LIMIT (MPH) | D-REDUCED SPEED LIMIT SIGN SPACING TO FIRST CONSTRUCTION AREA SPEED LIMIT SIGN (FEET) |
|-----------------------------------|--------------------------------------------|---------------------------------------------------------------------------------------|
| 45                                | 35                                         | 225                                                                                   |
| 50                                | 40                                         | 225                                                                                   |
| 55                                | 45                                         | 300                                                                                   |



THIS WORK WAS PREPARED BY ME OR UNDER MY SUPERVISION.  
 APRIL 30, 2018  
 WILSON OKAMOTO CORPORATION LIC. EXP. DATE

|                   |      |
|-------------------|------|
| SURVEY PLOTTED BY | DATE |
| DRAWN BY          |      |
| TRACED BY         |      |
| QUANTITIES BY     |      |
| CHECKED BY        |      |
| ORIGINAL PLAN     |      |
| NOTE BOOK         |      |
| No.               |      |

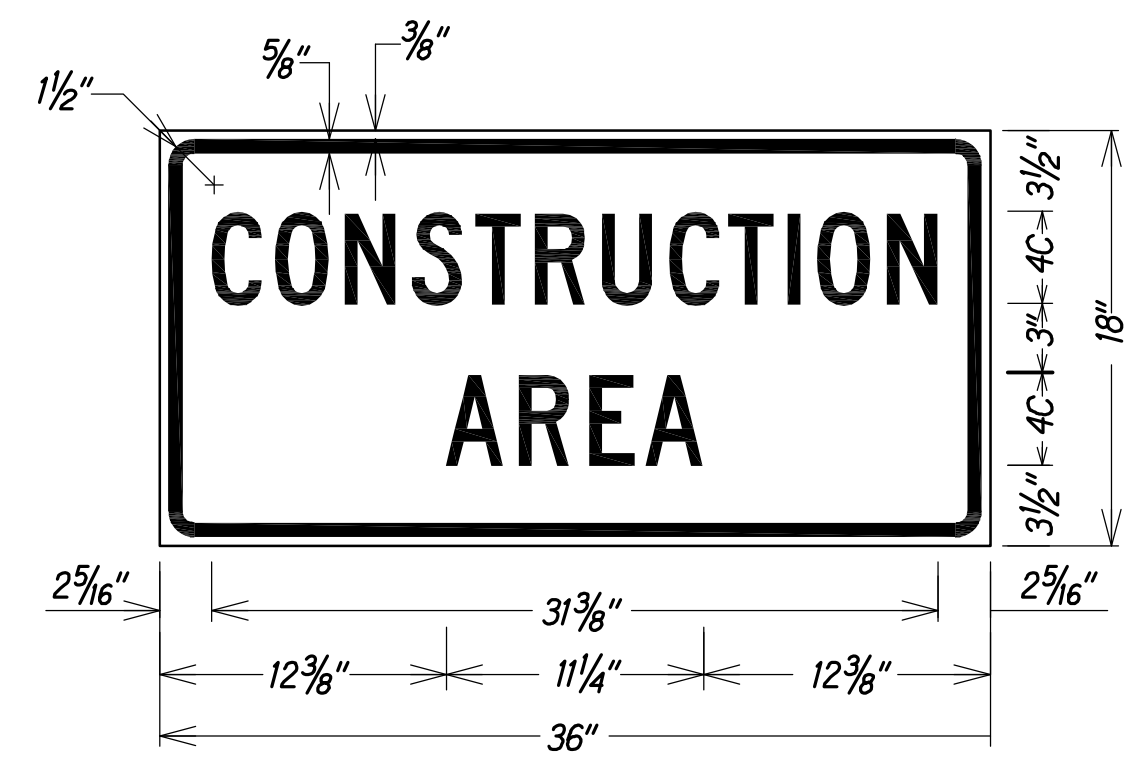

LEGEND: BLACK  
 BACKGROUND: ORANGE

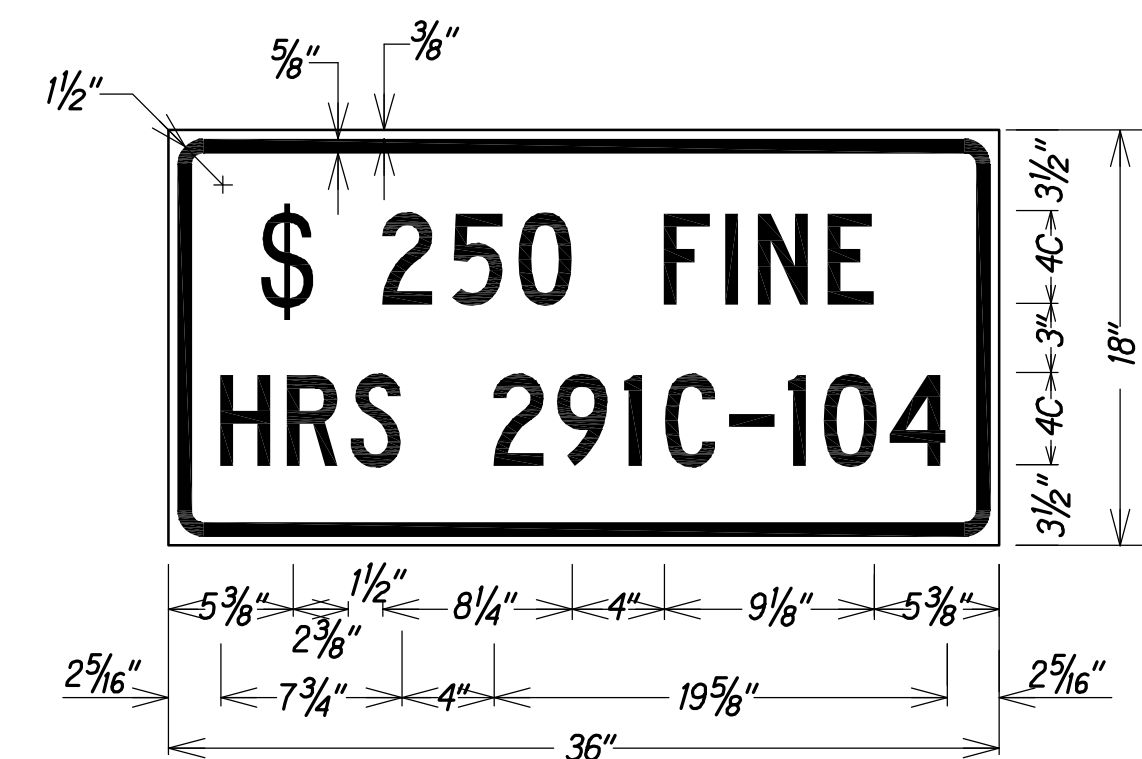

LEGEND: BLACK  
 BACKGROUND: WHITE

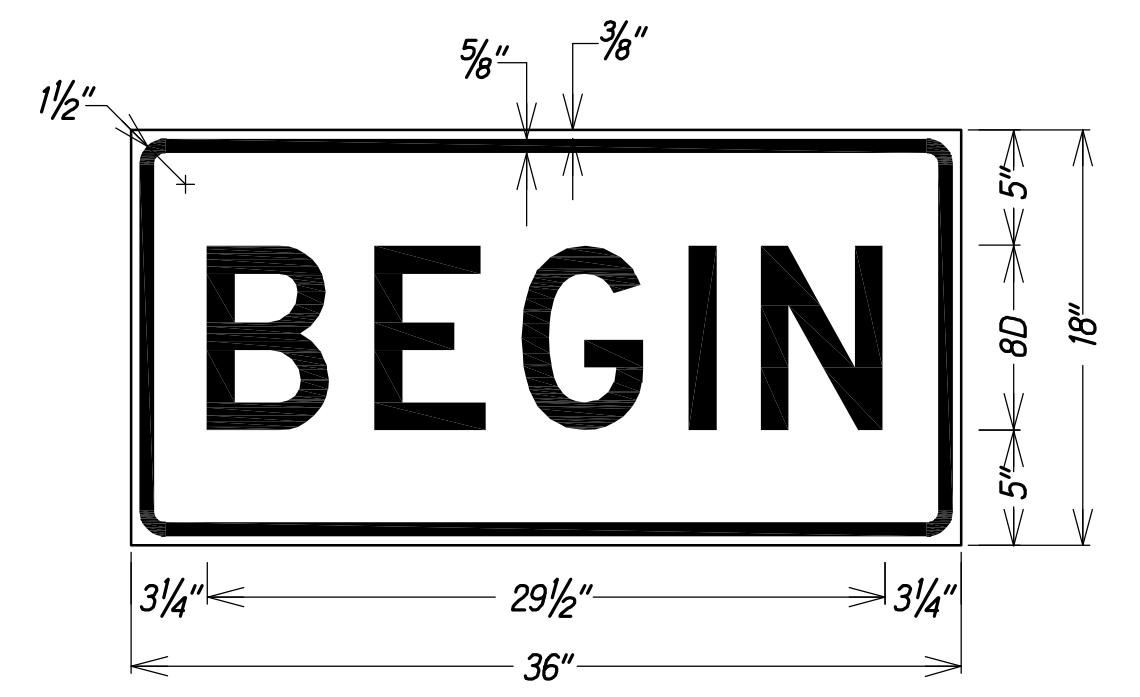

LEGEND: BLACK  
 BACKGROUND: ORANGE

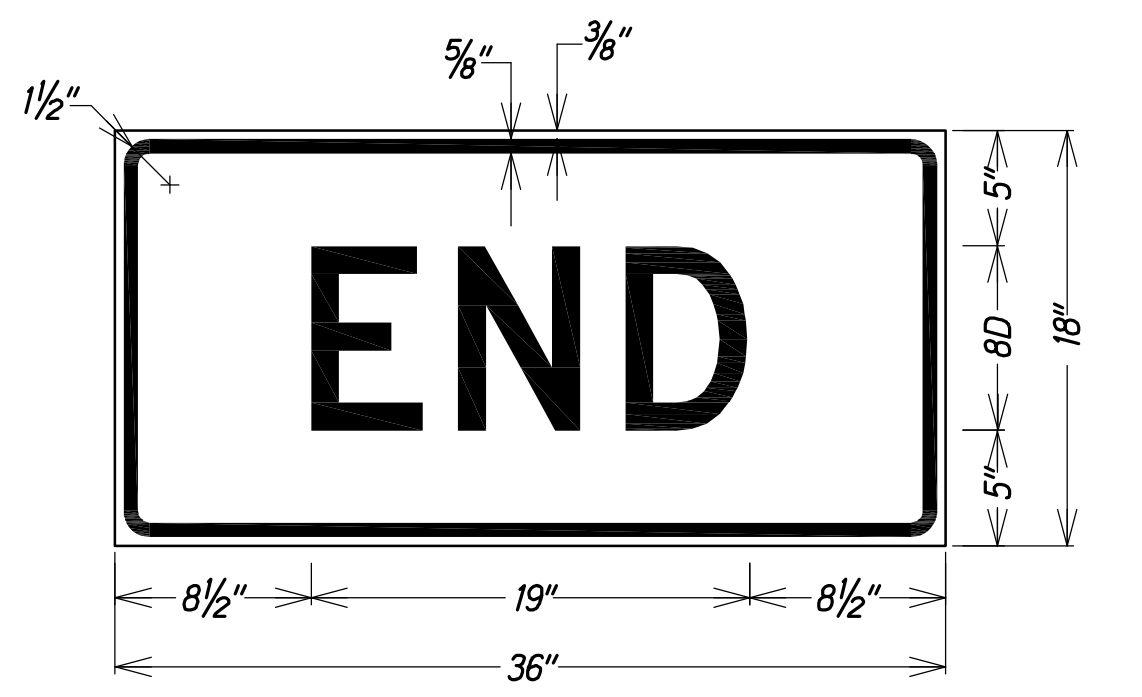

LEGEND: BLACK  
 BACKGROUND: ORANGE

STATE OF HAWAII  
 DEPARTMENT OF TRANSPORTATION  
 HIGHWAYS DIVISION  
**HIGH SPEED UNDIVIDED HIGHWAY**  
**WORK ZONE SIGNING PLAN, NOTES & DETAILS**  
 KEAAU-PAHOA ROAD, SHOULDER  
 LANE CONVERSION, PHASE 2  
 Shower Drive Intersection Improvements  
 Fed. Aid Proj. No. STP-0130(33)  
 Scale: Date: March 2016

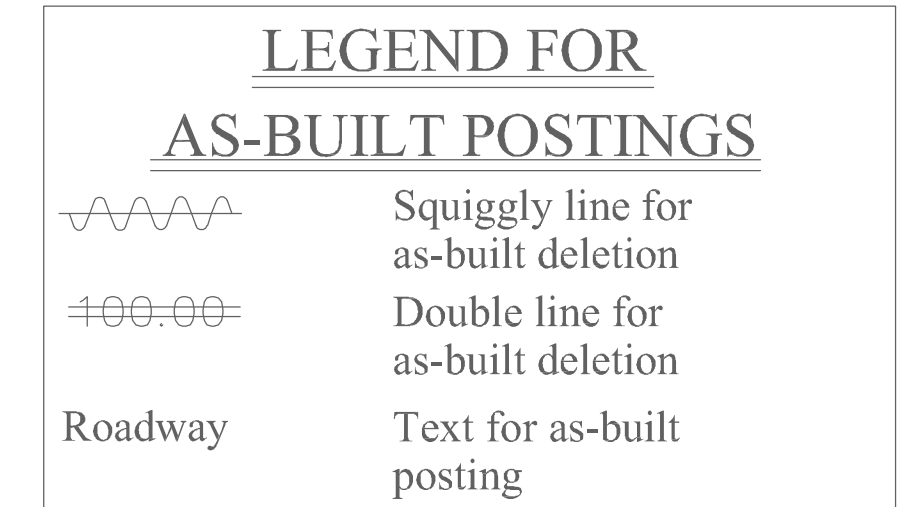
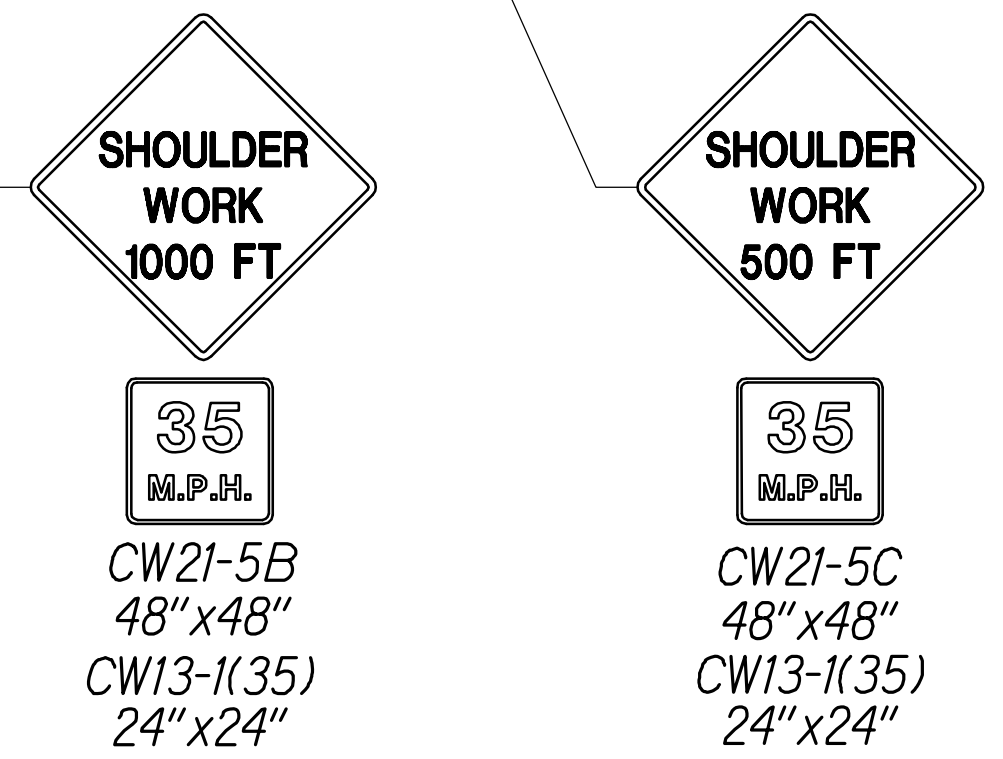
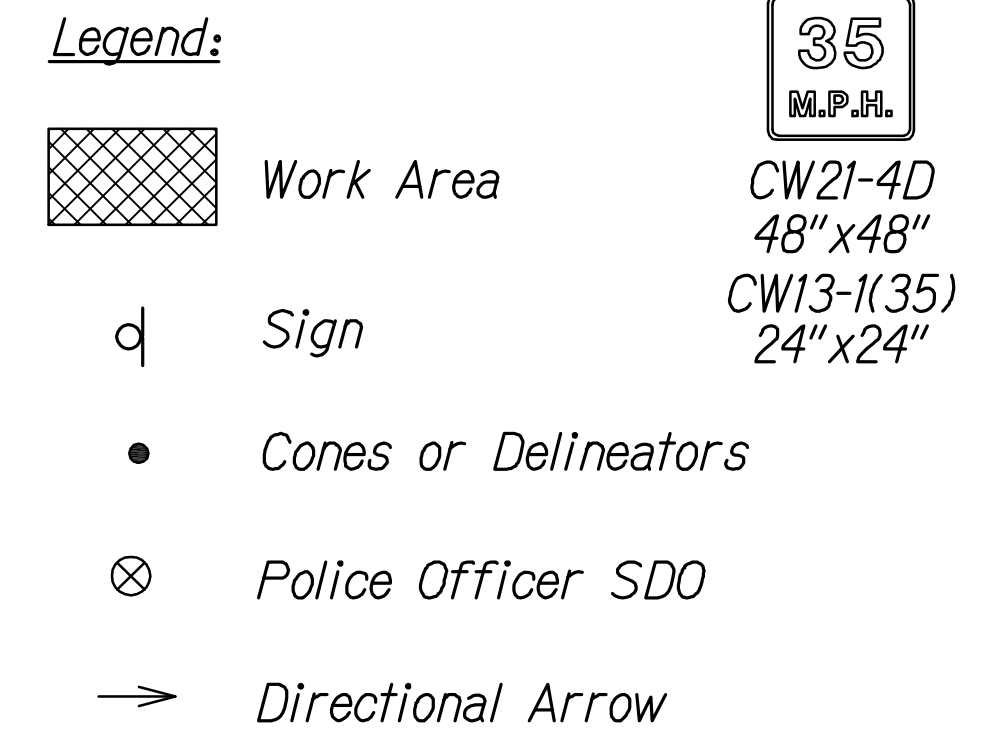
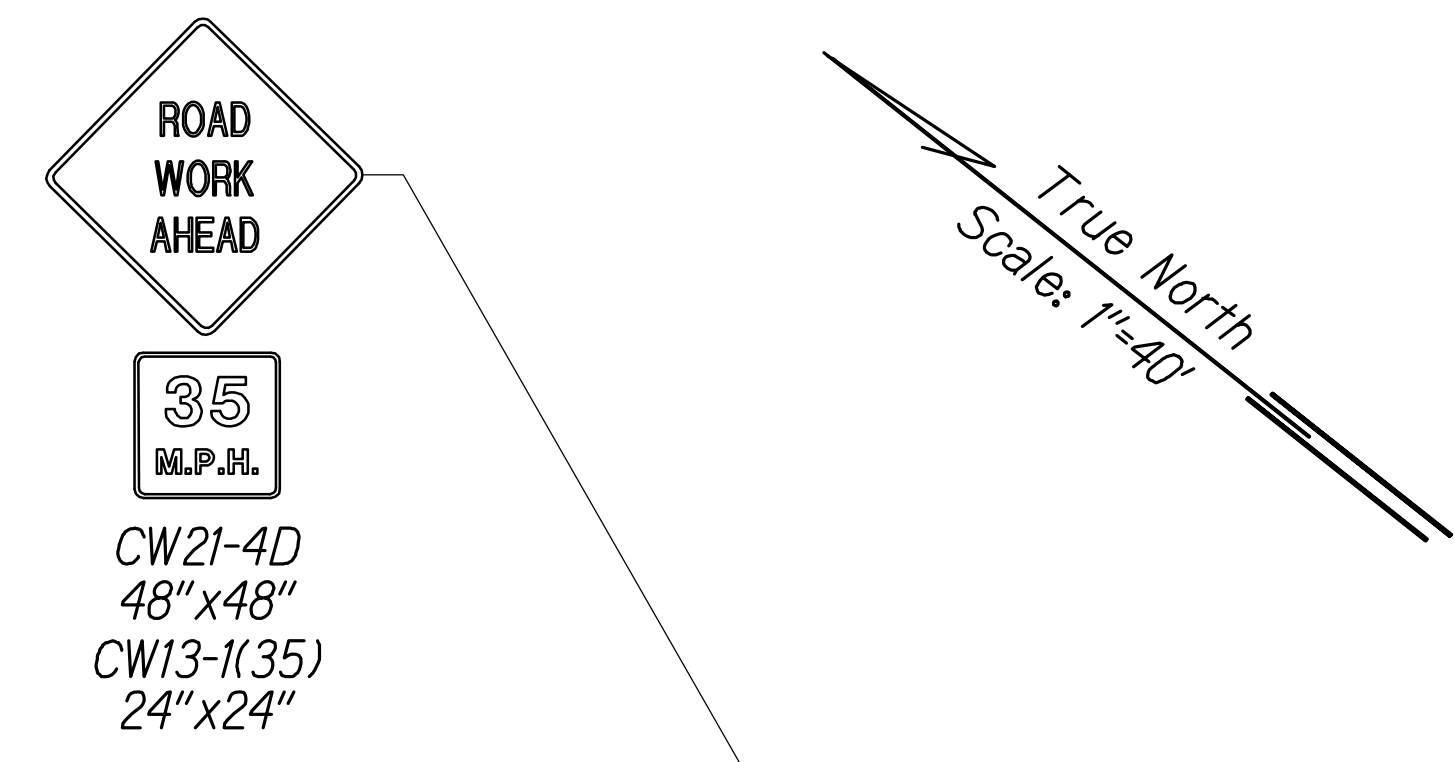
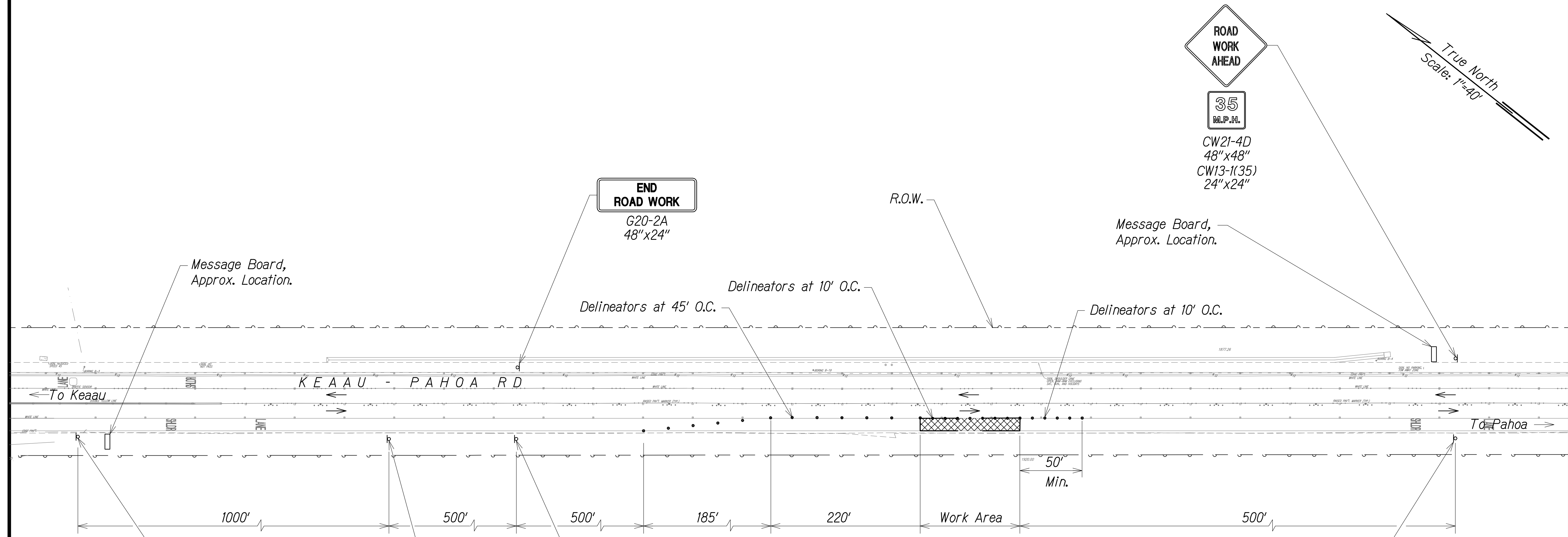

- Note:**
- Contractor Shall Coordinate with D.O.T. for Message on Message Board.
  - Work Hours to Occur Between 8:30a.m. and 2:30p.m. (Monday through Friday).
  - Work Area Limited to 1,000 Feet or Less During Working Hours.

|                   |      |
|-------------------|------|
| SURVEY PLOTTED BY | DATE |
| DRAWN BY          |      |
| TRACED BY         |      |
| QUANTITIES BY     |      |
| CHECKED BY        |      |
| ORIGINAL PLAN     |      |
| NOTE BOOK         |      |
| No.               |      |

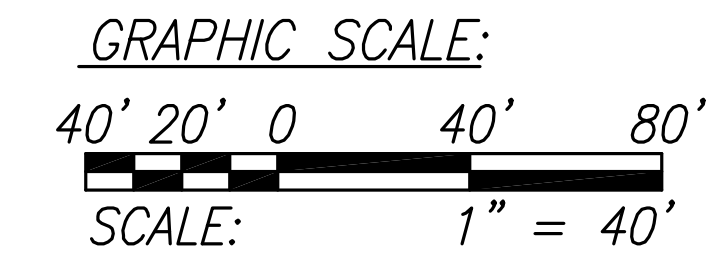

**TRAFFIC CONTROL PLAN - PHASE 1  
FOR WORK ON PAHOA BOUND SHOULDER**  
SCALE: 1" = 40'

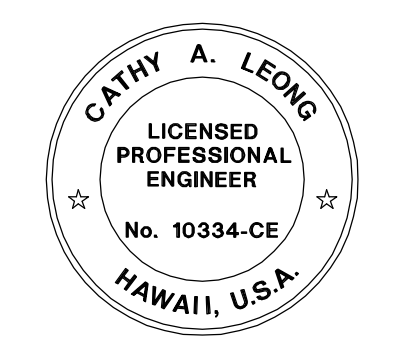

THIS WORK WAS PREPARED BY ME OR UNDER MY SUPERVISION.  
APRIL 30, 2018  
WILSON OKAMOTO CORPORATION LIC. EXP. DATE

STATE OF HAWAII  
DEPARTMENT OF TRANSPORTATION  
HIGHWAYS DIVISION

**TRAFFIC CONTROL PLAN 1**

KEAAU-PAHOA ROAD, SHOULDER LANE CONVERSION, PHASE 2  
Shower Drive Intersection Improvements  
Fed. Aid Proj. No. STP-0130(33)  
Scale: 1"=40' Date: March 2016

SHEET No. TCP-2 OF 15 SHEETS

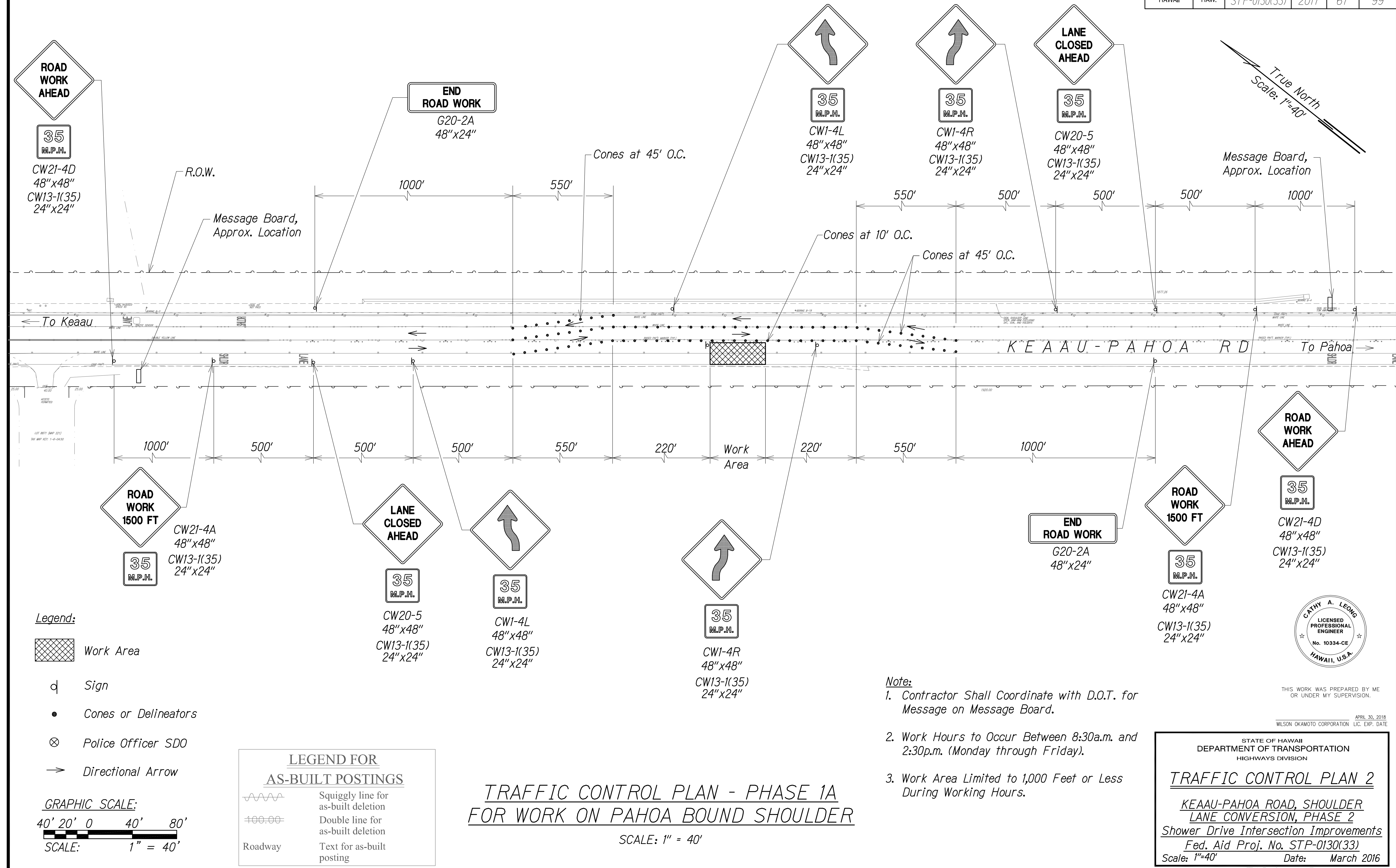

True North  
Scale: 1"=40'

Message Board, Approx. Location

R.O.W.

Message Board, Approx. Location

Cones at 45' O.C.

Cones at 10' O.C.

Cones at 45' O.C.

To Keaau

KEAAU-PAHOA RD To Pahoa

1000' 500' 500' 500' 550' 220' Work Area 220' 550' 1000'

Legend:

- Work Area
- $\square$  Sign
- $\bullet$  Cones or Delineators
- $\otimes$  Police Officer SDO
- $\rightarrow$  Directional Arrow

GRAPHIC SCALE:  
40' 20' 0 40' 80'  
SCALE: 1" = 40'

**LEGEND FOR AS-BUILT POSTINGS**

- Squiggly line for as-built deletion
- Double line for as-built deletion
- Roadway Text for as-built posting

**TRAFFIC CONTROL PLAN - PHASE 1A  
FOR WORK ON PAHOA BOUND SHOULDER**

SCALE: 1" = 40'

- Note:**
- Contractor Shall Coordinate with D.O.T. for Message on Message Board.
  - Work Hours to Occur Between 8:30a.m. and 2:30p.m. (Monday through Friday).
  - Work Area Limited to 1,000 Feet or Less During Working Hours.

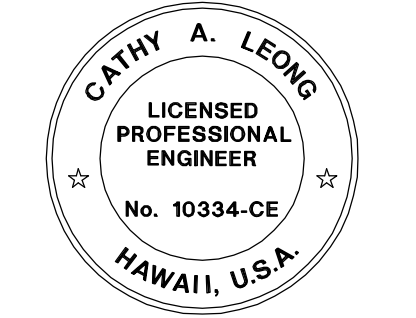

THIS WORK WAS PREPARED BY ME OR UNDER MY SUPERVISION.

APRIL 30, 2018  
WILSON OKAMOTO CORPORATION LIC. EXP. DATE

STATE OF HAWAII  
DEPARTMENT OF TRANSPORTATION  
HIGHWAYS DIVISION

**TRAFFIC CONTROL PLAN 2**

KEAAU-PAHOA ROAD, SHOULDER  
LANE CONVERSION, PHASE 2  
Shower Drive Intersection Improvements  
Fed. Aid Proj. No. STP-0130(33)  
Scale: 1"=40' Date: March 2016

SHEET No. TCP-30F 15 SHEETS

|                   |      |
|-------------------|------|
| SURVEY PLOTTED BY | DATE |
| DRAWN BY          |      |
| TRACED BY         |      |
| QUANTITIES BY     |      |
| CHECKED BY        |      |
| ORIGINAL PLAN     |      |
| NOTE BOOK         |      |
| No.               |      |

|                     |       |                    |             |           |              |
|---------------------|-------|--------------------|-------------|-----------|--------------|
| FED. ROAD DIST. NO. | STATE | FED. AID PROJ. NO. | FISCAL YEAR | SHEET NO. | TOTAL SHEETS |
| HAWAII              | HAW.  | STP-0130(33)       | 2017        | 68        | 99           |

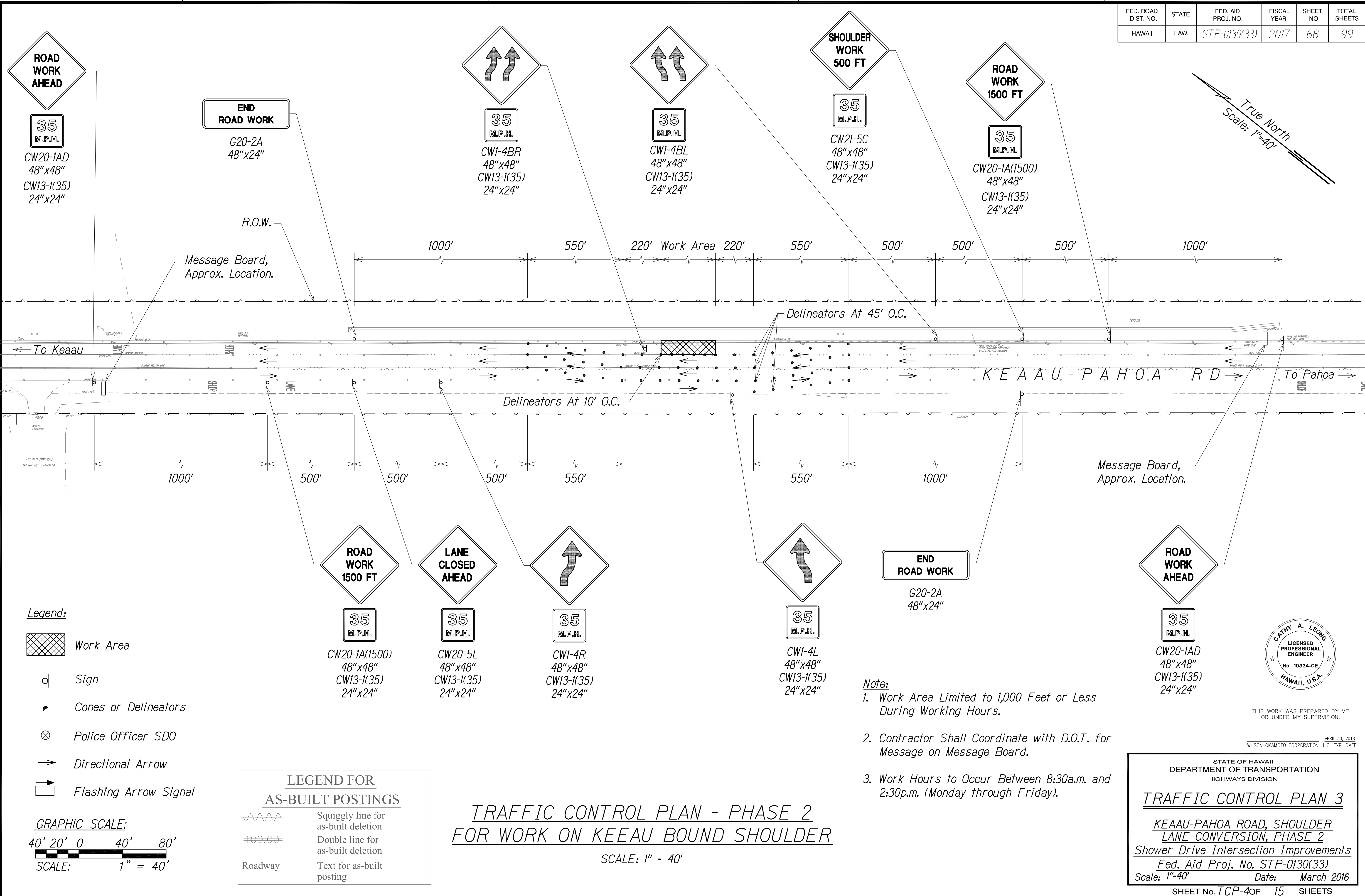

- Legend:**
- Work Area
  - Sign
  - Cones or Delineators
  - Police Officer SDO
  - Directional Arrow
  - Flashing Arrow Signal

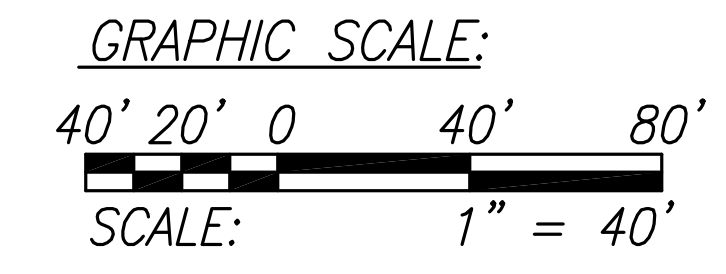

**LEGEND FOR AS-BUILT POSTINGS**

|         |                                     |
|---------|-------------------------------------|
|         | Squiggly line for as-built deletion |
|         | Double line for as-built deletion   |
| Roadway | Text for as-built posting           |

**TRAFFIC CONTROL PLAN - PHASE 2  
FOR WORK ON KEEAU BOUND SHOULDER**

SCALE: 1" = 40'

- Note:**
1. Work Area Limited to 1,000 Feet or Less During Working Hours.
  2. Contractor Shall Coordinate with D.O.T. for Message on Message Board.
  3. Work Hours to Occur Between 8:30a.m. and 2:30p.m. (Monday through Friday).



THIS WORK WAS PREPARED BY ME OR UNDER MY SUPERVISION.

APRIL 30, 2018  
WILSON OKAMOTO CORPORATION LIC. EXP. DATE

STATE OF HAWAII  
DEPARTMENT OF TRANSPORTATION  
HIGHWAYS DIVISION

**TRAFFIC CONTROL PLAN 3**

**KEAAU-PAHOA ROAD, SHOULDER  
LANE CONVERSION, PHASE 2**  
Shower Drive Intersection Improvements  
Fed. Aid Proj. No. STP-0130(33)  
Scale: 1"=40' Date: March 2016

|                   |      |
|-------------------|------|
| SURVEY PLOTTED BY | DATE |
| DRAWN BY          |      |
| TRACED BY         |      |
| QUANTITIES BY     |      |
| CHECKED BY        |      |
| ORIGINAL PLAN     | No.  |
| NOTE BOOK         |      |



**LEGEND FOR AS-BUILT POSTINGS**

~~~~~ Squiggly line for as-built deletion

==== Double line for as-built deletion

Roadway Text for as-built posting

True North
Scale: 1"=40'

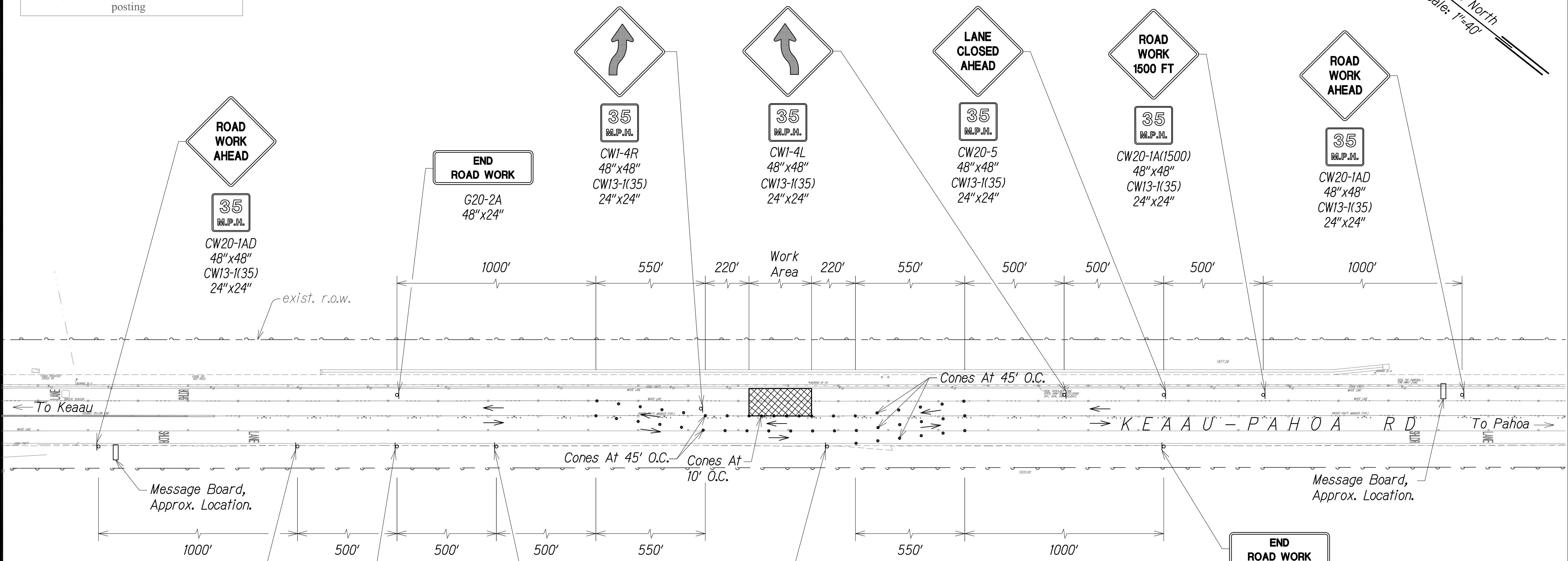

Legend:

- Work Area
- Sign
- Cones or Delineators
- Police Officer SDO
- Directional Arrow
- Flashing Arrow Signal

Legend:

- 35 M.P.H. CW20-1A(1500) 48"x48" CW13-1(35) 24"x24"
- LANE CLOSED AHEAD CW20-5 48"x48" CW13-1(35) 24"x24"
- 35 M.P.H. CW1-4R 48"x48" CW13-1(35) 24"x24"
- 35 M.P.H. CW1-4L 48"x48" CW13-1(35) 24"x24"

- Note:**
1. Work Area Limited to 1,000 Feet or Less During Working Hours.
 2. Contractor Shall Coordinate with D.O.T. for Message on Message Board.
 3. Work Hours to Occur Between 8:30a.m. and 2:30p.m. (Monday through Friday).



THIS WORK WAS PREPARED BY ME OR UNDER MY SUPERVISION.

APRIL 30, 2018
WILSON OKAMOTO CORPORATION LIC. EXP. DATE

| | |
|-------------------|-------|
| SURVEY PLOTTED BY | DATE |
| DRAWN BY | |
| DESIGNED BY | |
| CHECKED BY | |
| ORIGINAL PLAN | |
| NOTE BOOK | |
| No. | |

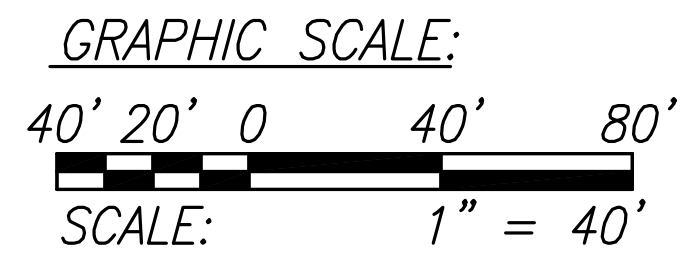

**TRAFFIC CONTROL PLAN - PHASE 2A
FOR WORK ON KEEAU BOUND SHOULDER**

SCALE: 1" = 40'

STATE OF HAWAII
DEPARTMENT OF TRANSPORTATION
HIGHWAYS DIVISION

TRAFFIC CONTROL PLAN 4

KEEAU-PAHOA ROAD, SHOULDER
LANE CONVERSION, PHASE 2
Shower Drive Intersection Improvements
Fed. Aid Proj. No. STP-0130(33)
Scale: 1"=40' Date: March 2016

SHEET No. TCP-50F 15 SHEETS

| | | | | | |
|---------------------|-------|--------------------|-------------|-----------|--------------|
| FED. ROAD DIST. NO. | STATE | FED. AID PROJ. NO. | FISCAL YEAR | SHEET NO. | TOTAL SHEETS |
| HAWAII | HAW. | STP-0130(33) | 2017 | 70 | 99 |

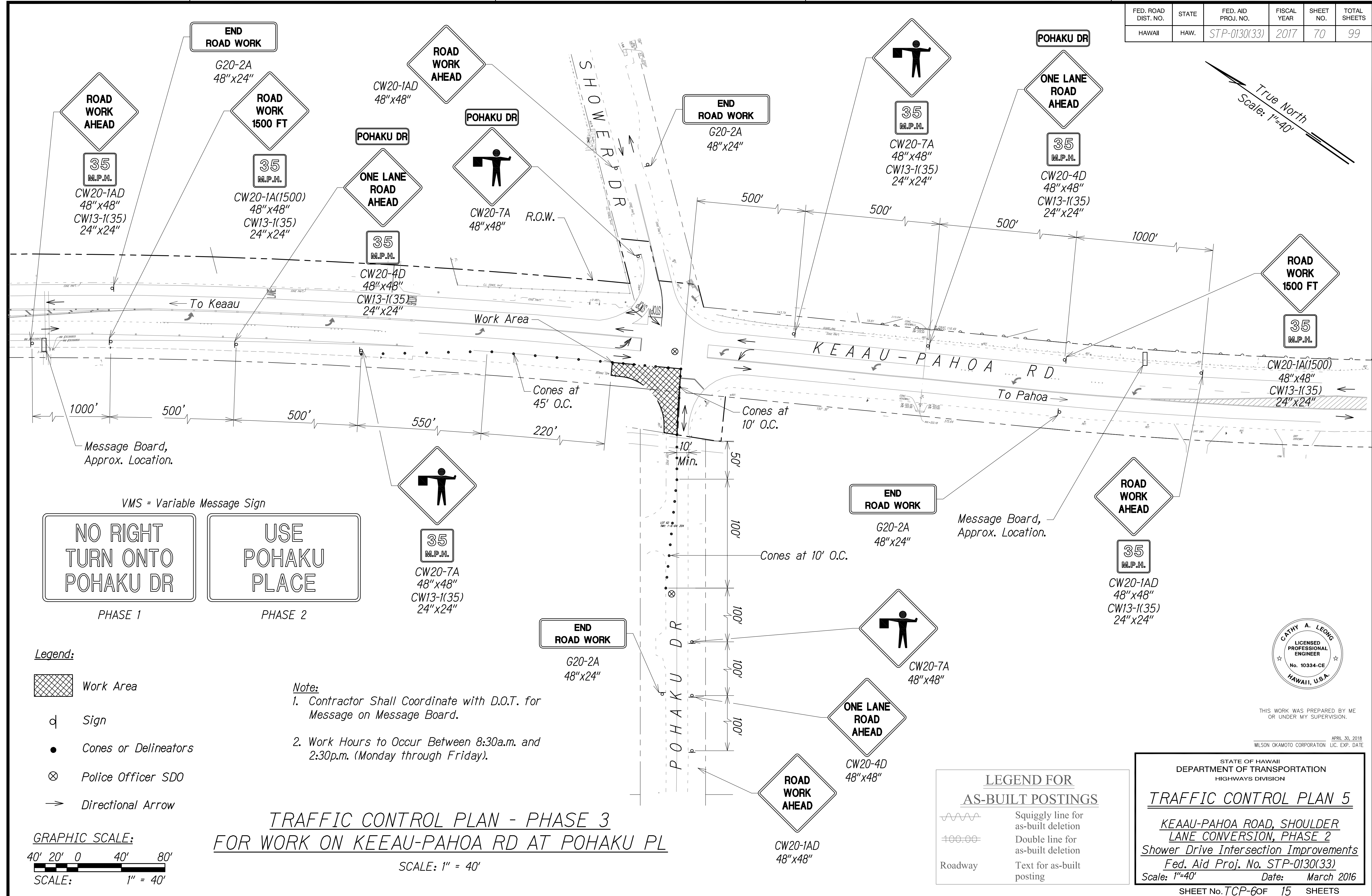

True North
Scale: 1"=40'

VMS - Variable Message Sign

NO RIGHT TURN ONTO POHAKU DR
PHASE 1

USE POHAKU PLACE
PHASE 2

- Legend:**
- Work Area
 - Sign
 - Cones or Delineators
 - Police Officer SDO
 - Directional Arrow

Note:

1. Contractor Shall Coordinate with D.O.T. for Message on Message Board.
2. Work Hours to Occur Between 8:30a.m. and 2:30p.m. (Monday through Friday).

**TRAFFIC CONTROL PLAN - PHASE 3
FOR WORK ON KEEAU-PAHOA RD AT POHAKU PL**

SCALE: 1" = 40'

GRAPHIC SCALE:
40' 20' 0 40' 80'

SCALE: 1" = 40'

LEGEND FOR AS-BUILT POSTINGS

| | |
|---------|-------------------------------------|
| | Squiggly line for as-built deletion |
| | Double line for as-built deletion |
| Roadway | Text for as-built posting |

STATE OF HAWAII
DEPARTMENT OF TRANSPORTATION
HIGHWAYS DIVISION

TRAFFIC CONTROL PLAN 5

KEAAU-PAHOA ROAD, SHOULDER
LANE CONVERSION, PHASE 2
Shower Drive Intersection Improvements
Fed. Aid Proj. No. STP-0130(33)
Scale: 1"=40' Date: March 2016

SHEET No. TCP-60F 15 SHEETS



THIS WORK WAS PREPARED BY ME OR UNDER MY SUPERVISION.

APRIL 30, 2018
WILSON OKAMOTO CORPORATION LIC. EXP. DATE

| | |
|--------------------|-------|
| SURVEY PLOTTED BY: | DATE: |
| DRAWN BY: | |
| TRACED BY: | |
| QUANTITIES BY: | |
| CHECKED BY: | |
| ORIGINAL PLAN NO.: | |
| NOTE BOOK NO.: | |

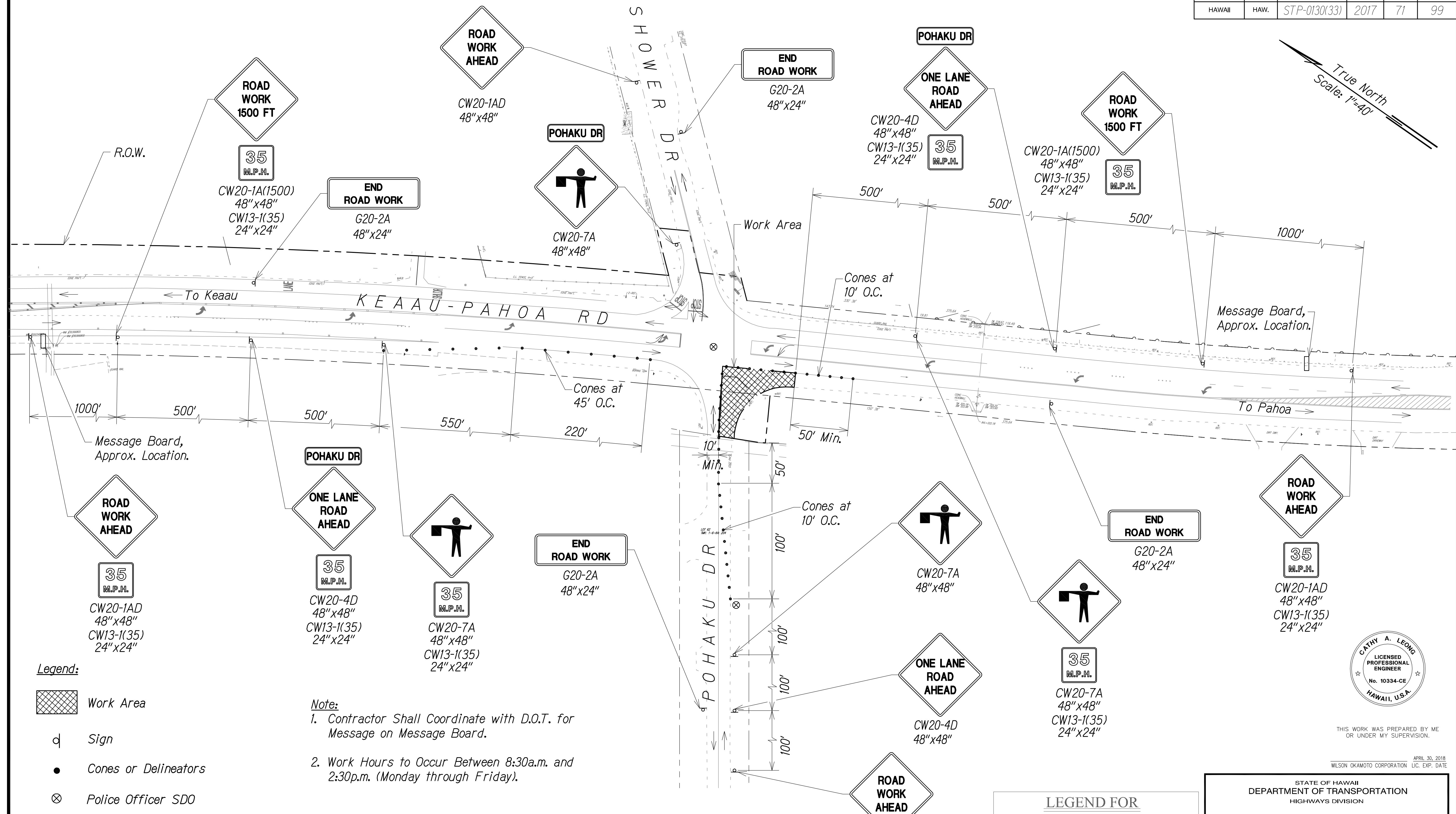

- Legend:**
- Work Area
 - Sign
 - Cones or Delineators
 - Police Officer SDO
 - Directional Arrow

Note:

- Contractor Shall Coordinate with D.O.T. for Message on Message Board.
- Work Hours to Occur Between 8:30a.m. and 2:30p.m. (Monday through Friday).

**TRAFFIC CONTROL PLAN - PHASE 4
FOR WORK ON KEEAU-PAHOA RD AT POHAKU PL**

SCALE: 1" = 40'

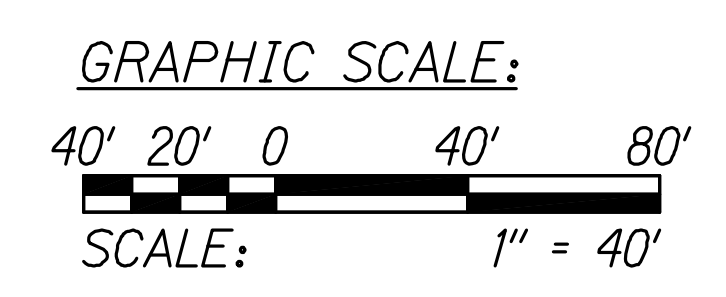

| | |
|-------------------|------|
| SURVEY PLOTTED BY | DATE |
| DRAWN BY | |
| TRACED BY | |
| QUANTITIES BY | |
| CHECKED BY | |
| ORIGINAL PLAN | |
| NOTE BOOK | |
| No. | |

**LEGEND FOR
AS-BUILT POSTINGS**

| | |
|---------|-------------------------------------|
| | Squiggly line for as-built deletion |
| | Double line for as-built deletion |
| Roadway | Text for as-built posting |

STATE OF HAWAII
DEPARTMENT OF TRANSPORTATION
HIGHWAYS DIVISION

TRAFFIC CONTROL PLAN 6

**KEAAU-PAHOA ROAD, SHOULDER
LANE CONVERSION, PHASE 2**

Shower Drive Intersection Improvements

Fed. Aid Proj. No. STP-0130(33)

Scale: 1"=40' Date: March 2016

SHEET No. TCP-7of 15 SHEETS

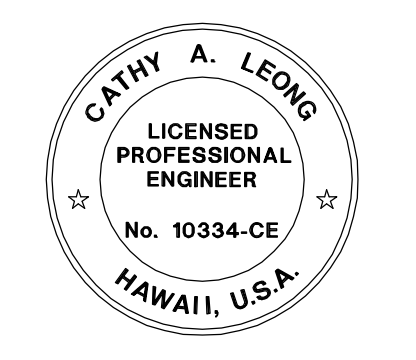

THIS WORK WAS PREPARED BY ME OR UNDER MY SUPERVISION.

APRIL 30, 2018
WILSON OKAMOTO CORPORATION LIC. EXP. DATE

| | | | | | |
|---------------------|-------|--------------------|-------------|-----------|--------------|
| FED. ROAD DIST. NO. | STATE | FED. AID PROJ. NO. | FISCAL YEAR | SHEET NO. | TOTAL SHEETS |
| HAWAII | HAW. | STP-0130(33) | 2017 | 72 | 99 |

VMS1 = Variable Message Sign 1

VMS2 = Variable Message Sign 2

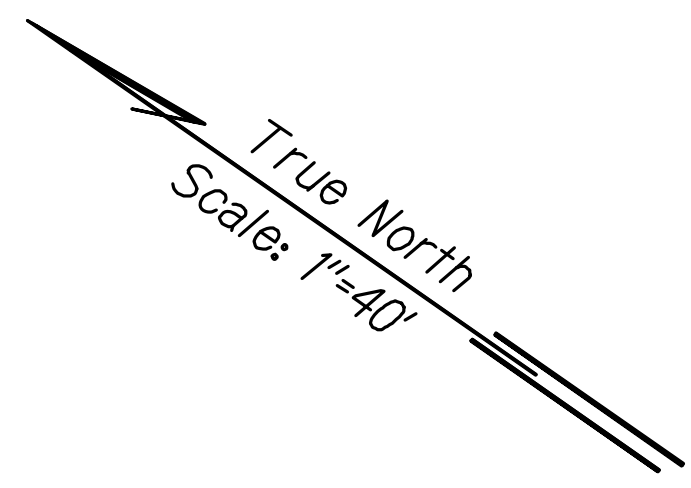
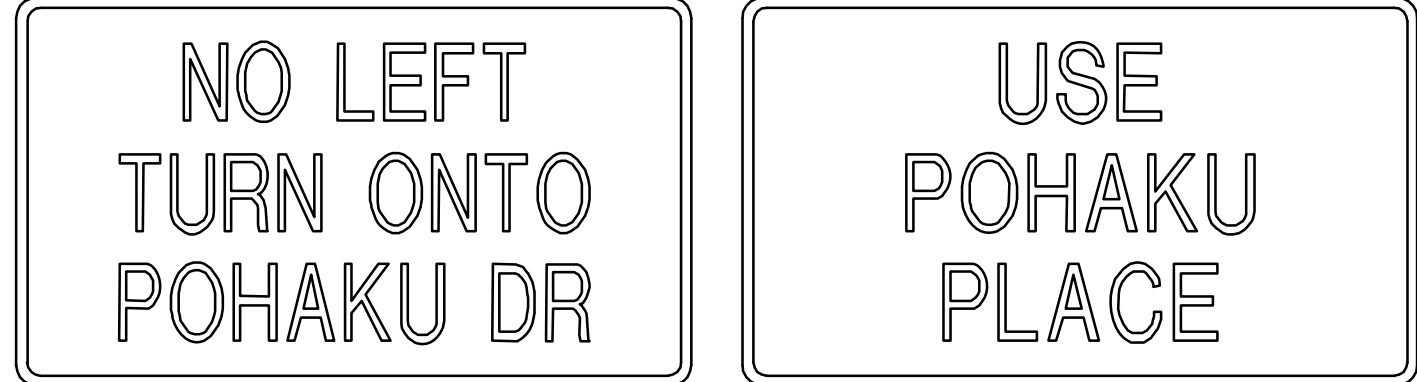
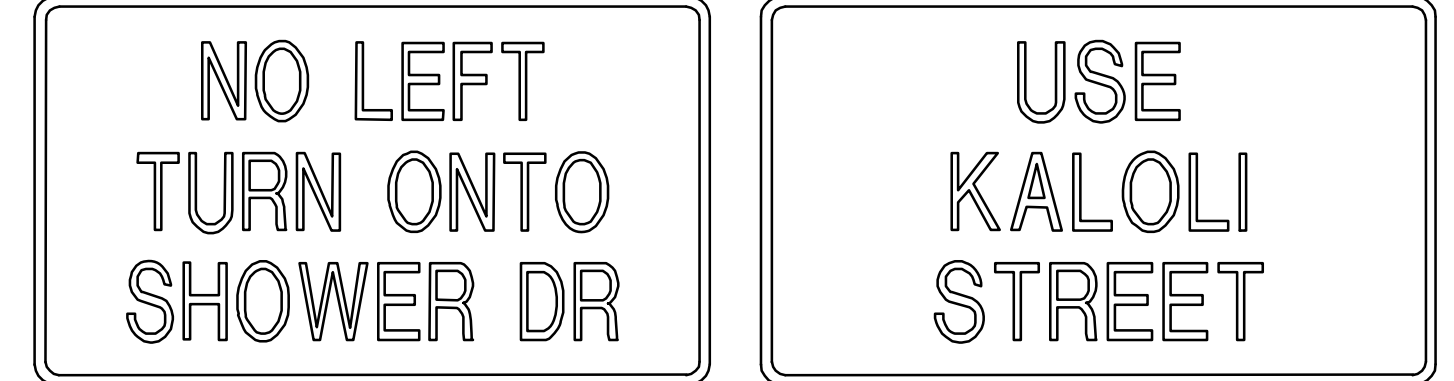

LEGEND FOR AS-BUILT POSTINGS

| | |
|---------|-------------------------------------|
| | Squiggly line for as-built deletion |
| | Double line for as-built deletion |
| Roadway | Text for as-built posting |

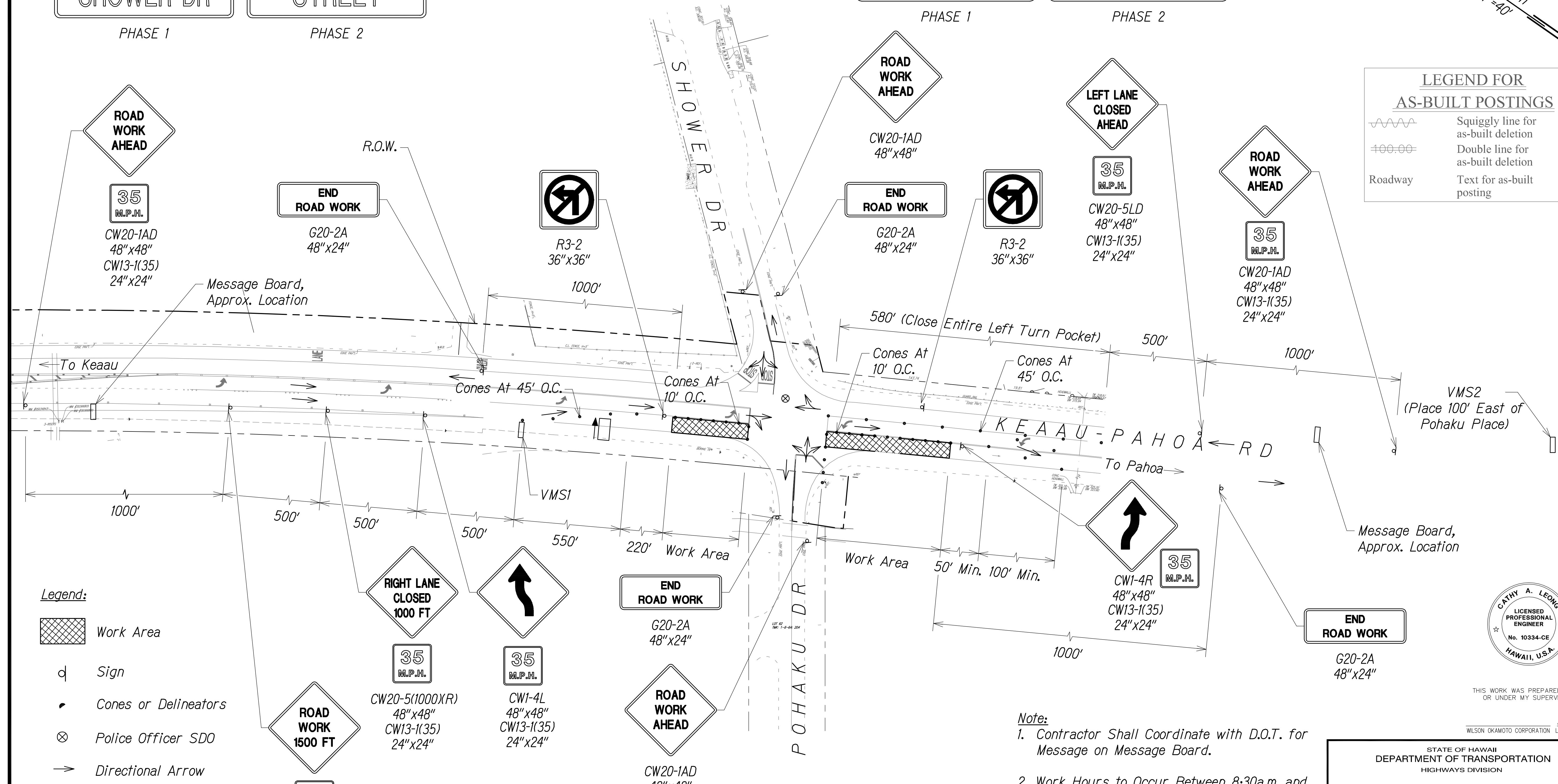

- Legend:**
- Work Area
 - Sign
 - Cones or Delineators
 - Police Officer SDO
 - Directional Arrow
 - Flashing Arrow Signal

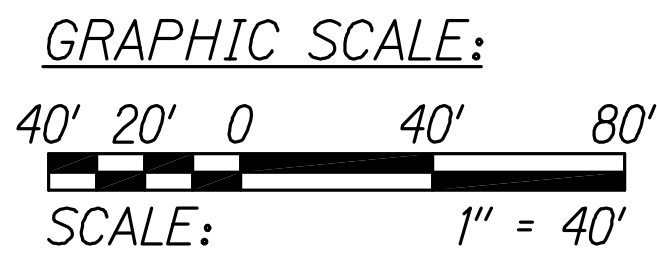

**TRAFFIC CONTROL PLAN - PHASE 5
FOR WORK ON KEEAU-PAHOA ROAD**

SCALE: 1" = 40'

- Note:**
- Contractor Shall Coordinate with D.O.T. for Message on Message Board.
 - Work Hours to Occur Between 8:30a.m. and 2:30p.m. (Monday through Friday).

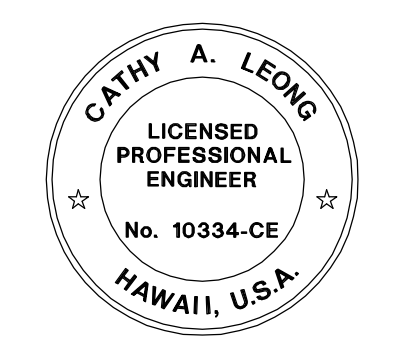

THIS WORK WAS PREPARED BY ME OR UNDER MY SUPERVISION.

APRIL 30, 2018
WILSON OKAMOTO CORPORATION LIC. EXP. DATE

STATE OF HAWAII
DEPARTMENT OF TRANSPORTATION
HIGHWAYS DIVISION

TRAFFIC CONTROL PLAN 7

**KEAAU-PAHOA ROAD, SHOULDER
LANE CONVERSION, PHASE 2**
Shower Drive Intersection Improvements
Fed. Aid Proj. No. STP-0130(33)
Scale: 1"=40' Date: March 2016

SHEET No. TCP-8 of 15 SHEETS

| | |
|-------------------|------|
| SURVEY PLOTTED BY | DATE |
| DRAWN BY | |
| TRACED BY | |
| QUANTIFIED BY | |
| CHECKED BY | |
| ORIGINAL PLAN | No. |
| NOTE BOOK | |

| FED. ROAD DIST. NO. | STATE | FED. AID PROJ. NO. | FISCAL YEAR | SHEET NO. | TOTAL SHEETS |
|---------------------|-------|--------------------|-------------|-----------|--------------|
| HAWAII | HAW. | STP-0130(33) | 2017 | 73 | 99 |

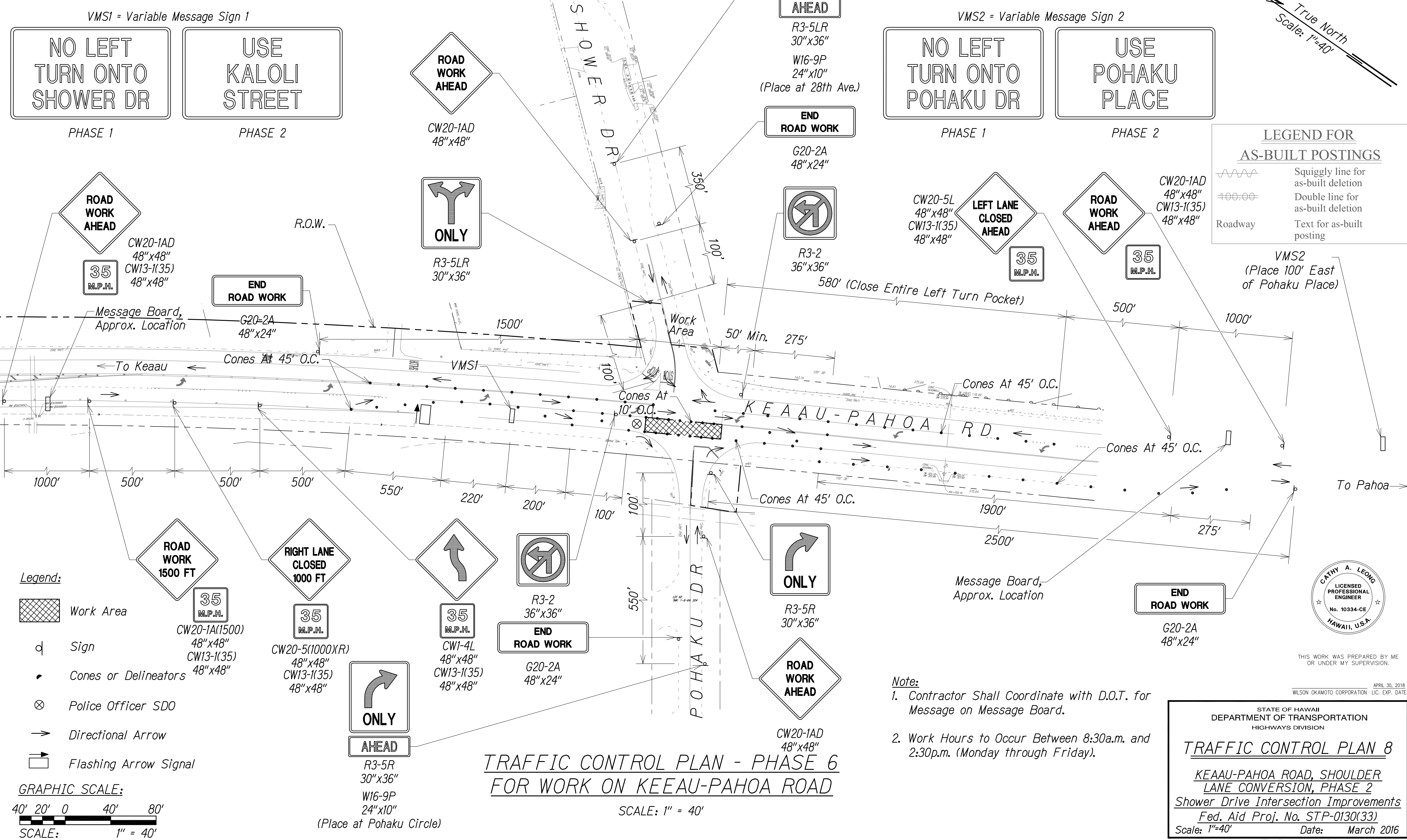

VMS1 = Variable Message Sign 1

NO LEFT TURN ONTO SHOWER DR

PHASE 1

USE KALOLI STREET

PHASE 2

VMS2 = Variable Message Sign 2

NO LEFT TURN ONTO POHAKU DR

PHASE 1

USE POHAKU PLACE

PHASE 2

LEGEND FOR AS-BUILT POSTINGS

~~~~~ Squiggly line for as-built deletion

==== Double line for as-built deletion

Roadway Text for as-built posting

**Legend:**

Work Area

Sign

Cones or Delineators

Police Officer SDO

Directional Arrow

Flashing Arrow Signal

GRAPHIC SCALE:

40' 20' 0 40' 80'

SCALE: 1" = 40'

**TRAFFIC CONTROL PLAN - PHASE 6 FOR WORK ON KEEAU-PAHOA ROAD**

SCALE: 1" = 40'

- Note:**
- Contractor Shall Coordinate with D.O.T. for Message on Message Board.
  - Work Hours to Occur Between 8:30a.m. and 2:30p.m. (Monday through Friday).

STATE OF HAWAII  
DEPARTMENT OF TRANSPORTATION  
HIGHWAYS DIVISION

**TRAFFIC CONTROL PLAN 8**

KEAAU-PAHOA ROAD, SHOULDER LANE CONVERSION, PHASE 2  
Shower Drive Intersection Improvements  
Fed. Aid Proj. No. STP-0130(33)  
Scale: 1"=40' Date: March 2016

|                   |      |
|-------------------|------|
| SURVEY PLOTTED BY | DATE |
| DRAWN BY          |      |
| TRACED BY         |      |
| QUANTITIES BY     |      |
| CHECKED BY        |      |
| ORIGINAL PLAN     |      |
| NOTE BOOK         |      |
| No.               |      |



THIS WORK WAS PREPARED BY ME OR UNDER MY SUPERVISION.

APRIL 30, 2018  
WILSON OKAMOTO CORPORATION LIC. EXP. DATE

|                     |       |                    |             |           |              |
|---------------------|-------|--------------------|-------------|-----------|--------------|
| FED. ROAD DIST. NO. | STATE | FED. AID PROJ. NO. | FISCAL YEAR | SHEET NO. | TOTAL SHEETS |
| HAWAII              | HAW.  | STP-0130(33)       | 2017        | 74        | 99           |

VMS1 = Variable Message Sign 1

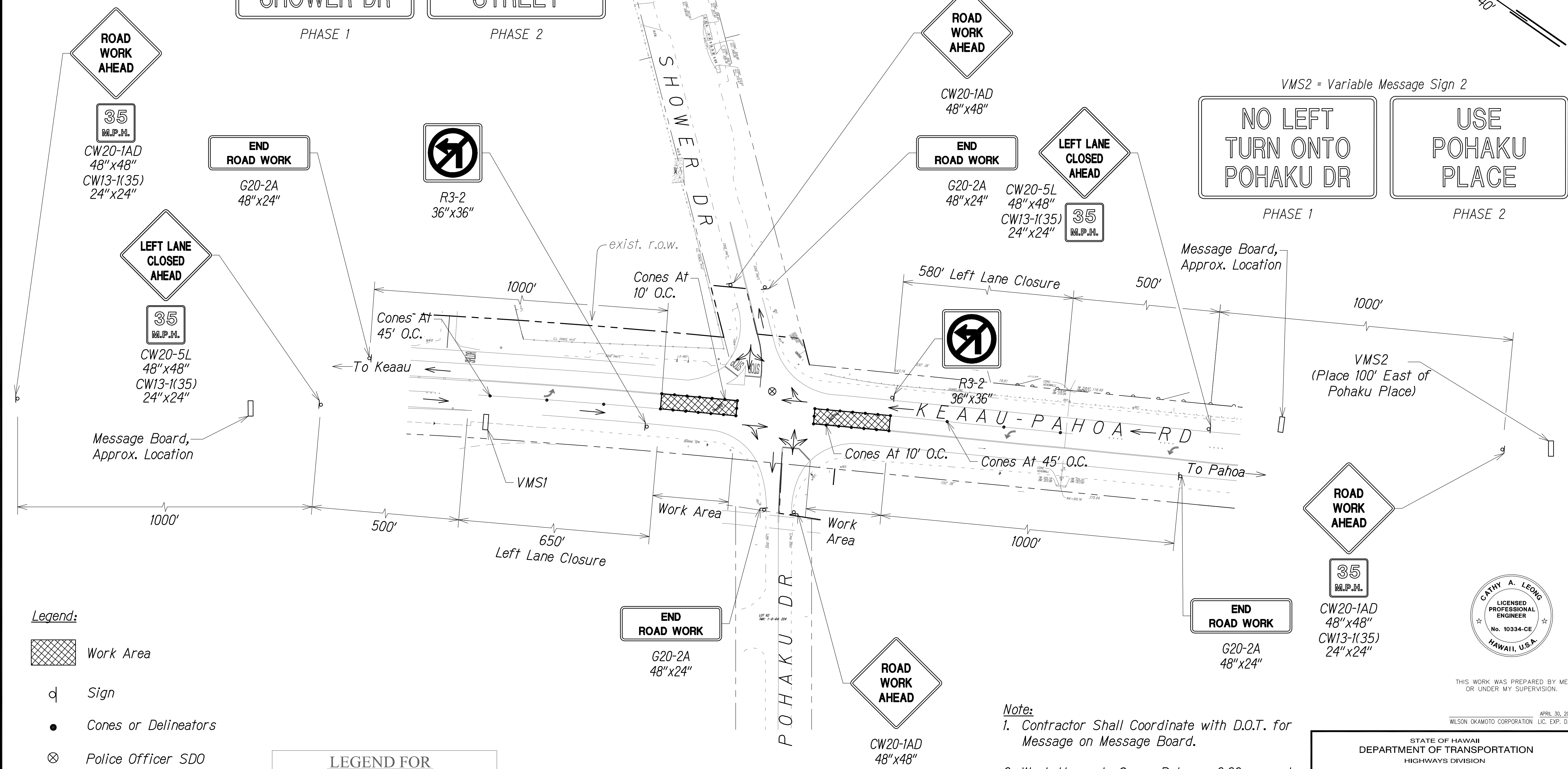
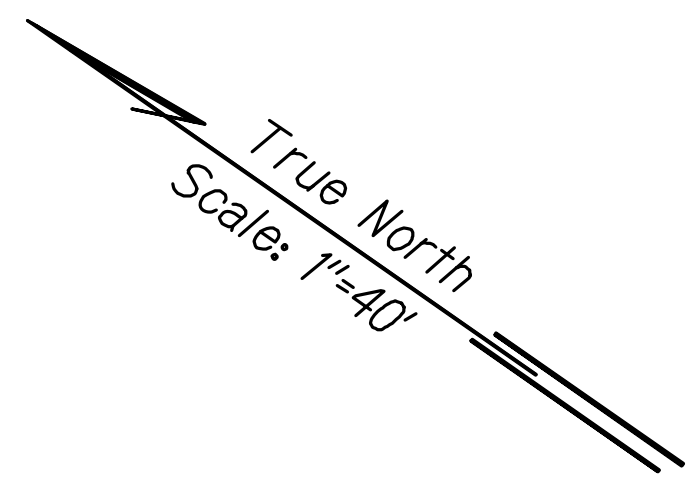
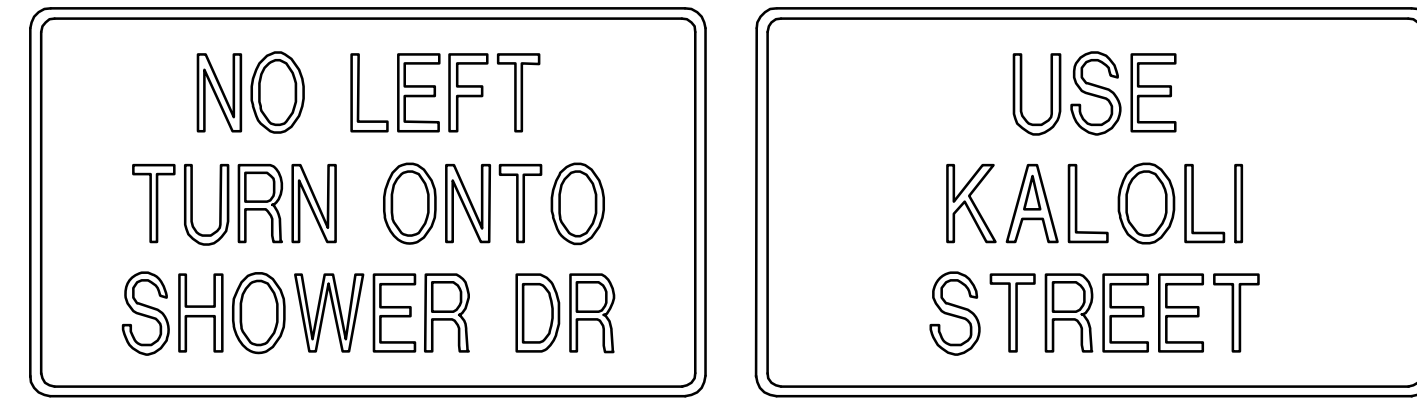

VMS2 = Variable Message Sign 2

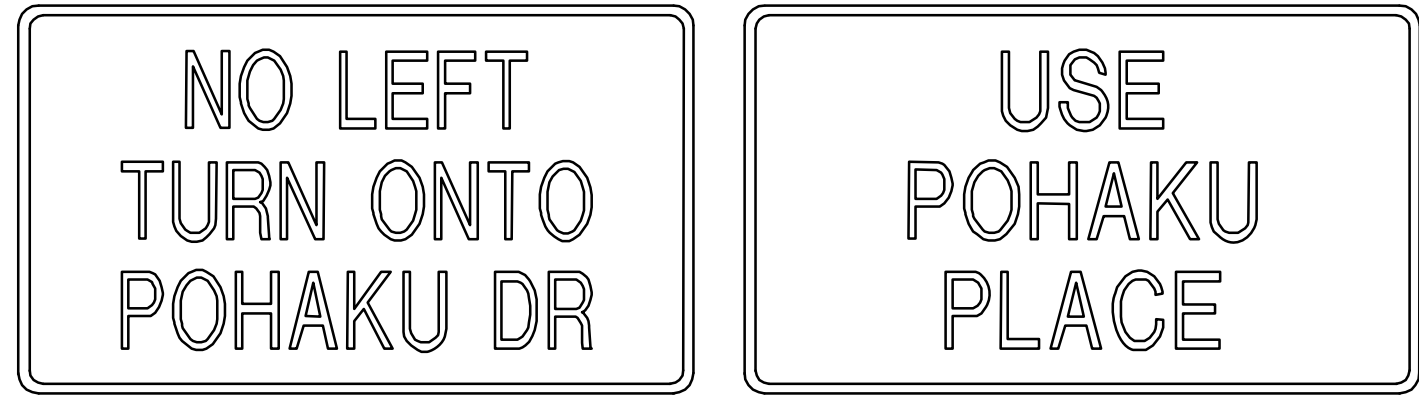

- Legend:**
- Work Area
  - Sign
  - Cones or Delineators
  - Police Officer SDO
  - Directional Arrow

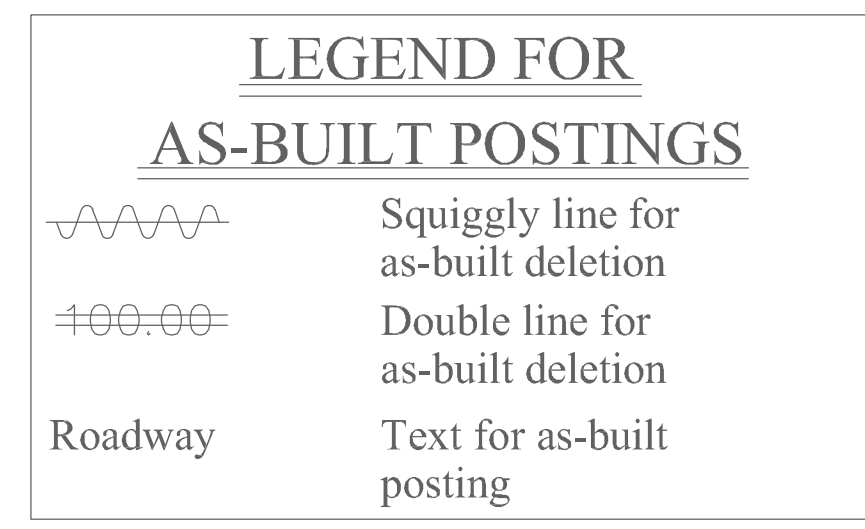
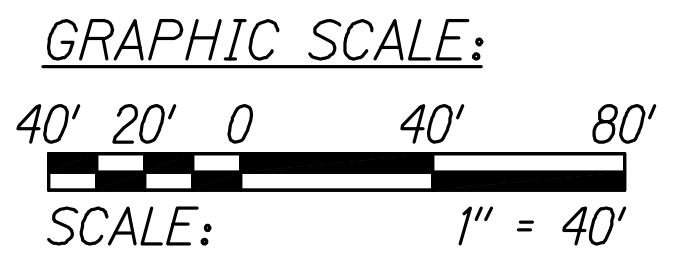

**TRAFFIC CONTROL PLAN - PHASE 7 FOR WORK ON KEEAU-PAHOA ROAD**

SCALE: 1" = 40'

- Note:**
1. Contractor Shall Coordinate with D.O.T. for Message on Message Board.
  2. Work Hours to Occur Between 8:30a.m. and 2:30p.m. (Monday through Friday).

|                   |           |
|-------------------|-----------|
| SURVEY PLOTTED BY | DATE      |
| DRAWN BY          |           |
| TRACED BY         |           |
| QUANTITIES BY     |           |
| CHECKED BY        |           |
| ORIGINAL PLAN     | No. _____ |
| NOTE BOOK         |           |

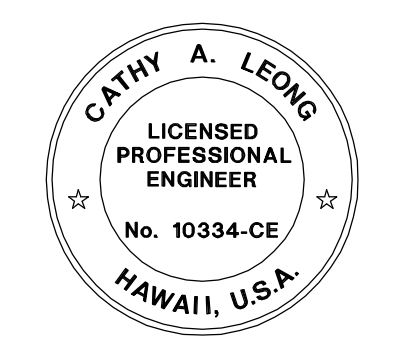

THIS WORK WAS PREPARED BY ME OR UNDER MY SUPERVISION.

APRIL 30, 2018  
WILSON OKAMOTO CORPORATION LIC. EXP. DATE

STATE OF HAWAII  
DEPARTMENT OF TRANSPORTATION  
HIGHWAYS DIVISION

**TRAFFIC CONTROL PLAN 9**

KEAAU-PAHOA ROAD, SHOULDER LANE CONVERSION, PHASE 2  
Shower Drive Intersection Improvements  
Fed. Aid Proj. No. STP-0130(33)  
Scale: 1"=40' Date: March 2016

SHEET No. TCP-10 of 15 SHEETS

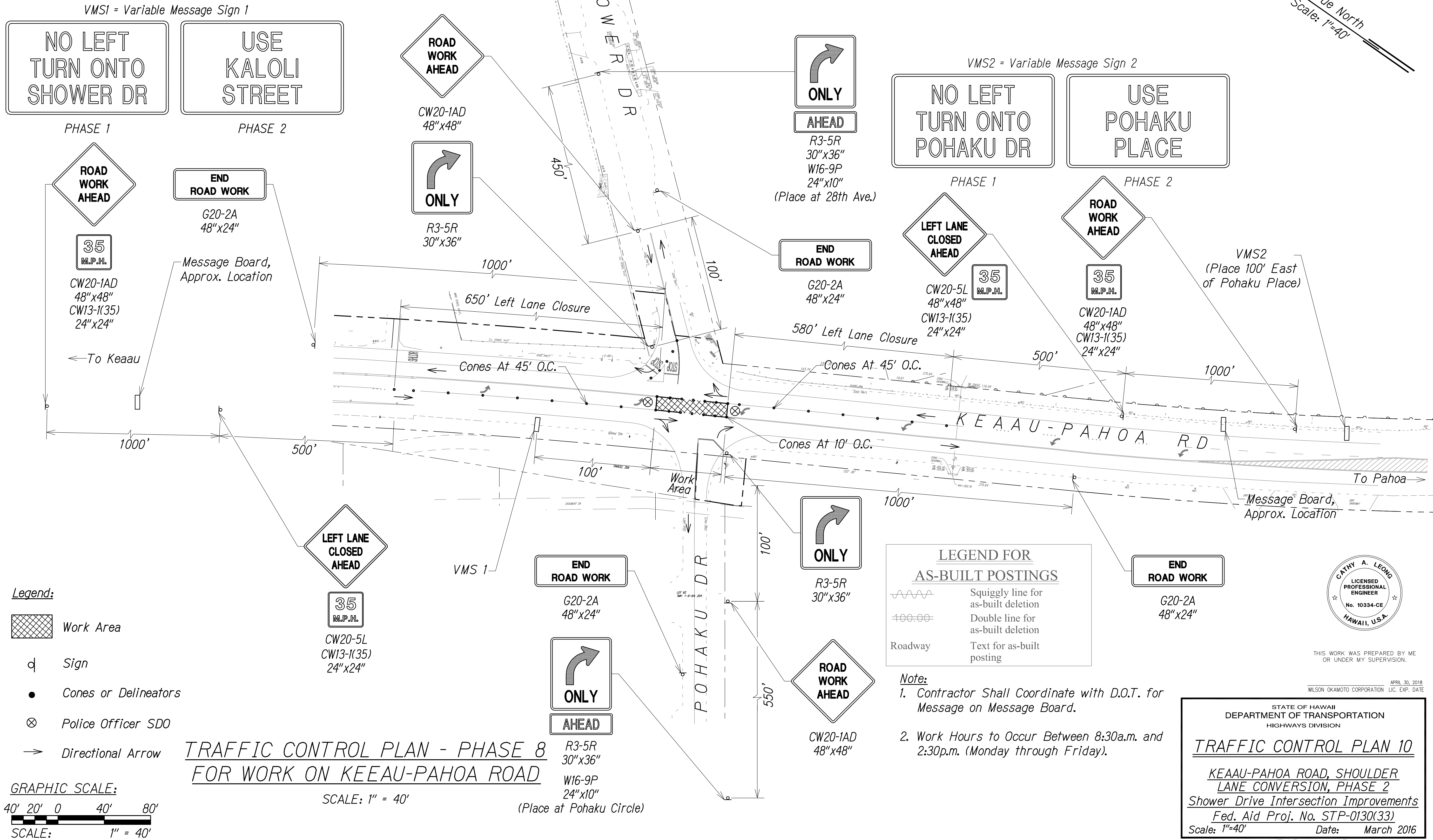
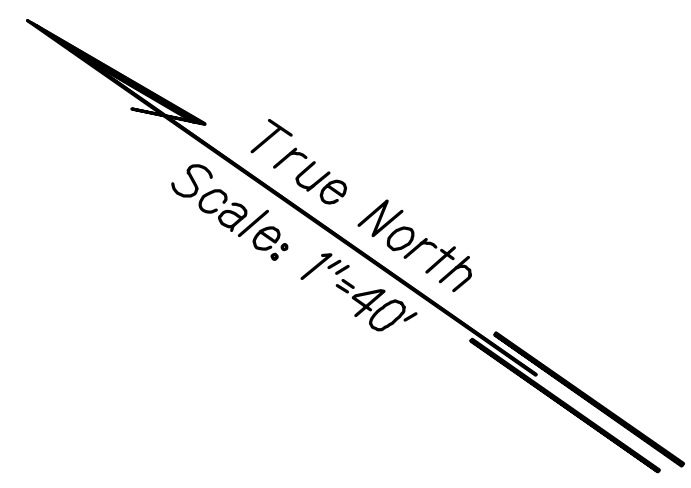

- Legend:**
- Work Area
  - Sign
  - Cones or Delineators
  - Police Officer SDO
  - Directional Arrow

GRAPHIC SCALE:  
  
 SCALE: 1" = 40'

**TRAFFIC CONTROL PLAN - PHASE 8  
 FOR WORK ON KEEAU-PAHOA ROAD**  
 SCALE: 1" = 40'  
 (Place at Pohaku Circle)

**LEGEND FOR AS-BUILT POSTINGS**

- Squiggly line for as-built deletion
- Double line for as-built deletion
- Roadway Text for as-built posting

- Note:**
- Contractor Shall Coordinate with D.O.T. for Message on Message Board.
  - Work Hours to Occur Between 8:30a.m. and 2:30p.m. (Monday through Friday).

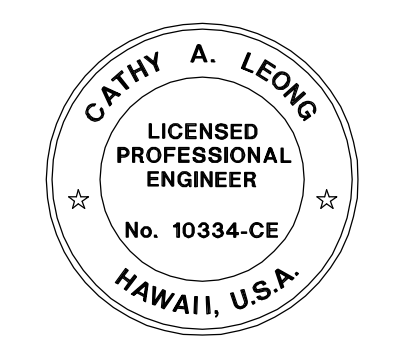

THIS WORK WAS PREPARED BY ME OR UNDER MY SUPERVISION.

APRIL 30, 2018  
 WILSON OKAMOTO CORPORATION LIC. EXP. DATE

STATE OF HAWAII  
 DEPARTMENT OF TRANSPORTATION  
 HIGHWAYS DIVISION

**TRAFFIC CONTROL PLAN 10**

KEAAU-PAHOA ROAD, SHOULDER  
 LANE CONVERSION, PHASE 2  
 Shower Drive Intersection Improvements  
 Fed. Aid Proj. No. STP-0130(33)  
 Scale: 1"=40' Date: March 2016

SHEET No. TCP-11 of 15 SHEETS

|                   |      |
|-------------------|------|
| SURVEY PLOTTED BY | DATE |
| DRAWN BY          |      |
| TRACED BY         |      |
| QUANTITIES BY     |      |
| CHECKED BY        |      |
| ORIGINAL PLAN     |      |
| NOTE BOOK         |      |
| No.               |      |



|                     |       |                    |             |           |              |
|---------------------|-------|--------------------|-------------|-----------|--------------|
| FED. ROAD DIST. NO. | STATE | FED. AID PROJ. NO. | FISCAL YEAR | SHEET NO. | TOTAL SHEETS |
| HAWAII              | HAW.  | STP-0130(33)       | 2017        | 76        | 99           |

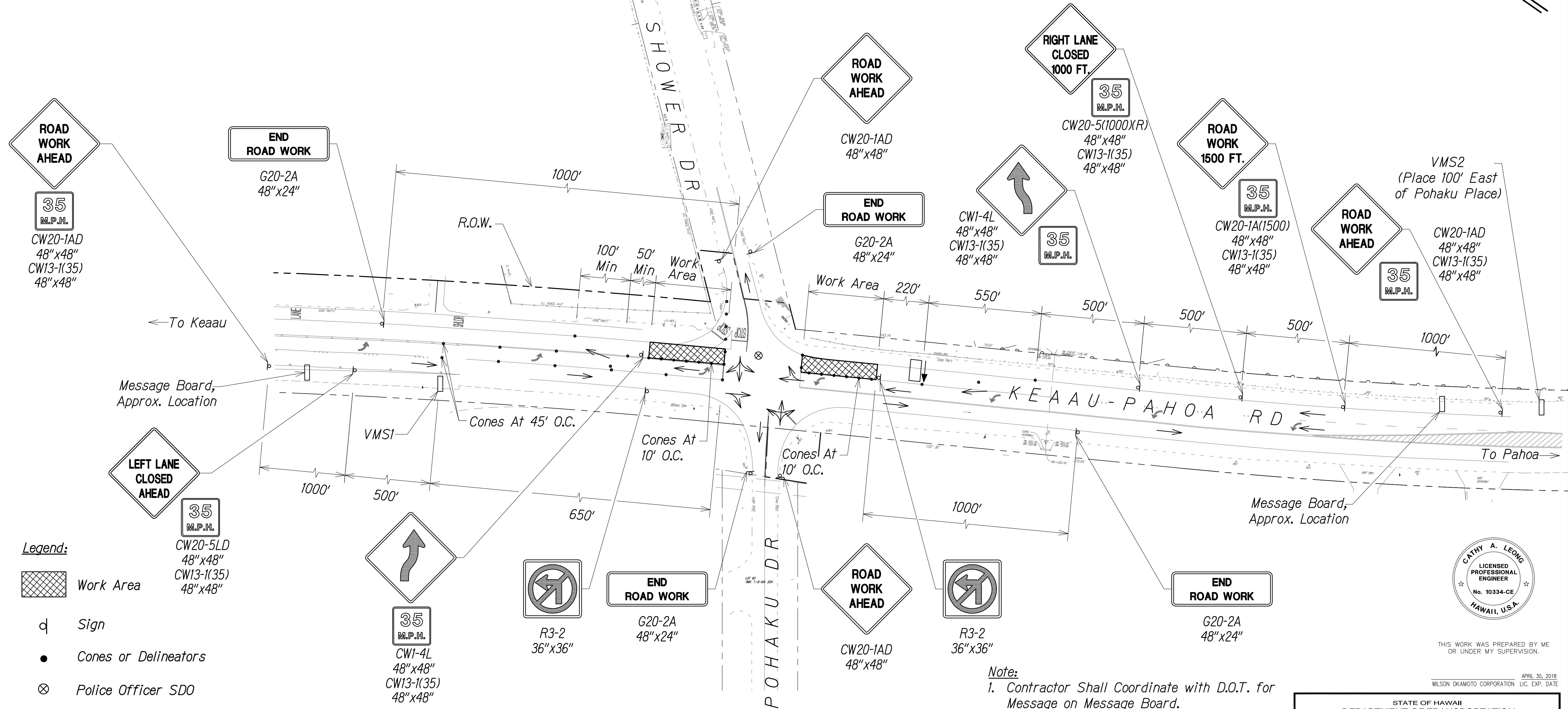
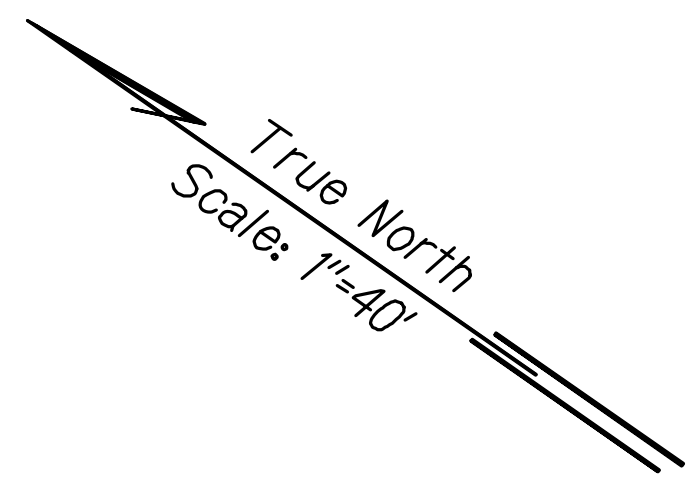
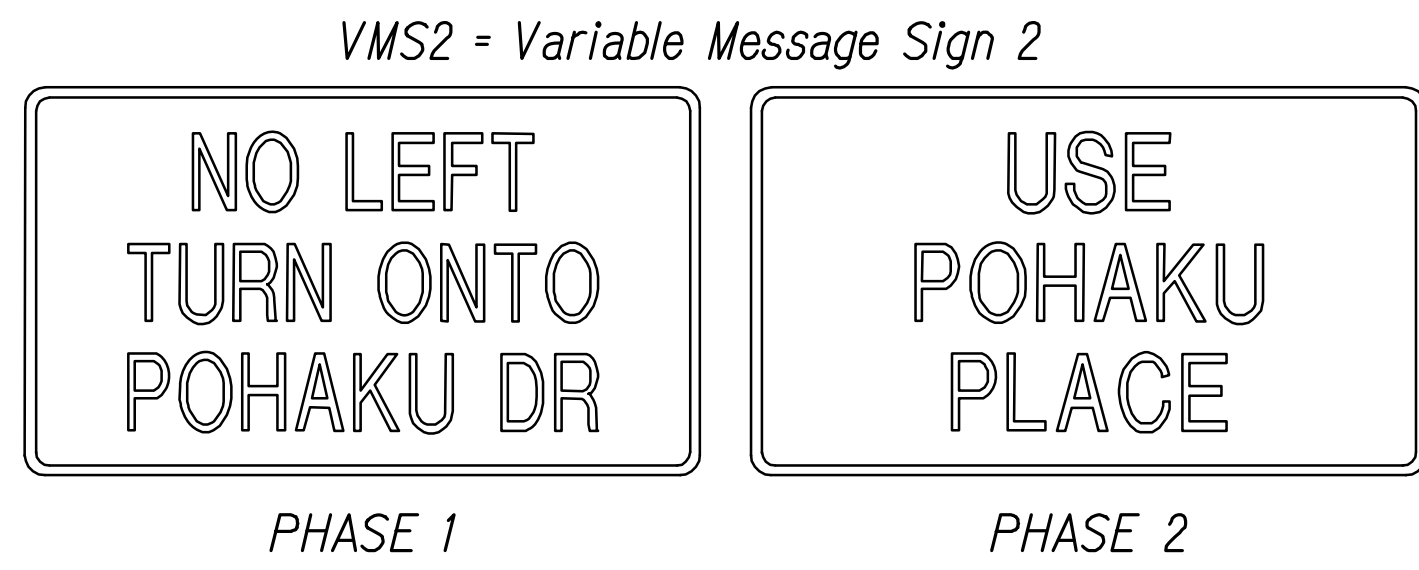
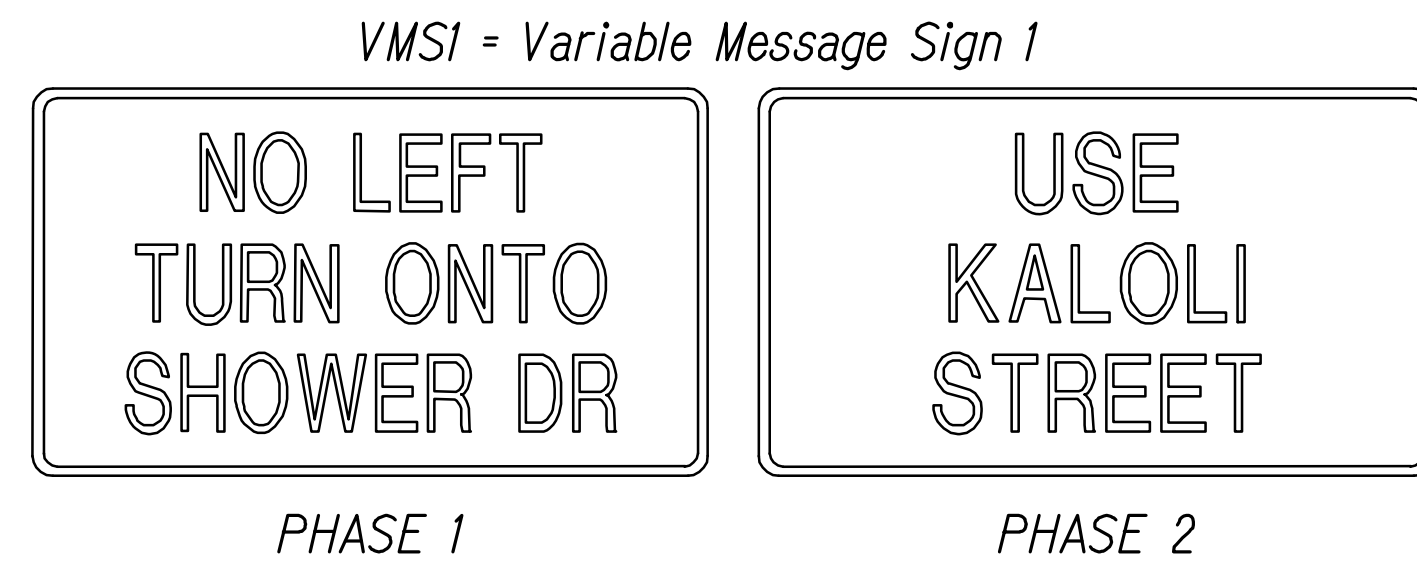

- Legend:**
- Work Area
  - Sign
  - Cones or Delineators
  - Police Officer SDO
  - Directional Arrow
  - Flashing Arrow Signal

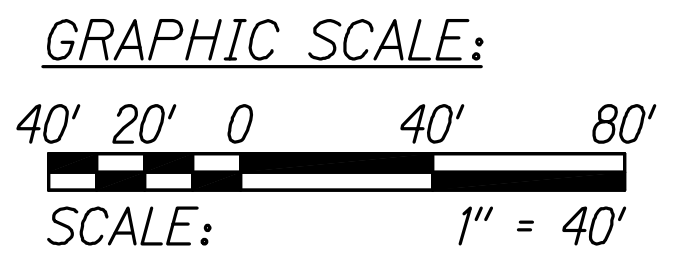
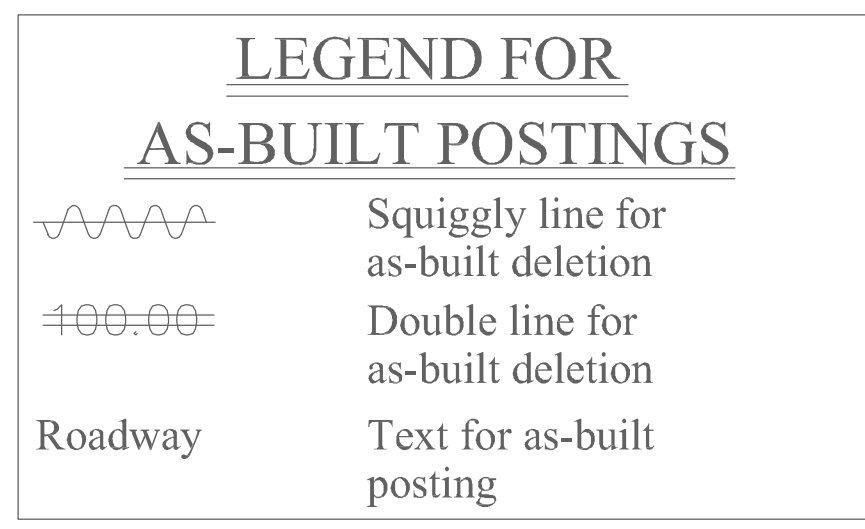

### TRAFFIC CONTROL PLAN - PHASE 9 FOR WORK ON KEEAU-PAHOA ROAD

SCALE: 1" = 40'

- Note:**
- Contractor Shall Coordinate with D.O.T. for Message on Message Board.
  - Work Hours to Occur Between 8:30a.m. and 2:30p.m. (Monday through Friday).

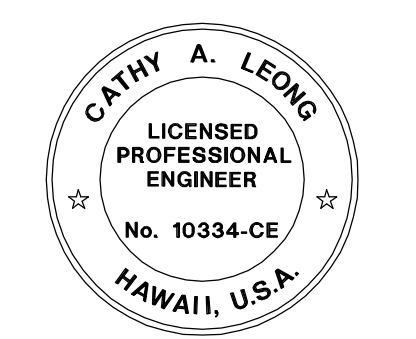

THIS WORK WAS PREPARED BY ME OR UNDER MY SUPERVISION.

APRIL 30, 2018  
WILSON OKAMOTO CORPORATION LIC. EXP. DATE

STATE OF HAWAII  
DEPARTMENT OF TRANSPORTATION  
HIGHWAYS DIVISION

### TRAFFIC CONTROL PLAN 11

KEAAU-PAHOA ROAD, SHOULDER LANE CONVERSION, PHASE 2  
Shower Drive Intersection Improvements  
Fed. Aid Proj. No. STP-0130(33)  
Scale: 1"=40' Date: March 2016

SHEET No. T.C.P-12 OF 15 SHEETS

|                          |                      |
|--------------------------|----------------------|
| SURVEY PLOTTED BY: _____ | DATE: _____          |
| DRAWN BY: _____          | TRACED BY: _____     |
| NOTE BOOK NO. _____      | QUANTITIES BY: _____ |
| CHECKED BY: _____        | NO. _____            |

VMS1 = Variable Message Sign 1

**NO LEFT TURN ONTO SHOWER DR**  
PHASE 1

**USE KALOLI STREET**  
PHASE 2

**ONLY**  
**AHEAD**  
R3-5R  
30"x36"  
W16-9P  
24"x10"  
(Place at 28th Ave.)

VMS2 = Variable Message Sign 2

**NO LEFT TURN ONTO POHAKU DR**  
PHASE 1

**USE POHAKU PLACE**  
PHASE 2

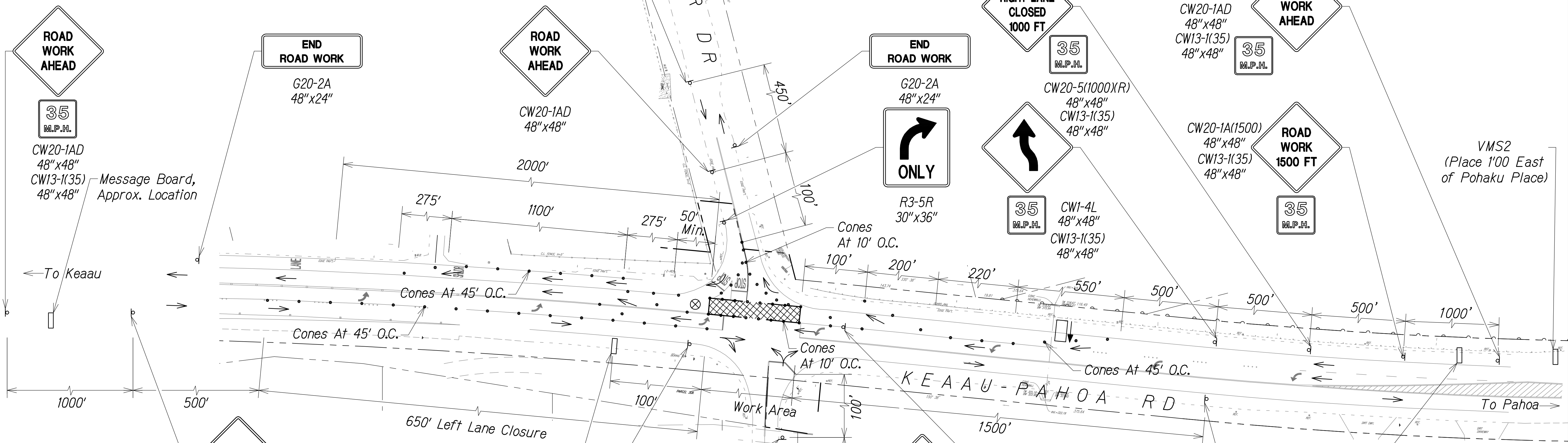
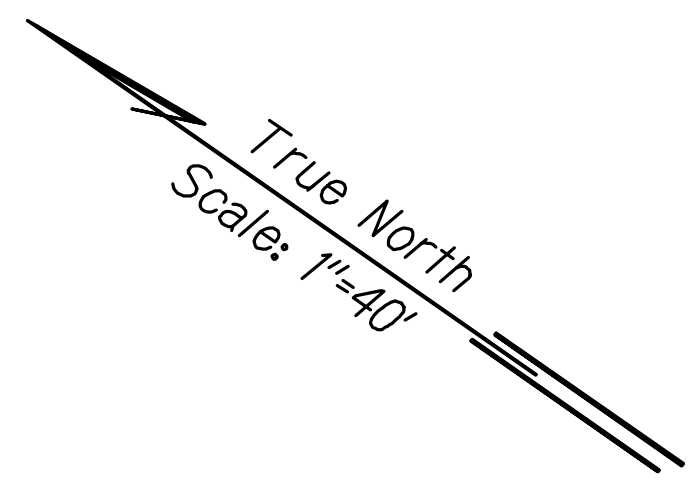

- Legend:**
- Work Area
  - Sign
  - Cones or Delineators
  - Police Officer SDO
  - Directional Arrow
  - Flashing Arrow Signal
  - 35 M.P.H.  
CW20-5L 48"x48"  
CW13-1(35) 48"x48"

**GRAPHIC SCALE:**  
40' 20' 0 40' 80'  
**SCALE:** 1" = 40'

**ONLY**  
**AHEAD**  
R3-5LR  
30"x36"  
W16-9P  
24"x10"  
(Place at Pohaku Circle)

**Note:**

- Contractor Shall Coordinate with D.O.T. for Message on Message Board.
- Work Hours to Occur Between 8:30a.m. and 2:30p.m. (Monday through Friday).

**LEGEND FOR AS-BUILT POSTINGS**

- Squiggly line for as-built deletion
- Double line for as-built deletion
- Roadway Text for as-built posting

**TRAFFIC CONTROL PLAN - PHASE 10  
FOR WORK ON KEEAU-PAHOA ROAD**

SCALE: 1" = 40'

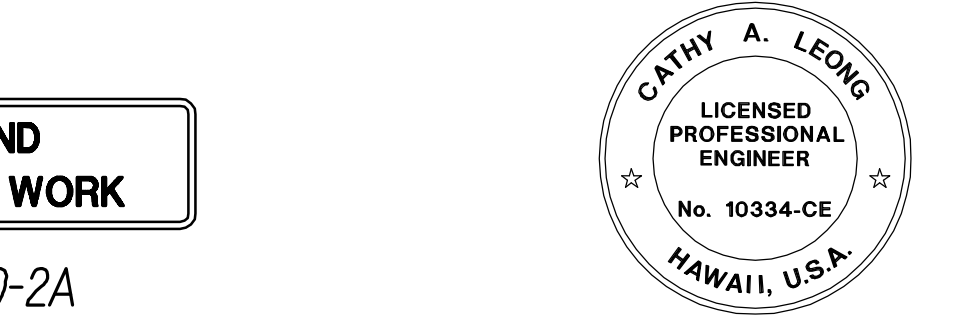

THIS WORK WAS PREPARED BY ME OR UNDER MY SUPERVISION.

APRIL 30, 2018  
WILSON OKAMOTO CORPORATION LIC. EXP. DATE

STATE OF HAWAII  
DEPARTMENT OF TRANSPORTATION  
HIGHWAYS DIVISION

**TRAFFIC CONTROL PLAN 12**

**KEAAU-PAHOA ROAD, SHOULDER LANE CONVERSION, PHASE 2**  
Shower Drive Intersection Improvements  
Fed. Aid Proj. No. STP-0130(33)  
Scale: 1"=40' Date: March 2016

|                   |      |
|-------------------|------|
| SURVEY PLOTTED BY | DATE |
| DRAWN BY          |      |
| TRACED BY         |      |
| QUANTITIES BY     |      |
| CHECKED BY        |      |
| ORIGINAL PLAN     |      |
| NOTE BOOK         |      |
| No.               |      |

|                     |       |                    |             |           |              |
|---------------------|-------|--------------------|-------------|-----------|--------------|
| FED. ROAD DIST. NO. | STATE | FED. AID PROJ. NO. | FISCAL YEAR | SHEET NO. | TOTAL SHEETS |
| HAWAII              | HAW.  | STP-0130(33)       | 2017        | 78        | 99           |

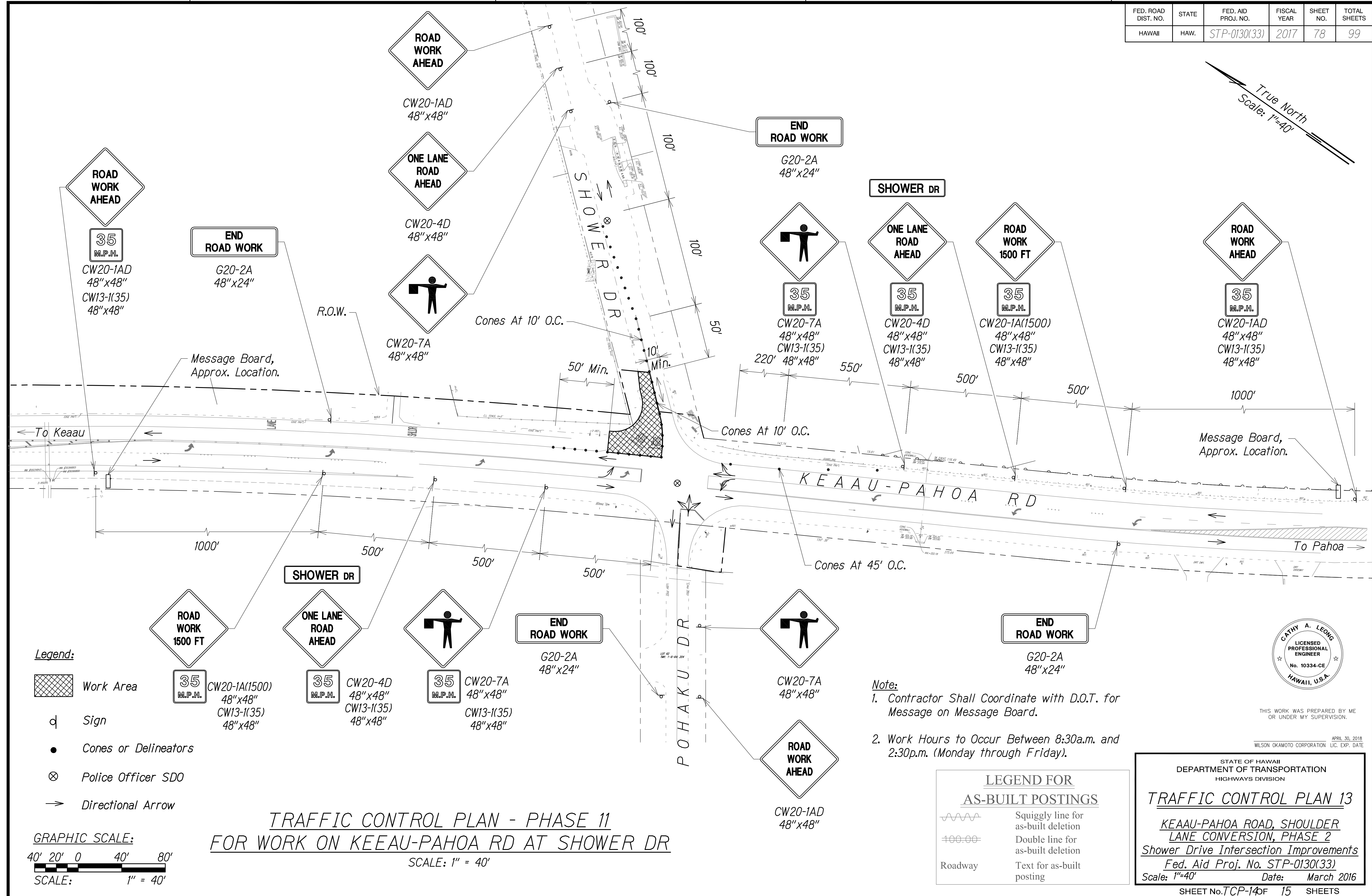
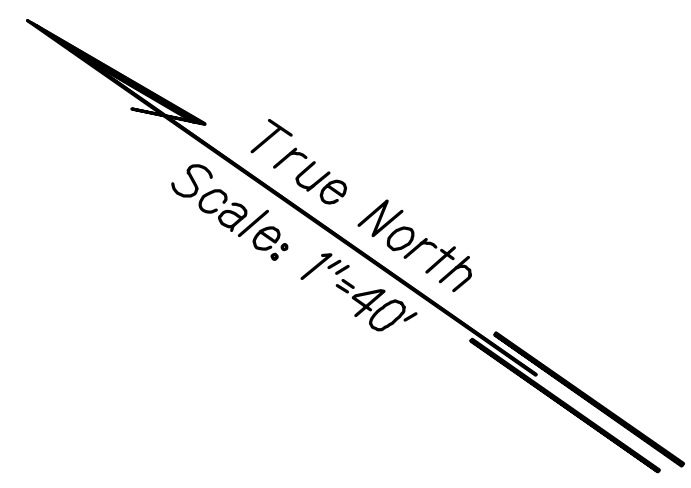

**Legend:**

- Work Area
- Sign
- Cones or Delineators
- Police Officer SDO
- Directional Arrow

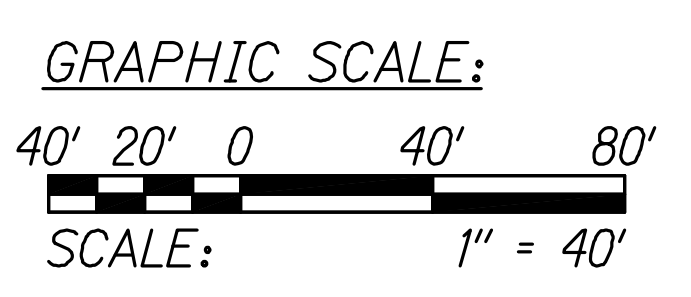

**TRAFFIC CONTROL PLAN - PHASE 11**  
**FOR WORK ON KEEAU-PAHOA RD AT SHOWER DR**  
 SCALE: 1" = 40'

- Note:**
- Contractor Shall Coordinate with D.O.T. for Message on Message Board.
  - Work Hours to Occur Between 8:30a.m. and 2:30p.m. (Monday through Friday).

**LEGEND FOR AS-BUILT POSTINGS**

|         |                                     |
|---------|-------------------------------------|
|         | Squiggly line for as-built deletion |
|         | Double line for as-built deletion   |
| Roadway | Text for as-built posting           |

STATE OF HAWAII  
 DEPARTMENT OF TRANSPORTATION  
 HIGHWAYS DIVISION

**TRAFFIC CONTROL PLAN 13**

**KEEAU-PAHOA ROAD, SHOULDER LANE CONVERSION, PHASE 2**  
 Shower Drive Intersection Improvements  
 Fed. Aid Proj. No. STP-0130(33)  
 Scale: 1"=40' Date: March 2016

|                   |           |
|-------------------|-----------|
| SURVEY PLOTTED BY | DATE      |
| DRAWN BY          |           |
| TRACED BY         |           |
| QUANTITIES BY     |           |
| CHECKED BY        |           |
| ORIGINAL PLAN     | No. _____ |
| NOTE BOOK         |           |

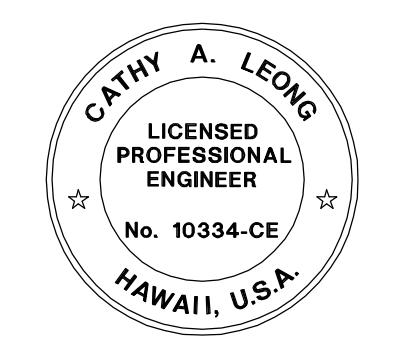

THIS WORK WAS PREPARED BY ME OR UNDER MY SUPERVISION.  
 APRIL 30, 2018  
 WILSON OKAMOTO CORPORATION LIC. EXP. DATE



|                     |       |                    |             |           |              |
|---------------------|-------|--------------------|-------------|-----------|--------------|
| FED. ROAD DIST. NO. | STATE | FED. AID PROJ. NO. | FISCAL YEAR | SHEET NO. | TOTAL SHEETS |
| HAWAII              | HAW.  | STP-0130(33)       | 2017        | 79        | 99           |

VMS = Variable Message Sign

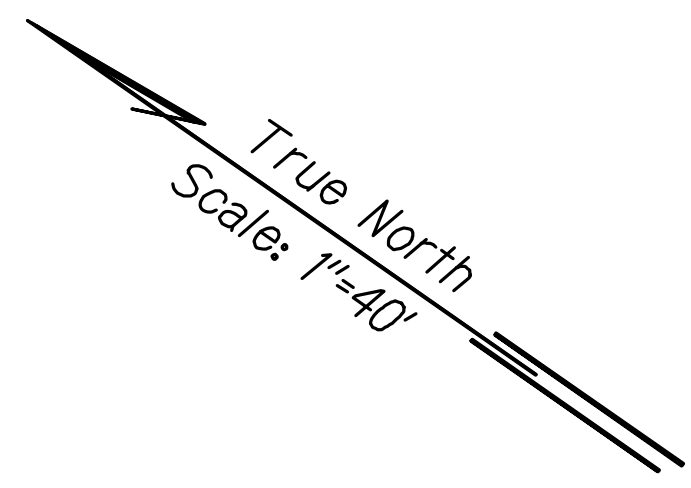
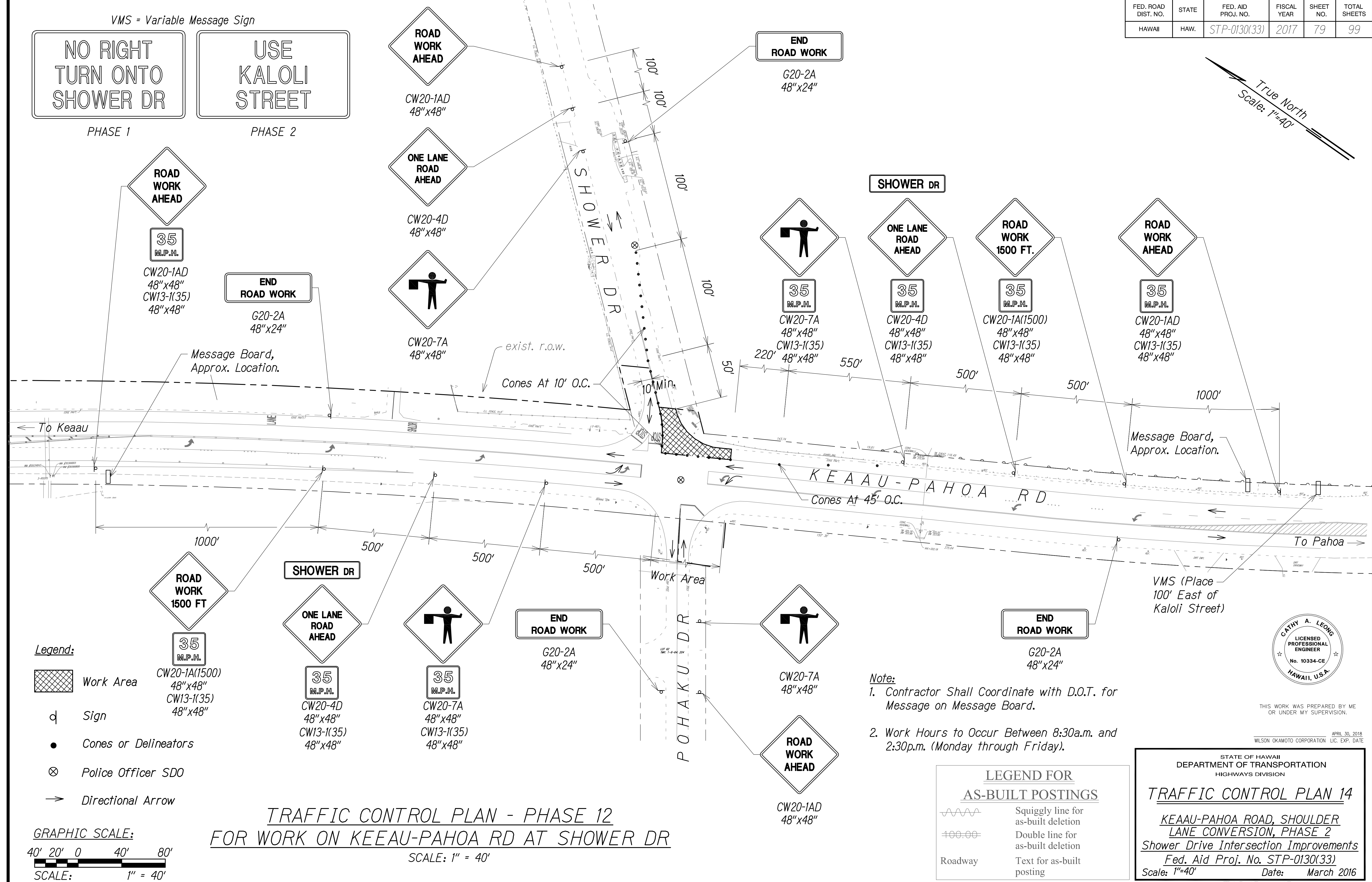
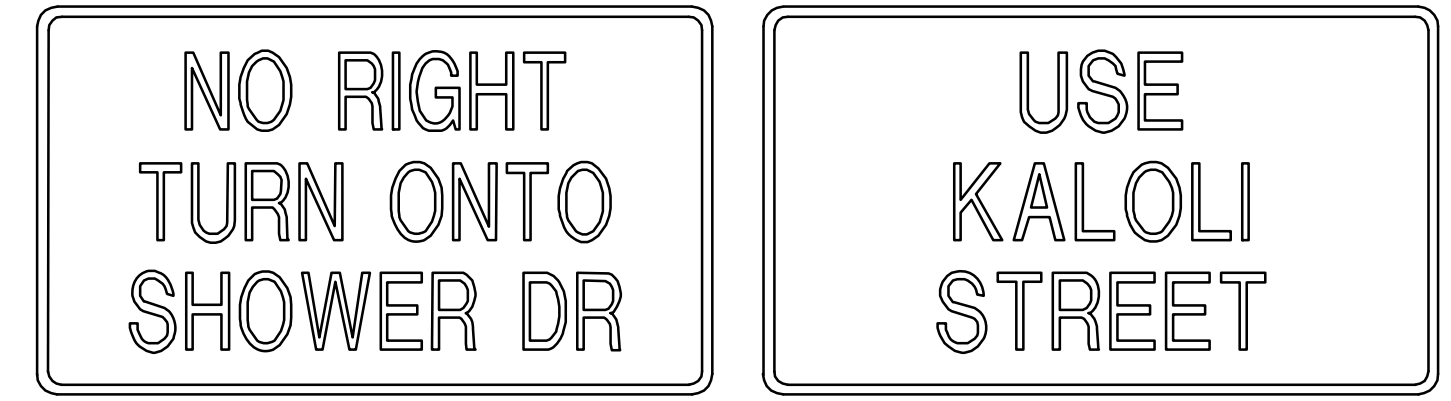

**Legend:**

- Work Area
- Sign
- Cones or Delineators
- Police Officer SDO
- Directional Arrow

- 35 M.P.H.  
CW20-1A(1500) 48"x48"  
CW13-1(35) 48"x48"
- ONE LANE ROAD AHEAD  
35 M.P.H.  
CW20-4D 48"x48"  
CW13-1(35) 48"x48"
- ROAD WORK AHEAD  
35 M.P.H.  
CW20-7A 48"x48"  
CW13-1(35) 48"x48"
- END ROAD WORK  
G20-2A 48"x24"

- Note:**
- Contractor Shall Coordinate with D.O.T. for Message on Message Board.
  - Work Hours to Occur Between 8:30a.m. and 2:30p.m. (Monday through Friday).

**LEGEND FOR AS-BUILT POSTINGS**

|         |                                     |
|---------|-------------------------------------|
|         | Squiggly line for as-built deletion |
|         | Double line for as-built deletion   |
| Roadway | Text for as-built posting           |

STATE OF HAWAII  
DEPARTMENT OF TRANSPORTATION  
HIGHWAYS DIVISION

**TRAFFIC CONTROL PLAN 14**

KEAAU-PAHOA ROAD, SHOULDER  
LANE CONVERSION, PHASE 2  
Shower Drive Intersection Improvements  
Fed. Aid Proj. No. STP-0130(33)  
Scale: 1"=40' Date: March 2016

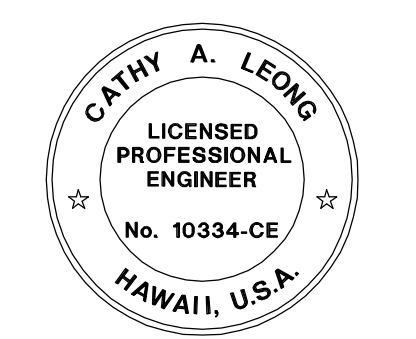

THIS WORK WAS PREPARED BY ME OR UNDER MY SUPERVISION.  
APRIL 30, 2018  
WILSON OKAMOTO CORPORATION LIC. EXP. DATE

|                   |      |
|-------------------|------|
| SURVEY PLOTTED BY | DATE |
| DRAWN BY          |      |
| TRACED BY         |      |
| QUANTITIES BY     |      |
| CHECKED BY        |      |
| ORIGINAL PLAN     |      |
| NOTE BOOK         |      |
| No.               |      |

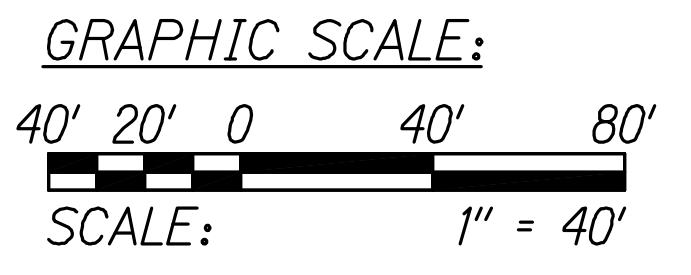

**TRAFFIC CONTROL PLAN - PHASE 12**  
**FOR WORK ON KEEAU-PAHOA RD AT SHOWER DR**  
SCALE: 1" = 40'