

FED. ROAD DIST. NO.	STATE	PROJ. NO.	FISCAL YEAR	SHEET NO.	TOTAL SHEETS
HAWAII	HAW.	130B-01-98	1999	112	210

FOR CONTINUATION
SEE SHT. NO. 114

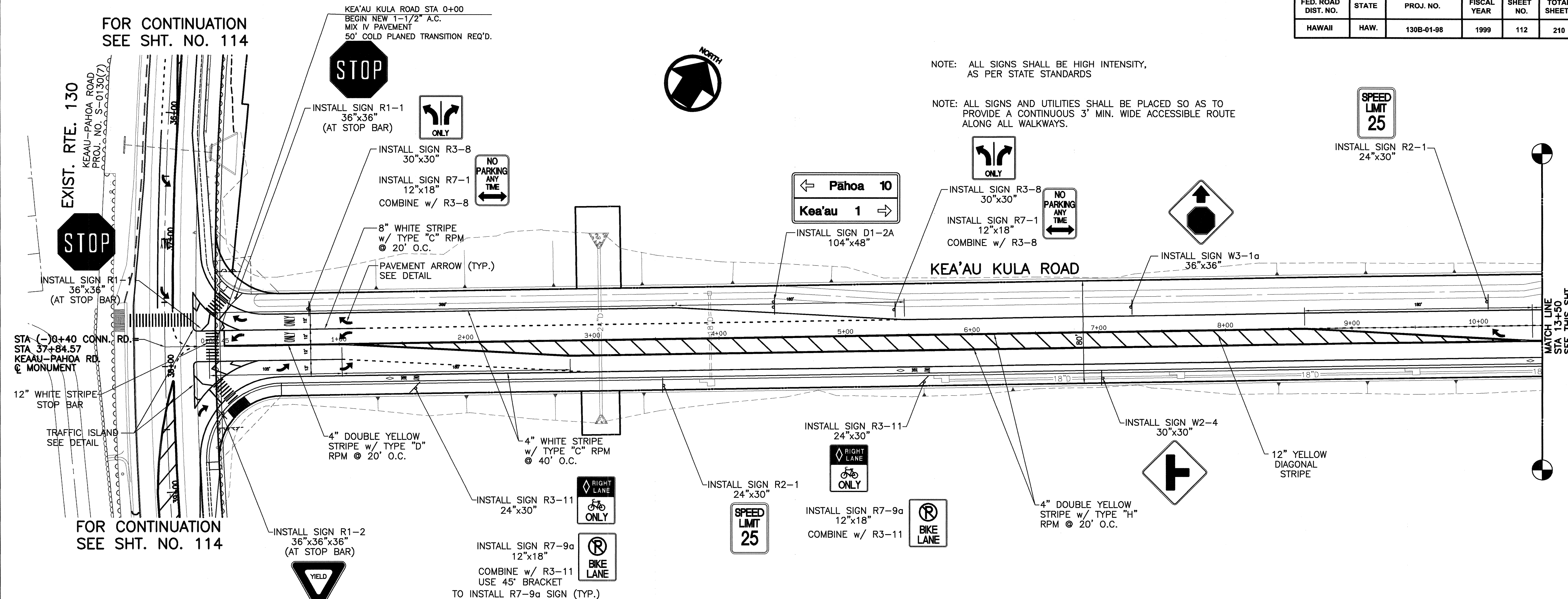

NOTE: ALL SIGNS SHALL BE HIGH INTENSITY,
AS PER STATE STANDARDS

NOTE: ALL SIGNS AND UTILITIES SHALL BE PLACED SO AS TO
PROVIDE A CONTINUOUS 3' MIN. WIDE ACCESSIBLE ROUTE
ALONG ALL WALKWAYS.

FOR CONTINUATION
SEE SHT. NO. 114

PLAN - KEA'AU KULA ROAD (CONNECTOR ROAD)
SCALE: 1"=40'

ESTIMATED QUANTITIES	
A.C. MIX IV	1050 TONS

NOTE: THE CONTRACTOR SHALL
PAVE THE KEA'AU KULA
ROAD W/ 1-1/2" A.C.
MIX IV.

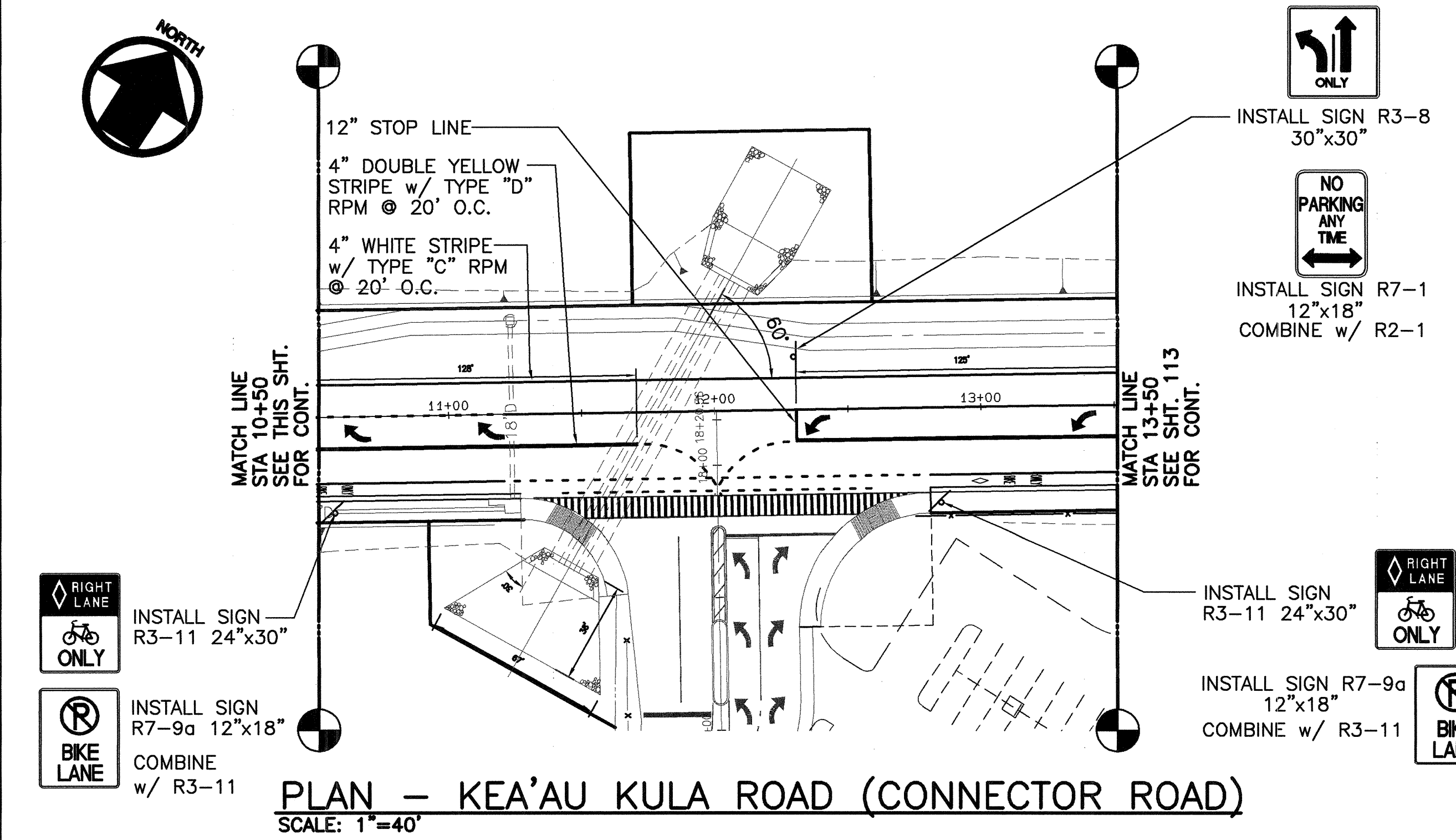

PLAN - KEA'AU KULA ROAD (CONNECTOR ROAD)
SCALE: 1"=40'

SURVEY PLOTTED BY	DATE
DRAWN BY	
TRACED BY	
QUANTITIES BY	
CHECKED BY	
ORIGINAL PLAN	
NOTE BOOK	
No. shts-plotted	

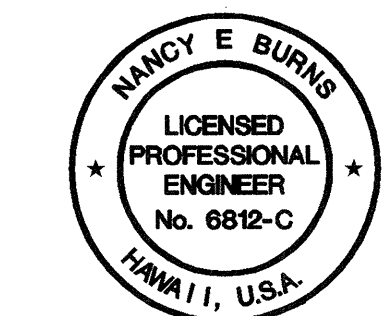

The work was prepared by me or under
my supervision and construction of this
project will be under my observation.
Nancy E. Burns
DATE: 9/11/98

STATE OF HAWAII
DEPARTMENT OF TRANSPORTATION
HIGHWAYS DIVISION
SIGNING & STRIPING
KEA'AU KULA ROAD
KEA'AU-PAHOA ROAD VIC. OF KEA'AU
TOWN (KEA'AU BYPASS ROAD), PH. 2
PROJECT NO. 130B-01-98
Scale: 1"=40' Date: August, 1998
SHEET No. 1 OF 3 SHEETS

FED. ROAD DIST. NO.	STATE	PROJ. NO.	FISCAL YEAR	SHEET NO.	TOTAL SHEETS
HAWAII	HAW.	130B-01-98	1999	113	210

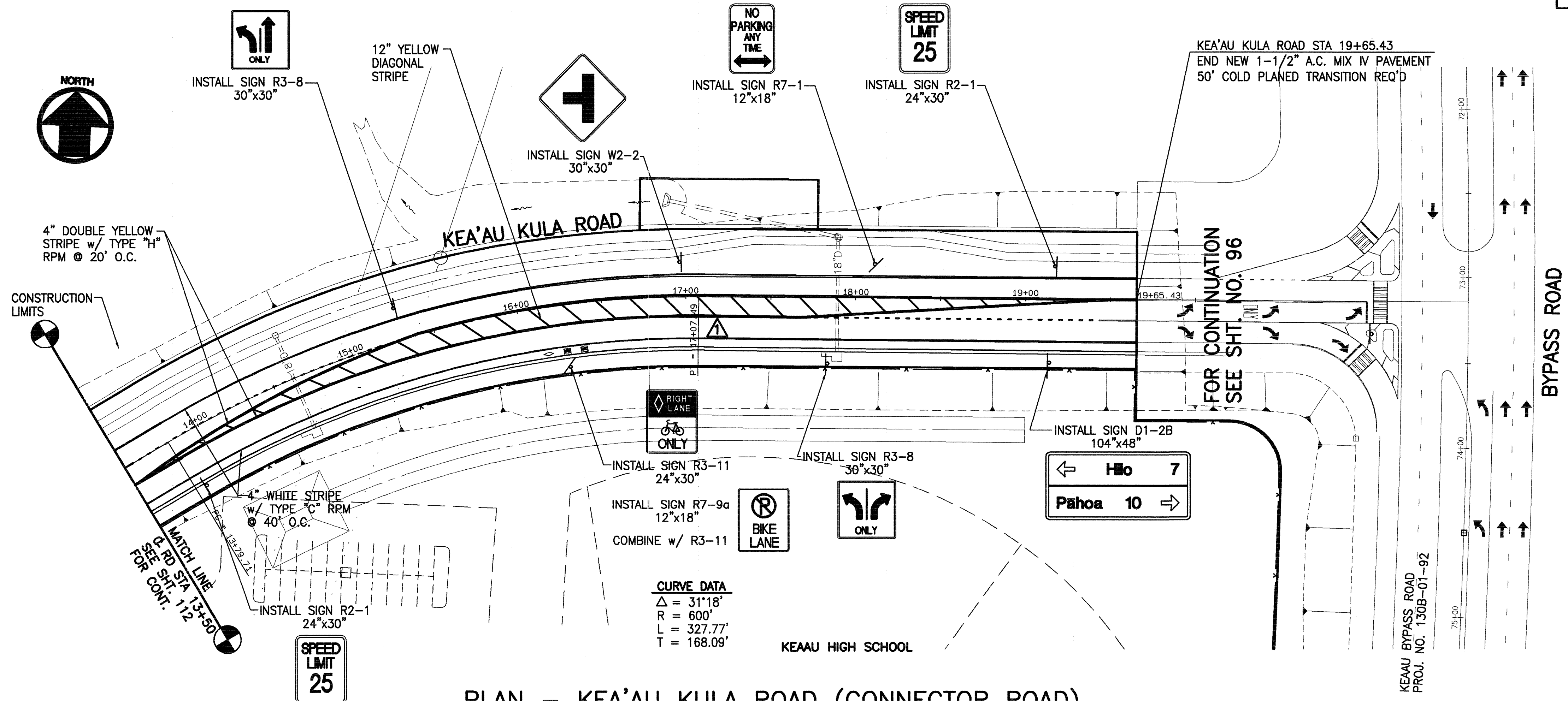

PLAN — KEA'AU KULA ROAD (CONNECTOR ROAD)
SCALE: 1"=40'

CURVE DATA
 $\Delta = 31^{\circ}18'$
 $R = 600'$
 $L = 327.77'$
 $T = 168.09'$

SURVEY PLOTTED BY	DATE
DRAWN BY	
TRACED BY	
QUANTITIES BY	
CHECKED BY	
ORIGINAL PLAN	
NOTE BOOK	
No. 411-2-2-98	

NOTE:
 THE CONTRACTOR SHALL PAVE THE KEA'AU KULA ROAD W/ 1-1/2" A.C. MIX IV. ALL SIGNS SHALL BE HIGH INTENSITY.



The work was prepared by me or under my supervision and construction of this project will be under my observation.
Nancy E. Burns
 DATE: 8/24/98

STATE OF HAWAII
 DEPARTMENT OF TRANSPORTATION
 HIGHWAYS DIVISION
SIGNING & STRIPING
KEA'AU KULA ROAD
 KEA'AU-PAHOA ROAD VIC. OF KEA'AU TOWN (KEA'AU BYPASS ROAD), PH. 2
 PROJECT NO. 130B-01-98
 Scale: 1"=40' Date: August, 1998
 SHEET No. 2 OF 3 SHEETS

FED. ROAD DIST. NO.	STATE	PROJ. NO.	FISCAL YEAR	SHEET NO.	TOTAL SHEETS
HAWAII	HAW.	130B-01-98	1999	114	210

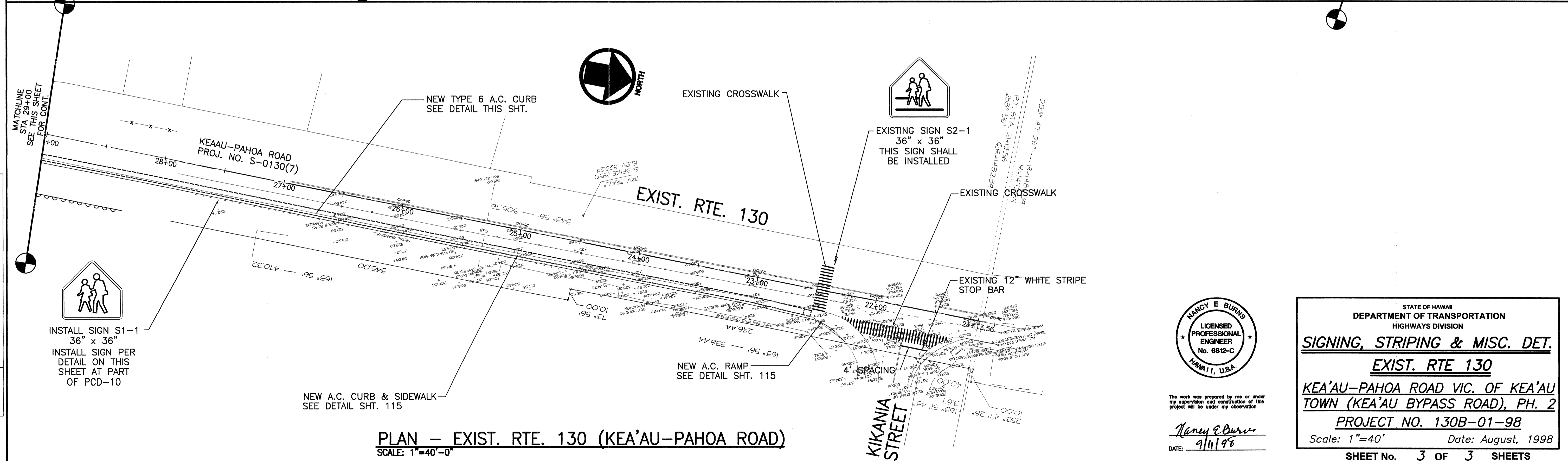
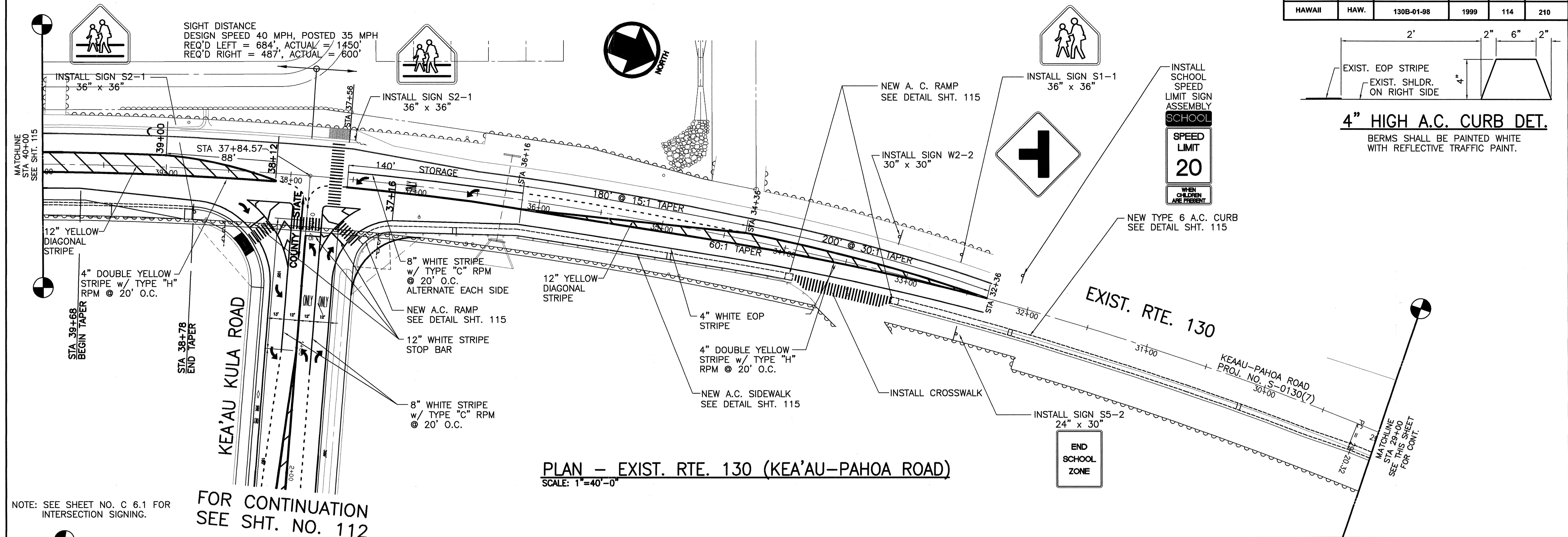

SURVEY PLOTTED BY	DATE
DRAWN BY	
DESIGNED BY	
QUANTITIES BY	
CHECKED BY	
ORIGINAL PLAN	
NOTE BOOK	
No. SHEET	



The work was prepared by me or under my supervision and construction of this project will be under my observation.

Nancy E. Burns
DATE: 9/11/98

STATE OF HAWAII
DEPARTMENT OF TRANSPORTATION
HIGHWAYS DIVISION

SIGNING, STRIPING & MISC. DET.

EXIST. RTE 130

KEA'AU-PAHOA ROAD VIC. OF KEA'AU TOWN (KEA'AU BYPASS ROAD), PH. 2

PROJECT NO. 130B-01-98

Scale: 1"=40' Date: August, 1998

SHEET No. 3 OF 3 SHEETS