

FED. ROAD DIST. NO.	STATE	PROJ. NO.	FISCAL YEAR	SHEET NO.	TOTAL SHEETS
HAWAII	HAW.	130B-01-92	1997	11	115

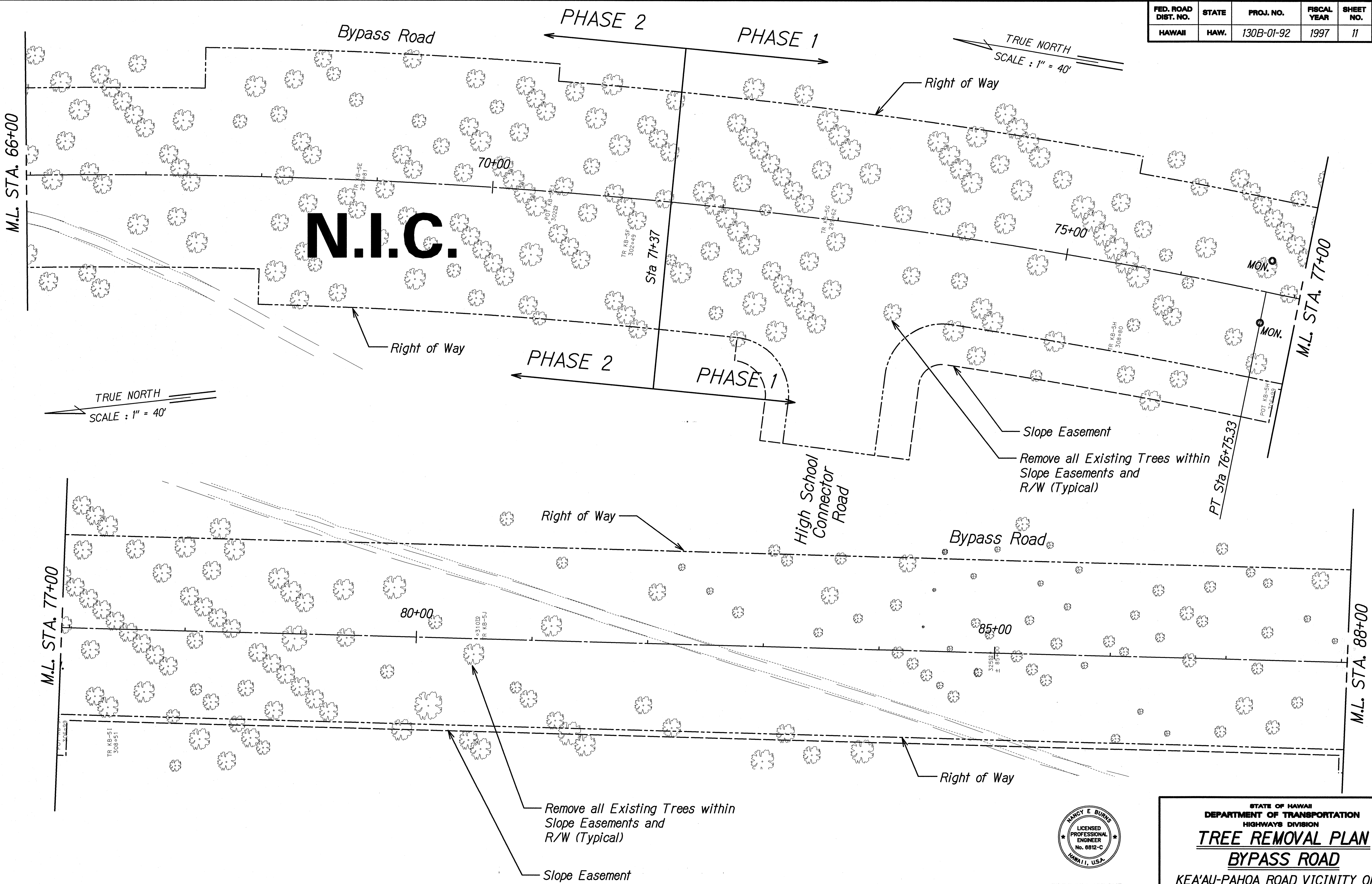

ORIGINAL PLAN	SURVEY PLOTTED BY	DATE
NOTED BOOK	DRAWN BY	
DESIGNED BY	TRACED BY	
CHECKED BY	DESIGNED BY	
	CHECKED BY	



THIS WORK WAS PREPARED BY ME
OR UNDER MY SUPERVISION
Nancy E. Burns
DATE: 5/22/97

STATE OF HAWAII
DEPARTMENT OF TRANSPORTATION
HIGHWAYS DIVISION
TREE REMOVAL PLAN
BYPASS ROAD
KEA'AU-PAHOA ROAD VICINITY OF
KEA'AU TOWN (KEA'AU BYPASS ROAD)
PROJECT NO. 130B-01-92, PHASE 1
Scale: 1"=40' Date: May, 1997
SHEET No. 1 OF 4 SHEETS

FED. ROAD DIST. NO.	STATE	PROJ. NO.	FISCAL YEAR	SHEET NO.	TOTAL SHEETS
HAWAII	HAW.	130B-01-92	1997	12	115

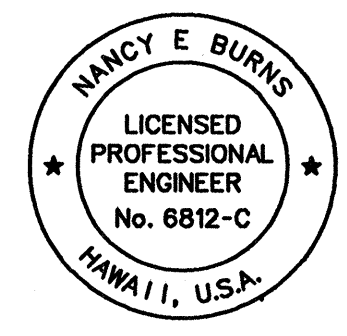
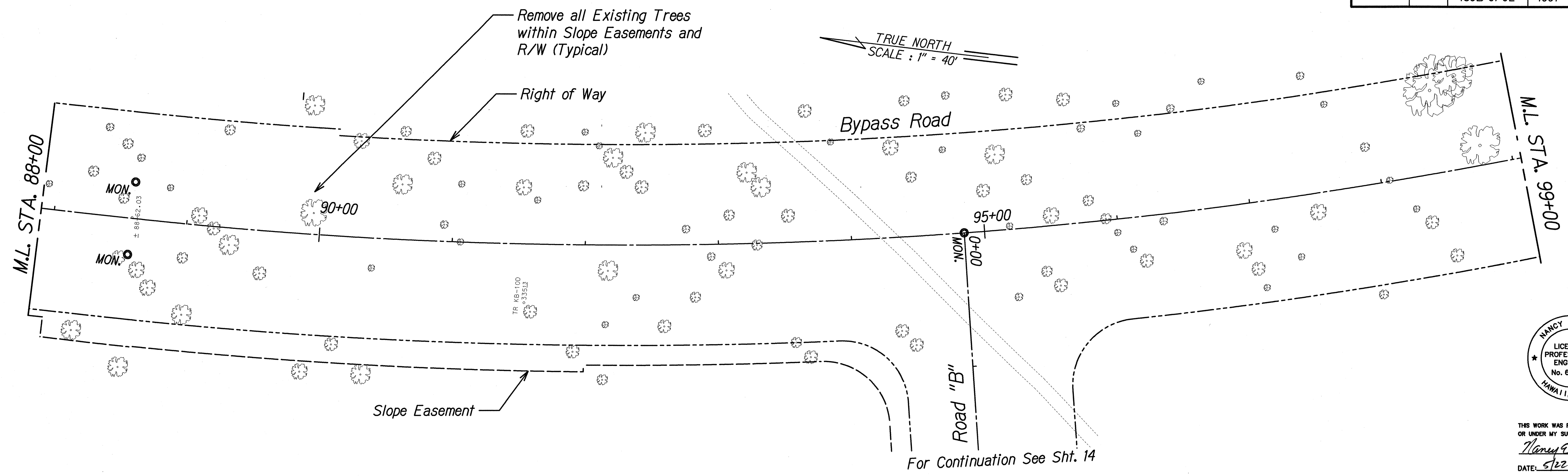

THIS WORK WAS PREPARED BY ME
OR UNDER MY SUPERVISION.
Nancy E. Burns
DATE: 5/22/97

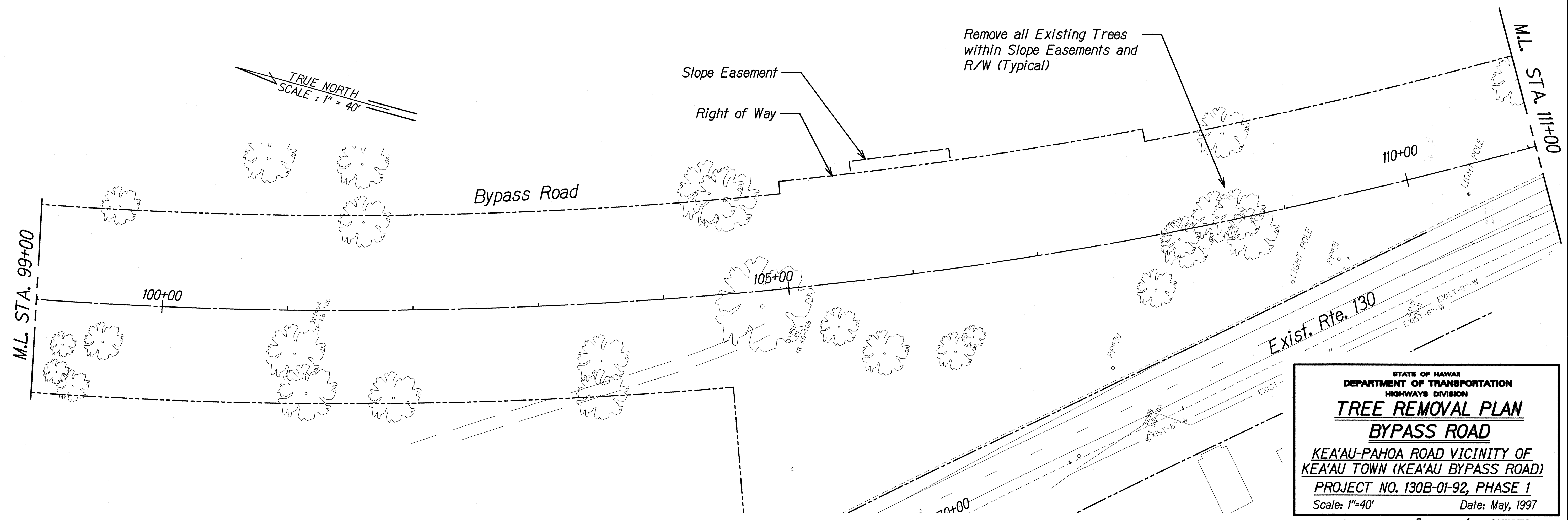

STATE OF HAWAII
DEPARTMENT OF TRANSPORTATION
HIGHWAYS DIVISION

TREE REMOVAL PLAN
BYPASS ROAD

KEA'AU-PAHOA ROAD VICINITY OF
KEA'AU TOWN (KEA'AU BYPASS ROAD)

PROJECT NO. 130B-01-92, PHASE 1

Scale: 1"=40' Date: May, 1997

SURVEY PLOTTED BY	DATE
DRAWN BY	
TRACED BY	
DESIGNED BY	
CHECKED BY	

ORIGINAL PLAN
NOTE BOOK
N. phdcm-22gn

FED. ROAD DIST. NO.	STATE	PROJ. NO.	FISCAL YEAR	SHEET NO.	TOTAL SHEETS
HAWAII	HAW.	130B-01-92	1997	13	115

TRUE NORTH
SCALE : 1" = 40'

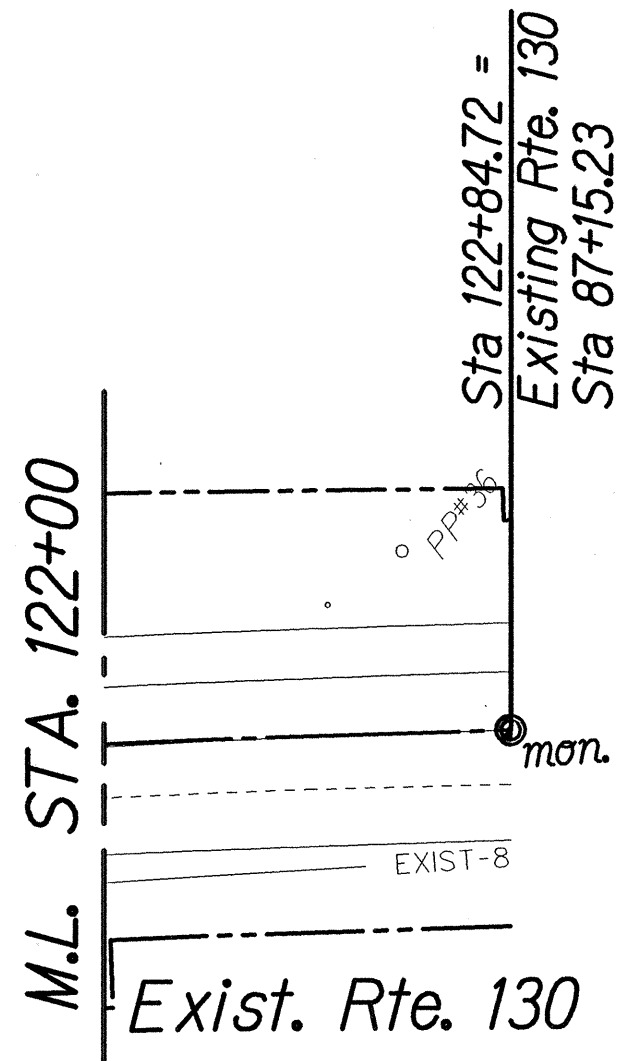
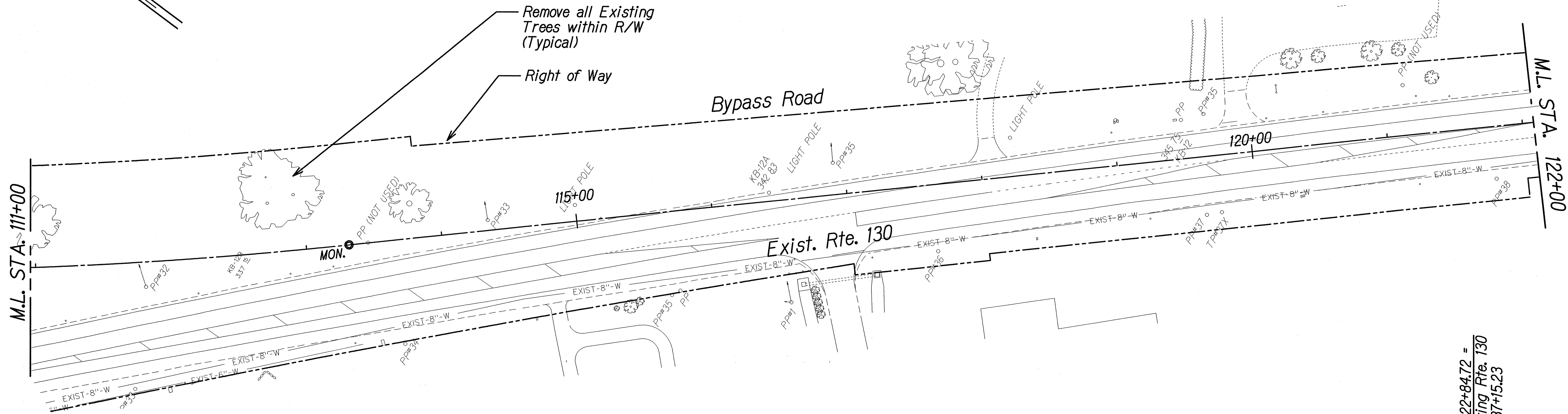

ORIGINAL PLAN	SURVEY PLOTTED BY	DATE
NOTED BOOK	DRAWN BY	
NA. PHIDEK-3UG	DESIGNED BY	
	CHECKED BY	

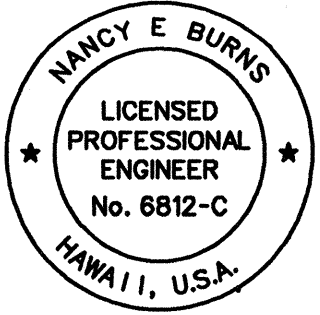

THIS WORK WAS PREPARED BY ME
OR UNDER MY SUPERVISION.
Nancy E. Burns
DATE: 5/22/97

STATE OF HAWAII
DEPARTMENT OF TRANSPORTATION
HIGHWAYS DIVISION

TREE REMOVAL PLAN
BYPASS ROAD
KEA'AU-PAHOA ROAD VICINITY OF
KEA'AU TOWN (KEA'AU BYPASS ROAD)
PROJECT NO. 130B-01-92, PHASE 1
Scale: 1"=40' Date: May, 1997

SHEET No. 3 OF 4 SHEETS

FED. ROAD DIST. NO.	STATE	PROJ. NO.	FISCAL YEAR	SHEET NO.	TOTAL SHEETS
HAWAII	HAW.	130B-01-92	1997	14	115

TRUE NORTH
SCALE : 1" = 40'

Remove all Existing Trees within Slope Easement and R/W (Typical)

For Continuation See Sht. 12

BYPASS ROAD

For Continuation See Sht. 12

Existing Rte. 130
Sta 55+98.50 =
Road "A" Sta 1+19.31

ROAD "A"

Right of Way

Road "B"

5+00 MON.

M.L. STA. 6+00

Slope Easement

TRUE NORTH
SCALE : 1" = 40'

Road "B"

10+00

MON. 0+00

M.L. STA. 6+00

Right of Way

Road "B" Sta 13+22.39 =
Existing Rte. 130 Sta 50+30.15



THIS WORK WAS PREPARED BY ME
OR UNDER MY SUPERVISION
Nancy E. Burns
DATE: 5/22/97

STATE OF HAWAII
DEPARTMENT OF TRANSPORTATION
HIGHWAYS DIVISION

TREE REMOVAL PLAN
ROAD "A" AND ROAD "B"
KEA'AU-PAHOA ROAD VICINITY OF
KEA'AU TOWN (KEA'AU BYPASS ROAD)
PROJECT NO. 130B-01-92, PHASE 1
Scale: 1"=40' Date: May, 1997

ORIGINAL PLAN	SURVEY PLOTTED BY	DATE
NOTE BOOK	DRAWN BY	
	DESIGNED BY	
	CHECKED BY	