

FED. ROAD DIST. NO.	STATE	PROJ. NO.	FISCAL YEAR	SHEET NO.	TOTAL SHEETS
HAWAII	HAW.	130B-01-92	1997	74	115

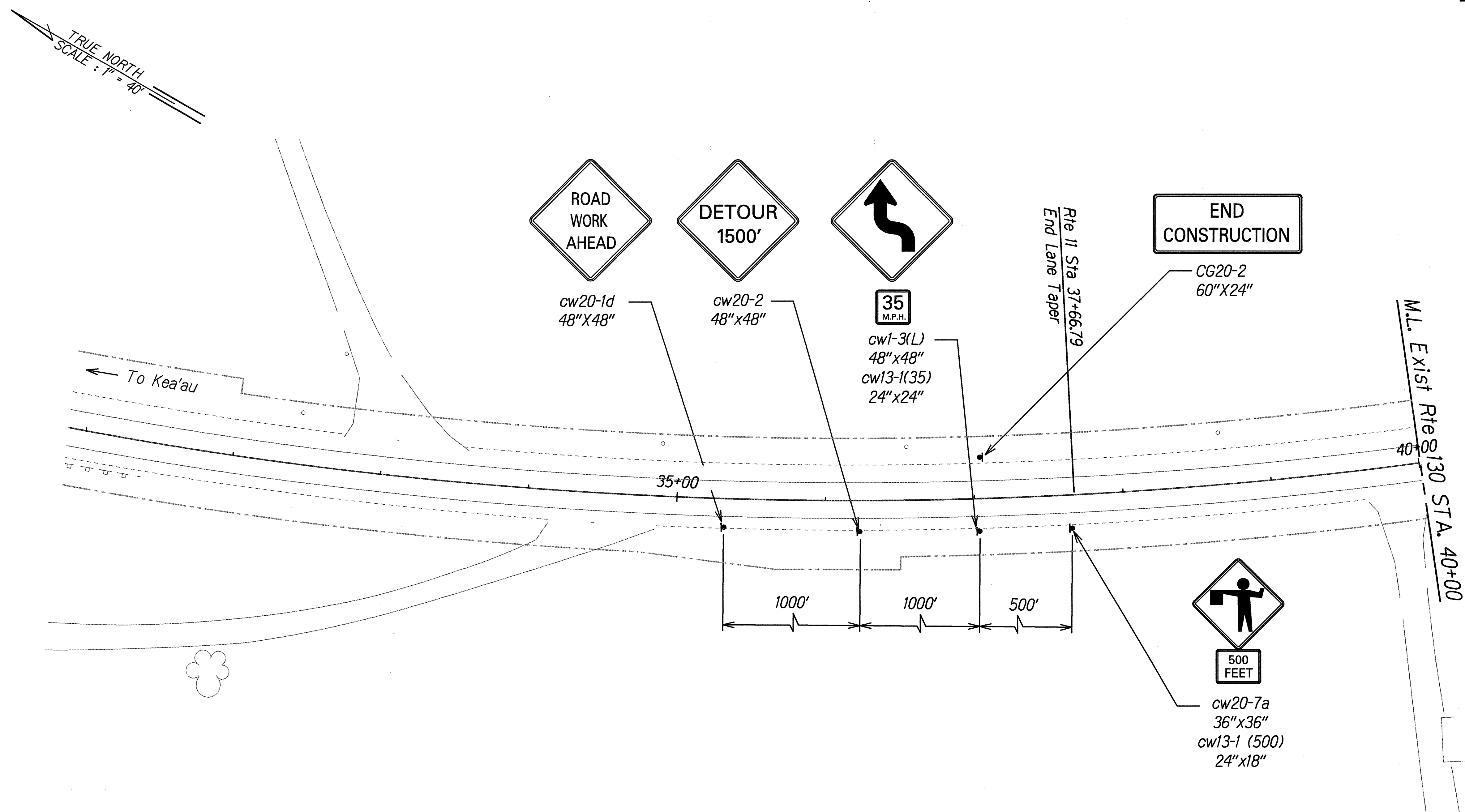

SURVEY PLOTTED BY	DATE
DRAWN BY	
CHECKED BY	
NOTED BY	
QUANTITIES BY	
CHECKED BY	
ORIGINAL PLAN	
NOTE BOOK	
DATE	

LEGEND	
Temporary Concrete Barrier	=====
Type I Barricade	...
Construction Area	////

- Notes:
1. Remove all existing striping within the detour area or as directed by the Engineer
 2. Replace with temporary striping as shown on Traffic Control Plans or as directed by the Engineer
 3. During the traffic control Plan stage B, the traffic pattern will be detoured on the Bypass Road, Road "B" and the Detour lanes. Three lanes of traffic including the shoulder lane will be operational as shown on the plans or as directed by the Engineer.
 4. This detour is to remain in place during the Phase 2 construction. All Type I barricades maybe removed at the end of the Phase 1 construction.

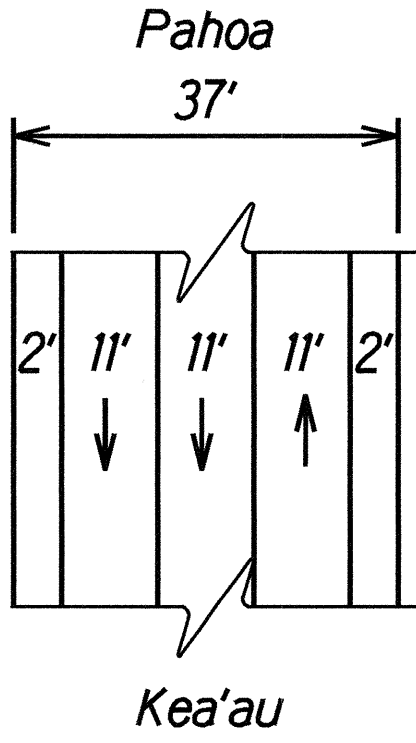

Typical Pav't Striping for
Temporary Detour Lane
Scale: N.T.S.

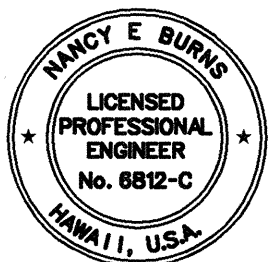

THIS WORK WAS PREPARED BY ME
OR UNDER MY SUPERVISION
Nancy E. Burns
DATE: 8/6/97

STATE OF HAWAII
DEPARTMENT OF TRANSPORTATION
HIGHWAYS DIVISION

TRAFFIC CONTROL PLAN
STAGE B

KEA'AU-PAHOA ROAD VICINITY OF
KEA'AU TOWN (KEA'AU BYPASS ROAD)

PROJECT NO. 130B-01-92, PHASE 1

Scale: 1" = 40' Date: May, 1997

FED. ROAD DIST. NO.	STATE	PROJ. NO.	FISCAL YEAR	SHEET NO.	TOTAL SHEETS
HAWAII	HAW.	130B-01-92	1997	75	115

TRUE NORTH
SCALE: 1" = 40'

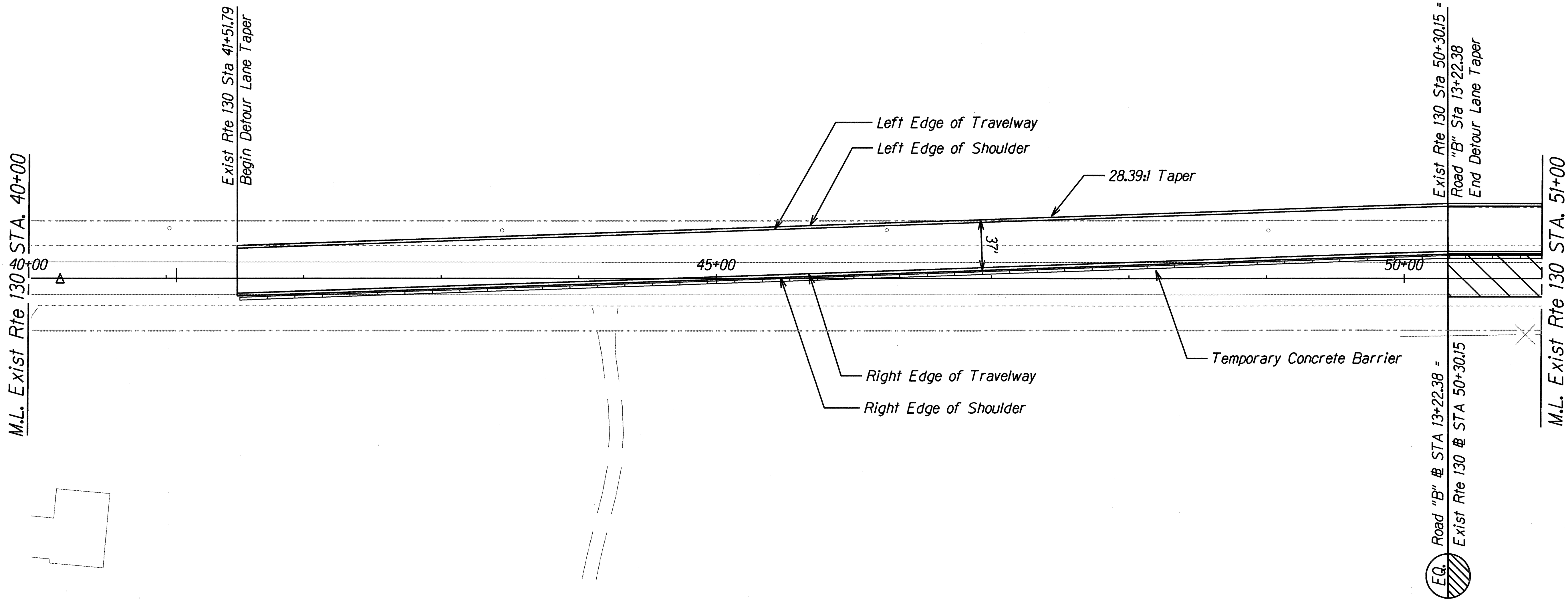

M.L. Exist Rte 130 STA. 40+00

Exist Rte 130 Sta 41+51.79
Begin Detour Lane Taper

45+00

50+00

Exist Rte 130 Sta 50+30.15 =
Road "B" Sta 13+22.38
End Detour Lane Taper

M.L. Exist Rte 130 STA. 51+00

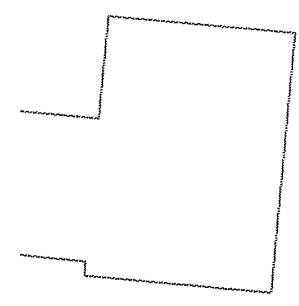

EQ. Road "B" @ STA 13+22.38 =
Exist Rte 130 @ STA 50+30.15

SURVEY PLOTTED BY	DATE
DRAWN BY	
TRACED BY	
CHECKED BY	
NO. REVISIONS	
CHECKED BY	

LEGEND	
Temporary Concrete Barrier	
Type I Barricade	
Construction Area	

- Notes:
1. Remove all existing striping within the detour area or as directed by the Engineer
 2. Replace with temporary striping as shown on Traffic Control Plans or as directed by the Engineer
 3. During the traffic control Plan stage B, the traffic pattern will be detoured on the Bypass Road, Road "B" and the Detour lanes. Three lanes of traffic including the shoulder lane will be operational as shown on the plans or as directed by the Engineer.
 4. This detour is to remain in place during the Phase 2 construction. All Type I barricades maybe removed at the end of the Phase 1 construction.



THIS WORK WAS PREPARED BY ME
OR UNDER MY SUPERVISION
Nancy E. Burns
DATE: 5/8/97

STATE OF HAWAII
DEPARTMENT OF TRANSPORTATION
HIGHWAYS DIVISION
TRAFFIC CONTROL PLAN
STAGE B
KEA'AU-PAHOA ROAD VICINITY OF
KEA'AU TOWN (KEA'AU BYPASS ROAD)
PROJECT NO. 130B-01-92, PHASE 1
Scale: 1" = 40' Date: May, 1997

FED. ROAD DIST. NO.	STATE	PROJ. NO.	FISCAL YEAR	SHEET NO.	TOTAL SHEETS
HAWAII	HAW.	130B-01-92	1997	76	115

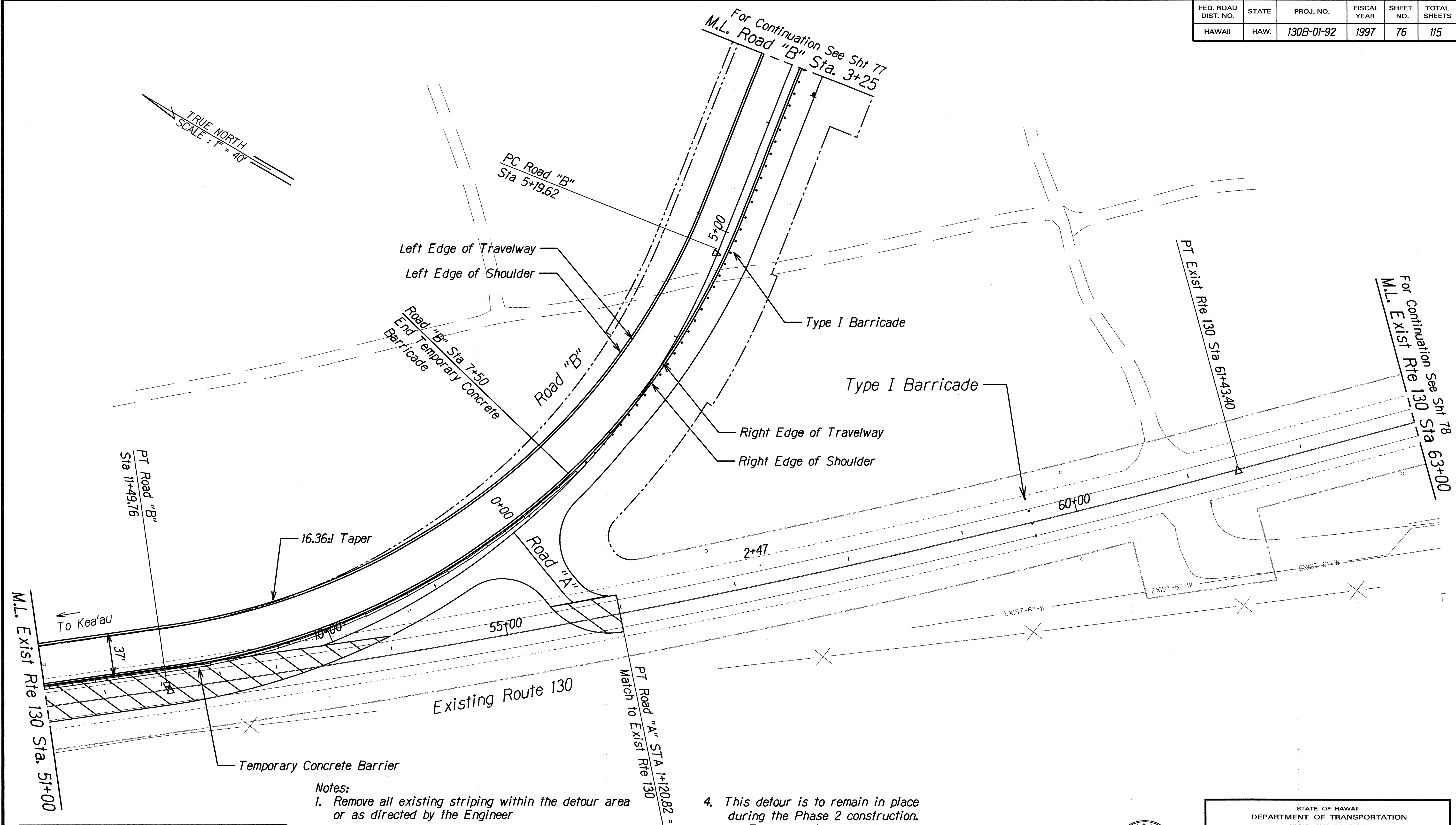

Notes:

1. Remove all existing striping within the detour area or as directed by the Engineer
2. Replace with temporary striping as shown on Traffic Control Plans or as directed by the Engineer
3. During the traffic control Plan stage B, the traffic pattern will be detoured on the Bypass Road, Road "B" and the Detour lanes. Three lanes of traffic including the shoulder lane will be operational as shown on the plans or as directed by the Engineer.
4. This detour is to remain in place during the Phase 2 construction. All Type 1 barricades maybe removed at the end of the Phase 1 construction.

LEGEND	
Temporary Concrete Barrier	—
Type I Barricade	...
Construction Area	///



THIS WORK WAS PREPARED BY ME
OR UNDER MY SUPERVISION
Nancy E. Burns
DATE: 8/18/97

STATE OF HAWAII
DEPARTMENT OF TRANSPORTATION
HIGHWAYS DIVISION
TRAFFIC CONTROL PLAN
STAGE B
KEA'AU-PAHOA ROAD VICINITY OF
KEA'AU TOWN (KEA'AU BYPASS ROAD)
PROJECT NO. 130B-01-92, PHASE 1
Scale: 1" = 40' Date: May, 1997
SHEET NO. 3 OF 8 SHEETS

SURVEY PLOTTED BY	DATE
DRAWN BY	
CHECKED BY	
NOTE BOOK	
CHECKED BY	
DATE	

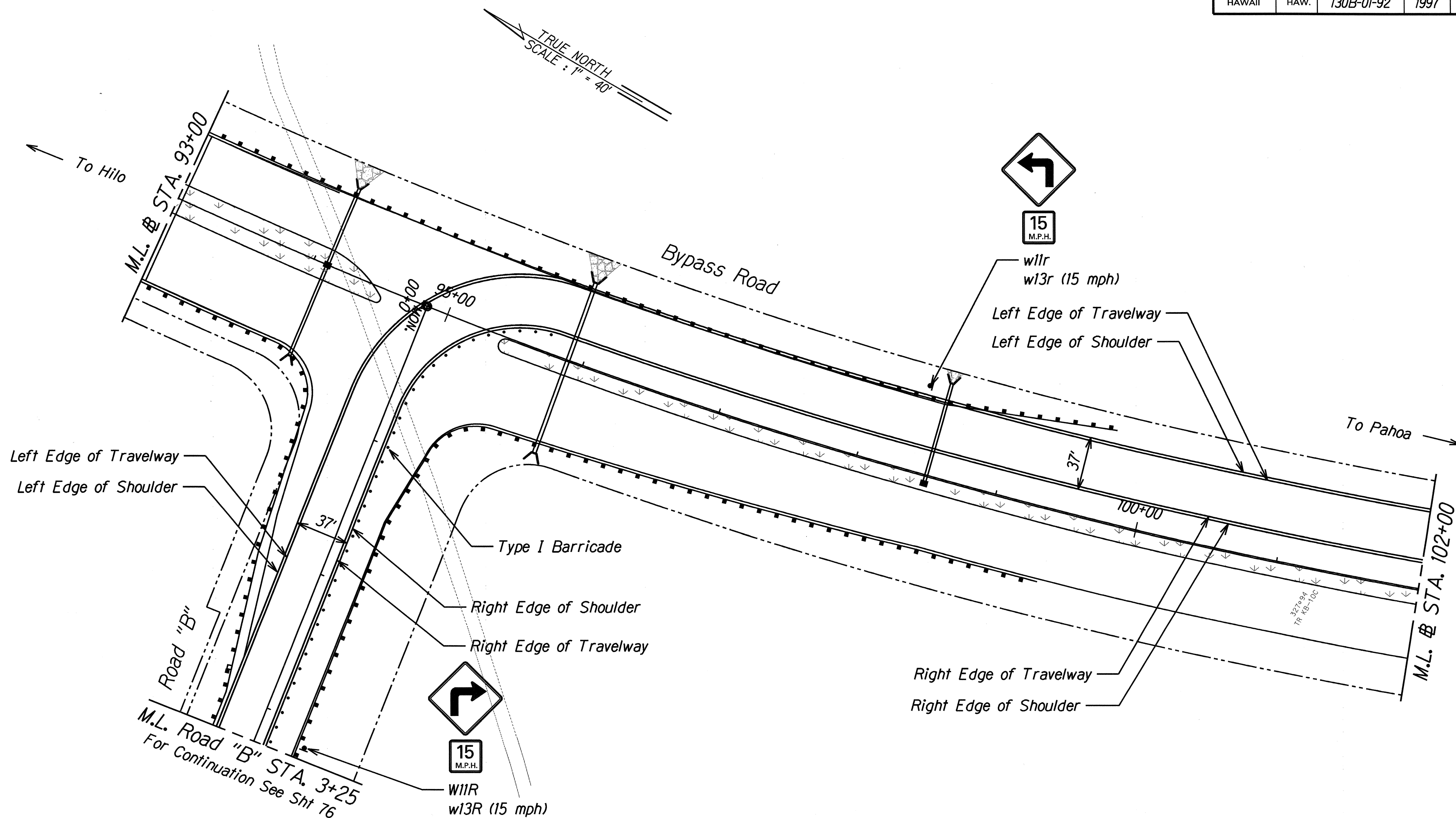

Notes:

1. Remove all existing striping within the detour area or as directed by the Engineer
2. Replace with temporary striping as shown on Traffic Control Plans or as directed by the Engineer
3. During the traffic control Plan stage B, the traffic pattern will be detoured on the Bypass Road, Road "B" and the Detour lanes. Three lanes of traffic including the shoulder lane will be operational as shown on the plans or as directed by the Engineer.
4. This detour is to remain in place during the Phase 2 construction. All Type I barricades maybe removed at the end of the Phase 1 construction.

LEGEND

Temporary Concrete Barrier	
Type I Barricade	
Construction Area	

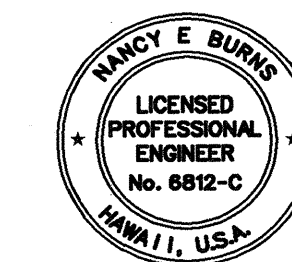

THIS WORK WAS PREPARED BY ME OR UNDER MY SUPERVISION.
Nancy E. Burns
 DATE: 8/19/97

STATE OF HAWAII
 DEPARTMENT OF TRANSPORTATION
 HIGHWAYS DIVISION
TRAFFIC CONTROL PLAN
STAGE B
 KEA'AU-PAHOA ROAD VICINITY OF
 KEA'AU TOWN (KEA'AU BYPASS ROAD)
 PROJECT NO. 130B-01-92, PHASE 1
 Scale: 1" = 40' Date: May, 1997

SHEET NO. 4 OF 8 SHEETS

ADD. 77

SURVEY PLOTTED BY	DATE
DRAWN BY	
TRACED BY	
NOTED BY	
CHECKED BY	
DATE	

FED. ROAD DIST. NO.	STATE	PROJ. NO.	FISCAL YEAR	SHEET NO.	TOTAL SHEETS
HAWAII	HAW.	130B-01-92	1997	78	115

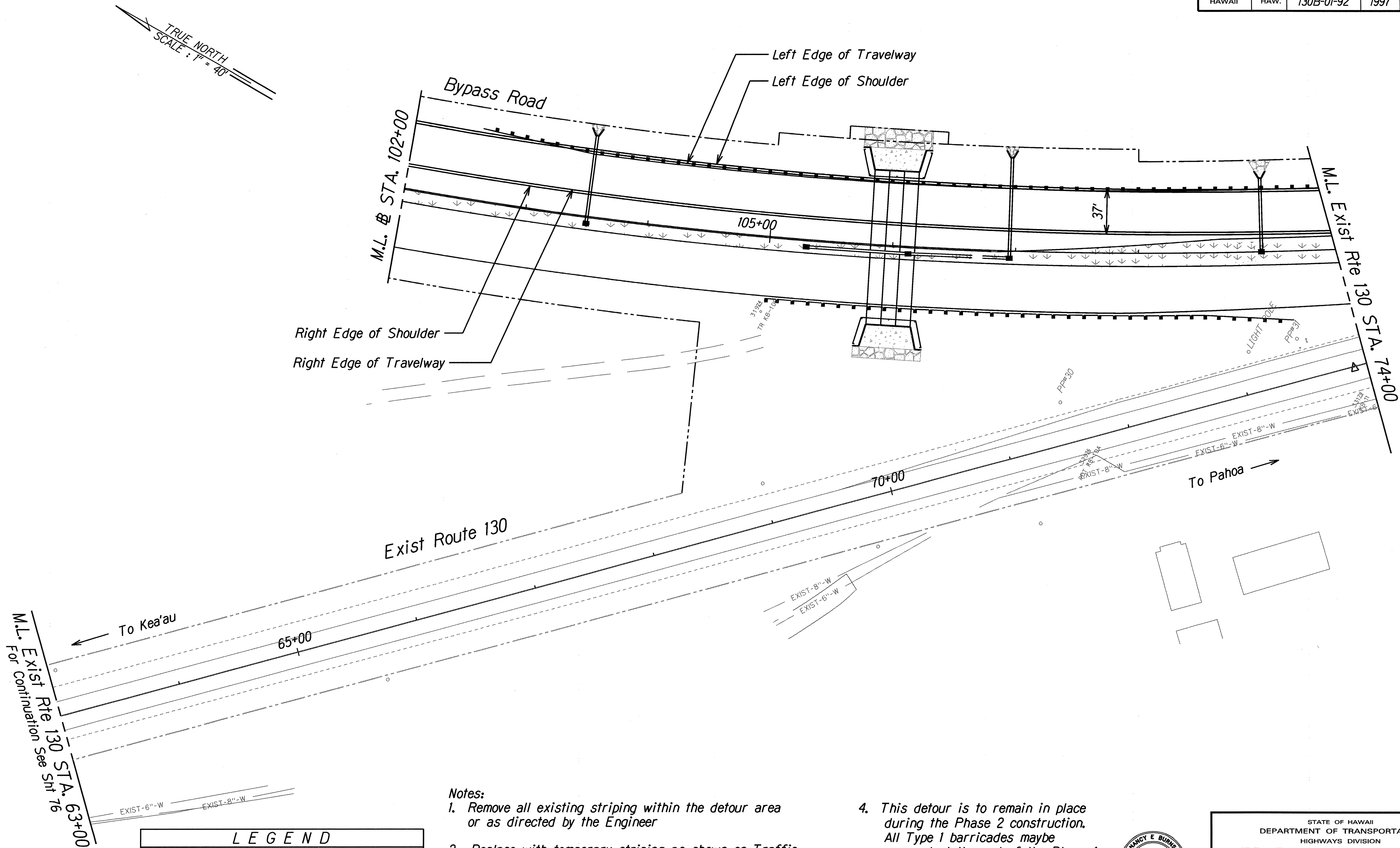

SURVEY PLOTTED BY	DATE
DRAWN BY	
NOTED BY	
CHECKED BY	
ORIGINAL PLAN	
NOTE BOOK	
DATE	

LEGEND	
Temporary Concrete Barrier	
Type I Barricade	
Construction Area	

- Notes:
1. Remove all existing striping within the detour area or as directed by the Engineer
 2. Replace with temporary striping as shown on Traffic Control Plans or as directed by the Engineer
 3. During the traffic control Plan stage B, the traffic pattern will be detoured on the Bypass Road, Road "B" and the Detour lanes. Three lanes of traffic including the shoulder lane will be operational as shown on the plans or as directed by the Engineer.
 4. This detour is to remain in place during the Phase 2 construction. All Type 1 barricades maybe removed at the end of the Phase 1 construction.



THIS WORK WAS PREPARED BY ME
OR UNDER MY SUPERVISION
DATE: 8/8/97

STATE OF HAWAII
DEPARTMENT OF TRANSPORTATION
HIGHWAYS DIVISION

TRAFFIC CONTROL PLAN
STAGE B

KEA'AU-PAHOA ROAD VICINITY OF
KEA'AU TOWN (KEA'AU BYPASS ROAD)

PROJECT NO. 130B-01-92, PHASE 1

Scale: 1" = 40' Date: May, 1997

SHEET No. 5 OF 8 SHEETS

FED. ROAD DIST. NO.	STATE	PROJ. NO.	FISCAL YEAR	SHEET NO.	TOTAL SHEETS
HAWAII	HAW.	130B-01-92	1997	79	115

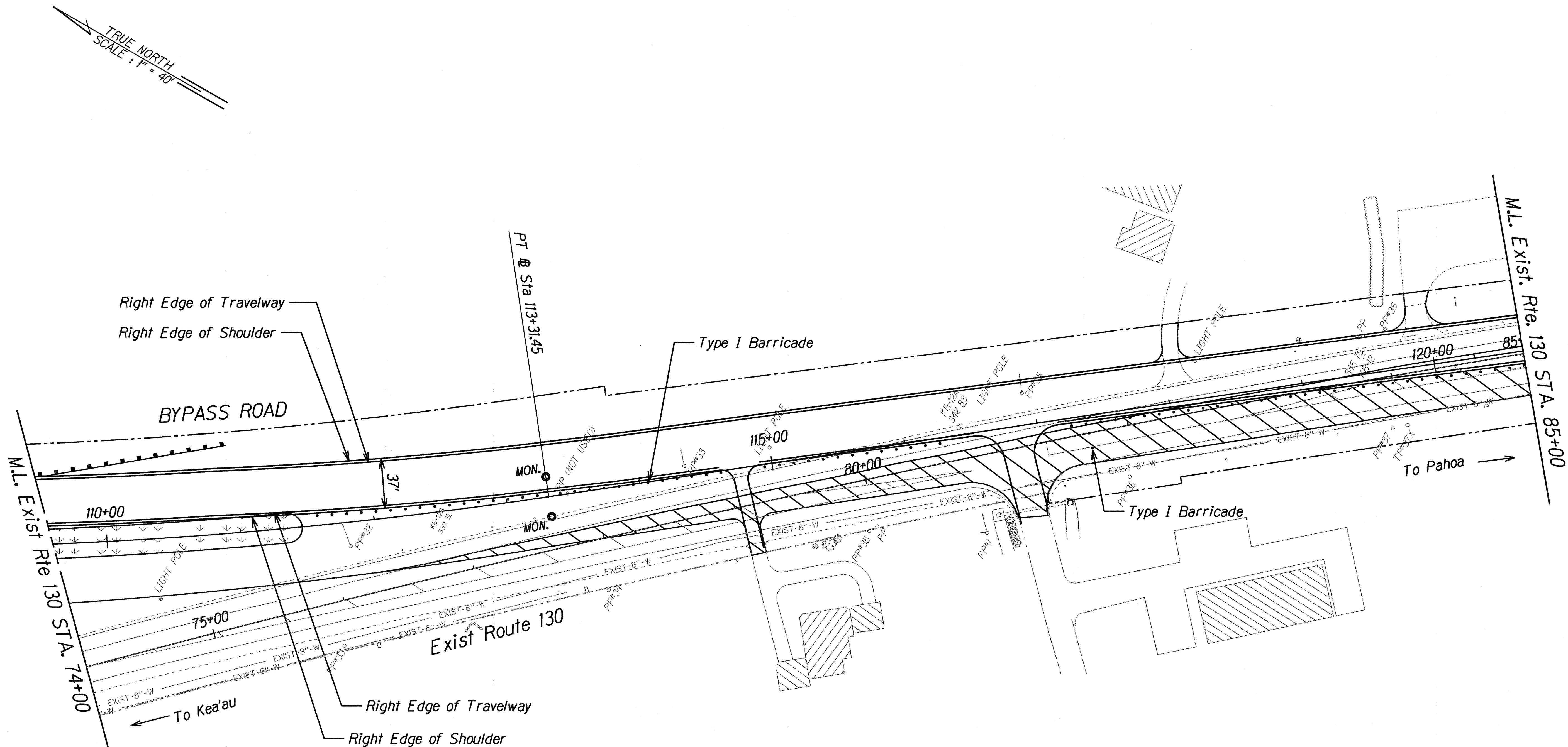

SURVEY PLOTTED BY	DATE
DRAWN BY	
TRACED BY	
CHECKED BY	
NOTED BY	
DATE	

LEGEND	
Temporary Concrete Barrier	
Type I Barricade	
Construction Area	

- Notes:
1. Remove all existing striping within the detour area or as directed by the Engineer
 2. Replace with temporary striping as shown on Traffic Control Plans or as directed by the Engineer
 3. During the traffic control Plan stage B, the traffic pattern will be detoured on the Bypass Road, Road "B" and the Detour lanes. Three lanes of traffic including the shoulder lane will be operational as shown on the plans or as directed by the Engineer.
 4. This detour is to remain in place during the Phase 2 construction. All Type I barricades maybe removed at the end of the Phase 1 construction.



THIS WORK WAS PREPARED BY ME
OR UNDER MY SUPERVISION.
Nancy E. Burns
DATE: 8/8/97

STATE OF HAWAII
DEPARTMENT OF TRANSPORTATION
HIGHWAYS DIVISION

TRAFFIC CONTROL PLAN
STAGE B

KEA'AU-PAHOA ROAD VICINITY OF
KEA'AU TOWN (KEA'AU BYPASS ROAD)

PROJECT NO. 130B-01-92, PHASE 1

Scale: 1" = 40' Date: May, 1997

SHEET No. 6 OF 8 SHEETS

FED. ROAD DIST. NO.	STATE	PROJ. NO.	FISCAL YEAR	SHEET NO.	TOTAL SHEETS
HAWAII	HAW.	130B-01-92	1997	80	115

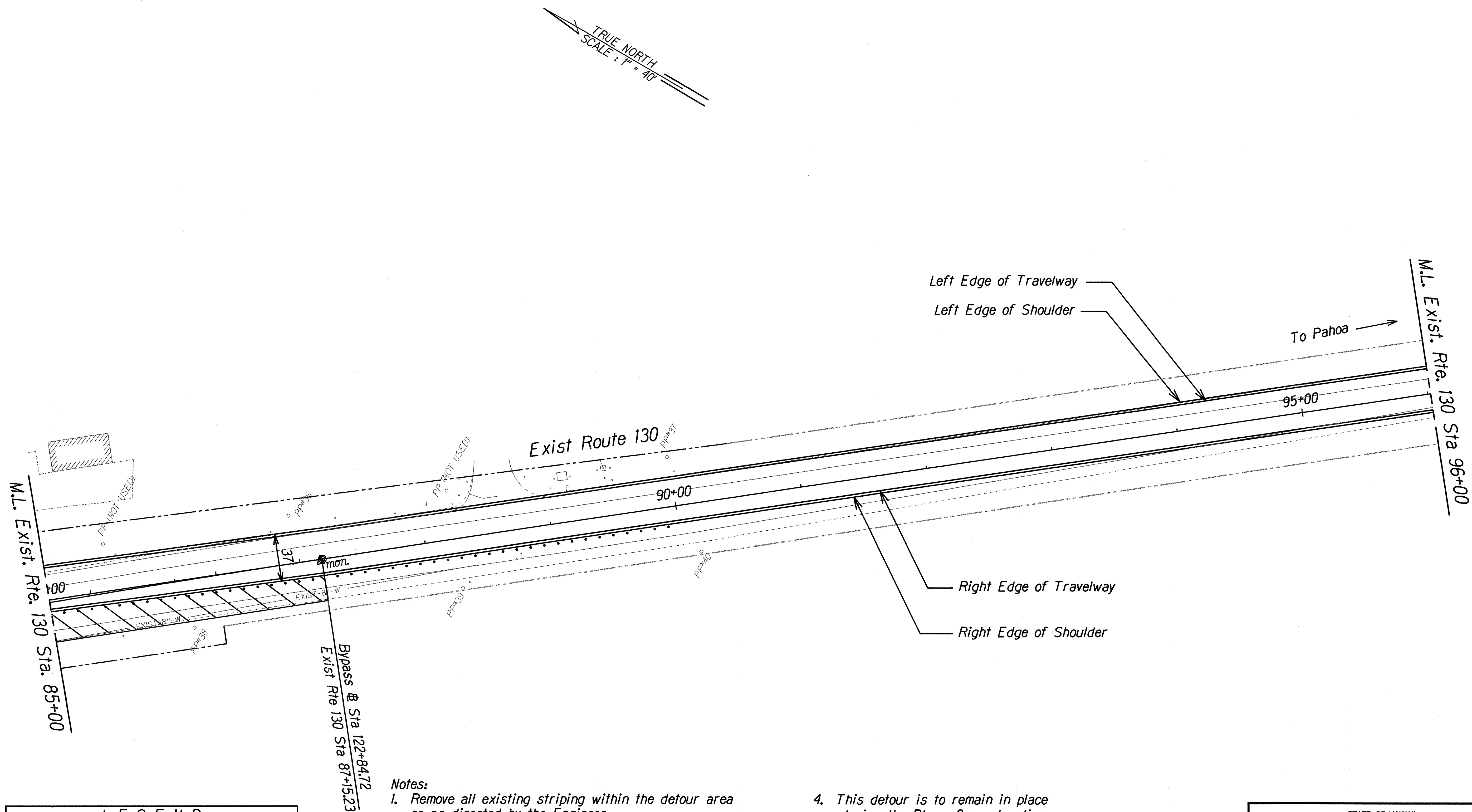

SURVEY PLOTTED BY	DATE
DRAWN BY	
TRACED BY	
NOTE BOOK	
QUANTITIES BY	
CHECKED BY	
PHYSION	
PLAN	
ORIGINAL	

LEGEND	
Temporary Concrete Barrier	—
Type I Barricade	...
Construction Area	▨

- Notes:
1. Remove all existing striping within the detour area or as directed by the Engineer
 2. Replace with temporary striping as shown on Traffic Control Plans or as directed by the Engineer
 3. During the traffic control Plan stage B, the traffic pattern will be detoured on the Bypass Road, Road "B" and the Detour lanes. Three lanes of traffic including the shoulder lane will be operational as shown on the plans or as directed by the Engineer.

4. This detour is to remain in place during the Phase 2 construction. All Type 1 barricades maybe removed at the end of the Phase 1 construction.

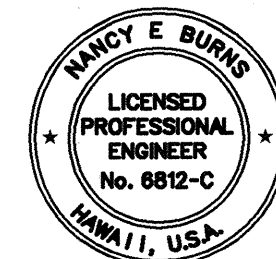

THIS WORK WAS PREPARED BY ME
OR UNDER MY SUPERVISION
Nancy E. Burns
DATE: 2/18/97

STATE OF HAWAII
DEPARTMENT OF TRANSPORTATION
HIGHWAYS DIVISION

TRAFFIC CONTROL PLAN
STAGE B
KEA'AU-PAHOA ROAD VICINITY OF
KEA'AU TOWN (KEA'AU BYPASS ROAD)
PROJECT NO. 130B-01-92, PHASE 1
Scale: 1" = 40' Date: May, 1997

SHEET No. 7 OF 8 SHEETS

FED. ROAD DIST. NO.	STATE	PROJ. NO.	FISCAL YEAR	SHEET NO.	TOTAL SHEETS
HAWAII	HAW.	130B-01-92	1997	81	115

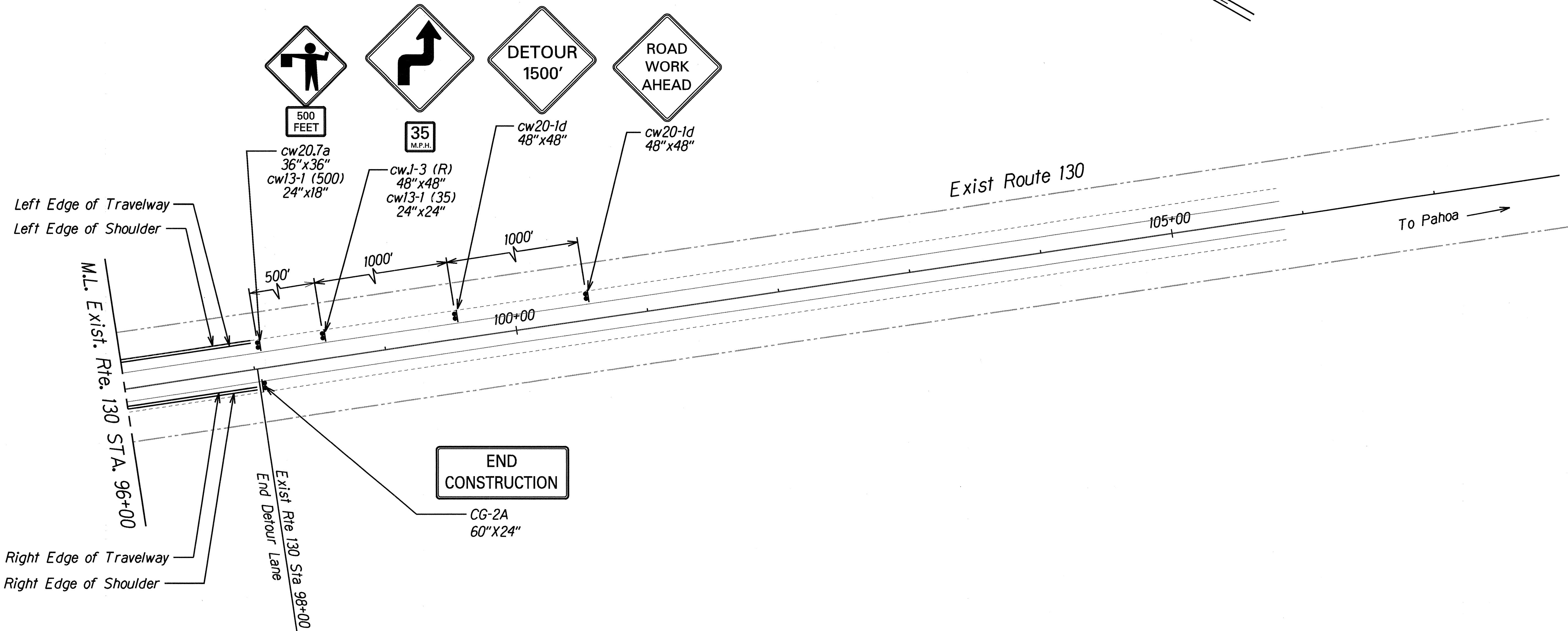

SURVEY PLOTTED BY	DATE
DRAWN BY	
TRACED BY	
NOTED BY	
CHECKED BY	
APPROVED BY	
DATE	

L E G E N D	
Temporary Concrete Barrier	—
Type I Barricade	...
Construction Area	▨

Notes:

1. Remove all existing striping within the detour area or as directed by the Engineer
2. Replace with temporary striping as shown on Traffic Control Plans or as directed by the Engineer
3. During the traffic control Plan stage B, the traffic pattern will be detoured on the Bypass Road, Road "B" and the Detour lanes. Three lanes of traffic including the shoulder lane will be operational as shown on the plans or as directed by the Engineer.
4. This detour is to remain in place during the Phase 2 construction. All Type 1 barricades maybe removed at the end of the Phase 1 construction.



THIS WORK WAS PREPARED BY ME
OR UNDER MY SUPERVISION
Nancy E. Burns
DATE: 8/8/97

STATE OF HAWAII
DEPARTMENT OF TRANSPORTATION
HIGHWAYS DIVISION
TRAFFIC CONTROL PLAN
STAGE B
KEA'AU-PAHOA ROAD VICINITY OF
KEA'AU TOWN (KEA'AU BYPASS ROAD)
PROJECT NO. 130B-01-92, PHASE 1
Scale: 1" = 40' Date: May, 1997
SHEET No. 8 OF 8 SHEETS