

FED. ROAD DIST. NO.	STATE	FED. AID PROJ. NO.	FISCAL YEAR	SHEET NO.	TOTAL SHEETS
HAWAII	HAW.				

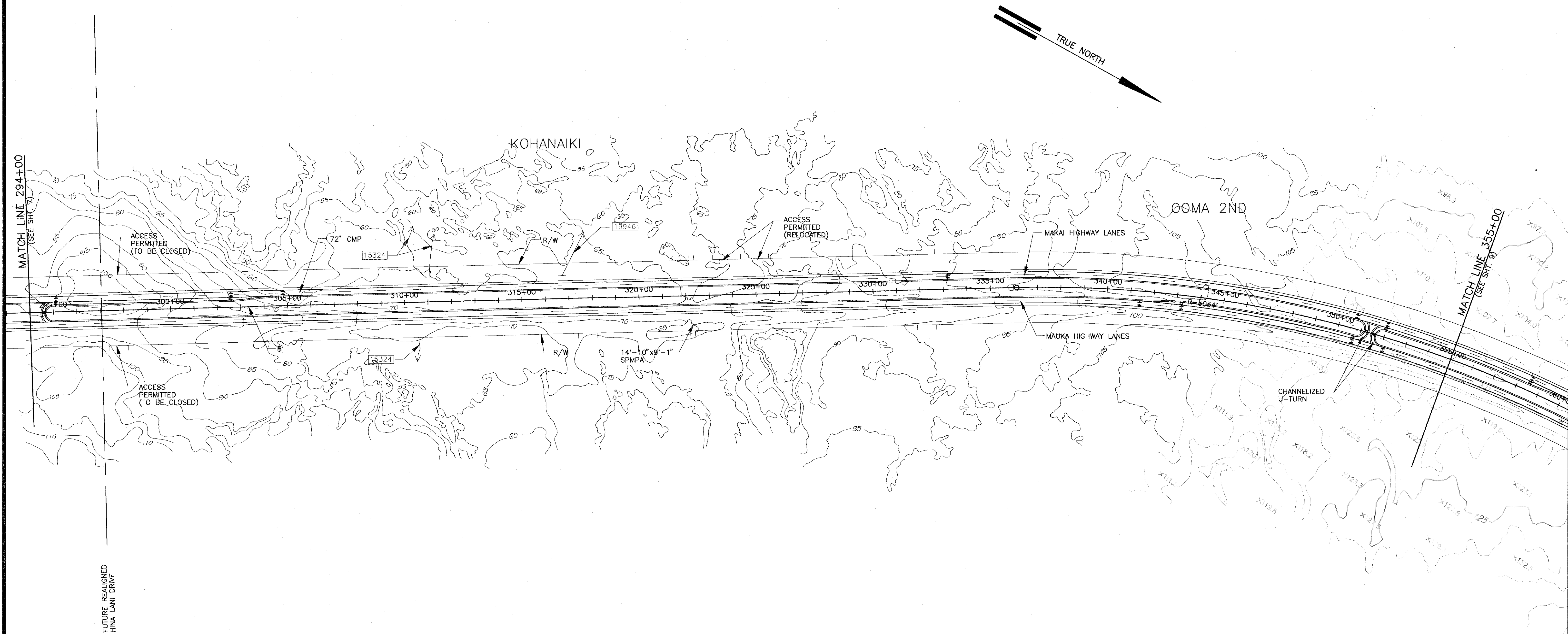

ORIGINAL PLAN	SURVEY PLOTTED BY	DATE
NOTE BOOK	DRAWN BY	
No.	TRACED BY	
	QUANTITIES BY	
	CHECKED BY	

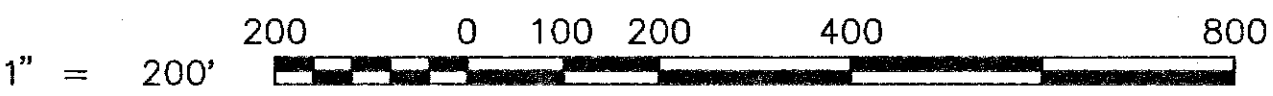

STATE OF HAWAII  
DEPARTMENT OF TRANSPORTATION  
HIGHWAYS DIVISION

QUEEN KAAHUMANU WIDENING  
KAILUA TO KEAHOLE

STA 294+00 TO 355+00

SCALE: 1" = 200'      DATE:

SHEET No. 7 OF 10 SHEETS