

FED. ROAD DIST. NO.	STATE	PROJ. NO.	FISCAL YEAR	SHEET NO.	TOTAL SHEETS
HAWAII	HAW.	HWY-H-06-05M	2005	12	12

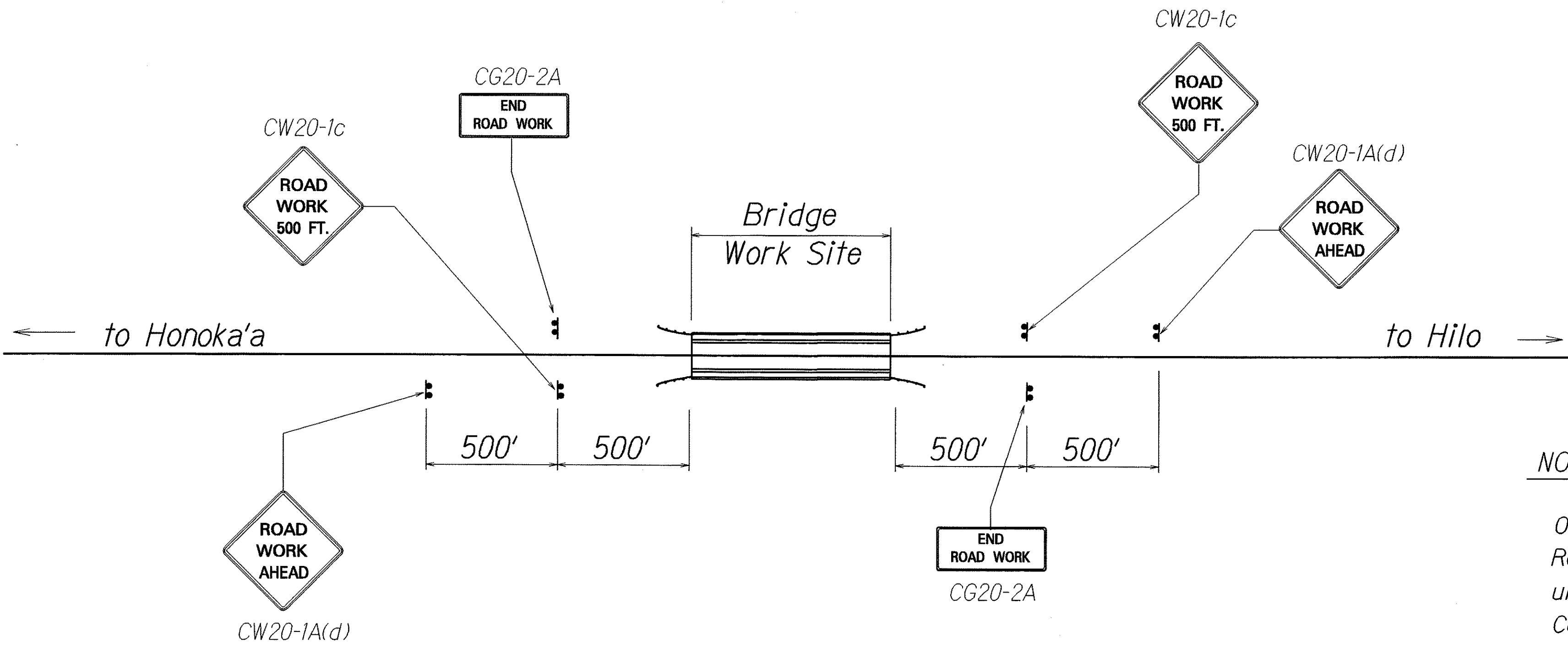

NOTE:
One set of Construction Warning Signs shall be paid for by Contract items .
Relocation of signs to other sites shall be paid for on a force account basis
under Item No. 645.0200, Police Officer and/or Additional Traffic Devices .
Contractor shall provide additional signs at no cost to the State, should he
choose to work on more than one site at one time .

CONSTRUCTION SIGN PLAN FOR NON-WORKING HOURS
Not To Scale

CONSTRUCTION SIGN SCHEDULE	
ITEM NO. 621.0100	NO.
CG20-2	2
CW20-1c	2
CW20-1A(d)	2
Total Construction Signs	6

ORIGINAL PLAN	SURVEY PLOTTED BY	DATE
NOTED BOOK	DRAWN BY	
9/13/05	TRACED BY	
4/01	QUANTITIES BY	
	CHECKED BY	

STATE OF HAWAII
DEPARTMENT OF TRANSPORTATION
HIGHWAYS DIVISION
**CONSTRUCTION SIGN
PLAN AND SCHEDULE**
HONOLI'I/KOLEKOLE/HAKALAU/MAULUA
BRIDGE JOINT REPAIRS
Project No. HWY-H-06-05M
Scale: As Shown Date: Jan., 2005
SHEET No. 1 OF 1 SHEETS