

FED. ROAD DIST. NO.	STATE	PROJ. NO.	FISCAL YEAR	SHEET NO.	TOTAL SHEETS
HAWAII	HAW.	19J-01-02	2004	ADD.31	40

TRUE NORTH  
SCALE : 1" = 20'

Sta. 144+97 Lt. to Sta. 146+97 Lt.  
Install Six (6) New RM-3 (White) with Flex Post at 40' o.c.

Sta. 147+75 Lt. to Sta. 148+95 Lt.  
Install Four (4) New RM-3 (White) with Flex Post at 40' o.c.

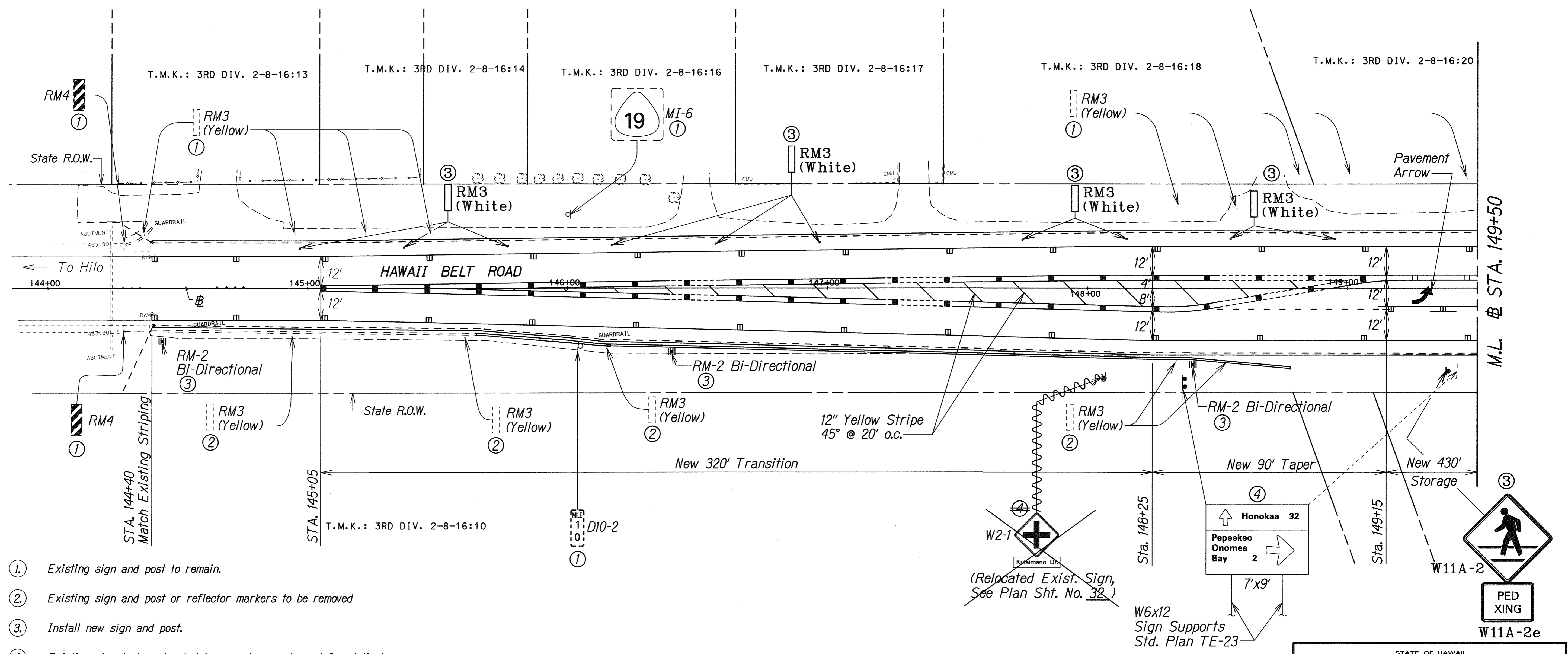

- ① Existing sign and post to remain.
- ② Existing sign and post or reflector markers to be removed
- ③ Install new sign and post.
- ④ Existing sign to be relocated (new anchor, posts and foundation)

Note:  
Remove All Existing Pavement Markers, Striping, and Markers on Hawaii Belt Road Between Sta. 144+40 and 159+00 and on Kulaimano Road Up To the State Right Of Way. This Work Shall Be Considered Incidental To The Various Contract Items. Install New Striping and Markings As Shown On The Striping and Signing Plans.

LEGEND FOR AS-BUILT POSTINGS	
	Squiggly line for as-built deletion
	Double line for as-built deletion
Roadway	Text for as-built posting

DATE	REVISION
5/10/04	Add Sign Supports to "Honokaa/Pepeekeo Onomea Bay" Sign and Revise New Location.

STATE OF HAWAII  
DEPARTMENT OF TRANSPORTATION  
HIGHWAYS DIVISION

**PAVEMENT MARKING AND SIGNING PLAN**  
Hawaii Belt Road  
Traffic Operational Improvements  
At Kulaimano Road  
Project No. 19J-01-02

Scale: 1"=20' Date: Feb. 2003

SHEET No. T2 OF 6 SHEETS

DATE	
SURVEY PLOTTED BY	
DRAWN BY	
DESIGNED BY	
CHECKED BY	
NOTE BOOK	
NO. 101/01010	
CHECKED BY	

"AS-BUILT"

ADD. 31

FED. ROAD DIST. NO.	STATE	PROJ. NO.	FISCAL YEAR	SHEET NO.	TOTAL SHEETS
HAWAII	HAW.	19J-01-02	2004	32	40

Sta. 152+15 Lt. to Sta. 153+15 Lt.  
Install Six (6) New RM-3 (White) with Flex Post at 20' o.c.

Sta. 153+30 Lt. to Sta. 153+60 Lt.  
Install Three (3) New RM-3 (White) with Flex Post along radius.

Sta. 153+90 Lt. to Sta. 154+10 Lt.  
Install Two (2) New RM-3 (White) with Flex Post along radius.

Sta. 154+40 Lt. to Sta. 154+80 Lt.  
Install Two (2) New RM-3 (White) with Flex Post at 40' o.c.

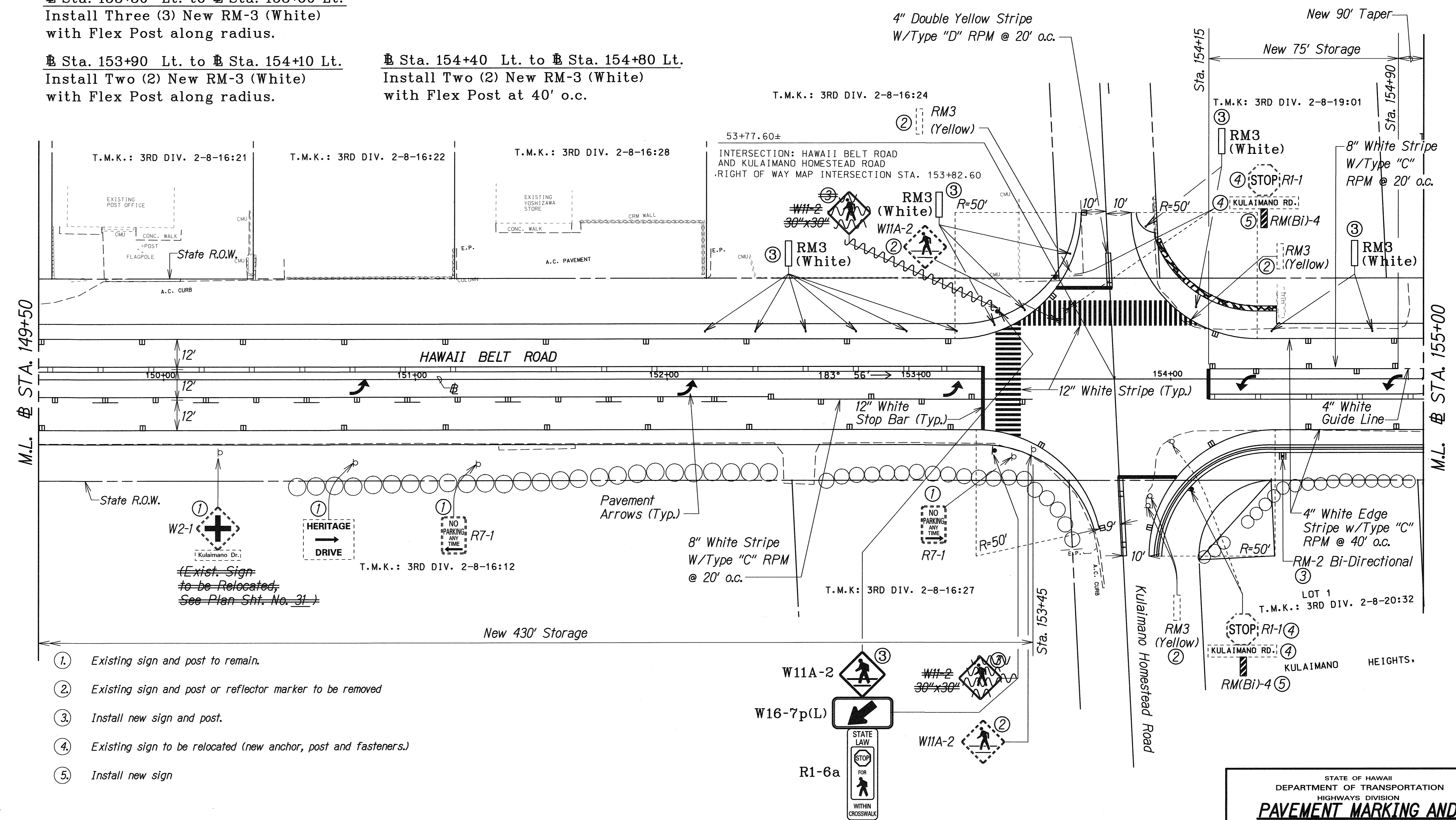
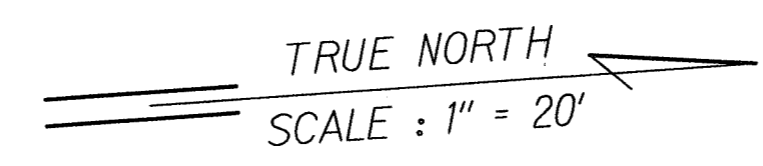

- ① Existing sign and post to remain.
- ② Existing sign and post or reflector marker to be removed
- ③ Install new sign and post.
- ④ Existing sign to be relocated (new anchor, post and fasteners.)
- ⑤ Install new sign

Note:  
Remove All Existing Pavement Markers, Striping, and Markers on Hawaii Belt Road Between Sta. 145+05 and 159+00 and on Kulaimano Road Up To the State Right Of Way. This Work Shall Be Considered Incidental To The Various Contract Items. Install New Striping and Markings As Shown On The Striping and Signing Plans.

LEGEND FOR AS-BUILT POSTINGS	
	Squiggly line for as-built deletion
	Double line for as-built deletion
Roadway	Text for as-built posting

SURVEY PLOTTED BY	DATE
DRAWN BY	
DESIGNED BY	
CHECKED BY	
NOTE BOOK	
FILE NO.	
PROJECT NO.	

STATE OF HAWAII  
DEPARTMENT OF TRANSPORTATION  
HIGHWAYS DIVISION  
**PAVEMENT MARKING AND SIGNING PLAN**  
Hawaii Belt Road  
Traffic Operational Improvements  
At Kulaimano Road  
Project No. 19J-01-02  
Scale: 1"=20' Date: Feb. 2003  
SHEET No. T3 OF 6 SHEETS

"AS-BUILT"

FED. ROAD DIST. NO.	STATE	PROJ. NO.	FISCAL YEAR	SHEET NO.	TOTAL SHEETS
HAWAII	HAW.	19J-01-02	2004	ADD.33	40

TRUE NORTH  
SCALE : 1" = 20'

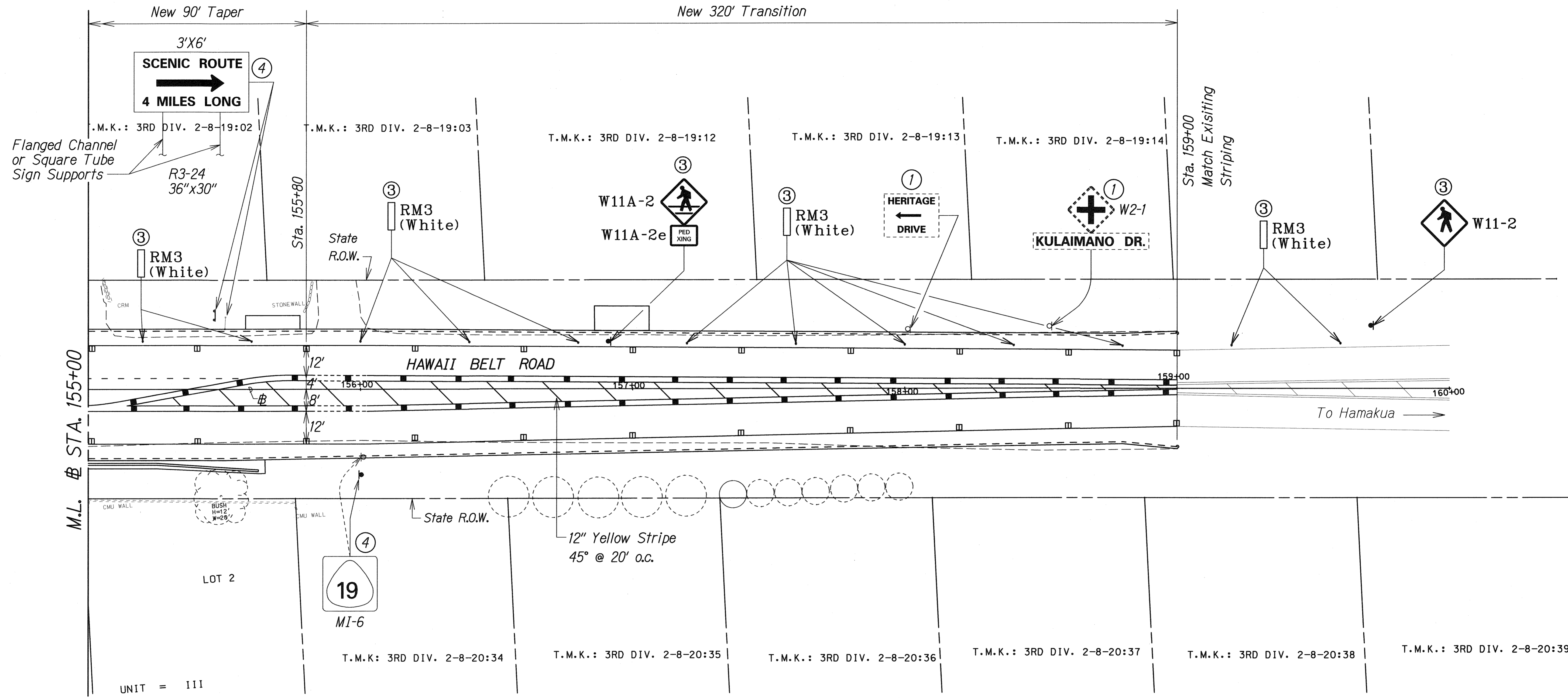

- ① Existing sign and post to remain.
- ② Existing sign and post to be removed
- ③ Install new sign and post.
- ④ Existing sign to be relocated (New Anchor, Post and Fasteners)

Sta. 155+20 Lt. to Sta. 159+60 Lt.  
Install Twelve (12) New RM-3 (White)  
with Flex Post at 40' o.c.

Note:  
Remove All Existing Pavement Markers, Striping, and Markers on Hawaii Belt Road Between Sta. 145+05 and 159+00 and on Kulaimano Road Up To the State Right Of Way. This Work Shall Be Considered Incidental To The Various Contract Items. Install New Striping and Markings As Shown On The Striping and Signing Plans.

	Squiggly line for as-built deletion
	Double line for as-built deletion
Roadway	Text for as-built posting

5/10/04	Add Sign Supports to "Scenic Route" Sign.
DATE	REVISION

STATE OF HAWAII  
DEPARTMENT OF TRANSPORTATION  
HIGHWAYS DIVISION

**PAVEMENT MARKING AND SIGNING PLAN**

Hawaii Belt Road  
Traffic Operational Improvements  
At Kulaimano Road  
Project No. 19J-01-02

Scale: 1"=20' Date: Feb. 2003

SHEET No. T4 OF 6 SHEETS

ORIGINAL PLAN	DATE
DESIGNED BY	
TRACED BY	
NOTED BY	
CHECKED BY	
QUANTITIES BY	
DATE	

"AS-BUILT"

ADD. 33