

FED. ROAD DIST. NO.	STATE	PROJ. NO.	FISCAL YEAR	SHEET NO.	TOTAL SHEETS
HAWAII	HAW.	19J-01-03M	2003	21	24

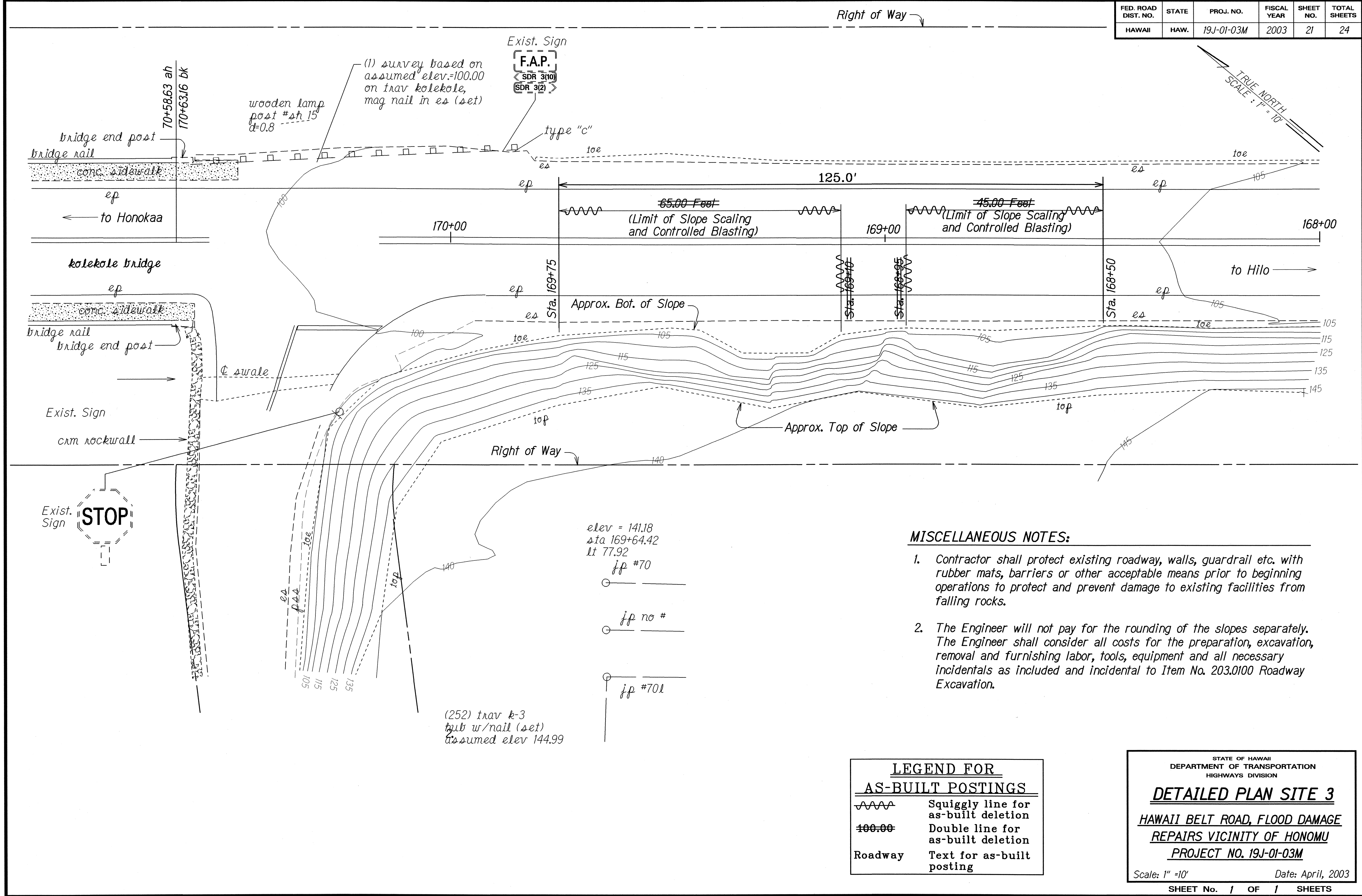

ORIGINAL PLAN	SURVEY PLOTTED BY	DATE
NOTE BOOK	DRAWN BY	
7/16/03 ab	TRACED BY	
7/16/03 ab	CHECKED BY	
7/16/03 ab		
7/16/03 ab		
7/16/03 ab		
7/16/03 ab		
7/16/03 ab		
7/16/03 ab		

LEGEND FOR AS-BUILT POSTINGS	
	Squiggly line for as-built deletion
	Double line for as-built deletion
Roadway	Text for as-built posting

STATE OF HAWAII
DEPARTMENT OF TRANSPORTATION
HIGHWAYS DIVISION

DETAILED PLAN SITE 3

HAWAII BELT ROAD, FLOOD DAMAGE REPAIRS VICINITY OF HONOLULU

PROJECT NO. 19J-01-03M

Scale: 1" = 10' Date: April, 2003

SHEET No. 1 OF 1 SHEETS

"AS-BUILT"