

FED. ROAD DIST. NO.	STATE	FED. AID PROJ. NO.	FISCAL YEAR	SHEET NO.	TOTAL SHEETS
HAWAII	HAW.	NH-019-1(33)	2003	11	74

CURVE DATA									
	Curve ①	Curve ②	Curve ③	Curve ④	Curve ⑤	Curve ⑥	Curve ⑦	Curve ⑧	Curve ⑨
Δ	24°34'30"	16°11'00"	33°35'00"	24°58'00"	35°44'00"	28°39'00"	19°07'00"	29°10'00"	7°51'50"
Δ/2	12°17'15"	8°05'30"	16°47'30"	12°29'00"	17°52'00"	14°19'30"	9°33'30"	14°35'00"	3°55'55"
R	21,000'	38,600'	9,200'	8,200'	11,100'	14,000.00'	22,700'	11,000'	16,500'
T	4,573.94'	5,487.87'	2,776.18'	1,815.39'	3,578.07'	3,575.06'	3,822.44'	2,861.87'	1,134.10'
C	8,938.32'	10,866.46'	5,315.62'	3,544.95'	6,811.03'	6,927.81'	7,538.75'	5,539.33'	2,262.86'
Lc	9,007.21'	10,902.66'	5,392.49'	3,573.15'	6,922.67'	7,000.52'	7,573.83'	5,599.60'	2,264.64'

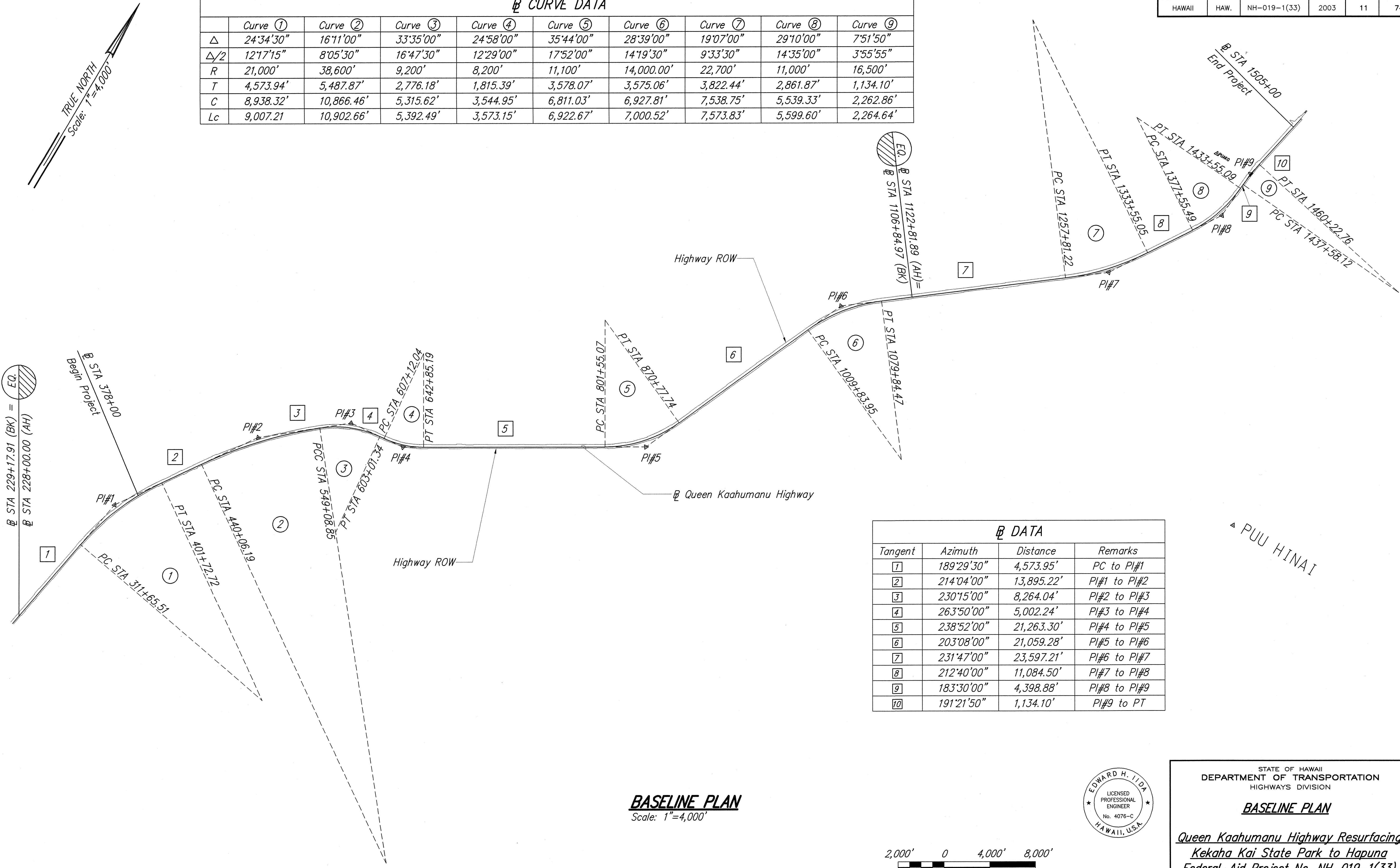

DATA			
Tangent	Azimuth	Distance	Remarks
1	189°29'30"	4,573.95'	PC to PI#1
2	214°04'00"	13,895.22'	PI#1 to PI#2
3	230°15'00"	8,264.04'	PI#2 to PI#3
4	263°50'00"	5,002.24'	PI#3 to PI#4
5	238°52'00"	21,263.30'	PI#4 to PI#5
6	203°08'00"	21,059.28'	PI#5 to PI#6
7	231°47'00"	23,597.21'	PI#6 to PI#7
8	212°40'00"	11,084.50'	PI#7 to PI#8
9	183°30'00"	4,398.88'	PI#8 to PI#9
10	191°21'50"	1,134.10'	PI#9 to PT

SURVEY PLOTTED BY	DATE
DRAWN BY	3/03
DESIGNED BY	3/03
QUANTITIES BY	3/03
CHECKED BY	3/03

BASELINE PLAN
Scale: 1"=4,000'

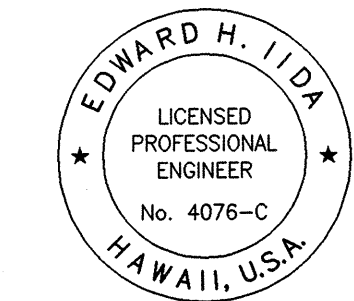
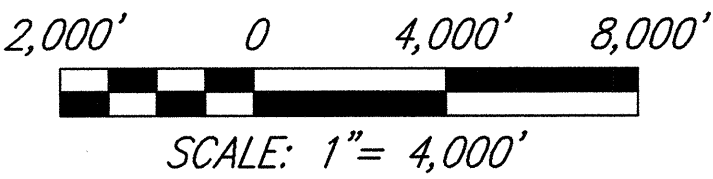

THIS WORK WAS PREPARED BY ME OR UNDER MY SUPERVISION
Edward H. Iida
MITSUNAGA & ASSOCIATES

STATE OF HAWAII
DEPARTMENT OF TRANSPORTATION
HIGHWAYS DIVISION

BASELINE PLAN
Queen Kaahumanu Highway Resurfacing
Kekaha Kai State Park to Hapuna
Federal-Aid Project No. NH-019-1(33)
Scale: As Noted Date: March 2003
SHEET No. **C-9** OF **68** SHEETS

11