

| FED. ROAD DIST. NO. | STATE | FED. AID PROJ. NO. | FISCAL YEAR | SHEET NO. | TOTAL SHEETS |
|---------------------|-------|--------------------|-------------|-----------|--------------|
| HAWAII              | HAW.  | BR-F-019-2(27)     | 1987        | 52        | 134          |

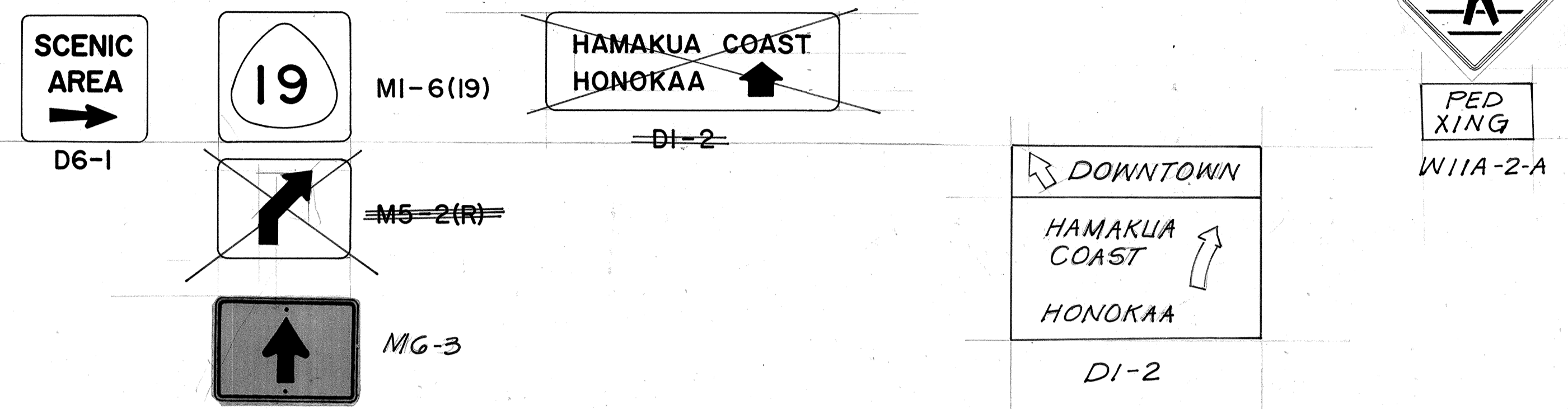

TRUE NORTH  
Scale: 1" = 40'

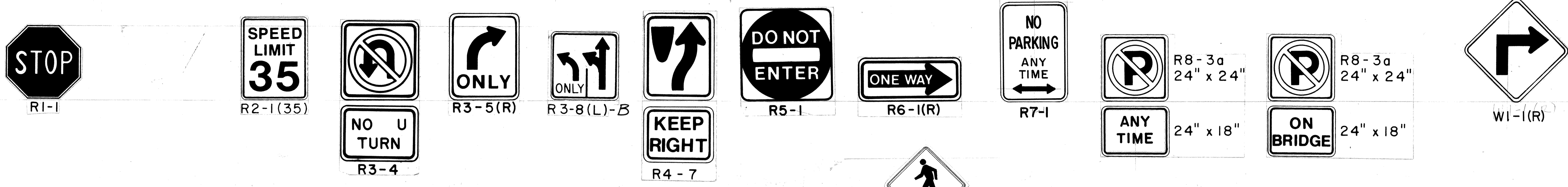
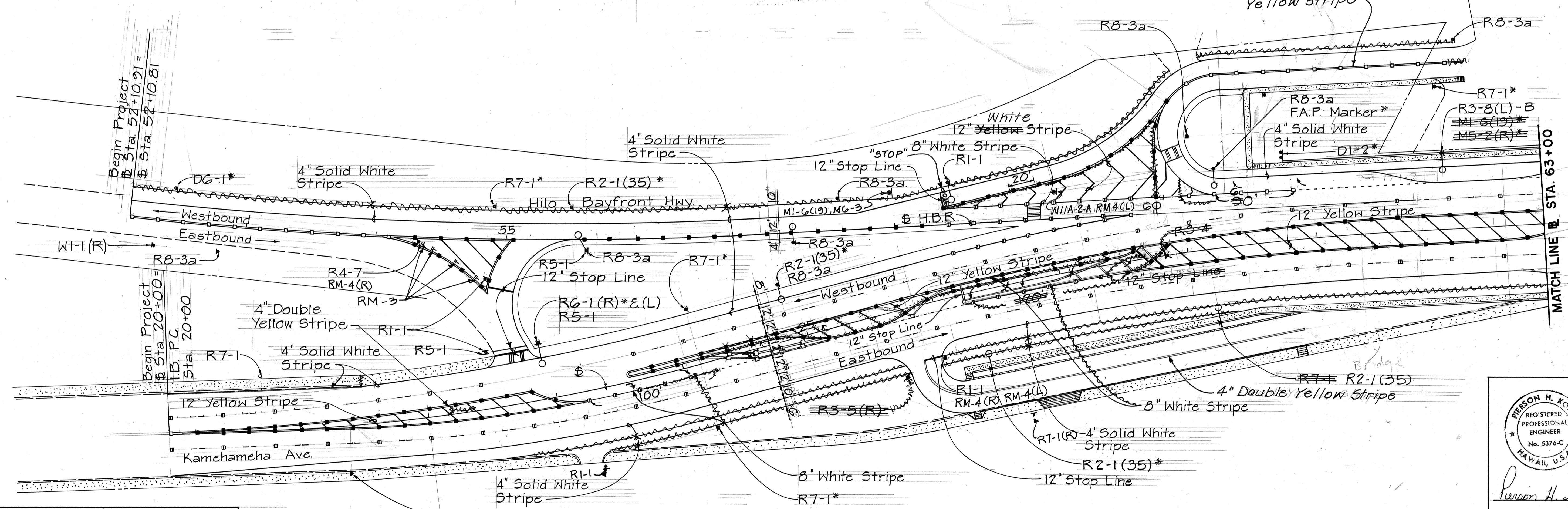

PERSON H. KOIKE  
REGISTERED PROFESSIONAL ENGINEER  
No. 5376-C  
HAWAII, U.S.A.  
THIS WORK WAS PREPARED BY ME OR UNDER MY SUPERVISION

| Type     | Each | Type     | Each |
|----------|------|----------|------|
| D1-2     | 1    | R6-1(R)  | 1    |
| D6-1     | 1    | R7-1     | 8    |
| R1-1     | 3    | R8-3a    | 7    |
| RM-1     | 3    | Any Time | 7    |
| R2-1(35) | 3    | R6-1(L)  | 1    |
| R3-4     | 1    | MI-6(19) | 1    |
| R3-5     | 1    | M5-2(R)  | 1    |
| R3-8(L)  | 1    |          |      |
| R4-7     | 1    |          |      |
| R5-1     | 2    |          |      |

Note:  
 1. For Placement & Type of Raised Pavement Markers Located at Median Nose, See Std. Plans.  
 2. All Supplementary Plates For R8-3a Shall Be "Any Time" Unless Shown Otherwise on Plans.  
 3. Pav't Striping & Markings Shall Be Paint Unless Shown Otherwise on Plans.  
 4. For Legend See Sht. T16  
 5. Signs With (\*) Denotes Relocated Signs  
 6. For Pav't. Arrows See Std. Plans.

DATE: \_\_\_\_\_  
 SURVEY PLOTTED BY: \_\_\_\_\_  
 DRAWN BY: \_\_\_\_\_  
 TRACED BY: \_\_\_\_\_  
 CHECKED BY: \_\_\_\_\_  
 ORIGINAL PLAN NO. \_\_\_\_\_  
 NOTE BOOK NO. \_\_\_\_\_

| DATE | REVISION |
|------|----------|
|      |          |

STATE OF HAWAII  
DEPARTMENT OF TRANSPORTATION  
HIGHWAYS DIVISION

**STRIPING AND SIGNING PLAN**  
**STA. 52+10.91 TO 63+00**  
 HAWAII BELT ROAD/KAMEHAMEHA AVENUE  
 Wailoa Bridge Replacement And Approaches  
 FEDERAL AID PROJECT NO. BR-F-019-2(27)  
 SCALE: AS NOTED DATE: SEPT, 1986  
 SHEET No. T14 OF 16 SHEETS

| FED. ROAD DIST. NO. | STATE | FED. AID PROJ. NO. | FISCAL YEAR | SHEET NO. | TOTAL SHEETS |
|---------------------|-------|--------------------|-------------|-----------|--------------|
| HAWAII              | HAW.  | BR-F-019-2(27)     | 1987        | 53        | 134          |

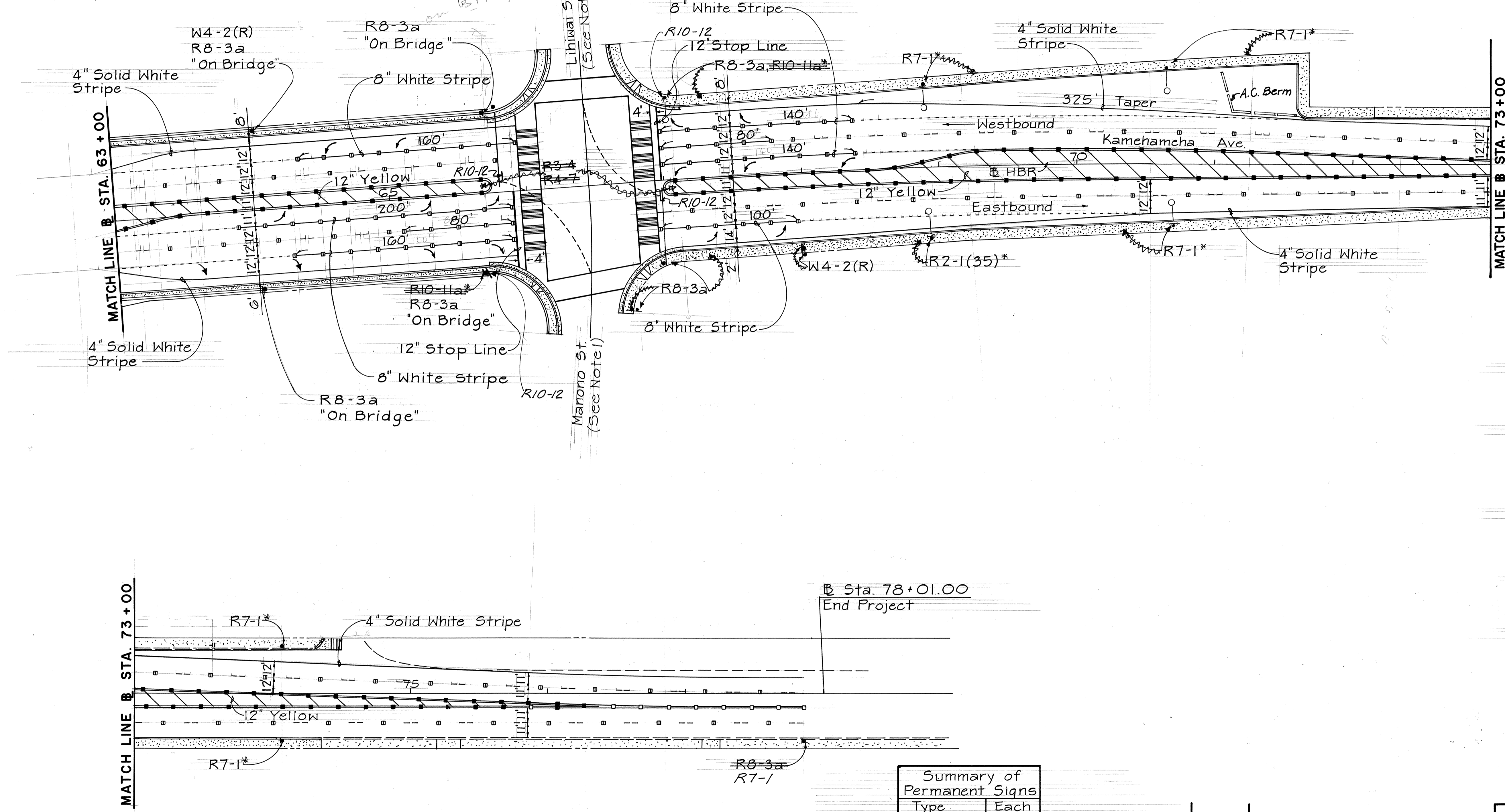
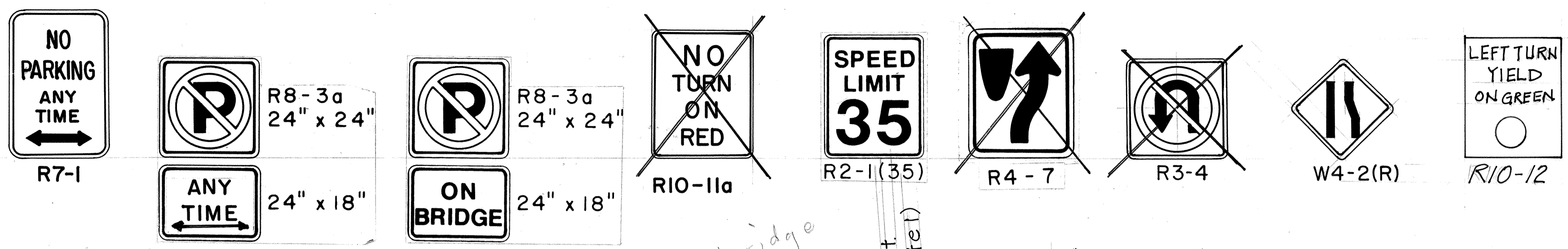

- Notes:
1. See Sht. T16 for Striping and Signing Details for Manono/Lihwai Streets.
  2. For Placement & Type of Raised Pavement Markers Located at Median Nose, See Std. Plans.
  3. All Supplemental Plates For R8-3a Shall Be "Any Time" Unless Otherwise Shown on Plans.
  4. Pav't Striping & Markings Shall Be Paint Unless Otherwise Shown on Plans.
  5. For Cross Walk Installation & Pav't Arrows See Std. Plans.
  6. For Legend See Sht. T16

TRUE NORTH  
Scale: 1" = 40'

|                   |       |
|-------------------|-------|
| DATE              | _____ |
| SURVEY PLOTTED BY | _____ |
| DRAWN BY          | _____ |
| DESIGNED BY       | _____ |
| CHECKED BY        | _____ |
| NO.               | _____ |

| Type            | Each |
|-----------------|------|
| R2-1(35)        | 1    |
| R7-1            | 5    |
| R8-3a           | 5    |
| Any Time        | 5    |
| R8-3a On Bridge | 4    |
| R10-11a         | 1    |
| R3-4            | 2    |
| R4-7            | 2    |
| W4-2(R)         | 2    |

THIS WORK WAS PREPARED BY ME OR UNDER MY SUPERVISION

STATE OF HAWAII  
 DEPARTMENT OF TRANSPORTATION  
 HIGHWAYS DIVISION  
**STRIPING AND SIGNING PLAN**  
**STA. 63+00 TO 77+85.84**  
 HAWAII BELT ROAD/KAMEHAMEHA AVENUE  
 Wailoa Bridge Replacement And Approaches  
 FEDERAL AID PROJECT NO. BR-F-019-2(27)  
 SCALE: AS NOTED DATE: SEPT. 1986  
 SHEET No. T15 OF 16 SHEETS

| DATE | REVISION |
|------|----------|
|      |          |

| FED. ROAD DIST. NO. | STATE | FED. AID PROJ. NO. | FISCAL YEAR | SHEET NO. | TOTAL SHEETS |
|---------------------|-------|--------------------|-------------|-----------|--------------|
| HAWAII              | HAW.  | BR-F-019-2(27)     | 1987        | 54        | 134          |

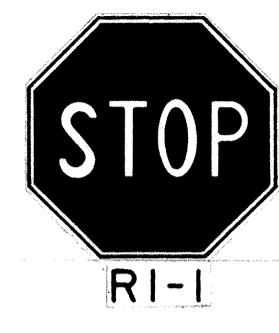

R8-3a  
24" x 24"  
  
ANY TIME  
24" x 18"

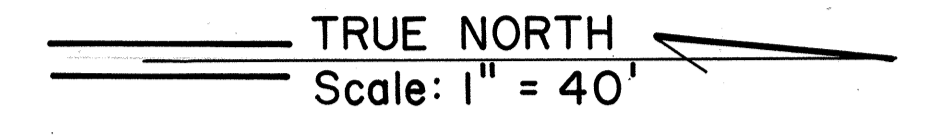

- Note:
1. For Placement & Type of Raised Pavement Markers Located at Median Nose, See Std. Plans
  2. All Supplementary Plates For R8-3a Shall Be "Any Time" Unless Otherwise Shown On Plans.
  3. Pav't. Striping & Markings Shall Be Paint Unless Otherwise Shown on Plans.
  4. For Pav't. Arrows See Std. Plans.

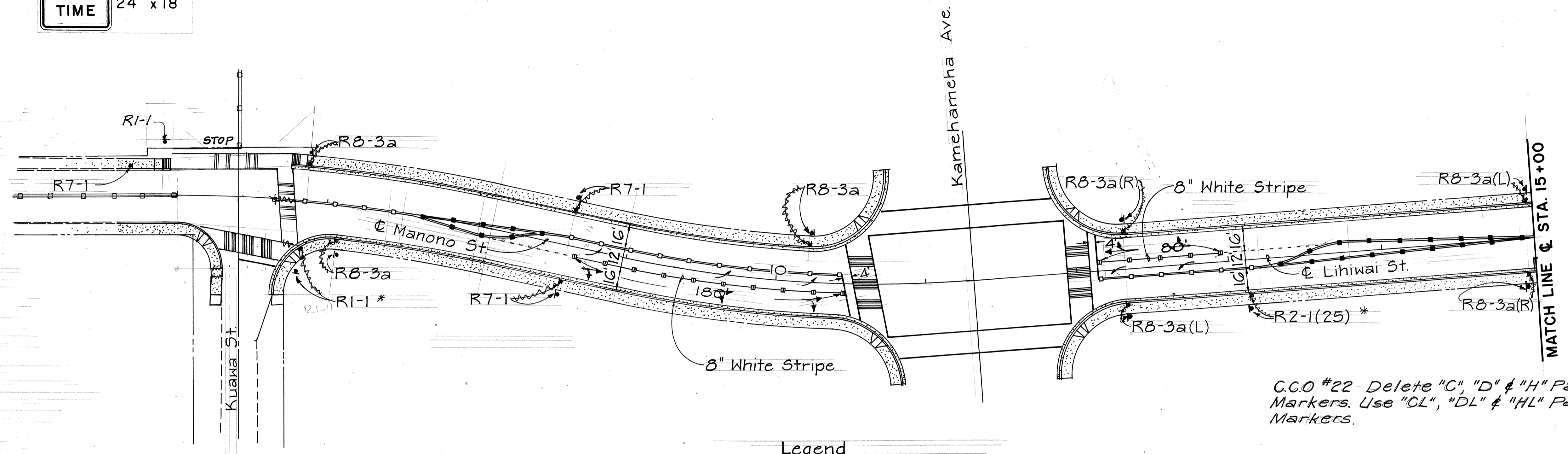

C.C.O #22 - Delete "C", "D" & "H" Pavement Markers. Use "CL", "DL" & "HL" Pavement Markers.

Legend

- 4" or 8" White Stripe With Type "CL" Marks @ 20' O.C.
- 4 Type "A" Markers And Type "CL" Marks @ 40' O.C.
- 4" Double Yellow Stripe With Type "DL" Markers at 20' O.C.
- 4" Yellow Stripe (Single or Double) With Type "HL" Markers @ 20' O.C.
- 12" Stop Line
- 4" White Guide Line
- New or Relocated Sign
- Exist. Signs
- Standard Pavement Arrows
- Crosswalk And Stop Line; Stop Line 4' From Crosswalk
- Reflector Marker, Type RM-2
- Light Standard w/ Mounted Sign

| Summary of Permanent Signs |      |
|----------------------------|------|
| Type                       | Each |
| R1-1                       | 4    |
| R2-1(25)                   | 1    |
| R7-1                       | 3    |
| R8-3a                      |      |
| Any Time                   | 7    |
| D1                         | 1    |

|                   |      |
|-------------------|------|
| ORIGINAL PLAN     | DATE |
| SURVEY PLOTTED BY |      |
| DRAWN BY          |      |
| TRACED BY         |      |
| DESIGNED BY       |      |
| QUANTITIES BY     |      |
| CHECKED BY        |      |
| NO.               |      |

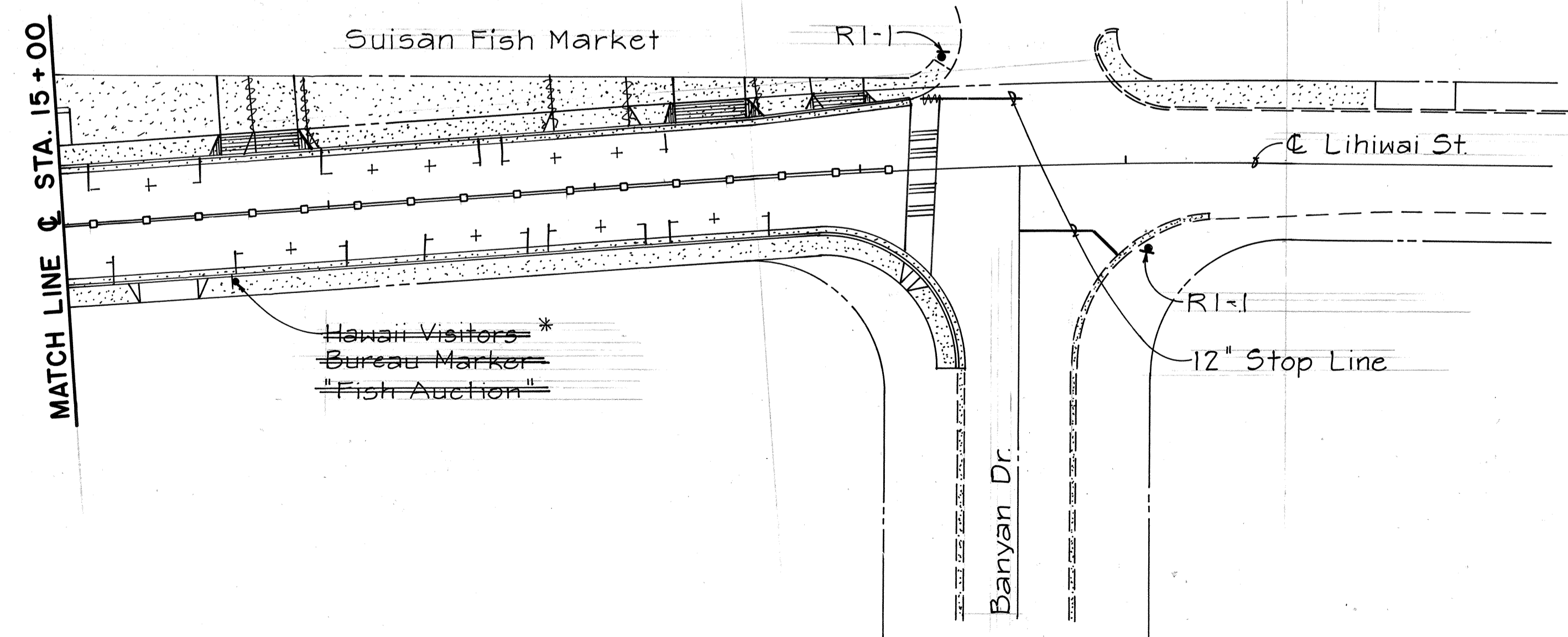

PERSON H. KOIKE  
 REGISTERED PROFESSIONAL ENGINEER  
 No. 5376-C  
 HAWAII, U.S.A.  
 THIS WORK WAS PREPARED BY ME OR UNDER MY SUPERVISION

STATE OF HAWAII  
 DEPARTMENT OF TRANSPORTATION  
 HIGHWAYS DIVISION  
**STRIPING AND SIGNING PLAN**  
**MANONO/LIHWAI STREET**  
 HAWAII BELT ROAD/KAMEHAMEHA AVENUE  
 Waioloa Bridge Replacement And Approaches  
 FEDERAL AID PROJECT NO. BR-F-019-2(27)  
 SCALE: AS NOTED DATE: SEPT. 1986  
 SHEET NO. 16 OF 16 SHEETS

| DATE | REVISION |
|------|----------|
|------|----------|