

STANDARD PLANS SUMMARY

FED. ROAD DIST. NO.	STATE	FED. AID PROJ. NO.	FISCAL YEAR	SHEET NO.	TOTAL SHEETS
HAWAII	HAW.	BR-019-2(46)	2000	2	26

STANDARD PLAN NO.	TITLE	DATE
B-01	NOTES AND MISCELLANEOUS DETAILS	07/01/86
B-02		
B-03	TYPICAL STRUCTURE EXCAVATION AND BACKFILL PAY LIMITS	07/01/86
B-04		
B-05		
B-06	CONCRETE BOX GIRDER	07/01/86
B-07	CONCRETE BOX GIRDER	07/01/86
B-08	CONCRETE BOX GIRDER	07/01/86
B-09		
B-10		
B-11		
B-12	PRESTRESSED CONCRETE PILES	r07/16/90
B-13	PRESTRESSED CONCRETE PILES	r07/16/90

D-01	CHAIN LINK FENCE WITH TOPRAIL	r03/06/87
D-02	CHAIN LINK FENCE WITHOUT TOPRAIL	r07/26/90
D-03	WIRE FENCE WITH METAL POSTS	07/01/86
D-04	TYPICAL DETAILS OF CURBS AND/OR GUTTERS	07/01/86
D-05	TYPICAL DETAILS OF REINFORCED CONCRETE DROP DRIVEWAY	07/01/86
D-06	CENTERLINE AND REFERENCE SURVEY MONUMENT	07/01/86
D-07	STREET SURVEY MONUMENT	07/01/86
D-08	LANDSCAPING SHRUB AND TREE PLANTING	07/01/86
D-09 ●	FIELD OFFICE	07/01/86
D-10 ●	FIELD OFFICE	07/01/86
D-11	PROJECT SITE LABORATORY	07/01/86
D-12	PROJECT SITE LABORATORY	07/01/86
D-13	FIELD OFFICE AND PROJECT SITE LABORATORY	07/01/86

H-01	TYPE A, B, C, AND D CATCH BASIN	07/01/86
H-02	TYPE A1, B1, C1 AND D1 CATCH BASIN	07/01/86
H-03	TYPE A2, B2, C2 AND D2 CATCH BASIN	07/01/86
H-04	TYPICAL REINFORCING DETAILS FOR CATCH BASINS	07/01/86
H-05	TYPE A, B AND C STORM DRAIN MANHOLE	07/01/86
H-06	TYPE D AND E STORM DRAIN MANHOLE	07/01/86
H-07	TYPE F STORM DRAIN MANHOLE	07/01/86
H-08	CATCH BASIN AND MANHOLE CASTING	07/01/86
H-09	TYPE A-9 AND A-9P FRAMES AND GRATES	07/01/86
H-10	TYPE A-9B FRAMES AND GRATES	07/01/86
H-11	TYPE 61614 AND 61214 GRATED DROP INLET	07/01/86
H-12	TYPE 61616 GRATED DROP INLET	07/01/86
H-13	61214, 61614 & 61616 STEEL FRAMES AND GRATES	07/01/86
H-14	61214B STEEL FRAMES AND GRATES	07/01/86
H-15	61614B STEEL FRAMES AND GRATES	07/01/86
H-16	CONCRETE AND CEMENT RUBBLE MASONRY STRUCTURES	r10/16/90
H-17	INLET STRUCTURES	r10/16/90
H-18	FLARED END SECTION FOR CULVERTS	07/01/86
H-19	OUTLET STRUCTURES	r02/15/91
H-20	CONCRETE SPILLWAY INLET	07/01/86
H-21	18" SLOTTED C.M.P. DRAIN	07/01/86
H-22	C.M.P. COUPLING DETAILS STANDARD JOINT	r10/16/90
H-23	HAT SHAPED COUPLING BAND	r10/16/90

STANDARD PLAN NO.	TITLE	DATE
TE-01 ●	MISCELLANEOUS SIGN DETAILS	07/01/86
TE-02 ●	GALVANIZED FLANGED CHANNEL SIGN POST MOUNTING	07/01/86
TE-03 ●	GALVANIZED SQUARE TUBE SIGN POST MOUNTING	07/01/86
TE-04	REGULATORY SIGNS	r09/01/87
TE-05	WARNING SIGNS	07/01/86
TE-06	MISCELLANEOUS SIGNS	r11/03/89
TE-07	RESERVED	07/01/86
TE-08 ●	CONSTRUCTION SIGNS	r09/01/87
TE-09	MISCELLANEOUS INTERSECTION SIGNS	r03/06/87
TE-10	RESERVED	07/01/86
TE-11	BIKE ROUTE SIGN AND SUPPLEMENTARY PLATES	07/01/86
TE-12	STATE ROUTE MARKER AND AUXILIARY MARKERS	07/01/86
TE-13	INTERSTATE ROUTE MARKER	07/01/86
TE-14	STATE ROUTE MARKER AND BORDER DETAIL FOR GUIDE SIGNS	07/01/86
TE-15	ROUTE MARKER ASSEMBLIES	07/01/86
TE-16	MISCELLANEOUS REFLECTOR MARKERS	07/01/86
TE-17	TYPE II OBJECT MARKERS	07/01/86
TE-18	MILEPOSTS	07/01/86
TE-19	RESERVED	07/01/86
TE-20	OVERHEAD SIGN SUPPORTS	07/01/86
TE-21	OVERHEAD SIGN SUPPORT, BOX TRUSS TYPE, ALUMINUM	07/01/86
TE-22	FOUNDATION DETAILS AND SCHEDULES	07/01/86
TE-23	SUPPORTS FOR GROUND MOUNTED GUIDE SIGN	r11/03/89
TE-24	BREAKAWAY SIGN SUPPORTS FOR GROUND MOUNTED SIGNS	07/01/86
TE-25	LAMINATED ALUMINUM SIGN PANELS (OVERHEAD)	07/01/86
TE-26	LAMINATED ALUMINUM SIGN PANELS (GROUND MOUNTED)	07/01/86
TE-27	SOLID ALUMINUM EXTRUDED SIGN PANEL AND ACCESSORY DETAILS	07/01/86
TE-28	GUIDE SIGNS LUMINAIRE MOUNTINGS	07/01/86
TE-29	RESERVED	07/01/86
TE-30	RAISED PAVEMENT MARKERS AND STRIPING	r05/09/90
TE-31	MISCELLANEOUS PAVEMENT MARKINGS	r05/09/90
TE-32	MISCELLANEOUS PAVEMENT MARKINGS	r05/09/90
TE-33	MISCELLANEOUS PAVEMENT MARKINGS	r11/03/89
TE-34	RESERVED	07/01/86
TE-35	PAVEMENT ALPHABETS, NUMBERS & SYMBOLS	07/01/86
TE-36	PAVEMENT ALPHABETS, NUMBERS & SYMBOLS	07/01/86
TE-37	RESERVED	07/01/86
TE-38	TRAFFIC SIGNAL SYSTEM, MISCELLANEOUS DETAILS	r11/03/89
TE-39	TRAFFIC SIGNAL SYSTEM, MISCELLANEOUS DETAILS	07/01/86
TE-40	LOOP DETECTORS	r11/03/89
TE-41	PULLBOXES	07/01/86
TE-42	TYPE III TRAFFIC SIGNAL STANDARD	07/01/86
TE-43	CONCRETE PULLBOX (2'x3')	07/01/86
TE-44	RESERVED	07/01/86

STANDARD PLAN NO.	TITLE	DATE
TE-45	RESERVED	07/01/86
TE-46	RESERVED	07/01/86
TE-47	RESERVED	07/01/86
TE-48	RESERVED	07/01/86
TE-49	RESERVED	07/01/86
TE-50	METAL GUARD RAIL	r03/06/87
TE-51	METAL GUARD RAIL	r09/01/87
TE-52	METAL GUARD RAIL WITH RUBRAIL	r11/03/89
TE-53	METAL GUARD RAIL WITH RUBRAIL AT OBSTRUCTION	r09/01/87
TE-54	BEAM TYPE GUARDRAIL WITH RUBRAIL AT OBSTRUCTION (SHOULDER INSTSALLATION)	r11/03/89
TE-55	METAL GUARDRAIL CONNECTION TO CONCRETE BARRIER	r11/03/89
TE-56	CONCRETE BARRIER TRANSITION	07/01/86
TE-57	GUARDRAIL TYPE 3, THRIE BEAM	r11/03/89
TE-57A	GUARDRAIL TYPE 3, MODIFIED THRIE BEAM	11/03/89
TE-58	APPROACH END FLARE, ONE & TWO WAY ROADWAY	07/01/86
TE-59	TRAILING END FLARE, ONE & TWO WAY ROADWAY	r11/03/89
TE-60	ANCHOR BLOCK DETAILS	07/01/86
TE-61	BREAKAWAY CABLE TERMINAL (BCT)	r11/03/89
TE-62	BREAKAWAY CABLE TERMINAL (BCT)	r09/01/87
TE-63	GUARDRAIL TYPE 4 (RIGID BARRIER)	r09/01/87
TE-64	PORTABLE CONCRETE BARRIER	r11/03/89
TE-65	GUARDRAIL TYPE 4, MISCELLANEOUS	r09/01/87
TE-66	BARRICADES	07/01/86
TE-67	DELINEATION & PAVEMENT MARKINGS AT BRIDGES	07/01/86
TE-68	WHEELCHAIR RAMPS	r07/18/94
TE-69	WHEELCHAIR RAMPS	r07/18/94

ORIGINAL PLAN	SURVEY PLOTTED BY	DATE
NOTED BY	DRAWN BY	
NOTED BY	DESIGNED BY	
NOTED BY	CHECKED BY	
No.		

ST-1.DWG 08/04/99 14:53 FINAL L:\DWG\6041-01\NEWSRUCT

DATE	REVISION
STATE OF HAWAII DEPARTMENT OF TRANSPORTATION HIGHWAYS DIVISION	
STANDARD PLANS SUMMARY	
SEISMIC RETROFIT OF VARIOUS BRIDGES EAST OF NINOLE, HAWAII F.A. PROJECT NO. BR-019-2(46)	
Scale: As Noted Date: AUG. 17, 1999	
SHEET No. T-2 OF 3 SHEETS	

FED. ROAD DIST. NO.	STATE	FED. AID PROJ. NO.	FISCAL YEAR	SHEET NO.	TOTAL SHEETS
HAWAII	HAW.	BR-019-2(46)	2000	3	26

GENERAL NOTES

1. The scope of work for this project consists of retrofitting superstructures and substructure of Nanue Bridge, Opea Bridge, Umauma Bridge, and Waikamalo Bridge.
2. The Contractor is reminded of the requirements of Subsection 108.01 – Subletting of Contract, which requires him to perform work amounting to no less than 50 percent of the total contract cost, less deductible items. Non-compliance with this subsection may be grounds for rejection of bid.
3. The Contractor’s attention is directed to the following sections of the special provisions: Subsection 107.13 – Public Convenience and Safety; Subsection 107.21 – Contractor’s Responsibility for Utility Property and Services; and Section 645 – Traffic Control.
4. At the end of each day’s work, the Contractor shall remove all equipment and other obstructions to permit free and safe passage of public traffic.
5. The existence and location of underground utilities, manholes, monuments and structures as shown on the plans are from the latest available data, but the accuracy is not guaranteed. The encountering of other obstacles during the course of work is possible. The Contractor shall be held liable for any damages incurred to the existing facilities and/or improvements as a result of his operations.
6. The Contractor shall notify the Engineer in writing, two (2) weeks prior to the start of retrofitting operations.
7. The Contractor shall erect construction warning signs approximately 500 feet before the beginning of project and 500 feet after the end of project, or, as directed by the Engineer.

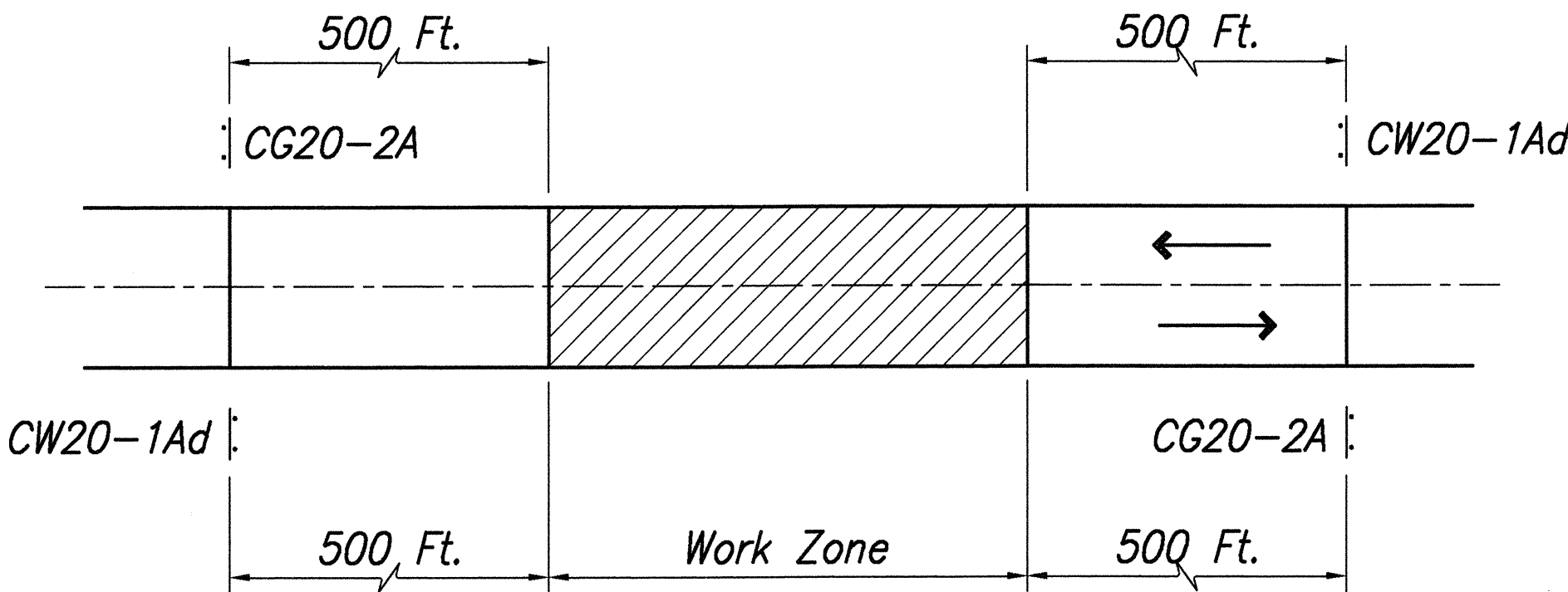

Note:
Bid item under section
621-Traffic Control Signs.
4 each bridge x4 bridges
=16 signs total

WORK ZONE PLAN – CONSTRUCTION SIGNS

Not to Scale

ORIGINAL PLAN	SURVEY PLOTTED BY	DATE
DRAWN BY		
DESIGNED BY		
CHECKED BY		
No.		

08/09/99 2:56 L:\DWG\6041-01\NEWSRUCT ST-2.DWG

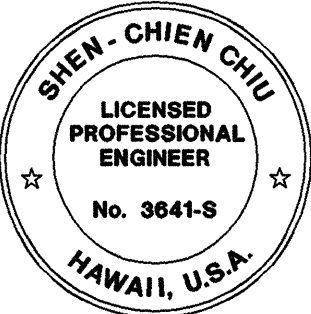

THIS WORK WAS PREPARED BY
ME OR UNDER MY SUPERVISION

Shien-Chien Chiu

DATE	REVISION
	STATE OF HAWAII DEPARTMENT OF TRANSPORTATION HIGHWAYS DIVISION
	GENERAL NOTES
	SEISMIC RETROFIT OF VARIOUS BRIDGES EAST OF NINOLE, HAWAII F.A. PROJECT NO. BR-019-2(46)
Scale: As Noted	Date: AUG. 17, 1999

SHEET No. T-3 OF 3 SHEETS