

FED. ROAD DIST. NO.	STATE	FED. AID PROJ. NO.	FISCAL YEAR	SHEET NO.	TOTAL SHEETS
HAWAII	HAW.	NH-019-2(51)	2001	4	6

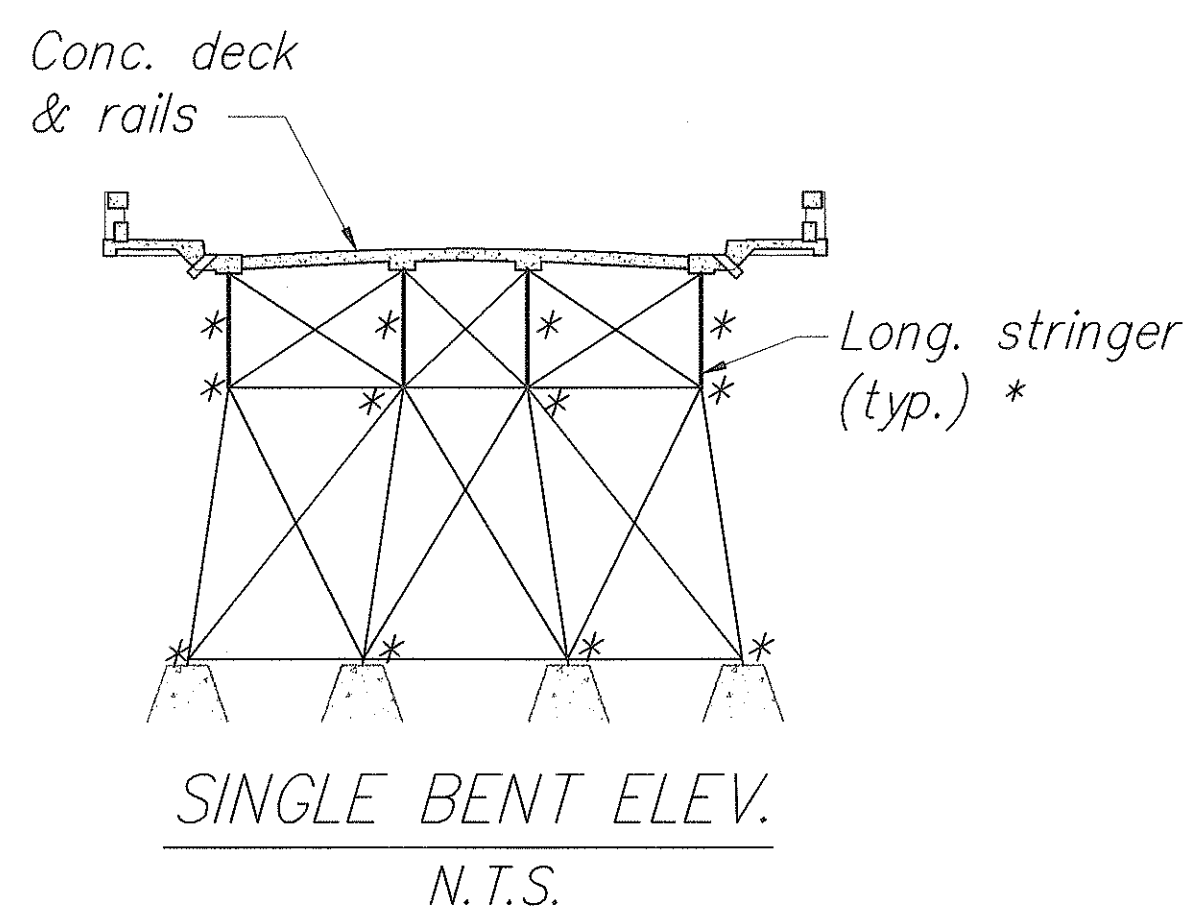
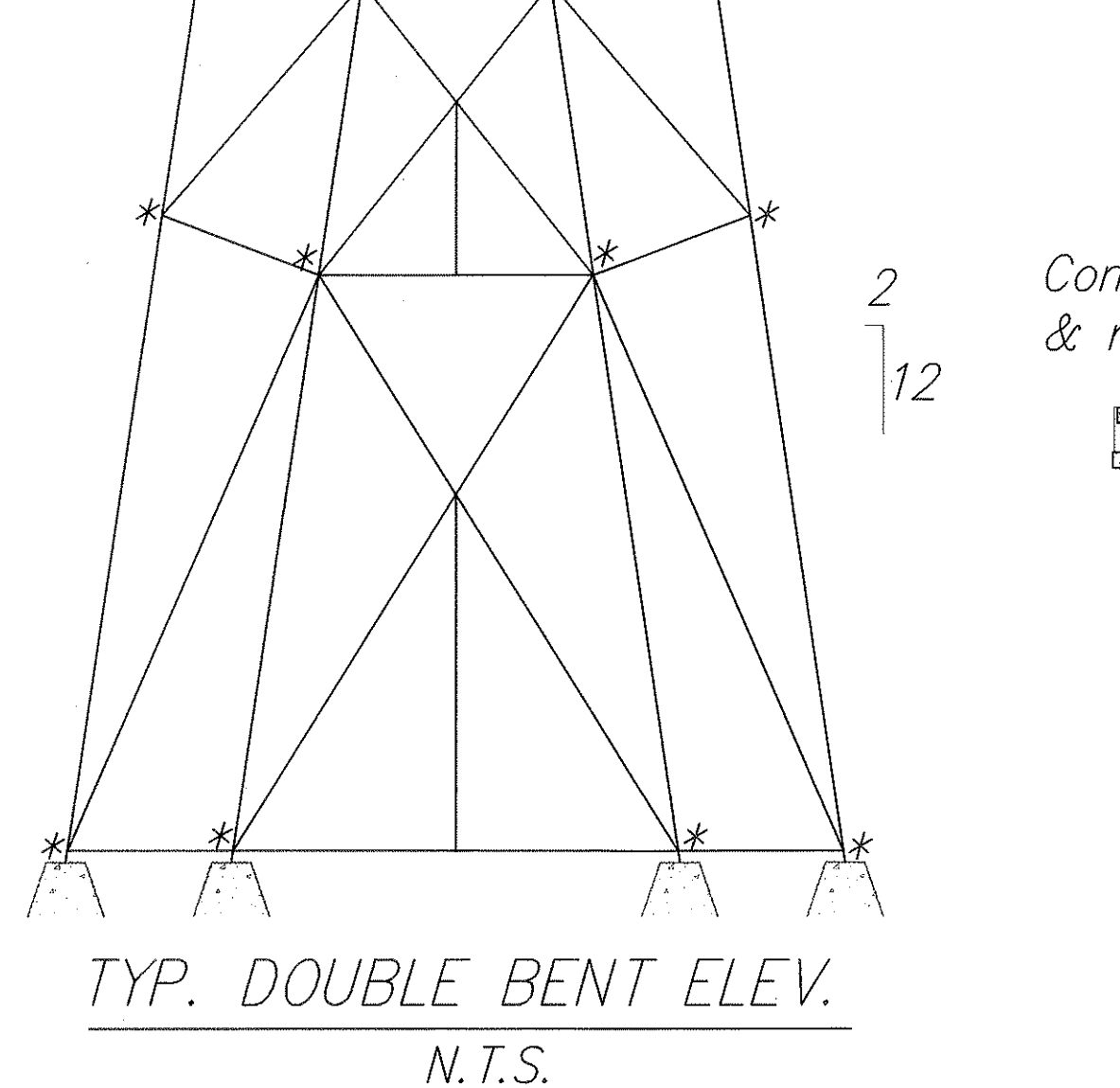
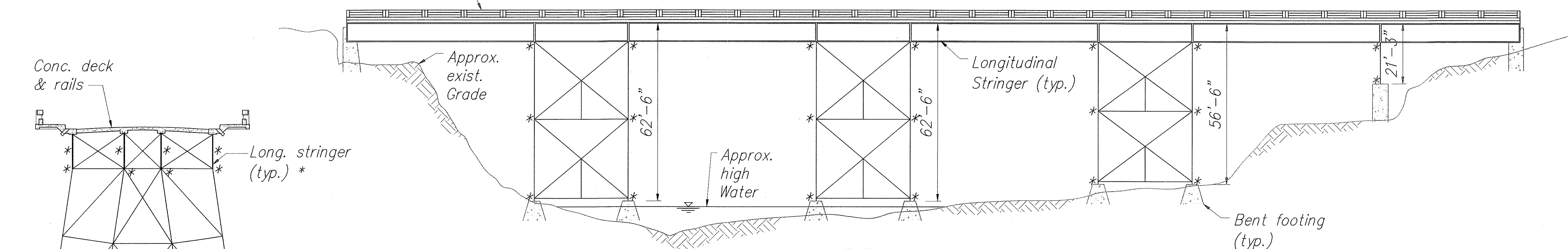
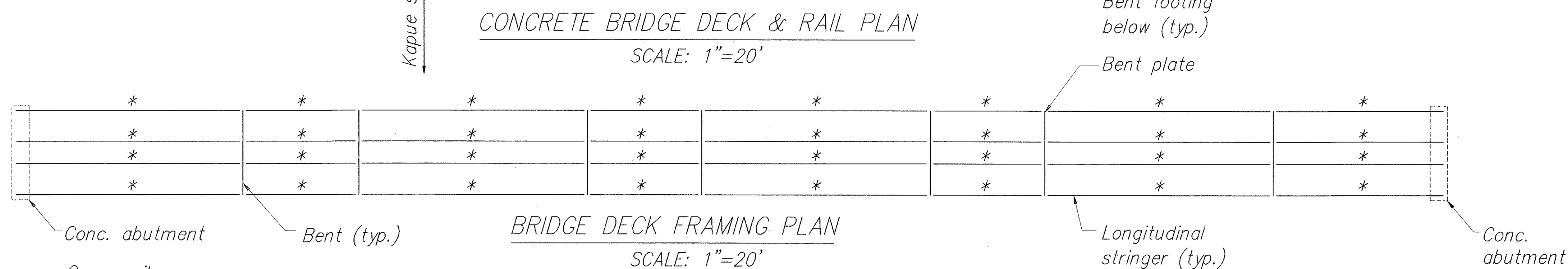
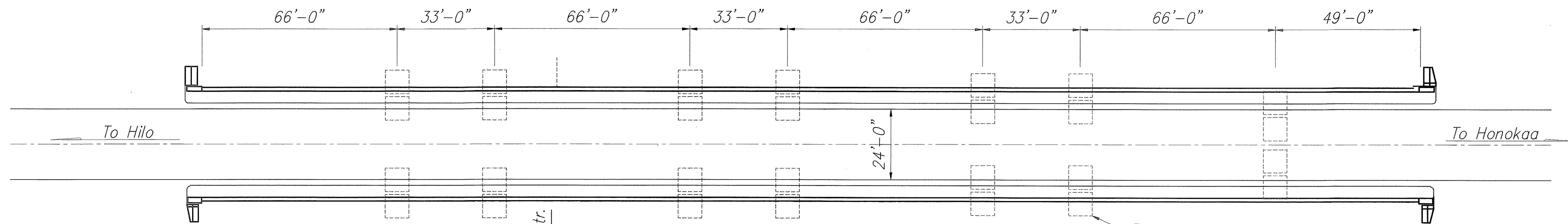

- NOTES:**
1. Bridge steel members are built-up & are represented by lines in this drawing. Details are omitted for clarity. This drawing is for illustration only.
 2. Only major structural members are shown. Bracing, diaphragms, etc. are not shown.
 3. Contractor loads are permitted only on stringers & bent joints indicated with an asterisk (*). Refer to General Notes for other load restrictions.
 4. Remove and trim vegetation under the bridge as necessary to complete the removal of lead based paint and re-coating of steel members. Vegetation removal must be done to the approval of the Engineer. Cost shall be incidental to other contract items.

THIS WORK WAS PREPARED BY ME
OR UNDER MY SUPERVISION.

STATE OF HAWAII
DEPARTMENT OF TRANSPORTATION
HIGHWAYS DIVISION

KAPUE BRIDGE
PLANS AND ELEVATIONS
HAWAII BELT ROAD
CLEAN AND PAINT STEEL MEMBERS
KAPUE AND KOLEKOLE BRIDGES
F. A. Project No. NH-019-2(51)
Scale: As Noted Date: Sept. 2000