

FED. ROAD DIST. NO.	STATE	PROJ. NO.	FISCAL YEAR	SHEET NO.	TOTAL SHEETS
HAWAII	HAW.	19A-01-97M	1997	28	29

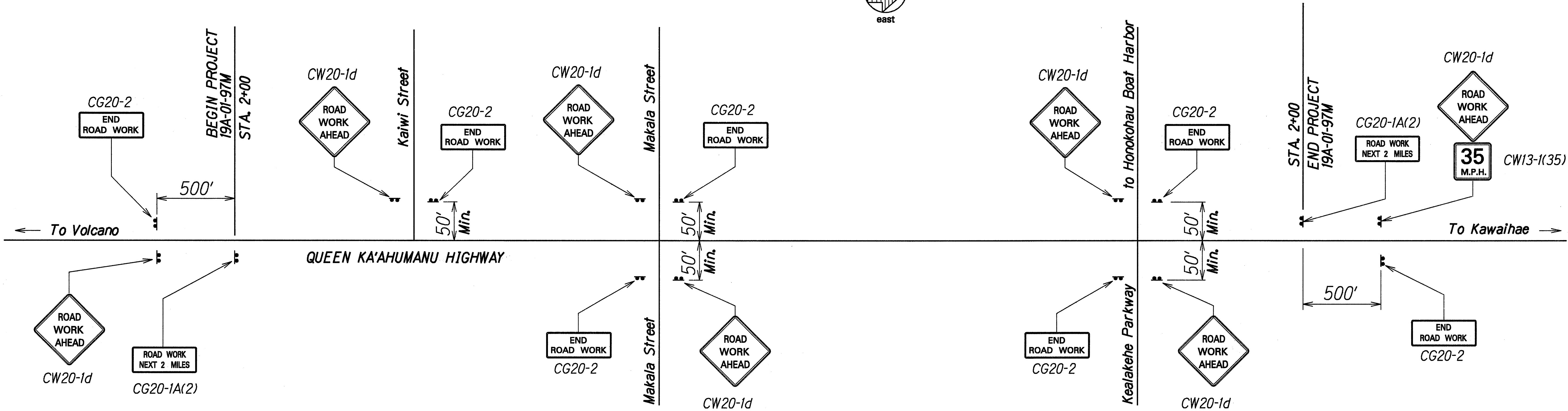

CONSTRUCTION SIGN PLAN  
Not To Scale

CONSTRUCTION SIGN SCHEDULE				
ROAD AND LOCATION *	ROUTE 19 CENTERLINE STATION **	LEFT	RIGHT	ITEM No. 621.7121 ( no posts )
Queen Ka'ahumanu Highway	96+00		●	CW20-1d
	96+00	●		CG20-2
	2+00		●	CG20-1(2)
	Kaiwi Street	●		CG20-2
	Kaiwi Street	●		CW20-1d
	Makala Street	●	●	(2) CG20-2
	Makala Street	●	●	(2) CW20-1d
	Makala Street		●	CG20-2
	Makala Street	●		CW20-1d
	Kealahou Parkway	●		CW20-1d
	Kealahou Parkway		●	CG20-2
	0+00.11	●		CG20-1(2)
Total Construction Signs				16

\* - Final locations of all signs to be determined in the field by the Engineer.  
\*\* - Signs erected on side roads must be located 50' (Min.), from E. P. of Queen Ka'ahumanu Highway.

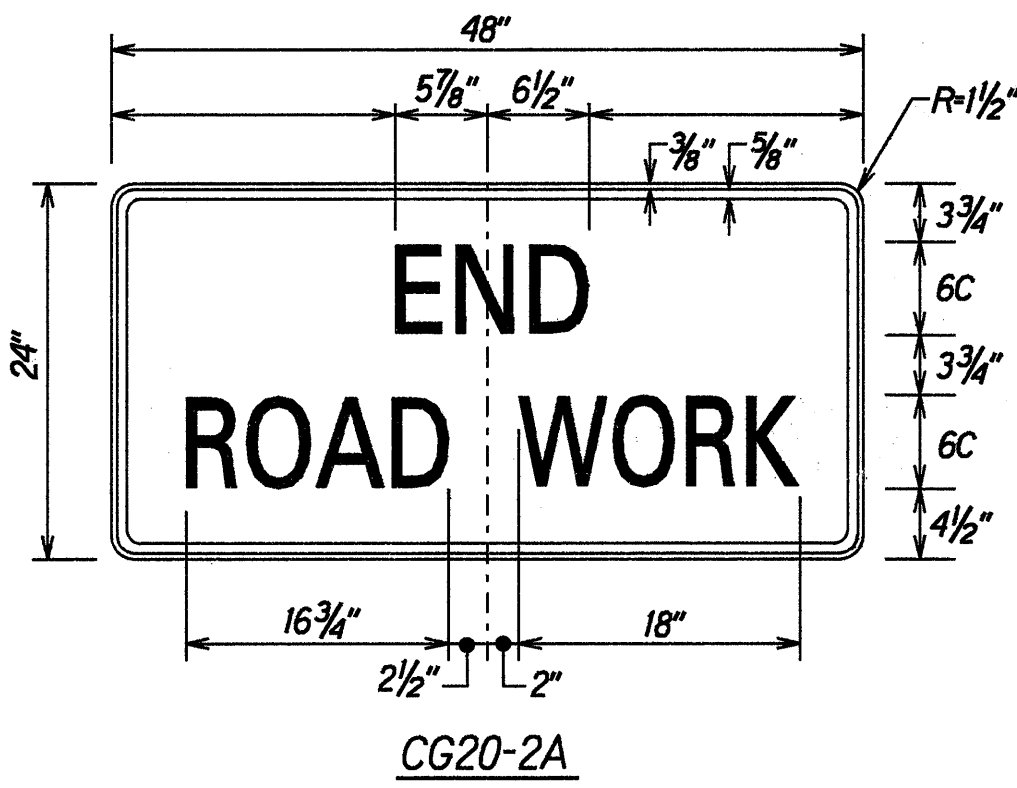
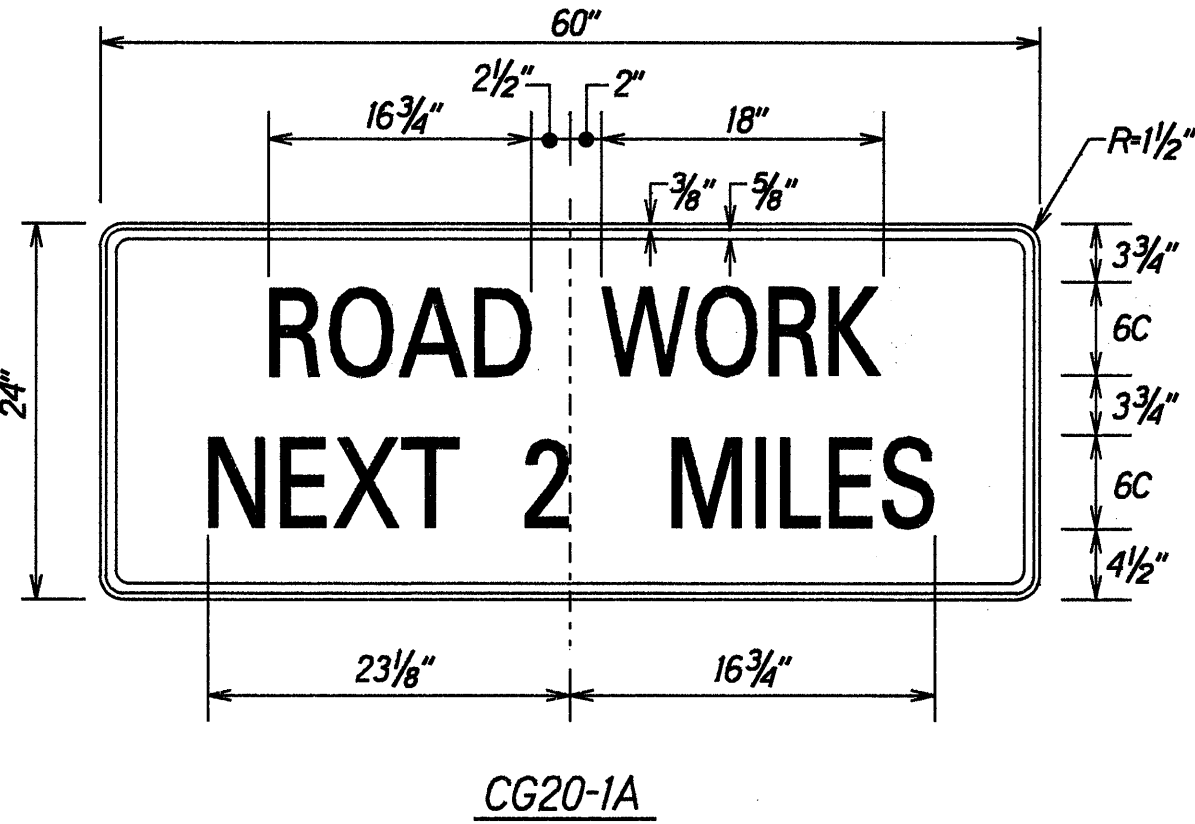

SIGN DETAILS  
Not To Scale

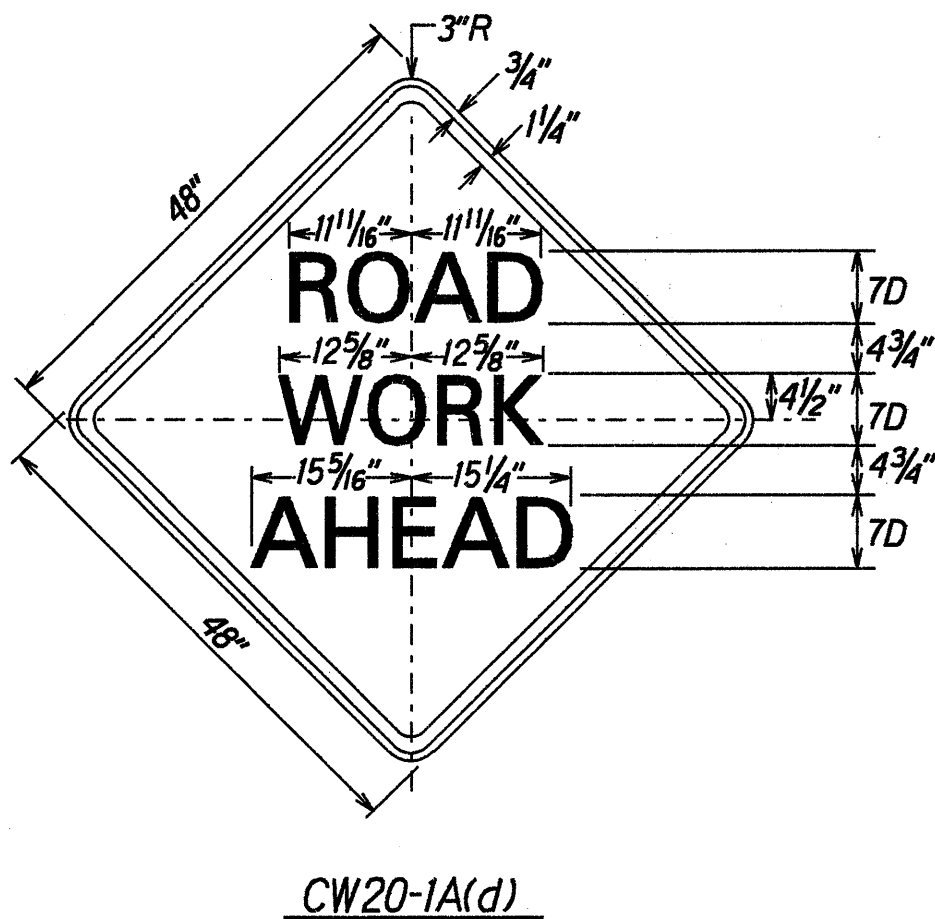

STATE OF HAWAII  
DEPARTMENT OF TRANSPORTATION  
HIGHWAYS DIVISION

**CONSTRUCTION SIGN  
PLAN & SCHEDULE**

QUEEN KA'AHUMANU HIGHWAY RESURFACING  
PALANI ROAD TO HONOKOHOU HARBOR  
PROJECT NO. 19A-01-97M

Scale: None Date: May, 1997

SHEET NO. 1 OF 1 SHEETS