

FED. ROAD DIST.	STATE	PROJ. NO.	FISCAL YEAR	SHEET NO.	TOTAL SHEETS
HAWAII	HAW.	19J-02-97M	1997	20	22

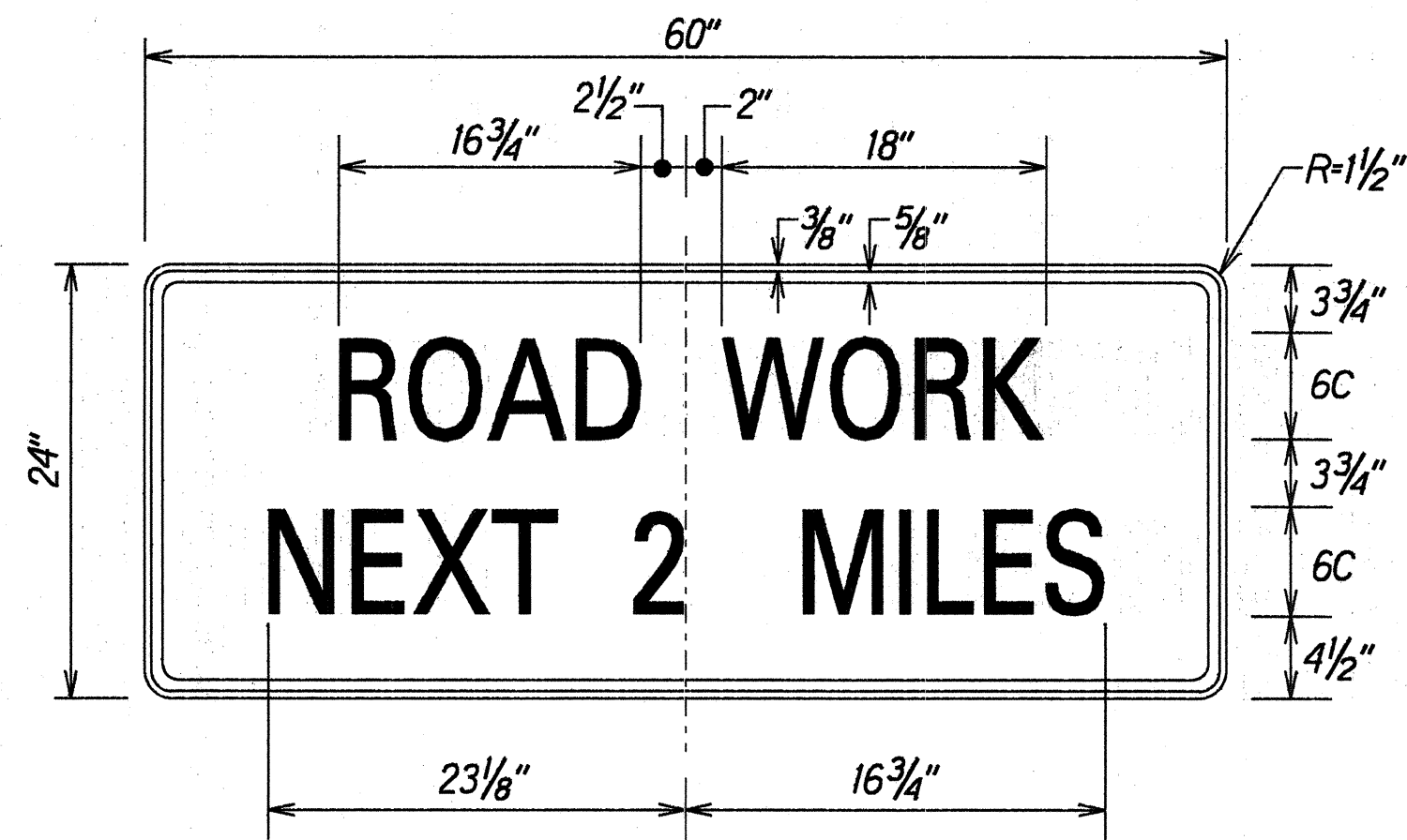

CG20-1A

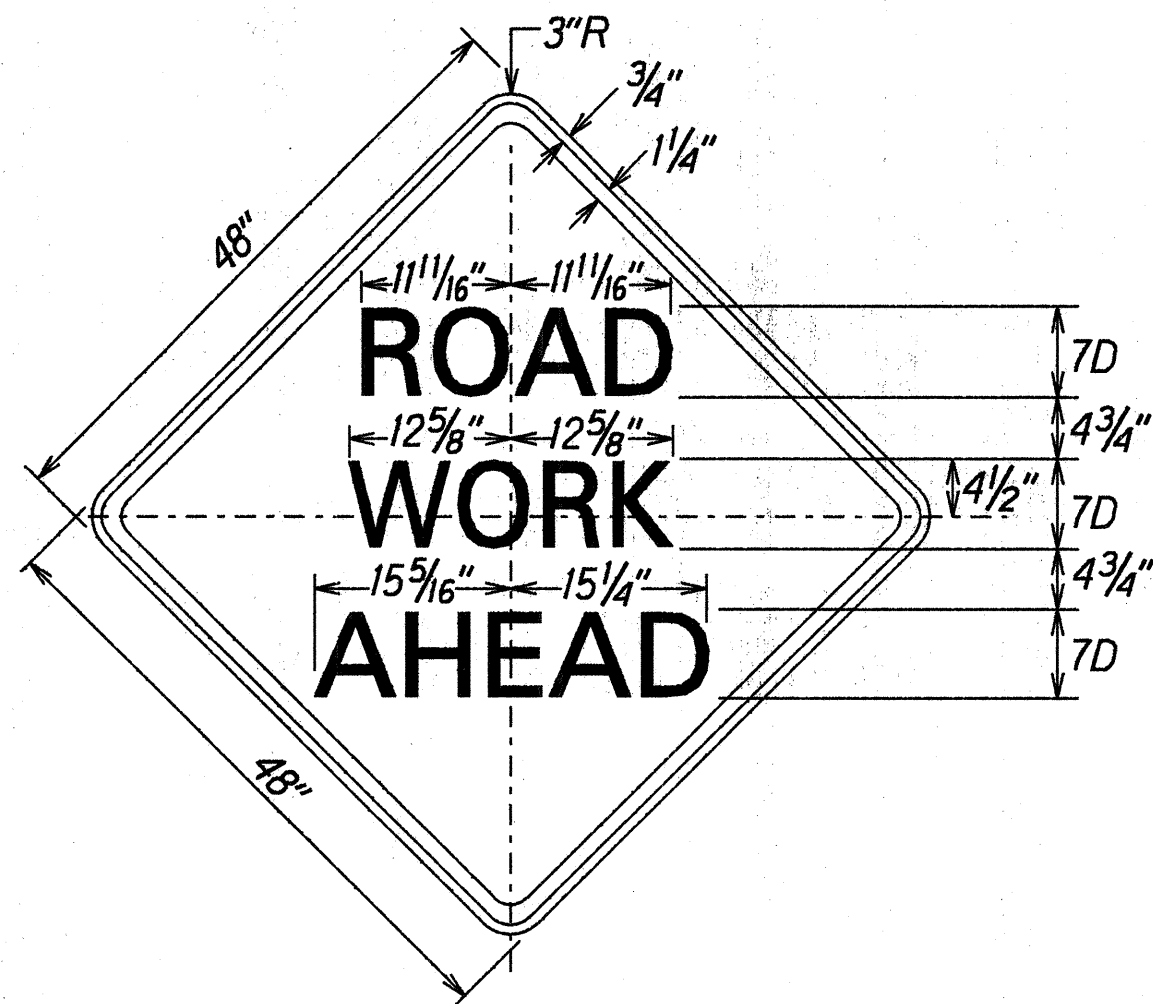

CW20-1A(d)

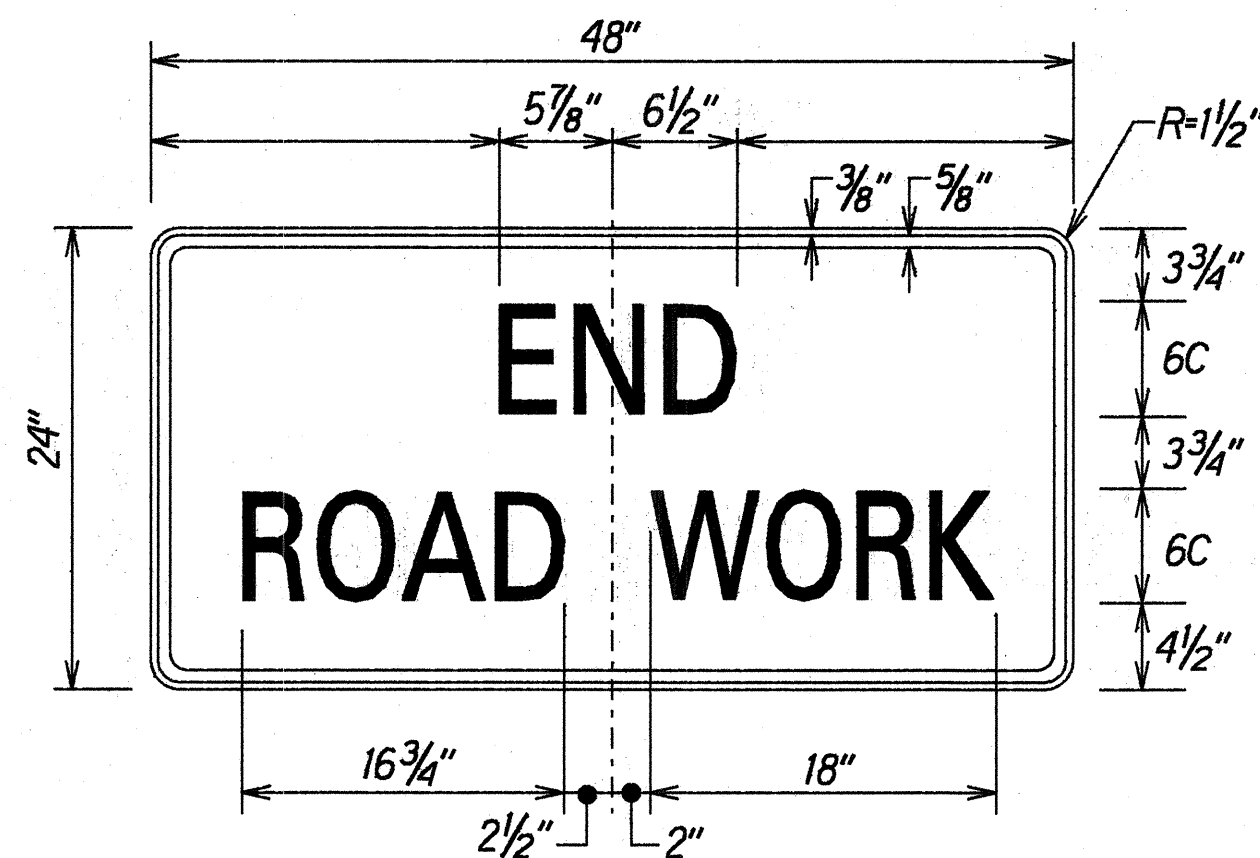

CG20-2A

SIGN DETAILS
Not To Scale

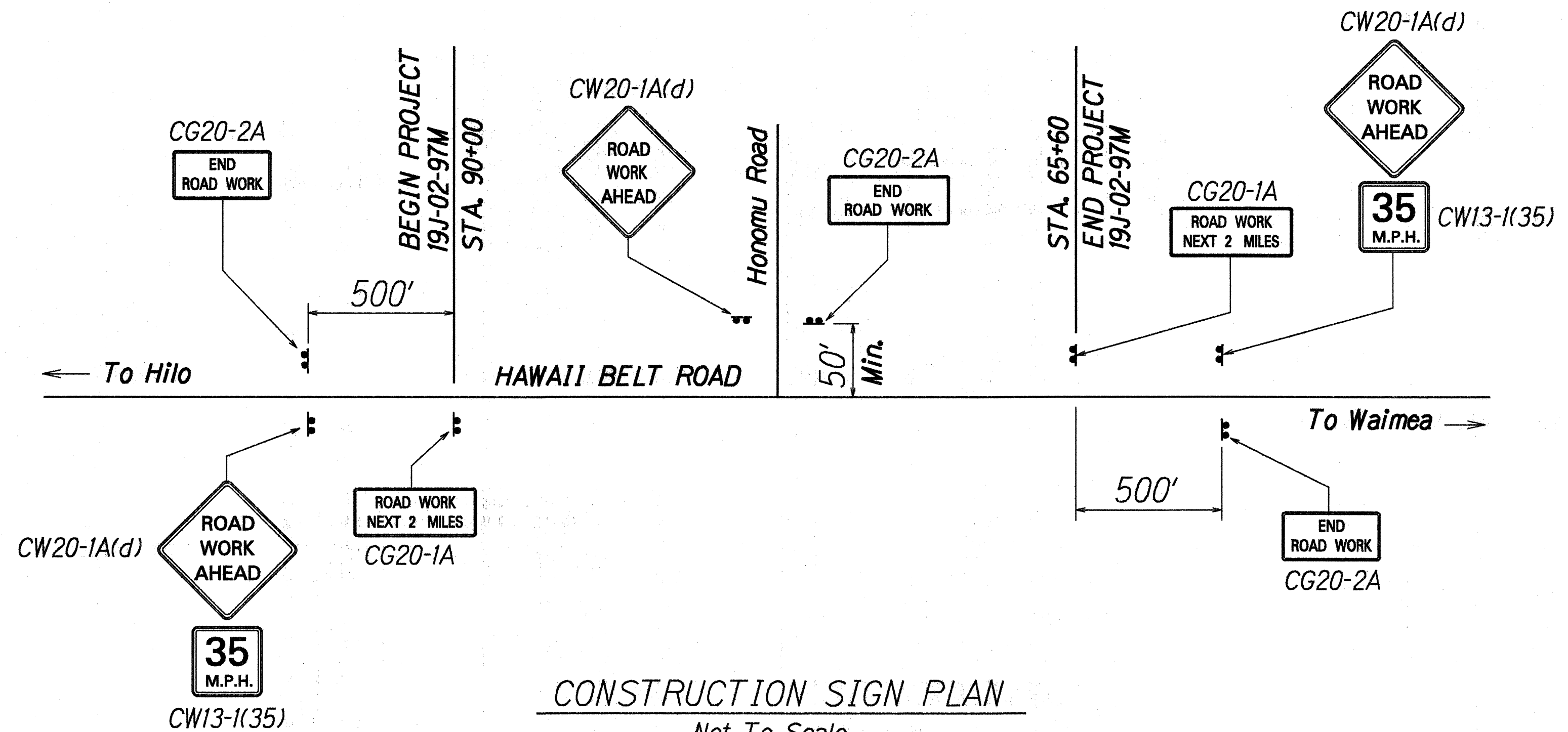

CONSTRUCTION SIGN PLAN
Not To Scale

CONSTRUCTION SIGN SCHEDULE					
ROAD AND LOCATION *	ROUTE 19 CENTERLINE STATION **	LEFT	RIGHT	ITEM No. 621.7121 (no posts)	ITEM No. 621.7120 (two posts)
Hawaii Belt Road	85+00		●	CW13-1(35)	CW20-1A(d)
	85+00	●			CG20-2A
	90+00		●		CG20-1A
	Honoumuli Rd.		●		CG20-2A
	Honoumuli Rd.	●			CW20-1A(d)
	65+60	●			CG20-1A
	70+60	●		CW13-1(35)	CW20-1A(d)
	70+60		●		CG20-2A
Total Construction Signs				2	8

- * - Final locations of all signs to be determined in the field by the Engineer.
** - Signs erected on side roads must be located 50' (Min.), from E. P. of Hawaii Belt Road.

ORIGINAL PLAN	SURVEY PLOTTED BY	DATE
NOTES	DRAWN BY	
QUANTITIES	CHECKED BY	
BY		

STATE OF HAWAII
DEPARTMENT OF TRANSPORTATION
HIGHWAYS DIVISION

**CONSTRUCTION SIGN
PLAN & SCHEDULE**

HAWAII BELT ROAD RESURFACING
PEPE'EKEO TO KOLEKOLE
PROJECT NO. 19J-02-97M

Scale: As Shown Date: Nov., 1996

SHEET No. 1 OF 1 SHEETS