

FED. ROAD DIST. NO.	STATE	PROJ. NO.	FISCAL YEAR	SHEET NO.	TOTAL SHEETS
HAWAII	HAW.	19D-01-96M	1996	19	20

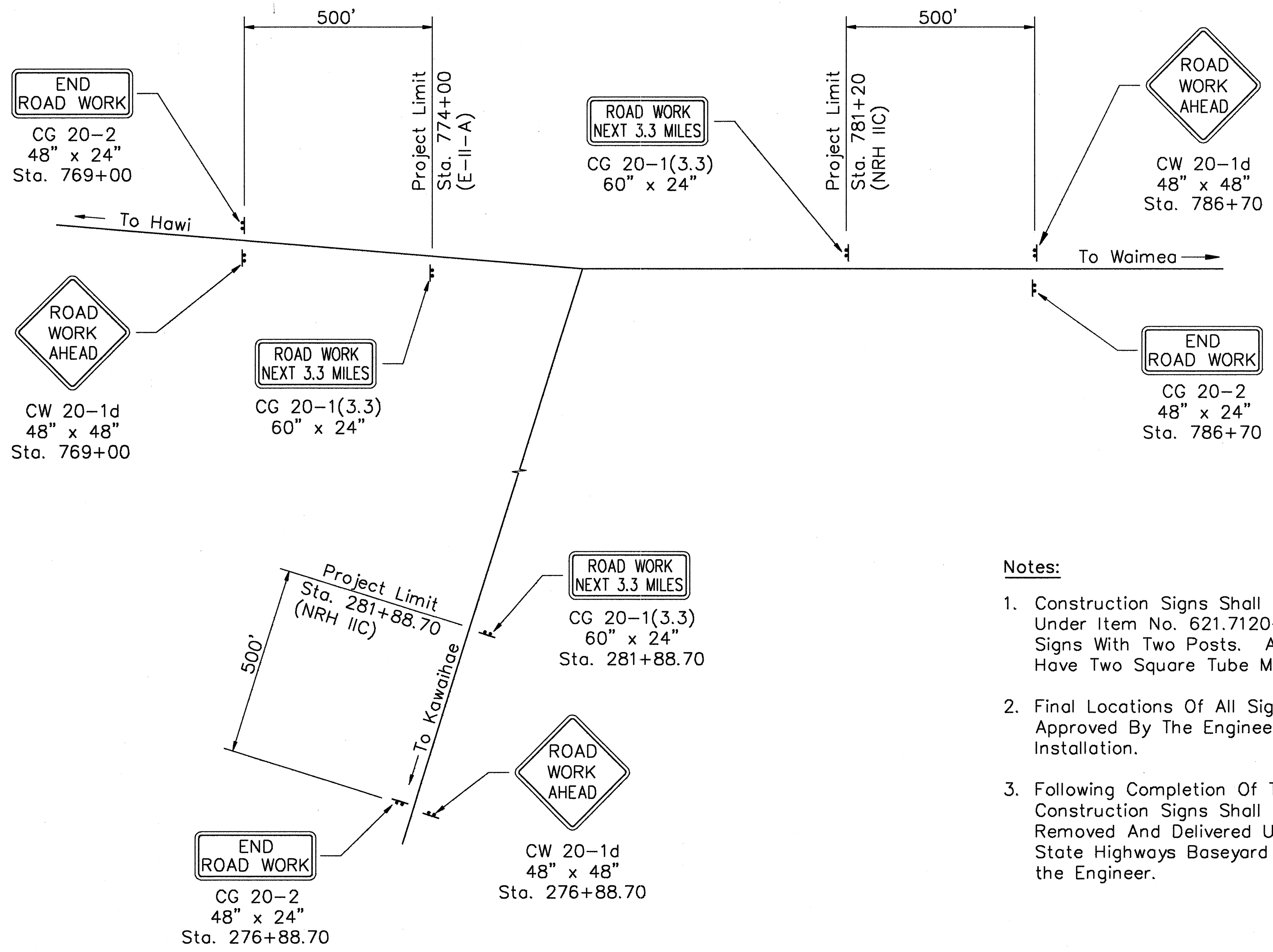

- Notes:**
1. Construction Signs Shall Be Paid For Under Item No. 621.7120-Construction Signs With Two Posts. All Signs Shall Have Two Square Tube Metal Posts.
 2. Final Locations Of All Signs Shall Be Approved By The Engineer Prior To Installation.
 3. Following Completion Of The Project, Construction Signs Shall Be Carefully Removed And Delivered Undamaged To The State Highways Baseyard Designated By the Engineer.

CONSTRUCTION SIGN PLAN
Not To Scale

DATE	_____
SURVEY PLOTTED BY	_____
DRAWN BY	_____
DESIGNED BY	_____
CHECKED BY	_____
ORIGINAL PLAN	_____
NOTES	_____
No.	_____

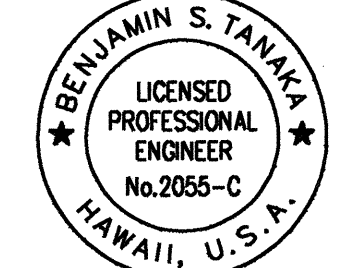
 THIS WORK WAS PREPARED BY ME OR UNDER MY SUPERVISION
Benjamin S. Tanaka

STATE OF HAWAII
 DEPARTMENT OF TRANSPORTATION
 HIGHWAYS DIVISION
CONSTRUCTION SIGN PLAN
 KAWAIHAE ROAD RESURFACING
 MP 58.97 TO MP 63.30
 PROJECT NO. 19D-01-96M
 Date: April 1996
 SHEET NO. 1 OF 1 SHEETS