

FED. ROAD DIST. NO.	STATE	FED. AID PROJ. NO.	FISCAL YEAR	SHEET NO.	TOTAL SHEETS
HAWAII	HAW.	MG-1950(1)	1982	6	25

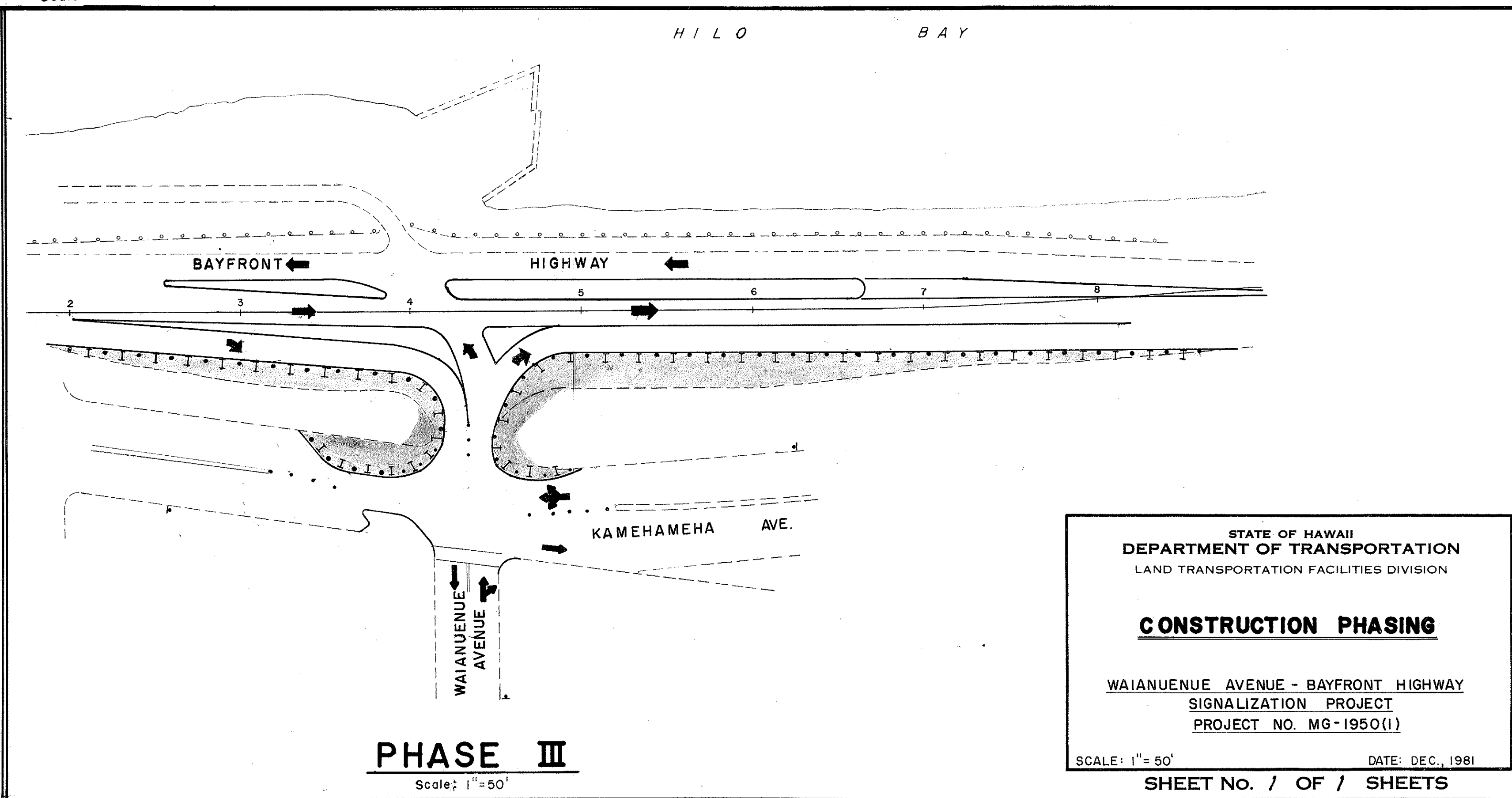
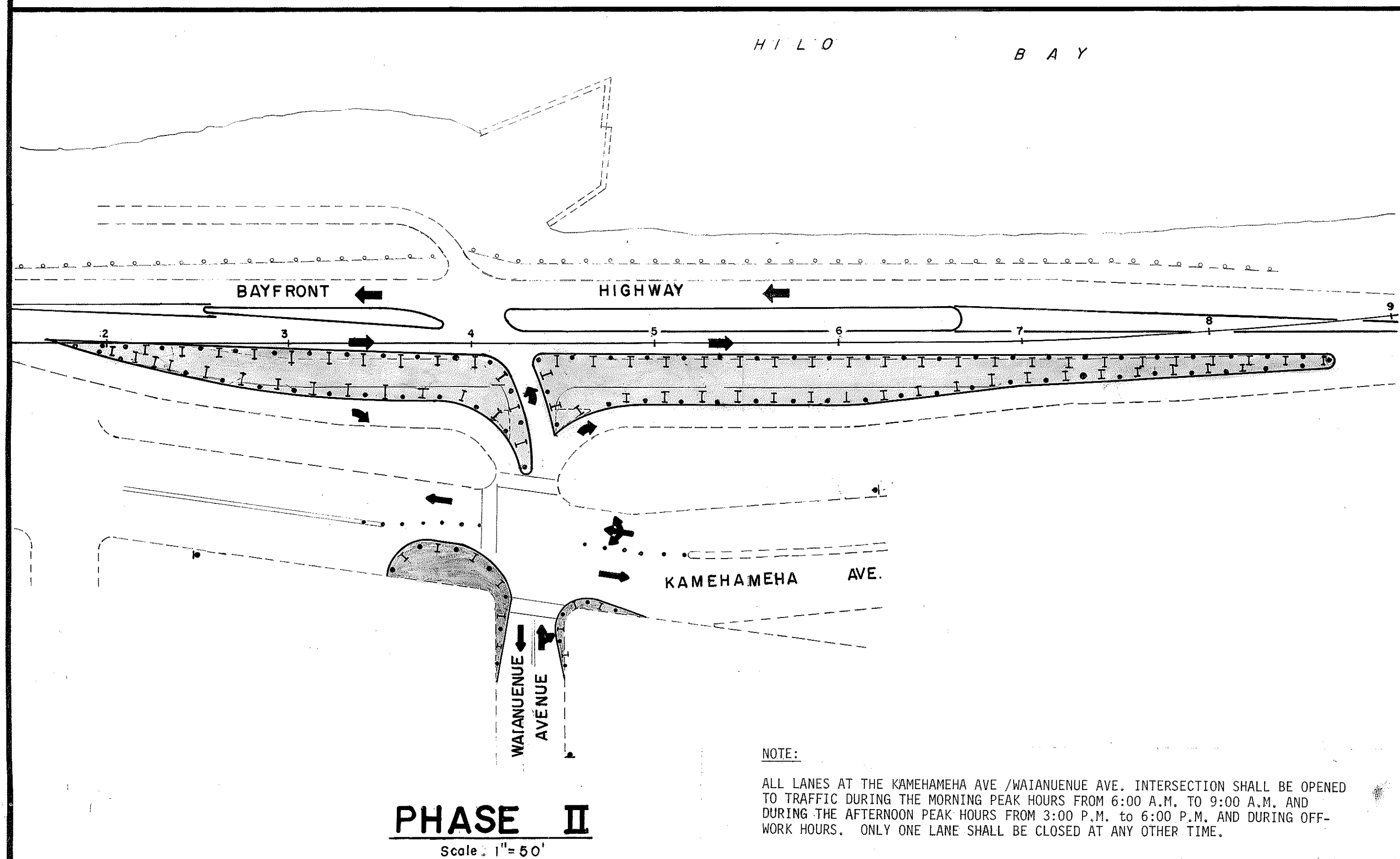
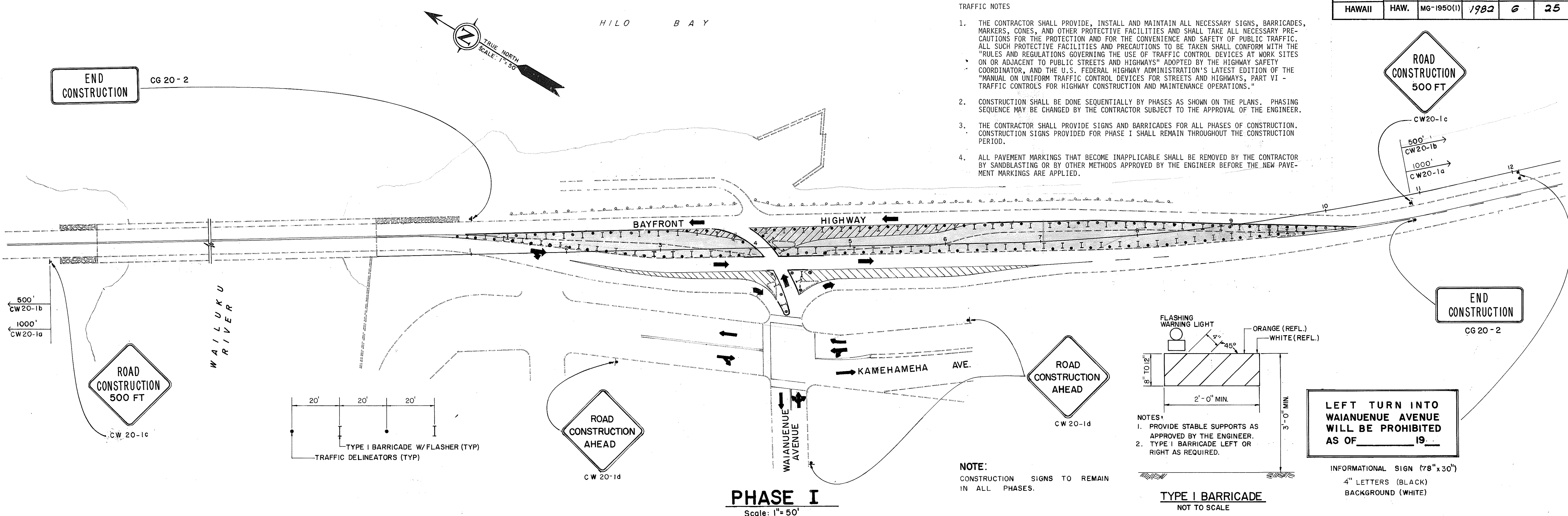

STATE OF HAWAII  
DEPARTMENT OF TRANSPORTATION  
LAND TRANSPORTATION FACILITIES DIVISION

**CONSTRUCTION PHASING**

WAIANUENUE AVENUE - BAYFRONT HIGHWAY  
SIGNALIZATION PROJECT  
PROJECT NO. MG-1950(1)

SCALE: 1"=50' DATE: DEC., 1981  
SHEET NO. 1 OF 1 SHEETS

ORIGINAL PLAN	SURVEY PLOTTED BY	DATE
NO. 1	DRAWN BY	
NO. 2	TRACED BY	
NO. 3	QUANTITIES BY	
NO. 4	CHECKED BY	