

# Attachment A-2 Property Boundary Map

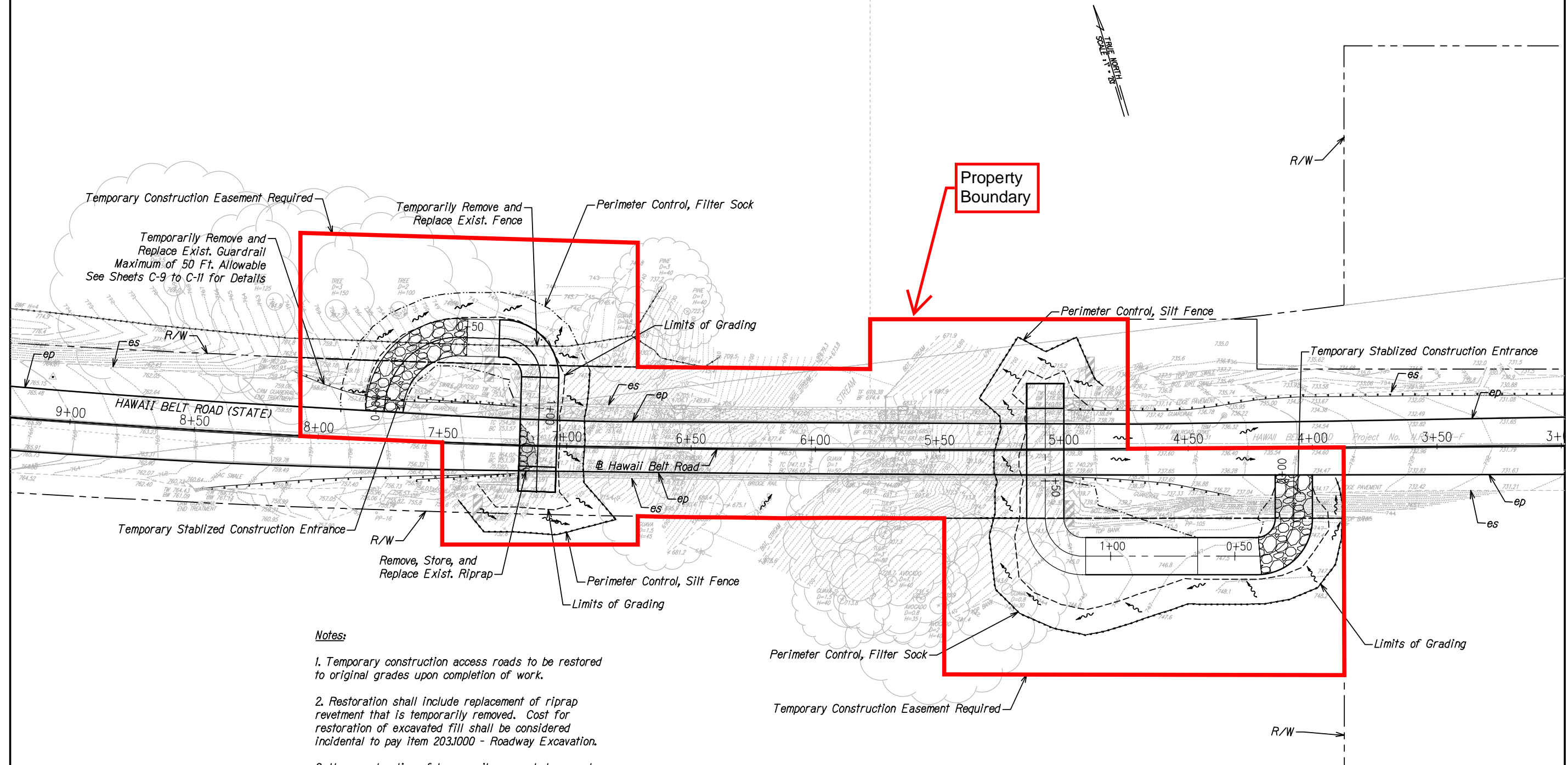

## Notes:

1. Temporary construction access roads to be restored to original grades upon completion of work.
2. Restoration shall include replacement of riprap revetment that is temporarily removed. Cost for restoration of excavated fill shall be considered incidental to pay item 203.1000 - Roadway Excavation.
3. Upon restoration of temporarily excavated areas to original grades, the site shall be stabilized with hydro seeding.
4. Sediment and Erosion Control BMP measures shown in the Contract Documents are minimum BMPs requirements and do not constitute an acceptable and/or complete Sediment Control Plan. The Contractor shall incorporate additional BMPs based upon their means and methods considering site conditions and construction sequence.

1" = 20'  
SCALE IN FEET

ORIGINAL PLAN	SURVEY PLOTTED BY	DATE
DRAWN BY	TRACED BY	
NOTE BOOK	QUANTIFIED BY	
	CHECKED BY	

## STATE OF HAWAII DEPARTMENT OF TRANSPORTATION HIGHWAYS DIVISION **ROADWAY PLAN KAHOLO BRIDGE**

**HAWAII BELT ROAD**  
*Seismic Retrofit of Kaholo Stream Bridge*  
Fed. Aid Proj. No. BR-019-2(072)

Scale: 1"=20' Date: Feb. 2024

SHEET No. C-2 OF 12 SHEETS

# Attachment A-2 Property Boundary Map

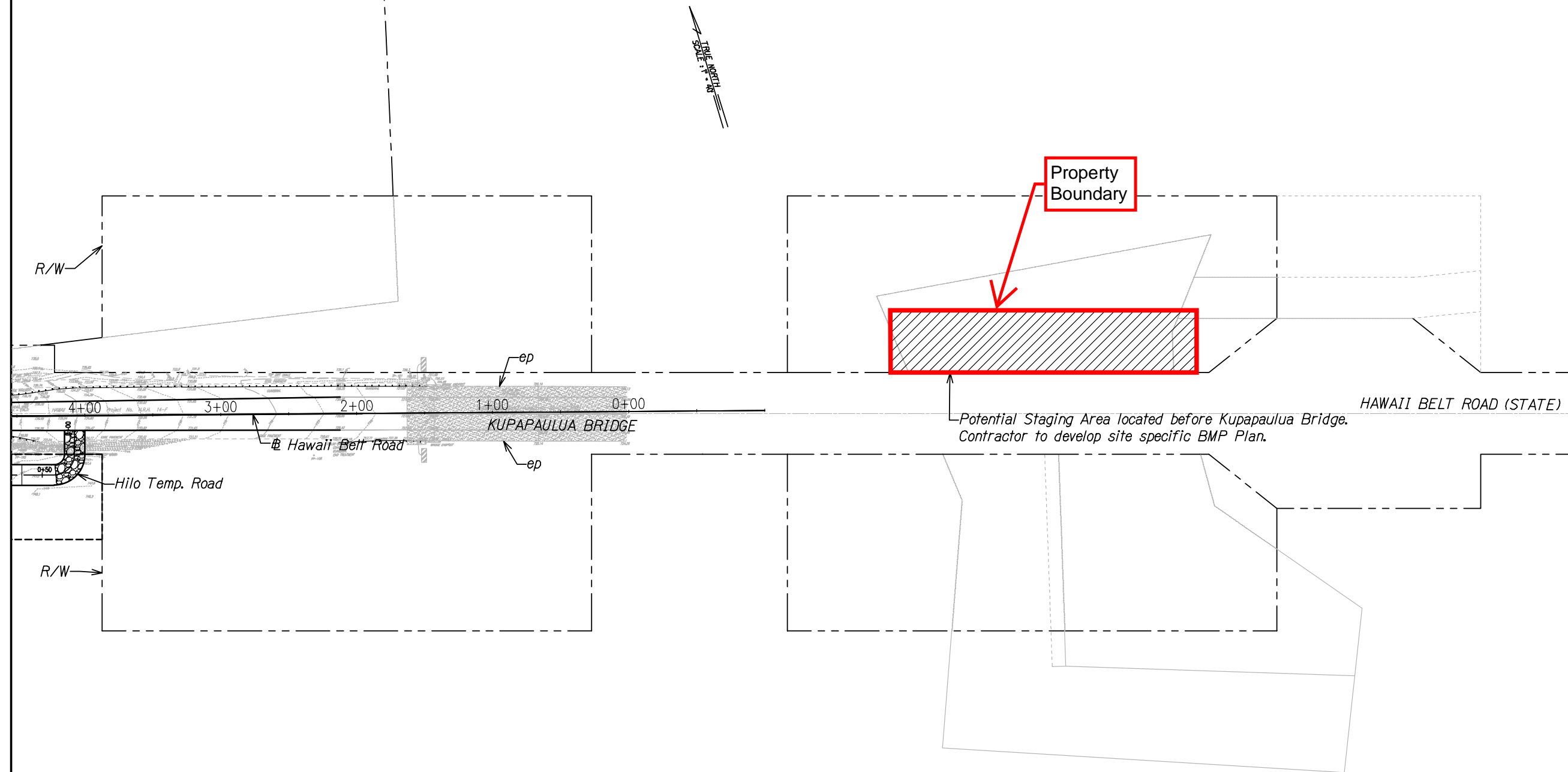

ORIGINAL PLAN	SURVEY PLOTTED BY	DATE
NOTE BOOK	DRAWN BY	
	CHECKED BY	
	DESIGNED BY	
	REVIEWED BY	
	APPROVED BY	

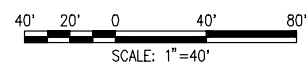

STATE OF HAWAII  
DEPARTMENT OF TRANSPORTATION  
HIGHWAYS DIVISION

**ROADWAY PLAN  
STAGING AREA**

**HAWAII BELT ROAD**  
*Seismic Retrofit of Kaholo Stream Bridge*  
*Fed. Aid Proj. No. BR-019-2(072)*

Scale: 1"=40' Date: Feb. 2024

SHEET No. C-3 OF 12 SHEETS