

FED. ROAD DIST. NO.	STATE	PROJ. NO.	FISCAL YEAR	SHEET NO.	TOTAL SHEETS
HAWAII	HAW.	19K-01-20M	2020	8	22

- Work Zone Note:
1. This Work Zone Sign Plan is intended for use on long-term stationary work zones/construction phases (3 days or more). All work zones or construction phases less than 3 days duration will use Traffic Control Plans shown in Section 645 of the Special Provisions.
 2. All existing regulatory speed limit signs with posts within the work zone/project limits shall be removed and replaced with work zone speed limit sign assemblies (R2-1(25) and R2-5b(25) with "CONSTRUCTION AREA" and "\$250 FINE HRS 291C-104" Supplemental Signs).
 3. Construction sign assemblies shall be installed on both the approaching and trailing ends of each work zone as shown on this plan.
 4. Each construction warning sign shall have a minimum of two (2) Type II OM. Each work zone speed limit assembly shall have a minimum of one (1) Type II OM. Installation of each Type II OM shall be considered incidental to Item No. 645.1000 - Traffic Control.
 5. Upon the completion of all physical work or as directed by the Engineer, all construction signs and work zone speed limit assemblies shall be removed. All speed limit signs and posts that were existing at the start of the project within the work zone/project limits shall be restored back to their original locations and configurations.
 6. Placement of construction signs shall not obstruct the path of pedestrians and bicyclists.
 7. The removal and restoration of existing regulatory speed limit signs shall be considered incidental to Item No. 645.1000 - Traffic Control.
 8. The installation, maintenance and removal of work zone speed limit signs shall be paid for under Item No. 645.1000 - Traffic Control.
 9. The work zone speed limit signs shall be new and become the property of the Contractor.
 10. The Contractor shall adjust the locations of work zone signs to correspond with the beginning and end of work zone limits for each phase. Relocation of work zone signs shall be considered incidental to Item No. 645.1000 - Traffic Control.

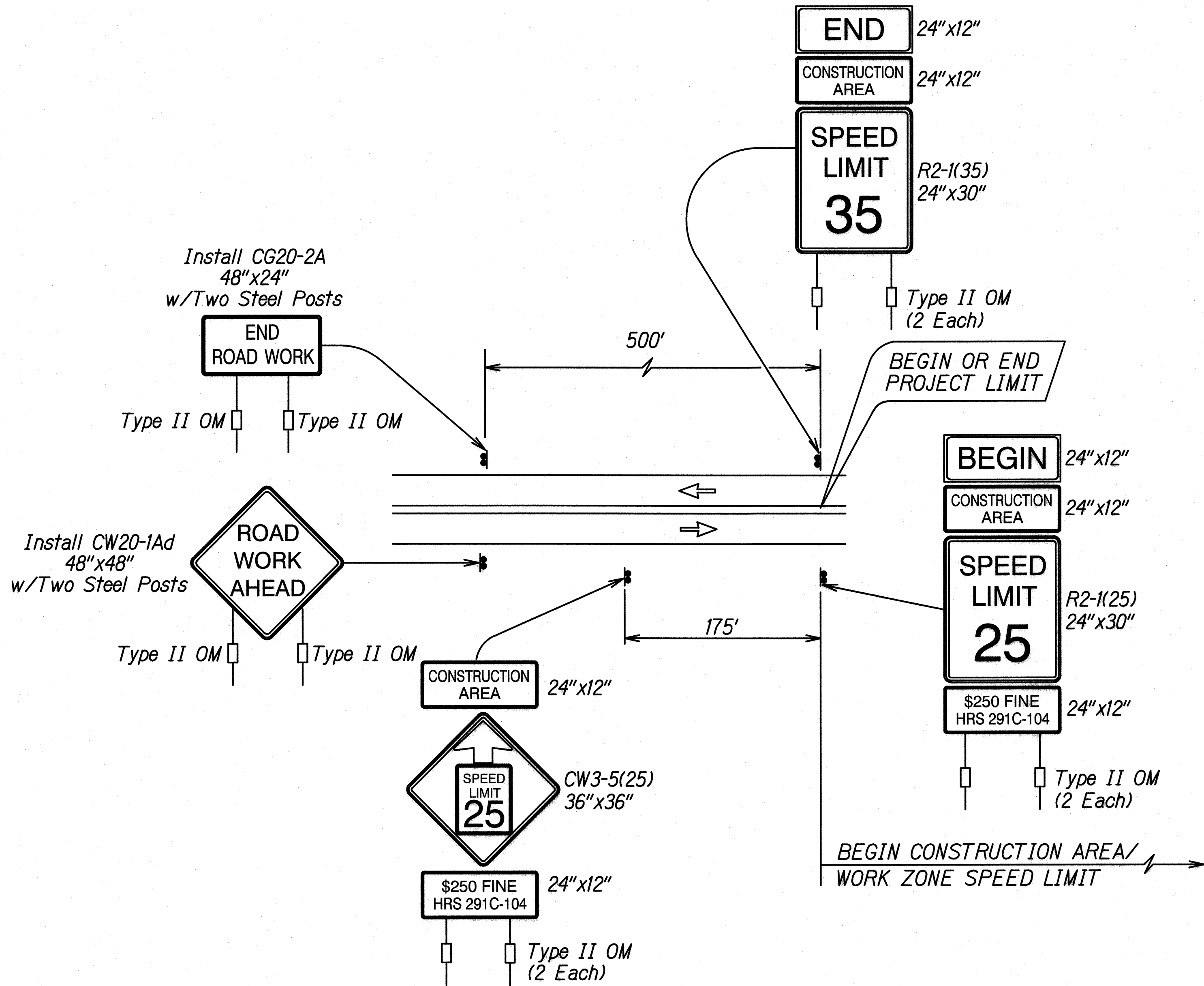

TYPICAL DETAIL FOR CONSTRUCTION SIGNS
ON TWO LANE OR MULTILANE UNDIVIDED LOW SPEED HIGHWAY

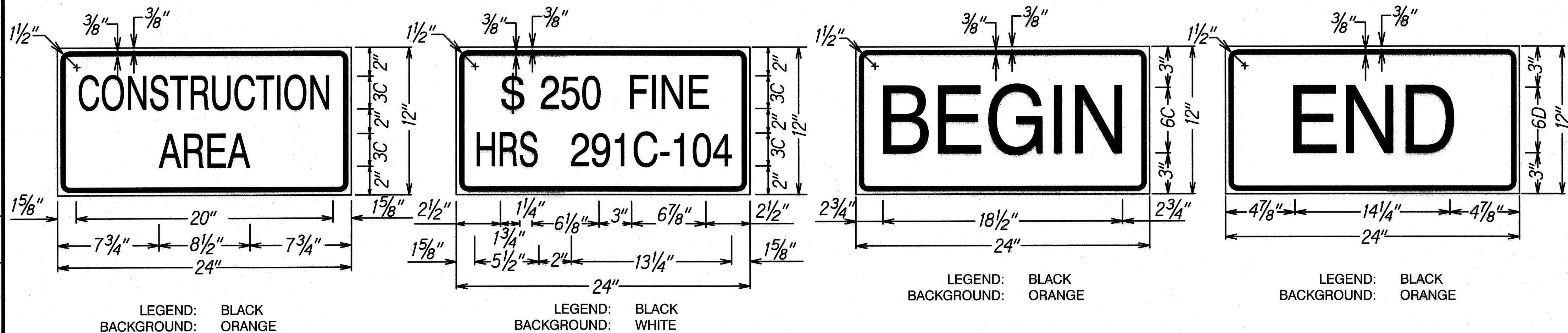

THIS WORK WAS PREPARED BY ME OR UNDER MY SUPERVISION.

SIGNATURE: *Gerald D. Andrade* EXPIRATION DATE OF THE LICENSE: 04/30/20

STATE OF HAWAII
DEPARTMENT OF TRANSPORTATION
HIGHWAYS DIVISION

**LOW SPEED UNDIVIDED HIGHWAY
WORK ZONE SIGNING PLAN, NOTES&DETAILS**

HAWAII BELT ROAD
Wailuku Stream Bridge Spall Repairs, MP 2.74
Project No. 19K-01-20M

Scale: None Date: Oct. 1, 2019

SHEET No. C-1 OF 7 SHEETS

FED. ROAD DIST. NO.	STATE	PROJ. NO.	FISCAL YEAR	SHEET NO.	TOTAL SHEETS
HAWAII	HAW.	19K-01-20M	2020	9	22

TRUE NORTH
SCALE : NTS

- Notes:
- Contractor May Shift Waimea-Bound Traffic Lane As Needed To Accomplish Repair Work While Hilo-Bound Traffic Is Detoured.
 - Hilo Bound Daytime Detour From 8:00 a.m. to 5:30 p.m. or As Otherwise Directed By The Engineer.

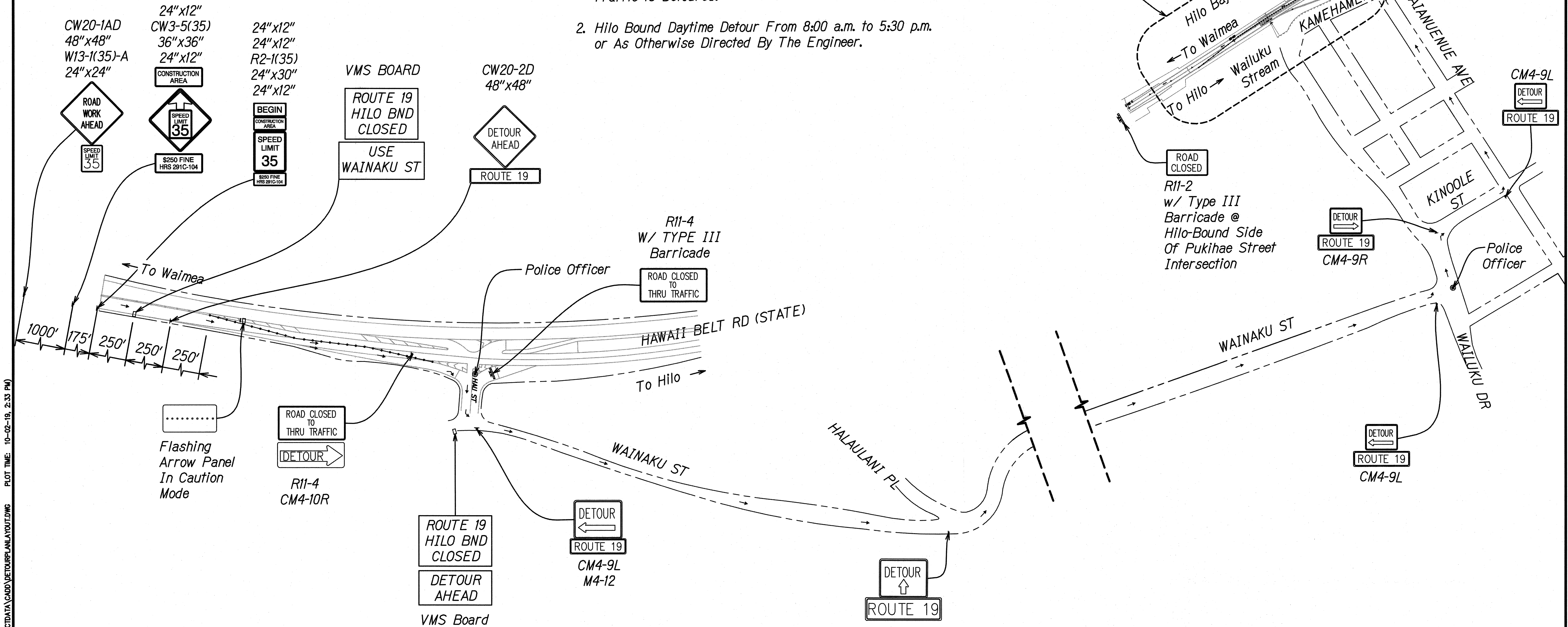

- Legend
- ⊗ Flagger/Officer
 - Traffic Cones
 - Traffic Flow
 - Sign(s)
 - Barricade
 - Arrow Board
 - VMS Board

OVERALL DETOUR PLAN
SCALE: NTS

DESIGNED BY	DATE
DRAWN BY	
CHECKED BY	
APPROVED BY	
PROJECT NO.	
PROJECT NAME	
PROJECT LOCATION	
PROJECT DESCRIPTION	
PROJECT STATUS	
PROJECT START DATE	
PROJECT END DATE	
PROJECT BUDGET	
PROJECT COST	
PROJECT PROFIT	
PROJECT RISK	
PROJECT IMPACT	
PROJECT BENEFIT	
PROJECT SUSTAINABILITY	
PROJECT COMMUNITY ENGAGEMENT	
PROJECT TRANSPARENCY	
PROJECT ACCOUNTABILITY	
PROJECT INTEGRITY	
PROJECT ETHICS	
PROJECT COMPLIANCE	
PROJECT LEGALITY	
PROJECT MORALITY	
PROJECT JUSTICE	
PROJECT EQUITY	
PROJECT INCLUSIVITY	
PROJECT PARTICIPATION	
PROJECT COOPERATION	
PROJECT SOLIDARITY	
PROJECT HUMANITY	
PROJECT CIVILITY	
PROJECT DECENCY	
PROJECT RESPECT	
PROJECT DIGNITY	
PROJECT WORTH	
PROJECT MEANING	
PROJECT PURPOSE	
PROJECT VALUE	
PROJECT QUALITY	
PROJECT EXCELLENCE	
PROJECT PERFECTION	
PROJECT HARMONY	
PROJECT BALANCE	
PROJECT PACE	
PROJECT RHYTHM	
PROJECT BEAUTY	
PROJECT GRACE	
PROJECT GLOUTY	
PROJECT KINDNESS	
PROJECT COMPASSION	
PROJECT MERCY	
PROJECT LOVE	

DRAWING NAME: PROJECTS 190200-WAILUKU STREAM BRIDGE V.S.O-PROJECT DATA (CAD) DETOUR PLAN LAYOUT.DWG PLOT TIME: 10-02-19, 2:33 PM

THIS WORK WAS PREPARED BY ME OR UNDER MY SUPERVISION.

SIGNATURE: *Gerald D. Andrade* EXPIRATION DATE OF LICENSE: 04/30/20

STATE OF HAWAII
DEPARTMENT OF TRANSPORTATION
HIGHWAYS DIVISION

**GENERAL LAYOUT
HILO BOUND DETOUR**

**HAWAII BELT ROAD
Wailuku Stream Bridge Spall Repairs, MP 274
Project No. 19K-01-20M**

Scale: Not To Scale Date: Oct. 2, 2019

SHEET No. C-2 OF 7 SHEETS

FED. ROAD DIST. NO.	STATE	PROJ. NO.	FISCAL YEAR	SHEET NO.	TOTAL SHEETS
HAWAII	HAW.	19K-01-20M	2020	10	22

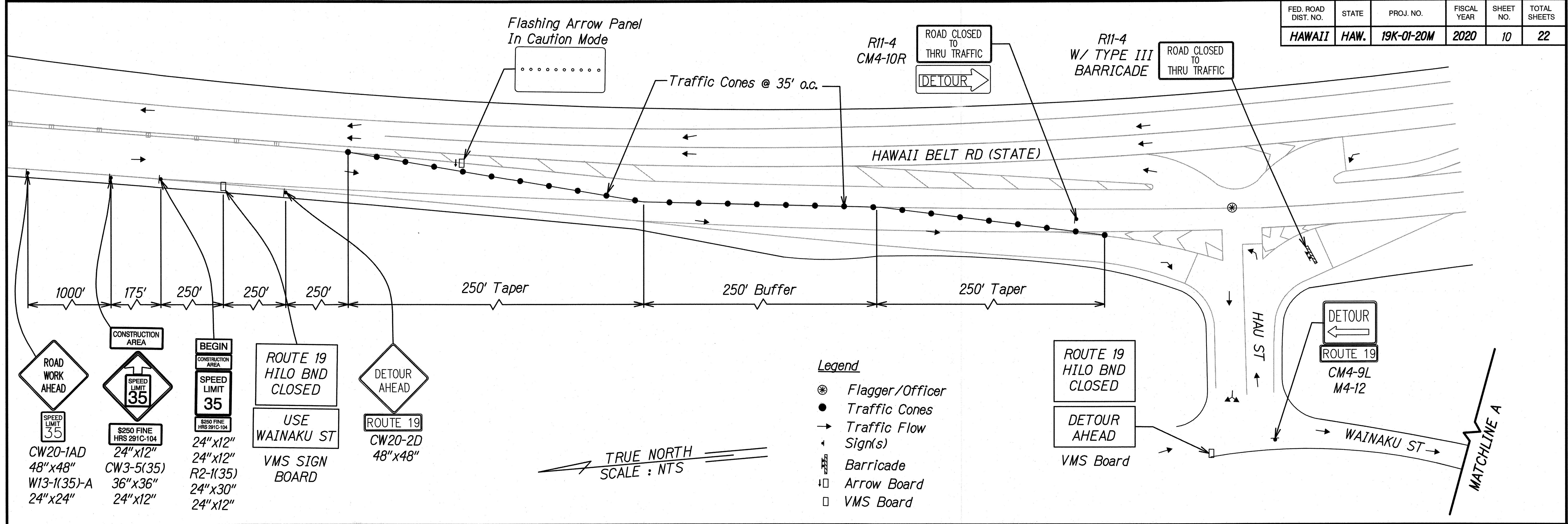

Note: Hilo Bound Daytime Detour From 8:00 a.m. to 5:30 p.m. or As Otherwise Directed By The Engineer.

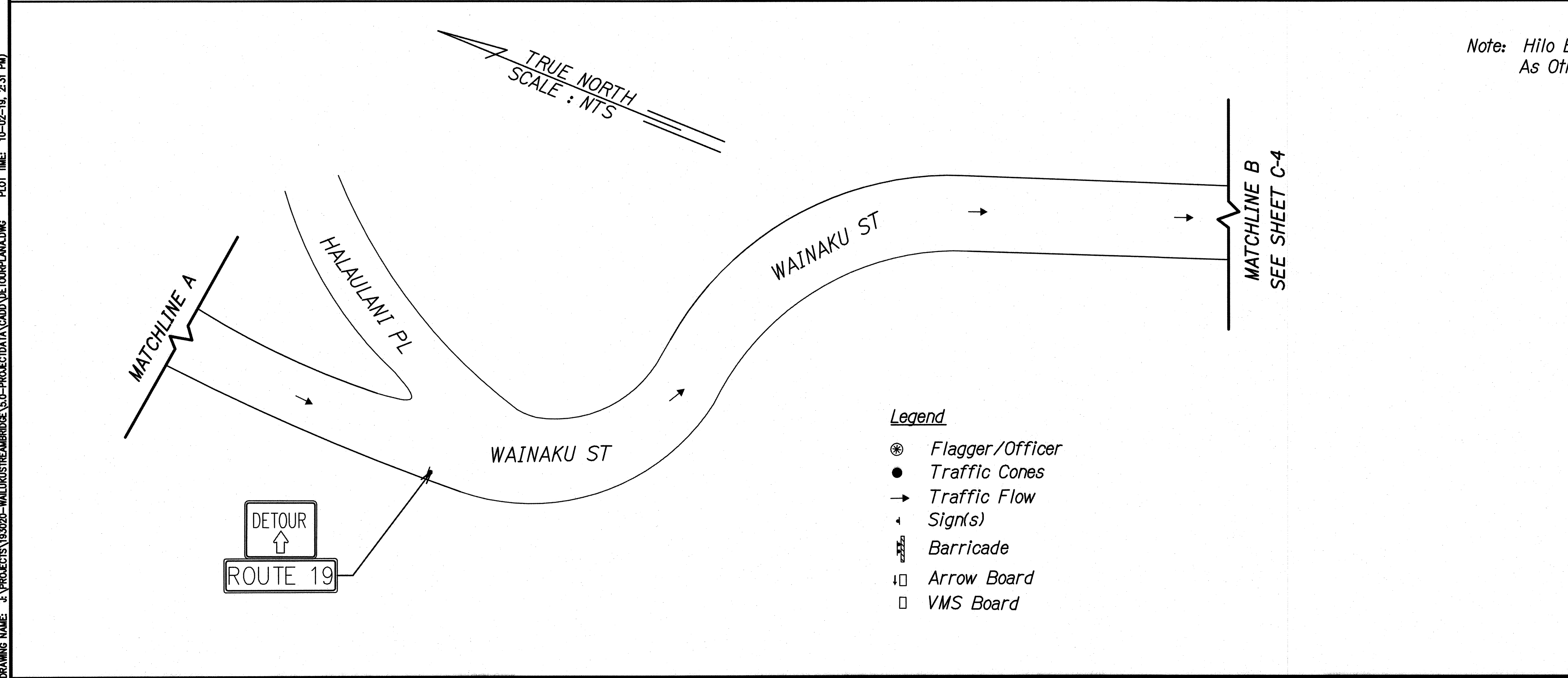

DESIGNED BY	DATE
DRAWN BY	DATE
CHECKED BY	DATE
IN CHARGE	DATE

DRAWING NAME: 4-PROJECTS\193020-WAILUKU\STREAM\BRIDGE\5.0-PROJECT\DATA\CADD\DETOUR\PLAN.DWG PLOT TIME: 10-02-19, 2:31 PM

THIS WORK WAS PREPARED BY ME OR UNDER MY SUPERVISION.

Signature: *Gerald D. Andros* Date: 04/30/20

STATE OF HAWAII
DEPARTMENT OF TRANSPORTATION
HIGHWAYS DIVISION

TRAFFIC CONTROL PLAN
DAYTIME ONLY

HAWAII BELT ROAD
Wailuku Stream Bridge Spall Repairs, MP 2.74
Project No. 19K-01-20M

Scale: As Shown Date: Oct. 2, 2019

SHEET No. C-3 OF 7 SHEETS

FED. ROAD DIST. NO.	STATE	PROJ. NO.	FISCAL YEAR	SHEET NO.	TOTAL SHEETS
HAWAII	HAW.	19K-01-20M	2020	11	22

Note: Hilo Bound Daytime Detour From 8:00 a.m. to 5:30 p.m. or As Otherwise Directed By The Engineer.

DRAWING NAME: J:\PROJECTS\193020-WAILUKUSTREAMBRIDGE\5.0-PROJECTDATA\CAAD\DETOUR\PLAN\B.DWG PLOT TIME: 10-02-19 2:28 PM

DESIGNED BY	DATE
DRAWN BY	
CHECKED BY	
IN CHARGE	
NOTES BOOK	
NO.	

Legend

- ⊗ Flagger/Officer
- Traffic Cones
- Traffic Flow Sign(s)
- ⚡ Barricade
- ⇄ Arrow Board
- VMS Board

TRUE NORTH
SCALE: N.T.S.

MATCHLINE B
SEE SHEET C-3

CM4-9L
DETOUR
ROUTE 19

DETOUR
ROUTE 19
CM4-9R

DETOUR
ROUTE 19
CM4-9L

DETOUR
ROUTE 19

DETOUR
END
CM4-9R
M4-12

See Sheet C-5

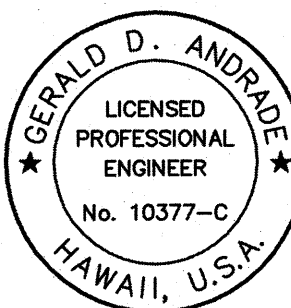

THIS WORK WAS PREPARED BY ME
OR UNDER MY SUPERVISION.
SIGNATURE
04/30/20
EXPIRATION DATE
OF THE LICENSE

STATE OF HAWAII
DEPARTMENT OF TRANSPORTATION
HIGHWAYS DIVISION

TRAFFIC CONTROL PLAN
DAYTIME ONLY

HAWAII BELT ROAD
Wailuku Stream Bridge Spall Repairs, MP 2.74
Project No. 19K-01-20M

Scale: As Shown Date: Oct. 2, 2019

SHEET No. C-4 OF 7 SHEETS

Note: Hilo Bound Daytime Detour From 8:00 a.m. to 5:30 p.m. or
As Otherwise Directed By The Engineer.

FED. ROAD DIST. NO.	STATE	PROJ. NO.	FISCAL YEAR	SHEET NO.	TOTAL SHEETS
HAWAII	HAW.	19K-01-20M	2020	12	22

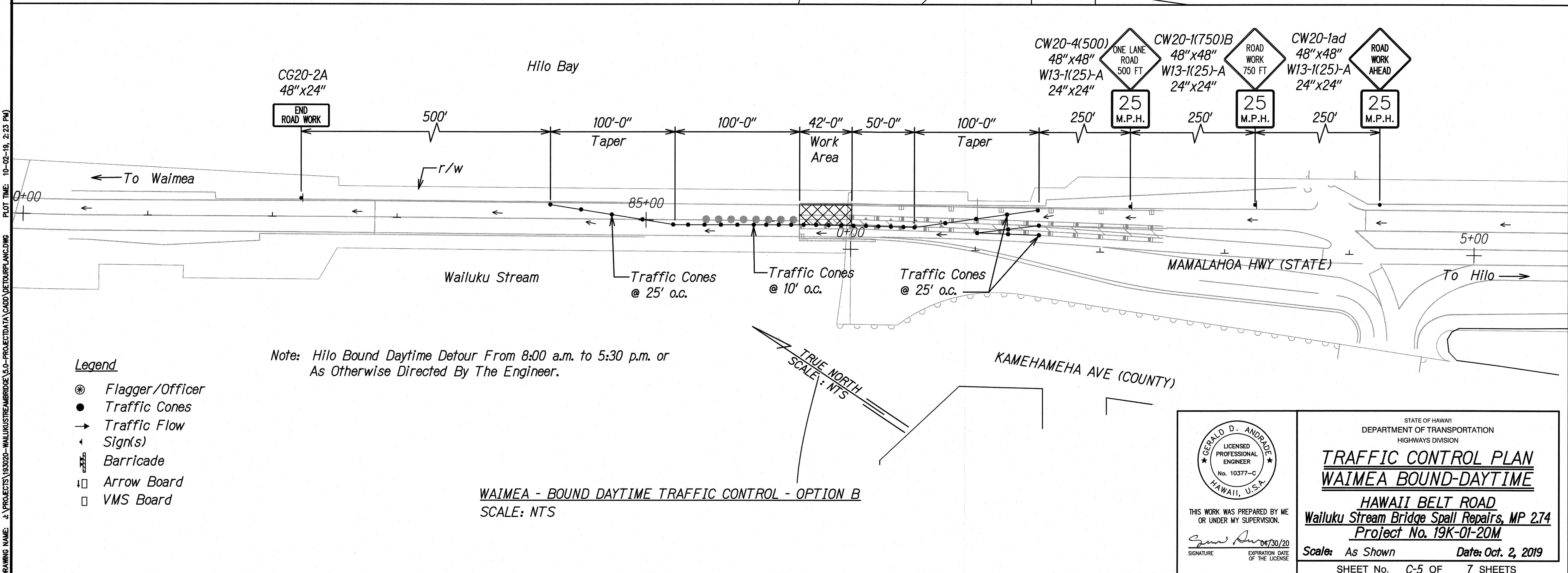
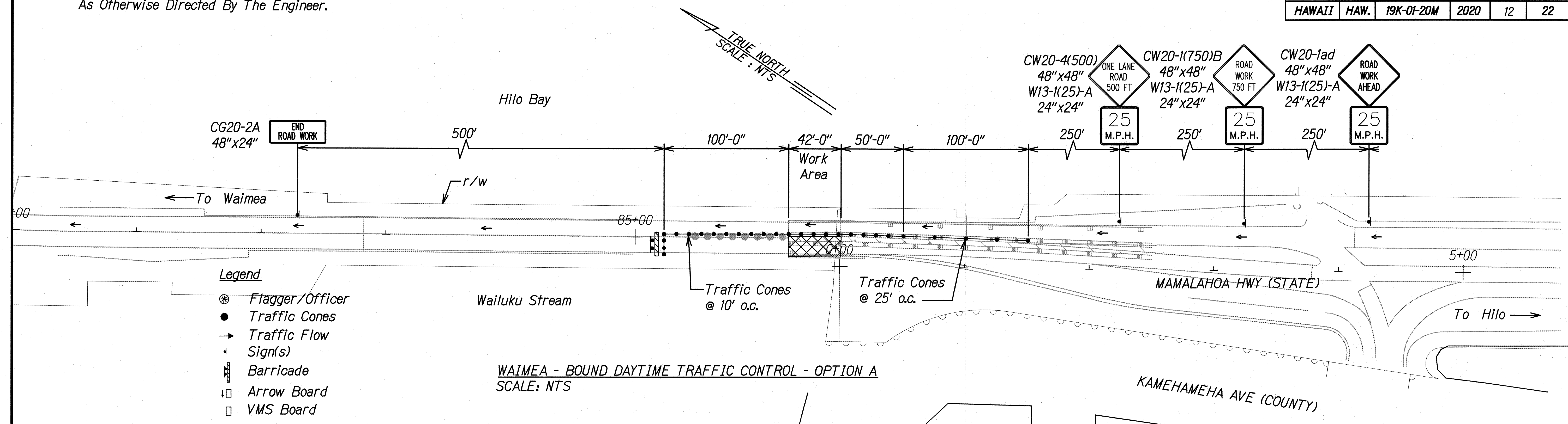

Note: Hilo Bound Daytime Detour From 8:00 a.m. to 5:30 p.m. or
As Otherwise Directed By The Engineer.

DESIGNED BY	DATE
DRAWN BY	
CHECKED BY	
IN CHARGE	

DRAWING NAME: J:\PROJECTS\193000-WAILEA STREAM BRIDGE\5.0-PROJECT DATA\0400-DETOUR PLAN C.DWG
PLOT TIME: 10-02-19 2:23 PM

STATE OF HAWAII
DEPARTMENT OF TRANSPORTATION
HIGHWAYS DIVISION

TRAFFIC CONTROL PLAN
WAIEA BOUND-DAYTIME

HAWAII BELT ROAD
Waialea Stream Bridge Spall Repairs, MP 2.74
Project No. 19K-01-20M

Scale: As Shown Date: Oct. 2, 2019

SHEET No. C-5 OF 7 SHEETS

GERALD D. ANDRADE
LICENSED PROFESSIONAL ENGINEER
No. 10377-C
HAWAII, U.S.A.

THIS WORK WAS PREPARED BY ME
OR UNDER MY SUPERVISION.

Gerald D. Andrade 04/30/20
SIGNATURE EXPIRATION DATE OF THE LICENSE

