

| DIST. NO. | STATE | FED. AID PROJECT | FISCAL YEAR | SHEET NO. | TOTAL SHEETS |
|-----------|-------|------------------|-------------|-----------|--------------|
| HAWAII    | HAW.  | HSIP-019-2(62)   | 2012        | 42        | 42           |

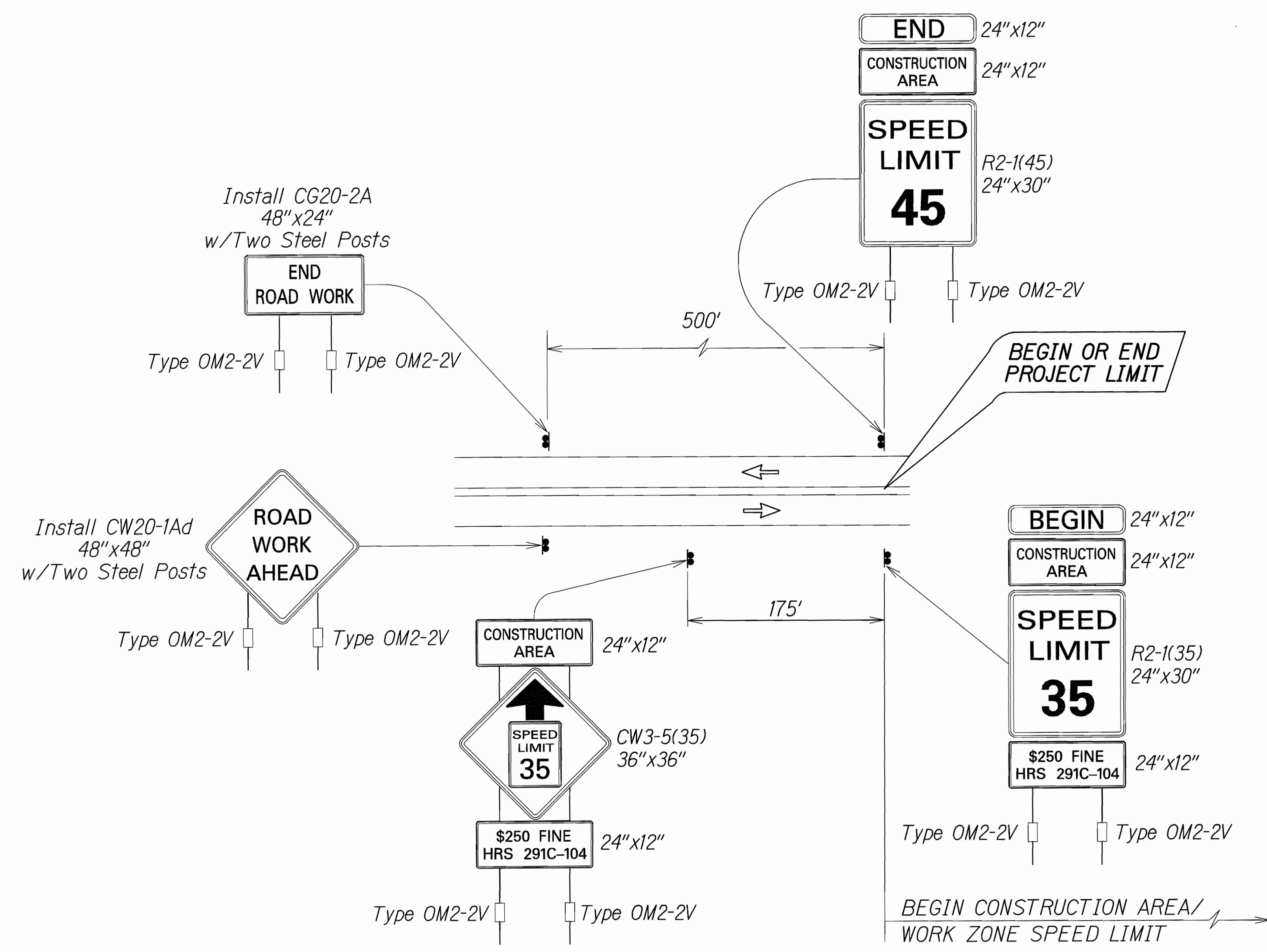

**Work Zone Notes:**

1. This Work Zone Sign Plan is intended for use on long-term stationary work zones/construction phases (3 days or more). Contractor shall use Traffic Control Plans shown in Section 645 of the Special Provisions.
2. All existing regulatory speed limit signs within the work zone/project limits shall be covered. Work zone speed limit sign assemblies and supplemental signs shall be temporarily installed within work zone/project limits.
3. Construction sign assemblies shall be installed on both the approaching and trailing ends of each work zone as shown on this plan.
4. Each construction warning sign and work zone speed limit assembly shall have a minimum of two (2) Type OM2-2V. Installation of each Type OM2-2V shall be considered incidental to Item No. 645.1000 - Traffic Control.
5. Upon the completion of all physical work or as directed by the Engineer, all construction signs and work zone speed limit assemblies shall be removed. All speed limit signs and posts that were existing at the start of the project within the work zone/project limits shall be uncovered.
6. Placement of construction signs shall not obstruct the path of pedestrians and bicyclists.
7. Maintenance and removal of work zone speed limit sign assemblies shall be considered incidental to Item No. 645.1000 - Traffic Control.

**TYPICAL DETAIL FOR CONSTRUCTION SIGNS ON TWO LANE HIGH SPEED HIGHWAY**

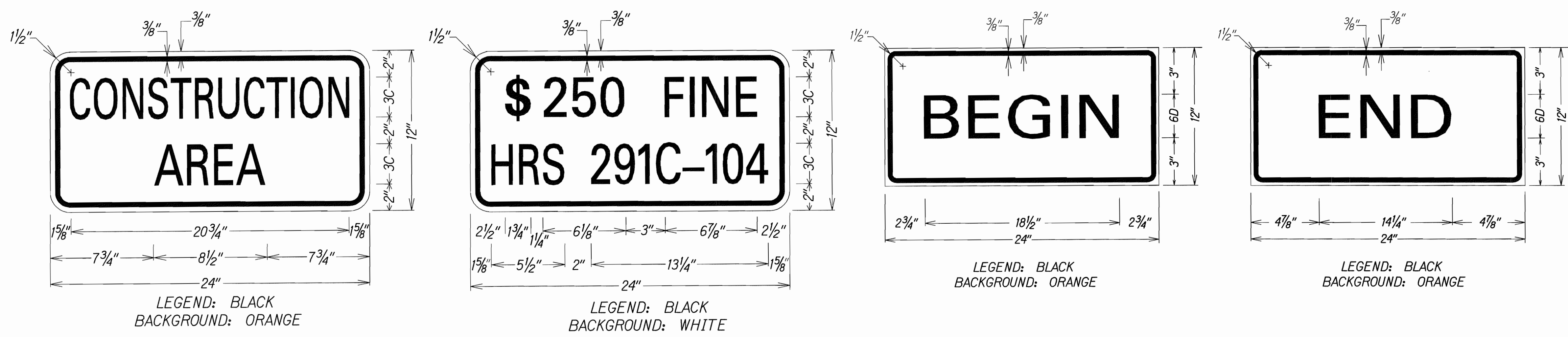

DATE: \_\_\_\_\_  
 SURVEY PLOTTED BY: \_\_\_\_\_  
 ORIGINAL PLAN DRAWN BY: \_\_\_\_\_  
 NOTED BY: \_\_\_\_\_  
 DESIGNED BY: \_\_\_\_\_  
 CHECKED BY: \_\_\_\_\_

STATE OF HAWAII  
 DEPARTMENT OF TRANSPORTATION  
 HIGHWAYS DIVISION  
**HIGH SPEED UNDIVIDED HIGHWAY**  
**WORK ZONE SIGNING PLAN, NOTES & DETAILS**  
 HAWAII BELT ROAD  
 Safety Improvements  
 Laupahoehoe Gulch and Ka'awali'i Gulch  
 Federal Aid Project No. HSIP-019-2(62)  
 Date: June, 2012  
 SHEET No. 1 OF 1 SHEETS