

FED. ROAD DIST. NO.	STATE	PROJ. NO.	FISCAL YEAR	SHEET NO.	TOTAL SHEETS
HAWAII	HAW.	19J-01-10	2010	ADD. 11	25

**KEY:**

- ① Exist. Sign & Post to Remain.
- ② Install New Sign with Post.
- ③ Remove Existing Sign & Post and Install New Sign & Post.
- ④ Remove Existing Sign and Replace with New Sign.
- ⑤ Add New Sign.
- ⑥ Add New Pavement Marking
- ⑦ Remove Existing Sign & Flasher and Install New Sign & Flasher on Existing Wooden Pole
- ⑧ Remove Existing Sign & Install New Sign on Existing Post(s)

Ⓜ Reflector Markers (RM-5) shall be mounted every 25 feet on all existing metal guardrails except on terminal sections. For details, see Plan Sheet No. 22. Unless otherwise noted, the Contractor shall be responsible for mounting RM-5's on all existing metal guardrails even when not shown on plans.

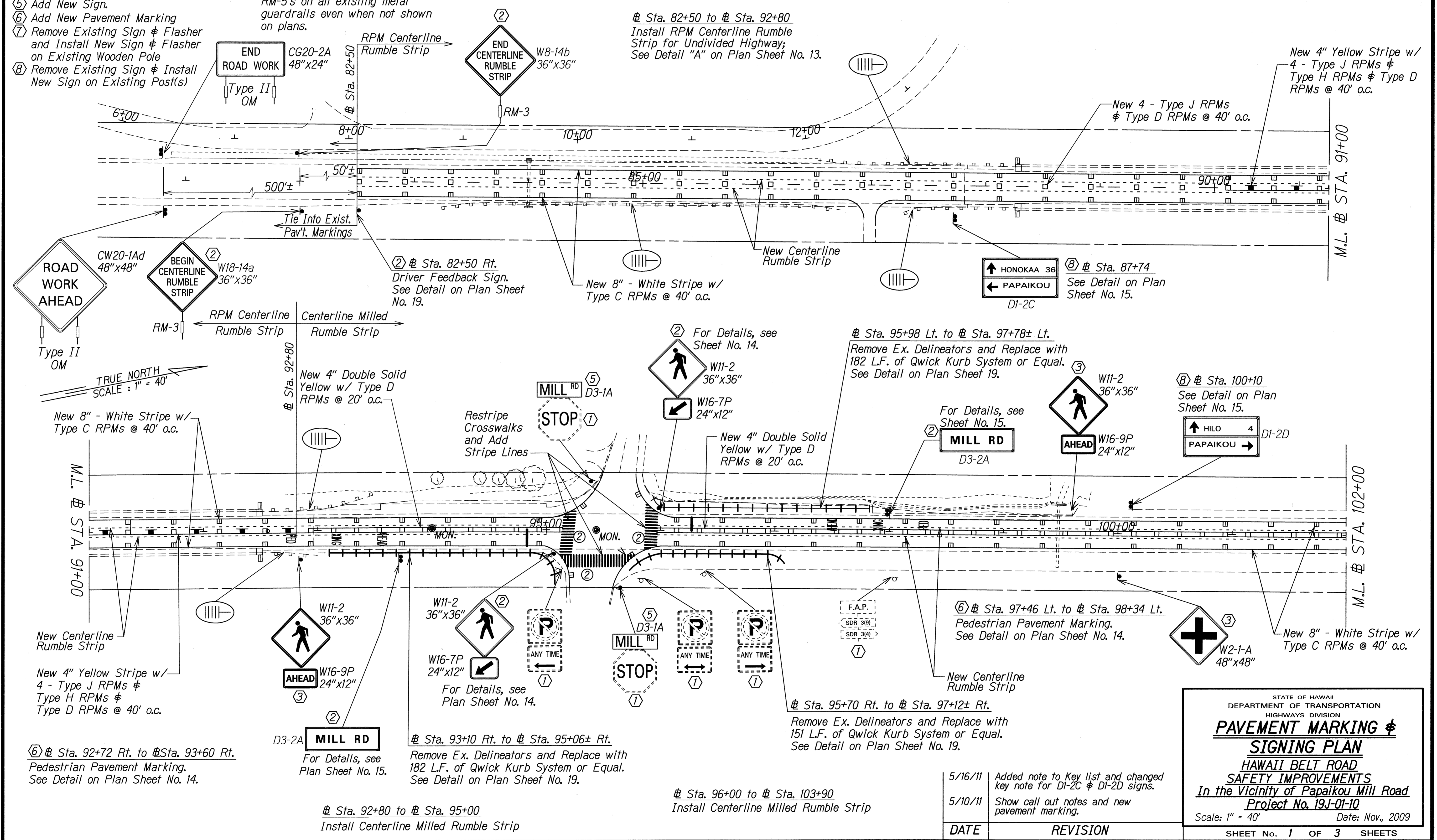
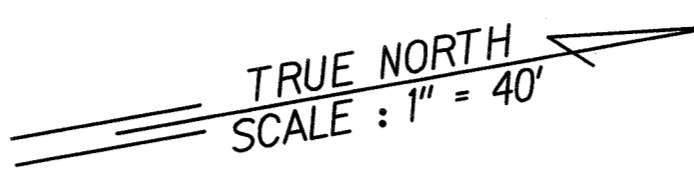

SURVEY PLOTTED BY	DATE
DESIGNED BY	
FRACED BY	
DESIGNED BY	
QUANTITIES BY	
CHECKED BY	

STATE OF HAWAII  
DEPARTMENT OF TRANSPORTATION  
HIGHWAYS DIVISION

**PAVEMENT MARKING & SIGNING PLAN**

**HAWAII BELT ROAD SAFETY IMPROVEMENTS**

**In the Vicinity of Papaikou Mill Road**

Project No. 19J-01-10

Scale: 1" = 40' Date: Nov., 2009

SHEET No. 1 OF 3 SHEETS

DATE	REVISION
5/16/11	Added note to Key list and changed key note for DI-2C & DI-2D signs.
5/10/11	Show call out notes and new pavement marking.

FED. ROAD DIST. NO.	STATE	PROJ. NO.	FISCAL YEAR	SHEET NO.	TOTAL SHEETS
HAWAII	HAW.	19J-01-10	2010	12	25

Sta. 96+00 to Sta. 103+90  
Install Centerline Milled Rumble Strip

Sta. 105+00 to Sta. 4+40  
Install Centerline Milled Rumble Strip

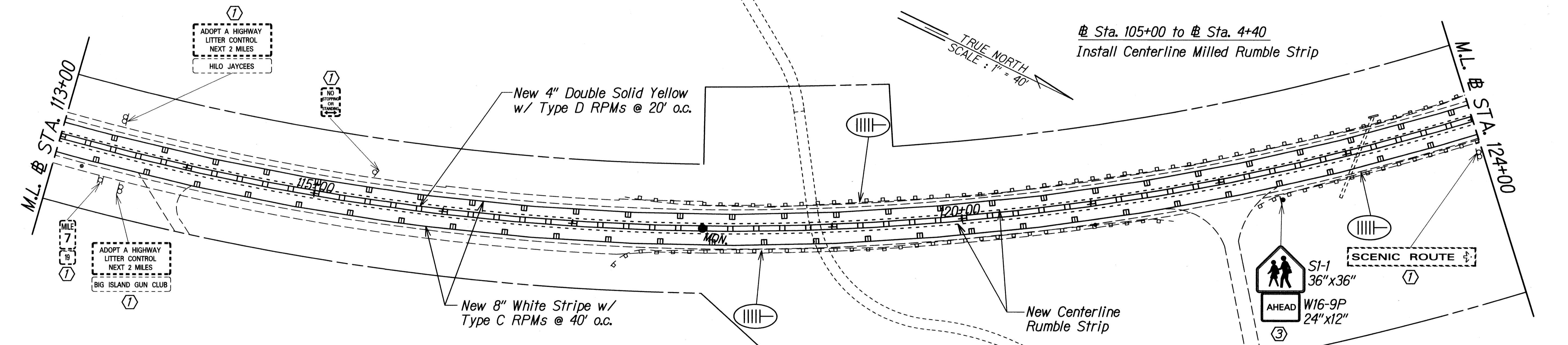
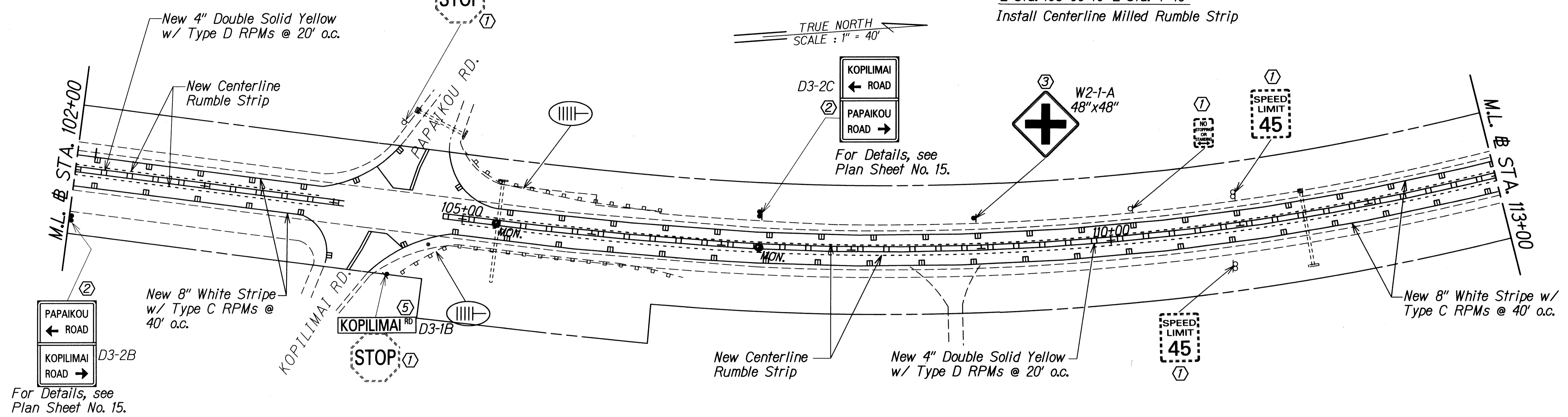

- KEY:**
- ① Exist. Sign & Post to Remain.
  - ② Install New Sign with Post.
  - ③ Remove Existing Sign & Post and Install New Sign & Post.
  - ④ Remove Existing Sign and Replace with New Sign.
  - ⑤ Add New Sign.
  - ⑥ Add New Pavement Marking
  - ⑦ Remove Existing Sign & Flasher and Install New Sign & Flasher on Existing Wooden Pole

Ⓜ Reflecter Markers (RM-5) shall be mounted every 25 feet on all existing metal guardrails except on terminal sections. For details, see Plan Sheet No. 22. Unless otherwise noted, the Contractor shall be responsible for mounting RM-5's on all existing metal guardrails even when not shown on plans.

SURVEY PLOTTED BY	DATE
DRAWN BY	
TRACED BY	
QUANTITIES BY	
CHECKED BY	
ORIGINAL PLAN	
NOTE BOOK	
FILE NO.	
DATE	

STATE OF HAWAII  
DEPARTMENT OF TRANSPORTATION  
HIGHWAYS DIVISION

**PAVEMENT MARKING & SIGNING PLAN**

**HAWAII BELT ROAD SAFETY IMPROVEMENTS**  
In the Vicinity of Papaikou Mill Road  
Project No. 19J-01-10

Scale: 1" = 40'      Date: Nov., 2009

SHEET No. 2 OF 3 SHEETS

FED. ROAD DIST. NO.	STATE	PROJ. NO.	FISCAL YEAR	SHEET NO.	TOTAL SHEETS
HAWAII	HAW.	19J-01-10	2010	ADD. 13	25

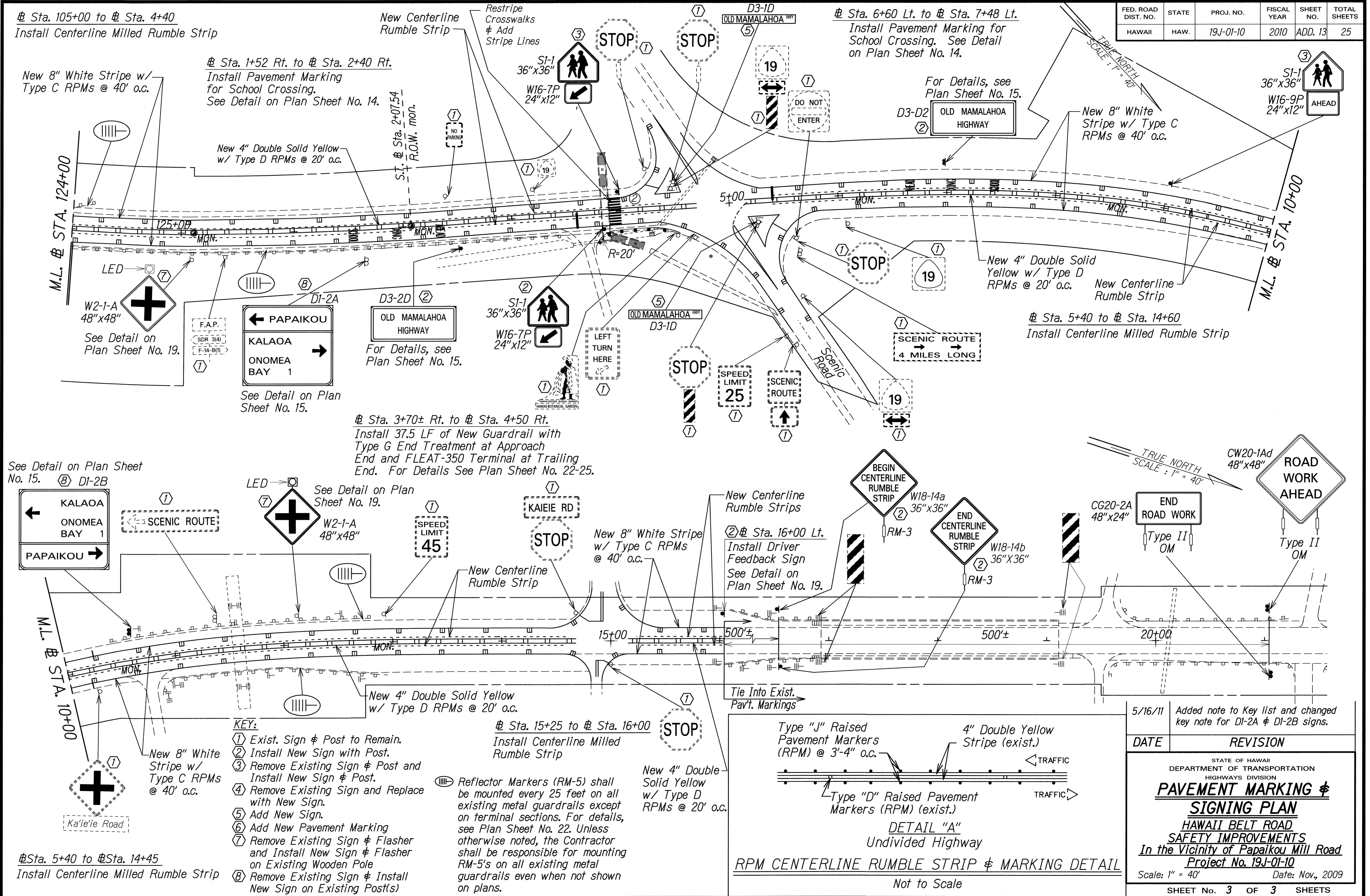

See Detail on Plan Sheet No. 15. (B) DI-2B

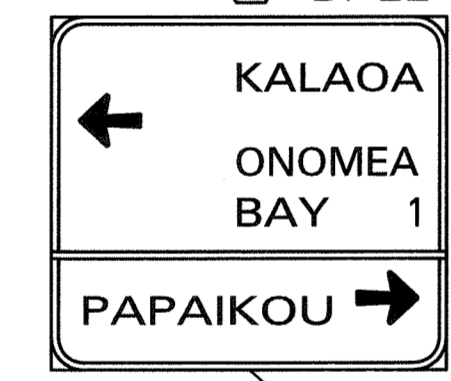

M.L. STA. 10+00

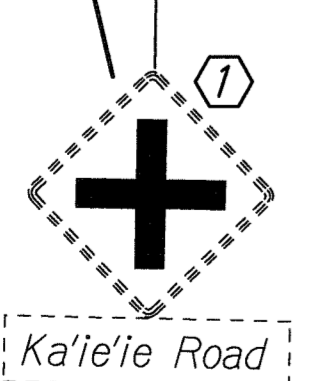

#Sta. 5+40 to #Sta. 14+45  
Install Centerline Milled Rumble Strip

- KEY:**
- ① Exist. Sign & Post to Remain.
  - ② Install New Sign with Post.
  - ③ Remove Existing Sign & Post and Install New Sign & Post.
  - ④ Remove Existing Sign and Replace with New Sign.
  - ⑤ Add New Sign.
  - ⑥ Add New Pavement Marking
  - ⑦ Remove Existing Sign & Flasher and Install New Sign & Flasher on Existing Wooden Pole
  - ⑧ Remove Existing Sign & Install New Sign on Existing Post(s)

Ⓜ Reflector Markers (RM-5) shall be mounted every 25 feet on all existing metal guardrails except on terminal sections. For details, see Plan Sheet No. 22. Unless otherwise noted, the Contractor shall be responsible for mounting RM-5's on all existing metal guardrails even when not shown on plans.

#Sta. 15+25 to #Sta. 16+00  
Install Centerline Milled Rumble Strip

#Sta. 16+00 Lt.  
Install Driver Feedback Sign  
See Detail on Plan Sheet No. 19.

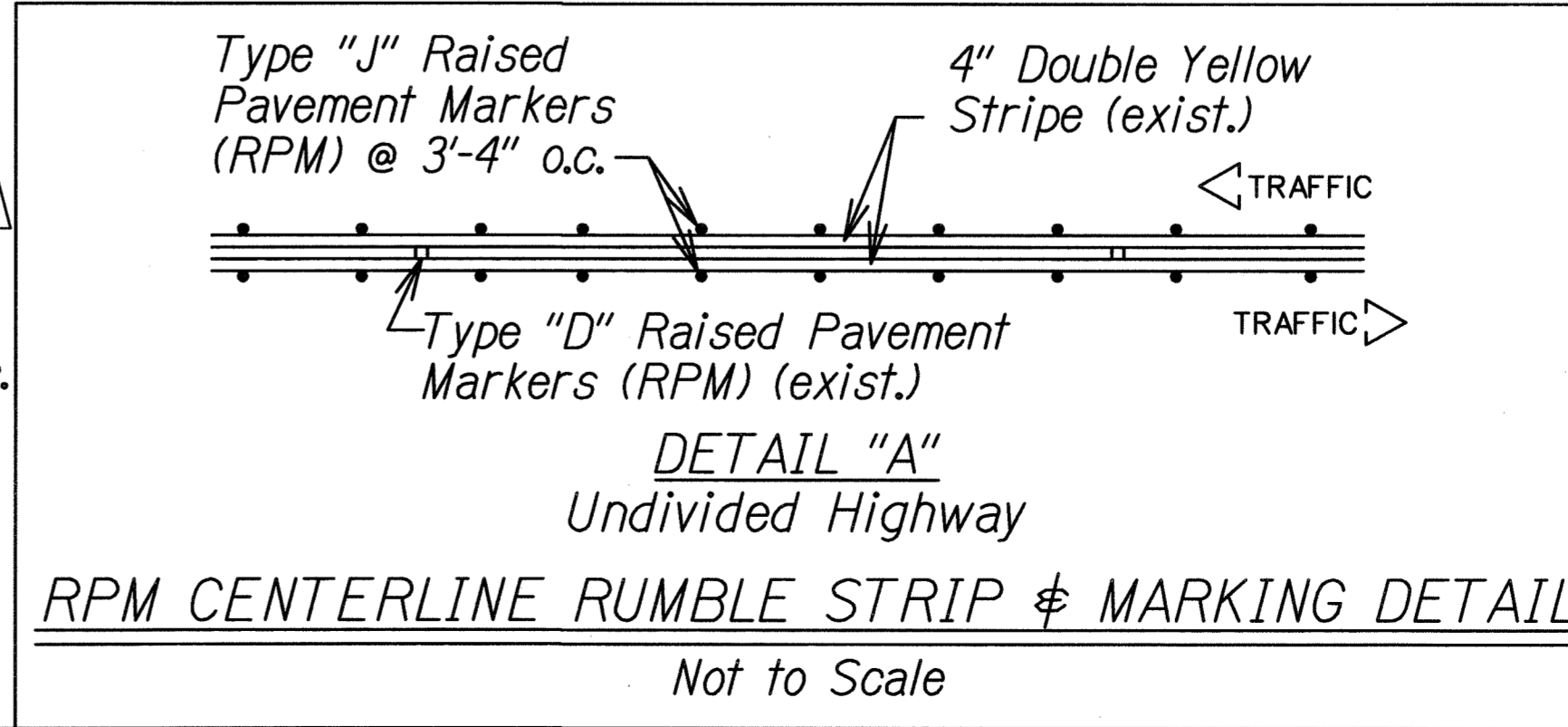

5/16/11	Added note to Key list and changed key note for DI-2A & DI-2B signs.
DATE	REVISION
STATE OF HAWAII DEPARTMENT OF TRANSPORTATION HIGHWAYS DIVISION	
<b>PAVEMENT MARKING &amp; SIGNING PLAN</b>	
<b>HAWAII BELT ROAD SAFETY IMPROVEMENTS</b>	
<b>In the Vicinity of Papaikou Mill Road</b>	
<b>Project No. 19J-01-10</b>	
Scale: 1" = 40'	Date: Nov., 2009
SHEET No. 3 OF 3 SHEETS	

DESIGNED BY	DATE
DRAWN BY	
TRACED BY	
NOTE BOOK	
QUANTITIES BY	
CHECKED BY	