

FED. ROAD DIST. NO.	STATE	FED. AID PROJ. NO.	FISCAL YEAR	SHEET NO.	TOTAL SHEETS
HAWAII	HAW.	HSIP-019-1(41)	2018	43	43

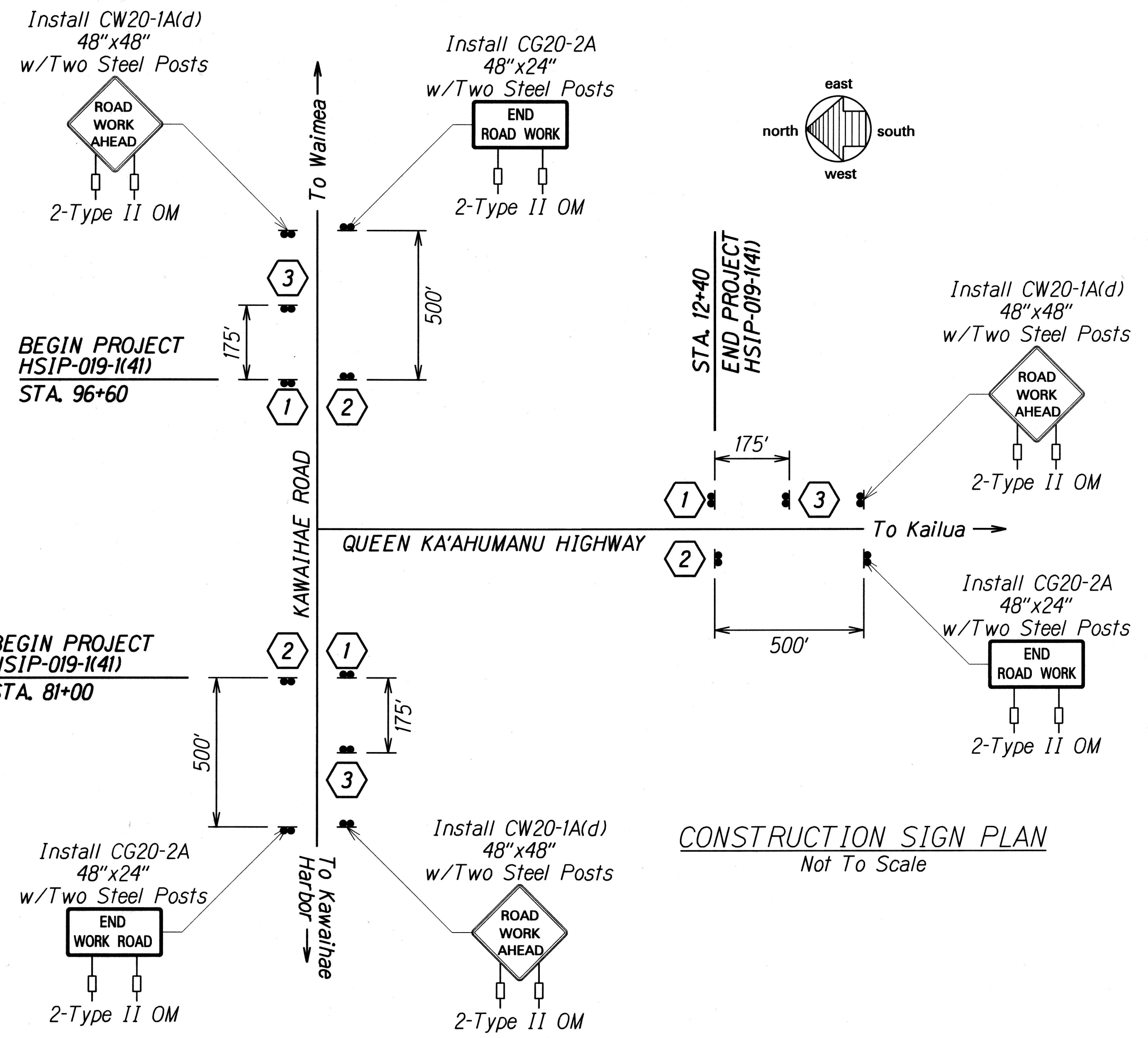

CONSTRUCTION SIGN PLAN  
Not To Scale

Work Zone Speed Limit Sign Assembly Key:

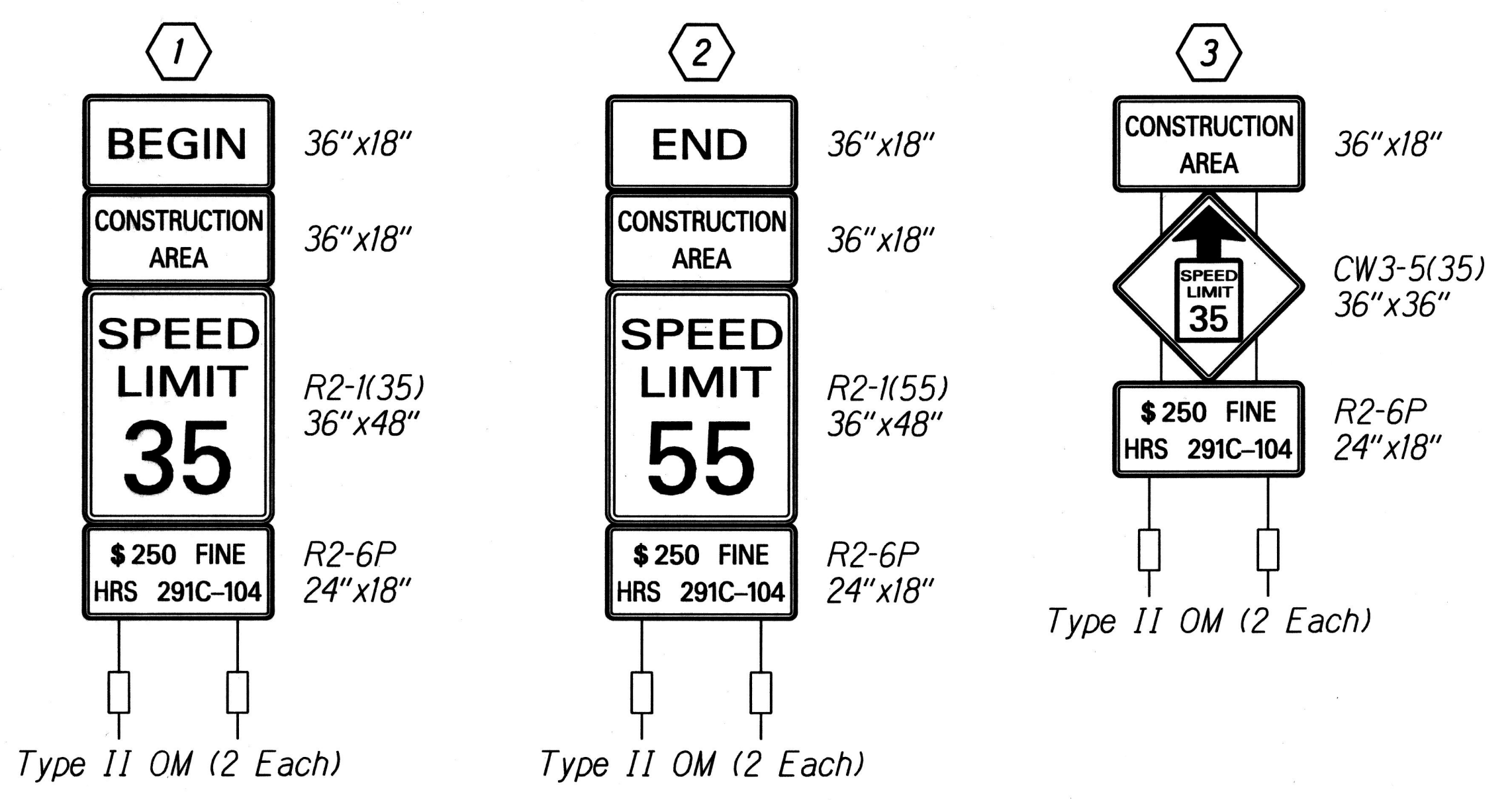

Work Zone Notes:

1. This Work Zone Sign Plan is intended for use on long-term stationary work zones/construction phases (3 days or more). All work zones or construction phases less than 3 days duration will use Traffic Control Plans shown in Section 645 of the Hawaii Standard Specifications for Road and Bridge Construction.
2. All existing regulatory speed limit signs with posts within the work zone limits shall be removed and replaced with work zone speed limit sign assemblies (R2-1(XX) and R2-5b(XX) with "CONSTRUCTION AREA" and "\$250 FINE HRS 291C-104" Supplemental Signs).
3. Construction sign assemblies shall be installed on both the approaching and trailing ends of each work zone as shown on this plan.
4. Each construction warning sign and work zone speed limit assembly shall have a minimum of two (2) Type II OM. Installation of each Type II OM shall be considered incidental to Item No. 645.1000 Traffic Control (including Work Zone Signs and Posts).
5. Upon the completion of all physical work or as directed by the Engineer, all construction signs and work zone speed limit assemblies shall be removed. All speed limit signs and posts that were existing at the start of the project within the work zone limits shall be restored back to their original locations and configurations.
6. Placement of construction signs shall not obstruct the path of pedestrians and bicyclists.
7. The removal and restoration of existing regulatory speed limit signs with new posts along with the installation, maintenance and removal of work zone speed limit sign assemblies shall be considered incidental to Item No. 645.1000 Traffic Control (including Work Zone Signs and Posts).

CONSTRUCTION SIGN SCHEDULE

PROJECT NO. (ROAD)	CENTERLINE STATION	LEFT	RIGHT	Item No. 621.7121 (No Posts)	Item No. 621.7120 (Two Posts)	Remarks
FAP 11-B (Kawaihae Road)	76+00	●			CG20-2A	
	76+00		●		CW20-1A(d)	
	79+25		●	"CONSTRUCTION AREA", R2-6P	CW3-5(35)	Assembly - ③
	81+00	●		M4-12, "CONSTRUCTION AREA", R2-6P	R2-1(55)	Assembly - ②
	81+00		●	M4-11, "CONSTRUCTION AREA", R2-6P	R2-1(35)	Assembly - ①
	96+60	●		M4-11, "CONSTRUCTION AREA", R2-6P	R2-1(35)	Assembly - ①
	96+60		●	M4-12, "CONSTRUCTION AREA", R2-6P	R2-1(55)	Assembly - ②
	98+35	●		"CONSTRUCTION AREA", R2-6P	CW3-5(35)	Assembly - ③
	101+60	●			CW20-1A(d)	
	101+60		●		CG20-2A	
G-3257-01-60 (Queen Ka'ahumanu Highway)	12+40	●		M4-11, "CONSTRUCTION AREA", R2-6P	R2-1(35)	Assembly - ①
	12+40		●	M4-12, "CONSTRUCTION AREA", R2-6P	R2-1(55)	Assembly - ②
	14+15	●		"CONSTRUCTION AREA", R2-6P	CW3-5(35)	Assembly - ③
	17+40	●			CW20-1A(d)	
	17+40		●		CG20-2A	
Total Construction Signs				24	15	

Note:  
Final locations of all signs to be determined in the field by the Engineer.

STATE OF HAWAII  
DEPARTMENT OF TRANSPORTATION  
HIGHWAYS DIVISION  
**WORK ZONE SIGNING PLAN,**  
**NOTES & DETAILS**  
QUEEN KA'AHUMANU HIGHWAY  
INTERSECTION IMPROVEMENTS  
AT KAWAIHAE ROAD  
Federal-Aid Project No. HSIP-019-1(41)  
Scale: Not To Scale Date: Sept., 2017  
SHEET No. 1 OF 1 SHEETS

DATE: \_\_\_\_\_  
SURVEY PLANNED BY: \_\_\_\_\_  
DRAWN BY: \_\_\_\_\_  
NOTE BOOK DESIGNED BY: \_\_\_\_\_  
CHECKED BY: \_\_\_\_\_  
ORIGINAL PLAN: \_\_\_\_\_  
DATE: \_\_\_\_\_