

FED. ROAD DIST. NO.	STATE	PROJ. NO.	FISCAL YEAR	SHEET NO.	TOTAL SHEETS
HAWAII	HAW	19FGH-01-07M	2008	21	51



Photo 1

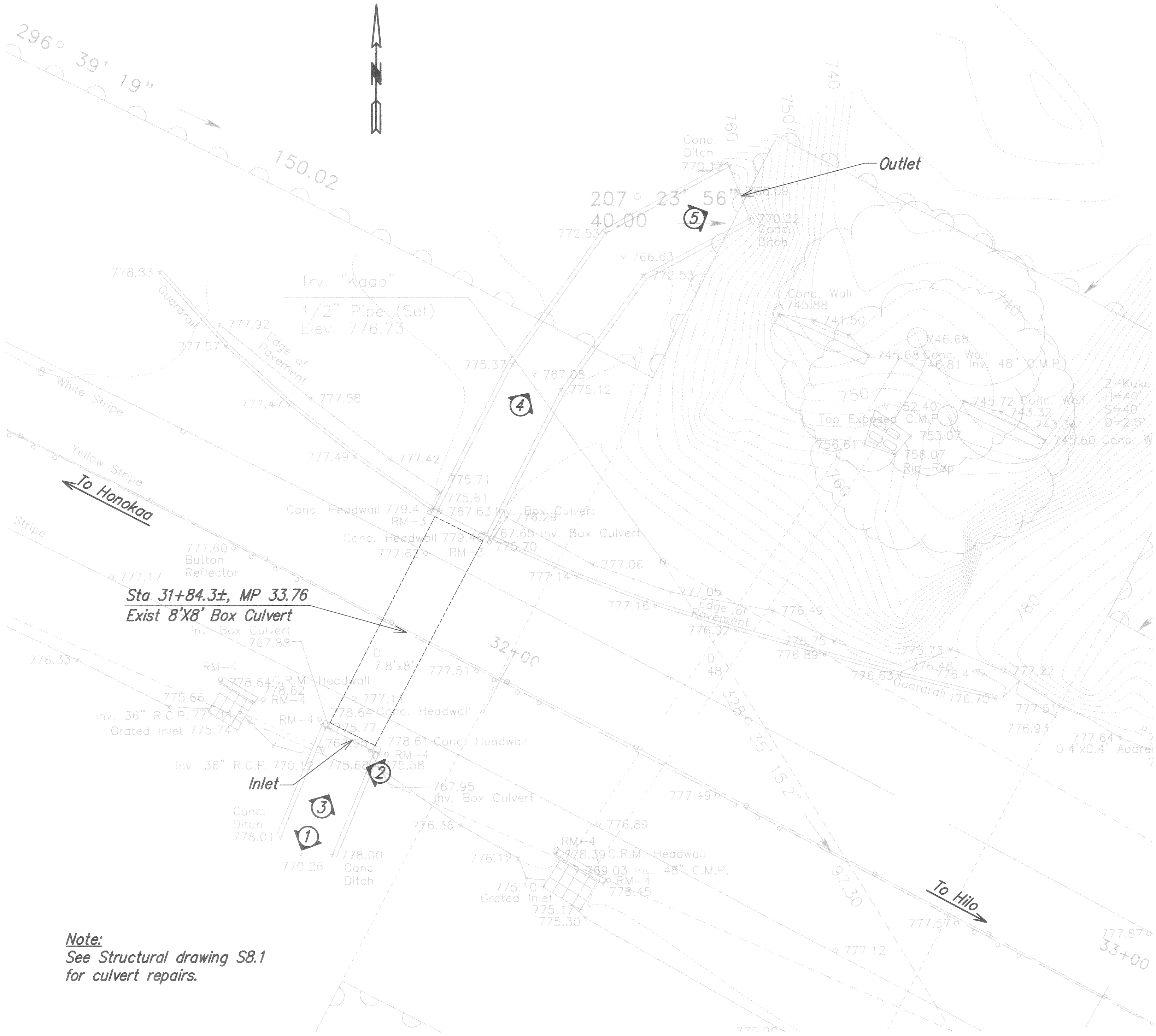

Photo 2



Photo 3

PHOTO NOTE:
Photographs are only for identifying the worksite. The Contractor shall perform his/her own site inspection to verify the existing site conditions that he/she may encounter during construction.



Note:
See Structural drawing S8.1 for culvert repairs.

SITE PLAN
Scale: 1"=10'



Photo 4



Photo 5

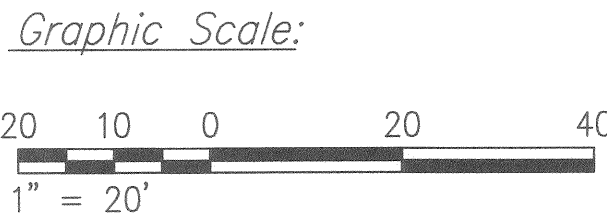
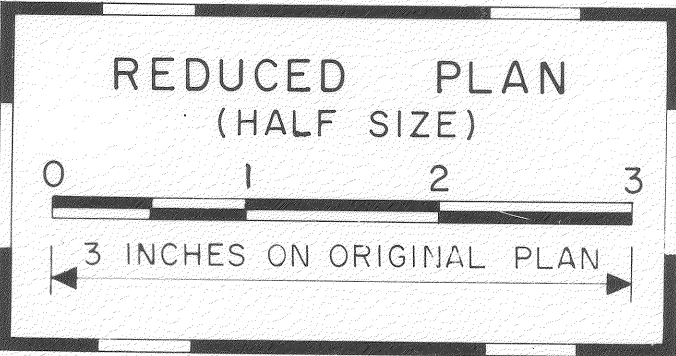

EarthTech
A Tyco International Ltd. Company

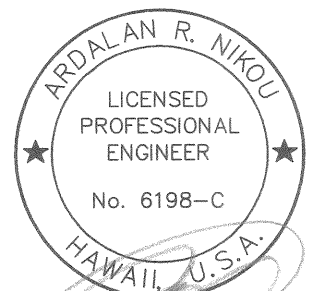

EXPIRATION DATE OF THE LICENSE 4/30/2008
THIS WORK WAS PREPARED BY
ME OR UNDER MY SUPERVISION.

STATE OF HAWAII
DEPARTMENT OF TRANSPORTATION
HIGHWAYS DIVISION

MILE POST 33.76
SITE IMPROVEMENTS
HAWAII BELT ROAD DRAINAGE
IMPROVEMENTS
Project No. 19FGH-01-07M

Scale: 1"=10' Date: April 2007

SHEET No. C12.1 OF 1 SHEETS