

FED. ROAD DIST. NO.	STATE	FED. AID PROJ. NO.	FISCAL YEAR	SHEET NO.	TOTAL SHEETS
HAWAII	HAW.	NH-019-11(37)	2007	37	47

LEGEND

- 4 each Type A Raised Pavement Markers
Type C Raised Pavement Markers @ 40'-0" o.c.
- 4 each Type J Raised Pavement Markers
Type D Raised Pavement Markers @ 40'-0" o.c.
- 8" White Stripe with Type C Raised Pavement Markers @ 20'-0" o.c. (Tape, Type I or Thermoplastic Extrusion)
- 4" Double Solid Yellow with Type D Raised Pavement Markers @ 20'-0" o.c. (Tape, Type I or Thermoplastic Extrusion))
- 4" Double Solid Yellow Stripes with Type H Raised Pavement Markers @ 20'-0" o.c. (Tape, Type II or Thermoplastic Extrusion))
- 4" Yellow Edge Stripe with Type H Raised Pavement Markers @ 40'-0" o.c. (Tape, Type II or Thermoplastic Extrusion))
- 4" Double Solid White Stripes with Type C Raised Pavement Markers @ 20'-0" o.c. (Tape, Type I or Thermoplastic Extrusion)
- Lane Change Restriction Marking
4 each Type A Raised Pavement Markers
Type C Raised Pavement Markers @ 20'-0" o.c.
4" White Stripe (Tape, Type I or Thermoplastic Extrusion)
- 4" or 8" White Edge Stripe with Type C Raised Pavement Markers @ 40'-0" o.c. (Tape, Type II or Thermoplastic Extrusion)
- 4" White Guide Lines (Tape, Type III or Thermoplastic Extrusion except for bus bays)
- Transverse Median Marking (Tape, Type II or Thermoplastic Extrusion)
- Transverse Shoulder Marking (Tape, Type II or Thermoplastic Extrusion)
- Channelizing Island or Deceleration Lane Gore (Tape, Type II or Thermoplastic Extrusion)
- ②
Crosswalk and Stop Line. All Stop Lines shall be 10'-0" from Crosswalk unless otherwise noted. The circled number indicates the number of lanes for payment (Tape, Type III or Thermoplastic Extrusion)
- ↖
Pavement Arrow (Tape, Type III or Thermoplastic Extrusion)
- STOP
Pavement Word (Tape, Type III or Thermoplastic Extrusion)
- 4 Each Type J Raised Pavement Markers
Type D Raised Pavement Markers @ 40'-0" o.c.
Type H Raised Pavement Markers (Reflective Surface facing no-passing direction)
4" Single Solid Yellow Stripe (Tape, Type I or Thermoplastic Extrusion)
- Extension of Edge Line, 4" Wide x 2'-0" Long White Stripe @ 10'-0" o.c. w/Type C Markers @ 40'-0" o.c. (Tape, Type III or Thermoplastic Extrusion)

NOTES

- Layout of pavement markings and striping shall be done by the Contractor and approved by the Engineer prior to any installation work.
- Existing pavement markings not incorporated in the final traffic pattern shall be removed as directed by the Engineer. Costs shall be incidental to the various pavement marking items.
- Raised pavement markers shall not be installed within crosswalks.
- Final locations of all signs shall be approved by the Engineer prior to any installation work.
- Existing signs not shown on these plans shall remain as posted unless otherwise directed by the Engineer. Removal and disposal of existing signs and/or posts as designated on these plans shall be incidental to the various signing items.
- Final locations of all Stop Lines shall be approved by the Engineer prior to installation.
- All pavement striping shall be as noted on the legend or plans.
- All preformed pavement marking tapes over existing pavement shall be applied with an approved primer as recommended by the tape manufacturer and as approved by the Engineer. The primer shall be allowed to dry to the tacky stage prior to tape application.
- All pedestrian warning signs with supplemental sign shall be on a fluorescent yellow-green retroreflective background with a black legend and border.

LEGEND:

- SW Reflector Marker (RM-2, White) w/ steel post
- FW Reflector Marker (RM-2, White) w/ flexible post

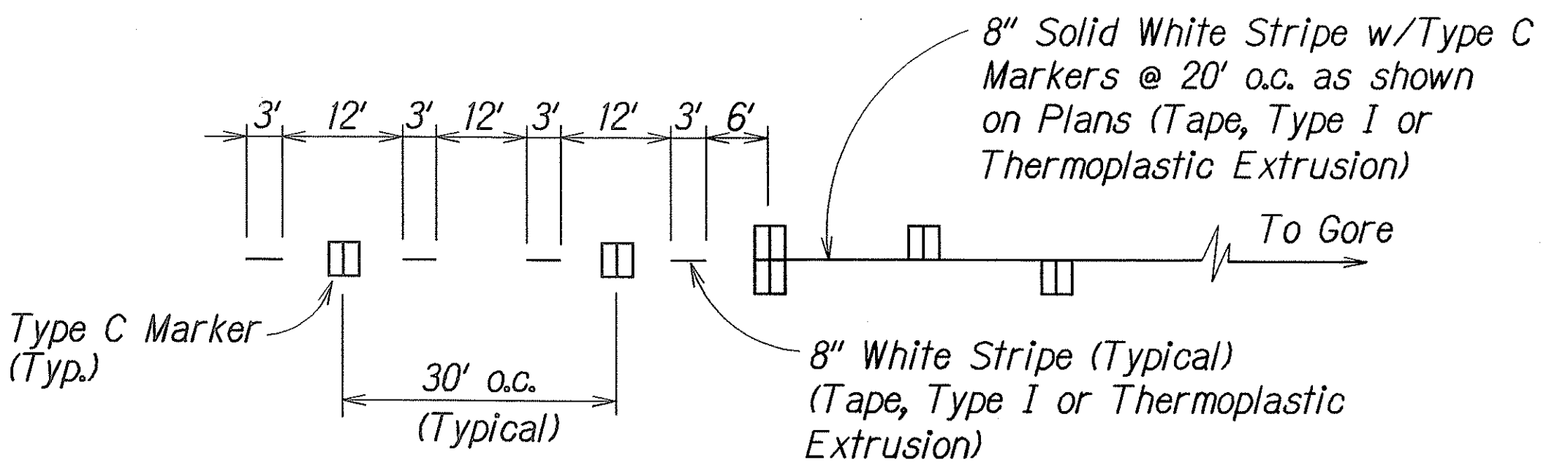
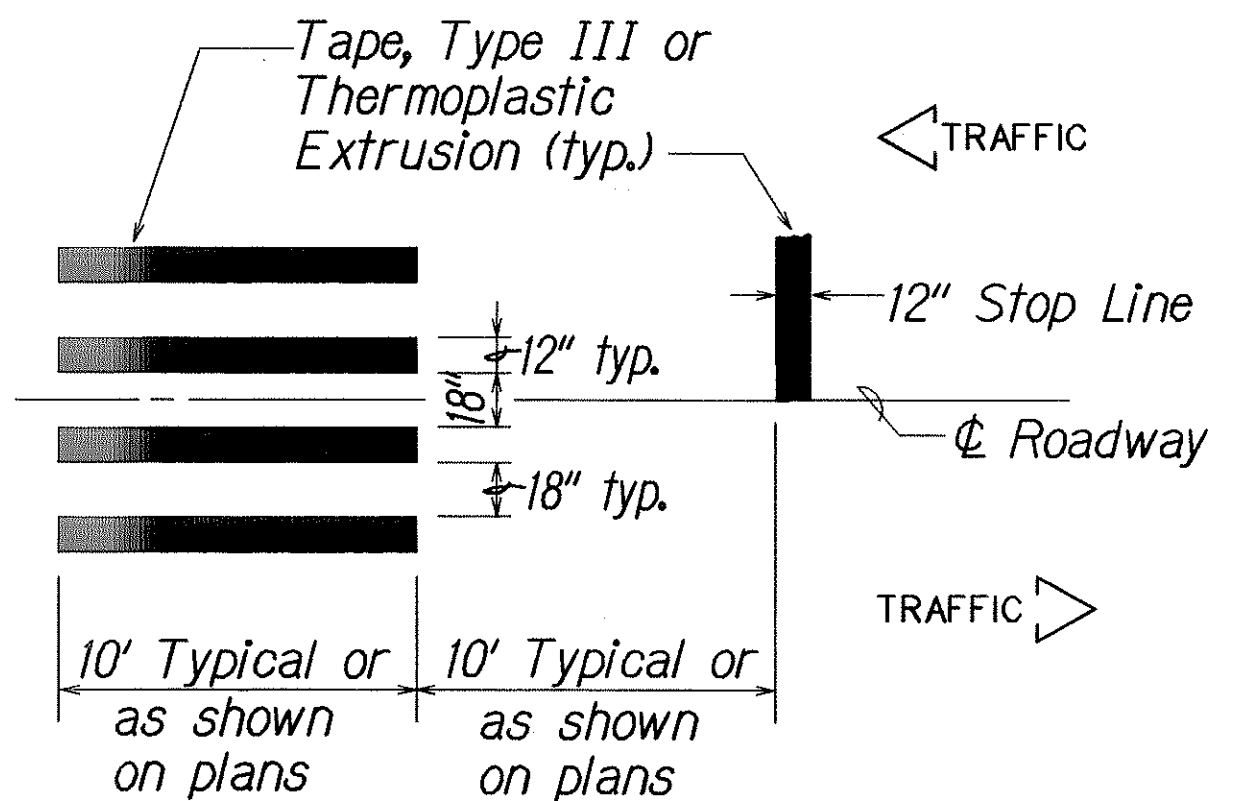
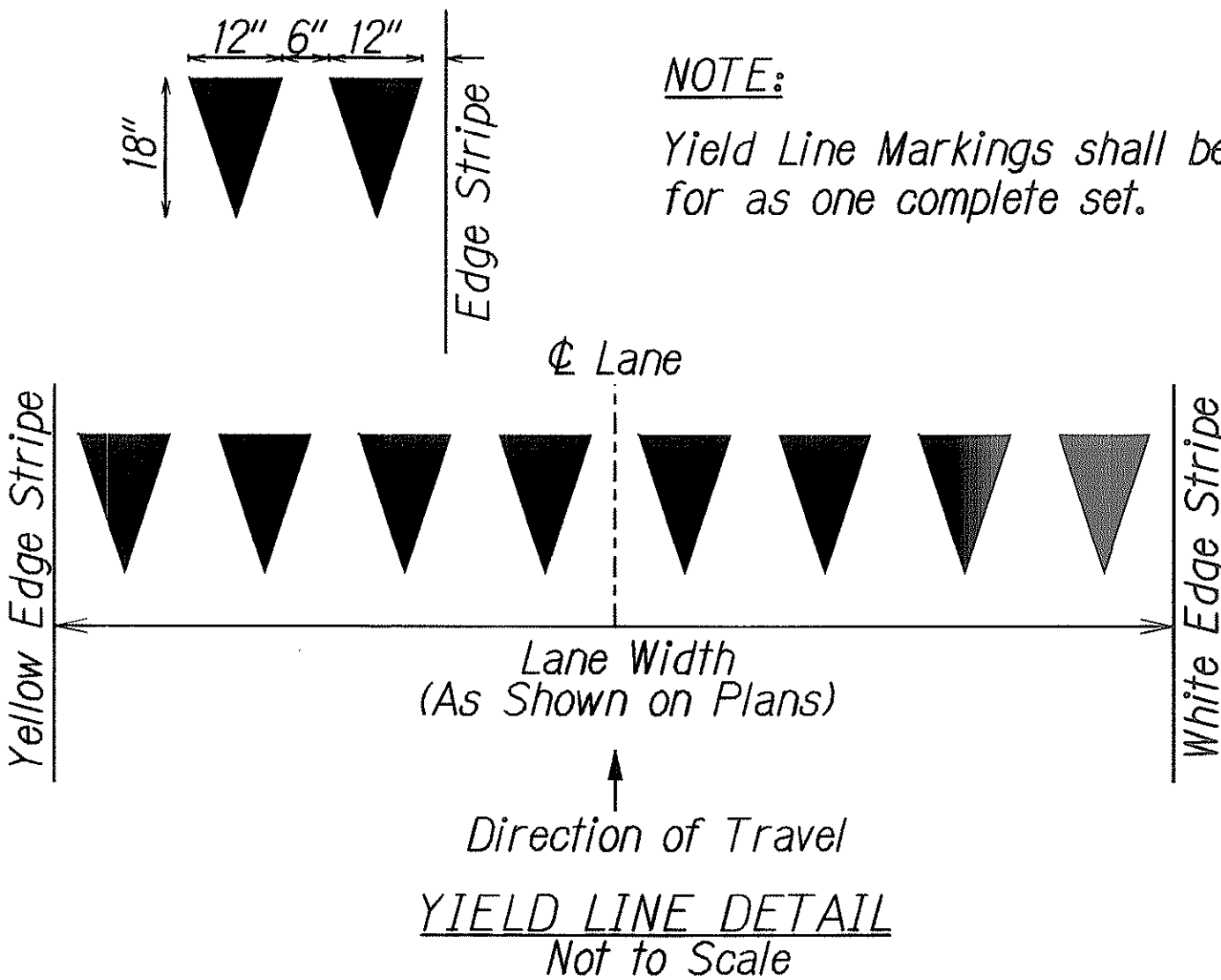

STATE OF HAWAII
DEPARTMENT OF TRANSPORTATION
HIGHWAYS DIVISION
PAVEMENT MARKING
LEGEND, DETAILS & NOTES
HAWAII BELT ROAD GUARDRAIL
& SHOULDER IMPROVEMENTS
Paauhau Road to Papalele Road and Various Locations
Federal Aid Project No. NH-019-11(37)
Scale: As Shown Date: August 2006
SHEET No. 71 OF 11 SHEETS

FED. ROAD DIST. NO.	STATE	FED. AID PROJ. NO.	FISCAL YEAR	SHEET NO.	TOTAL SHEETS
HAWAII	HAW.	NH-019-1(37)	2007	ADD.38	47

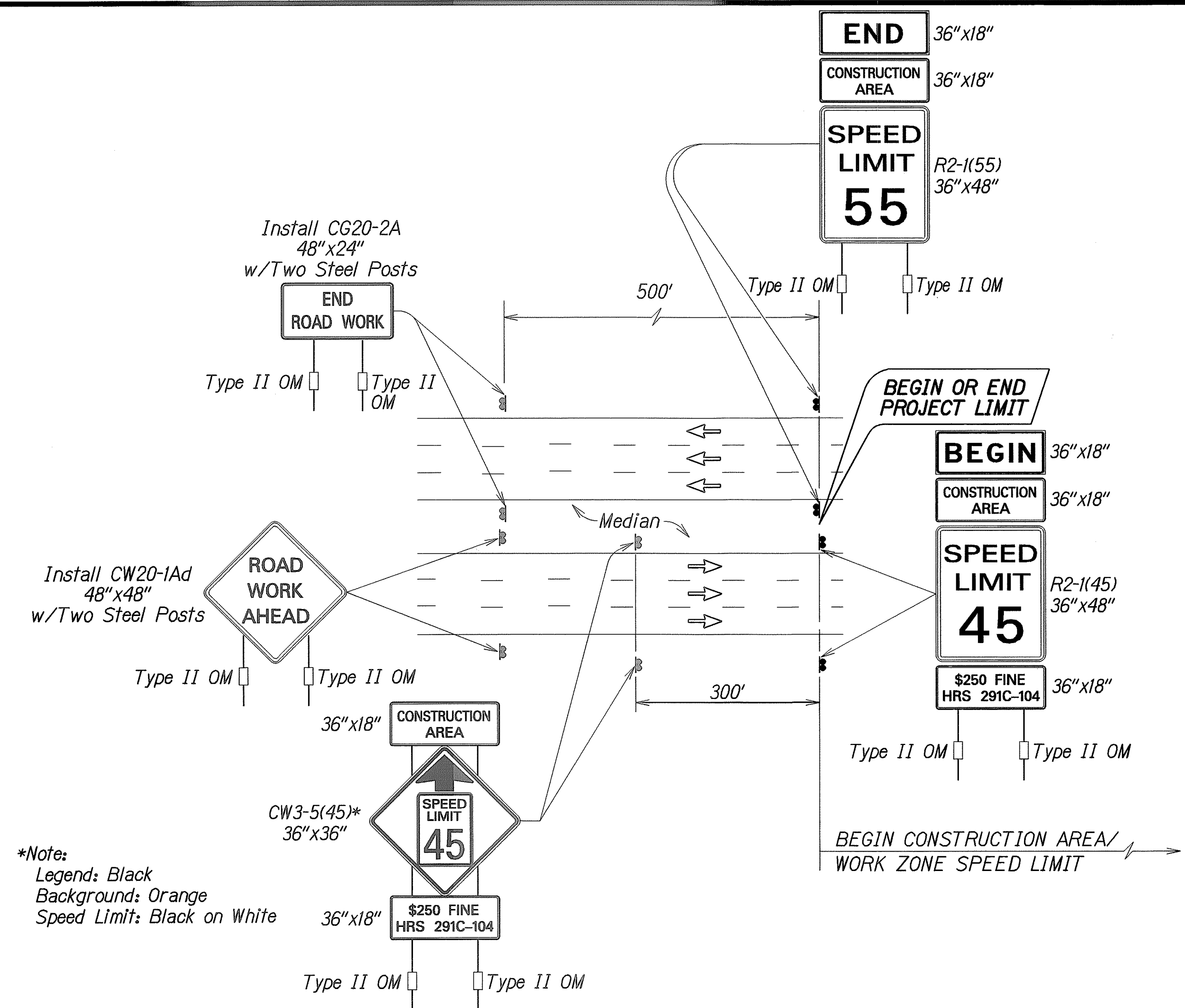

*Note:
Legend: Black
Background: Orange
Speed Limit: Black on White

TYPICAL DETAIL FOR CONSTRUCTION SIGNS
ON MULTILANE DIVIDED HIGH SPEED HIGHWAY

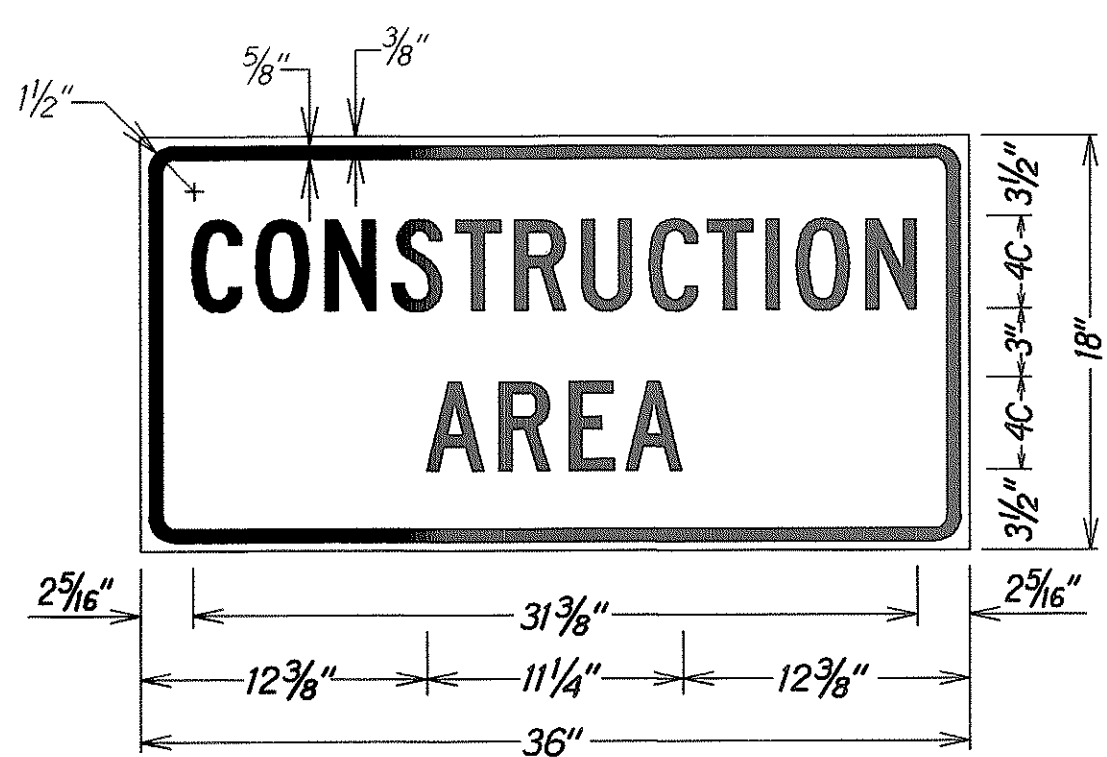

LEGEND: BLACK
BACKGROUND: ORANGE

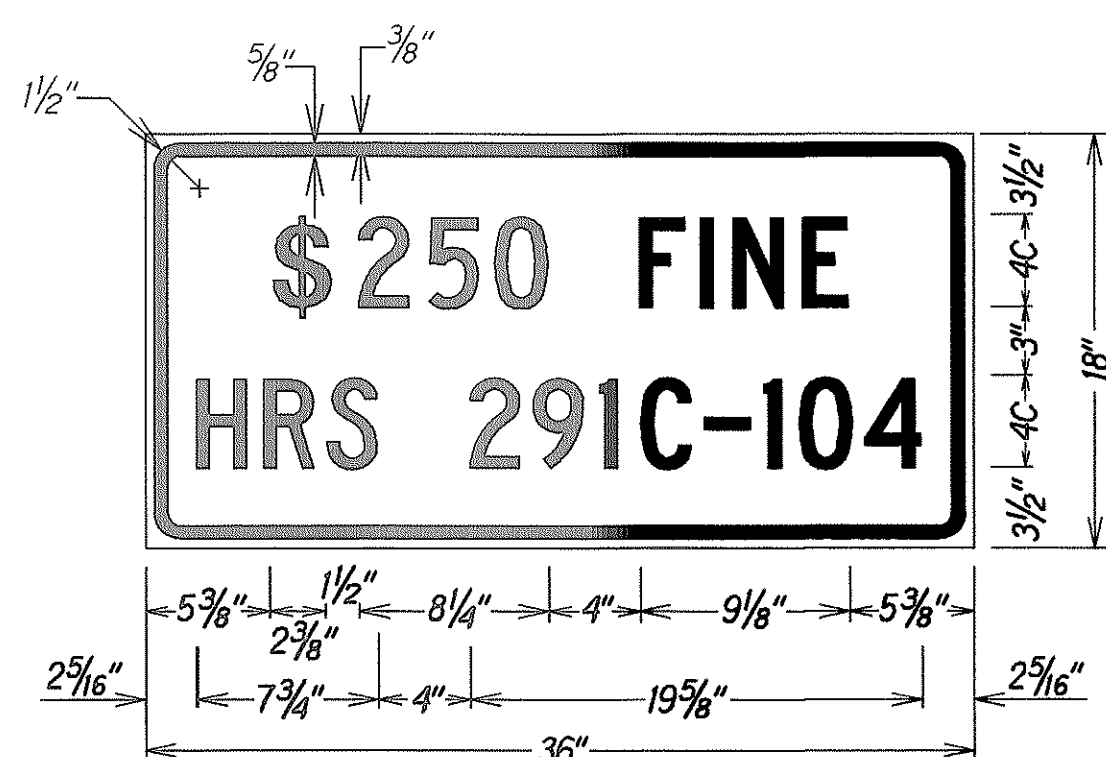

LEGEND: BLACK
BACKGROUND: WHITE

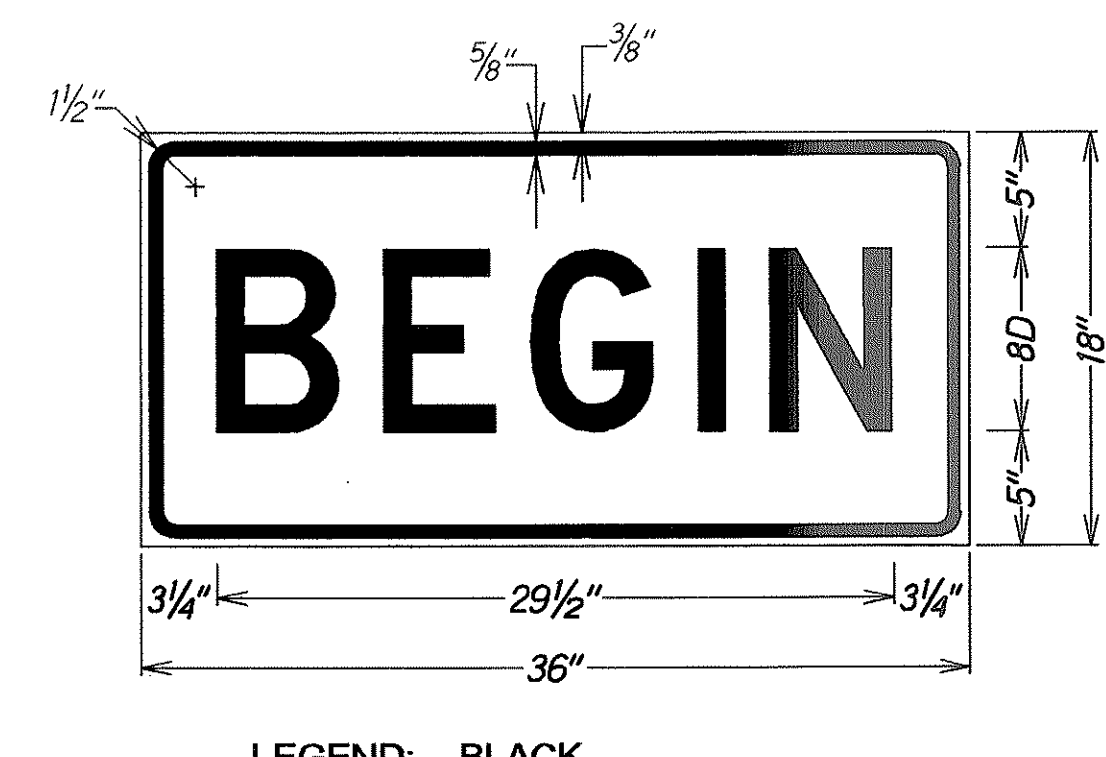

LEGEND: BLACK
BACKGROUND: ORANGE

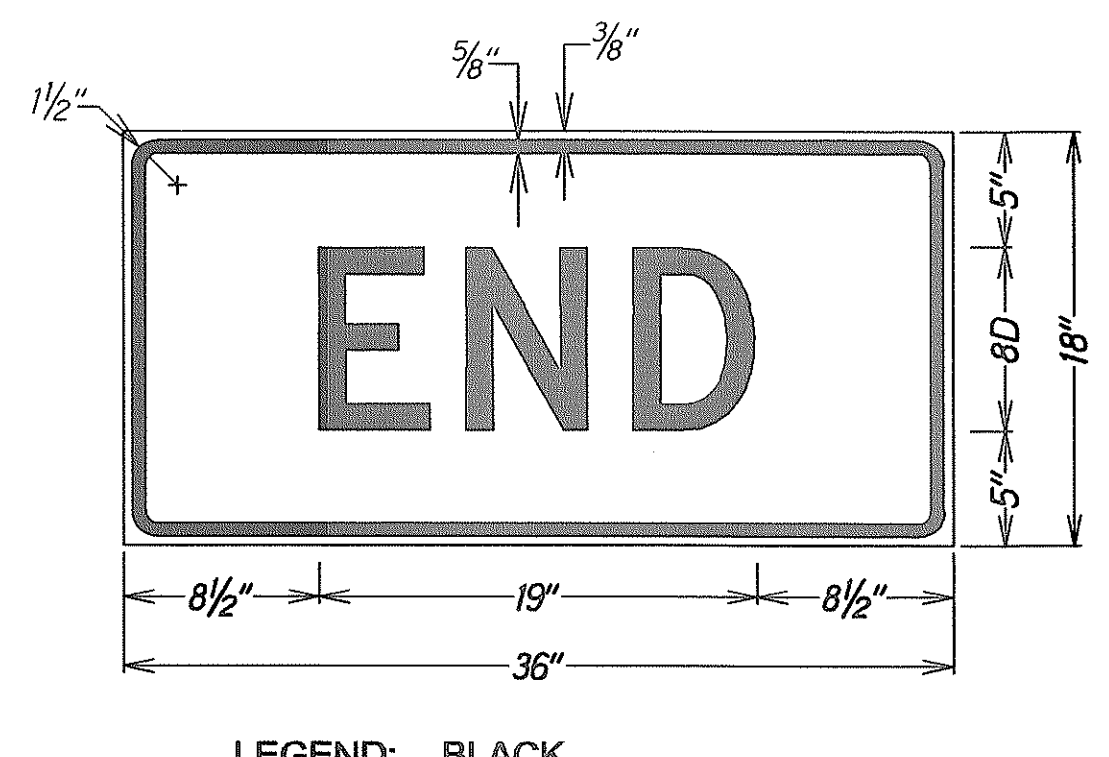

LEGEND: BLACK
BACKGROUND: ORANGE

Work Zone Note:

1. This Work Zone Sign Plan is intended for use on long-term stationary work zones/construction phases (3 days or more). All work zones or construction phases less than 3 days duration will use Traffic Control Plans shown in Section 645 of the Special Provisions.
2. All existing regulatory speed limit signs with posts within the work zone/project limits shall be removed and replaced with work zone speed limit sign assemblies (R2-1(45) and R2-5b(45) with "CONSTRUCTION AREA" and "\$250 FINE HRS 291C-104" Supplemental Signs).
3. Construction sign assemblies shall be installed on both the approaching and trailing ends of each work zone as shown on this plan.
4. Each construction warning sign and work zone speed limit assembly shall have a minimum of two (2) Type II OM. Installation of each Type II OM shall be considered incidental to Item No. 645.0100 - Traffic Control.
5. Upon the completion of all physical work or as directed by the Engineer, all construction signs and work zone speed limit assemblies shall be removed. All speed limit signs and posts that were existing at the start of the project within the work zone/project limits shall be restored back to their original locations and configurations.
6. Placement of construction signs shall not obstruct the path of pedestrians and bicyclists.
7. The removal and restoration of existing regulatory speed limit signs with new posts along with the installation, maintenance and removal of work zone speed limit sign assemblies shall be considered incidental to Item No. 645.0100 - Traffic Control.

4/26/07	Revised notes.
DATE	REVISION
STATE OF HAWAII DEPARTMENT OF TRANSPORTATION HIGHWAYS DIVISION HIGH SPEED DIVIDED HIGHWAY WORK ZONE SIGNING PLAN, NOTES&DETAILS HAWAII BELT ROAD Guardrail & Shoulder Improvements Pauhau Road to Papalele Road and Various Locations Federal Aid Project No. NH-019-1(37) Not To Scale Date: August 2006	
SHEET No. T2 OF 11 SHEETS	

FED. ROAD DIST. NO.	STATE	FED. AID PROJ. NO.	FISCAL YEAR	SHEET NO.	TOTAL SHEETS
HAWAII	HAW.	NH-019-1(37)	2007	ADD. 38S-1	47

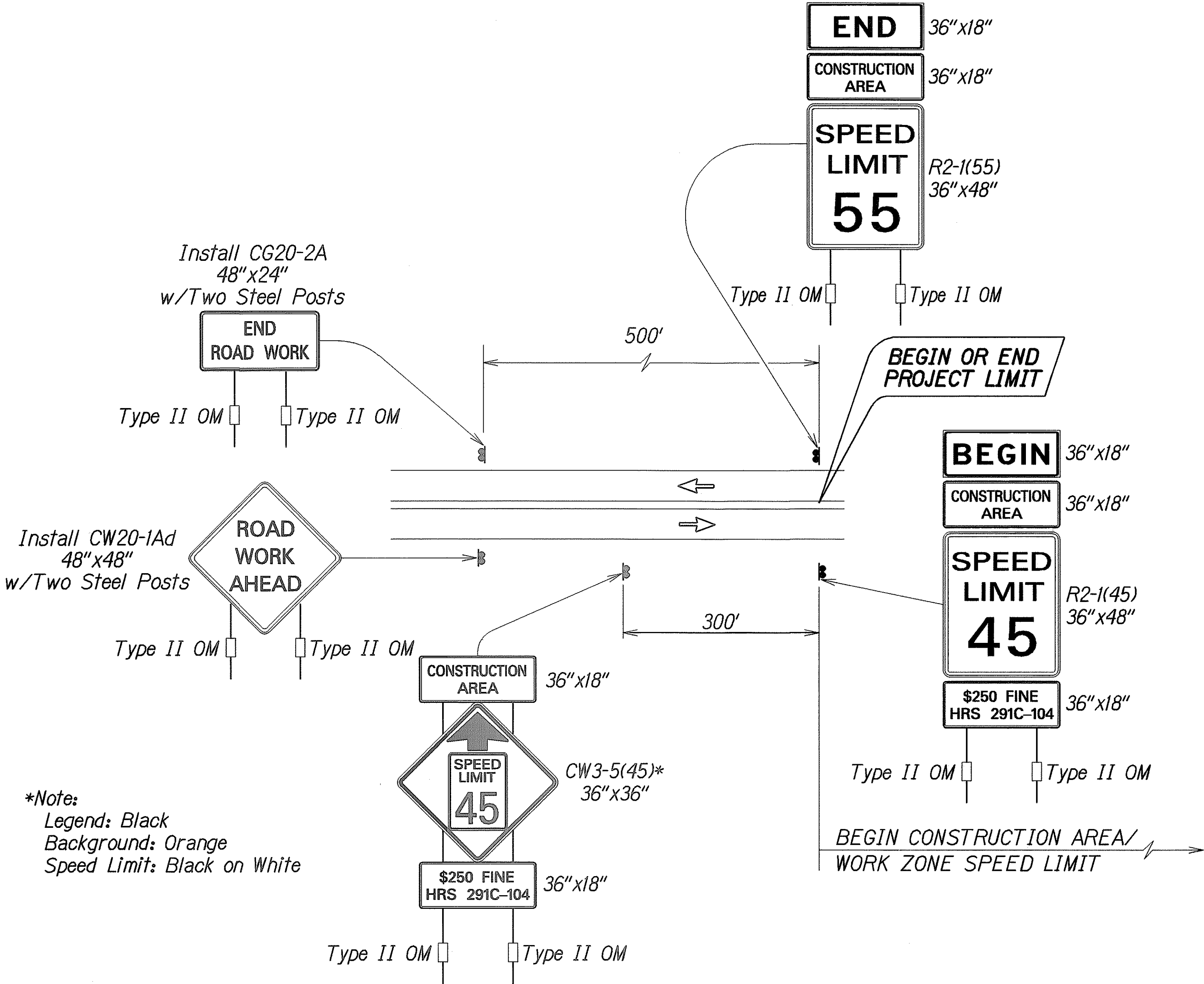

- Work Zone Note:**
1. This Work Zone Sign Plan is intended for use on long-term stationary work zones/construction phases (3 days or more). All work zones or construction phases less than 3 days duration will use Traffic Control Plans shown in Section 645 of the Special Provisions.
 2. All existing regulatory speed limit signs with posts within the work zone/project limits shall be removed and replaced with work zone speed limit sign assemblies (R2-1(45) and R2-5b(45) with "CONSTRUCTION AREA" and "\$250 FINE HRS 291C-104" Supplemental Signs).
 3. Construction sign assemblies shall be installed on both the approaching and trailing ends of each work zone as shown on this plan.
 4. Each construction warning sign and work zone speed limit assembly shall have a minimum of two (2) Type II OM. Installation of each Type II OM shall be considered incidental to Item No. 645.0100 - Traffic Control.
 5. Upon the completion of all physical work or as directed by the Engineer, all construction signs and work zone speed limit assemblies shall be removed. All speed limit signs and posts that were existing at the start of the project within the work zone/project limits shall be restored back to their original locations and configurations.
 6. Placement of construction signs shall not obstruct the path of pedestrians and bicyclists.
 7. The removal and restoration of existing regulatory speed limit signs with new posts along with the installation, maintenance and removal of work zone speed limit sign assemblies shall be considered incidental to Item No. 645.0100 - Traffic Control.

**TYPICAL DETAIL FOR CONSTRUCTION SIGNS
ON TWO LANE OR MULTILANE UNDIVIDED HIGH SPEED HIGHWAY**

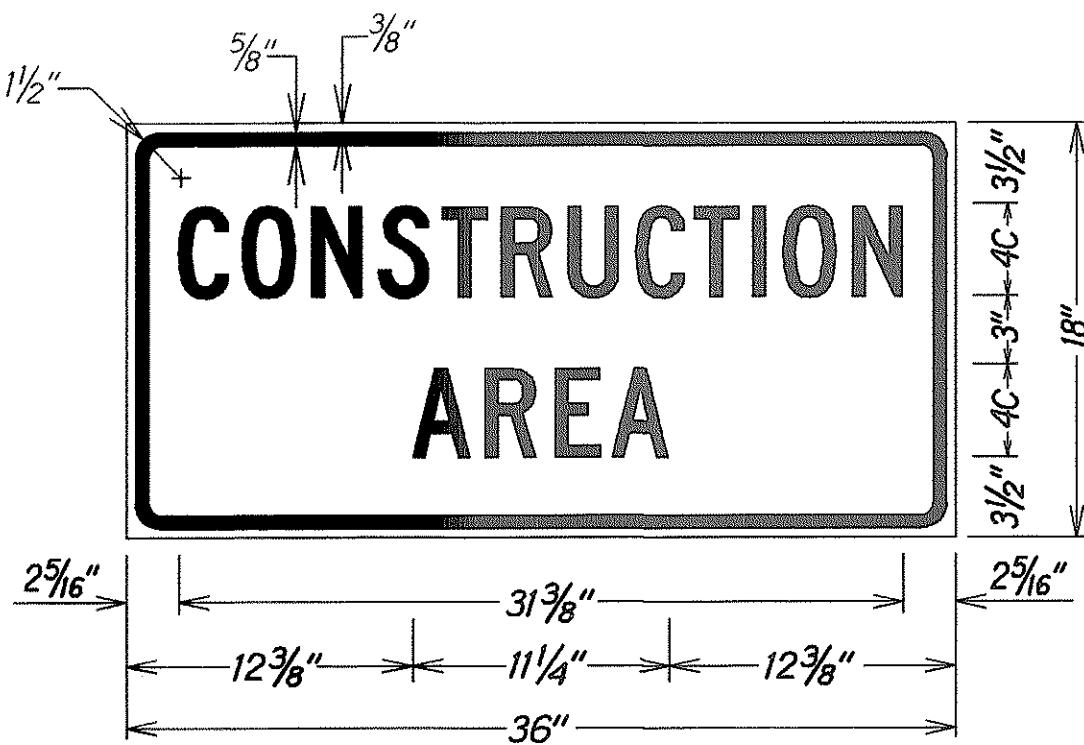

LEGEND: BLACK
BACKGROUND: ORANGE

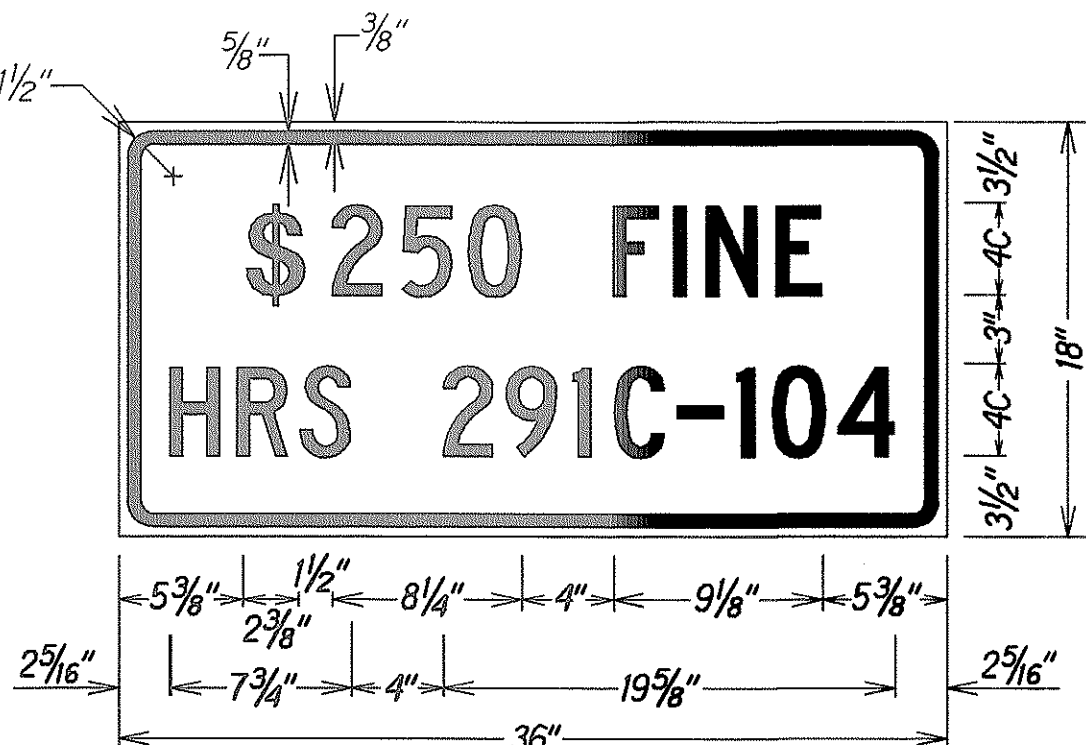

LEGEND: BLACK
BACKGROUND: WHITE

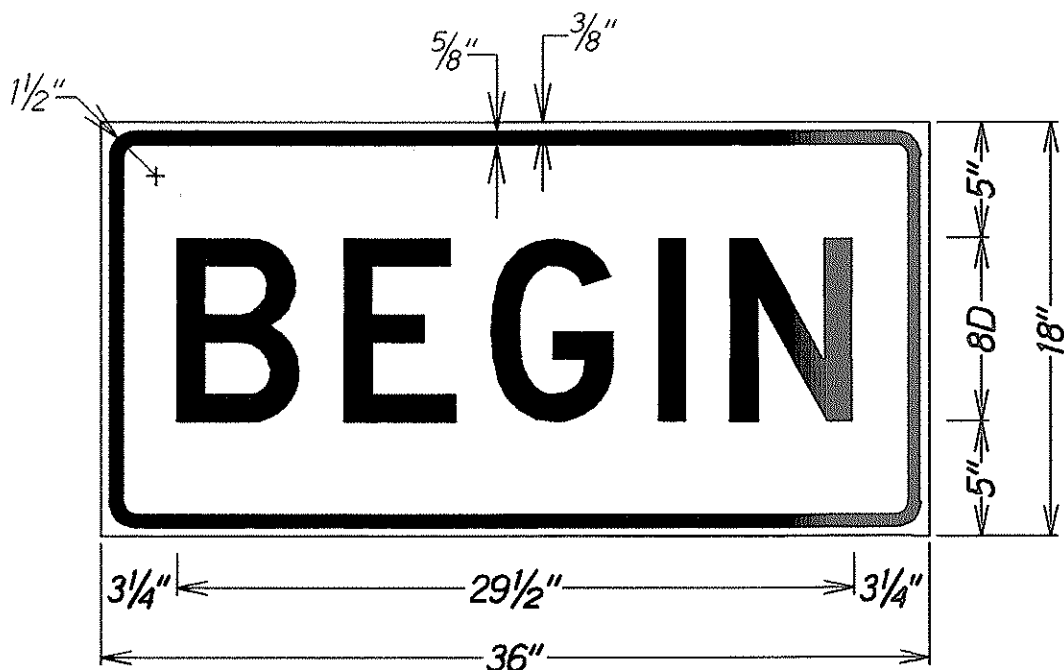

LEGEND: BLACK
BACKGROUND: ORANGE

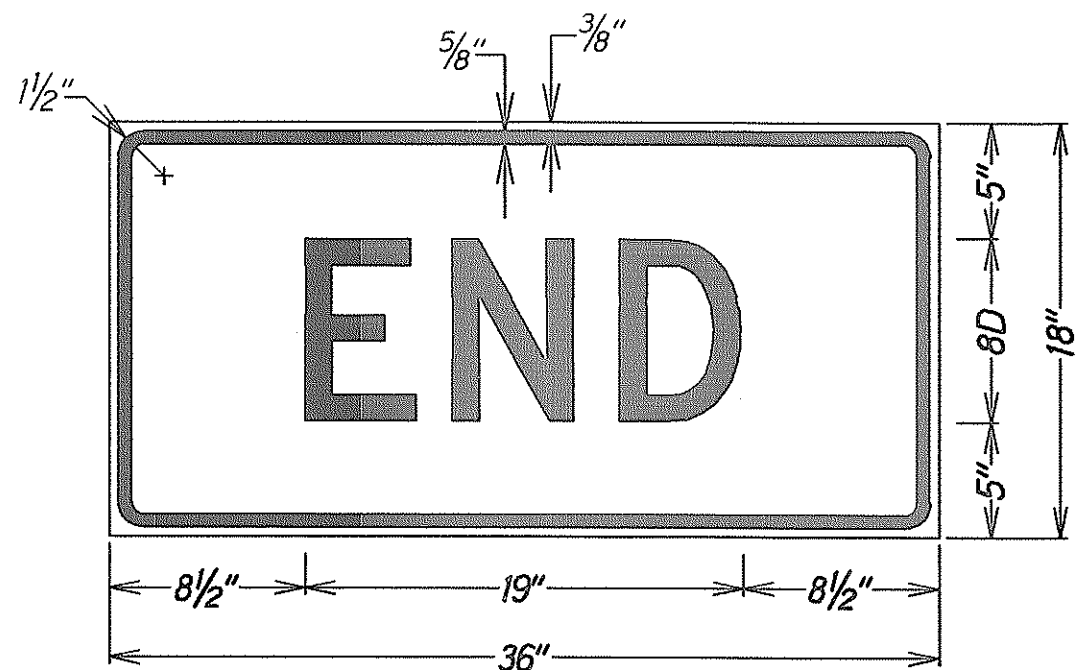

LEGEND: BLACK
BACKGROUND: ORANGE

4/26/07 Added plan sheet to contract plans.

DATE REVISION

STATE OF HAWAII
DEPARTMENT OF TRANSPORTATION
HIGHWAYS DIVISION
HIGH SPEED UNDIVIDED HIGHWAY
WORK ZONE SIGNING PLAN, NOTES&DETAILS
HAWAII BELT ROAD
Guardrail & Shoulder Improvements
Papalele Road to Paauhau Road
Federal Aid Project No. NH-019-1(37)
Not To Scale Date: July 2006

SHEET No. T2A OF 11 SHEETS

ADD. 38S-1

FED. ROAD DIST. NO.	STATE	FED. AID PROJ. NO.	FISCAL YEAR	SHEET NO.	TOTAL SHEETS
HAWAII	HAW.	NH-019-1(37)	2007	39	47

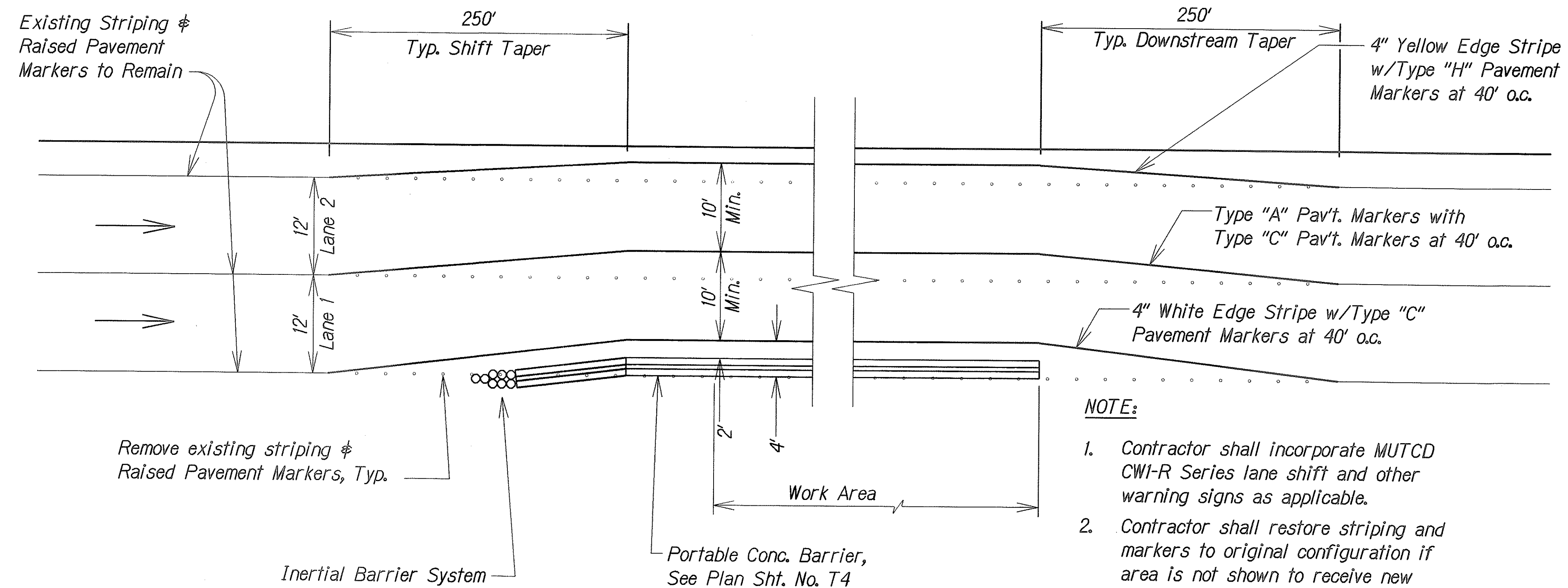

NOTE:

1. Contractor shall incorporate MUTCD CWI-R Series lane shift and other warning signs as applicable.
2. Contractor shall restore striping and markers to original configuration if area is not shown to receive new striping.
3. Removal and installation of temporary and permanent striping and markers will not be paid for separately, and shall be considered incidental to Other Contract Items.

TEMPORARY STRIPING PLAN - LANE SHIFT ON 2 LANE ROAD
Not To Scale

ORIGINAL PLAN	DATE
DESIGNED BY	11/2/03
DRAWN BY	
CHECKED BY	
IN CHARGE	

STATE OF HAWAII DEPARTMENT OF TRANSPORTATION HIGHWAYS DIVISION
TEMPORARY STRIPING PLAN
HAWAII BELT ROAD
Guardrail & Shoulder Improvements
Paauihau Road to Papalele Road and Various Locations
Federal Aid Project No. NH-019-1(37)
Scale: As Noted Date: August 2006
SHEET No. T3 OF 11 SHEETS

FED. ROAD DIST. NO.	STATE	FED. AID PROJ. NO.	FISCAL YEAR	SHEET NO.	TOTAL SHEETS
HAWAII	HAW.	NH-019-1(37)	2007	ADD,40	47

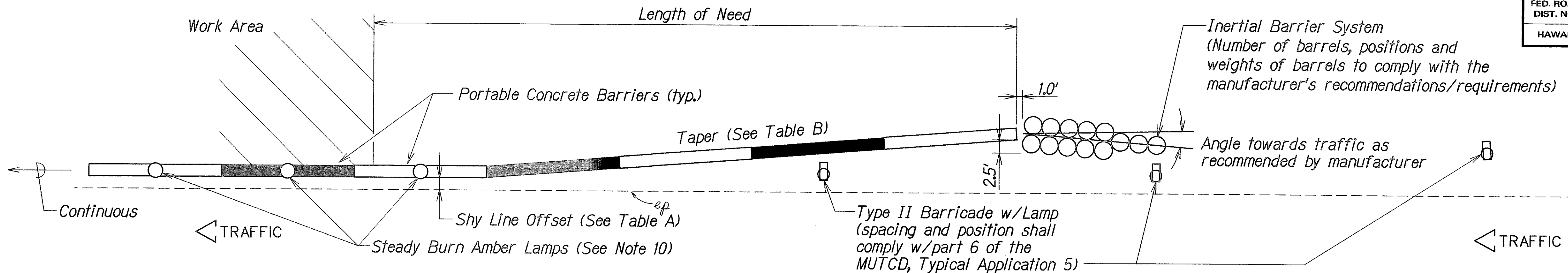

TYPICAL DETAIL - PORTABLE CONCRETE BARRIER END TREATMENT
Scale: 1" = 10'-0"

- NOTES:
- For end treatment, layout, crash cushions and where needed see Project Plans or Special Provisions.
 - Barriers must be pinned together and cannot exceed the Table of Maximum Tapers.
 - The concrete barrier "Standard Installation" design allows for 3'-3" of outward lateral movement if the barrier is struck. Barrier installations that require less than the 3'-3" of outward lateral movement should have stabilization pins.
 - ASTM A-36 steel shall be used for the connection pin, connection loops and stabilization pins. A one piece pin with a 3" rounded top may be used in place of the detailed connection pin if the one piece pin meets ASTM A-36 requirements.
 - A 4" white PVC sleeve may be used to form the lifting hole and if used the sleeve is to be left in place.
 - Concrete shall be Class A and reinforcing shall be Grade 60.
 - Identification and date of design will be as follows:
**PROPERTY OF HDOT
OCT 2001**
Text letters and numbers shall be shown as on Standard Plan Sht. No. B-01. "PROPERTY OF HDOT" may be changed depending upon ownership. All Portable Concrete Barriers made for HDOT will be subject to rejection, if "PROPERTY OF HDOT" is not imprinted. The Contractor shall bear the cost of the rejected Portable Concrete Barriers.
 - Minimum tangent length for portable Concrete Barrier System shall be 100' (5 units). This minimum does not include the required system length of the Inertial Barrier System.
 - Install steady burn amber lamps on portable concrete barriers @ 20.0' o.c. Installing, maintaining and removing each steady burn amber lamp including changing of batteries and bulbs shall be considered incidental to applicable portable concrete barrier items.

METAL REINFORCEMENT TABLE				
MARK	LOCATION	BAR SIZE	(NO. BARS)	SKETCH
H-1	Horizontal in Barrier Tied Inside V-1 Bars	#5	(6)	19'-3"
H-2	Centered Above Scuppers Long. & Transversely	#5	(6)	6'-6"
H-3	Tied Above H-1 Bars to Support H-2, Tied to V-1	#4	(2)	1'-6"
S-1	Horizontal in Top of Wing Wall & in Floor Back Wall	#4	(2)	
S-2	Horizontal Around Slots Between V-1's @ Scuppers	#4	(2)	
V-1	Vertical in Barrier (3) Each End & (2) at Each Scupper	#5	(16)	

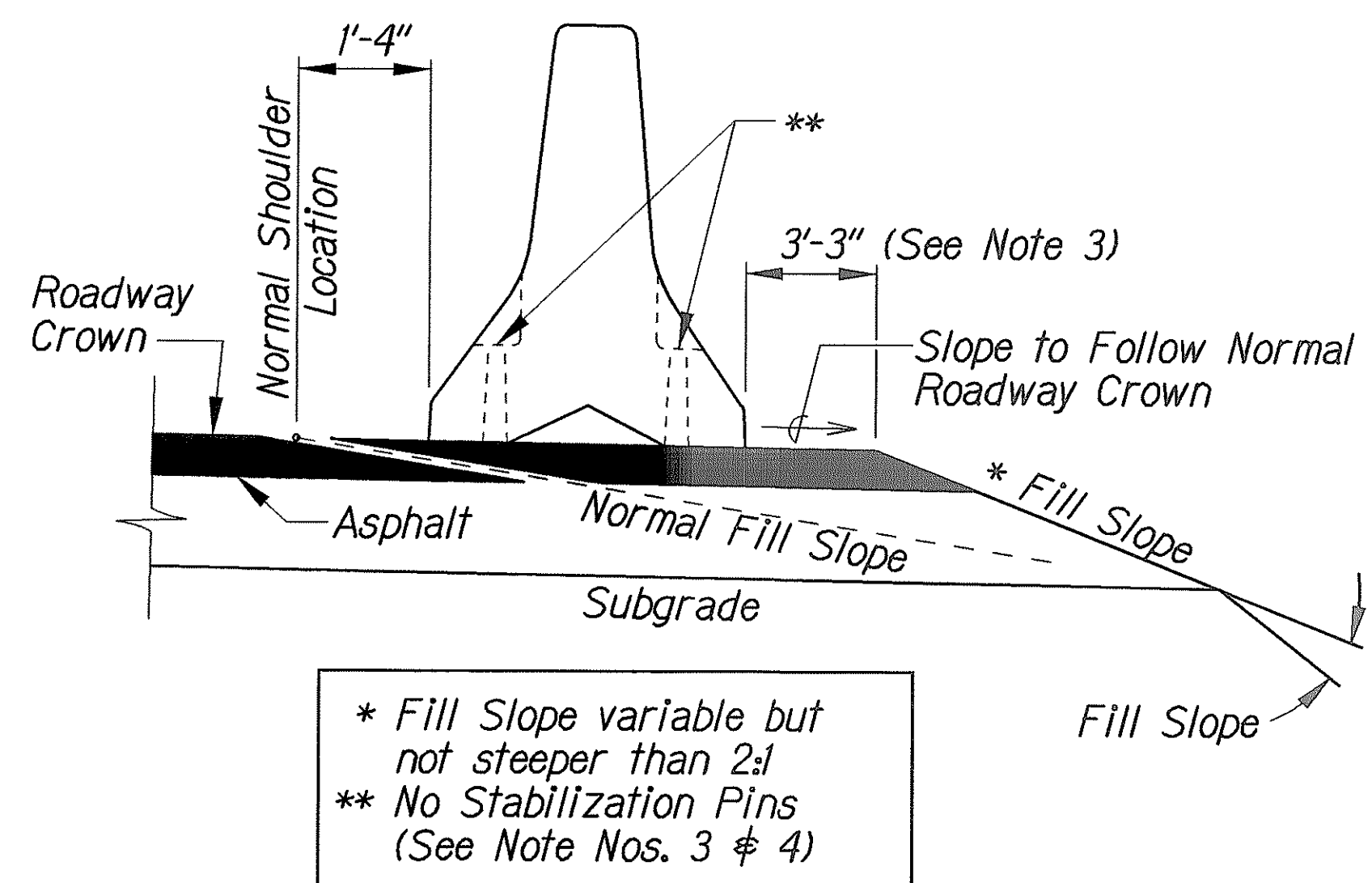

STANDARD INSTALLATION
(See Note No. 1)

TABLE A SHY LINE OFFSETS *	
DESIGN SPEED (mph)	SHY LINE OFFSETS
70	10.0'
65	9.0'
60	8.5'
55	7.0'
50	6.5'
45	6.0'
40	5.0'
35	4.5'
30	3.5'
≤ 25	2.0'

TABLE B MAXIMUM TAPERS FOR CONCRETE BARRIER		
DESIGN SPEED (mph)	TAPER	
	INSIDE SHY LINE	BEYOND SHY LINE
70	30:1	20:1
65	28:1	19:1
60	26:1	18:1
55	24:1	16:1
50	21:1	14:1
45	18:1	12:1
40	17:1	11:1
35	15:1	9:1
≤ 30	13:1	8:1

* Note: Minimum shy line offset for tangent sections shall be 2'-0".

SURVEY PLOTTED BY	DATE
DRAWN BY	
DESIGNED BY	
QUANTITIES BY	
CHECKED BY	

4/26/07	Revised End Treatment call out.
DATE	REVISION

STATE OF HAWAII
DEPARTMENT OF TRANSPORTATION
HIGHWAYS DIVISION

PORTABLE CONCRETE BARRIER

HAWAII BELT ROAD GUARDRAIL
& SHOULDER IMPROVEMENTS
Paauhau Road to Papalele Road and Various Locations
Federal Aid Project No. NH-019-1(37)

Scale: As Noted Date: August 2006

SHEET No. 74 OF 11 SHEETS

FED. ROAD DIST. NO.	STATE	FED. AID PROJ. NO.	FISCAL YEAR	SHEET NO.	TOTAL SHEETS
HAWAII	HAW.	NH-019-1(37)	2007	ADD. 41	47

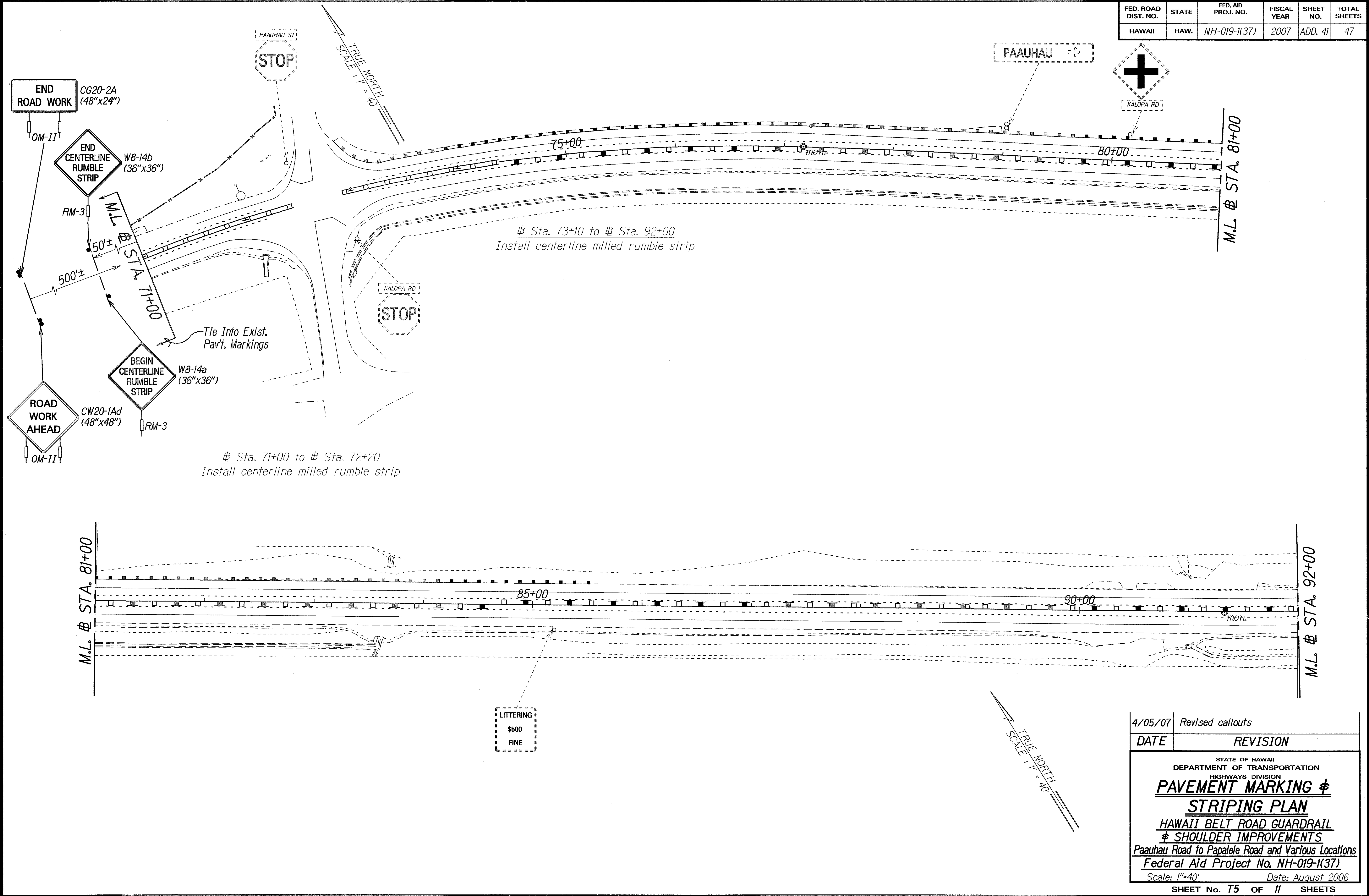

ORIGINAL PLAN	SURVEY PLOTTED BY	DATE
NOTED BY	DRAWN BY	
NOTED BY	TRACED BY	
NOTED BY	QUANTITIES BY	
NOTED BY	CHECKED BY	

4/05/07	Revised callouts
DATE	REVISION
STATE OF HAWAII DEPARTMENT OF TRANSPORTATION HIGHWAYS DIVISION PAVEMENT MARKING & STRIPING PLAN HAWAII BELT ROAD GUARDRAIL & SHOULDER IMPROVEMENTS Paauhau Road to Papalele Road and Various Locations Federal Aid Project No. NH-019-1(37) Scale: 1"=40' Date: August 2006	
SHEET No. 75 OF 11 SHEETS	

FED. ROAD DIST. NO.	STATE	FED. AID PROJ. NO.	FISCAL YEAR	SHEET NO.	TOTAL SHEETS
HAWAII	HAW.	NH-019-1(37)	2007	ADD. 42	47

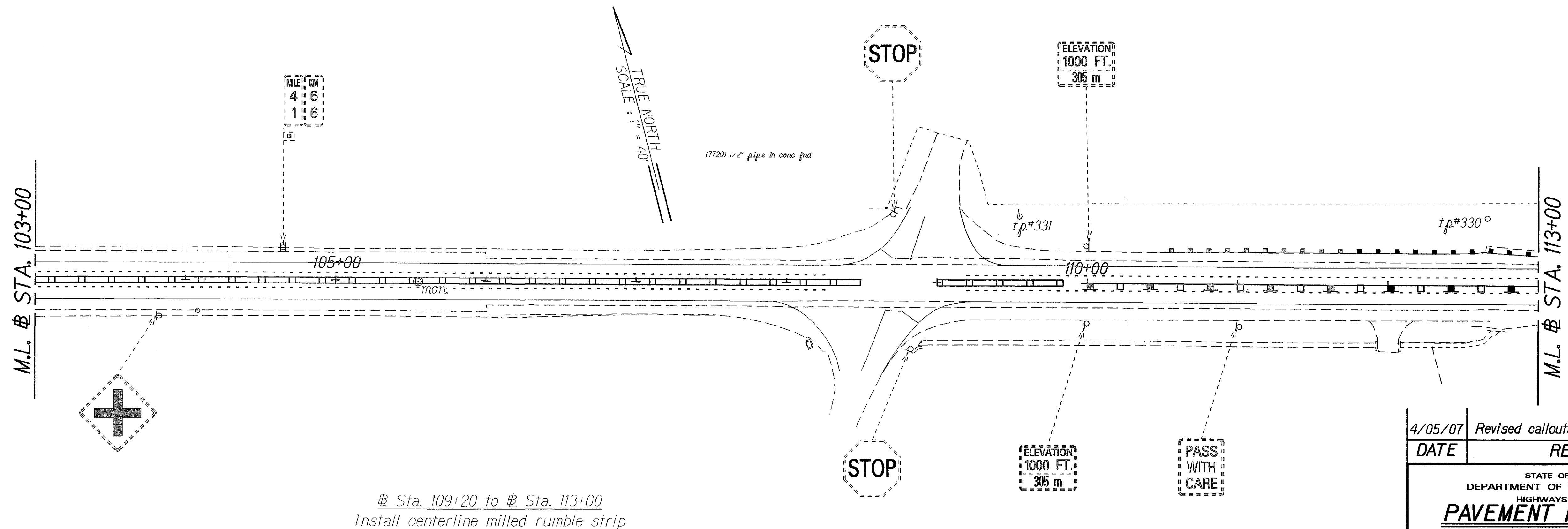
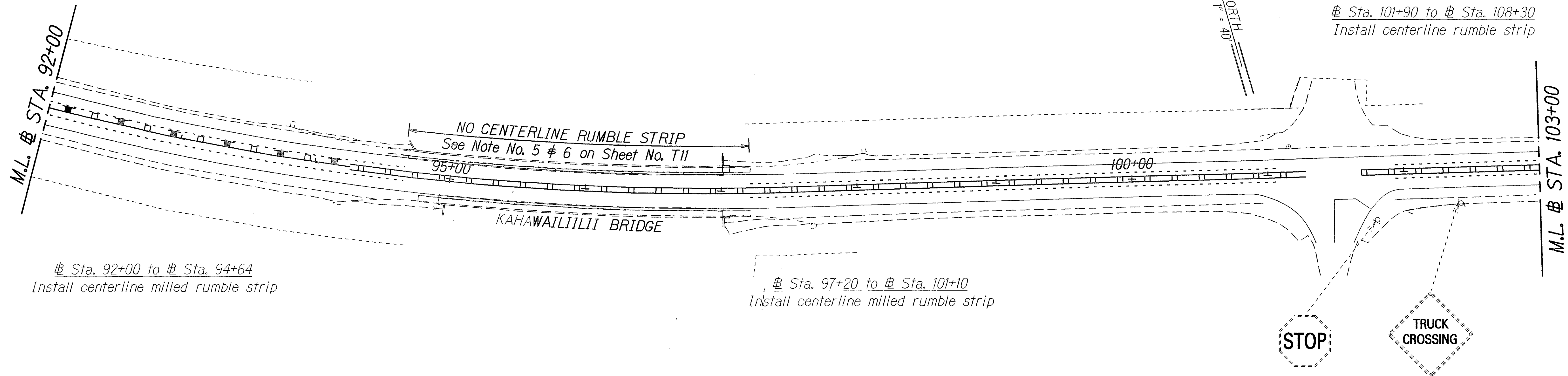

4/05/07	Revised callouts
DATE	REVISION
STATE OF HAWAII DEPARTMENT OF TRANSPORTATION HIGHWAYS DIVISION PAVEMENT MARKING & STRIPING PLAN HAWAII BELT ROAD GUARDRAIL & SHOULDER IMPROVEMENTS Paauhau Road to Papalele Road and Various Locations Federal Aid Project No. NH-019-1(37) Scale: 1"=40' Date: August 2006 SHEET No. T6 OF 11 SHEETS	

ORIGINAL PLAN	SURVEY PLOTTED BY	DATE
NOTE BOOK	DRAWN BY M. Takahashi	X
142.mey	TRACED BY	
No. 0011002	QUANTITIES BY	
	CHECKED BY	

FED. ROAD DIST. NO.	STATE	FED. AID PROJ. NO.	FISCAL YEAR	SHEET NO.	TOTAL SHEETS
HAWAII	HAW.	NH-019-1(37)	2007	ADD. 43	47

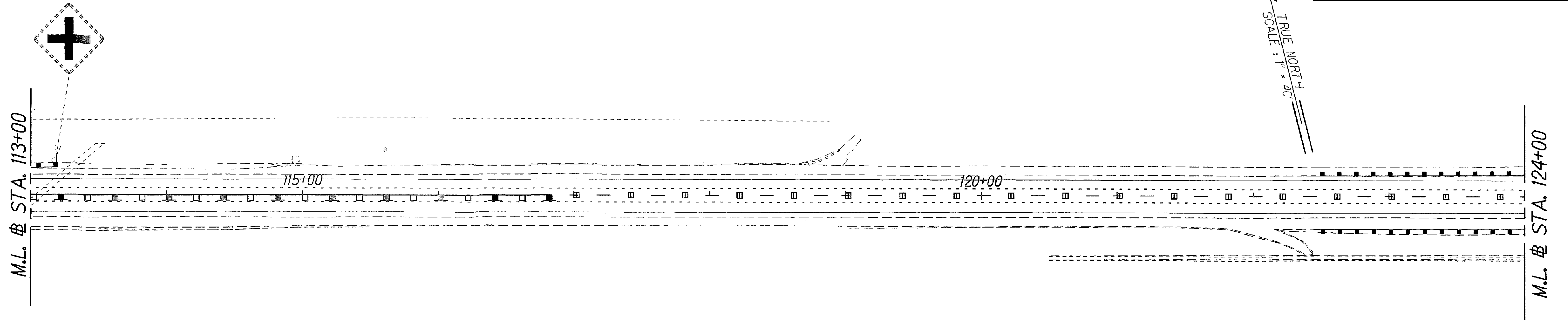

Sta. 113+00 to Sta. 135+00
Install centerline milled rumble strip

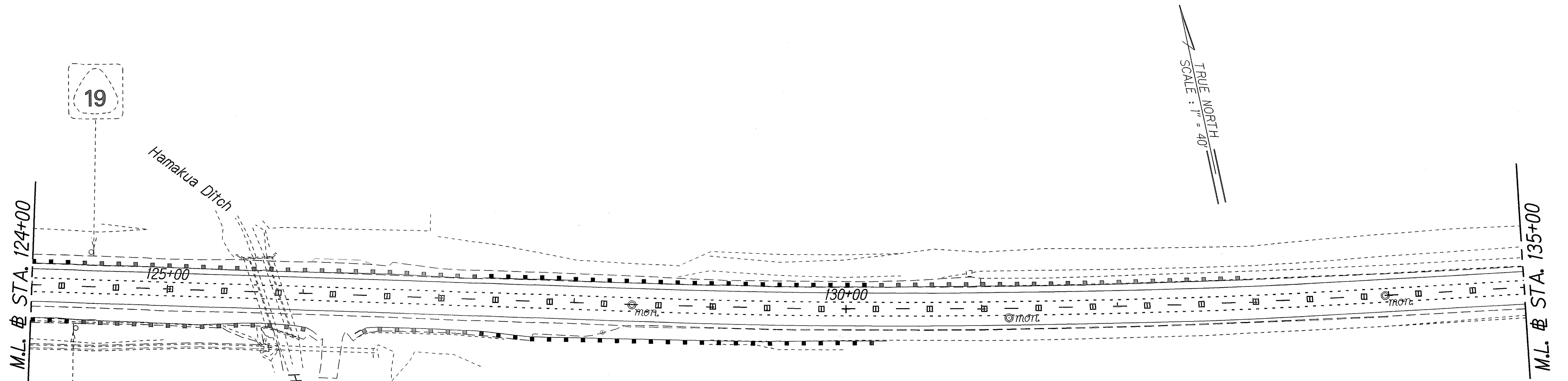

ORIGINAL PLAN	SURVEY PLOTTED BY	DATE
NOVE BOOK	DRAWN BY	11/11/01
102.may	TRACED BY	
Nc. collr03	QUANTITIES BY	
	CHECKED BY	

4/05/07	Revised callouts
DATE	REVISION

STATE OF HAWAII
DEPARTMENT OF TRANSPORTATION
HIGHWAYS DIVISION

PAVEMENT MARKING &
STRIPING PLAN

HAWAII BELT ROAD GUARDRAIL
& SHOULDER IMPROVEMENTS

Paauihau Road to Papalele Road and Various Locations

Federal Aid Project No. NH-019-1(37)

Scale: 1"=40' Date: August 2006

SHEET No. 17 OF 11 SHEETS

FED. ROAD DIST. NO.	STATE	FED. AID PROJ. NO.	FISCAL YEAR	SHEET NO.	TOTAL SHEETS
HAWAII	HAW.	NH-019-1(37)	2007	ADD. 44	47

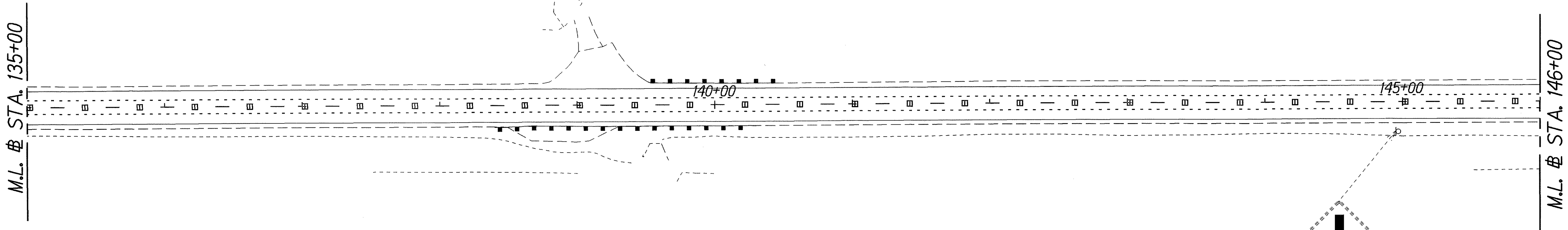

Sta. 135+00 to Sta. 148+80
Install centerline milled rumble strip

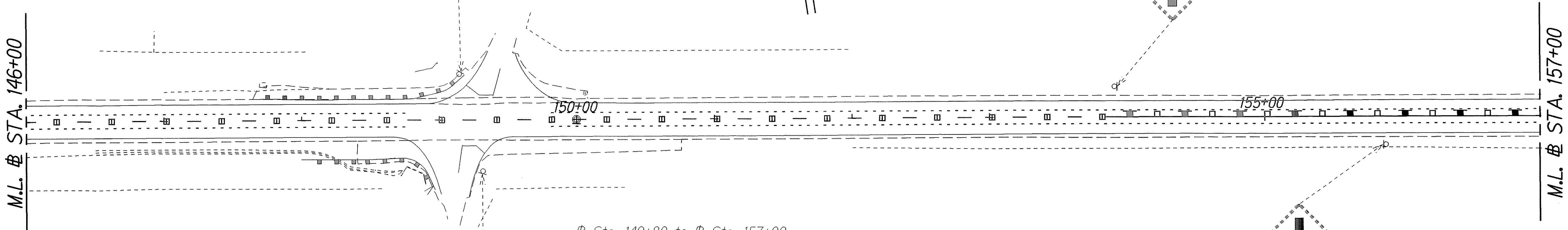

Sta. 149+80 to Sta. 157+00
Install centerline milled rumble strip

4/05/07 Revised callouts

DATE REVISION

STATE OF HAWAII
DEPARTMENT OF TRANSPORTATION
HIGHWAYS DIVISION

PAVEMENT MARKING
STRIPING PLAN
HAWAII BELT ROAD GUARDRAIL
& SHOULDER IMPROVEMENTS
Paauhau Road to Papalele Road and Various Locations
Federal Aid Project No. NH-019-1(37)
Scale: 1"=40' Date: August 2006

SHEET No. 78 OF 11 SHEETS

ORIGINAL PLAN	SURVEY PLOTTED BY	DATE
NOTE BOOK	DRAWN BY M. Takaijii	X
102.may	TRACED BY	
No. 0011004	QUANTITIES BY	
	CHECKED BY	

FED. ROAD DIST. NO.	STATE	FED. AID PROJ. NO.	FISCAL YEAR	SHEET NO.	TOTAL SHEETS
HAWAII	HAW.	NH-019-1(37)	2007	ADD. 45	47

ADOPT A HIGHWAY
LITTER CONTROL
NEXT 2 MILES
BAHA'IS OF HAWAII

Sta. 157+00 to Sta. 167+40
Install centerline milled rumble strip

MILE
4
0

M.L. STA. 157+00

ADOPT A HIGHWAY
LITTER CONTROL
NEXT 2 MILES
HONOKAA METHODIST

M.L. STA. 167+00

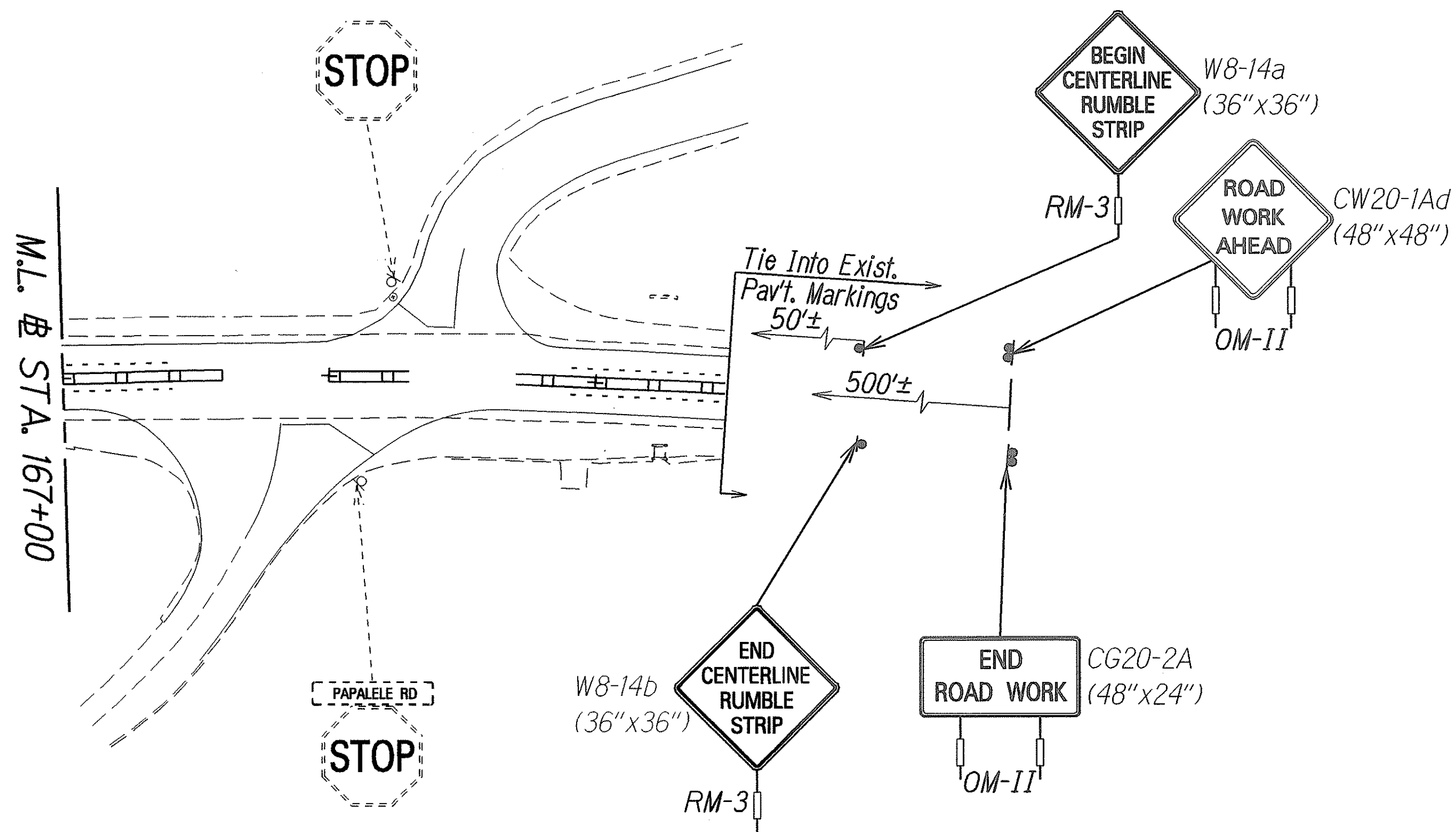

Sta. 168+90 to Sta. 169+50
Install centerline milled rumble strip

4/05/07	Revised callouts
DATE	REVISION
STATE OF HAWAII DEPARTMENT OF TRANSPORTATION HIGHWAYS DIVISION PAVEMENT MARKING & STRIPING PLAN HAWAII BELT ROAD GUARDRAIL & SHOULDER IMPROVEMENTS Paauhau Road to Papalele Road and Various Locations Federal Aid Project No. NH-019-1(37) Scale: 1"=40' Date: August 2006	
SHEET No. T9 OF 11 SHEETS	

ADD. 45

DESIGNED BY	DATE
TRACED BY	
QUANTITIES BY	
CHECKED BY	
ORIGINAL PLAN	
NOTE BOOK	
DATE	

FED. ROAD DIST. NO.	STATE	FED. AID PROJ. NO.	FISCAL YEAR	SHEET NO.	TOTAL SHEETS
HAWAII	HAW.	NH-019-1(37)	2007	ADD. 46	47

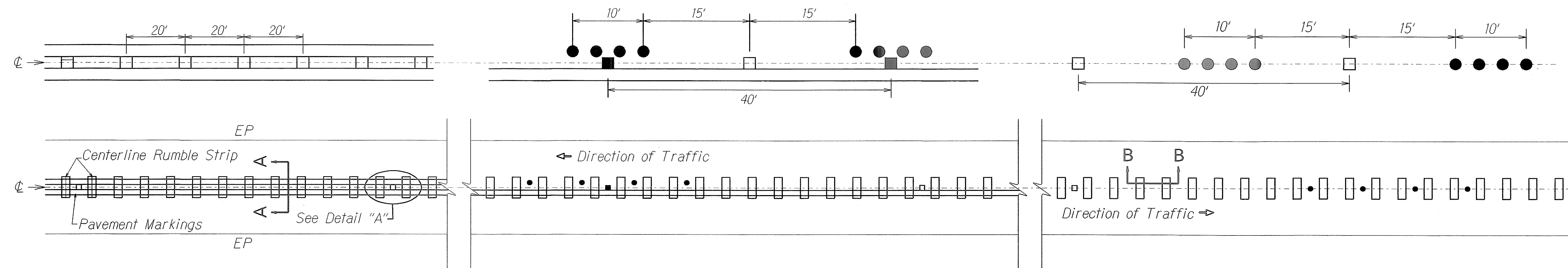

PLAN - CENTERLINE MILLED RUMBLE STRIP

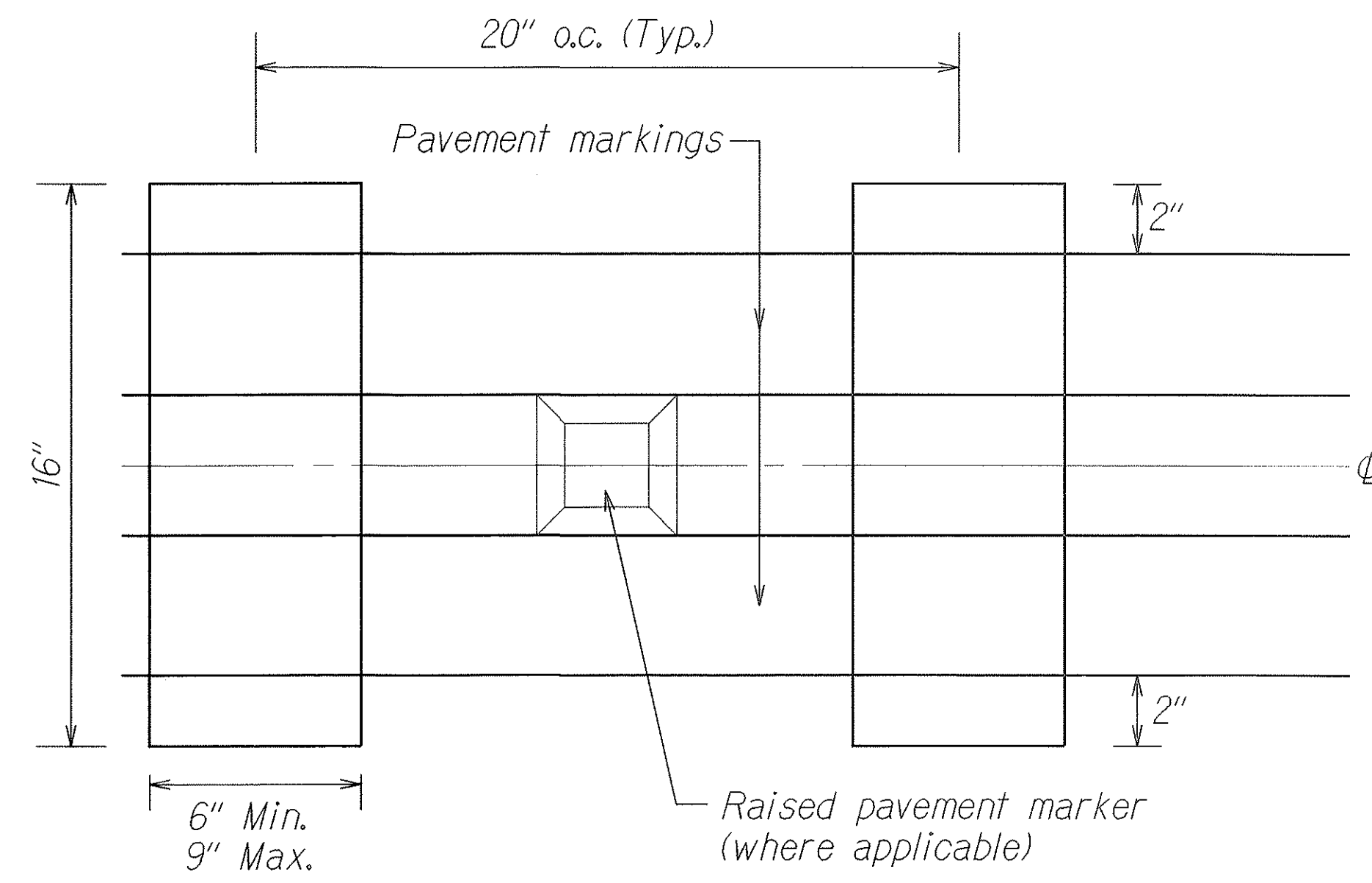

DETAIL "A"

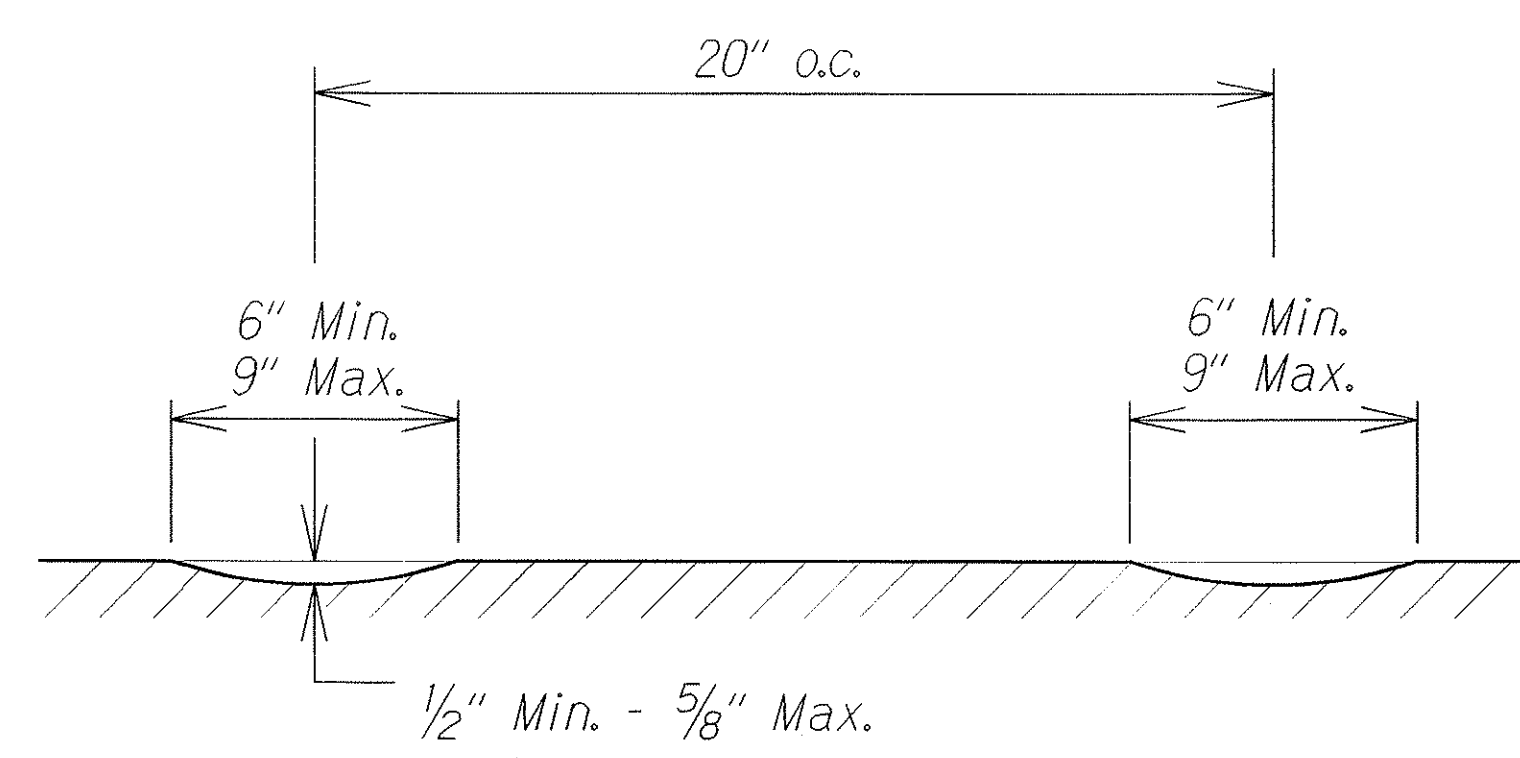

SECTION B-B - CENTERLINE MILLED RUMBLE STRIP

NOTES:

1. The method of constructing the centerline milled rumble strip shall be submitted to the Engineer for acceptance prior to the actual work.
2. Dimensions shown are approximate. Adjust rumble strip spacing to coordinate with pavement markings prior to installation.
3. Raised pavement markers shall be installed on level surface between the rumble strips. Do not install raised pavement markers inside the milled area.
4. The construction of the centerline milled rumble strip shall be paid for under Item No. 615.0100 - Milled Rumble Strip. The milling apparatus and removal of existing pavement markings will not be paid for separately and shall be considered incidental to Item 615.0100.
5. Do not install centerline rumble strips on bridge decks.
6. Where at-grade bridges are present, rumble strips shall end/begin 20 L.F. beyond the existing bridge deck joints/concrete approach slab.
7. Pre-formed pavement striping tape shall be used for solid line markings within the milled centerline rumble strip area.

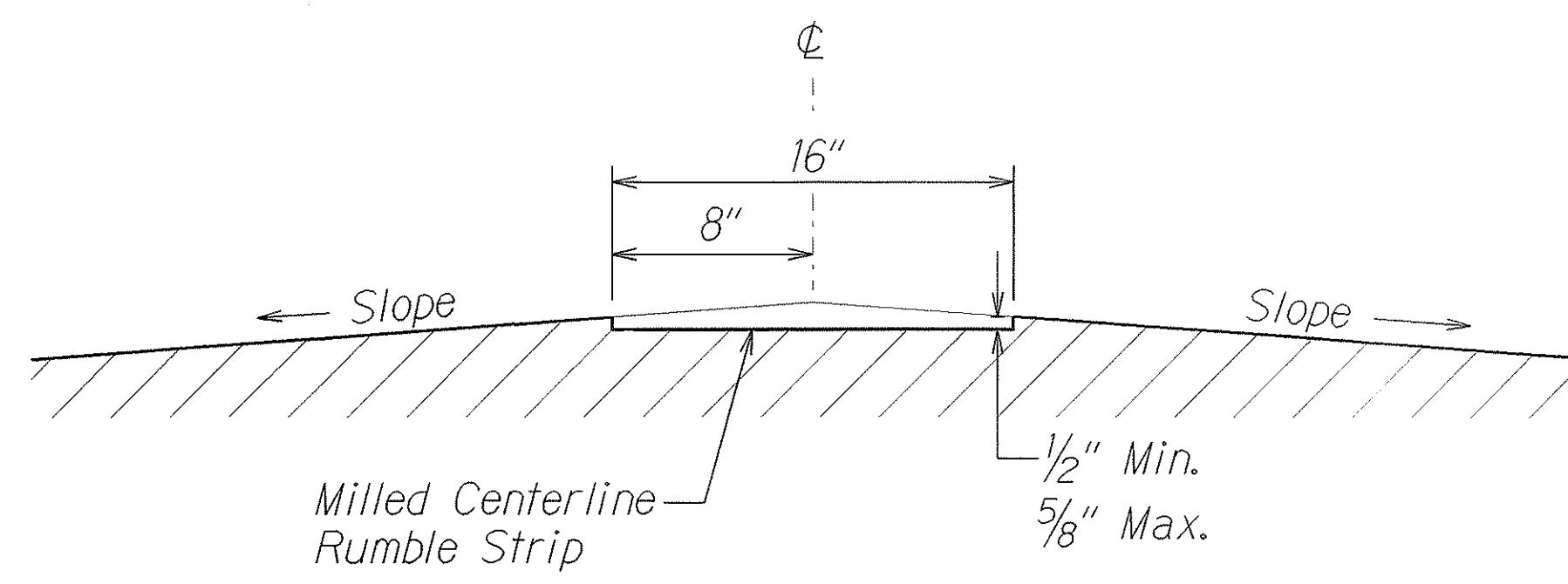

SECTION A-A - CENTERLINE MILLED RUMBLE STRIP

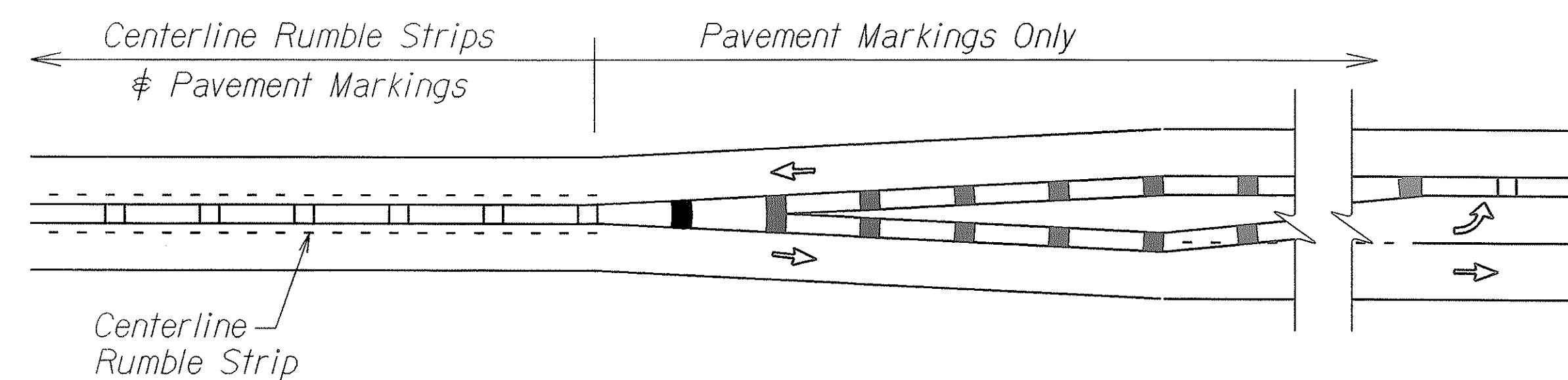

CENTERLINE MILLED RUMBLE STRIP INSTALLATION LIMIT

SURVEY PLOTTED BY	DATE
DRAWN BY	
DESIGNED BY	
QUANTITIES BY	
CHECKED BY	
NOTE BOOK	
102may	
No. 001750	

4/05/07	Revised titles Revised notes
DATE	REVISION
STATE OF HAWAII DEPARTMENT OF TRANSPORTATION HIGHWAYS DIVISION	
MILLED RUMBLE STRIP DETAIL	
HAWAII BELT ROAD GUARDRAIL	
& SHOULDER IMPROVEMENTS	
Paauhau Road to Papalele Road and Various Locations	
Federal Aid Project No. NH-019-1(37)	
Not to Scale	Date: August 2006
SHEET No. 710 OF 11 SHEETS	

FED. ROAD DIST. NO.	STATE	FED. AID PROJ. NO.	FISCAL YEAR	SHEET NO.	TOTAL SHEETS
HAWAII	HAW.	NH-019-1(37)	2007	47	47

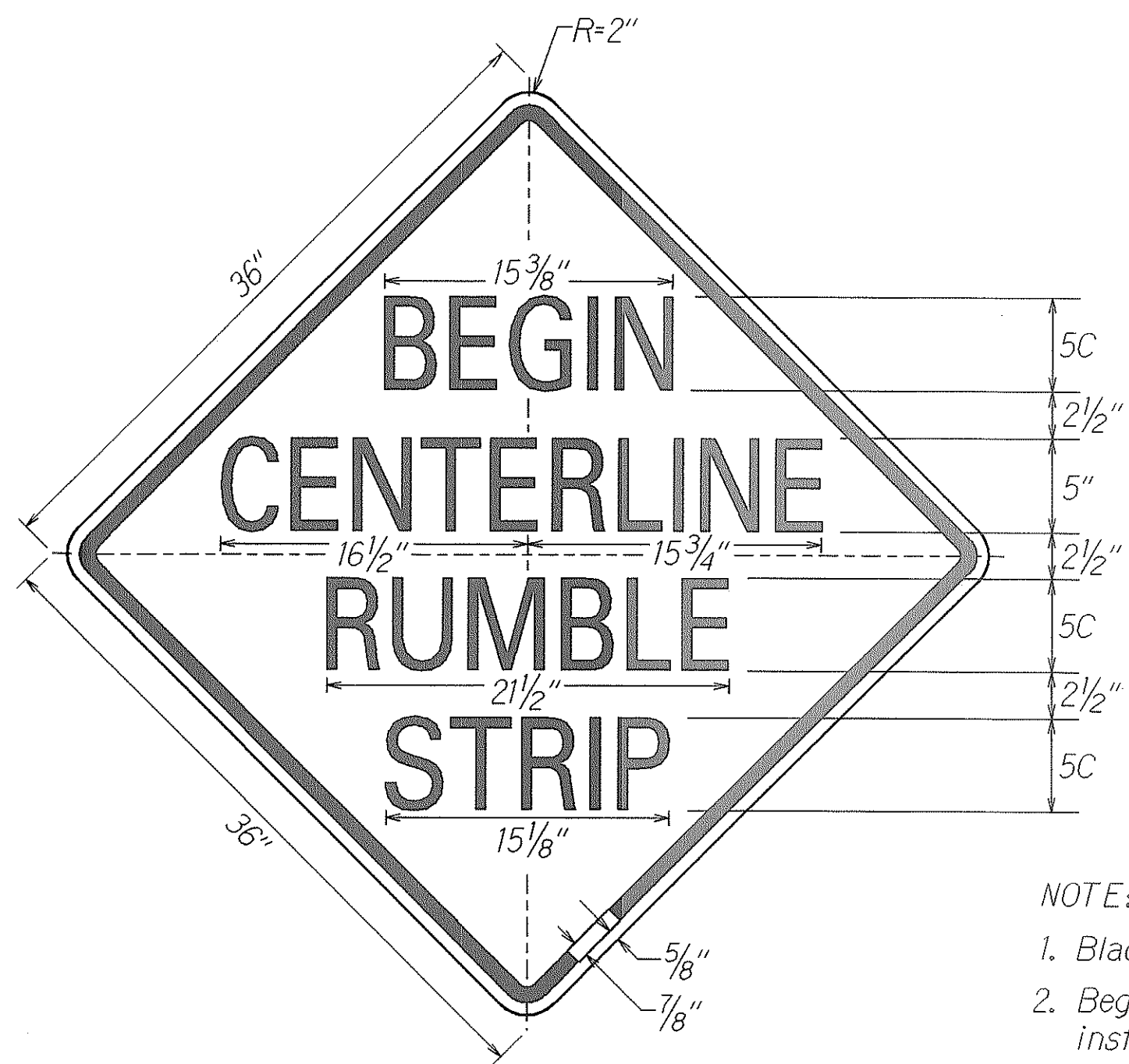

W8-14a

NOTE:

1. Black legend on reflectorized yellow background.
2. Begin Centerline Rumble Strip signs shall be installed 50 feet before the first rumble strip depression. End Centerline Rumble Strip signs shall be installed 50 feet beyond the last rumble strip depression.

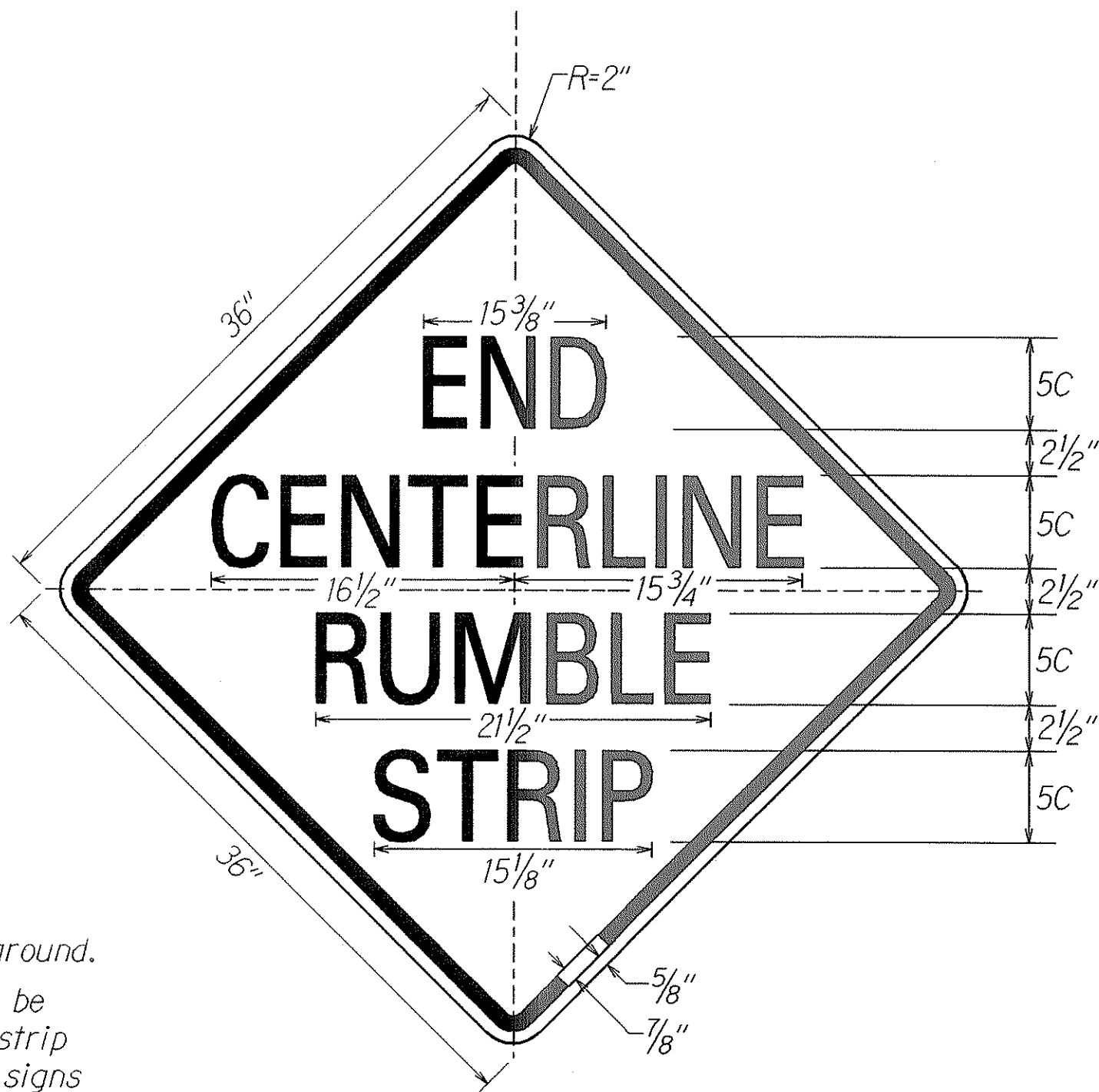

W8-14b

SIGN NOTES

1. All signs shall conform to Section 621 of the Special Provisions and the latest editions and amendments of the following FHWA publications:
 - a. "Manual on Uniform Traffic Control Devices for Streets and Highways" (MUTCD)
 - b. "Standard Highway Signs"
 - c. "Standard Alphabets for Highway Signs"
2. Borders, messages, arrows, symbols and shield shall conform to details as shown on the plans and as specified in the MUTCD.
3. Sign messages shall be as indicated on the plan, or as directed by the Engineer.
4. Backing for all new Regulatory and Warning Signs shall not be spliced.
5. Final locations of all signs shall be accepted by the Engineer prior to any installation work.
6. Existing signs that are to be replaced, shall not be removed until new signs are installed as replacements, or the messages are no longer necessary.
7. Existing signs not shown on these plans shall remain as posted unless otherwise directed by the Engineer. Removal and disposal of existing signs and/or posts as designated on these plans shall be incidental to the various signing items.
8. All signs shall be installed on square tube posts, unless otherwise noted.
9. Sign posts shall be painted with yellow reflective paint, except where located behind guardrails. Such paint work shall be considered incidental to sign items.
10. Contractor shall mark the back of all signs using labels and equipment provided by the State. Payment to be incidental to various contract items.

ORIGINAL PLAN	SURVEY PLOTTED BY	DATE
NOTED	DRAWN BY	DATE
NOTED	TRACED BY	DATE
NOTED	QUANTITIES BY	DATE
NOTED	CHECKED BY	DATE

STATE OF HAWAII
DEPARTMENT OF TRANSPORTATION
HIGHWAYS DIVISION
CENTERLINE RUMBLE STRIP
SIGN DETAILS AND NOTES
HAWAII BELT ROAD GUARDRAIL
SHOULDER IMPROVEMENTS
Paauhau Road to Papalele Road and Various Locations
Federal Aid Project No. NH-019-1(37)
Not to Scale Date: August 2006
SHEET No. 711 OF 11 SHEETS