

GENERAL NOTES FOR TRAFFIC CONTROL

- 1. The Contractor shall make minor adjustments at intersections, driveways, bridges, structures, etc., to fit field conditions.
- 2. Cones or delineators shall be extended to a point where they are visible to approaching traffic.
- 3. Traffic Control Devices shall be installed such that the sign or device farthest from the work area shall be placed first. The others shall then be placed progressively toward the work area.
- 4. Flaggers and/or Police Officers shall be in sight of each other or in direct communication at all times.
- 5. When required by the issuing Officer, the Permittee shall install a Flashing Arrow signal as shown on the Traffic Control Plans.
- 6. Sign spacings (L), Taper lengths (T), and spacing of Cones or Delineators shall be as shown in Table 1, unless otherwise noted on the Traffic Control Plans.
- 7. All highway traffic lanes shall be a minimum of 11 feet wide. Ramps and other roadway lanes shall be a minimum of 10 feet wide.
- 8. All Construction Warning Signs shall be promptly removed or covered whenever the message is applicable or not in use.
- 9. The backs of all signs used for Traffic Control shall be appropriately covered to preclude the display of inapplicable sign messages (i.e., When signs have messages on both faces).
- 10. At the end of each day's work or as soon as the work is completed, the Permittee shall remove all Traffic Control Devices no longer needed to permit free and safe passage of public traffic. Removal shall be in the reverse order of installation.
- 11. Replace permanent Pavement Markings and Traffic Signs upon completion of each phase of work.
- 12. Existing conflicting Pavement Markings shall be removed and Temporary Markings shall be installed before Traffic Patterns are changed. After completion of the work, Temporary Markings shall be removed.
- 13. All traffic control devices including cones, barricades, etc. shall comply with the Statewide Guideline for Work Zone Traffic Control Devices dated September 13, 2000, and Section 645 of the Special Provisions.
- 14. When working on shoulder or roadside, or closing one lane of the road, Contractor shall install traffic control devices arranged as shown on Section 645 of the Special Provisions.

ADDITIONAL NOTES FOR CONSTRUCTION PHASING PLAN

- 1. Lane closures shall be subject to the approval of the Engineer.
- 2. If necessary, complete closure of the Hawaii Belt Highway shall only occur on one Sunday. Sunday work shall be permitted from 8:30 a.m. to 3:30 p.m. only. The Contractor shall be responsible to obtain the required Noise Variance and permit from the Department of Health, State of Hawaii, as required. The Contractor will not be entitled to Extra Compensation for his election to perform work on Sunday.
- 3. All existing speed limit signs covered during the lane closure period shall be uncovered upon the removal of the closed lane including each construction/warning/regulatory sign.

TABLE 1 FOR TRAFFIC CONTROL PLAN

Posted Speed Limit (M.P.H.)	Sign Spacing (L) (Feet)	Taper Length (T) (Feet)		Longitudinal Buffer Space (B) (Feet)	Spacing of Cones or Delineators (Feet)		
		⊗W = 12' or Less	⊗W = 12' or Less		Taper	Tangent	Work Area
20	250	200	Wx17	35	20	20	10
25	250	200	Wx17	55	25	25	10
30	250	250	Wx20	85	30	30	10
35	250	250	Wx20	120	35	35	10
40	500	350	Wx30	170	40	40	10
45	500	550	Wx45	220	45	45	10
50	1000	600	Wx50	280	50	50	10
55	1000	700	Wx55	335	55	55	10

⊗W = Width of Lane, Shoulder or Offset

FED. ROAD DIST. NO.	STATE	FED. AID PROJ. NO.	FISCAL YEAR	SHEET NO.	TOTAL SHEETS
HAWAII	HAW.	BR-019-2(50)	2006	41	43

SURVEY PLOTTED BY _____ DATE _____

DRAWN BY _____

TRACED BY _____

DESIGNED BY _____

QUANTITIES BY _____

CHECKED BY _____

ORIGINAL PLAN

NOTEBOOK

No. _____

DATE: _____
SCALE: _____
FILE: _____

PM: _____
OPER: _____
REVISED: _____

NEAL S. FUKUMOTO
LICENSED PROFESSIONAL ENGINEER
No. 6186-C
HAWAII U.S.A.

This work was prepared by me or under my supervision.
Exp. 04-30-08
Wesley R. Segawa
Wesley R. Segawa & Associates, Inc.

STATE OF HAWAII
DEPARTMENT OF TRANSPORTATION
HIGHWAYS DIVISION
**TRAFFIC CONTROL PLAN
AND GENERAL NOTES**

REMOVAL OF HALAULANI BRIDGE
Hawaii Belt Road
Federal Aid Project No. BR-019-2(50)
Scale: AS NOTED Date: July, 2006

FED. ROAD DIST. NO.	STATE	FED. AID PROJ. NO.	FISCAL YEAR	SHEET NO.	TOTAL SHEETS
HAWAII	HAW.	BR-019-2(50)	2006	42	43

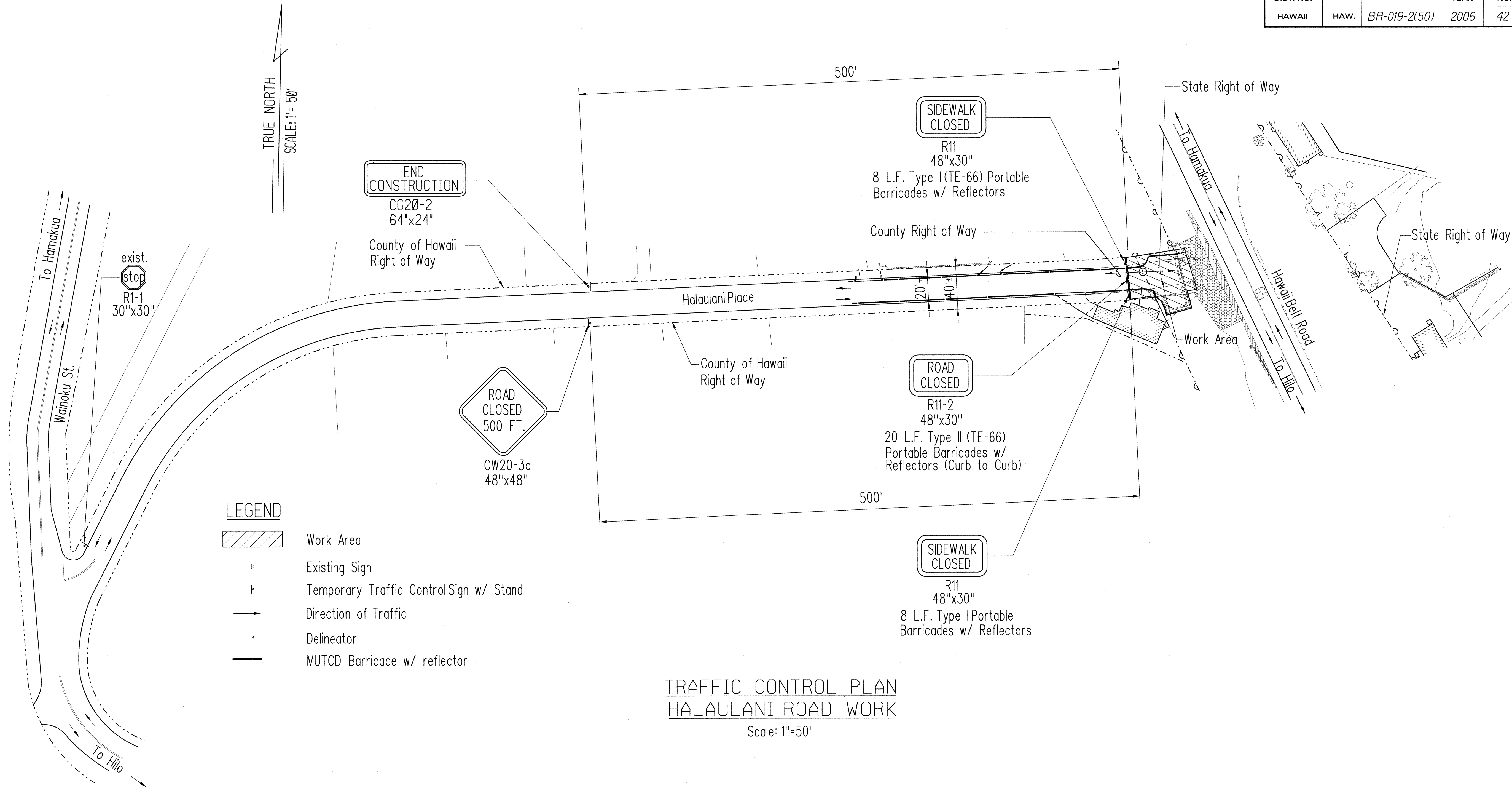

TRAFFIC CONTROL PLAN
HALAULANI ROAD WORK
Scale: 1"=50'

CONSTRUCTION SIGN SUMMARY					
HALAULANI PLACE ROAD WORK					
SIGN NO.	LOCATION	MESSAGE	TRIPOD	W/ PORTABLE BARRICADE (TE-66)	
				TYPE I	TYPE III
CG20-2	500'± East of Halaulani Pl.-Wainaku St. Inter. (LT.)	END CONSTRUCTION	1		
CW20-3c	500'± East of Halaulani Pl.-Wainaku St. Inter. (RT.)	ROAD CLOSED (500 FT.)	1		
R11	1000'± East of Halaulani Pl.-Wainaku St. Inter. (LT.)	SIDEWALK CLOSED		8 L.F. EA.	
	1000'± East of Halaulani Pl.-Wainaku St. Inter. (RT.)	SIDEWALK CLOSED		8 L.F. EA.	
R11-2	1000'± East of Halaulani Pl.-Wainaku St. Inter. (C)	ROAD CLOSED			20 L.F.

ORIGINAL PLAN	SURVEY PLOTTED BY	DATE
DRAWN BY		
DESIGNED BY		
CHECKED BY		
IN CHARGE		

STATE OF HAWAII
DEPARTMENT OF TRANSPORTATION
HIGHWAYS DIVISION

TRAFFIC CONTROL PLAN
HALAULANI PLACE
REMOVAL OF HALAULANI BRIDGE
Hawaii Belt Road
Federal Aid Project No. BR-019-2(50)
Scale: AS NOTED
Date: July, 2006

SHEET No. T2 OF 3 SHEETS

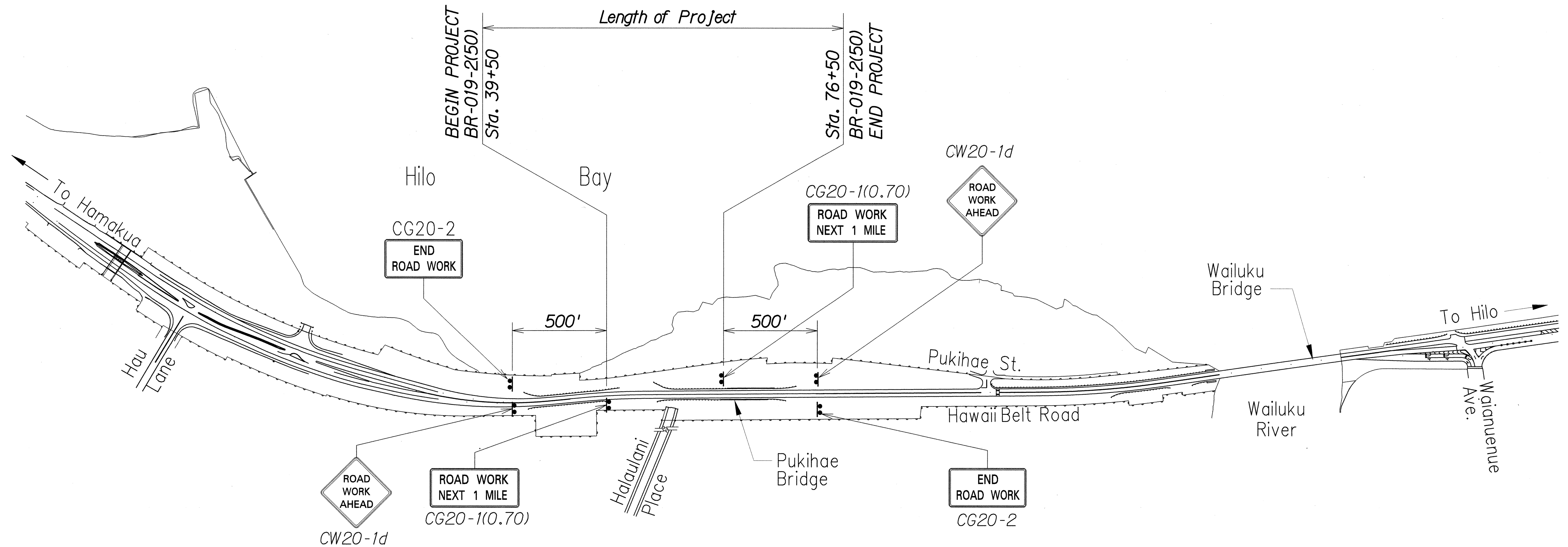
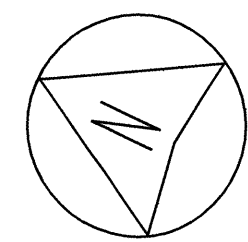

CONSTRUCTION SIGN PLAN
Not To Scale

CONSTRUCTION SIGN SCHEDULE					
PROJECT NO.	STATION	LEFT	RIGHT	ITEM No. 645.0100 (no posts)	ITEM No. 645.0100 (two posts)
SDR 3(1)	34+50	●			CG20-2
	34+50		●		CW20-1d
	39+50		●		CG20-1(0.70)
	76+50	●			CG20-1(0.70)
	81+50	●			CW20-1d
	81+50		●		CG20-2
Total Construction Signs					6

* Final locations of all signs to be determined in the field by the Engineer .

NOTES:

- (1) CW20-1d signs shall read "ROAD WORK AHEAD ".
- (2) CG20-1(0.70) signs shall read "ROAD WORK NEXT 1 MILE ".
- (3) CG20-2 signs shall read "END ROAD WORK ".
- (4) One set of Construction Signs will be paid on a Lump Sum Basis under Pay Item No.645.0100

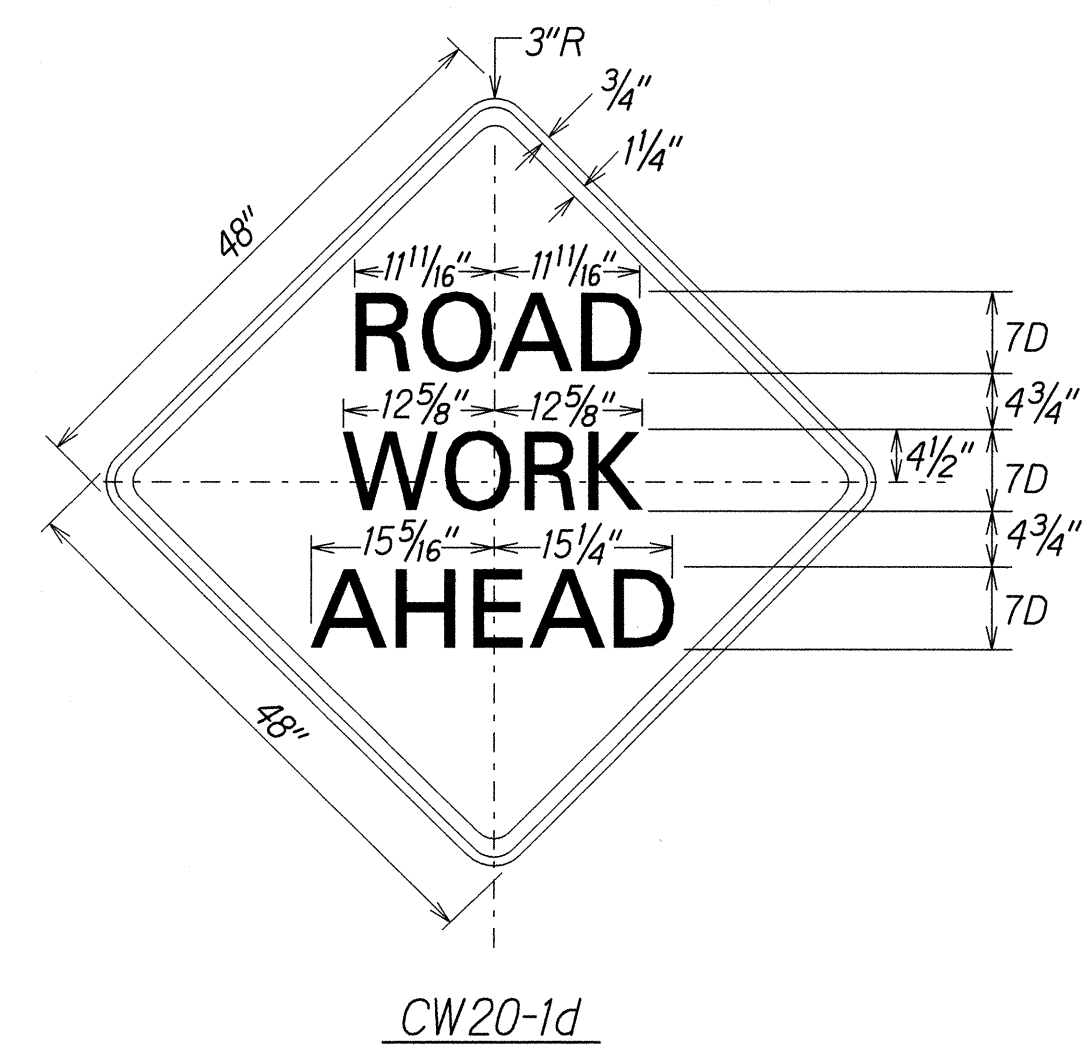
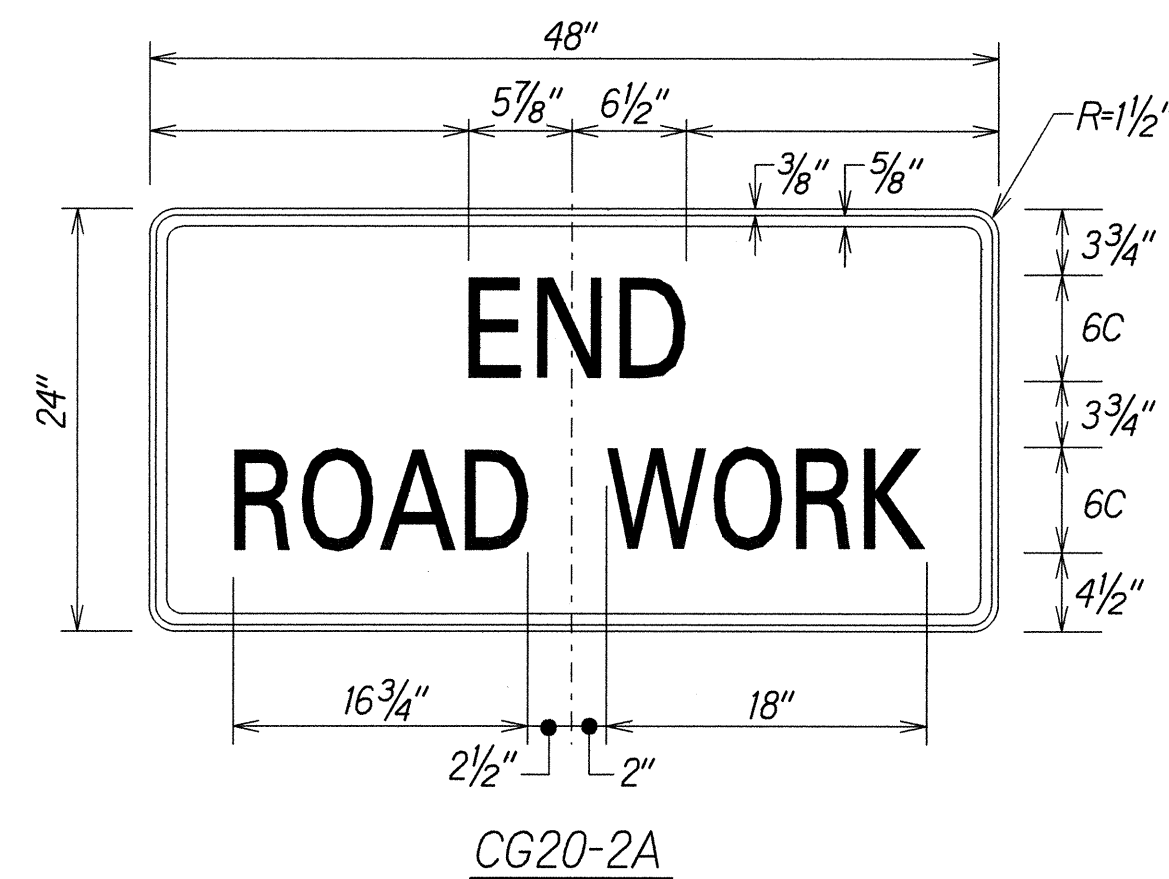

SIGN DETAILS
Not To Scale

STATE OF HAWAII
DEPARTMENT OF TRANSPORTATION
HIGHWAYS DIVISION

CONSTRUCTION SIGN
PLAN AND SCHEDULE

REMOVAL OF HALAULANI BRIDGE
Hawaii Belt Road
Federal Aid Project No. BR-019-2(50)

Scale: AS NOTED Date: July, 2006

SHEET No. T3 OF 3 SHEETS