

FED. ROAD DIST. No.	STATE	FED. AID PROJ. No.	FISCAL YEAR	SHEET No.	TOTAL SHEETS
HAWAII	HAW	BF-011-20	1959	10	36

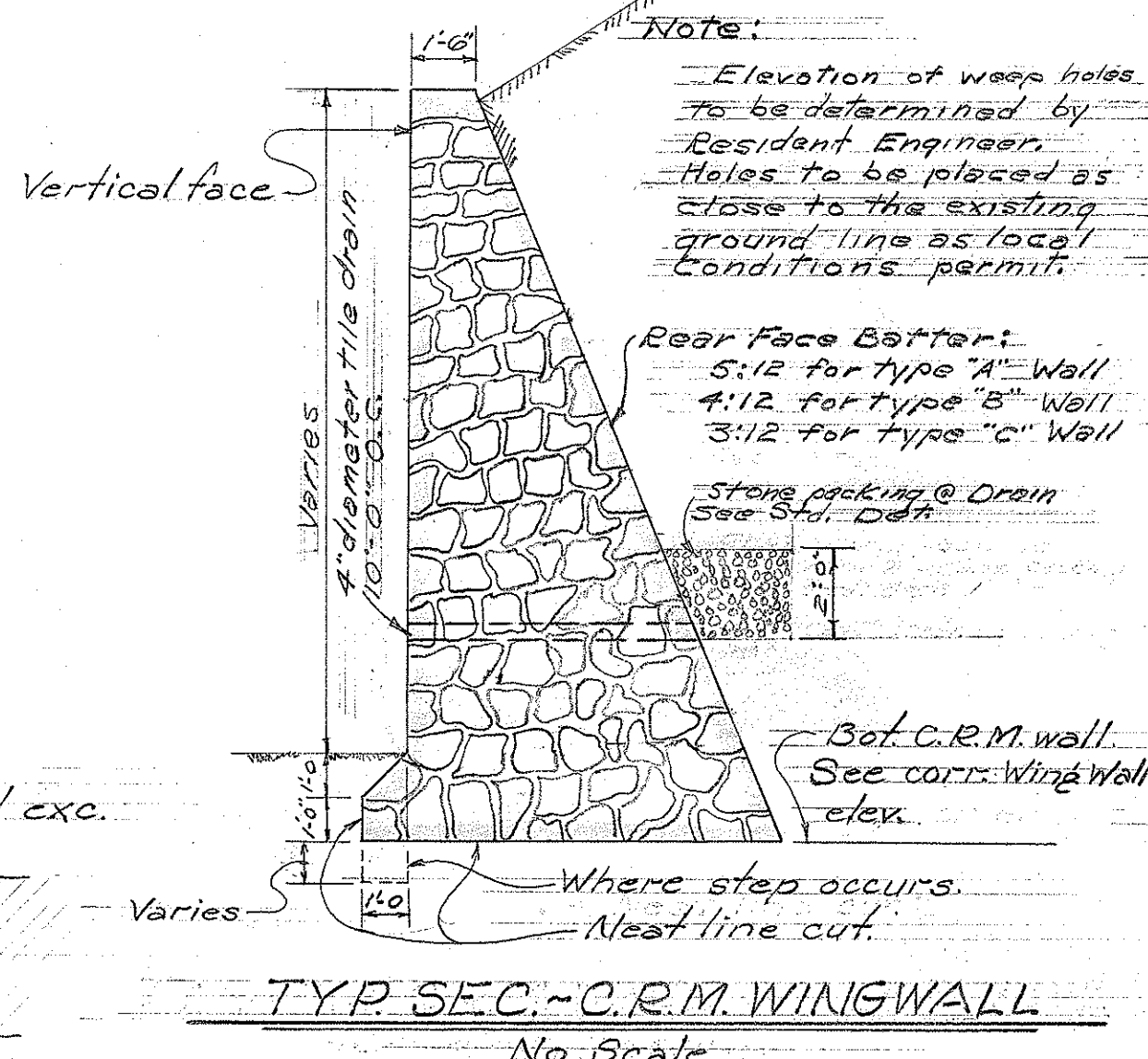
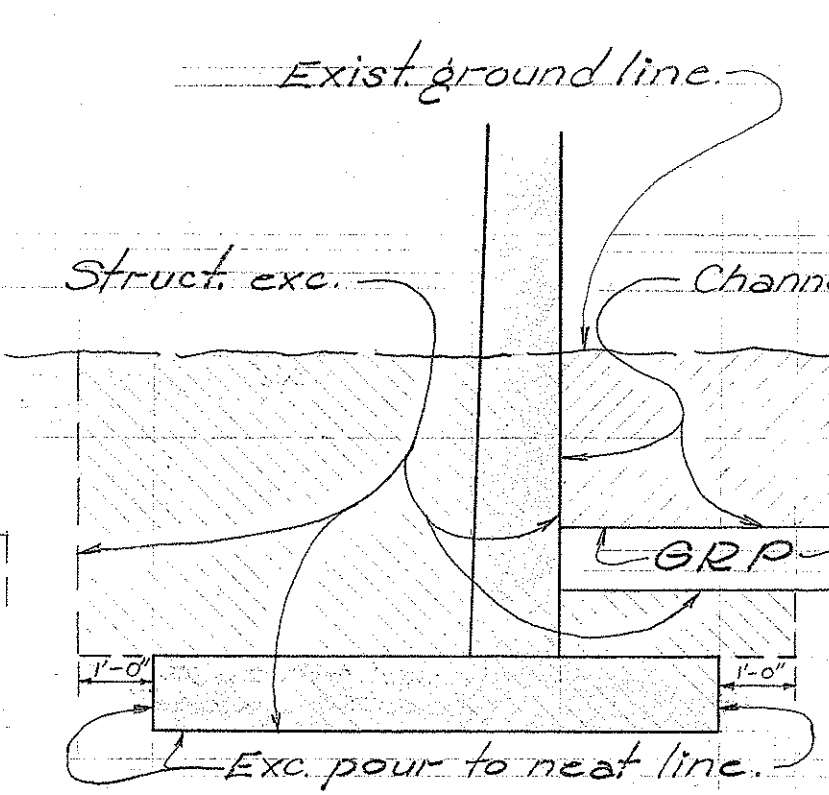
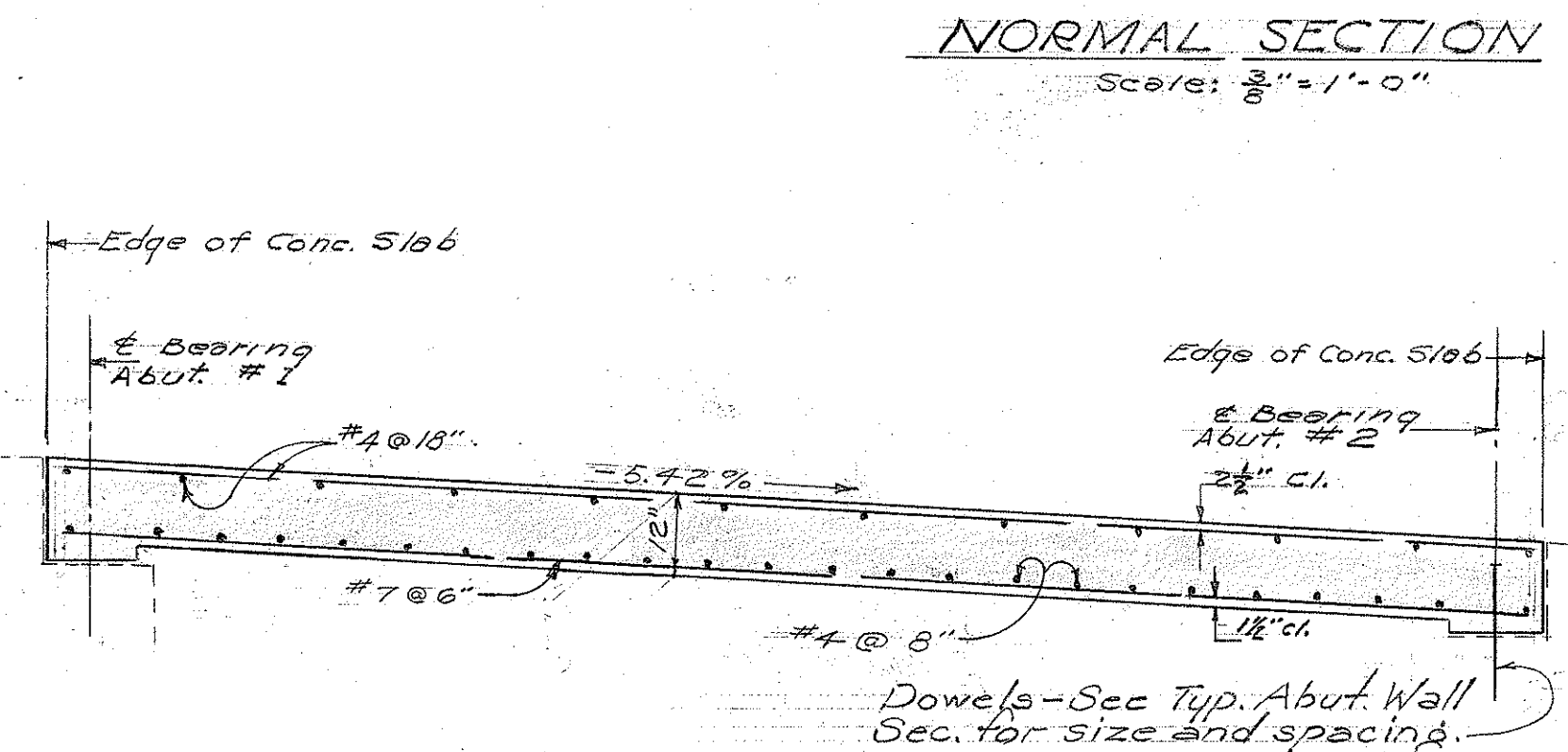
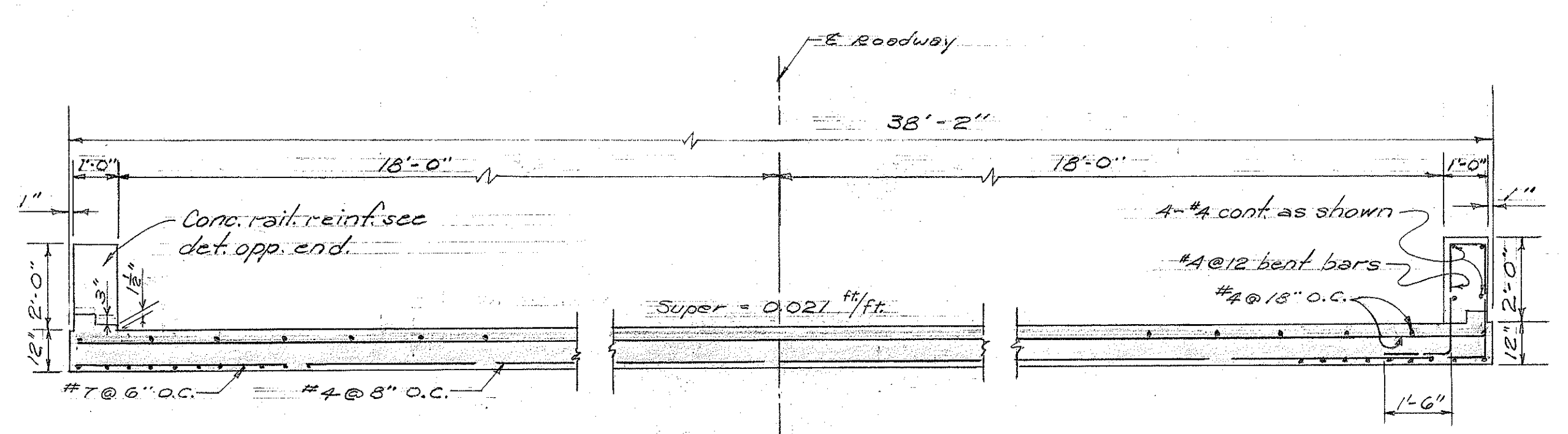
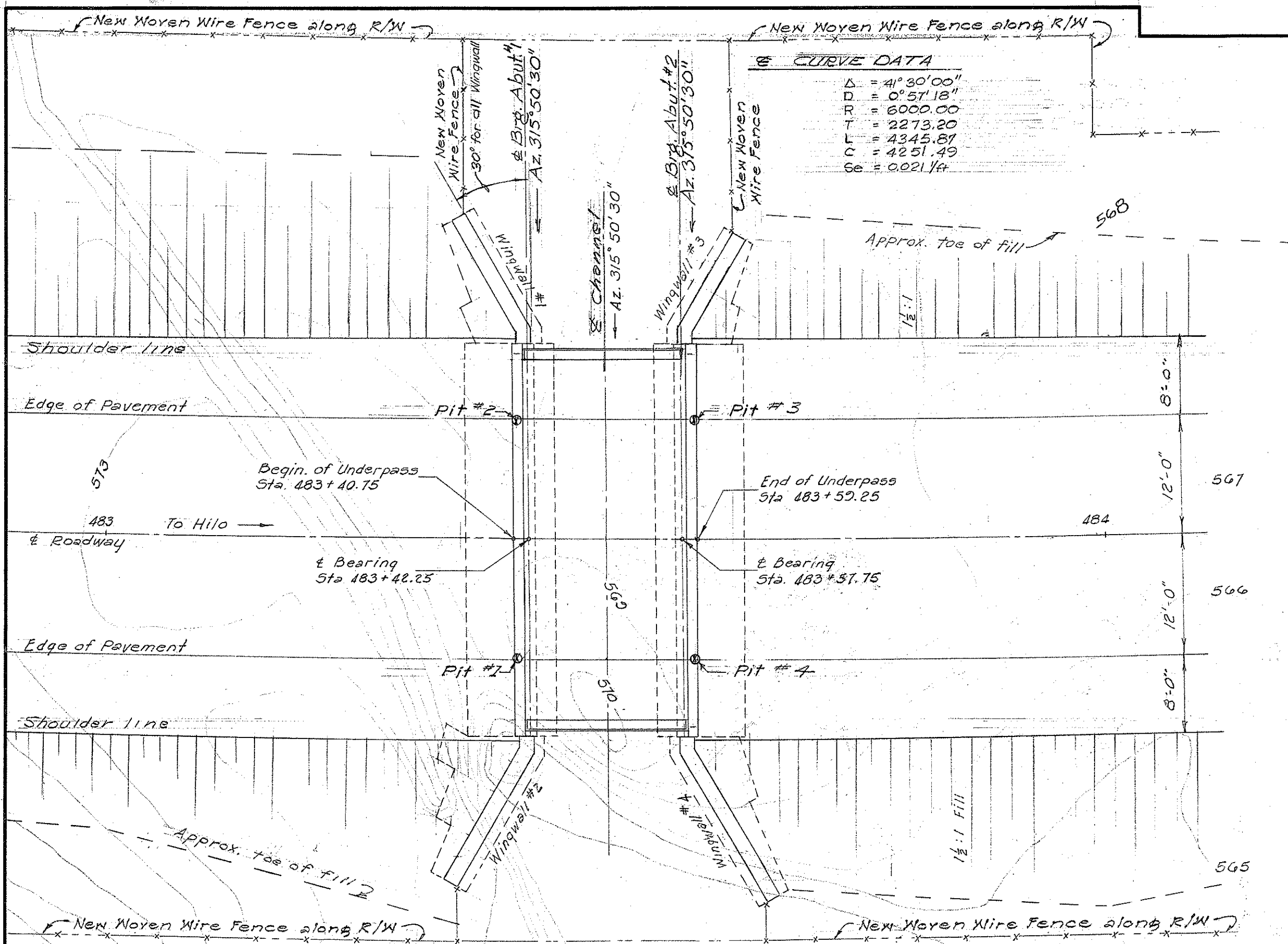

GENERAL NOTES

Materials
 Concrete: All concrete shall be Class A-1.
 Reinforcing Steel: See Std. Bridge Det. Admixtures:
 Admixture of "Pozzolith" or approved equal shall be added to concrete in accordance with the Special Provisions.

Construction Method:
 Backfill Behind Abutments:
 All backfill behind abutments shall be completed in place before concrete for the superstructure is poured.

Reinforcing Bars: Reinforcing shall be poured after the release of the superstructure falsework.

Neat Line Excavation: Footings shall be excavated and poured to neat lines. In case of overexcavation, the space between the footing and the ground shall be filled with Class D-1 concrete at the Contractor's expense.

ESTIMATED QUANTITIES

CLASS A-1 CONC.	LUMP SUM (125 Cu. Yd.)
REINF. STEEL	LUMP SUM (16,600 lb.)
C.R.M.	74 Cu. Yd.
GRP	44 Cu. Yd.
STRUCT. EXC.	192 Cu. Yd.
CHANNEL EXC.	25 Cu. Yd.
FILTER MAT.	46 Cu. Yd.

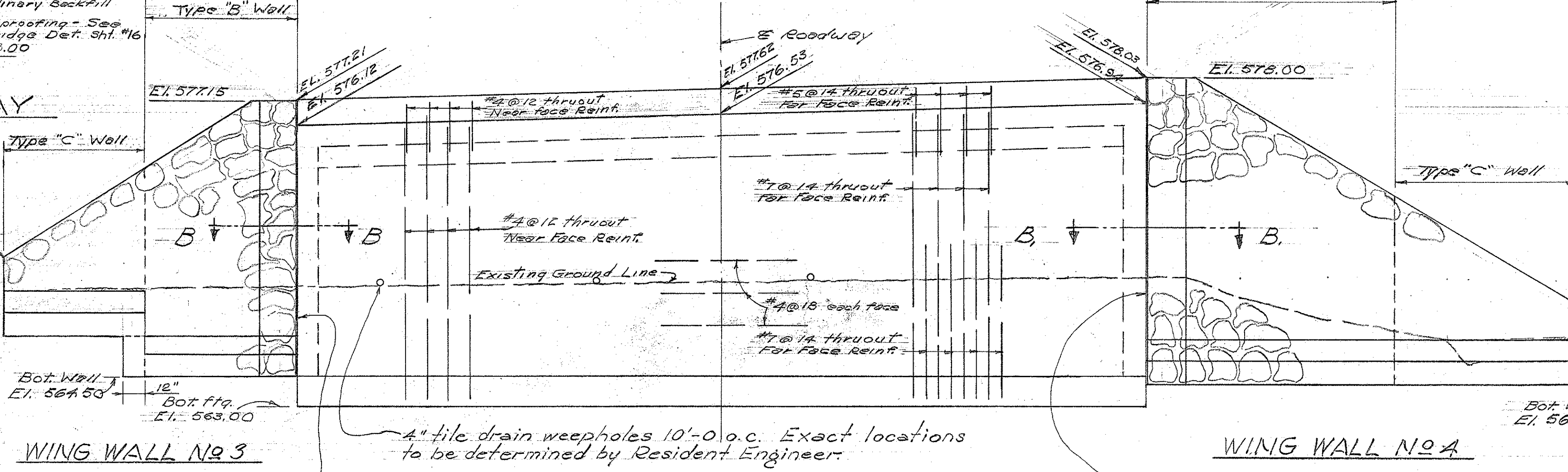
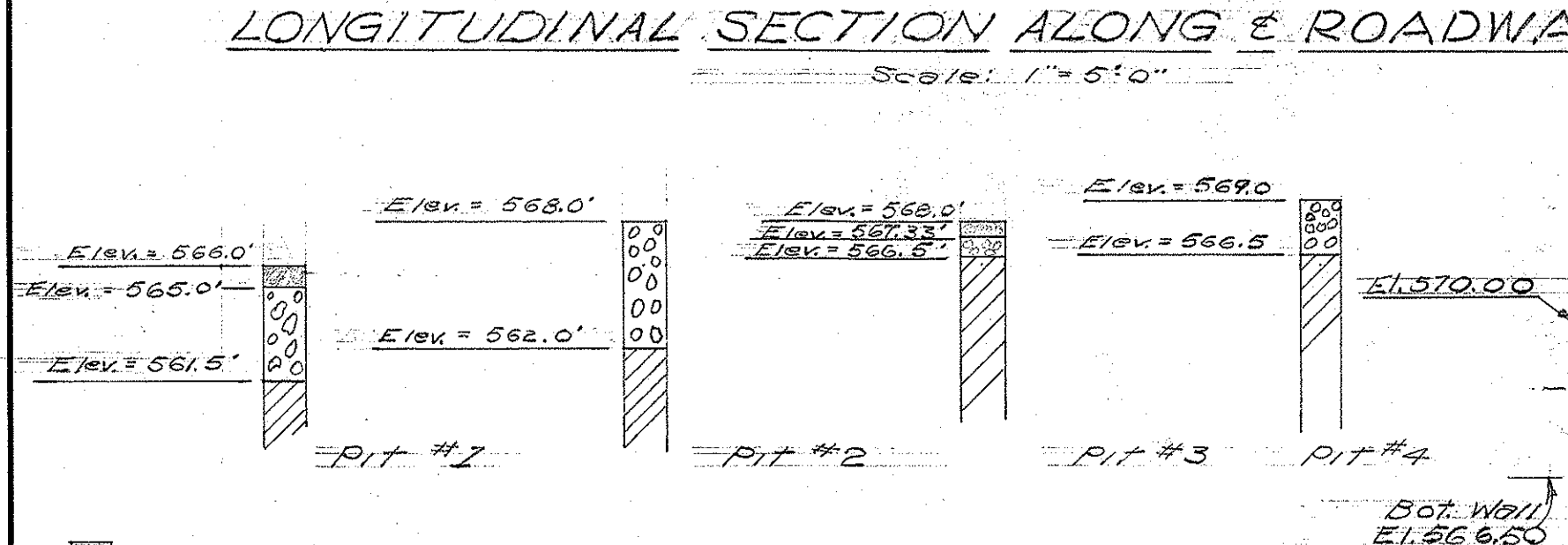
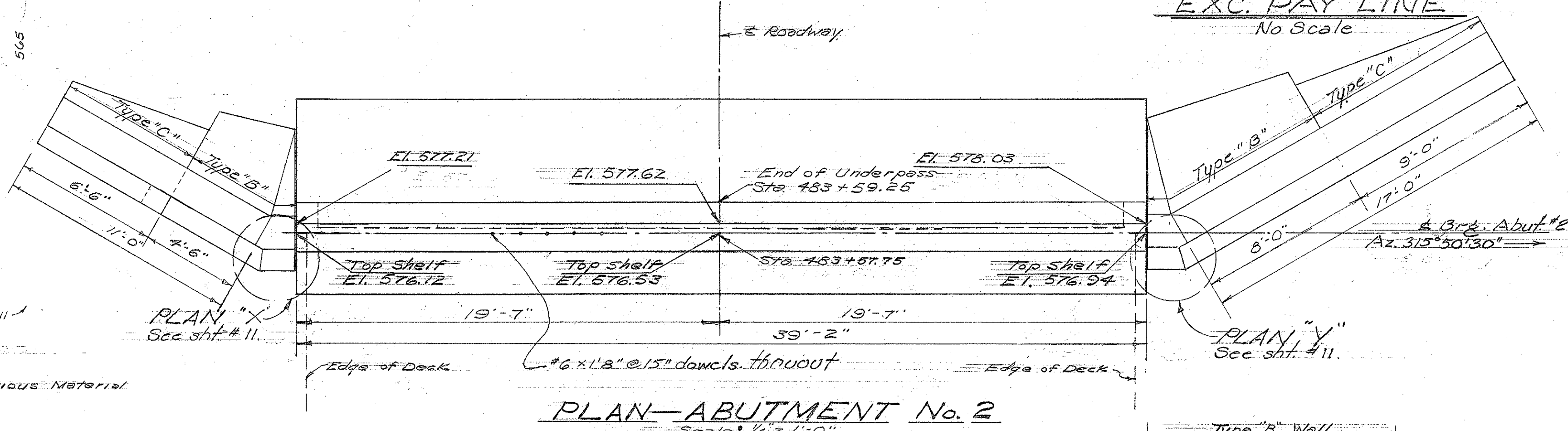
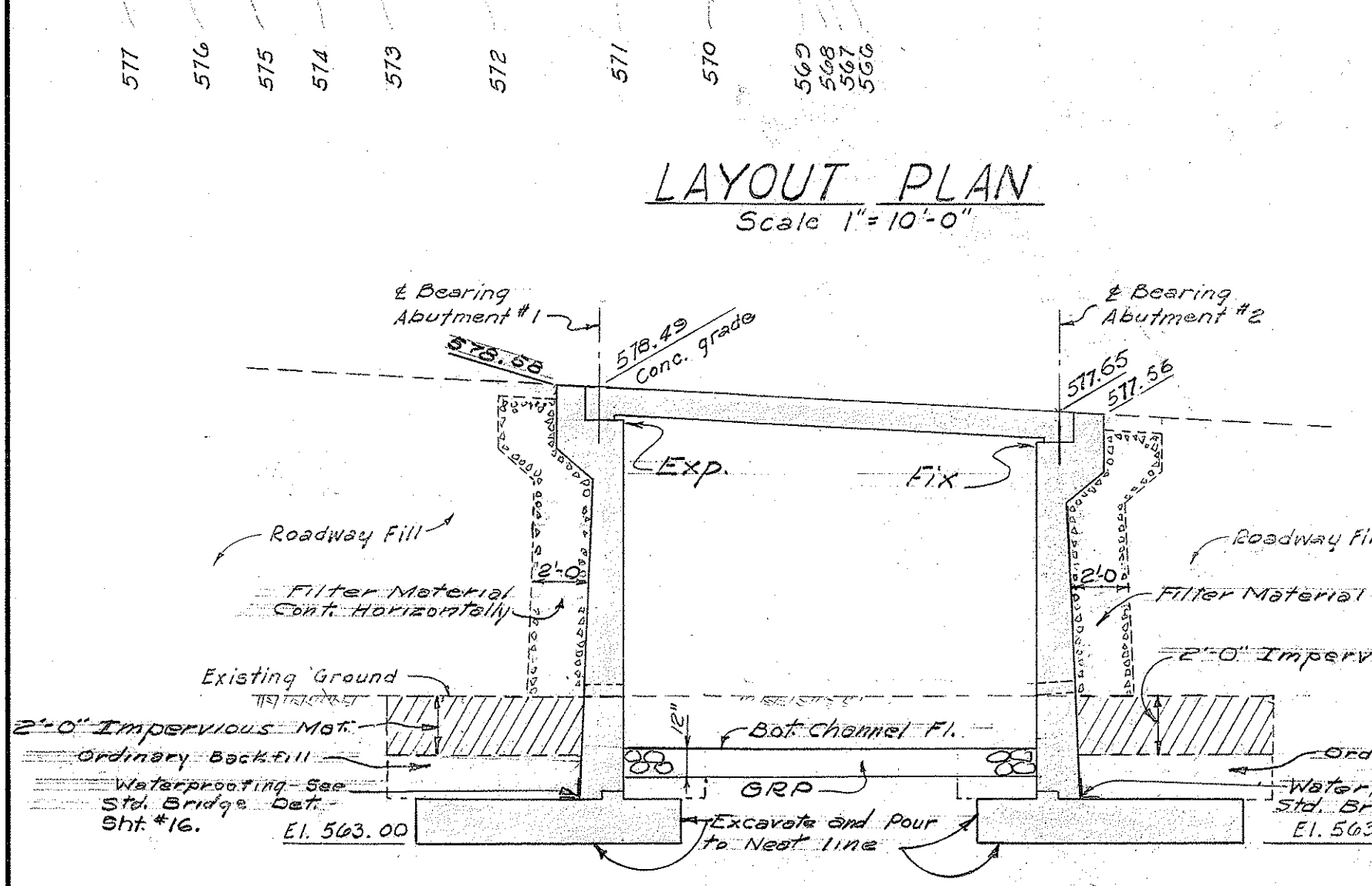

HAWAII STATE HIGHWAY DEPARTMENT
 STATE OF HAWAII

CATTLE UNDERPASS
 Sta. 483+40.75 to Sta. 483+59.25
 HAWAII BELT ROAD - PROJ. No. BF-011-2(1)

FED. ROAD DIST. NO.	STATE	FED. AID PROJ. NO.	FISCAL YEAR	SHEET NO.	TOTAL SHEETS
HAWAII	HAW	BF-011-80	1959	11	36

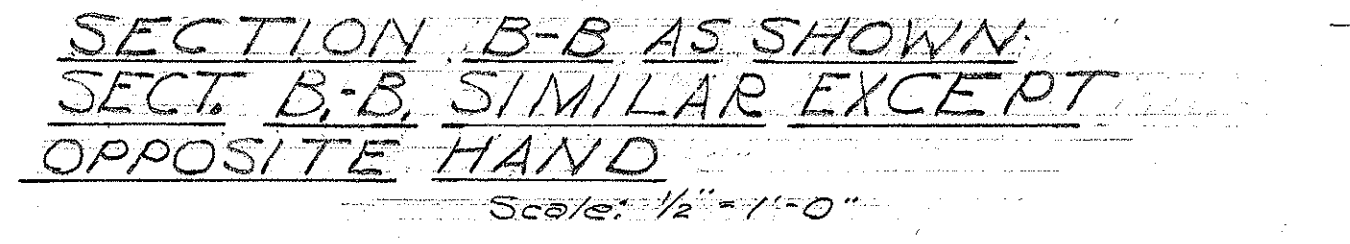
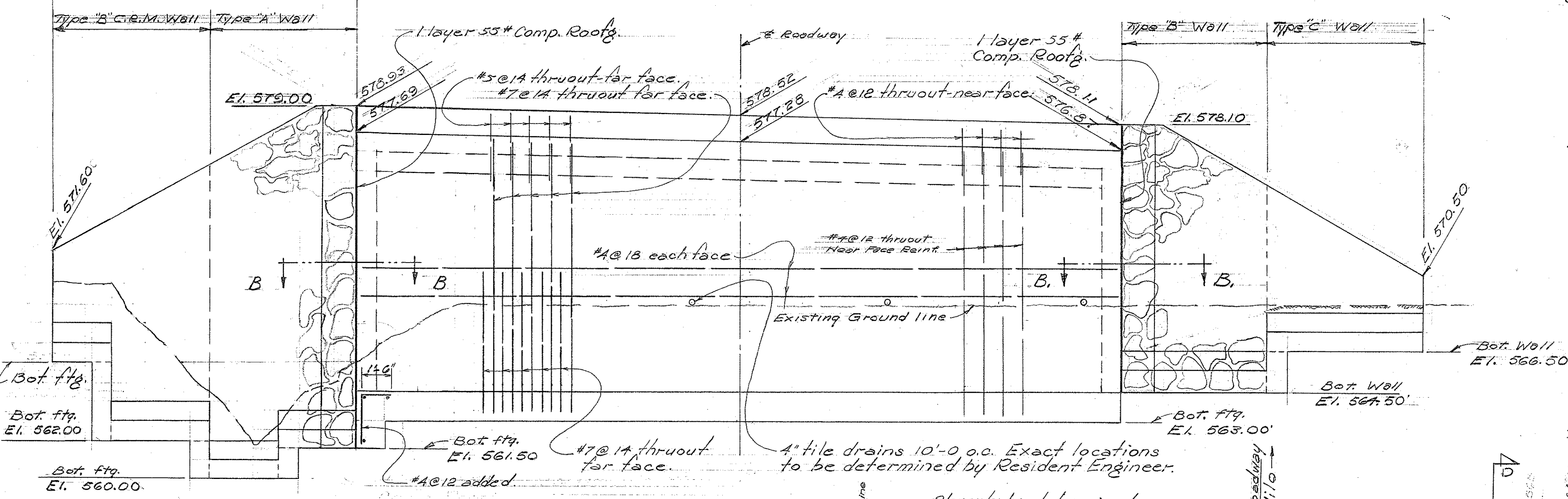
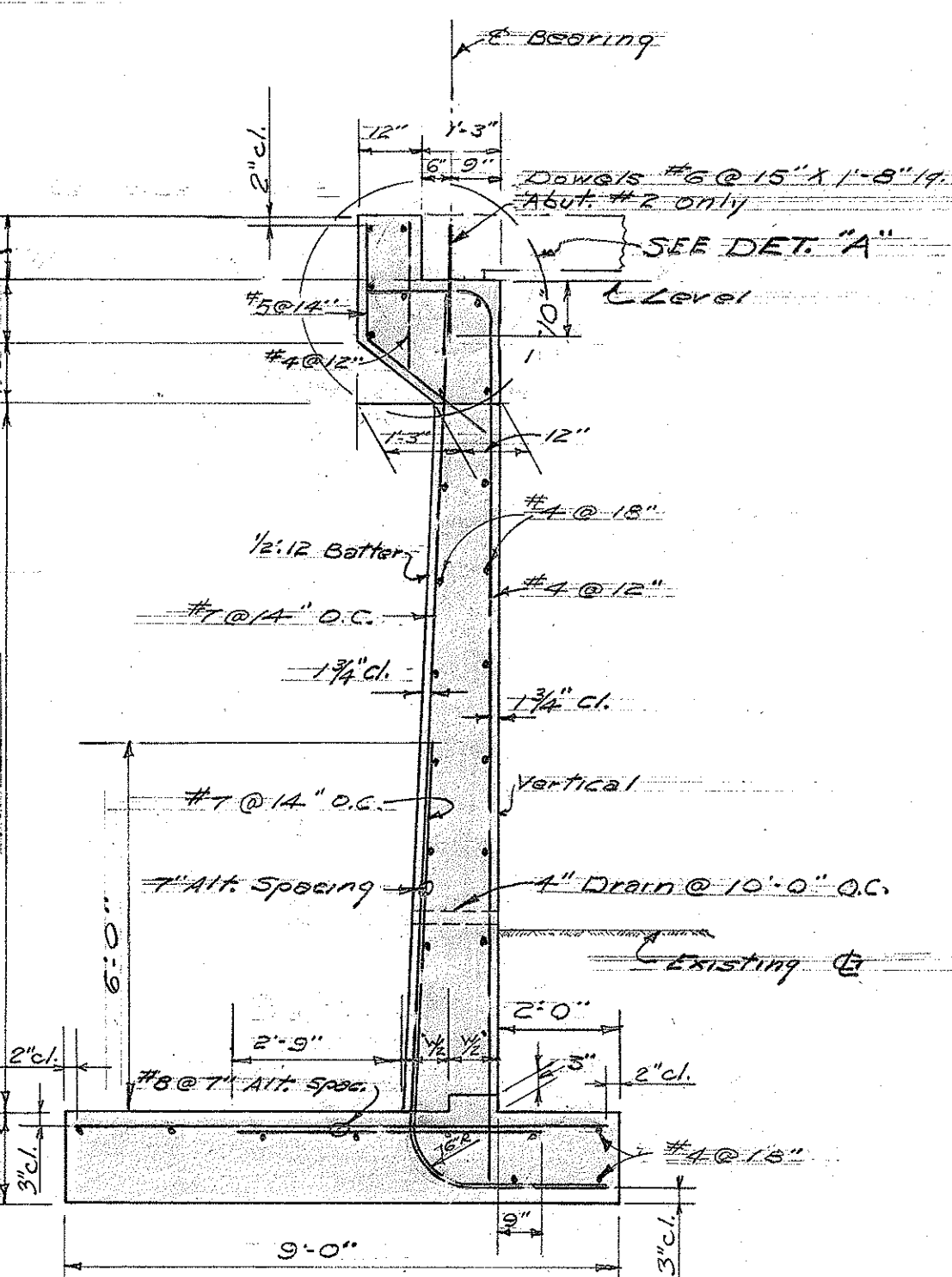
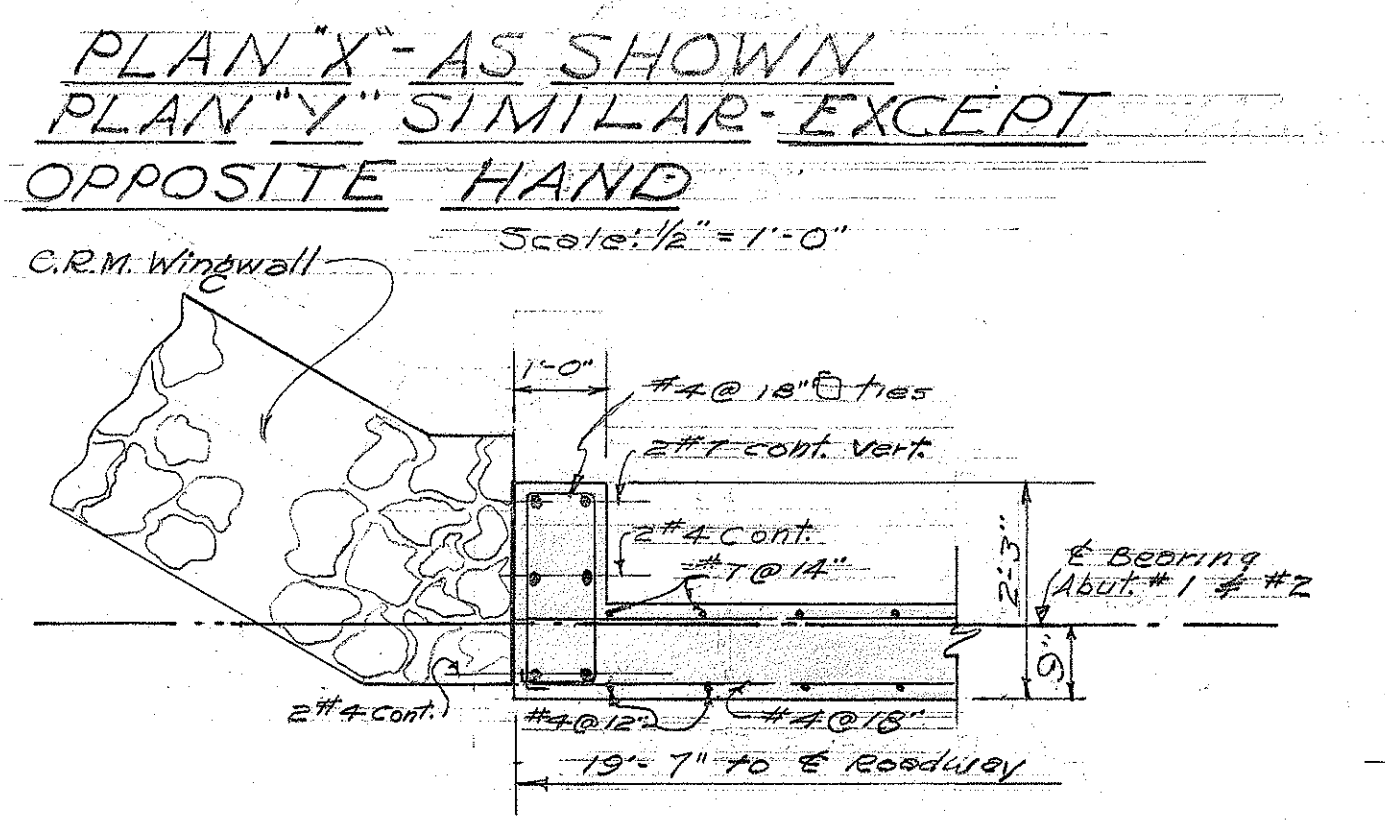
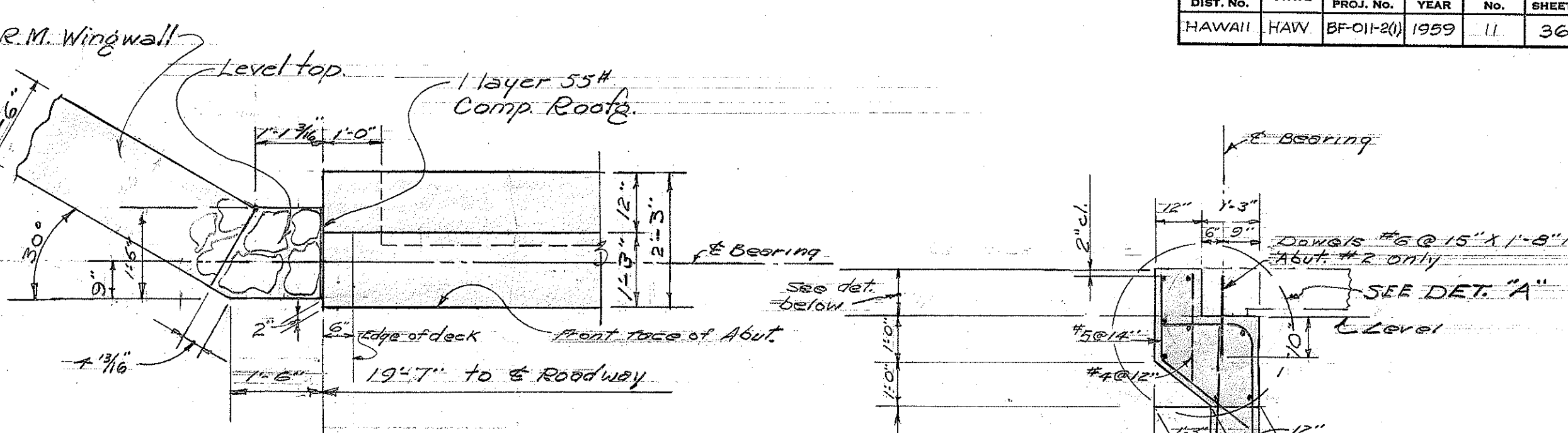
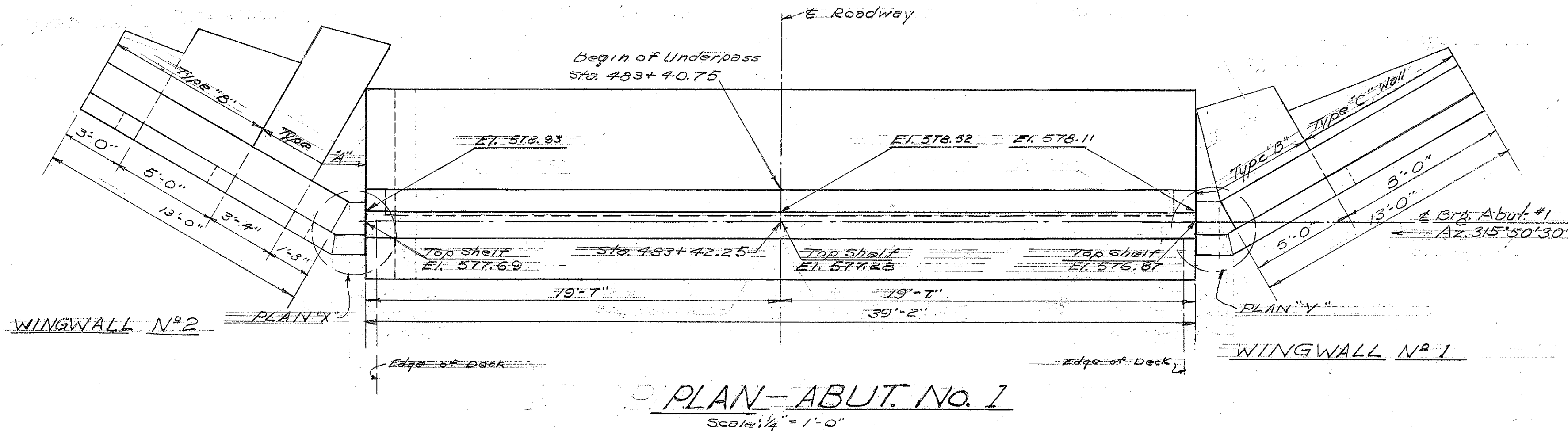

TYP. ABUT. WALL SECTION
Scale: $\frac{3}{8}$ " = 1'-0"

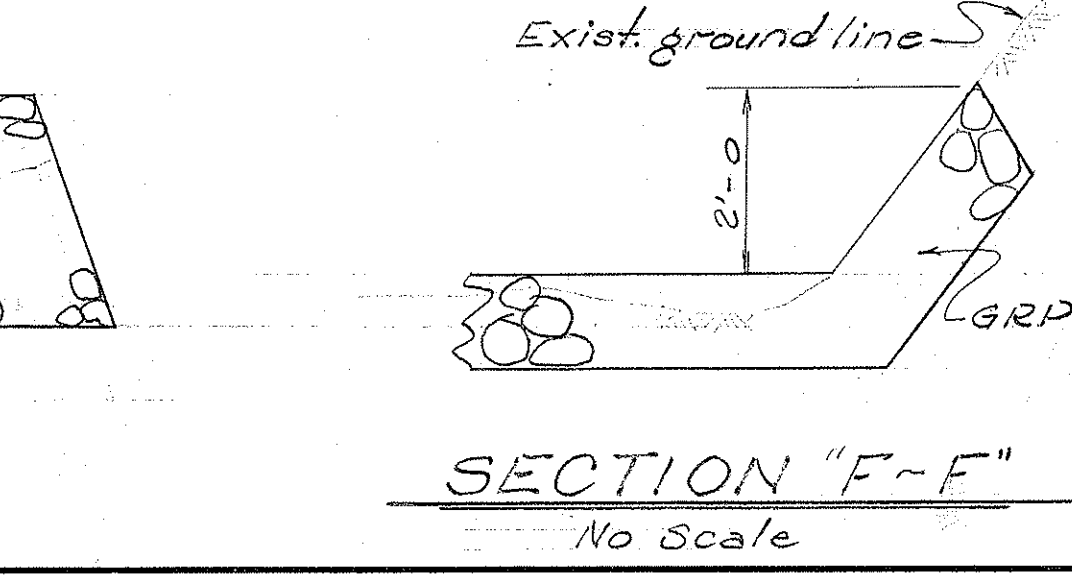
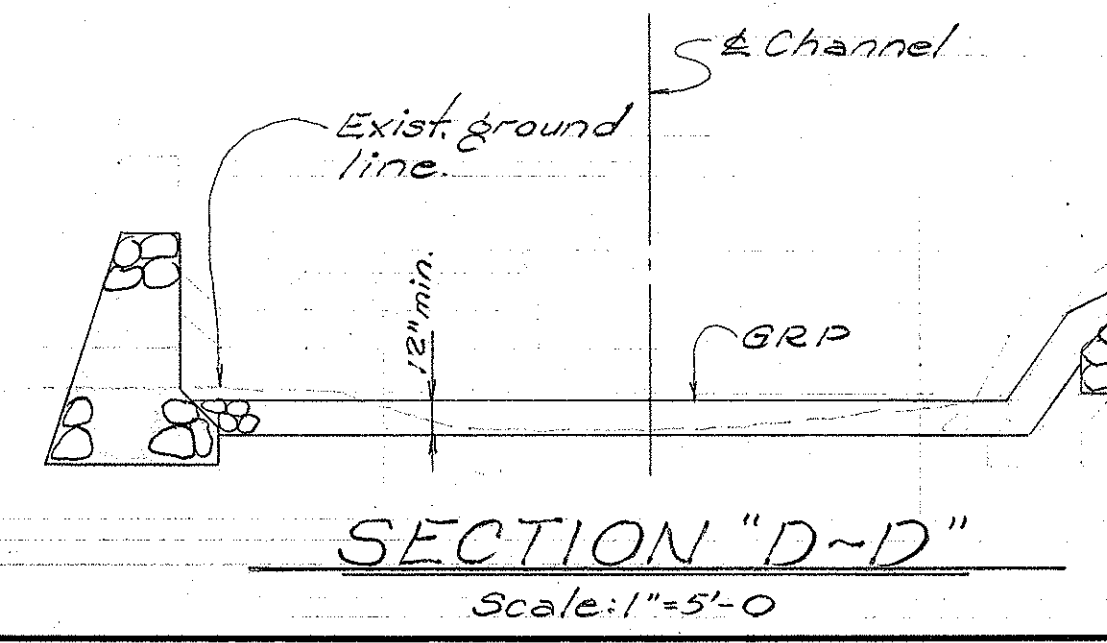
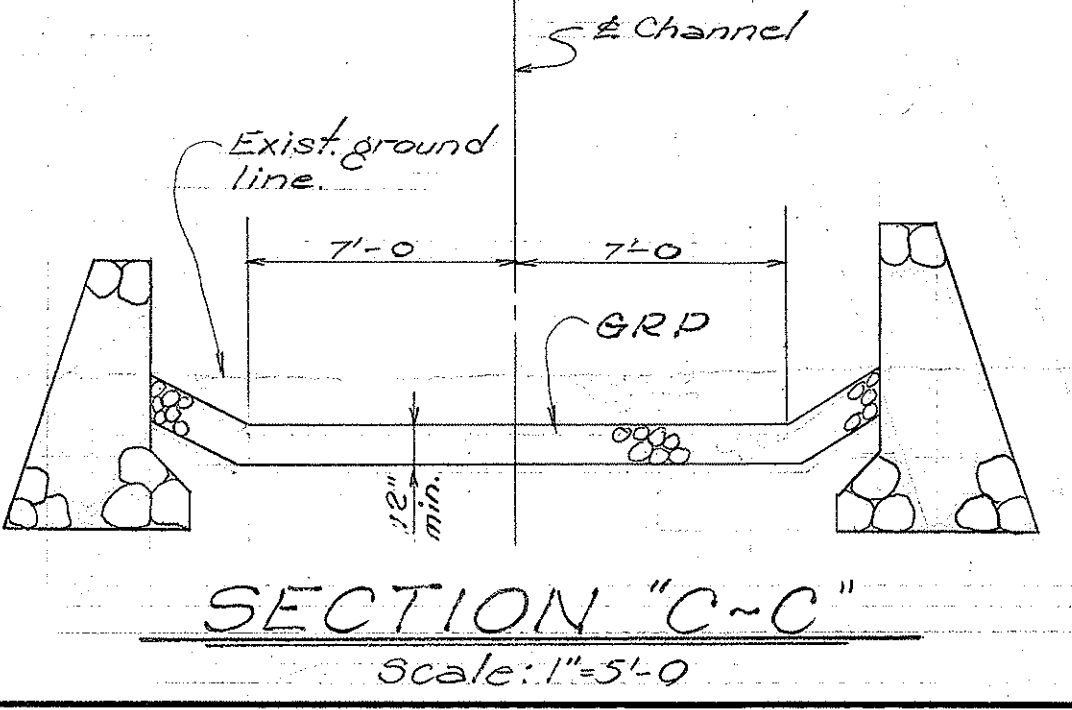
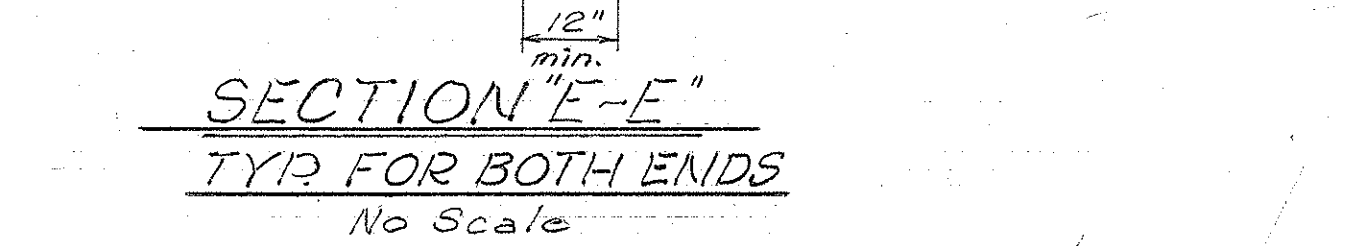
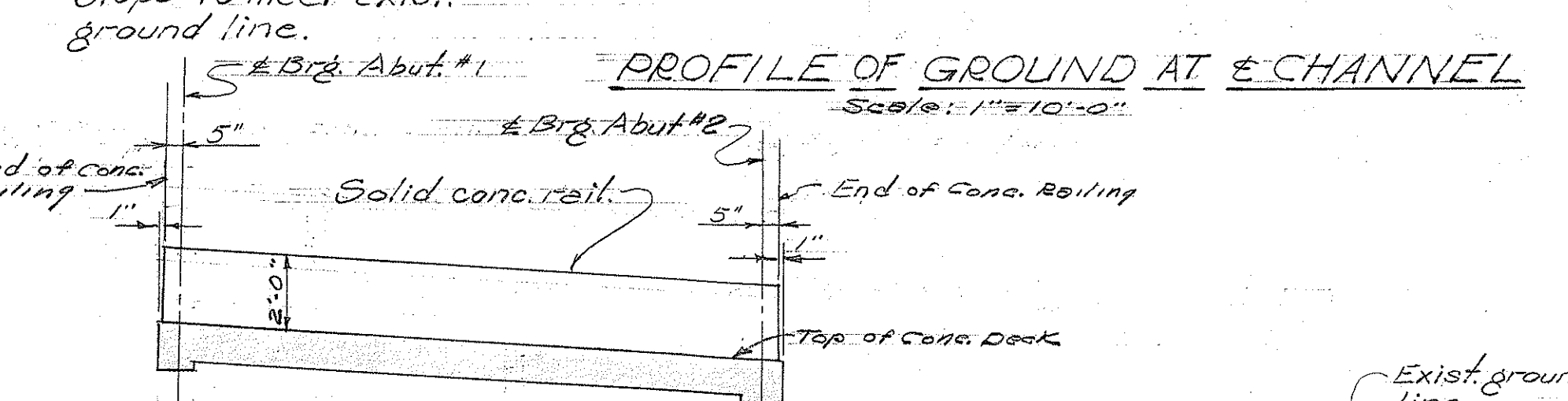
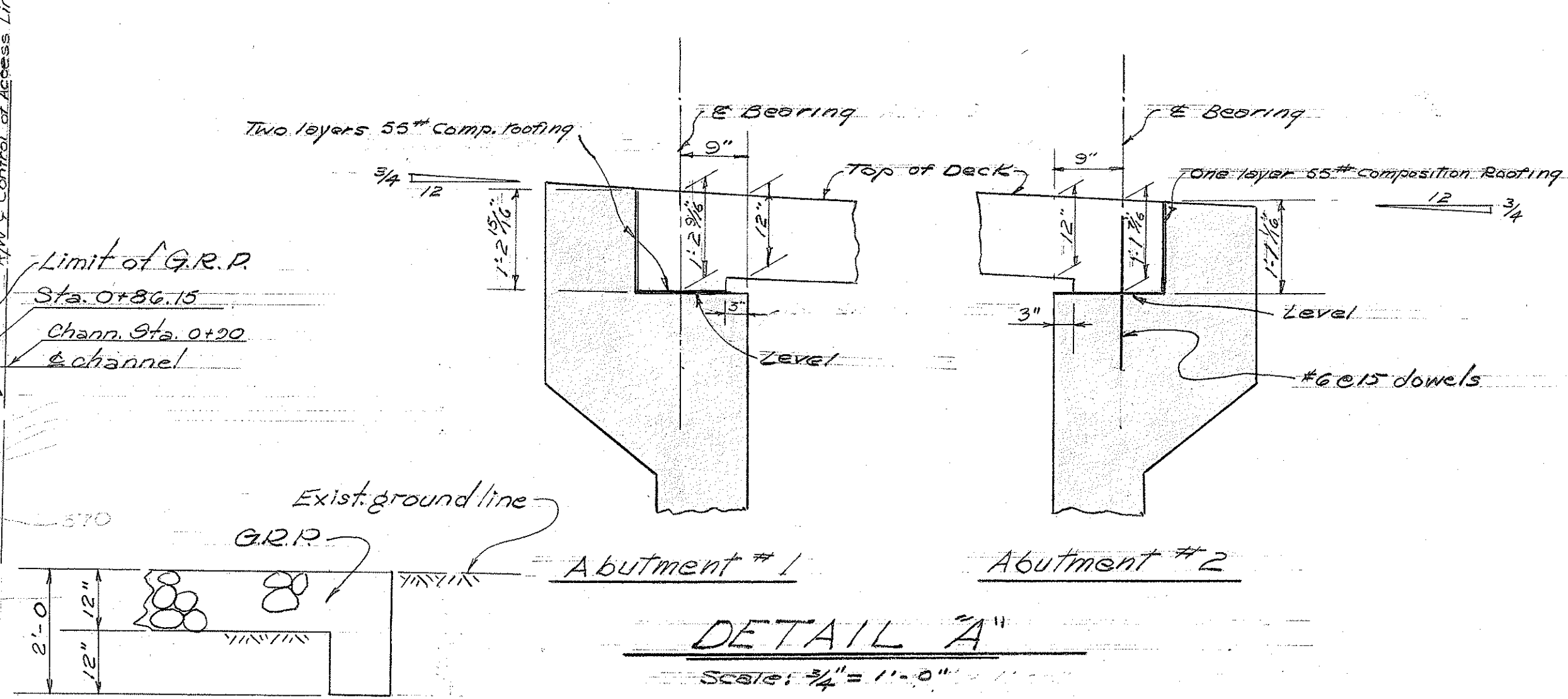
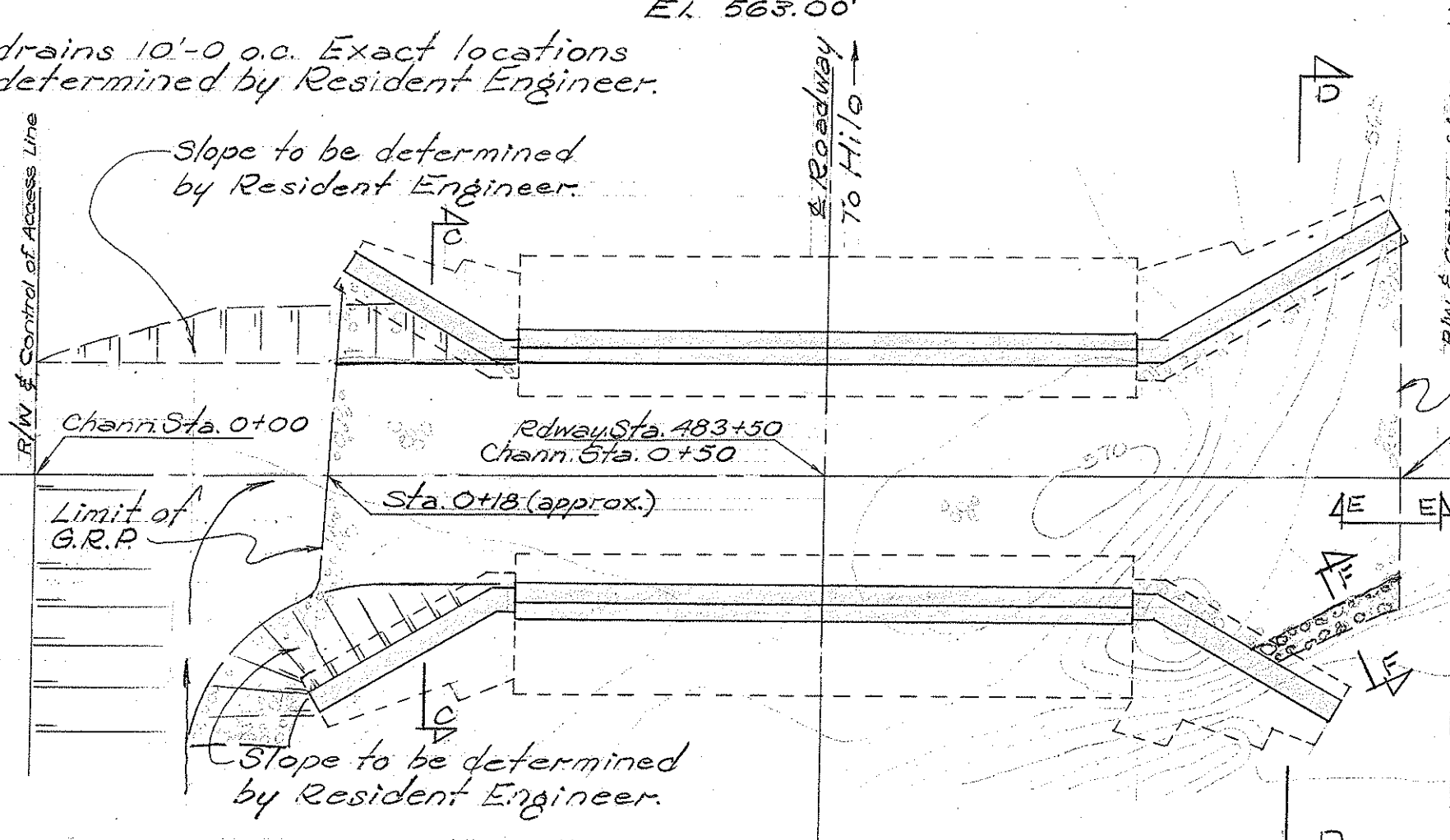
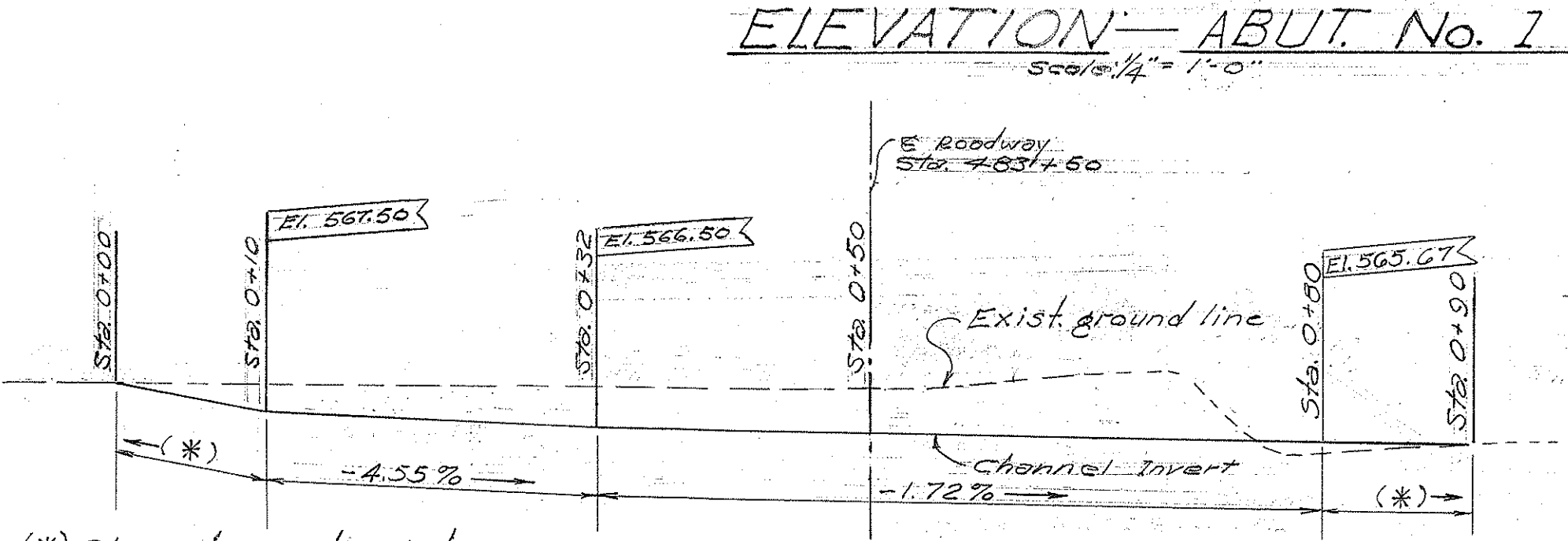

HAWAII STATE HIGHWAY DEPARTMENT
STATE OF HAWAII
CATTLE UNDERPASS
Sta. 483+40.75 to Sta. 483+59.25
HAWAII BELT ROAD PROJ. NO. BF-011-2(1)

DESIGNED BY	DATE
CHECKED BY	DATE
QUANTITIES BY	DATE
CHECKED BY	DATE
NO.	