

FED. ROAD DIST. NO.	STATE	PROJ. NO.	FISCAL YEAR	SHEET NO.	TOTAL SHEETS
HAWAII	HAW.	11A-01-02	2003	19	30

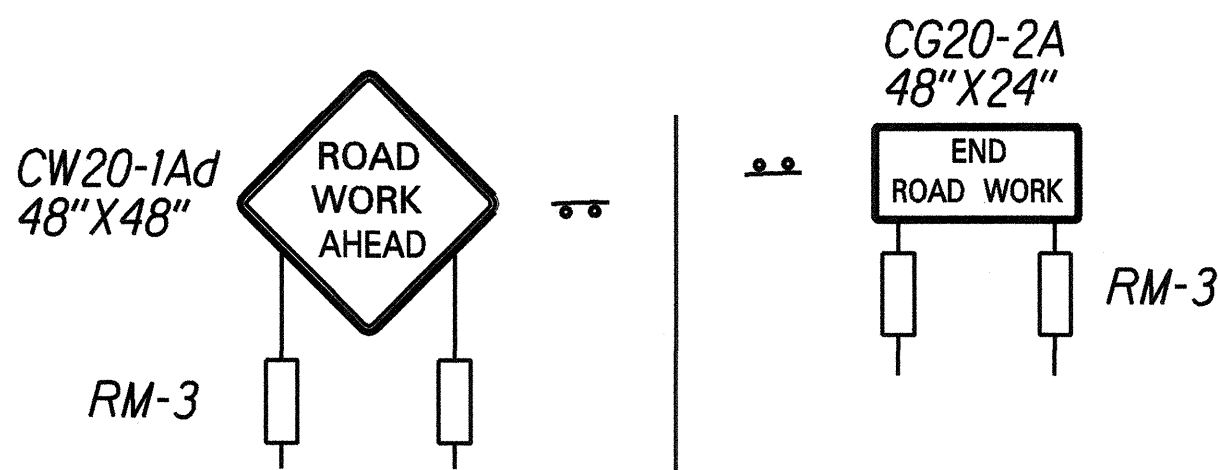

Note: RM-3 Signs Incidental to Construction Sign Posts

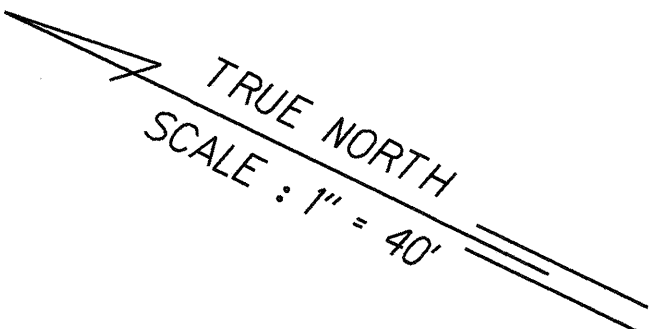
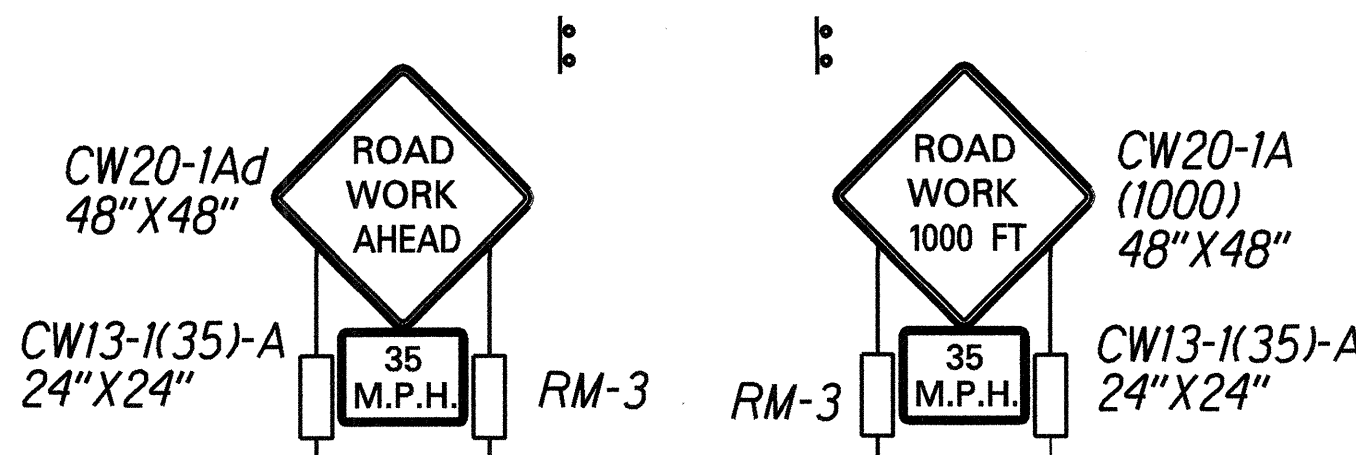
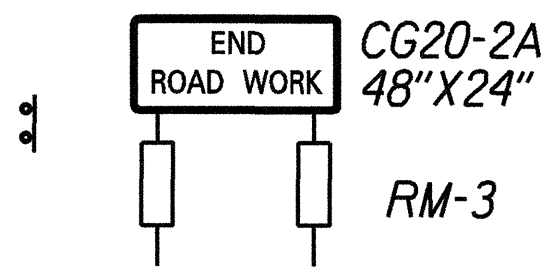
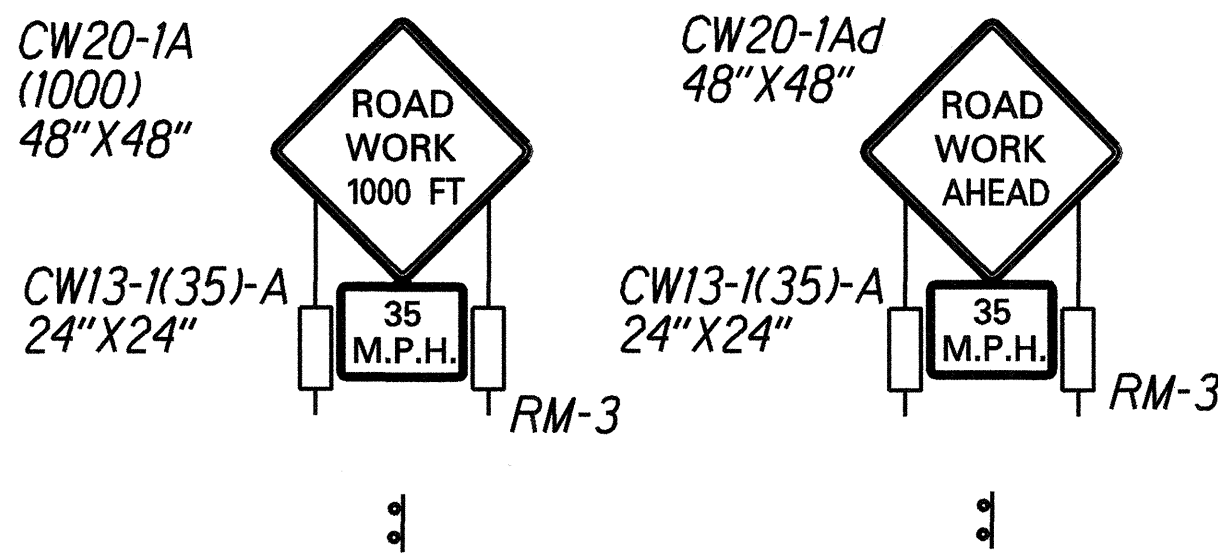

Construction Sign Schedule - Police Station Road				
Sta/Offset	Sign w/ Post	Amount	Sign w/o Post	Amount
75+00 RT	CW20-1A (1000)	1	CW13-1(35)A	1
75+00 LT	CG20-2A	1		
65+00 RT	CW20-1Ad	1	CW13-1(35)A	1
103+00 LT	CW20-1Ad	1	CW13-1(35)A	1
93+00 RT	CG20-2A	1		
93+00 LT	CW20-1A (1000)	1	CW13-1(35)A	1
1+15 RT S/RD	CG20-2A	1		
1+15 LT S/RD	CW20-1Ad	1		
Total		8	Total	4

Construction Sign Schedule - Hualalai Road				
Sta/Offset	Sign W/Post	Amount	Sign w/o Post	Amount
213+00 LT	CW20-1Ad	1	CW13-1(35)-A	1
203+00 LT	CW20-1A (1000)	1	CW13-1(35)-A	1
201+00 RT	CG20-2A	1		
168+00 RT	CW20-1Ad	1	CW13-1(35)-A	1
178+00 RT	CW20-1A (1000)	1	CW13-1(35)-A	1
183+00 LT	CG20-2A	1		
8+00 RT S/RD	CG20-2A	1		
8+00 LT S/RD	CW20-1Ad	1		
Total		8	Total	4

TYPICAL DIAGRAM FOR CONSTRUCTION SIGN LAYOUT

ORIGINAL PLAN	SURVEY PLOTTED BY	DATE
NOTE BOOK	DRAWN BY	
	DESIGNED BY	
	CHECKED BY	
	APPROVED BY	



THIS WORK WAS PREPARED BY ME OR UNDER MY SUPERVISION

FUJITA & ASSOCIATES, INC.

STATE OF HAWAII
DEPARTMENT OF TRANSPORTATION
HIGHWAYS DIVISION

CONSTRUCTION SIGN PLAN

Hawaii Belt Road
Intersection Improvements
At Police Station Road and Hualalai Road
Project No. 11A-01-02

Scale: 1"=40' Date: Dec., 2002

SHEET No. CSPI OF 1 SHEETS