

FED. ROAD DIST. NO.	STATE	PROJ. NO.	FISCAL YEAR	SHEET NO.	TOTAL SHEETS
HAWAII	HAW.	11M-01-00	2002	25	65

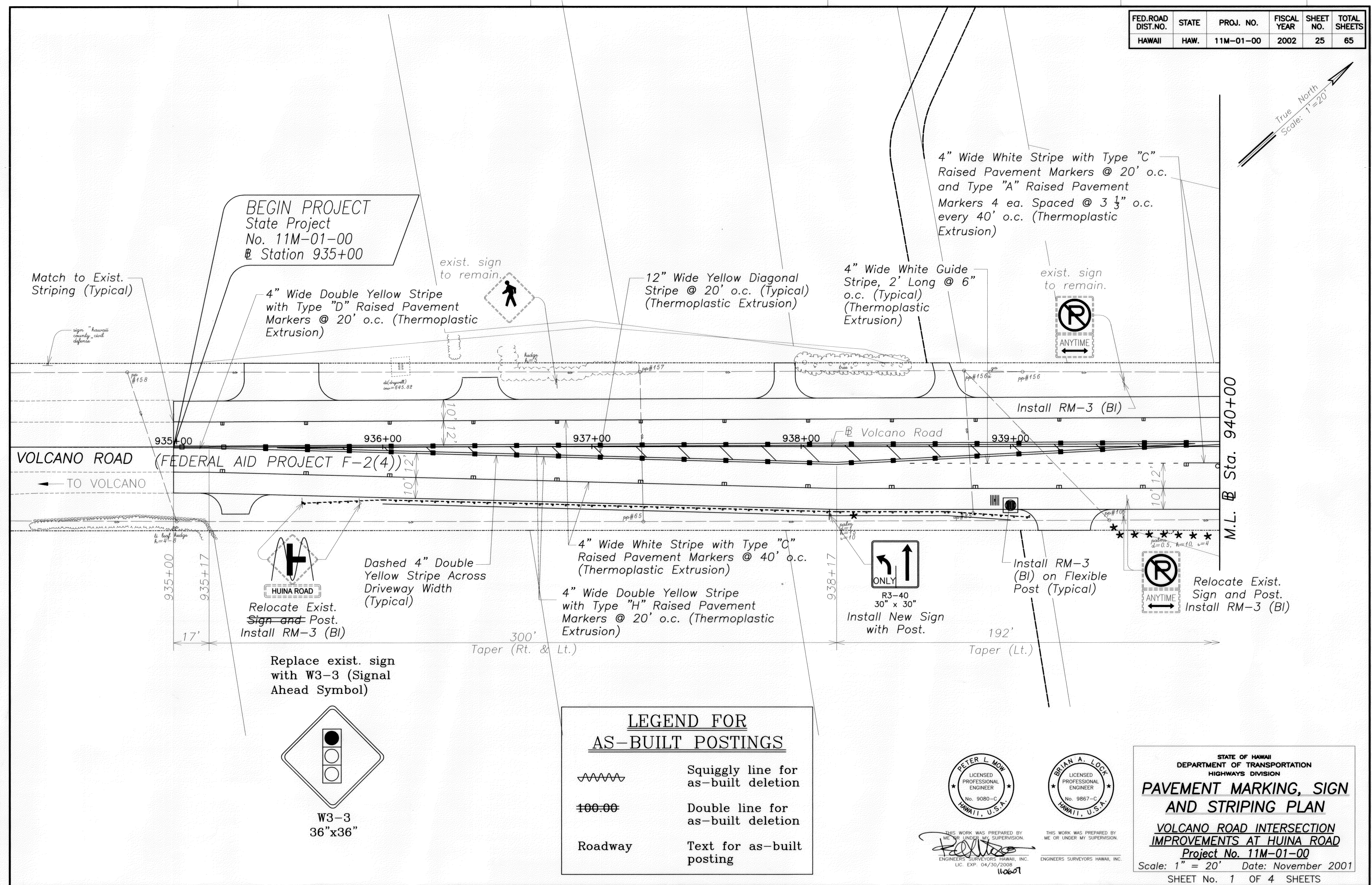
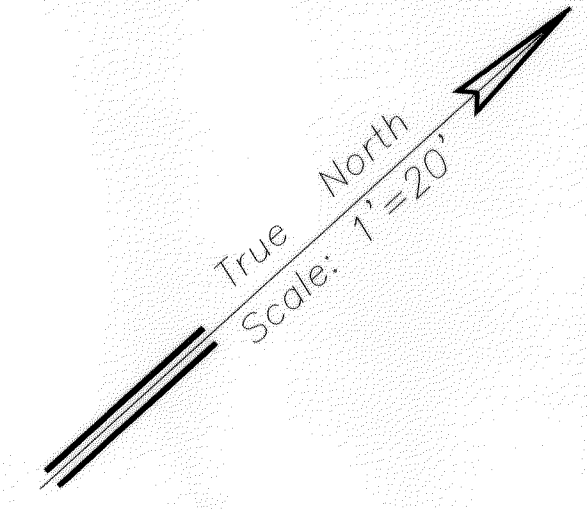

SURVEY PLOTTED BY	DATE
DESIGNED BY	
QUANTITIES BY	
CHECKED BY	
ORIGINAL PLAN	
NOTE BOOK	
PRINTED BY	
NO.	

BEGIN PROJECT
 State Project
 No. 11M-01-00
 Station 935+00

**LEGEND FOR
 AS-BUILT POSTINGS**

Squiggly line for as-built deletion

Double line for as-built deletion

Roadway Text for as-built posting

W3-3
 36"x36"

THIS WORK WAS PREPARED BY ME OR UNDER MY SUPERVISION.
 ENGINEERS SURVEYORS HAWAII, INC.
 LIC. EXP. 04/30/2008
 110601

THIS WORK WAS PREPARED BY ME OR UNDER MY SUPERVISION.
 ENGINEERS SURVEYORS HAWAII, INC.

STATE OF HAWAII
 DEPARTMENT OF TRANSPORTATION
 HIGHWAYS DIVISION
**PAVEMENT MARKING, SIGN
 AND STRIPING PLAN**
**VOLCANO ROAD INTERSECTION
 IMPROVEMENTS AT HUINA ROAD**
 Project No. 11M-01-00
 Scale: 1" = 20' Date: November 2001
 SHEET No. 1 OF 4 SHEETS

FED. ROAD DIST. NO.	STATE	PROJ. NO.	FISCAL YEAR	SHEET NO.	TOTAL SHEETS
HAWAII	HAW.	11M-01-00	2002	26	65

LEGEND FOR AS-BUILT POSTINGS

	Squiggly line for as-built deletion
	Double line for as-built deletion
Roadway	Text for as-built posting

Note:
See Sheet 11, "Geometric Layout - Huina Road".

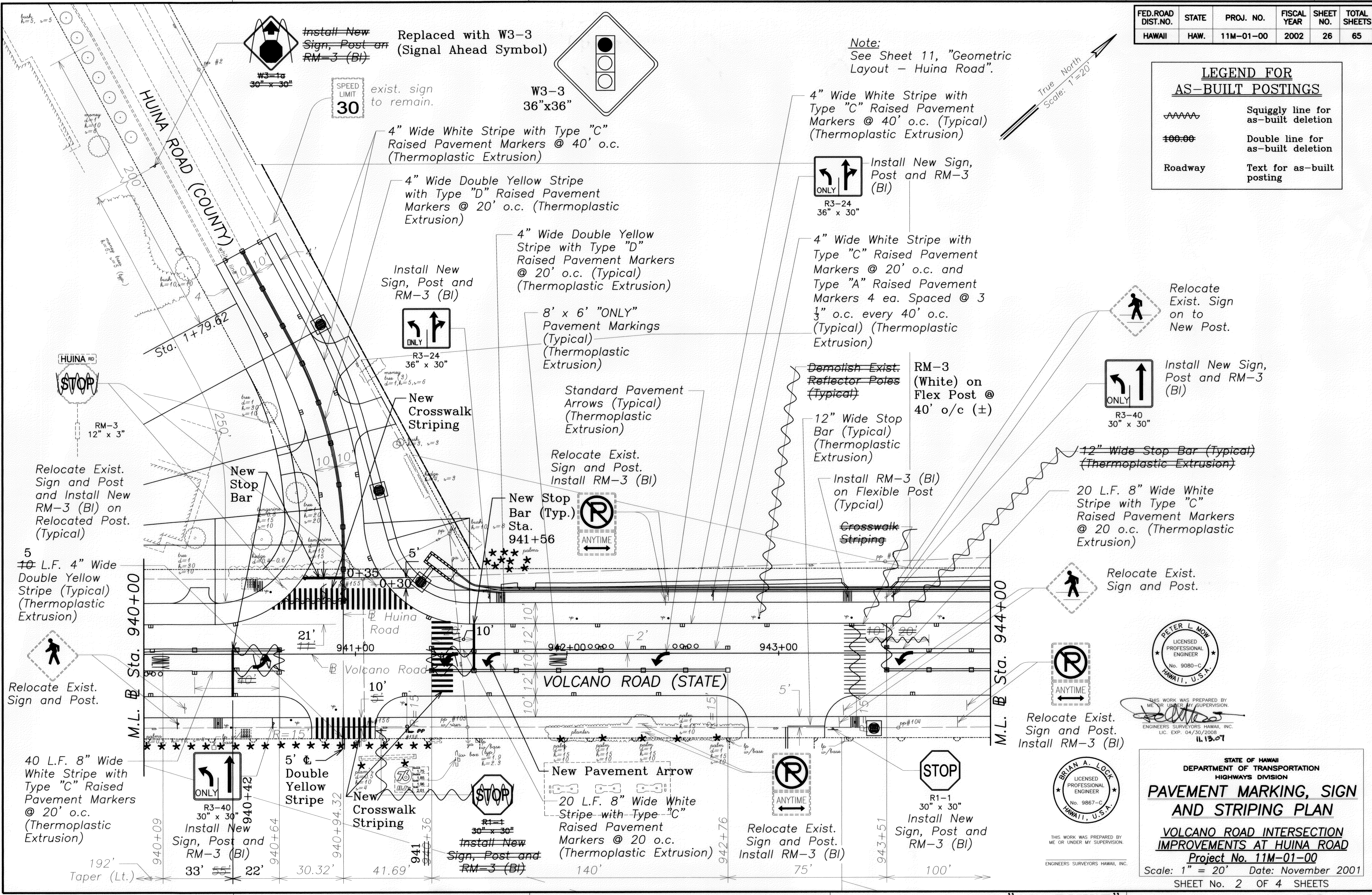
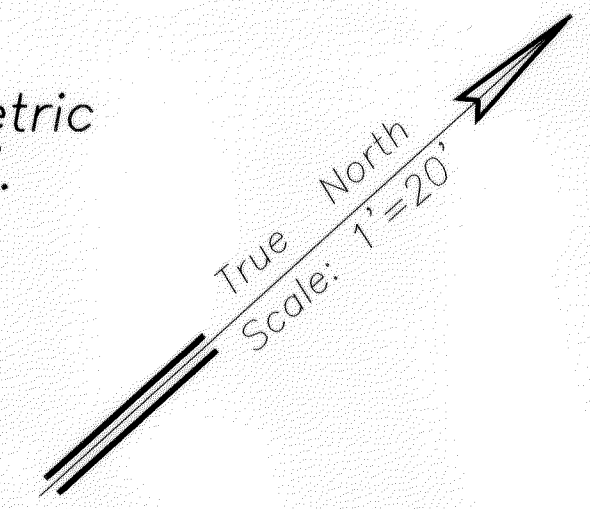

DATE	_____
SURVEY PLOTTED BY	_____
DRAWN BY	_____
DESIGNED BY	_____
QUANTITIES BY	_____
REVISED BY	_____
CHECKED BY	_____
ORIGINAL PLAN No. _____	

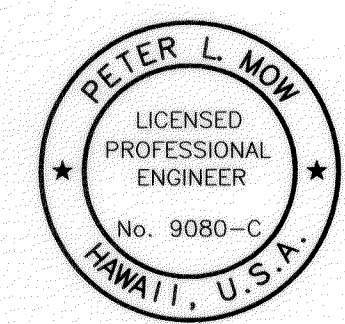

THIS WORK WAS PREPARED BY ME OR UNDER MY SUPERVISION.
 PETER L. MOW
 LICENSED PROFESSIONAL ENGINEER
 No. 9080-C
 HAWAII, U.S.A.
 11.13.07



THIS WORK WAS PREPARED BY ME OR UNDER MY SUPERVISION.
 BRIAN A. LOCK
 LICENSED PROFESSIONAL ENGINEER
 No. 9867-C
 HAWAII, U.S.A.
 ENGINEERS SURVEYORS HAWAII, INC.

STATE OF HAWAII
 DEPARTMENT OF TRANSPORTATION
 HIGHWAYS DIVISION

PAVEMENT MARKING, SIGN AND STRIPING PLAN

VOLCANO ROAD INTERSECTION IMPROVEMENTS AT HUINA ROAD
 Project No. 11M-01-00

Scale: 1" = 20' Date: November 2001
 SHEET No. 2 OF 4 SHEETS

"AS-BUILT"

FED. ROAD DIST. NO.	STATE	PROJ. NO.	FISCAL YEAR	SHEET NO.	TOTAL SHEETS
HAWAII	HAW.	11M-01-00	2002	27	65

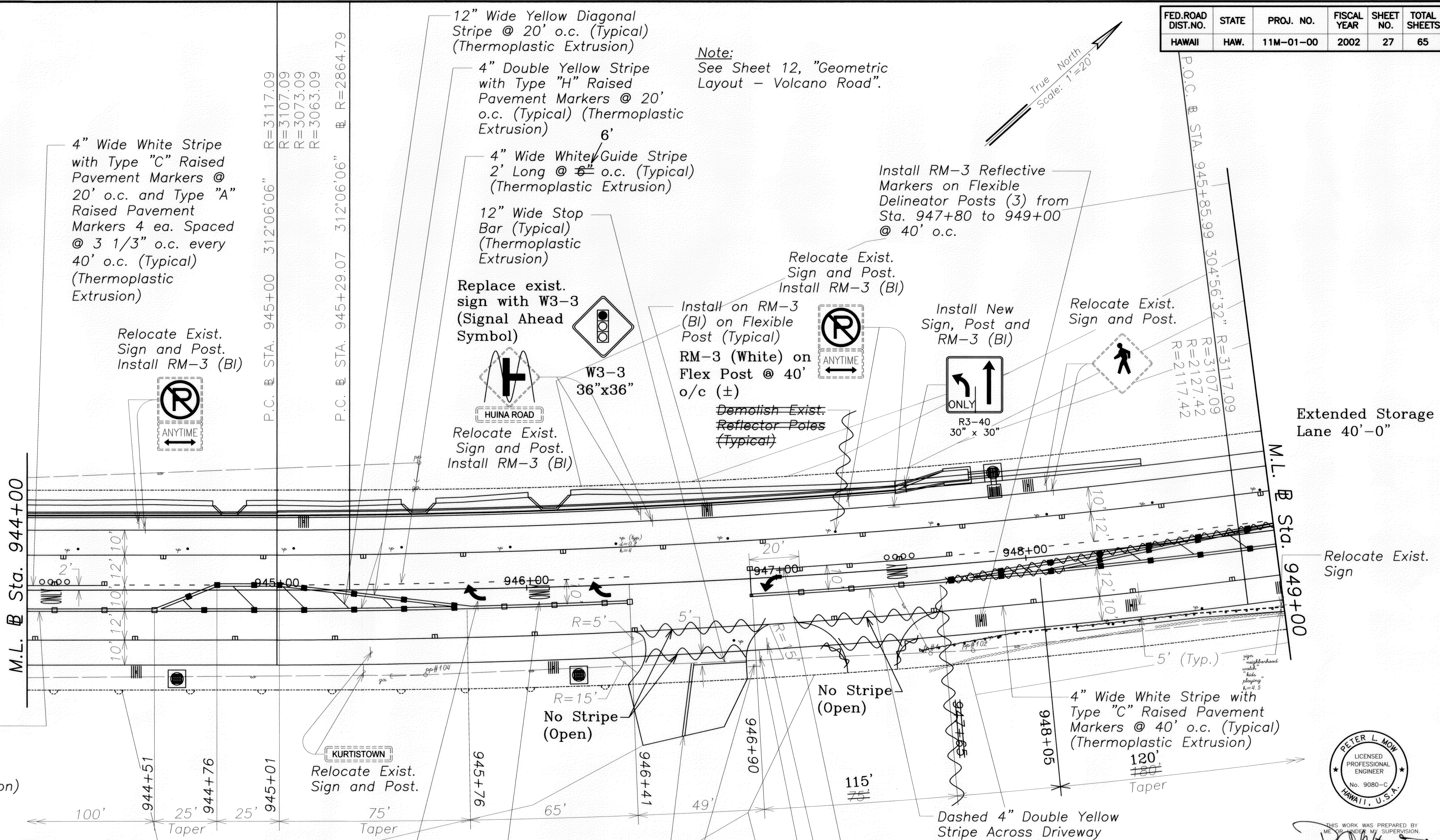
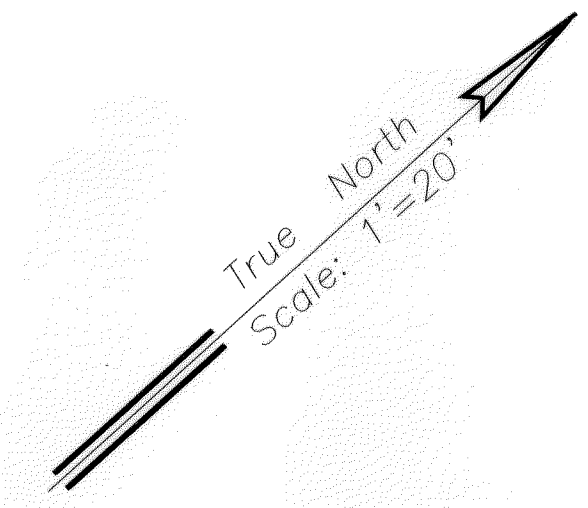

Note:
See Sheet 12, "Geometric Layout - Volcano Road".

4" Wide White Stripe with Type "C" Raised Pavement Markers @ 20' o.c. and Type "A" Raised Pavement Markers 4 ea. Spaced @ 3 1/3" o.c. every 40' o.c. (Typical) (Thermoplastic Extrusion)

12" Wide Yellow Diagonal Stripe @ 20' o.c. (Typical) (Thermoplastic Extrusion)

4" Double Yellow Stripe with Type "H" Raised Pavement Markers @ 20' o.c. (Typical) (Thermoplastic Extrusion)

4" Wide White Guide Stripe 2' Long @ 6" o.c. (Typical) (Thermoplastic Extrusion)

12" Wide Stop Bar (Typical) (Thermoplastic Extrusion)

Replace exist. sign with W3-3 (Signal Ahead Symbol)

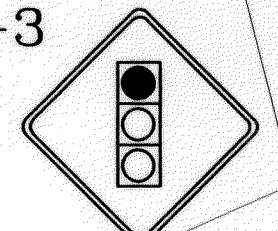

W3-3 36"x36"

Relocate Exist. Sign and Post. Install RM-3 (BI)

Install on RM-3 (BI) on Flexible Post (Typical) RM-3 (White) on Flex Post @ 40' o/c (±)

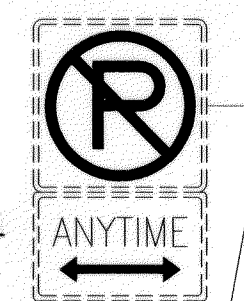

Demolish Exist. Reflector Poles (Typical)

Relocate Exist. Sign and Post. Install RM-3 (BI)

Install New Sign, Post and RM-3 (BI)

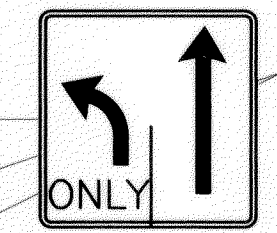

R3-40 30" x 30"

Relocate Exist. Sign and Post.

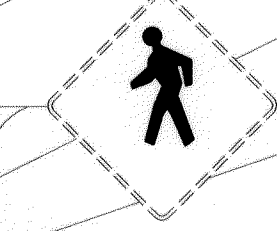

Relocate Exist. Sign and Post. Install RM-3 (BI)

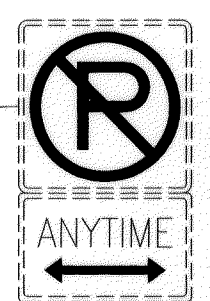

Extended Storage Lane 40'-0"

Relocate Exist. Sign

4" Double Yellow Stripe with Type "D" "D" Raised Pavement Markers @ 20' o.c. (Thermoplastic Extrusion)

No Stripe (Open)

No Stripe (Open)

4" Wide White Stripe with Type "C" Raised Pavement Markers @ 40' o.c. (Typical) (Thermoplastic Extrusion)

Dashed 4" Double Yellow Stripe Across Driveway Width (Typical)

20 L.F. 8" Wide White Stripe with Type "C" Raised Pavement Markers @ 20' o.c. (Thermoplastic Extrusion)

STOP R1-1 30" x 30" Install New Sign, Post and RM-3 (BI)

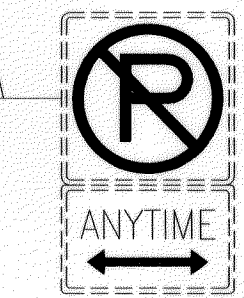
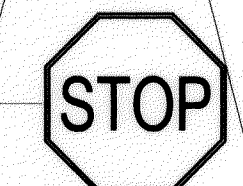

Relocate Exist. Sign and Post. Install RM-3 (BI)

4" Double Yellow Stripe in Adjusted Driveway. Match to Exist. Double Yellow Stripe. (Thermoplastic Extrusion)

Standard Pavement Arrows (Typical) (Thermoplastic Extrusion)

8' x 6" "ONLY" Pavement Markings (Typical) (Thermoplastic Extrusion)

LEGEND FOR AS-BUILT POSTINGS

- AAAAA Squiggly line for as-built deletion
- ==== Double line for as-built deletion
- Roadway Text for as-built posting

SURVEY PLOTTED BY	DATE
DRAWN BY	
DESIGNED BY	
QUANTITIES BY	
CHECKED BY	
ORIGINAL PLAN	
NOTE BOOK	
PLANT	
NO.	

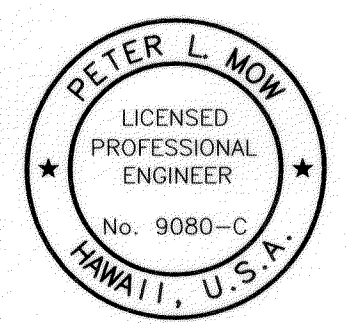

THIS WORK WAS PREPARED BY ME OR UNDER MY SUPERVISION.
Peter L. Mow
ENGINEERS SURVEYORS HAWAII, INC.
LIC. EXP. 04/30/2008
11.06.07



THIS WORK WAS PREPARED BY ME OR UNDER MY SUPERVISION.
Brian A. Lock
ENGINEERS SURVEYORS HAWAII, INC.

STATE OF HAWAII
DEPARTMENT OF TRANSPORTATION
HIGHWAYS DIVISION

PAVEMENT MARKING, SIGN AND STRIPING PLAN

VOLCANO ROAD INTERSECTION IMPROVEMENTS AT HUINA ROAD
Project No. 11M-01-00

Scale: 1" = 20' Date: November 2001
SHEET No. 3 OF 4 SHEETS

"AS-BUILT"

FED. ROAD DIST. NO.	STATE	PROJ. NO.	FISCAL YEAR	SHEET NO.	TOTAL SHEETS
HAWAII	HAW.	11M-01-00	2002	28	65

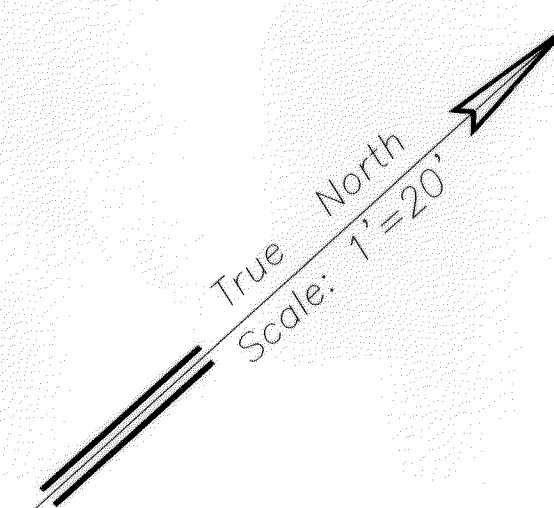
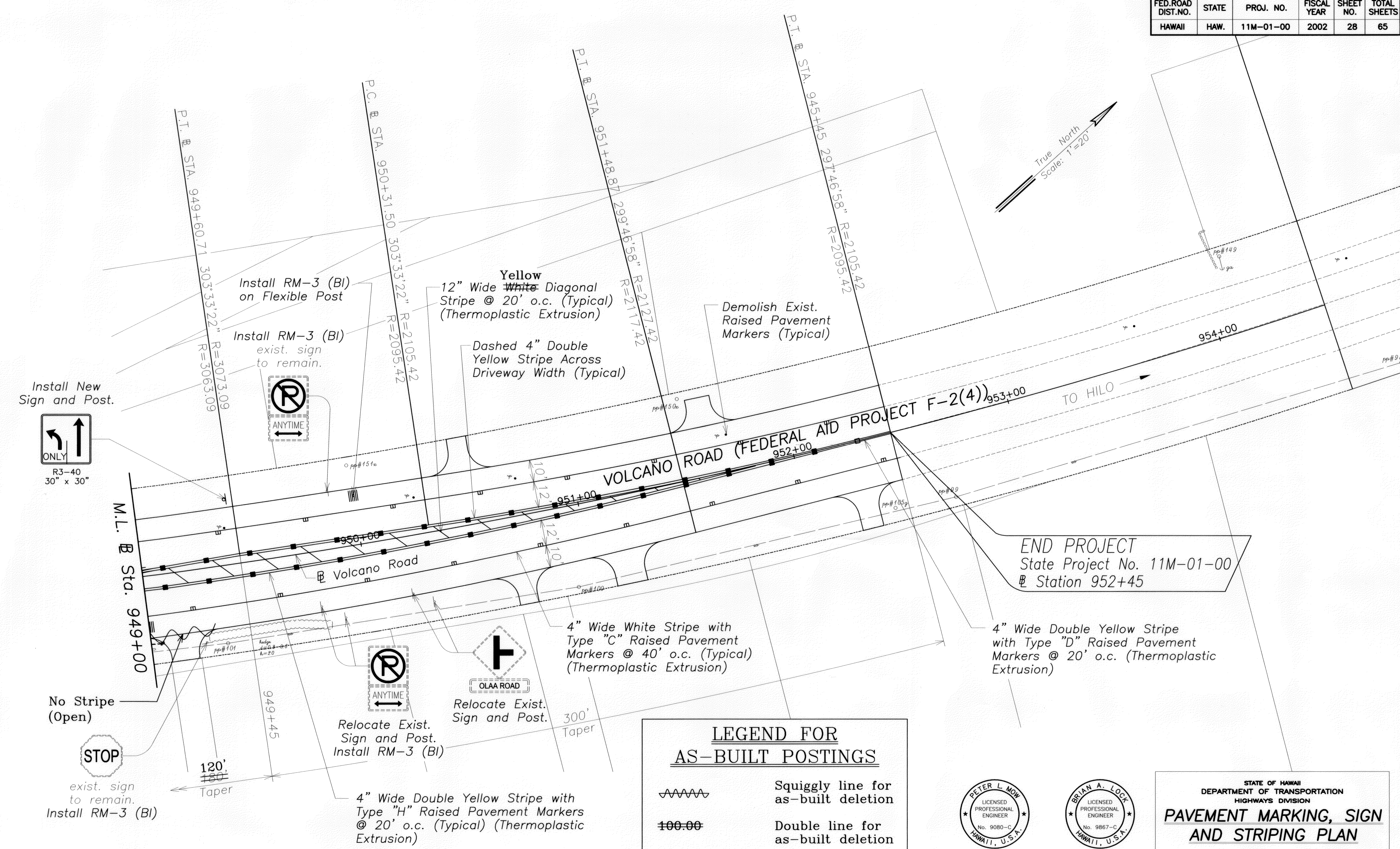

Install New Sign and Post.

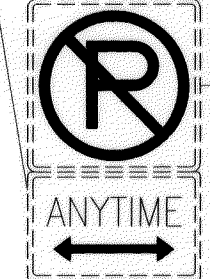
 R3-40
 30" x 30"

Install RM-3 (BI) on Flexible Post
 Install RM-3 (BI) exist. sign to remain.

 ANYTIME

Yellow ~~White~~ Diagonal Stripe @ 20' o.c. (Typical) (Thermoplastic Extrusion)
 Dashed 4" Double Yellow Stripe Across Driveway Width (Typical)

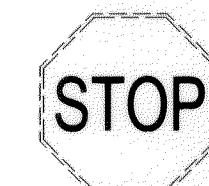
Demolish Exist. Raised Pavement Markers (Typical)

END PROJECT
 State Project No. 11M-01-00
 Station 952+45

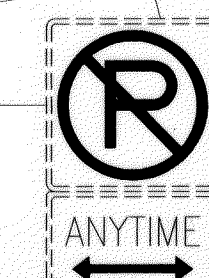
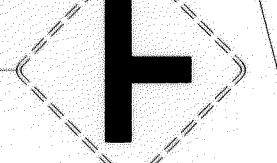
No Stripe (Open)

 exist. sign to remain.
 Install RM-3 (BI)

Relocate Exist. Sign and Post.
 Install RM-3 (BI)

 ANYTIME

 OLAA ROAD
 Relocate Exist. Sign and Post.

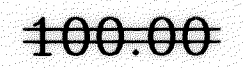
4" Wide White Stripe with Type "C" Raised Pavement Markers @ 40' o.c. (Typical) (Thermoplastic Extrusion)

4" Wide Double Yellow Stripe with Type "D" Raised Pavement Markers @ 20' o.c. (Thermoplastic Extrusion)

4" Wide Double Yellow Stripe with Type "H" Raised Pavement Markers @ 20' o.c. (Typical) (Thermoplastic Extrusion)

LEGEND FOR AS-BUILT POSTINGS	
	Squiggly line for as-built deletion
	Double line for as-built deletion
Roadway	Text for as-built posting



THIS WORK WAS PREPARED BY ME OR UNDER MY SUPERVISION.
 ENGINEERS SURVEYORS HAWAII, INC.
 LIC. EXP. 04/30/2008
 11.06.07

STATE OF HAWAII
 DEPARTMENT OF TRANSPORTATION
 HIGHWAYS DIVISION
PAVEMENT MARKING, SIGN AND STRIPING PLAN
 VOLCANO ROAD INTERSECTION IMPROVEMENTS AT HUINA ROAD
 Project No. 11M-01-00
 Scale: 1" = 20' Date: November 2001
 SHEET No. 4 OF 4 SHEETS

DATE
DESIGNED BY
TRACED BY
QUANTITIES BY
CHECKED BY
ORIGINAL PLAN
NOTE BOOK
NO. OF SHEETS
NO.

Note:
 See Sheet 12, "Geometric Layout - Volcano Road".

"AS-BUILT"