

FED. ROAD DIST. NO.	STATE	FED. AID PROJ. NO.	FISCAL YEAR	SHEET NO.	TOTAL SHEETS
HAWAII	HAW.	ER-12(2)	2001	105	145

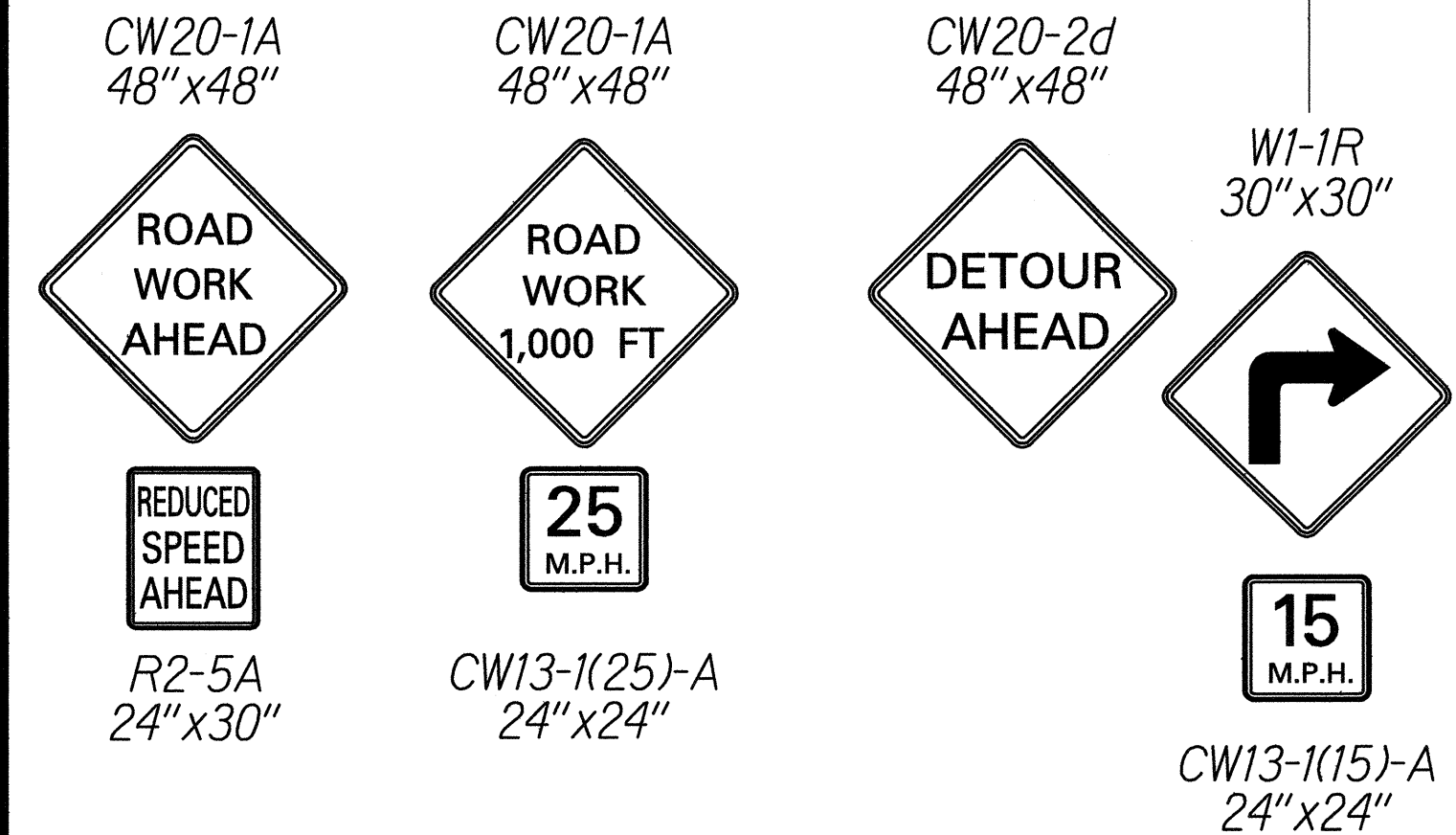
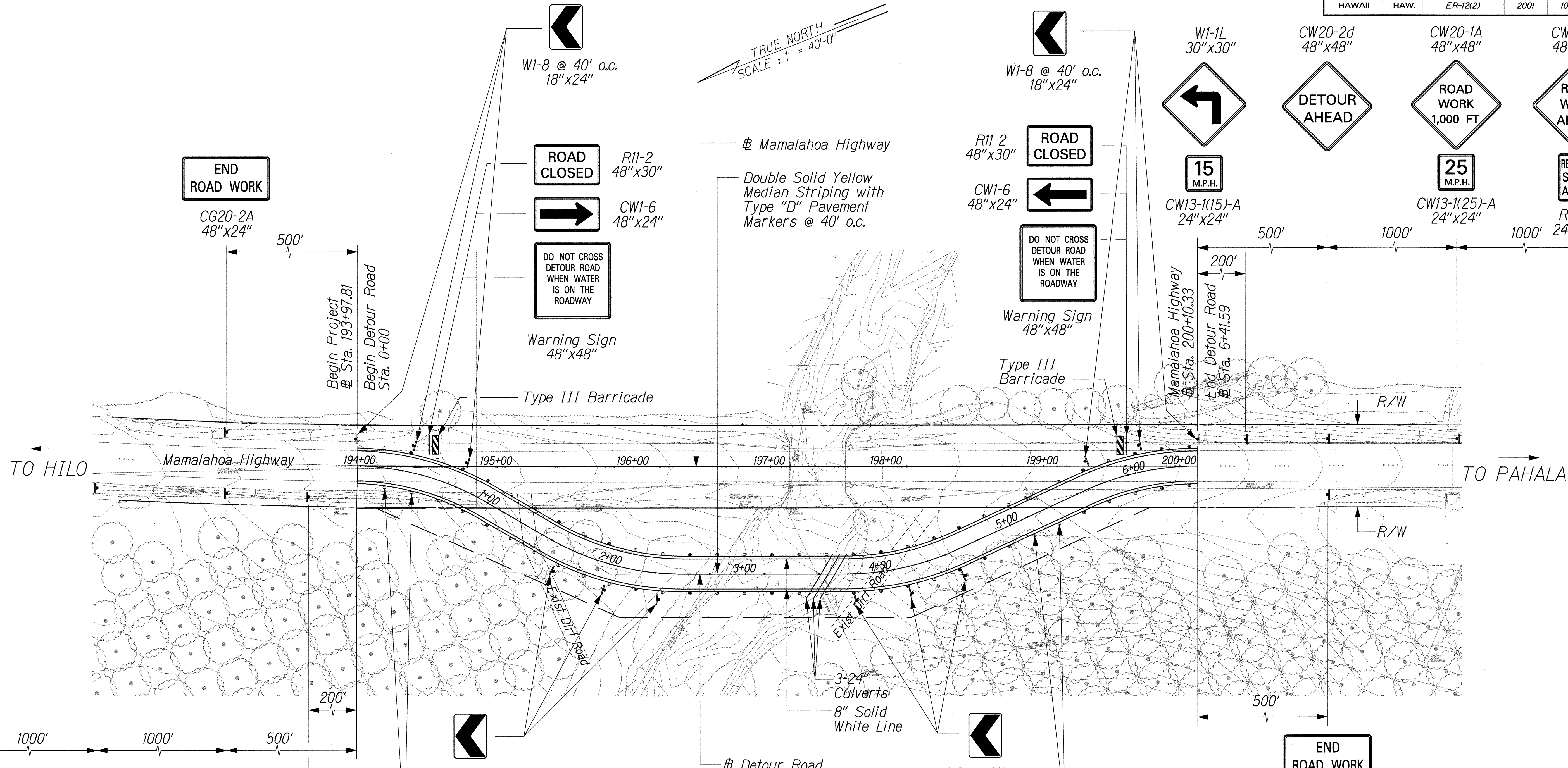

W1-8 @ 40' o.c. 18" x 24"
 Reflective Tubular Markers @ 20' o.c. (Typ.)

W1-8 @ 40' o.c. 18" x 24"
 Reflective Tubular Markers @ 20' o.c. (Typ.)

END ROAD WORK
 CG20-2A 48" x 24"

- NOTES:**
- Pavement markings and signing for the Detour Road will be considered as incidental to Detour Road Contract Items.
 - See Sheet BC23 for additional notes.

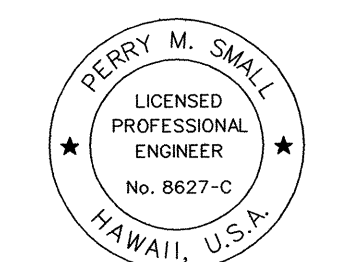

THIS WORK WAS PREPARED BY ME OR UNDER MY SUPERVISION.
Perry M. Small

STATE OF HAWAII
 DEPARTMENT OF TRANSPORTATION
 HIGHWAYS DIVISION

PAVEMENT MARKING AND SIGNING PLAN - DETOUR ROAD

MAMALAHOA HIGHWAY, EMERGENCY

REPLACEMENT OF KAALALA STREAM BRIDGE
 FEDERAL-AID PROJECT NO. ER-12(2), PAHALA, HAWAII

Scale: As Shown Date: February 20, 2001

SHEET No. BC11 OF 28 SHEETS

SURVEY PLOTTED BY	DATE
DESIGNED BY	
DESIGNED BY	
QUANTITIES BY	
CHECKED BY	
ORIGINAL PLAN	
NOTE BOOK	
No.	

44/KALAHALA-SIGN/SIGN/02.dgn May 2001