

FED. ROAD DIST. NO.	STATE	FED. AID PROJ. NO.	FISCAL YEAR	SHEET NO.	TOTAL SHEETS
HAWAII	HAWAII	ER-12(2)	2001	14	145

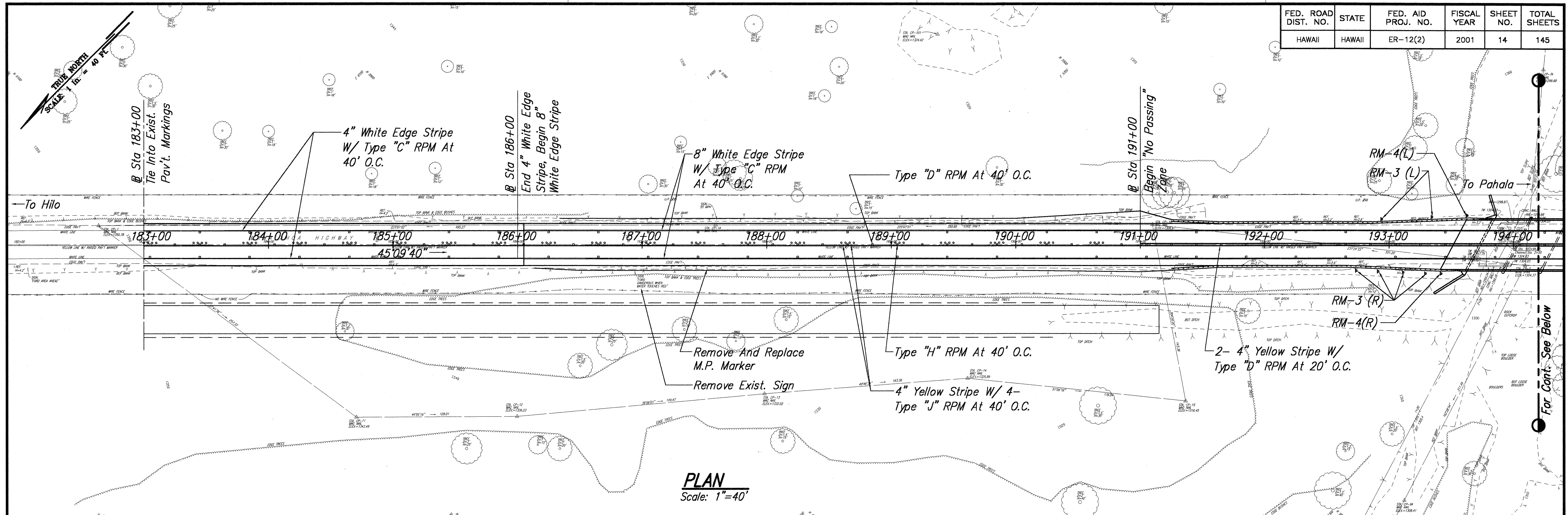

PLAN
Scale: 1"=40'

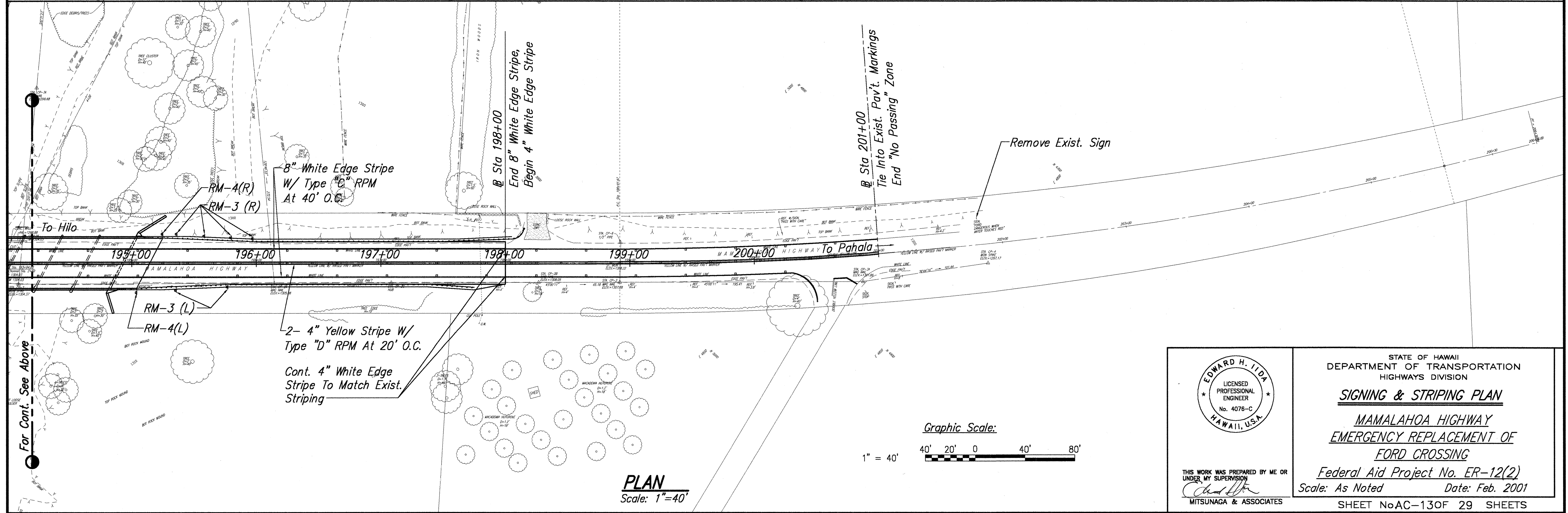

PLAN
Scale: 1"=40'

Graphic Scale:

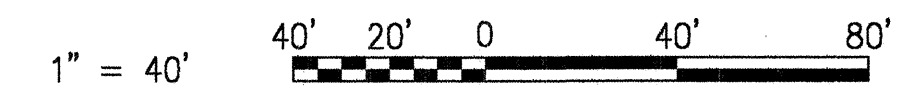

DATE
SURVEY PLOTTED BY
DRAWN BY
DESIGNED BY
CHECKED BY
ORIGINAL PLAN
NOTE BOOK
No.

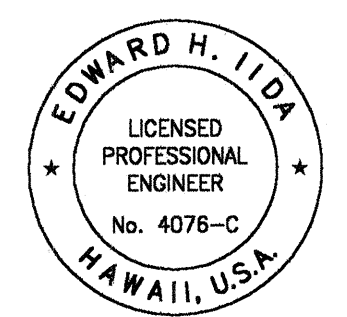

STATE OF HAWAII
DEPARTMENT OF TRANSPORTATION
HIGHWAYS DIVISION

SIGNING & STRIPING PLAN

MAMALAHOA HIGHWAY
EMERGENCY REPLACEMENT OF
FORD CROSSING

Federal Aid Project No. ER-12(2)
Scale: As Noted Date: Feb. 2001

SHEET No AC-13 OF 29 SHEETS

THIS WORK WAS PREPARED BY ME OR UNDER MY SUPERVISION

Edward H. Iida

EDWARD H. IIDA
MITSUNAGA & ASSOCIATES