

FED. ROAD DIST. NO.	STATE	FED. AID PROJ. NO.	FISCAL YEAR	SHEET NO.	TOTAL SHEETS
HAWAII	HAW.	STP-011-1(22)	1999	4	14

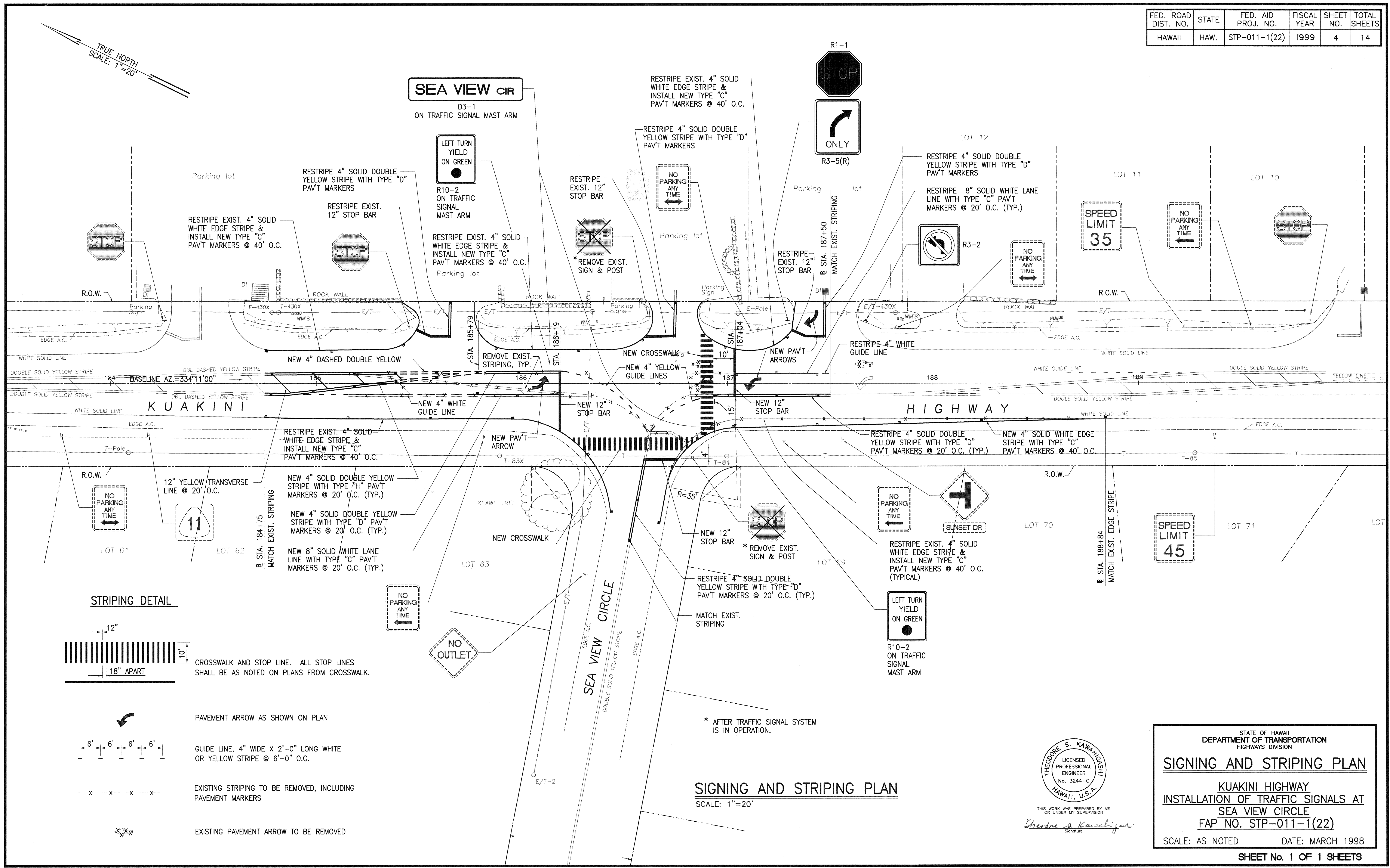

**STRIPING DETAIL**

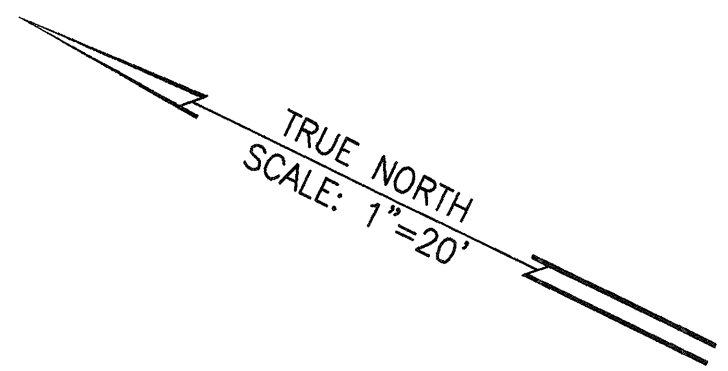
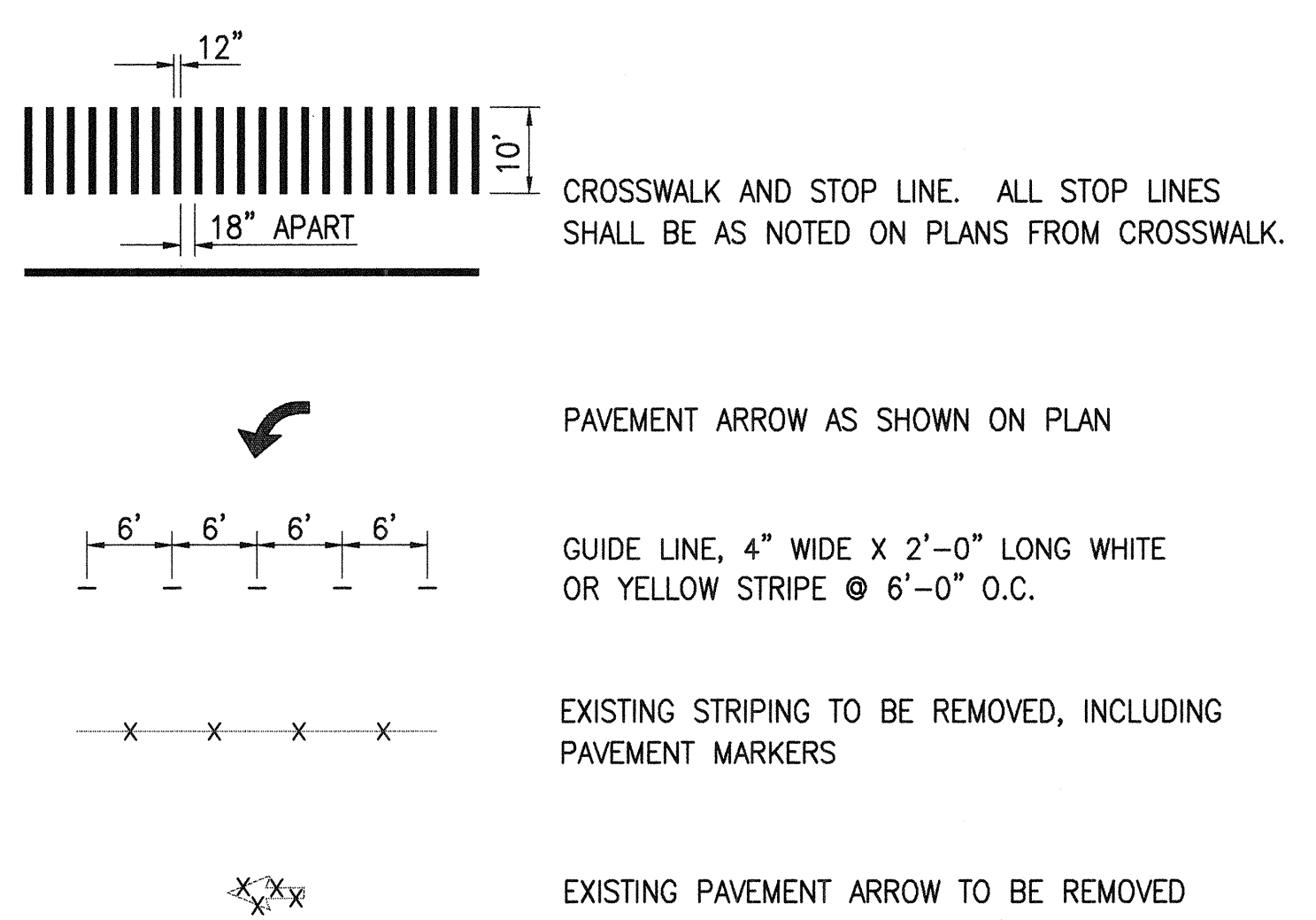

**SIGNING AND STRIPING PLAN**  
SCALE: 1"=20'

\* AFTER TRAFFIC SIGNAL SYSTEM IS IN OPERATION.

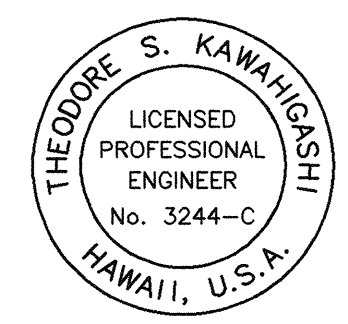

THIS WORK WAS PREPARED BY ME OR UNDER MY SUPERVISION  
*Theodore S. Kawahigashi*  
Signature

STATE OF HAWAII  
DEPARTMENT OF TRANSPORTATION  
HIGHWAYS DIVISION

**SIGNING AND STRIPING PLAN**

KUAKINI HIGHWAY  
INSTALLATION OF TRAFFIC SIGNALS AT  
SEA VIEW CIRCLE  
FAP NO. STP-011-1(22)

SCALE: AS NOTED      DATE: MARCH 1998

SHEET No. 1 OF 1 SHEETS